



# MONTGOMERY COUNTY CEMETERY INVENTORY REVISITED

## BURIAL SITE INFORMATION

Name: <b>Richardson Family Cemetery [LOST]</b>	Inventory ID: <b>017</b>
Alternate name: "Mount Airy"	
Address: <b>Vicinity of 18120 New Hampshire Avenue, Ashton</b>	
Website:	
GPS coordinates: Latitude: <b>39.154277</b>	Longitude: <b>-77.014750</b>
FindaGrave: <a href="https://www.findagrave.com/cemetery/2647949">https://www.findagrave.com/cemetery/2647949</a>	

## BURIAL SITE TYPE

Category:  Religious  Community  **Family**  African American  Other:

## BURIAL SITE EVALUATION

Setting/location description: <input type="checkbox"/> Rural <input type="checkbox"/> Urban <input type="checkbox"/> <b>Suburban</b> <input type="checkbox"/> Wooded <input type="checkbox"/> Other:		
General condition (See conditions sheet): <input type="checkbox"/> Excellent <input type="checkbox"/> Good <input type="checkbox"/> Fair <input type="checkbox"/> Poor <input checked="" type="checkbox"/> <b>None</b>		
Is there a formal entrance? <input type="checkbox"/> Yes <input type="checkbox"/> No	Accessibility: <input type="checkbox"/> Inaccessible <input type="checkbox"/> By foot <input type="checkbox"/> By car	
Is cemetery active (recent burials)? <input type="checkbox"/> Yes <input type="checkbox"/> No	Is there a cemetery sign: <input type="checkbox"/> Yes <input type="checkbox"/> No	
Is cemetery being maintained? <input type="checkbox"/> Yes <input type="checkbox"/> Minimal <input type="checkbox"/> No (If yes, note caretaker's name below)		
Are there visible markers? <input type="checkbox"/> Yes <input type="checkbox"/> No	Approximate number of burials/visible markers: <b>2</b>	Date ranges: <b>1764-1767</b>
Description: (markers, materials, arrangement, landscaping/vegetation, fence, paths and roads, etc.)		
<ul style="list-style-type: none"> <li>• <b>According to Farquhar, there were two grave markers in the field west of the present house.</b></li> <li>• <b>Site may actually be in woods located behind 18200 New Hampshire Avenue.</b></li> </ul>		

## BURIAL SITE CONTACT

Name: <b>Lynn and Karen Schilling</b>		
Relationship to burial site: <b>Owner</b>	Advocacy contact:	
		Phone:
City:	State:	ZIP Code:

## BURIAL SITE SURVEYOR

Name: <b>Glenn Wallace</b>	Survey Date:	Time spent:
Email: <a href="mailto:mococems@gmail.com">mococems@gmail.com</a>		
Photographer:		

## COMMENTS

Suggestions for follow-up:
<ul style="list-style-type: none"> <li>• <b>Ask for permission to search the woods for two grave markers.</b></li> </ul>
Safety issues, invasive vegetation removal, fence removal/restoration, signage, trash, erosion, vandalism:
Anything of significance about this cemetery?
<p><b>Samuel Richardson's grave in the field west of the present house is marked by a large tombstone: "Here lies the body of Mr. Samuel Richardson who departed this life 18 February 1764, aged 58 years," and beside it is another stating that "Maria Richardson departed this life 24 June, 1767, aged 57 years." ~Farquhar</b></p>

## SOURCES

Cite sources used and resources available:
<ul style="list-style-type: none"> <li>• <a href="https://mht.maryland.gov/secure/medusa/PDF/Montgomery/M;%2028-3.pdf">https://mht.maryland.gov/secure/medusa/PDF/Montgomery/M;%2028-3.pdf</a></li> </ul>

**This is a suggested location, but no trace of the cemetery exists.**

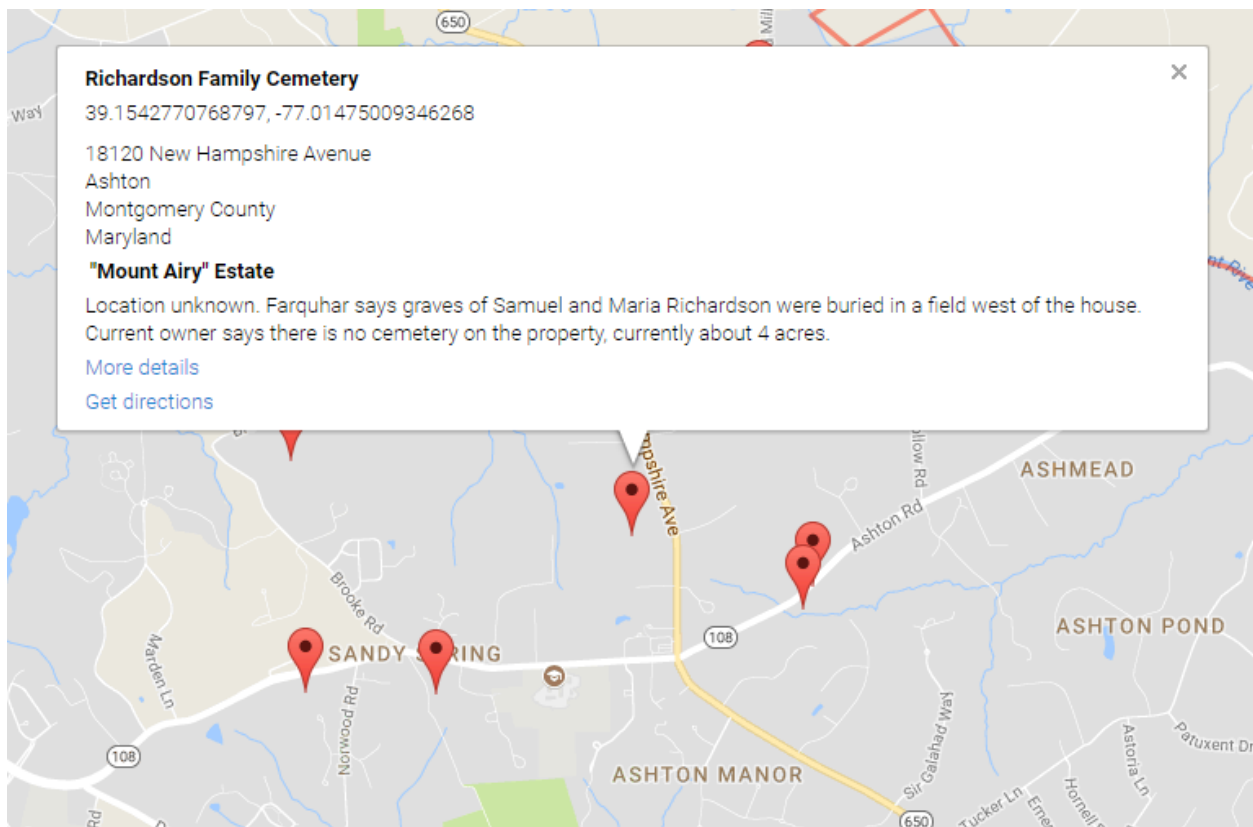

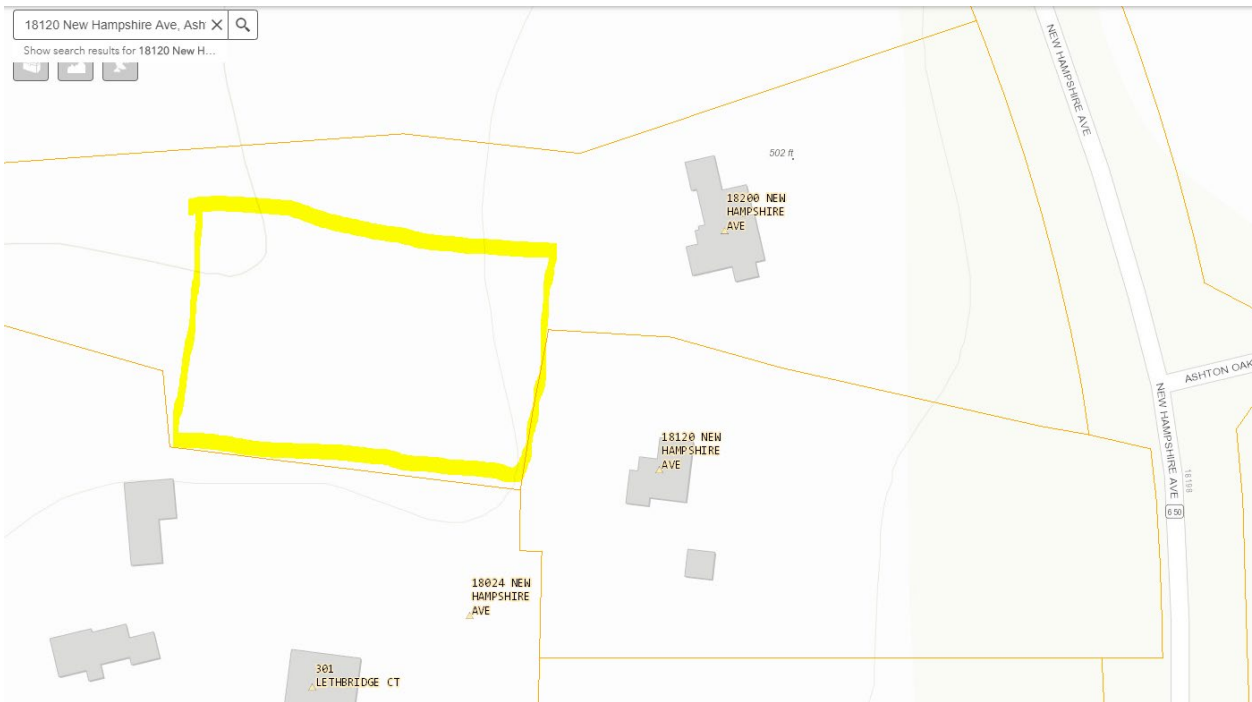



## Montgomery County Cemetery Inventory Photograph Log

<b>Cemetery Name:</b>		<b>Inventory ID:</b>
<b>Photographer:</b>		<b>Date:</b>
<b>Time</b>	<b>Photo No.</b>	<b>Description and direction you are facing</b>
	<b>1</b>	
	<b>2</b>	
	<b>3</b>	
	<b>4</b>	