

Montgomery County Cemetery Inventory

ID: 24

Name: Owen Family Cemetery

Alternate name:

Address: ~~Norbeck Country Club~~ near tennis courts

17200 Cashell Rd

Town: Rockville

ADC Map Page 21 Grid A-9

Type

Religious
 Family Owen
 Private
 Other

Association

Free black
 Enslaved
 Ethnic
 Prehistoric

Setting Rural Urban Suburban Forested Other Country Club

Condition Excellent Good Fair Poor

Negative Impacts (vandalism, dumping, neglect, encroachment, etc)

Approximate no. of burials 12 Date range of burials 1838 - 1894

Description (markers, materials, arrangement, landscaping, fence, paths and roads, etc.)

ON GROUNDS OF NORBECK COUNTRY CLUB.

9 markers; 7 with footstones; arranged in 3 rows. Not sure if markers - ~~some~~ markers are in original locations? May have been set upright by country club. Historic wrought iron fence surrounds cemetery. Few trees around edges between Club House & Tennis Shop ~~lies within com.~~

Surveyor(s) Nancy Kassner/Kari Survey date 8-1-2004

Photographer _____ Date _____ Photo no. _____

Current owner Norbeck Country Club

Address/Phone No. 17200 Cashell Rd.

Historic Status Locational Atlas ID National Register
 Master Plan ID Other

UTM _____

Additional sources of information:

1840 1852 See file @ Peerless Rockville
1851 1894
1879 1917

24
OWEN FAMILY CEMETERY
17200 CASHELL ROAD
ROCKVILLE

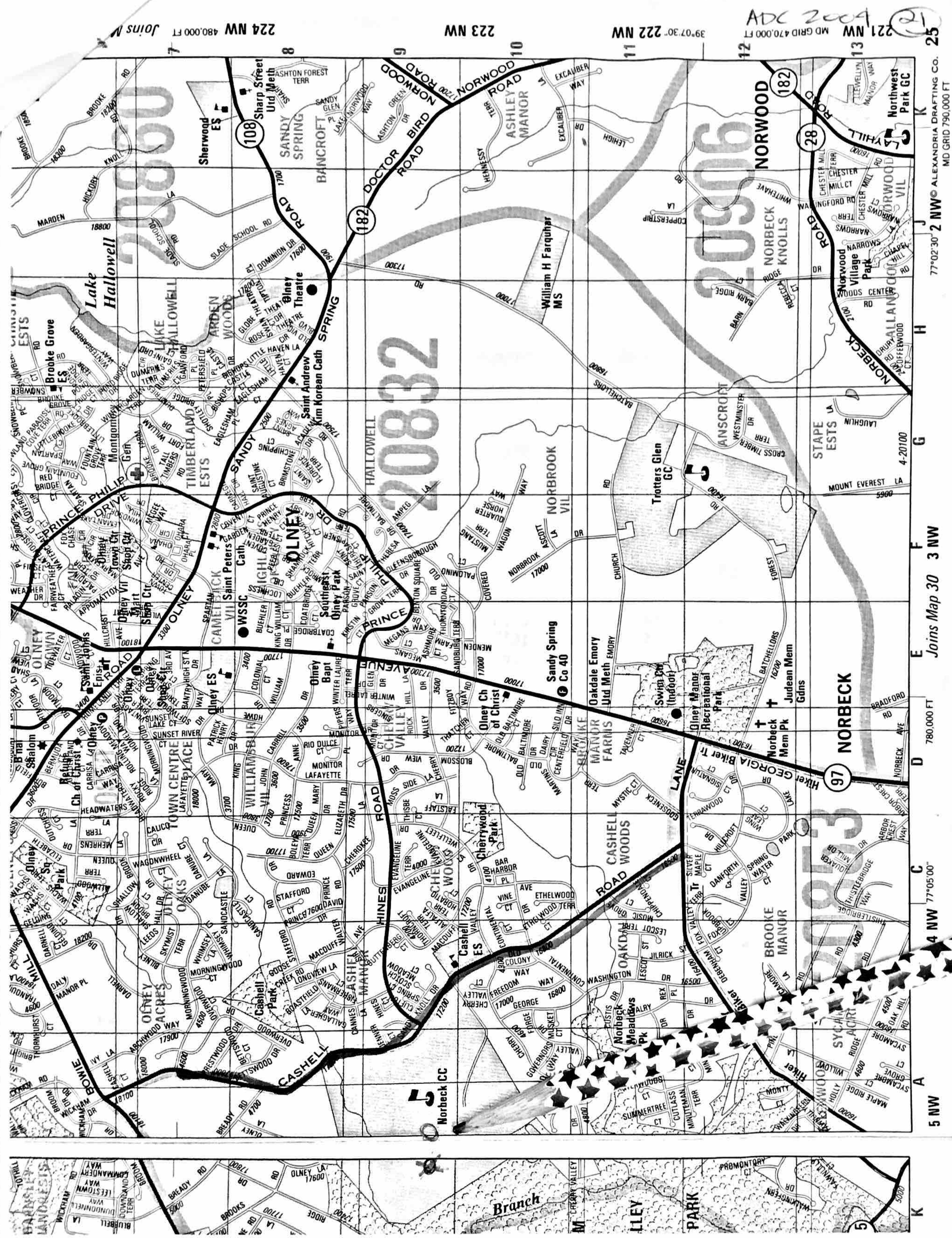

ADC 2004
 221 NW MD GRID 470,000 FT
 222 NW 39°07'30"
 223 NW
 224 NW 480,000 FT
 Joins N

25
 77°02'30" 2 NW
 ALEXANDRIA DRAFTING CO.
 MD GRID 790,000 FT
 780,000 FT
 77°05'00"
 4 NW
 5 NW
 3 NW
 Joins Map 30

24
 OWEN FAMILY CEMETERY
 17200 CASHELL ROAD
 ROCKVILLE

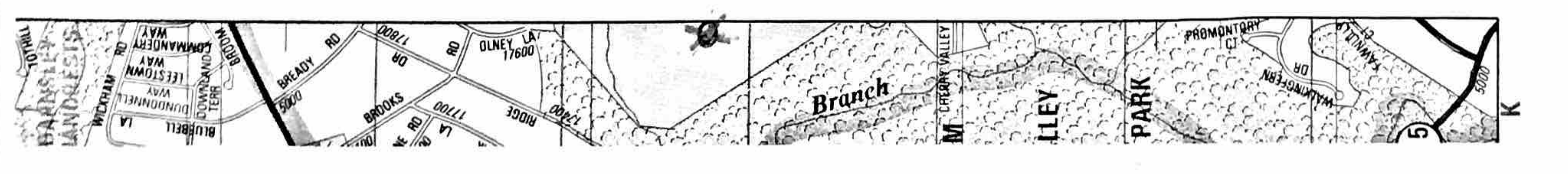

FAMILY BURYING GROUND AT NORBECK

Locations: Route 115 West, Muncaster Mill Road, right on Bowie Mill Road, right on Cashell Road. [A.D.C. Map: Montgomery, page 24, grid coordinates H-3.] **Condition of cemetery:** Neglected and overgrown in 1970, may no longer exist. **Inactive cemetery.** **Earliest known death:** 1840. **Most recent death:** 1894. **Date transcribed:** 1970. **Location of transcribed records:** Montgomery County Historical Society Library, 42 West Middle Lane, Rockville, Maryland 20850. **Comments:** At least 5 marked graves, located near the tennis courts at Norbeck Country Club.

24

OWEN FAMILY CEMETERY
17200 CASHELL ROAD
ROCKVILLE

Margaret A. Clagett died June 5, 1890; age 102
 Nathaniel Clagett died April 17, 1838; age 55
 Edward W. Owen died March 21, 1895; age 87
 Laura Clagett, daughter of E. W. and E. A. Owen
 Mary V. Owen, daughter of Edward and E. A. Owen

Colonel Gustavus W. Dorsey was in command of the last cavalry attack made by the southern forces in the Civil War. He was the son of Samuel Owings Dorsey and his wife, Mary Riggs Griffith. Samuel was the son of Dennis and Maria Owings Dorsey and Mary Riggs Griffith was the daughter of Philemon Griffith and his wife, Sarah Hammond Riggs.

Colonel Gustavus Dorsey married Margaret Owen, probably the daughter of Edward W. and Elizabeth Owen. Edward W. Owen married Elizabeth Clagett in 1830. She was the daughter of Nathaniel and Margaret A. Clagett buried in the cemetery.

OWEN FAMILY

The Owen cemetery is located in an overgrown area near the tennis courts on the Norbeck Country Club property. According to the 1865 map, there was a home in this area owned by W. W. Owen.

Col. W. Owen d. Jun 8, 1846 age 69 yrs.

Inscriptions on the tombstones:

H. M. O. dau of W. W. & A. G. Owen d Nov 22, 1851. aged 3 mos.

- ✓ L. Robinson died June 17, 1840; age 16 years
- ✓ Mary S. Owen, wife of W. W. Owen, died Dec. 7, 1894; age 87
- ✓ W. W. Owen, born November 30, 1813; died April 11, 1891
- ✓ Angelina Owen, wife of W. W. Owen, died February 19, 1852; age 37
- Angela C. Owen, wife of Col. W. Owen, died June 18, 1876, age 67 — *not there July 2004*
- R. Owen (could this be Robert, the brother of Washington W. Owen?)
- ✓ LAURA dau of W. W. & A. G. Owen d JUL 18, 1870 aged 29 yrs

The Reverend Robert Owen was sent to Maryland from Scotland to report to his parishioners the "condition of the colony". He returned to Maryland in 1695 and acquired a large tract of land on which he built a log house he called Contentment. His son Edward was the next owner and in 1730 this property was owned by Major Robert Owen, Jr.

*M. C. Hooper M. Owen age 2 yrs. 9 mos. d. 8 May 1838
 H. C. " " " " age 1 yr 3 mos d. 9. 70 1837*

Robert Owen in his will of 1779 left his home to his son, Washington Winder Owen. Adjoining lands were left to his sons Robert and Edward.

Washington Winder Owen was a county school trustee in 1881-1882 and for a time served as a director of the Sandy Spring Savings Institution. From the names carved on the stones in the cemetery it seems that Washington Winder Owen was married three times.

Catherine Goldsborough Owen, the daughter of W. W. Owen, was next in line to inherit the home place. She married Thomas John Beall, the son of Eden and Priscilla Beall, who lived at Flint Hill on the road from Norbeck to Norwood. Catherine and Thomas John Beall changed the name of the property from Contentment to Locust Hill. In 1900 the land was sold and went out of the hands of the Owen family.

(To be continued in a future issue)

d. Jan 22 1848 aged 14 yrs

24
 OWEN FAMILY CEMETERY
 17200 CASHELL ROAD
 ROCKVILLE