

MONTGOMERY COUNTY CEMETERY INVENTORY

Survey ID 35

Cemetery name Howes Family

Alternate name(s) _____

Address (or direction from nearest intersection) Across street from Watkins Mill H.S. close to corner of Middlebrook Rd + Mid-Country Hwy

ADC Map Page 19 Grid B-1 Town _____

Type _____ Association _____
 Religious _____ Free black _____
 Family _____ Enslaved _____
 Private _____ Ethnic Euro-American _____
 Other _____ Prehistoric _____

Setting Rural Urban Suburban Forested Other _____

Condition Excellent Good Fair Poor

Negative Impacts (vandalism, dumping, neglect, encroachment, etc) _____

Approximate no. of burials 11+ Date range of burials _____

Description (markers, materials, arrangement, landscaping, fence, paths and roads, etc.)

marker slabs bottom 1/2 of marker? No writing. see back →

Surveyor(s) Jim Sorenson Kathy Steuer Vivian Eicke Survey date 11/17/04
 Photographer A Brockett Date 4/17/05 Photo no. _____

Current owner M-DCPPC GREAT SENECA PARK
 Address/Phone No. 8787 GEORGIA AVE, SILVER SPRING MD 301-495-7600
 Historic Status Locational Atlas ID _____ National Register _____
 Master Plan ID _____ Other _____

UTM Waypoint (132) N 39.18315° W 77.22318°

Additional sources of information:

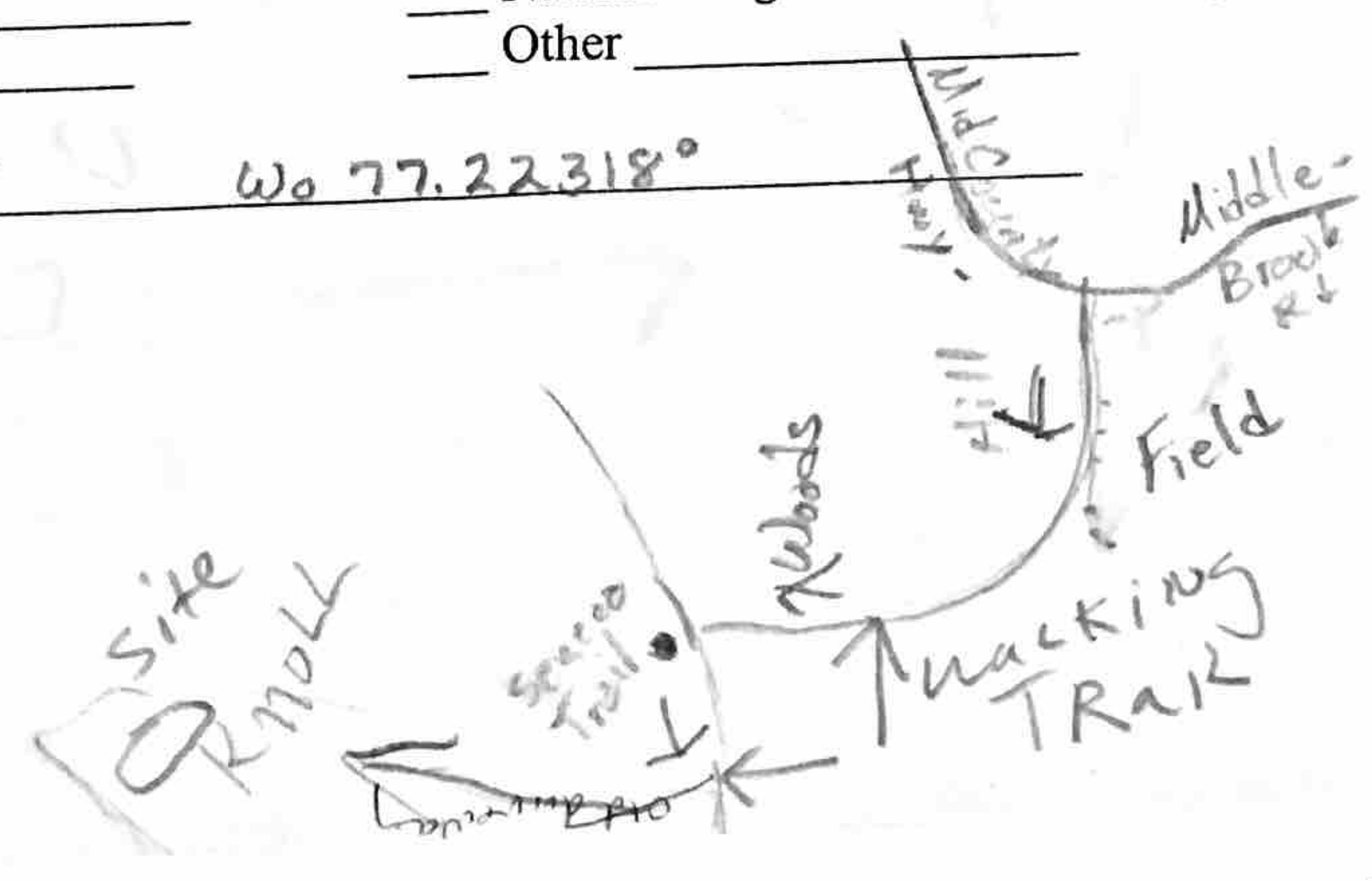

35
 HOWES (LEVEN) FAMILY CEMETERY
 NEAR MIDDLEBROOK RD & MIDDLECOUNTRY HIGHWAY INTERSECTION
 MIDDLEBROOK

HOWES (LEVEN) FAMILY CEMETERY
NEAR MIDDLEBROOK RD & MIDDLEBROOK
HIGHWAY INTERSECTION
MIDDLEBROOK

HOWES (LEVEN) FAMILY BURYING GROUND NEAR MID-
DLEBROOK
Directions: Route 355 North, right on Blunt Road, in housing develop-
ment. [A.D.C. Map: Montgomery, page 13, grid coordinates G-8.] Con-
dition of cemetery: Unknown. Inactive cemetery. Location of transcribed
records: Montgomery County Historical Society Library, 42 West Middle
Lane. Rockville, Maryland 20850. Comments: Only one marked grave.

- + = In place small fieldstone markers
- = Headstone base
- D = quartz rock

