



MONTGOMERY COUNTY CEMETERY INVENTORY REVISITED

BURIAL SITE INFORMATION

Name: Hickman Family Cemetery	Inventory ID: 038
Alternate name: Edwards Ferry Cemetery	County ID: M: 16-25
Address: Located .45 miles north of intersection of Edwards Ferry Road and River Road, Poolesville	
Website:	
GPS coordinates: Latitude: 39.110463	Longitude: -77.475000
FindaGrave: https://www.findagrave.com/cemetery/2528478	

BURIAL SITE TYPE

Category: Religious Community **Family** African American Other:

BURIAL SITE EVALUATION

Setting/location description: <input checked="" type="checkbox"/> Rural <input type="checkbox"/> Urban <input type="checkbox"/> Suburban <input checked="" type="checkbox"/> Wooded <input type="checkbox"/> Other:		
General condition (See conditions sheet): <input type="checkbox"/> Excellent <input type="checkbox"/> Good <input type="checkbox"/> Fair <input checked="" type="checkbox"/> Poor <input type="checkbox"/> None		
Is there a formal entrance? <input type="checkbox"/> Yes <input checked="" type="checkbox"/> No	Accessibility: <input type="checkbox"/> Inaccessible <input type="checkbox"/> By foot <input checked="" type="checkbox"/> By car	
Is cemetery active (recent burials)? <input type="checkbox"/> Yes <input checked="" type="checkbox"/> No	Is there a cemetery sign: <input type="checkbox"/> Yes <input checked="" type="checkbox"/> No	
Is cemetery being maintained? <input type="checkbox"/> Yes <input type="checkbox"/> Minimal <input checked="" type="checkbox"/> No (If yes, note caretaker's name below)		
Are there visible markers? <input checked="" type="checkbox"/> Yes <input type="checkbox"/> No	Approximate number of burials/visible markers: 12?	Date ranges: 1760-1788
Description: (markers, materials, arrangement, landscaping/vegetation, fence, paths and roads, etc.)		
• Scattered burial areas, roughly 100' x 50' located 30' west of River Road. (See map)		
• Majority of markers are unmarked fieldstones in three separate areas.		
• All trees mentioned in previous 2004 inventory report are now fallen.		

BURIAL SITE CONTACT

Name: US Dept of the Interior		
Relationship to burial site: Owner		Advocacy contact:
Address:		Phone:
City:	State:	ZIP Code:

BURIAL SITE SURVEYOR

Name: Glenn Wallace	Survey Date: 12/8/2018	Time spent: 20 min
Email: mococems@gmail.com	Photographer: Glenn Wallace	

COMMENTS

Suggestions for follow-up:

- **Remove fallen trees and rake out overgrowth**
- **Maybe put up a cemetery sign, though this might bring vandals**

Safety issues, invasive vegetation removal, fence removal/restoration, signage, trash, erosion, vandalism:

Anything of significance about this cemetery?

- **Montgomery County's oldest cemetery**

SOURCES

Cite sources used and resources available:

- <https://mht.maryland.gov/secure/medusa/PDF/Montgomery/M:%2016-25.pdf>

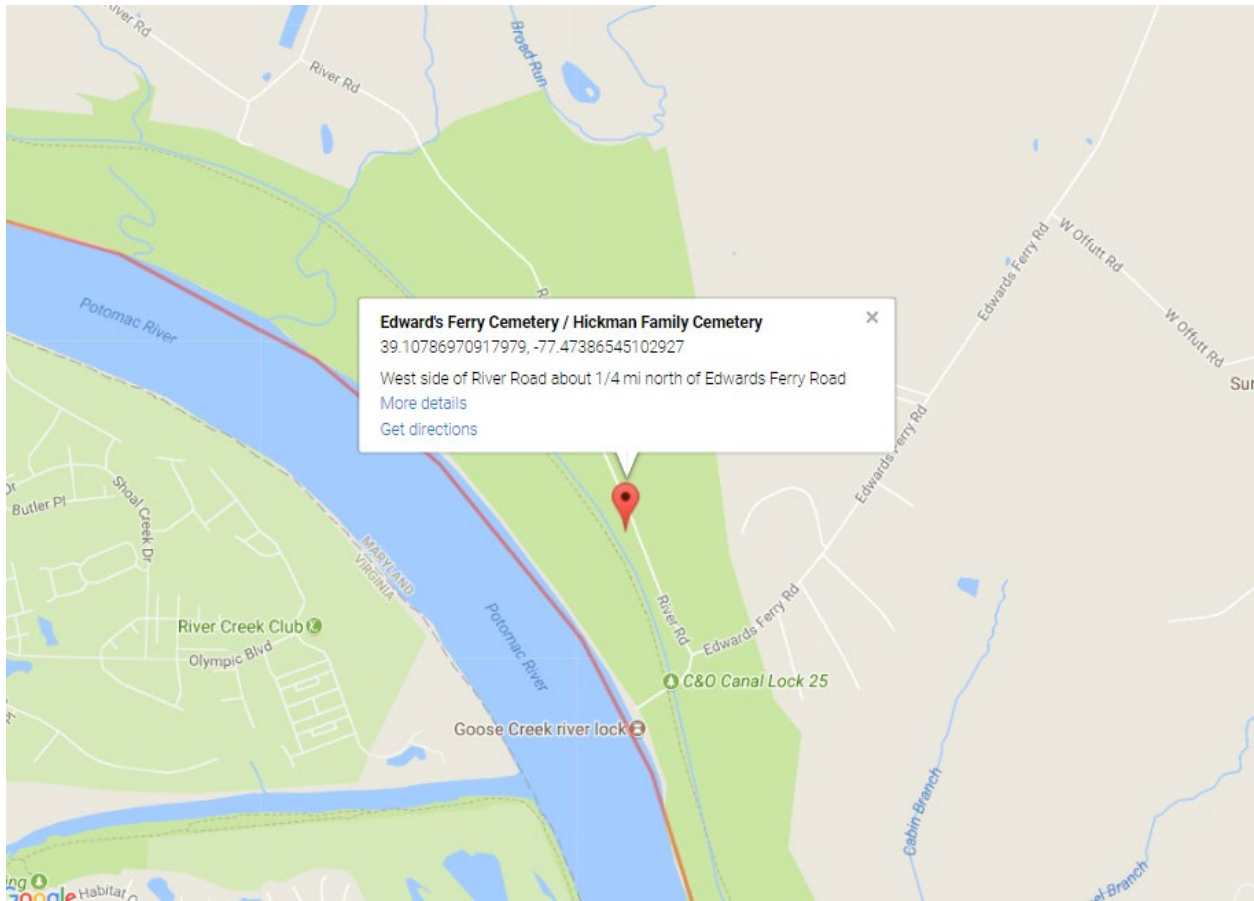

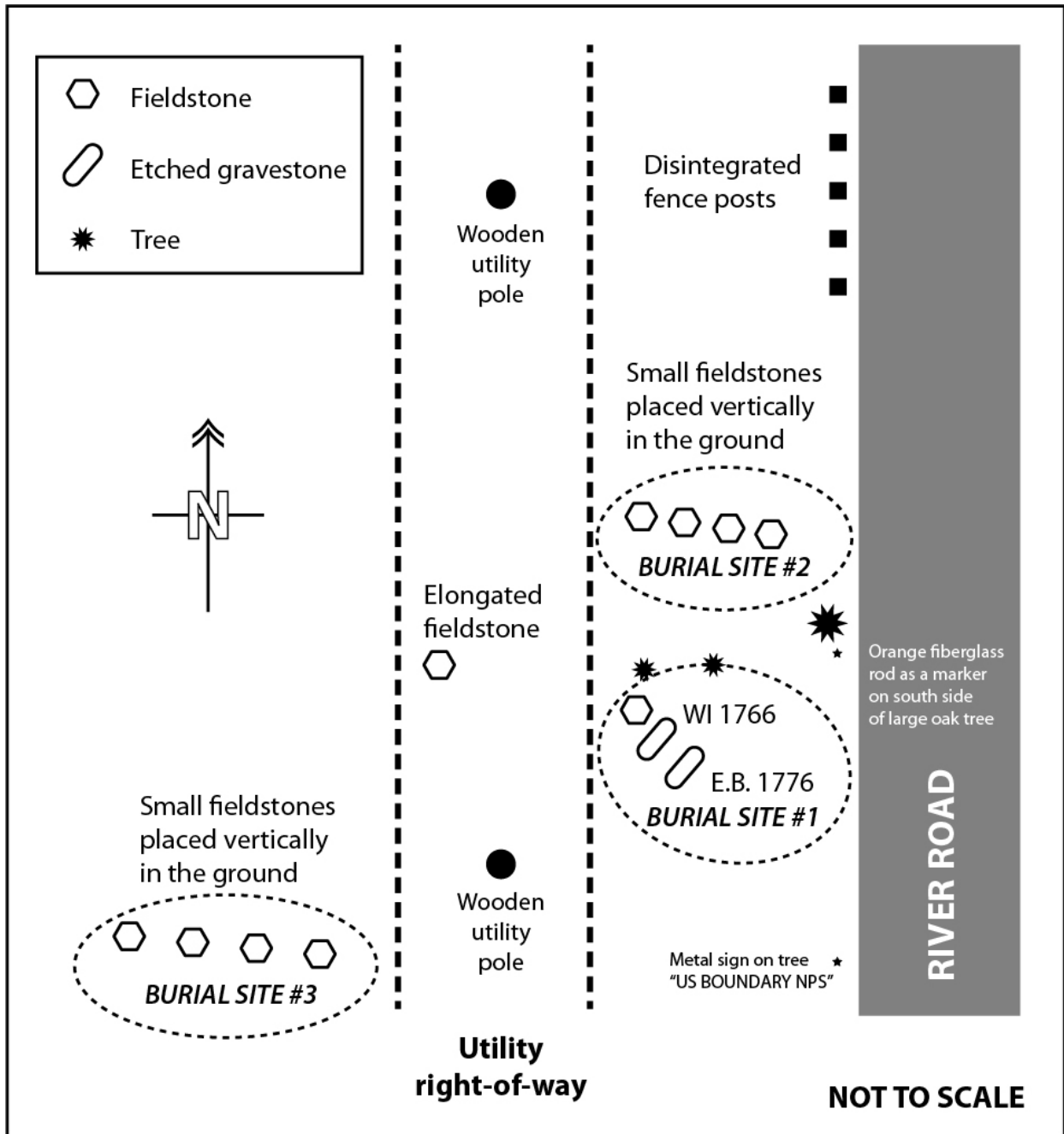

Cemetery Name: Hickman Family Cemetery		Inventory ID: 038
Photographer: Glenn Wallace		Date: 12/8/2018
Time	Photo No.	Description and direction you are facing
11:30 am	1	Panoramic at location from south to west to north
	2	Identifying markers at location
	3	Panoramic at burial site from west to north to east
	4	Burial site 1, facing north
	5	Burial site 1, facing west
	6	Burial site 1, Elizabeth (Hickman) Burns grave marker
	7	Burial site 1, William Hickman grave marker
	8	Long, unmarked boulder in right-of-way
	9	Burial site 2, facing south
	10	Burial site 2, facing west
	11	Burial site 3, facing east
	12	Burial site 3, facing west
11:50 am	13	Identifying orange rod along River Road



1. Panoramic at location from south to west to north



2. Identifying markers at location



3. Panoramic at burial site from west to north to east



4. Burial site 1, facing north



5. Burial site 1, facing west



6. Burial site 1, Elizabeth (Hickman) Burns grave marker



7. Burial site 1, William Hickman grave marker



8. Long, unmarked boulder in right-of-way



9. Burial site 2, facing south



10. Burial site 2, facing west



11. Burial site 3, facing east



12. Burial site 3, facing west



13. Identifying orange rod along River Road