



# MONTGOMERY COUNTY CEMETERY INVENTORY REVISITED

## BURIAL SITE INFORMATION

Name: <b>Hickman Family Cemetery</b>	Inventory ID: <b>038</b>
Alternate name: Edwards Ferry Cemetery	County ID: <b>M: 16-25</b>
Address:	
Website:	
GPS coordinates: Latitude:	Longitude:
FindaGrave: <a href="https://www.findagrave.com/cemetery/2528478">https://www.findagrave.com/cemetery/2528478</a>	

## BURIAL SITE TYPE

Category:  Religious  Community  **Family**  African American  Other:

## BURIAL SITE EVALUATION

Setting/location description: <input checked="" type="checkbox"/> <b>Rural</b> <input type="checkbox"/> Urban <input type="checkbox"/> Suburban <input checked="" type="checkbox"/> <b>Wooded</b> <input type="checkbox"/> Other:		
General condition (See conditions sheet): <input type="checkbox"/> Excellent <input type="checkbox"/> Good <input type="checkbox"/> Fair <input checked="" type="checkbox"/> <b>Poor</b> <input type="checkbox"/> None		
Is there a formal entrance? <input type="checkbox"/> Yes <input checked="" type="checkbox"/> <b>No</b>	Accessibility: <input type="checkbox"/> Inaccessible <input type="checkbox"/> By foot <input checked="" type="checkbox"/> <b>By car</b>	
Is cemetery active (recent burials)? <input type="checkbox"/> Yes <input checked="" type="checkbox"/> <b>No</b>	Is there a cemetery sign: <input type="checkbox"/> Yes <input checked="" type="checkbox"/> <b>No</b>	
Is cemetery being maintained? <input type="checkbox"/> Yes <input type="checkbox"/> Minimal <input checked="" type="checkbox"/> <b>No</b> (If yes, note caretaker's name below)		
Are there visible markers? <input checked="" type="checkbox"/> <b>Yes</b> <input type="checkbox"/> No	Approximate number of burials/visible markers: <b>12?</b>	Date ranges: <b>1760-1788</b>
Description: (markers, materials, arrangement, landscaping/vegetation, fence, paths and roads, etc.)		
<ul style="list-style-type: none"> <li>• <b>Scattered burial areas, roughly 100' x 50' located 30' west of River Road. (See map)</b></li> <li>• <b>Majority of markers are unmarked fieldstones in three separate areas.</b></li> <li>• <b>All trees mentioned in previous 2004 inventory report are now fallen.</b></li> </ul>		

## BURIAL SITE CONTACT

Name: <b>US Dept of the Interior</b>		
Relationship to burial site: <b>Owner</b>		Advocacy contact:
Address:		Phone:
City:	State:	ZIP Code:

## BURIAL SITE SURVEYOR

Name: <b>Glenn Wallace</b>	Survey Date: <b>12/8/2018</b>	Time spent: <b>20 min</b>
Email: <a href="mailto:mococems@gmail.com">mococems@gmail.com</a>	Photographer: <b>Glenn Wallace</b>	

## COMMENTS

Suggestions for follow-up:

- **Remove fallen trees and rake out overgrowth**
- **Maybe put up a cemetery sign, though this might bring vandals**

Safety issues, invasive vegetation removal, fence removal/restoration, signage, trash, erosion, vandalism:

Anything of significance about this cemetery?

- **Montgomery County's oldest cemetery**

## SOURCES

Cite sources used and resources available:

- <https://mht.maryland.gov/secure/medusa/PDF/Montgomery/M:%2016-25.pdf>

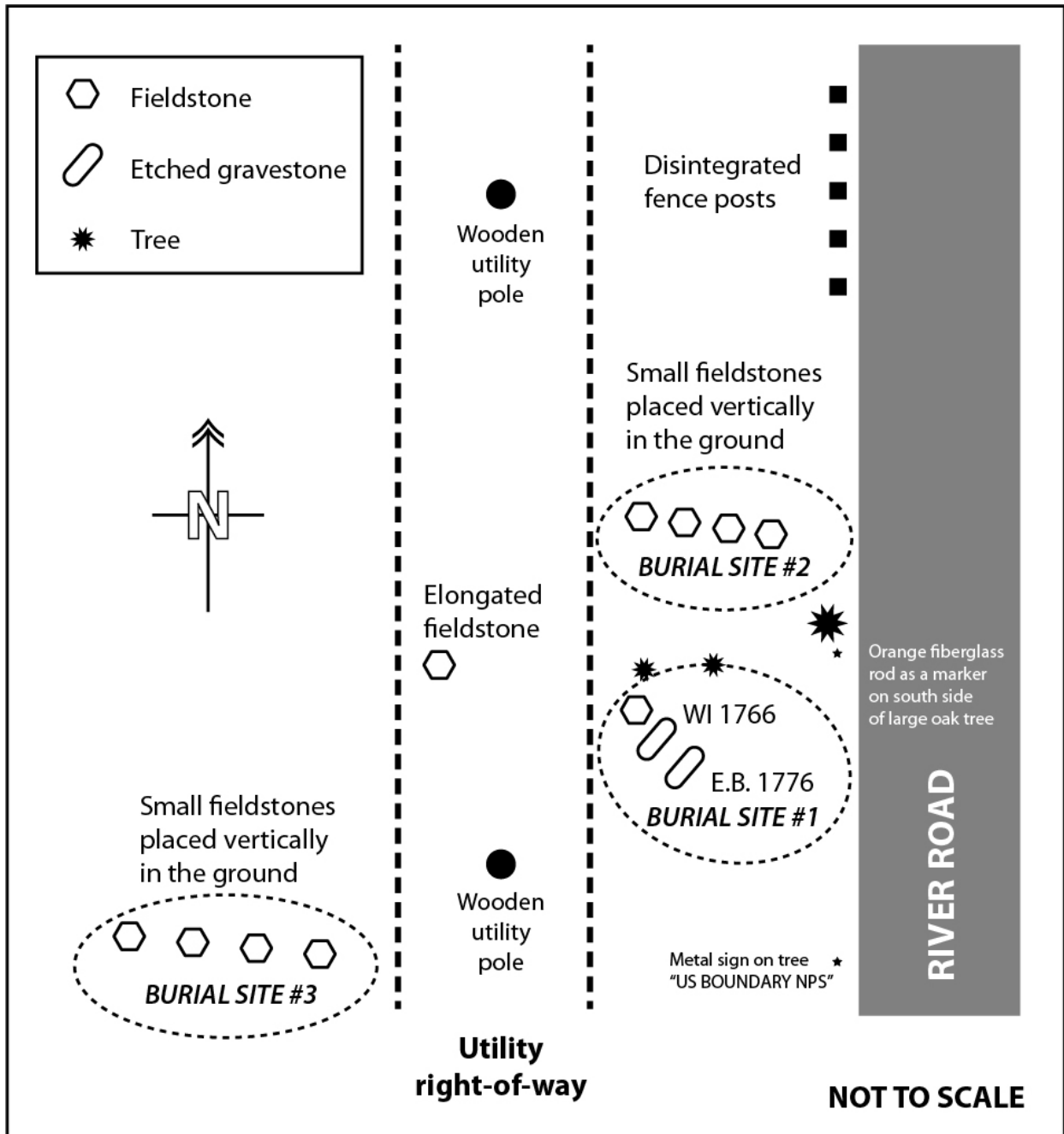

<b>Cemetery Name: Hickman Family Cemetery</b>		<b>Inventory ID: 038</b>
<b>Photographer: Glenn Wallace</b>		<b>Date: 12/8/2018</b>
<b>Time</b>	<b>Photo No.</b>	<b>Description and direction you are facing</b>
<b>11:30 am</b>	<b>1</b>	<b>Panoramic at location from south to west to north</b>
	<b>2</b>	<b>Identifying markers at location</b>
	<b>3</b>	<b>Panoramic at burial site from west to north to east</b>
	<b>4</b>	<b>Burial site 1, facing north</b>
	<b>5</b>	<b>Burial site 1, facing west</b>
	<b>6</b>	<b>Burial site 1, Elizabeth (Hickman) Burns grave marker</b>
	<b>7</b>	<b>Burial site 1, William Hickman grave marker</b>
	<b>8</b>	<b>Long, unmarked boulder in right-of-way</b>
	<b>9</b>	<b>Burial site 2, facing south</b>
	<b>10</b>	<b>Burial site 2, facing west</b>
	<b>11</b>	<b>Burial site 3, facing east</b>
	<b>12</b>	<b>Burial site 3, facing west</b>
<b>11:50 am</b>	<b>13</b>	<b>Identifying orange rod along River Road</b>



**1. Panoramic at location from south to west to north**





## 2. Identifying markers at location





**3. Panoramic at burial site from west to north to east**



**4. Burial site 1, facing north**





**5. Burial site 1, facing west**





**6. Burial site 1, Elizabeth (Hickman) Burns grave marker**



**7. Burial site 1, William Hickman grave marker**





**8. Long, unmarked boulder in right-of-way**





**9. Burial site 2, facing south**





**10. Burial site 2, facing west**





**11. Burial site 3, facing east**





**12. Burial site 3, facing west**





### 13. Identifying orange rod along River Road