

Property Address <u>1130 Harding Lane, Spencerville vicinity, Montgomery County</u>
Owner Name/Address <u>Stephen Lake, 1130 Harding Lane, Silver Spring, MD 20905</u>
Year Built <u>circa 1865</u>

Description:

The Joseph Harding House, constructed circa 1865, was previously surveyed by the Maryland-National Capital Parks and Planning Commission (M-NCPPC) in 1973, the Montgomery County Historic Preservation Commission in 1982 and again by the M-NCPPC in 1994. The property was recommended for designation as an historic site by the Montgomery County Historic Preservation Commission in the Master Plan for Historic Preservation. Since the prior survey, a skylight was added to the 1-story porch on the east side of the rear ell. Photographs attached to the Maryland Inventory of Historic Properties form show two stone outbuildings which are no longer extant. The form describes a stone dairy and a frame smokehouse. Only one outbuilding from an historic period remains on the property. A frame shed, located north of the house, has a front-gable roof with exposed rafter tails. Constructed circa 1930, the shed has an asphalt shingle roof and asbestos siding. Not mentioned in the prior survey form are two additional structures on the property. A stone and brick outdoor-grill/hearth is located north of the house and east of the shed. The last outbuilding is a wood-frame garage constructed in 1994. The garage, located east of the house, has two overhead garage doors on the front elevation. The side-gable roof is covered with asphalt shingles and the structure has two gable dormers which replicate the dormers on the main house. The garage has a concrete block foundation and vinyl exterior siding.

National Register Evaluation:

The Joseph Harding House, constructed circa 1865, was previously surveyed by the Maryland-National Capital Park and Planning Commission (M-NCPPC) and Montgomery County Historic Preservation Commission and is recommended for designation on the Master Plan for Historic Preservation by the Montgomery County Historic Preservation Commission. The property is eligible for the National Register of Historic Places under Criterion C, as a representative example of a residence which reflects the changing cultural and economic shift of Montgomery County from the nineteenth to the twentieth century. The house was constructed circa 1865 in a traditional I-house form and was later modified by rear additions in the early twentieth century and Colonial Revival features in 1934. The transition of the property from agricultural to suburban in function is evidence by stylistic changes made to replicate the popular Colonial Revival style of the early twentieth century and by the subdivision of its land. Character-defining features such as the 5-bay, I-house form, symmetrical fenestration pattern and central entryway consisting of a wood panel door and a rectangular transom with side-lights, possess excellent integrity. The Colonial Revival features include the pedimented porch with Tuscan-style columns and the two gable dormers on the front elevation. The period of significance for the property is from 1865 until 1934.

The property is not eligible under Criterion A, as research conducted indicates no association with any historic events or trends significant in the development of national, state or local history. Historic research indicates that the property has no association with persons who have made specific contributions to history, and therefore, it does not meet Criterion B. Finally, the property is not known to have any potential to yield important information, and therefore, is not eligible under Criterion D.

**MARYLAND HISTORICAL TRUST ADDENDUM SHEET
INTERCOUNTY CONNECTOR PROJECT**

Property Name: Joseph Harding House
Survey No.: M:28-27 (PACS D5.15)

Property Address <u>1130 Harding Lane, Spencerville vicinity, Montgomery County</u>
Owner Name/Address <u>Stephen Lake, 1130 Harding Lane, Silver Spring, MD 20905</u>
Year Built <u>circa 1865</u>

Verbal Boundary Description and Justification:

The National Register boundaries of the Joseph Harding House follow the current property lines of its tax parcel (Tax Map KS 122, Subdivision 1, Block A, Lot 12, Group 82). This .40 hectare (.99 acre) parcel is bounded on the north, west and east by adjacent parcels and on the south by Harding lane. The boundary includes the contributing main house and shed and the non-contributing hearth/grill and garage. According to deed research, the property was originally part of an 81 hectare (200 acre) parcel which was owned by the Harding family from 1844 until 1934. The property was reduced to its current size during the mid-twentieth century.

MHT CONCURRENCE:			
Eligibility <u>X</u>	Recommended <u> </u>	Not recommended	
Criteria <u> </u> A <u> </u> B <u>X</u> C <u> </u> D	Considerations <u> </u> A <u> </u> B <u> </u> C <u> </u> D <u> </u> E <u> </u> F <u> </u> G <u> </u> None		
Comments: _____			
E. Hannold/K. Williams		8/26/1998	
Reviewer, Office of Preservation Services		Date	Reviewer, NR program <u>B. Kuntze</u>
			Date <u>3/4/02</u>

Preparer:
P.A.C. Spero & Company
November 1996



Property Address 1130 Harding Lane, Spencerville vicinity, Montgomery County
Owner Name/Address Stephen Lake, 1130 Harding Lane, Silver Spring, MD 20905
Year Built circa 1865

Resource Sketch Map and National Register Boundary Map:

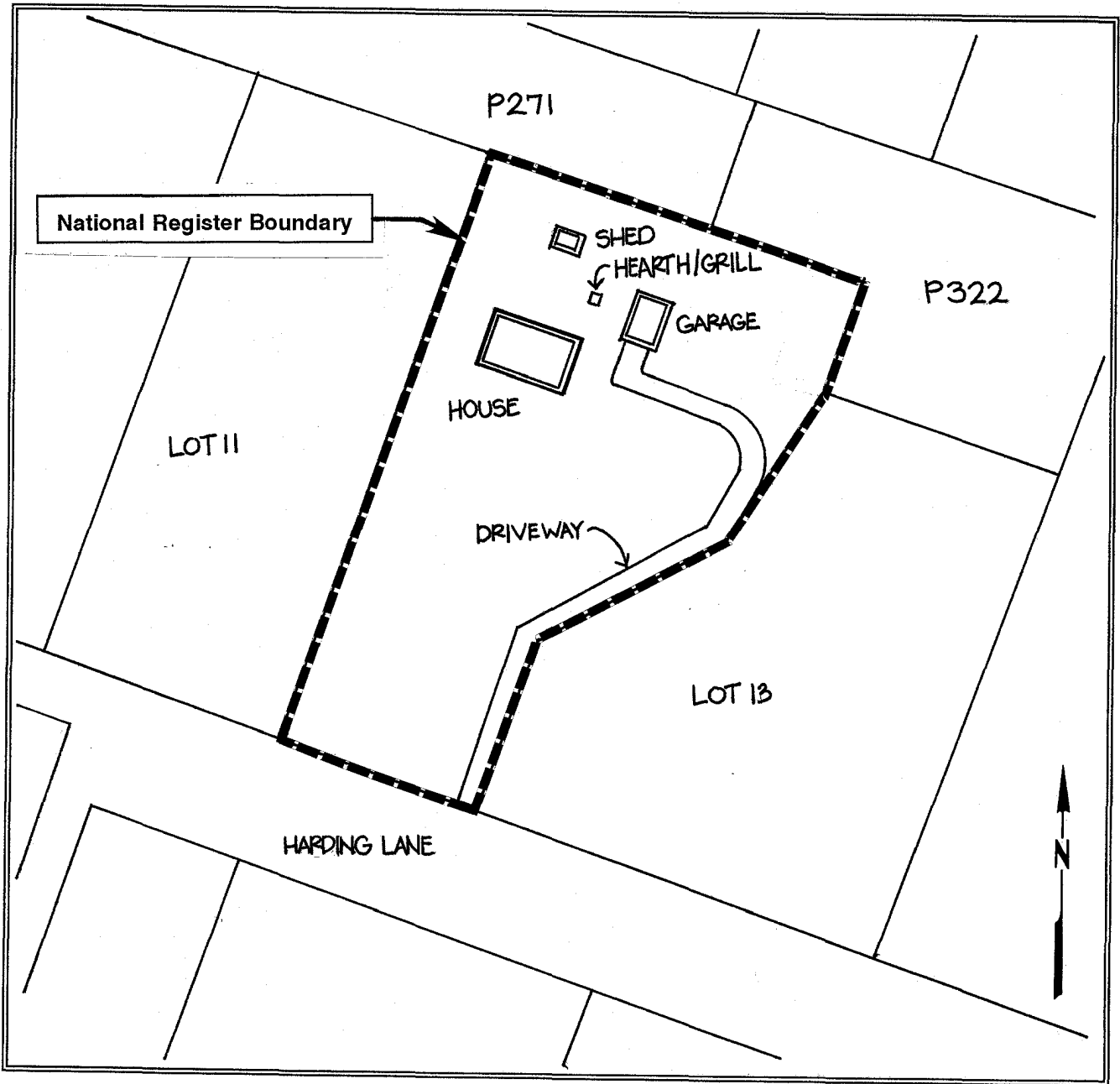

Intercounty Connector Project
Northern and Midcounty Highway
MD198 Alternatives
Quad BELTSVILLE, MD
Survey No. M: 28-27, PACS D5.15

JOSEPH HARDING HOUSE

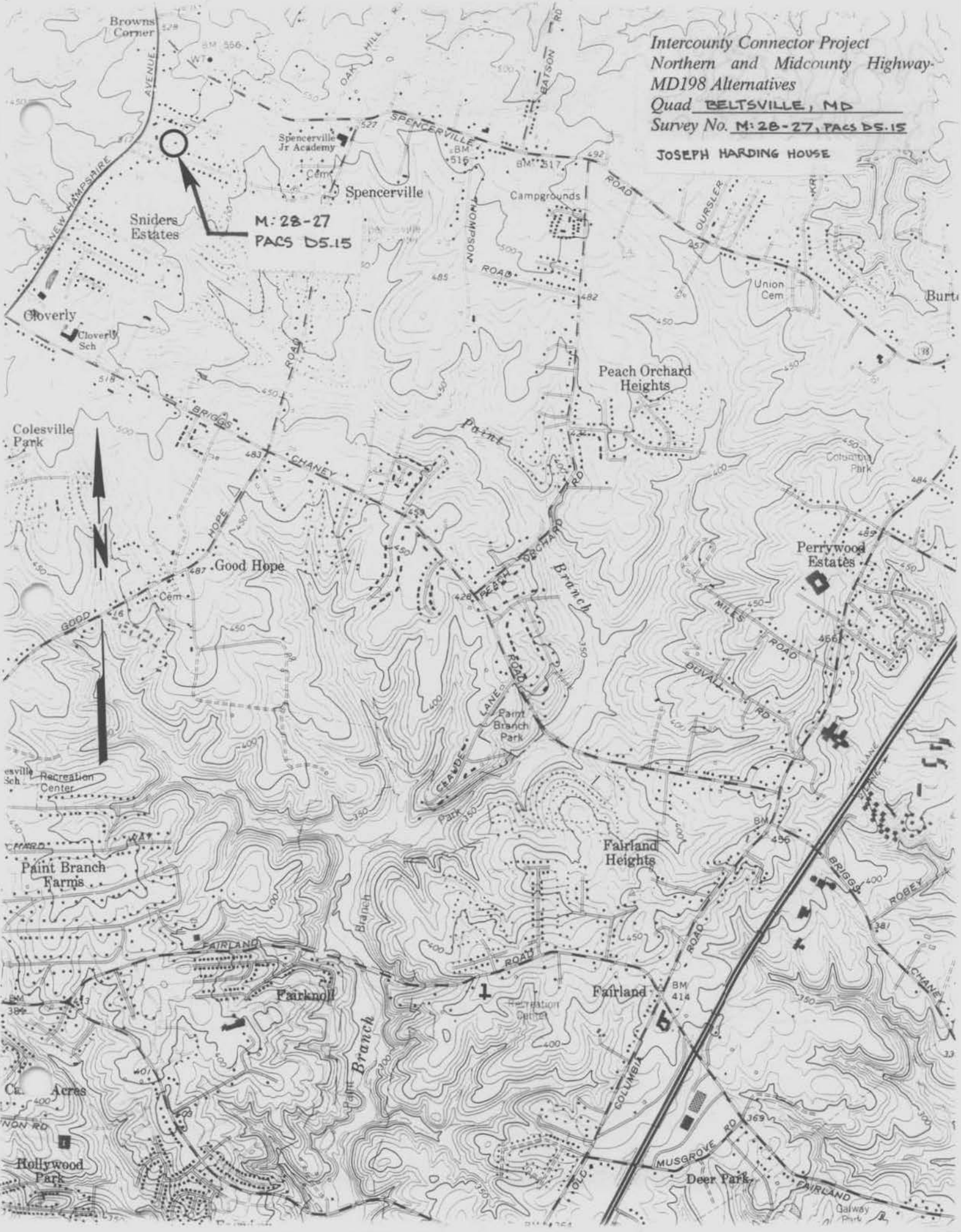

M: 28-27
PACS D5.15

M: 28-27
PACS D5.15



1. 11th & 8th Sts
2. Joseph Harding House
3. Jim Lamburns, Diplo
4. P.A.C. Speed Company
40 W Chesapeake Ave
Baltimore MD 21204
5. 1130 Harding Lane, southeast
corner
6. 1 of 8



1128-201

2. Joseph Harding Lane

3. Tom Janbiovics, 10/92

4. P.P.D. Spencer Company
45 W. Chesapeake Ave
Baltimore, MD 21202

5. 1130th Harding Lane,
-port elevation

6. 2 of 8



1. N128 217
2. Joseph Harding House
3. Jim Samburano, 10/12/2
4. P.A.C. Spew - Company
40 W. Chesapeake Ave
Baltimore, MD 21201
5. 1130 Harding Lane, East Clinton
6. 3 7 8



1. M328-21

2. Joseph Harday House

3. Jim Tamburino, MA

4. R.A.C. Sporo-Company
40 W Chesapeake Ave
Baltimore, MD 21201

5. M30 Harding Lane, garage

6. 4-7-8



1. 11128-20
2. Joseph Harding House
3. Jim Lamburns, 10'90
4. P.H. C. Spens & Company
40 W. Chesapeake Ave
Baltimore MD 21204
5. 1130 Harding Lane, Phil
6. 5 of 8



1128-20

2. Group: Harding, 1912

3. Jim Lamberton, 1912

4. L. E. Sperry + Company

1100 Chesapeake Ave
Baltimore, 1110-1111

5. 1130 Harding Lane, near Clouston

1 6 of 8



1. 11-28-20

2. Joseph Harding House

3. Sam Tamburro, 1019

4. R.A.C. Sporo + Company
40 W. Chesapeake Ave
Baltimore, MD 21204

5. 1130 Harding Lane, northeast
corner

6 7 7 8



1. 117 25 25

2. Joseph Harding House

3. Jim Lamberson, 10/96

11. P.A.C. Special Company
40 W. Chesapeake Ave
Baltimore, MD 21204

3. 135 S. Maryland Ave, front
elevation

6. 8 0 2 8

CAPSULE SUMMARY

FOR

JOSEPH HARDING HOUSE

1130 HARDING LANE, SPENCERVILLE

Montgomery County Survey Prefix & Site Number: M-28/27

Approximate Building Date: circa 1865, 1908, altered 1934

Town or Vicinity in which Resource is Located: Spencerville

Access: Private

The Joseph Harding House is a remodeled two story frame I-house located on an approximately two-acre site off Harding Lane. The house is a traditional side-gabled center hall I-house. The building has an L-plan with a main rectangular core built about 1865 and rear ell addition constructed about 1908. The house was remodeled in the Colonial Revival style in 1934 and infill additions were built in the L. The present remodeled building has local architectural significance as a distinctive example of the cultural adaptation of traditional domestic architecture in Montgomery county to the more fashionable Colonial Revival styles in the early decades of the twentieth century.

Maryland Historical Trust State Historic Sites Inventory Form

MARYLAND INVENTORY OF
HISTORIC PROPERTIES

Survey No. M.28-27

Magi No.

DOE yes no

1. Name (indicate preferred name)

historic Joseph Harding House

and/or common

2. Location

street & number 1130 Harding Lane not for publication

city, town Silver Spring vicinity of congressional district 8

state MD county Montgomery

3. Classification

Category	Ownership	Status	Present Use	
<input type="checkbox"/> district	<input type="checkbox"/> public	<input checked="" type="checkbox"/> occupied	<input type="checkbox"/> agriculture	<input type="checkbox"/> museum
<input checked="" type="checkbox"/> building(s)	<input checked="" type="checkbox"/> private	<input type="checkbox"/> unoccupied	<input type="checkbox"/> commercial	<input type="checkbox"/> park
<input type="checkbox"/> structure	<input type="checkbox"/> both	<input type="checkbox"/> work in progress	<input type="checkbox"/> educational	<input checked="" type="checkbox"/> private residence
<input type="checkbox"/> site	Public Acquisition	Accessible	<input type="checkbox"/> entertainment	<input type="checkbox"/> religious
<input type="checkbox"/> object	<input type="checkbox"/> in process	<input checked="" type="checkbox"/> yes: restricted	<input type="checkbox"/> government	<input type="checkbox"/> scientific
	<input type="checkbox"/> being considered	<input type="checkbox"/> yes: unrestricted	<input type="checkbox"/> industrial	<input type="checkbox"/> transportation
	<input checked="" type="checkbox"/> not applicable	<input type="checkbox"/> no	<input type="checkbox"/> military	<input type="checkbox"/> other:

4. Owner of Property (give names and mailing addresses of all owners)

name Allen L. Sowers

street & number 1130 Harding Lane telephone no.:

city, town Silver Spring state and zip code MD 20904

5. Location of Legal Description

courthouse, registry of deeds, etc. Montgomery County Courthouse liber 8898

street & number 51 Monroe Street folio 610

city, town Rockville state MD

6. Representation in Existing Historical Surveys

title Montgomery County Locational Atlas of Historic Sites

date 1976 federal state county local

pository for survey records M-NCPPC

city, town Silver Spring state MD

7. Description

Survey No. M: 28-27

Condition		Check one	Check one	
<input checked="" type="checkbox"/> excellent	<input type="checkbox"/> deteriorated	<input checked="" type="checkbox"/> unaltered	<input checked="" type="checkbox"/> original site	
<input type="checkbox"/> good	<input type="checkbox"/> ruins	<input checked="" type="checkbox"/> altered	<input type="checkbox"/> moved	date of move _____
<input type="checkbox"/> fair	<input type="checkbox"/> unexposed			

Prepare both a summary paragraph and a general description of the resource and its various elements as it exists today.

The Joseph Harding House is a remodeled two story frame I-house located on an approximately two-acre site off Harding Lane. The house is a traditional side-gabled center hall I-house with clapboard walls (now sided with vinyl) and moderate pitched roof and covered by composition shingle. The building has an L-plan with a main rectangular core built about 1865 and rear ell addition constructed about 1908. The house was remodeled in the Colonial Revival style in 1934 and infill additions were built in the L.

The principle elevation of the house faces south toward Harding Lane and has a symmetrical five-bay facade with primly symmetrical ranks of six-over-six windows with louvered shutters. The central entry has a transom and sidelights and is accentuated by a pedimented frame porch supported by Tuscan columns. Two prominent gabled dormers were also added at this time to light the attic story and complete the 1934 Colonial Revival style makeover.

The elevation of the rear facade facing north has few window openings. This facade of the ell addition has only two three-over-six sash windows lighting the second story. A two-part infill addition was built in 1934 into the L-plan of the house. The first section is two-stories in height and has a simple door leading out onto a balustraded veranda. The second part is a one story kitchen wing with a small bay window decorated with louvered shutters. The gable end facade of the I-house core facing east has a large irregularly coursed exterior stone chimney with a stone and brick stack. There are two four-over-four sash windows flanking the chimney stack at the gable end lighting the attic level. Two six-over-six windows have been built on the first and second stories lighting the rear half of this main I-house section. The same overall design and window pattern is repeated on the facade facing west with the exception that the chimney is internal.

The two story shed roof addition that forms part of the L infill has a six-over-six window on the second story of the east elevation. The west elevation of the flat roofed one-story kitchen addition has paired six-over-six windows and a simple entry with a wooden stoop. A shed-roofed porch supported by simple square posts decorated with lattice work covers this entry and runs the length of east side of the L infill.

8. Significance

Survey No.

M: 28-27

Period	Areas of Significance—Check and justify below			
<input type="checkbox"/> prehistoric	<input type="checkbox"/> archeology-prehistoric	<input type="checkbox"/> community planning	<input type="checkbox"/> landscape architecture	<input type="checkbox"/> religion
<input type="checkbox"/> 1400-1499	<input type="checkbox"/> archeology-historic	<input type="checkbox"/> conservation	<input type="checkbox"/> law	<input type="checkbox"/> science
<input type="checkbox"/> 1500-1599	<input type="checkbox"/> agriculture	<input type="checkbox"/> economics	<input type="checkbox"/> literature	<input type="checkbox"/> sculpture
<input type="checkbox"/> 1600-1699	<input checked="" type="checkbox"/> architecture	<input type="checkbox"/> education	<input type="checkbox"/> military	<input type="checkbox"/> social/
<input type="checkbox"/> 1700-1799	<input type="checkbox"/> art	<input type="checkbox"/> engineering	<input type="checkbox"/> music	<input type="checkbox"/> humanitarian
<input checked="" type="checkbox"/> 1800-1899	<input type="checkbox"/> commerce	<input type="checkbox"/> exploration/settlement	<input type="checkbox"/> philosophy	<input type="checkbox"/> theater
<input checked="" type="checkbox"/> 1900-	<input type="checkbox"/> communications	<input type="checkbox"/> industry	<input type="checkbox"/> politics/government	<input type="checkbox"/> transportation
		<input type="checkbox"/> invention		<input type="checkbox"/> other (specify)

Specific dates ca. 1865, 1908, ~~Builder~~ **Architect** Unknown

check: Applicable Criteria: 1934 A B C D
and/or
Applicable Exception: A B C D E F G

Level of Significance: national state local

Prepare both a summary paragraph of significance and a general statement of history and support.

Summary: The Joseph Harding house was originally a central hall frame I-house built around 1865 and remodeled as a Colonial Revival residence in 1934. The present remodeled building has local architectural significance as a distinctive example of the cultural adaptation of traditional domestic architecture in Montgomery county to the more fashionable Colonial Revival styles in the early decades of the twentieth century.

Although the I-house was a principal domestic building in Montgomery County during the nineteenth century, few of these houses have survived in the eastern section of the county without extensive recent alteration. Two other distinctive examples of the transitional domestic architecture of this period are Drayton (Atlas #15-51) and the Brunett House (Atlas #32-6), which were grander in intention and execution.

The Harding house has undergone only one major stylistic update (1934) and clearly reflects the period's architectural transition frequently expressed by the remodeling of the I-house of the independent farmer into an eclectic Colonial Revival style residence suitable to modern suburban living. The house blends traditional form and popular style and documents the impact of urbanization on the community's architectural taste during the early decades of the twentieth century.¹

Joseph Harding was typical of the smaller, independent farmers of Montgomery County who with their families labored in the fields and prospered on the land. Harding was locally known as the "potato king" for his abundant production and lucrative sale of this crop. Prominent in the community, he served as a toll-gate keeper for the Ashton-Colesville turnpike and was a founding member of the first Methodist Church located near Cloverly on New Hampshire Avenue.² Like many of his neighbors, Harding erected his I-house to reflect his economic success and position in society as a relatively well-to-do man.

(Continued)

Continuation Sheet
M: 28-27 - Joseph Harding House
Section 8: SIGNIFICANCE
Page 8.1

In 1934 the house was remodeled by its now suburban residents as a Colonial Revival house overlaying new architectural meanings related to the changing nature of the economy and the county's social life in the early twentieth century on this traditional house form. The Harding house has the form, proportion, overall structure and plan of the I-house house type and the stylistic decoration of the Colonial Revival style. The house retains a high degree of integrity as an amalgam of two distinct periods in the county's architecture and embodies a significant phase in the development of the community's material cultural heritage.

9. Major Bibliographical References

Survey No. M. 28-27

See Attached Sheet

10. Geographical Data

Acreage of nominated property 2

Quadrangle name _____

Quadrangle scale _____

UTM References do NOT complete UTM references

A

--	--	--	--	--	--	--	--	--	--

--	--	--	--	--	--	--	--	--	--

Zone Easting Northing

B

--	--	--	--	--	--	--	--	--	--

--	--	--	--	--	--	--	--	--	--

Zone Easting Northing

C

--	--	--	--	--	--	--	--	--	--

--	--	--	--	--	--	--	--	--	--

D

--	--	--	--	--	--	--	--	--	--

--	--	--	--	--	--	--	--	--	--

E

--	--	--	--	--	--	--	--	--	--

--	--	--	--	--	--	--	--	--	--

F

--	--	--	--	--	--	--	--	--	--

--	--	--	--	--	--	--	--	--	--

G

--	--	--	--	--	--	--	--	--	--

--	--	--	--	--	--	--	--	--	--

H

--	--	--	--	--	--	--	--	--	--

--	--	--	--	--	--	--	--	--	--

Verbal boundary description and justification

List all states and counties for properties overlapping state or county boundaries

state	code	county	code

state	code	county	code

11. Form Prepared By

name/title William Bushong

organization M-NCPPC date June 1994

street & number 8787 Georgia Avenue telephone (301) 495-4570

city or town Silver Spring state MD

The Maryland Historic Sites Inventory was officially created by an Act of the Maryland Legislature to be found in the Annotated Code of Maryland, Article 41, Section 181 KA, 1974 supplement.

The survey and inventory are being prepared for information and record purposes only and do not constitute any infringement of individual property rights.

return to: Maryland Historical Trust
Shaw House
21 State Circle
Annapolis, Maryland 21401
(301) 269-2438

MARYLAND HISTORICAL TRUST
DHCP/DHCD
100 COMMUNITY PLACE
CROWNSVILLE, MD 21032-2023
514-7600

Continuation Sheet
M: 28-27 - Joseph Harding House

Preservation Planning Data:

- a) Geographic Organization: Piedmont
- b) Chronological/Development Periods: Agricultural-Industrial Transition - A. D. 1815-1870, Industrial/Urban Dominance, 1870-1930
- c) Historic Period Themes: Architecture, Agriculture
- d) Resource Type: Farmhouse

Chain of Title/Owner Information:

Joseph and Elizabeth Harding purchased 80 acres of "Snowden's Manor Enlarged" from Basil Brooke in 1844. Harding also acquired additional acreage adjacent to this land between 1849 and 1882 to establish a farm of approximately 200 acres. In 1846 the Hardings built a log house on the property (no longer extant) that was located to the south of modern-day Harding Lane. Around 1865 Harding built the main I-house section. Joseph Harding died in 1894 leaving all his property to his second wife Josephine Harding. At her death in 1915 the farm was subdivided among the heirs.

Ernest Harding would jointly inherit the house and immediate acreage with his sister Pearle Harding Turner and in 1923 he bought out his sister's interest in the property. In 1934 Clarence and Bertha Bernard would purchase the house from Ernest and Ella Harding and soon thereafter installed new heating and water systems and remodeled the building's exterior as a Colonial Revival house. In 1950 the Bernards sold the house to Carter and Dorothy Ayres, but repurchased the property almost immediately. With Clarence Bernard's death in 1960, his widow Bertha sold the house again to Homer and Eleanor Weston. The Westons sold the house to Ben and Norma Irvin in 1976 who conveyed the house and surrounding two acres to Allen Sowers.

Cited Land and Estate Records from Crawford, MHT Form (10/82).

Deed	STS 1/108	Montgomery County Land Records
Deed	STS 5/87	Montgomery County Land Records
Deed	JGH 6/91	Montgomery County Land Records
Deed	EBP 10/435	Montgomery County Land Records
Deed	EBP 27/245	Montgomery County Land Records
Will	GCD 2/177	Montgomery County Register of Wills
Equity	#3148	Montgomery County Central Files

Continuation Sheet
M: 28-27 - Joseph Harding House

Deed 572/433	Montgomery County Land Records
Deed 1342/275	Montgomery County Land Records
Deed 2655/422	Montgomery County Land Records
Deed 2796/335	Montgomery County Land Records
Deed 4817/769	Montgomery County Land Records

Endnotes

1 For a discussion of historical and architectural trends in the period of 1920-1940 in Montgomery County, see Andrea Rebeck, "Montgomery County in the Early Twentieth Century." Unpublished report, Maryland Historical Trust and the Montgomery County Historic Preservation Commission, 1987. The shift in the county's economic base is discussed in Richard K. MacMaster and Ray E. Heibert, A Grateful Remembrance: The Story of Montgomery County, Maryland. (Rockville, MD: Montgomery County Government and Montgomery County Historical Society, 1976), 302-303.

2 Arlene Turner, "The Harding Family History." Montgomery County Historical Society, 1974.

Continuation Sheet
M: 28-27 - Joseph Harding House
Section 9: MAJOR BIBLIOGRAPHICAL REFERENCES
Page 9.1

Unpublished Sources

Crawford, Catherine. Maryland Historical Trust Form for the Joseph Harding House, 1982. (MHT)

Deeds, Land Records Office. (Montgomery County Courthouse)

Equity Records (Montgomery County Courthouse)

Rebeck, Andrea. "Montgomery County in the Early Twentieth Century." Unpublished report, Maryland Historical Trust and the Montgomery County Historic Preservation Commission, 1987.

Turner, Arlene. "The Harding Family History." Montgomery County Historical Society, 1974.

Robinson & Associates. Locational Atlas Historical Survey of 400 Resources, Survey Form, Summer 1989.

Wills. (Montgomery County Courthouse)

Published Sources

Hiebert, Ray Eldon and Richard K. MacMaster. **A Grateful Remembrance: the Story of Montgomery County, Maryland.** Rockville, Maryland: Montgomery County Government and the Montgomery County Historical Society, 1976.

Hopkins, G.M. **Atlas of Fifteen Miles Around Washington Including the County of Montgomery Maryland.** Philadelphia: G.M. Hopkins, 1879. (Library of Congress; Rockville Public Library)

Martenet, Simon J. **Martenet and Bond's Map of Montgomery County.** Baltimore: Simon J. Martenet, 1865. (Library of Congress)

Maryland Historical Trust

State Historic Sites Inventory Form

1. Name (indicate preferred name)

historic Harding House

and/or common

2. Location

street & number 1130 Harding Lane not for publication

city, town Silver Spring vicinity of congressional district 5th

state Maryland county Montgomery

3. Classification

Category	Ownership	Status	Present Use
<input type="checkbox"/> district	<input type="checkbox"/> public	<input checked="" type="checkbox"/> occupied	<input type="checkbox"/> agriculture <input type="checkbox"/> museum
<input checked="" type="checkbox"/> building(s)	<input checked="" type="checkbox"/> private	<input type="checkbox"/> unoccupied	<input type="checkbox"/> commercial <input type="checkbox"/> park
<input type="checkbox"/> structure	<input type="checkbox"/> both	<input type="checkbox"/> work in progress	<input type="checkbox"/> educational <input checked="" type="checkbox"/> private residence
<input type="checkbox"/> site	Public Acquisition	Accessible	<input type="checkbox"/> entertainment <input type="checkbox"/> religious
<input type="checkbox"/> object	<input type="checkbox"/> in process	<input type="checkbox"/> yes: restricted	<input type="checkbox"/> government <input type="checkbox"/> scientific
	<input type="checkbox"/> being considered	<input type="checkbox"/> yes: unrestricted	<input type="checkbox"/> industrial <input type="checkbox"/> transportation
	<input type="checkbox"/> not applicable	<input checked="" type="checkbox"/> no	<input type="checkbox"/> military <input type="checkbox"/> other:

4. Owner of Property (give names and mailing addresses of all owners)

name Ben Leroy & Norma Elaine Elaine Irvin

street & number 1130 Harding Lane telephone no.:

city, town Silver Spring state and zip code Maryland, 20904

5. Location of Legal Description

courthouse, registry of deeds, etc. Montgomery County Court House liber 4817

street & number Rockville folio 769

city, town Rockville state Maryland

6. Representation in Existing Historical Surveys

title MNCPPC Historic Sites Inventory

date 1976 federal state county local

depository for survey records Park Historian's Office

city, town Rockville state Maryland

7. DESCRIPTION	
CONDITION	<input type="checkbox"/> Excellent <input checked="" type="checkbox"/> Good <input type="checkbox"/> Fair <input type="checkbox"/> Deteriorated <input type="checkbox"/> Ruins <input type="checkbox"/> Unexposed <small>(Check One)</small>
	<input checked="" type="checkbox"/> Altered <input type="checkbox"/> Unaltered <input type="checkbox"/> Moved <input checked="" type="checkbox"/> Original Site <small>(Check One)</small>

DESCRIBE THE PRESENT AND ORIGINAL (if known) PHYSICAL APPEARANCE

The house is a 2-1/2 story, frame house, five bays wide, with one external and one internal end chimney. There are also two outbuildings, one stone and one frame; the stone building was a dairy, and the frame one was a smoke house. The house has been much altered; photographs in the possession of the owner show the house with a three bay porch with decorative columns and an el to the northwest corner. The facade is new. The present rear el is the oldest part of the house with hand-hewn beams, the foundation for the porch on the west side, and a stone foundation.

SEE INSTRUCTIONS

Significance

Survey No. M28-27

Period	Areas of Significance—Check and justify below					
prehistoric	<input type="checkbox"/> archeology-prehistoric	<input type="checkbox"/> community planning	<input type="checkbox"/> landscape architecture	<input type="checkbox"/> religion		
1400-1499	<input type="checkbox"/> archeology-historic	<input type="checkbox"/> conservation	<input type="checkbox"/> law	<input type="checkbox"/> science		
1500-1599	<input type="checkbox"/> agriculture	<input type="checkbox"/> economics	<input type="checkbox"/> literature	<input type="checkbox"/> sculpture		
1600-1699	<input checked="" type="checkbox"/> architecture	<input type="checkbox"/> education	<input type="checkbox"/> military	<input type="checkbox"/> social/		
1700-1799	<input type="checkbox"/> art	<input type="checkbox"/> engineering	<input type="checkbox"/> music	<input type="checkbox"/> humanitarian		
1800-1899	<input type="checkbox"/> commerce	<input type="checkbox"/> exploration/settlement	<input type="checkbox"/> philosophy	<input type="checkbox"/> theater		
1900-	<input type="checkbox"/> communications	<input type="checkbox"/> industry	<input type="checkbox"/> politics/government	<input type="checkbox"/> transportation		
		<input type="checkbox"/> invention		<input type="checkbox"/> other (specify)		

Specific dates _____ **Builder/Architect** _____

Check: Applicable Criteria: A B C D
and/or

Applicable Exception: A B C D E F G

Level of Significance: national state local

are both a summary paragraph of significance and a general statement of history and port.

The Harding Farmhouse is significant as an example of a mid nineteenth century vernacular dwelling which, due to mid twentieth century alterations, now has a Colonial Revival appearance. The original front porch (three bays long) has been replaced with a porticoed entry porch. This is one of a number of dwellings in Montgomery County which has undergone "revivalizing" during the mid twentieth century. This, however, is one of the more successful attempts. Joseph Harding and his wife, Elizabeth purchased 80 acres of "Snowden's Manor Enlarged" here from Basil Brooke in 1844.¹ Through various deed made between 1849 and 1882, Joseph added more acreage to his property, bring the total up to approximately 200 acres.² In 1846, the Hardings built their first house, a log house which was located on the right side of Harding Lane.³ It was here that Joseph's first five children were born. Then, with the death of his wife and small son in 1853, Joseph set out the family cemetary in the field behind the house.⁴

In about 1865 Joseph built a three story frame dwelling with porches along the south, east and west sides of the house. The house had a large basement, a large stone fireplace in the kitchen for cooking and a milk house east of the main house. Joseph, a successful farmer, was known as the "Potato King" of Montgomery County. He also was the toll-gate keeper for his stretch of the Ashton-Colesville Turnpike. Joseph is also known for being the founder of the first Methodist Church (located on New Hampshire Ave. near Cloverly).⁵

In 1894, Joseph died leaving all his property, both real and personal, to his second wife, Josephine G. Harding.⁶ Then, in May of 1915 Josephine died. There were too many heirs to Partition the property in a manner that would be advantageous to all, so the estate was divided into three parts and sold to three different heirs.⁷ Two of the children, Ernest and Pearle, both married, shared the house until 1923 when Pearle and her husband, Archie Turner sold out to Earnest Harding.⁸

In 1934, Ernest and his wife, Ella sold the house to Clarence and Bertha Bernhard.⁹ The Bernhards remodeled the house, tearing

See Attachment Sheet A

Attachment Sheet A

off the porches built by Joseph Harding and installing central heat and running water.¹⁰ In 1950, the Bernhards sold the house to Carter and Dorothy Ayres but bought it back in 1959.¹¹ Bertha, now a widow, sold the house again in 1960 to Homer and Elenor Weston.¹² In 1976, the personal representatives of the estate of Homer Weston sold the house to the present owners, Ben Leroy Irvin and his wife, Norma Elaine Irvin.¹³

The rear addition to the house was probably built sometime between 1902 and 1910 by the Harding Family.¹⁴

¹Deed STS 1/108, Montgomery County Land Records.

²Deed STS 5/87, " " " " & JGH 6/91, EBP 10/435 & EBP 27/245.

³Arlene Turner, The Harding Family History, 1974. Montgomery County Historical Society Library.

⁴Ibid.

⁵Ibid.

⁶Will GCD 2/177, Montgomery County Register of Wills.

⁷Equity #3148, Montgomery County Central Files

⁸Arlene Turner.

⁹Deed 572/433, Montgomery County Land Records.

¹⁰Arlene Turner.

¹¹Deed 1342/275 & 2655/422, Montgomery County Land Records.

¹²Deed 2796/335, " "

¹³Deed 4817/769, " "

¹⁴Montgomery County Commissioners Tax Assesment Books, 1897-1910. The addition also appears on the 1915 plat map of the property.

MARYLAND HISTORICAL TRUST WORKSHEET

NOMINATION FORM
for the
NATIONAL REGISTER OF HISTORIC PLACES, NATIONAL PARKS SERVICE

SEE INSTRUCTIONS

1. NAME				
COMMON:				
AND/OR HISTORIC: Harding House				
2. LOCATION				
STREET AND NUMBER: 1130 Harding Lane				
CITY OR TOWN: Silver Spring				
STATE: Maryland		COUNTY: Montgomery		
3. CLASSIFICATION				
CATEGORY (Check One)		OWNERSHIP		STATUS
<input type="checkbox"/> District <input type="checkbox"/> Site <input type="checkbox"/> Object		<input checked="" type="checkbox"/> Building <input type="checkbox"/> Structure <input type="checkbox"/> Both		<input checked="" type="checkbox"/> Occupied <input type="checkbox"/> Unoccupied <input type="checkbox"/> Preservation work in progress
		<input type="checkbox"/> Public <input checked="" type="checkbox"/> Private <input type="checkbox"/> Both		Yes: <input type="checkbox"/> Restricted <input type="checkbox"/> Unrestricted <input checked="" type="checkbox"/> No
PRESENT USE (Check One or More as Appropriate)				
<input type="checkbox"/> Agricultural <input type="checkbox"/> Commercial <input type="checkbox"/> Educational <input type="checkbox"/> Entertainment		<input type="checkbox"/> Government <input type="checkbox"/> Industrial <input type="checkbox"/> Military <input type="checkbox"/> Museum		<input type="checkbox"/> Park <input checked="" type="checkbox"/> Private Residence <input type="checkbox"/> Religious <input type="checkbox"/> Scientific
		<input type="checkbox"/> Transportation <input type="checkbox"/> Other (Specify)		<input type="checkbox"/> Comments
4. OWNER OF PROPERTY				
OWNER'S NAME: H. F. Weston				
STREET AND NUMBER: 1130 Harding Lane				
CITY OR TOWN: Silver Spring			STATE: Maryland	
5. LOCATION OF LEGAL DESCRIPTION				
COURTHOUSE, REGISTRY OF DEEDS, ETC: Montgomery County Courthouse				
STREET AND NUMBER:				
CITY OR TOWN: Rockville			STATE: Maryland	
Title Reference of Current Deed (Book & Pg. #):				
6. REPRESENTATION IN EXISTING SURVEYS				
TITLE OF SURVEY: None				
DATE OF SURVEY: <input type="checkbox"/> Federal <input type="checkbox"/> State <input type="checkbox"/> County <input type="checkbox"/> Local				
DEPOSITORY FOR SURVEY RECORDS:				
STREET AND NUMBER:				
CITY OR TOWN:			STATE:	

M:28-27

7. DESCRIPTION

CONDITION	(Check One)					
	<input type="checkbox"/> Excellent	<input checked="" type="checkbox"/> Good	<input type="checkbox"/> Fair	<input type="checkbox"/> Deteriorated	<input type="checkbox"/> Ruins	<input type="checkbox"/> Unexposed
	(Check One)			(Check One)		
	<input checked="" type="checkbox"/> Altered	<input type="checkbox"/> Unaltered		<input type="checkbox"/> Moved	<input checked="" type="checkbox"/> Original Site	

DESCRIBE THE PRESENT AND ORIGINAL (if known) PHYSICAL APPEARANCE

The house is a 2-1/2 story, frame house, five bays wide, with one external and one internal end chimney. There are also two outbuildings, one stone and one frame; the stone building was a dairy, and the frame one was a smoke house. The house has been much altered; photographs in the possession of the owner show the house with a three bay porch with decorative columns and an el to the northwest corner. The facade is new. The present rear el is the oldest part of the house with hand-hewn beams, the foundation for the porch on the west side, and a stone foundation.

SEE INSTRUCTIONS

8. SIGNIFICANCE

PERIOD (Check One or More as Appropriate)

<input type="checkbox"/> Pre-Columbian	<input type="checkbox"/> 16th Century	<input type="checkbox"/> 18th Century	<input type="checkbox"/> 20th Century
<input type="checkbox"/> 15th Century	<input type="checkbox"/> 17th Century	<input checked="" type="checkbox"/> 19th Century	

SPECIFIC DATE(S) (If Applicable and Known)

AREAS OF SIGNIFICANCE (Check One or More as Appropriate)

<input type="checkbox"/> Aboriginal	<input type="checkbox"/> Education	<input type="checkbox"/> Political	<input type="checkbox"/> Urban Planning
<input type="checkbox"/> Prehistoric	<input type="checkbox"/> Engineering	<input type="checkbox"/> Religion/Phi-	<input type="checkbox"/> Other (Specify)
<input type="checkbox"/> Historic	<input type="checkbox"/> Industry	losophy	_____
<input type="checkbox"/> Agriculture	<input type="checkbox"/> Invention	<input type="checkbox"/> Science	_____
<input type="checkbox"/> Architecture	<input type="checkbox"/> Landscape	<input type="checkbox"/> Sculpture	_____
<input type="checkbox"/> Art	Architecture	<input type="checkbox"/> Social/Human-	_____
<input type="checkbox"/> Commerce	<input type="checkbox"/> Literature	itarian	_____
<input type="checkbox"/> Communications	<input type="checkbox"/> Military	<input type="checkbox"/> Theater	_____
<input type="checkbox"/> Conservation	<input type="checkbox"/> Music	<input type="checkbox"/> Transportation	_____

STATEMENT OF SIGNIFICANCE

House was the Harding house; it dates from about the Civil War according to the owner. It is shown on the 1878 Hopkins Atlas.

SEE INSTRUCTIONS

9. MAJOR BIBLIOGRAPHICAL REFERENCES

10. GEOGRAPHICAL DATA

LATITUDE AND LONGITUDE COORDINATES DEFINING A RECTANGLE LOCATING THE PROPERTY			O R	LATITUDE AND LONGITUDE COORDINATES DEFINING THE CENTER POINT OF A PROPERTY OF LESS THAN TEN ACRES		
CORNER	LATITUDE	LONGITUDE		LATITUDE	LONGITUDE	
	Degrees Minutes Seconds	Degrees Minutes Seconds		Degrees Minutes Seconds	Degrees Minutes Seconds	
NW	° ' "	° ' "		° ' "	° ' "	
NE	° ' "	° ' "		° ' "	° ' "	
SE	° ' "	° ' "		° ' "	° ' "	
SW	° ' "	° ' "		° ' "	° ' "	

APPROXIMATE ACREAGE OF NOMINATED PROPERTY:

Acreage Justification:

LIST ALL STATES AND COUNTIES FOR PROPERTIES OVERLAPPING STATE OR COUNTY BOUNDARIES

STATE:	COUNTY:
STATE:	COUNTY:
STATE:	COUNTY:
STATE:	COUNTY:

11. FORM PREPARED BY

NAME AND TITLE:
Christopher Owens, Park Historian

ORGANIZATION: M-NCPPC DATE: 3/27/73

STREET AND NUMBER:
8787 Georgia Avenue

CITY OR TOWN: Silver Spring STATE: Maryland

12. State Liaison Officer Review: (Office Use Only)

Significance of this property is:
 National State Local

Signature _____

SEE INSTRUCTIONS



MARYLAND HISTORICAL TRUST
STATE HISTORIC SITES SURVEY FORM
LOCATIONAL MAP

SURVEY NO.: ^M28/27
PROPERTY NAME: Harding House
TOWN: Silver Spring
COUNTY: MONTGOMERY
QUADRANGLE: Beltsville, MD

B



28^{M-}-27, HARDING HOUSE

Mont Co, MD

MAY 1994, WM. BUSHONG.

VIEW NORTHEAST
(SOUTHWEST ELEVATION)

NEG: MD SHPO

1 OF 3



^{M-}
28-27 HARDING HOUSE

MONT CO, MD

MAY 1994 WM. BUSHONG

VIEW WEST

(EAST ELEVATION)

NEG. : MD SHPO

2 OF 3



M-
28-27, HARDING HOUSE
MONT CO, VT
MAY 1994, WM. BUSHONG

VIEW SOUTH + WEST
(NE ELEVATION)

NEG. : MD SHPO

3 OF 3



NAME HARDING HOUSE

LOCATION 1130 HARDING LA. BROWNS CORNER, Md.

FACADE N.W.

PHOTO TAKEN 3/27/73 M. DWYER



M:28-27

NAME HARDING HOUSE

LOCATION 1130 HARDING LA. BROWNS CORNER, Md

FACADE S.

PHOTO TAKEN 3/27/73 M. DWYER



NAME HARDING HOUSE - CREAM HOUSE (DAIRY)
LOCATION 1130 HARDING LA. BROWNS CORNER, Md
FACADE S.E.
PHOTO TAKEN 3/27/73 M. DWYER

M:28-27