

Montgomery County Cemetery Inventory

ID: 46

Name: (Henry Chew) Gaither Family Cemetery

Alternate name:

Address: Pleasant Fields
4615 Sundown Road

Town: between
Unity/Laytonsville

ADC Map Page 12 Grid A-7

Type

Religious
 Family Gaither family
 Private
 Other

Association

Free black
 Enslaved
 Ethnic
 Prehistoric

Setting Rural Urban Suburban Forested Other

Condition Excellent Good Fair Poor

Negative Impacts (vandalism, dumping, neglect, encroachment, etc) As this farm has been divided new homes surround. Although at this time new development has not occurred.

Approximate no. of burials 5 Date range of burials 1845-1858

Description (markers, materials, arrangement, landscaping, fence, paths and roads, etc.)

Enclosed in a black metal fence circa 1990 (20' 6" by 24" 2") is this Gaither family cemetery. The stones all face east and are marble. One field stone with no markings was found by the present owners and placed near the babys marker. Ep^{Epitaph} ~~Epitaph~~ ^{Epitaph} Henry Chew, Eliza Gaither, and Gen. William Lⁿgan Gaither are buried here. Ep^{Epitaph} ~~Epitaph~~ ^{Epitaph} has a footstone and a willow tree image on headstone. Henry, Eliza, and Gen. Lⁿgan are marble stones. →

Surveyor(s) Amanda Becker and Janet Becker Survey date 3/7/04

Photographer _____ Date _____ Photo no. _____

Current owner Donna Marie and Robert Thomas

Address/Phone No. 4615 Sundown Road, Laytonsville, Md 301-570-2810

Historic Status Locational Atlas ID _____ National Register

Master Plan ID _____ Other _____

UTM _____

Additional sources of information:

46
GAITHER (HENRY CHEW) FAMILY
SUNDOWN ROAD
LAYTONSVILLE

Have found out the money was given to St. Bartholomew's Episcopal Church (by a relative in the 1900's) for upkeep of the cemetery. About 7 yrs. ago church member and then Mayor of Haytonsville ~~Charlie~~ Charles White had original fence taken down and replaced by now modern, semi-rusting fence. These tablelet stones in cemetery are quite impressive for a ^{once} rural setting.

46

GAITHER (HENRY CHEW) FAMILY.
SUNDOWN ROAD
HAYTONSVILLE

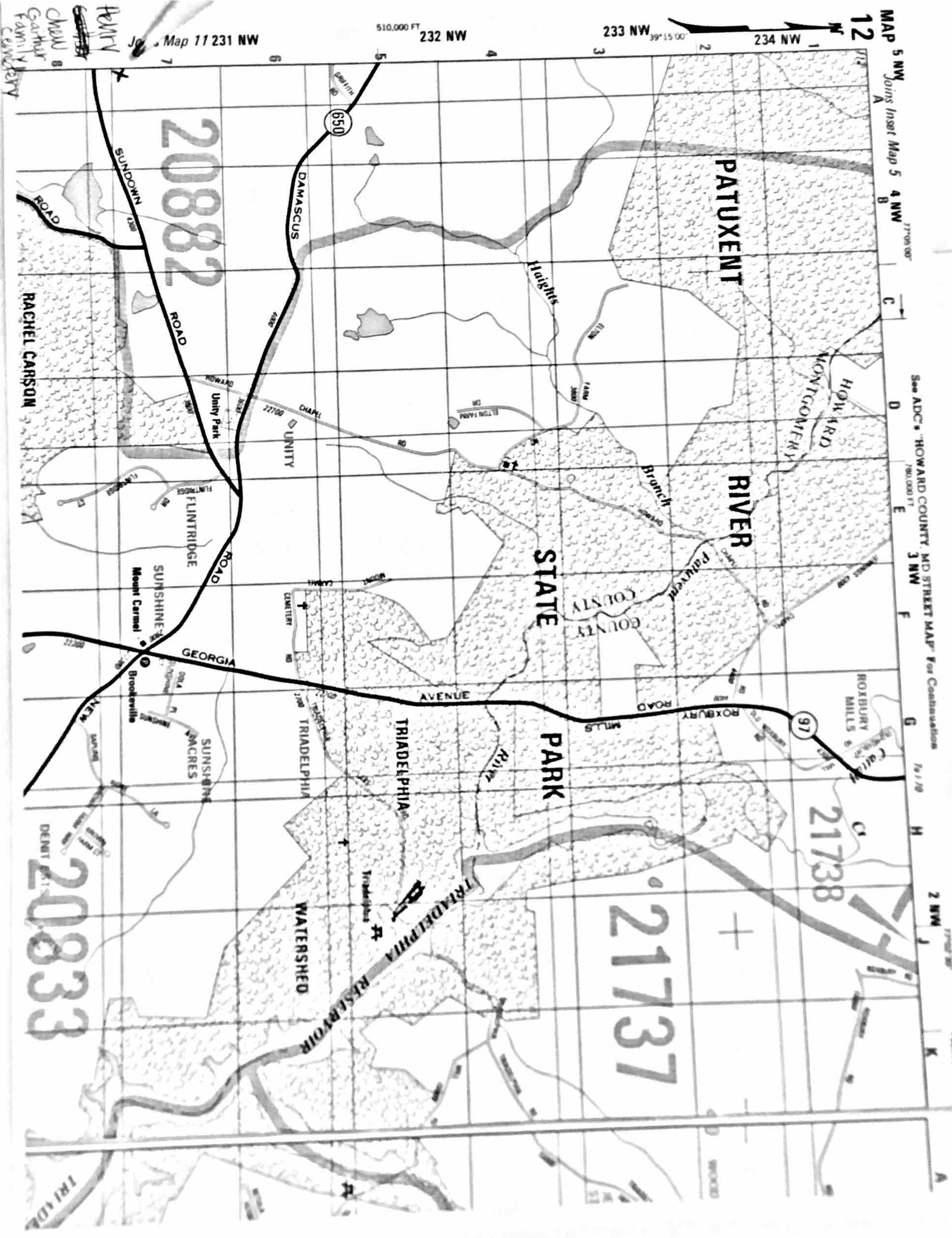

Henry
 Chad
 Gaither
 Family
 Cemetery

20882

RACHEL CARSON

20833

GAITHER (HENRY CREW) FAMILY
 SUNDOWN ROAD
 LAYTONSVILLE

46

Montgomery County Cemetery Inventory

Name: ^(Henry Chew) Gaither Family Cemetery ID: GAITHER 46
 Alternate name: Wormington Family Cemetery
 Address: 4821 Sundown Rd - driveway nearest, but actually goes with big stone house

Town: b/twn — + Zion Rd

ADC Map Page 12 Grid A-B

Type Family Gaither, Wormington Association Free black
 Religious Enslaved
 Family Private Ethnic
 Other Prehistoric

Setting Rural Urban Suburban Forested Other

Condition Excellent Good Fair Poor

Negative Impacts (vandalism, dumping, neglect, encroachment, etc) gopher holes under stones

Approximate no. of burials 6 Date range of burials 1845-1858

Description (markers, materials, arrangement, landscaping, fence, paths and roads, etc.)

Fenced-iron picket erected by Charles White in 1990s.

see attached - original iron fence removed, possibly

Driveway next to field. Inside ^{livestock} ~~horse~~ area (board fence)

3 large marble slabs on ground, one tablet w/ footstone, 1 fieldstone,

Surveyor(s) J. Manuel & 1 that just says "Baby" Survey date 5/1/2004

Photographer R. Brockett Date 5/1/2004 Photo no. _____

Current owner Maintained by St. Bartholomew's Church
 Address/Phone No. _____

Historic Status Locational Atlas ID _____ National Register
 Master Plan ID _____ Other _____

UTM GAITHER

Additional sources of information:

Cemetery is on property of large historic stone house to the east; access is via the driveway for 4821 Sundown Rd. Transcriptions on Reverse.

Cem. bequeathed by Lucy Worthington to Episcopal Church around the turn of the 20th century w/ \$3500 for maintenance.

46
GAITHER (HENRY CHEW) FAMILY
SUNDOWN ROAD
LANTONVILLE

1. Baby
2. Tombstone
3. Ephraim Gaither b. Apr 1, 1780 d. May 2, 1857
4. Henry Chew Gaither w/o William & Elizabeth Gaither
 b. Jan 25, 1778 d. Feb 12 1845 age 68 yrs
5. Eliza Gaither w/o Henry Chew and d/o William Worthington
 b. Mar 20, 1793 died suddenly at West Point
 June 19, 1851 age 58 yrs.
6. Gen. William Langan Gaither only child of
 Henry Chew & Eliza Gaither b. Feb 21, 1813
 d. at Berkeley Springs on 2nd of Aug 1858
 Aged 45 yrs 5 mos. & 11 days

46
 GAITHER (HENRY CHEW) FAMILY.
 SUNDOWN ROAD
 LAYTONSVILLE

EXTRACT FROM WILL OF LUCY A WORTHINGTON

" I give and bequesth to "The Convention of the Protestant Episcopal Church of the Diocese of Washington, a body corporate for the support of the episcopate of said Diocese, the sum of Thirty-five Hundred dollars of the said net proceeds of the said residue and remainder of my estate, and in consideration of this bequest I request the said body corporate to assume the care and to maintain in good order the family grave yard upon my farm in Montgomery County, Maryland, in which are interred the remains of my uncle, Henry Chew Gaither, his wife, Eliza Worthington Gaither, and their son William Lingan Gaither, but this request is not intended to be or to create a charge upon this bequest."

*House kept on 7th
N.A. 2.*

46

GAITHER (HENRY CHEW) FAMILY
SUNDOWN ROAD
LAYTONSVILLE

DIOCESE OF WASHINGTON

H. L. RUSSELL, TREASURER

1001 15TH STREET N.W.

December 29, 1928

Rev. Philip A. Dales,
St. John's Rectory,
Olney, Maryland

My dear Sir:-

I am enclosing herewith a check for \$20.00 to cover expense of caring for the family graves on the Lucy A. Worthington farm for the years 1927 and 1928. I am also enclosing for your files a copy of that portion of the will of the late Lucy A. Worthington that referred to her bequest to the Episcopal Fund.

It would be desirable to have a committee, composed of members of the Vestry, report to the Treasurer each year that the work has been done, and the cost, at the same time requesting that a check be sent in payment. This suggestion is made simply that the Treasurer's files may have evidence that the terms of the will are being complied with.

Very truly yours,



Treasurer

Diocese of Washington

H

46
GAITHER (HENRY CHEW) FAMILY.
SUNDOWN ROAD
LAYTONSVILLE

July 30, 1964

Mr. Edgar R. Mellon
Washington Gas Light Company
1100 H Street, N. W.
Washington, D. C.

Dear Mr. Mellon:

In accordance with our understanding, I am enclosing you a photocopy of a letter under the date of December 29, 1928, addressed to Rev. Philip A. Dales, St. John's Rectory, Olney, Maryland, who at that time served as rector of St. Bartholomew's Church at Laytonsville, Maryland, and also a copy of the extract from the will of Lucy A. Worthington, which is attached to the letter that was in the files of our Treasurer.

The iron fence which is around this cemetery has rusted through at the connections at the corner posts and the entire lower part of the fence has become so rusted that it is a mere sieve. Consequently, the fence does not prevent the cattle which is in the open field from breaking it down and they run over the graveyard.

This requires a capital improvement of a new fence which we are informed will run about \$4.00 a foot. There are approximately 100 feet of fence which will make the cost approximately \$400.00. It is our intention, if agreeable with the Treasurer's office, to secure two bids for replacing this fence and submit same to the Treasurer of the Diocese for approval as a capital investment in this cemetery. We will thank you if you will advise with reference to this project.

Very truly yours,

W. W. White
Senior Warden
St. Bartholomew's Church

WWW/rg
Enclosures

AC
GATHER (HENRY CHEW) FAMILY
SUNDOWN ROAD
LAYTONSVILLE



DIOCESE OF WASHINGTON

FEB 20 1990

The Rev. Canon John R. Frizzell, Jr., D.D.
Executive Officer

February 16, 1990

Mr. Charles White
The Baltimore Life Insurance Company
901 North Howard Street
Baltimore, MD 21201

Dear Mr. White:

I have just returned from vacation and have your letter of January 30th in reference to a new fence for the Worthington family burial yard.

I appreciate the material which you sent along with your letter and found it very helpful. It is clear to me that the Diocese has at least a moral obligation to help in the maintenance of this plot and we are prepared to carry that out.

Will you please get two bids on the erection of a new fence and send them to me with your recommendations and comments? I'll look forward to hearing from you at your convenience.

With kindest regards,

John R. Frizzell, Jr.
Executive Officer

cc: The Rev. Claude Bonbrest

AC
GATHER (HENRY CHEW) FAMILY.
SUNDOWN ROAD
LANTANVILLE

Charles T. White, CLU, LUTCF
Assistant Vice President
Manpower Development

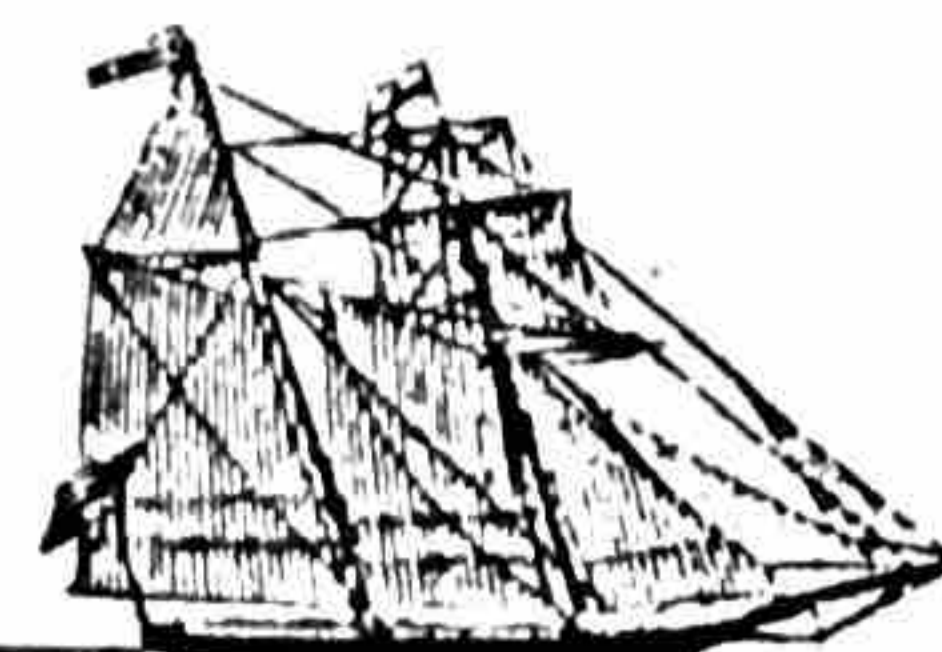

BALTIMORE LIFE
LIFE OF MARYLAND

April 25, 1990

The Rev. Cannon John R. Frizzell, Jr., D.D.
Diocese of Washington
Episcopal Church House
Mount Saint Alban
Washington, D.C. 20016

RE: New Fence
Worthington family burial yard

Dear Rev. Frizzell:

Pursuant to your request in your letter of February 6, 1990, I have proceeded to obtain three bids for the erection of a new fence.

The old fence had pickets with hot-forged points but I suggest that we use pickets with arrowheads. I would further recommend that the bid made by Bethesda Iron Works, Inc. for \$4,631.00 be accepted. I do notice that the Bethesda Iron Works bid price is exclusive of tax but I believe this will be the case for the other bids also.

I would be available to process the acceptance of the contract to Bethesda Iron and oversee the work as it progressed. I have been in contact with the owner of the property on which this burial yard is located and they have indicated cooperation in getting the work done. I'll look forward to hearing from you.

Sincerely,

Charles T. White

CTW:ef

AC
GAITHER (HENRY CHEW) FAMILY.
SUNDOWN ROAD
LANTONVILLE

Charles T. White, CLU, LUTCF
Assistant Vice President
Manpower Development

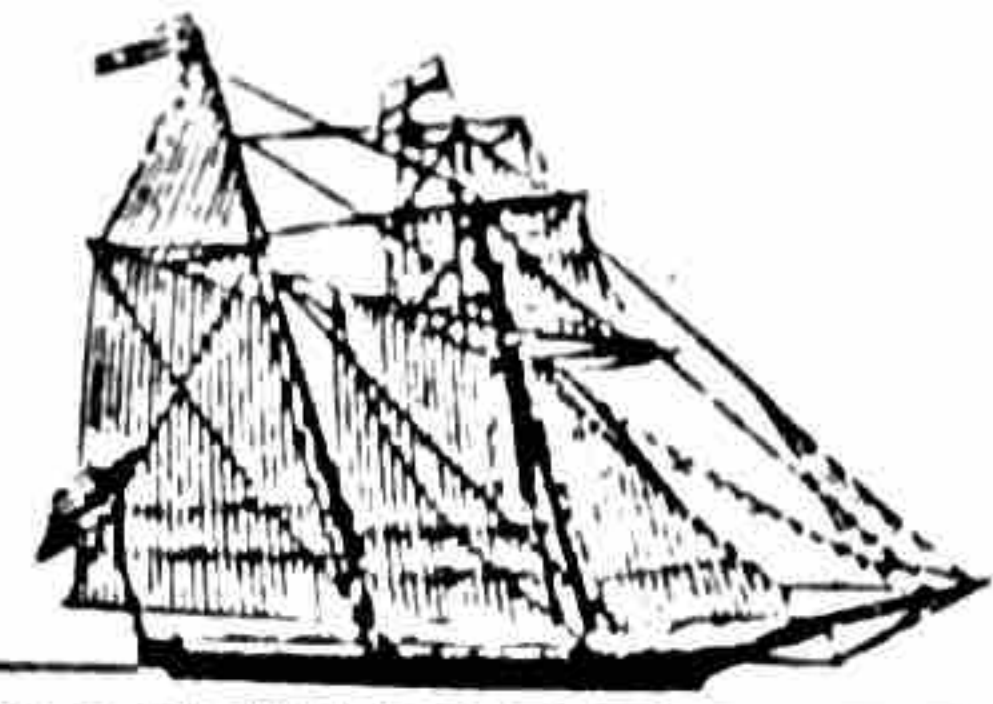

BALTIMORE LIFE
LIFE OF MARYLAND

April 25, 1990

The Rev. Cannon John R. Frizzell, Jr., D.D.
Diocese of Washington
Episcopal Church House
Mount Saint Alban
Washington, D.C. 20016

RE: New Fence
Worthington family burial yard

Dear Rev. Frizzell:

Pursuant to your request in your letter of February 6, 1990, I have proceeded to obtain three bids for the erection of a new fence.

The old fence had pickets with hot-forged points but I suggest that we use pickets with arrowheads. I would further recommend that the bid made by Bethesda Iron Works, Inc. for \$4,631.00 be accepted. I do notice that the Bethesda Iron Works bid price is exclusive of tax but I believe this will be the case for the other bids also.

I would be available to process the acceptance of the contract to Bethesda Iron and oversee the work as it progressed. I have been in contact with the owner of the property on which this burial yard is located and they have indicated cooperation in getting the work done. I'll look forward to hearing from you.

Sincerely,

Charles T. White
Charles T. White

CTW:ef

AC
GAITHER (HENRY CHEW) FAMILY
SUNDOWN ROAD
LAYTONSVILLE