

75
DAMASCUS UMC CEMETERY
9800 MAIN STREET
DAMASCUS

Montgomery County Cemetery Inventory

ID: 75

Name: Damascus United Methodist Church Cemetery

Alternate name: ~~Mt. Lebanon Church, Pleasant Plains of Damascus~~ 9800 Main St.

Address: ~~Corner of 108 & 124~~ (corner of 108 + 124)

Town: Damascus

ADC Map Page 4 Grid E-8

Type

Religious _____
 Family _____
 Private _____
 Other _____

Association

Free black _____
 Enslaved _____
 Ethnic _____
 Prehistoric _____

Setting Rural Urban Suburban Forested Other _____

Condition Excellent Good Fair Poor

Negative Impacts (vandalism, dumping, neglect, encroachment, etc) using riding mower

Approximate no. of burials about 1,000 Date range of burials 1865 - present

Description (markers, materials, arrangement, landscaping, fence, paths and roads, etc.)

Trees Vacant land at rear for additional burials
Chain fence with pillars, chain link fence
Some broken stones - about 5 (possibly by mower)
Church built in 1869. ^{1st} Replaced by a newer church that is now a
Current church is across Woodfield Rd. Thrift shop. 1869 church demolished.

Surveyor(s) Janet D. Manuel Survey date 4/17/04

Photographer Anne B Date 4/17/04 Photo no. _____

Current owner _____

Address/Phone No. _____

Historic Status Locational Atlas ID _____ National Register
 Master Plan ID _____ Other _____

UTM 75

Additional sources of information:

DAMASCUS UNITED METHODIST CHURCH CEMETERY (MOUNT
 ANON CHURCH, PLEASANT PLAINS OF DAMASCUS CHURCH)
 Directions: Route 355 North, right on Route 27, right on Route 108, right
 on Route 124, Woodfield Road, entrance on right. [A.D.C. Map:
 Montgomery, page 6, grid coordinates B-3.] Condition of cemetery: Well
 kept. Active cemetery. Earliest known death: 1865. Most recent death:
 Present. Famous person interred: Dr. Benjamin F. Lansdale. Veterans
 interred: WWI, WWII and other wars vets. 3 volumes records in 1938,
 1858-1910, at Clarksburg, 3 volumes, 1910-1922, at Laytonsville. Location
 of burial records: Church office. Date transcribed: 1976. Location of
 transcribed records: Montgomery County Historical Society Library, 42
 West Middle Lane, Rockville, Maryland 20850. Author: J. Thomas Scharf,
 A.M. Title: *History of Western Maryland*, page 725, Vol. I. Publisher:
 Regional Publishing Company [reprinted 1968], Baltimore, MD (originally
 printed in Philadelphia, 1882). Comments: Over 925 marked graves,
 records from 1922 at church.

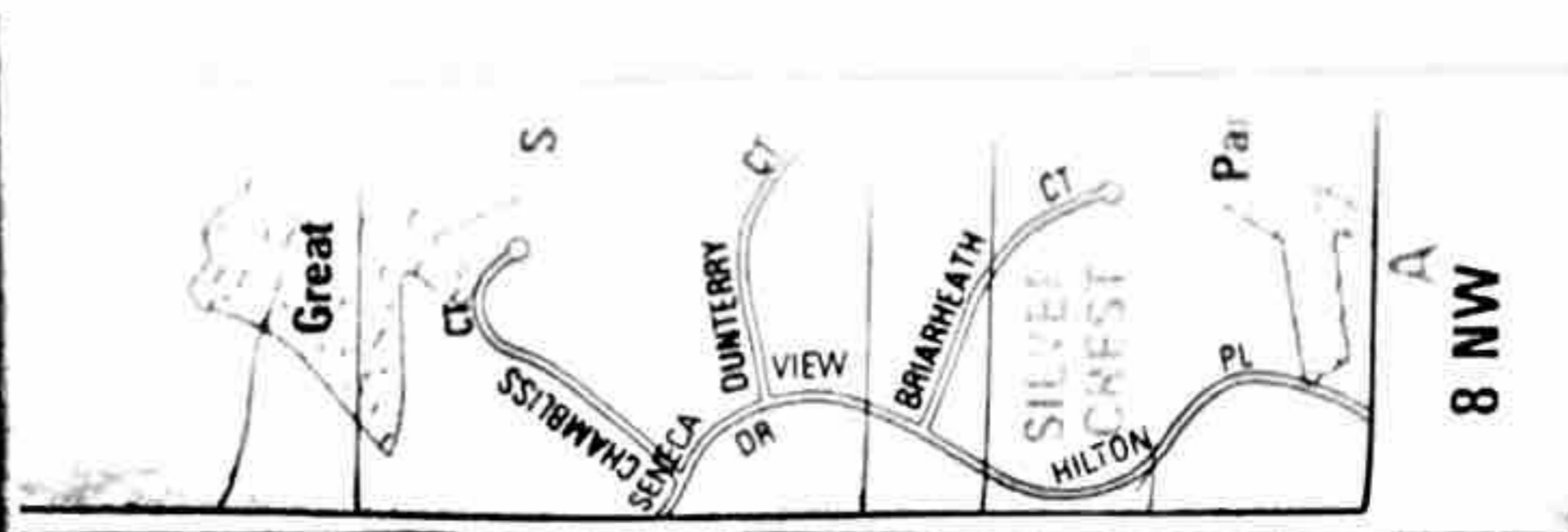
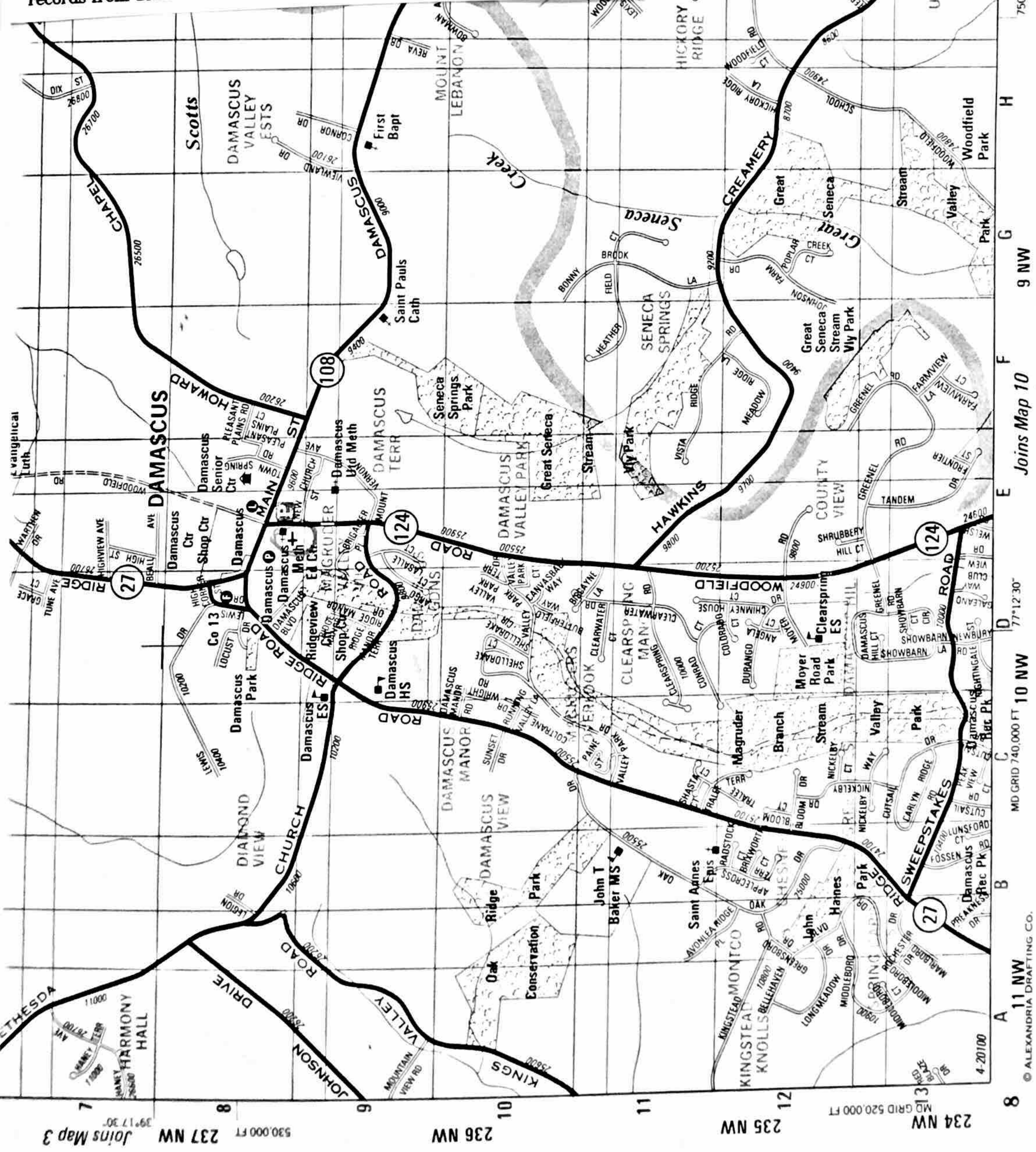

75
 DAMASCUS UMC CEMETERY
 9800 MAIN STREET
 DAMASCUS

MD GRID 740,000 FT 10 NW
 77°12'30"
 © ALEXANDRIA DRAFTING CO.

234 NW MD GRID 520,000 FT
 235 NW
 236 NW
 237 NW
 530,000 FT
 79°17'30"
 Joins Map 3

