

76 DARNESTOWN PRESBYTERIAN CHURCH CEMETERY. 15120 TURKEY FOOT ROAD DARNESTOWN

Montgomery County Cemetery Inventory

ID: 76

Name: Darnestown Presbyterian

Alternate name:

Address: 15120 Turkey Foot Rd.

Town: ~~Gaithersburg~~ Darnestown

ADC Map Page 27 Grid B-3

Type
 Religious PRESBYTERIAN
 Family _____
 Private _____
 Other _____

Association
 Free black
 Enslaved
 Ethnic _____
 Prehistoric _____

Setting Rural Urban Suburban Forested Other _____

Condition Excellent Good Fair Poor

Negative Impacts (vandalism, dumping, neglect, encroachment, etc) NONE

Approximate no. of burials 500-1000 Date range of burials 1836-PRESENT

Description (markers, materials, arrangement, landscaping, fence, paths and roads, etc.)

SEE ATTACHED.

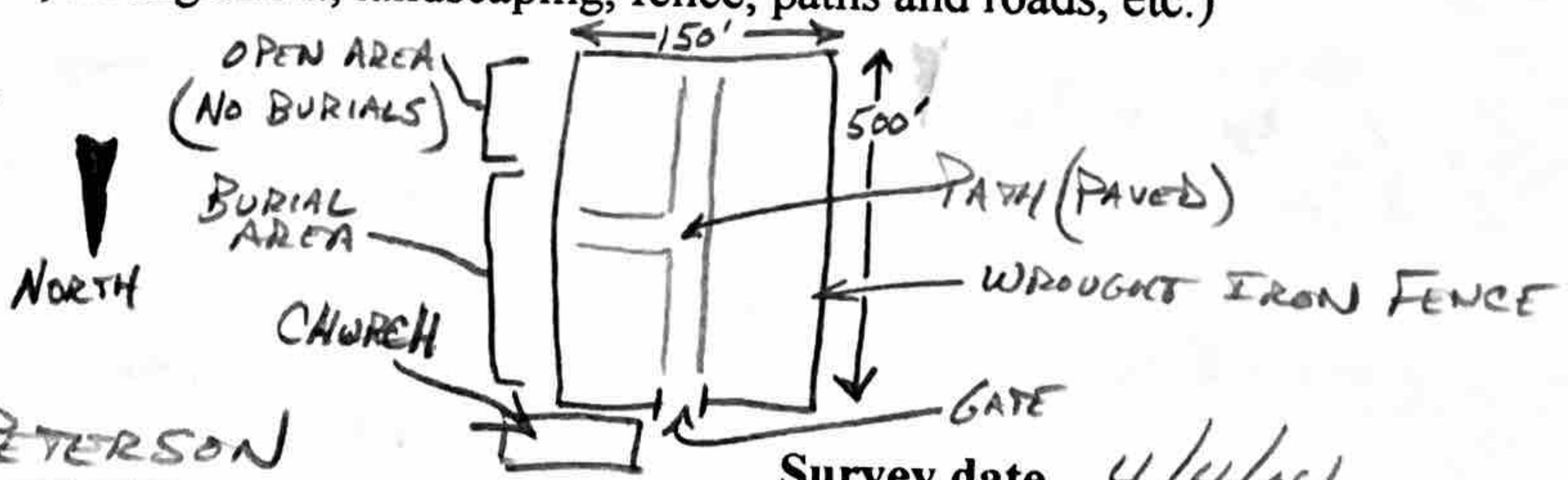

Surveyor(s) CARL PETERSON

Survey date 4/4/04

Photographer CARL PETERSON

Date 4/4/04 Photo no. 76-001 thru 76-011

Current owner _____

Address/Phone No. _____

Historic Status Locational Atlas ID _____ National Register
 Master Plan ID _____ Other _____

UTM 18 S 0302332 UTM 4330700 (MAIN GATE - NORTH END)

Additional sources of information:

76 DARNESTOWN PRESBYTERIAN
CHURCH CEMETERY.
15120 TURKEY FOOT ROAD
DARNESTOWN

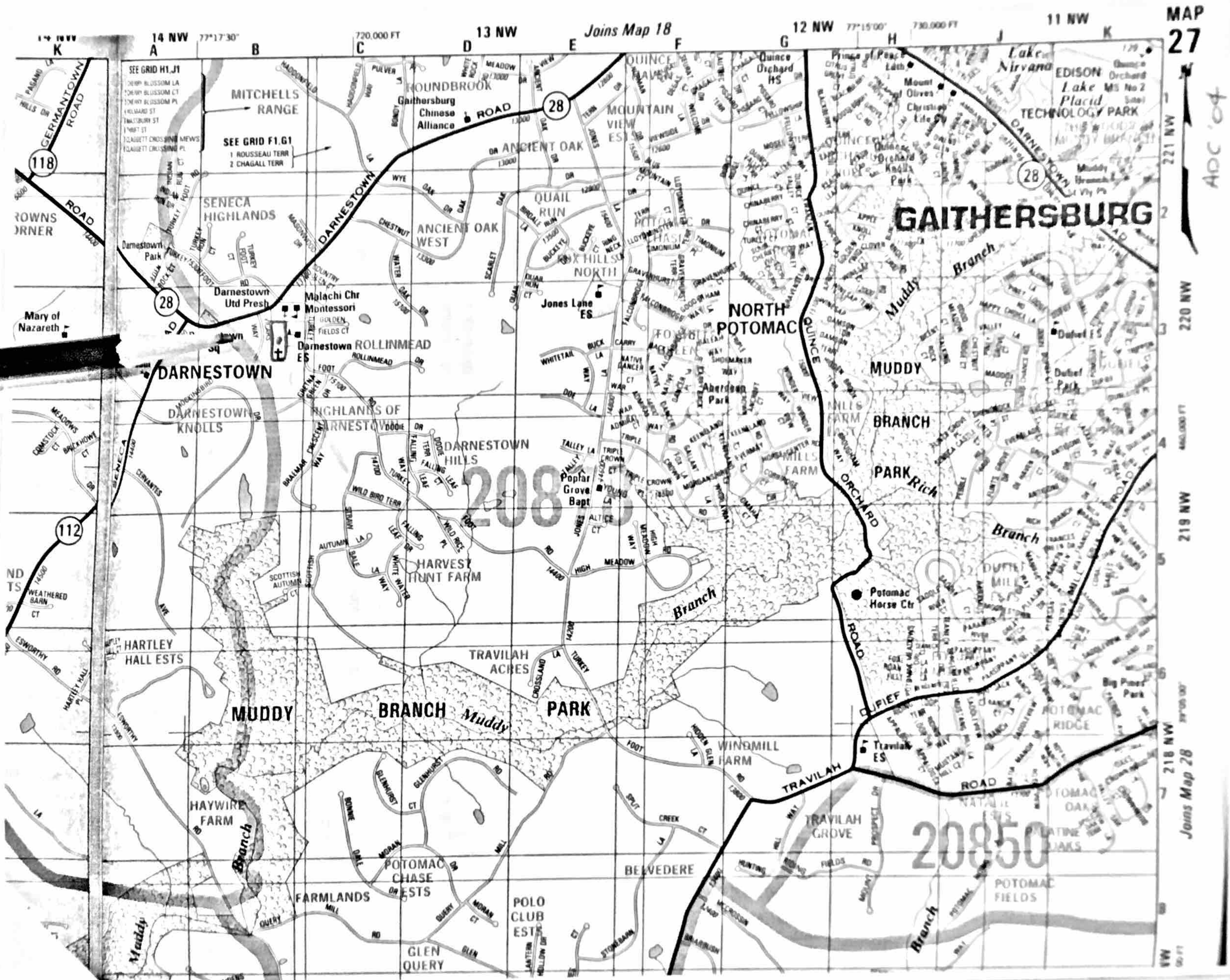

ADC '04

Joins Map 28

DARNESTOWN PRESBYTERIAN CHURCH CEMETERY

Directions: Route 28 West, Darnestown Road, to Turkey Foot cemetery and old church on left. [A.D.C. Map: Montgomery, page 21, grid coordinates K-10.] Condition of cemetery: Well kept. Active cemetery. Earliest known death: 1836. Most recent death: Present. Famous person interred: Edwin Warfield Broome. Veterans interred: WWI, WWII and other wars vets. Location of burial records: Church office. Date transcribed: 1985. Location of transcribed records: Montgomery County Historical Society Library, 42 West Middle Lane, Rockville, Maryland 20850. Author: J. Thomas Scharf, A.M. Title: *History of Western Maryland*, page 761, Vol. I. Publisher: Regional Publishing Company [reprinted 1968], Baltimore, MD [originally printed in Philadelphia, 1882]. Comments: Church records 1913-1923 and 1933 to present, years 1924-1932 missing.

The
DARNESTOWN PRESBYTERIAN
CHURCH CEMETERY.
15120 TURKEY FOOT ROAD
DARNESTOWN

Cemetery Description:

**DARNESTOWN PRESBYTERIAN
ID # 76**

Large, well-kept cemetery located behind old church. Rectangular space (approx 150 ft x 500 ft) bordered by wrought iron fence. Roughly $\frac{3}{4}$ of existing space contains burials. Remainder is open land (presumably for additional future burials). One main paved path with a perpendicular side path. No negative impacts apparent. Recent residential development nearby. Burials range from early 1800s to present. Markers—both old and new—tend to be well-constructed; some are very ornate (see photos). Layout is orderly, although not in exact rows.

76
DARNESTOWN PRESBYTERIAN
CHURCH CEMETERY.
15120 TURKEY FOOT ROAD
DARNESTOWN



76-001.JPG



76-002.JPG



76-003.JPG



76-004.JPG



76-005.JPG



76-006.JPG



76-007.JPG



76-008.JPG



76-009.JPG



76-010.JPG



76-011.JPG

To DARNESTOWN PRESBYTERIAN
CHURCH CEMETERY.
15120 TURKEY FOOT ROAD
DARNESTOWN