

**MARYLAND HISTORICAL TRUST  
DETERMINATION OF ELIGIBILITY FORM**

NR Eligible: yes  no

Property Name: Grace Episcopal Cemetery & Confederate Monument Inventory Number: M:36-4-1  
 Address: Georgia Avenue (MD 97) and Grace Church Road Historic district:  yes  no  
 City: Silver Spring Zip Code: 20910 County: Montgomery  
 USGS Quadrangle(s): Kensington  
 Property Owner: Grace Episcopal Church Tax Account ID Number: 01432115  
 Tax Map Parcel Number(s): N440 Tax Map Number: JP21  
 Project: MD 97: Forest Glen Road to 16th Street (MO224M11) Agency: SHA  
 Agency Prepared By: EHT Tracerics, Inc.  
 Preparer's Name: Emma Waterloo Date Prepared: 1/25/2013  
 Documentation is presented in: DOE form  
 Preparer's Eligibility Recommendation:  Eligibility recommended  Eligibility not recommended  
 Criteria:  A  B  C  D Considerations:  A  B  C  D  E  F  G  
*Complete if the property is a contributing or non-contributing resource to a NR district/property:*  
 Name of the District/Property: \_\_\_\_\_  
 Inventory Number: \_\_\_\_\_ Eligible:  yes  no Listed:  yes  no  
 Site visit by MHT Staf  yes  no Name: \_\_\_\_\_ Date: \_\_\_\_\_

Description of Property and Justification: *(Please attach map and photo)*

**ARCHITECTURAL DESCRIPTION**

Grace Episcopal Church Cemetery and Confederate Monument is situated on the northeast corner of the intersection of Georgia Avenue (MD 97) and Grace Church Road, in the Woodside neighborhood of Silver Spring, Maryland. The cemetery and monument are contributing resources to the Woodside Historic District (M: 36-4), which is an identified historic district in Montgomery County's Locational Atlas & Index of Historic Sites. Resources listed in the Locational Atlas & Index of Historic Sites are protected from demolition or "substantial alteration" at the county level. It is also adjacent to the Woodside Park Historic District (M: 36-18), which is recorded in the Marland Inventory of Historic Places (MIHP). (1) The property is bound to the north by the former Grace Episcopal Day School (Parish Hall), to the south by Grace Church Road, to the east by an asphalt-paved driveway that leads to a parking lot for Grace Episcopal Church, and to the west by Georgia Avenue. The south and west property boundaries are defined by concrete pedestrian sidewalks that flank the north side of Grace Church Road and the east side of Georgia Avenue, respectively.

<b>MARYLAND HISTORICAL TRUST REVIEW</b>	
Eligibility recommended <input checked="" type="checkbox"/>	Eligibility not recommended <input type="checkbox"/>
Criteria: <input checked="" type="checkbox"/> A <input type="checkbox"/> B <input type="checkbox"/> C <input type="checkbox"/> D	Considerations: <input checked="" type="checkbox"/> A <input type="checkbox"/> B <input type="checkbox"/> C <input type="checkbox"/> D <input type="checkbox"/> E <input type="checkbox"/> F <input type="checkbox"/> G
MHT Comments:	
<u>Shirley Dan...</u> Reviewer, Office of Preservation Services	<u>6/6/2013</u> Date
<u>[Signature]</u> Reviewer, National Register Program	<u>6/7/13</u> Date

Cemetery

The cemetery, which includes over 150 burials, is situated on approximately 0.6 acres, which encompasses a grassy lot that slopes down to the east. (2) An east/west-oriented concrete path is located in the northern section of the cemetery. The path curves to the north at its western extent, providing access to a concrete walkway that connects the Parish Hall with the pedestrian sidewalk along Georgia Avenue. This serves as the northern entrance to the cemetery, which is marked by two brick piers with stretcher-bond brick collars, surrounded by shrubs. The piers are located to the east and west of the walkway. The eastern end of the walkway joins with the asphalt driveway associated with the church parking lot. A short, U-shaped, brick retaining wall edges the northern side of the west cemetery boundary along Georgia Avenue. A single-story, wood sign that includes two flat panels supported by wood posts to the north and south is located along Georgia Avenue, south of the brick retaining wall. The sign announces the location of Grace Episcopal Church and Day School.

The cemetery was established as a churchyard burial ground for a country parish. As such, the cemetery was not laid out to a particular design, but was a practical resource for the church. The graves are organized in rows aligned roughly north/south on land situated south of the original location of the church. The westernmost row of markers is situated approximately 35 feet east of the Georgia Avenue right-of-way, and the southernmost markers are placed just north of the pedestrian sidewalk along Grace Church Road. Sections are marked by small square blocks of granite, carved with the section letter. Landscaping provides the cemetery with both privacy and beauty; shrubs are concentrated along the east and west cemetery boundaries, with mature trees and shrubs scattered between the graves.

Despite the fact that the cemetery was not laid out according to fashionable cemetery designs, the markers and monuments reflect the changes associated with cemetery design movements. The Grace Episcopal Church Cemetery has been an active cemetery from the 1860s to the present, and its markers exemplify the evolution in funerary taste. Materials for markers include marble, granite, concrete, and bronze. The earliest markers reflect the influence of the Rural Cemetery Movement, which put a premium on individual expression. Markers from the earliest period are usually constructed of marble, and are typically tall obelisks, often set on pedestals. A few examples incorporate small sculptural works, such as urns. An example is the marble monument for the Wilson family, located in the northwest corner of the cemetery. The monument is set on a chamfered plinth, with a square pedestal engraved with the family names. According to historic photos, its crowning finial has been lost. Additional ornamentation include roses and other stylized foliage. More modest markers from the second half of the nineteenth century are tablet-type markers. The tablets have a variety of shapes, including pointed arch, square-head, segmental-arch, and a square-head with a central semicircular arch shape.

Markers from the turn-of-the-twentieth century reflect the influences of the Landscape Lawn Parks Movement. The Landscape Lawn Parks Movement was a unifying cemetery design, which emphasized the landscape as an open park-like setting. Consequently, markers were both more modest in decoration and scale than those of the Rural Cemetery, and were often mass produced. Typical forms for markers of this period are tall pedestal tombs with domed caps, and headstones on bases. Granite became a more prevalent material for these markers. Introduced at this time were larger family monuments, accompanied by small lawn-type markers to distinguish individual graves. An example of this is the granite monument for the Schrider family, erected in 1901. It is comprised of a large, gently curved headstone, set on a tooled base, with small stone markers to identify Benjamin, his wife Susan, and their sons, August and William.

Throughout the twentieth century, marker design became increasingly standardized as the influences of the Memorial Park Movement reimagined cemeteries with a strong regularity of form and design. The markers are homogenous, providing little individuality in ornamentation or design. Granite is the typical material for these markers, and lasers are used to incise the

<b>MARYLAND HISTORICAL TRUST REVIEW</b>	
Eligibility recommended _____	Eligibility not recommended _____
Criteria: ___A ___B ___C ___D	Considerations: ___A ___B ___C ___D ___E ___F ___G
<b>MHT Comments:</b>	
_____	_____
<b>Reviewer, Office of Preservation Services</b>	<b>Date</b>
_____	_____
<b>Reviewer, National Register Program</b>	<b>Date</b>

inscription for clarity. Individual markers tend to be one of three styles: headstone on base, such as the marker erected for Mildred Newbold Getting in 1982; an angled wedge of stone, such as the one for the Pope family, centrally located in the cemetery; and lawn-type markers, such as the one for William M. Canby, erected on December 28, 1980. Some of the lawn-type markers are made of bronze. Over time the bronze develops a green patina that allows the marker to blend in with the landscape. Larger family monuments coupled with lawn-type markers continued to be used as well. Modern markers dot the cemetery, and are concentrated in the northeast corner near the Parish Hall.

**Confederate Monument**

Erected in 1896, the Confederate Monument is located on a 15-foot-by-30-foot plot that sits on a small knoll in the southwest corner of the cemetery. The knoll is distinguished from the rest of the cemetery by a low brick retaining wall, constructed by members of the Veterans of Foreign Wars in the 1960s. The 8-foot-tall, granite memorial is stylistically influenced by the principles of the Landscape Lawn Parks Movement, and reflects a harmony in materials and design, without the use of intricate ornamentation or statuary. It is comprised of a rough-hewn obelisk with a polished granite cap. A recessed, polished granite plaque with an inscription commemorating the unknown soldiers is centered on the west elevation of the obelisk. The obelisk is set on a chamfered base that reads "CONFEDERATE," which is elevated from the ground on a chamfered plinth.

**HISTORIC CONTEXT**

Grace Episcopal Church was established in 1855 by several prominent community members to serve the rural area outside the District of Columbia, in what is now Silver Spring, Maryland. Founding members included farmer Oliver H.P. Clark and physician Dr. Josiah Harding, as well as Elizabeth Blair, daughter of Francis Preston Blair, organizer of the modern Republican Party and the driving force behind the development of Silver Spring, and sister of Montgomery Blair, Post Master General under President Lincoln. (3) An acre of land, located along the Washington and Brookeville Turnpike (sometimes known as the 7th Street Pike, and currently known as Georgia Avenue), was donated by Thomas Noble Wilson, a local farmer who owned an approximate 95-acre farm on a parcel of land once known as "Labyrinth," for the construction of the church. (4) Ground was broken for a wood-frame building to house the congregation in 1857. (5) A churchyard burial ground was established south of the church, at what is now the northeast corner of the intersection of Georgia Avenue and Grace Church Road.

Due to its close proximity to the City of Washington, the rural community in the Silver Spring area saw action during the Civil War. Specifically, on July 11, 1864, Confederate troops, under the command of General Jubal Early and just three days after their victory at the Battle of Monocacy, advanced down the Washington and Brookeville Turnpike to Silver Spring. Their path would have taken them past Grace Episcopal Church and Cemetery. The Confederate's goal was to take Washington; however, after the costly Battle of Monocacy and the 35-mile march to the federal city, Early's troops were too exhausted to continue to Washington that day. Minor skirmishes with Union soldiers took place while the Confederates regrouped, and the Union forces were driven back to the fortifications around Washington. On July 12, the fighting had moved to Fort Stevens in Northwest Washington. Fort Stevens is approximately 2.5 miles from Grace Episcopal Church. The strong defenses of the fort in addition to the newly arrived reinforcements, minimized the military threat of the battle-weary Confederate force, and General Early retreated to Rockville, Maryland, on the 13th. (6)

The Confederate forces sustained casualties during the skirmishes, and the dead were quickly buried in shallow graves during the retreat to Rockville. Seventeen soldiers who were killed either on July 11 or 12 were buried in a shallow grave in the Brightwood neighborhood of the District of Columbia. After the war, the pastor of Grace Episcopal Church, James Avirett who had served as a chaplain with the Confederate 7th Virginia Cavalry, noticed the poor condition of the graves of the hastily buried soldiers, and began a campaign to give the soldiers a proper burial at Grace Church Cemetery. Reverend Avirett had the soldiers exhumed, and

**MARYLAND HISTORICAL TRUST REVIEW**

Eligibility recommended \_\_\_\_\_ Eligibility not recommended \_\_\_\_\_  
 Criteria: \_\_\_ A \_\_\_ B \_\_\_ C \_\_\_ D Considerations: \_\_\_ A \_\_\_ B \_\_\_ C \_\_\_ D \_\_\_ E \_\_\_ F \_\_\_ G

**MHT Comments:**

\_\_\_\_\_  
 Reviewer, Office of Preservation Services

\_\_\_\_\_  
 Date

\_\_\_\_\_  
 Reviewer, National Register Program

\_\_\_\_\_  
 Date

the remains were placed in six coffins for transport. At the time of exhumation, it was discovered that the majority of the soldiers were no more than teenagers, three of whom were officers and 14 privates. The only soldier identified was James B. Bland of Highland County, Virginia. Bland had served with the 62nd Virginia Mounted Infantry. With consent of the vestry on December 11, 1874, the remains were reinterred between the primary entrance of Grace Episcopal Church and the turnpike. James B. Bland was placed in the northernmost grave in case his family ever came in search of his remains. (7)

During Reconstruction, the Metropolitan Branch of the Baltimore and Ohio Railroad (B&O RR) was constructed in 1873 through Silver Spring. Direct transportation to the City of Washington opened the area up for suburban residential development. At the same time, the population of Washington was rapidly expanding, and the middle classes were beginning to look for housing outside of the federal city. This coincided with a national movement of investment and improvement companies platting out subdivisions wherever land was available and marketable. During this period, Benjamin F. Leighton, a northern lawyer and banker, arrived in Washington to work for the government. In August 1889, he purchased nearly 92 acres of farm land from Richard and Laura Wilson, the children of Thomas Noble Wilson and the same farm from which the land for Grace Episcopal Church was donated. (8) One month later in September 1889, Leighton filed a plat for a subdivision of the property, which he had named "Woodside." (9)

Woodside was marketed for its location, which had easy access to Washington. In addition to the B&O RR, transportation was provided by the Washington, Woodside, and Forest Glen Railway and Power Company, which ran from 1897 to 1930. (10) The company had laid the tracks along the eastern side of Georgia Avenue, beginning in 1896. The track alignment required the company to secure a right-of-way (ROW) for the tracks from Grace Episcopal Church. The ROW required a 12-foot strip of land from the west boundary of the church property, and coincided with the area where the Confederate soldiers had been reinterred. To accommodate the ROW, the church moved the Confederate soldiers' remains to a common grave, located at the corner of Georgia Avenue and Grace Church Road. A granite monument was erected over the gravesite. This is one of two known Civil War battlefield burial grounds in Montgomery County. In return for the ROW, the railway company provided electricity to the church, free of charge. (11)

Additionally in 1896, the original wood-frame Grace Episcopal Church burned down as the result of an accident involving a coal oil lamp. The fire had quickly engulfed the church, and the heat from the flames scorched the plantings in the cemetery. (12) A new church, designed by Clarence L. Harding and constructed in the Shingle Style, was completed one year later in 1897. (13)

Suburban development continued through the first half of the twentieth century, and Silver Spring and Woodside continued to grow. By the 1950s, Silver Spring's retail economy was second only to Washington, D.C. in the Maryland/Virginia region. (14) Due to this development by the early 1950s, Grace Episcopal Church was outgrowing its picturesque Shingle-style building. In 1955, ground was broken on a separate lot, adjacent to the east of the original parcel, for the current brick-clad church. The new church was influenced by the Tudor Revival style, and was completed in 1956. (15) Constructing the church east of the original location allowed the congregation to continue to worship in the older building while the new one was under construction. After the congregation moved to its present location, feasibility studies for the reuse of the old church were conducted. It was determined to be more cost-effective to construct a new building to serve as a parish hall and educational facility. The 1896 church was demolished in 1967, and a new educational building was constructed in its place. At this same time, the Veterans of Foreign Wars built the brick retaining wall around the knoll where the Confederate Monument is located to protect the site from erosion. (16) Throughout these changes to the Grace Episcopal Church grounds, the cemetery and Confederate Monument have remained intact.

EVALUATION

The Grace Episcopal Church Cemetery and Confederate Monument, situated at the northeast corner of the intersection of Georgia

<b>MARYLAND HISTORICAL TRUST REVIEW</b>	
Eligibility recommended _____	Eligibility not recommended _____
Criteria:    ___ A    ___ B    ___ C    ___ D	Considerations:    ___ A    ___ B    ___ C    ___ D    ___ E    ___ F    ___ G
MHT Comments:	
_____	_____
<b>Reviewer, Office of Preservation Services</b>	<b>Date</b>
_____	_____
<b>Reviewer, National Register Program</b>	<b>Date</b>

Avenue and Grace Church Road, is a contributing property to the Woodside Historic District (M:36-4), a locally recognized historic district, and is adjacent to the Woodside Park Historic District (M:36-18), recorded in the Maryland Inventory of Historic Places. The property also is individually eligible for the National Register of Historic Places. The Grace Episcopal Church Cemetery retains integrity of materials and design as a mid-nineteenth-century churchyard burial ground. Its integrity of workmanship has been somewhat compromised due to the deterioration of, and damage to many of the markers within the cemetery; this is a common issue for most mid-nineteenth-century grave markers. The cemetery has also lost integrity of setting and location because the Silver Spring area is no longer a rural community of farmers, but a heavily developed suburb of Washington, D.C. However, the cemetery retains sufficient integrity of feeling and association with both the Grace Episcopal Church, and as a churchyard burial ground situated along a major thoroughfare. The Confederate Monument retains a high degree of integrity of materials, design, workmanship, setting, feeling, and association. While the graves of the Confederate soldiers have been moved numerous times—a common practice for Civil War interments, they have not been moved since their relocation to the southwest corner of Grace Episcopal Church Cemetery in 1896, at which time Confederate Monument was erected. The monument is in excellent condition.

Together, the Grace Episcopal Church Cemetery and Confederate Monument retain sufficient integrity to represent the property's period of significance, which extends from 1855 to 1896. This encompasses the founding of Grace Episcopal Church, with which the cemetery is associated, until 1896 when the Confederate Monument was erected. Significant dates include 1874, when the Confederate soldiers were interred on church property, and 1896 when the graves were moved and the monument erected in its present location.

The Grace Episcopal Church Cemetery and Confederate Monument is eligible for the National Register under Criterion A, and Criteria Considerations A and D. The Grace Episcopal Cemetery and Confederate Monument has a strong connection with the Confederate campaign to take Washington, D.C., during the Civil War. In 1864, General Jubal Early marched his troops down the Washington and Brookeville Turnpike (Georgia Avenue), past Grace Episcopal Church Cemetery, to Northwest Washington where they engaged in the Battle of Fort Stevens—the only battle fought in the nation's capital. The Confederate soldiers hastily buried their dead during their quick retreat to Rockville, Maryland, after the battle. Ten years later in 1874, Confederate sympathizer and Grace Episcopal Church pastor, Reverend James Avirett, disinterred the remains of Confederate soldiers in a shallow grave in Brightwood, and gave the 16 unknown soldiers and one known soldier a proper burial in the Grace Episcopal Church Cemetery. In 1896, the soldiers were moved to a common grave in the southwest corner of the cemetery to accommodate a streetcar ROW, and a monument was erected in their honor. Further, the cemetery serves as one of two known Confederate battlefield burial grounds in Montgomery County. Therefore, it is eligible under Criterion A.

Additionally, the property is eligible under Criteria Consideration A, as a religious property deriving its primary significance from an important historic event. The Grace Episcopal Church Cemetery and Confederate Monument is also eligible under Criteria Consideration D as a cemetery associated with an important Civil War battle, because it contains the remains of Confederate soldiers killed at the Battle of Fort Stevens, which is the only battle fought within Washington, D.C. Therefore, this property is individually eligible for the National Register.

**BOUNDARY DESCRIPTION**

Situated at the northeast corner of the intersection of Georgia Avenue (MD 97) and Grace Church Road, the Grace Episcopal Church Cemetery and Confederate Monument are located 1.3 miles northeast of the center of Silver Spring in Montgomery County, Maryland. Part of the larger Grace Episcopal Church property, the Cemetery and Confederate Monument encompass approximately 0.6 acres. It is bound to the north by the Grace Church School building (Parish Hall), to the south by Grace Church Road, to the east by an asphalt-paved driveway that leads to a parking lot for Grace Episcopal Church, and to the west by Georgia

<b>MARYLAND HISTORICAL TRUST REVIEW</b>	
Eligibility recommended _____	Eligibility not recommended _____
Criteria:    ___ A    ___ B    ___ C    ___ D	Considerations:    ___ A    ___ B    ___ C    ___ D    ___ E    ___ F    ___ G
MHT Comments:	
_____	_____
<b>Reviewer, Office of Preservation Services</b>	<b>Date</b>
_____	_____
<b>Reviewer, National Register Program</b>	<b>Date</b>



Avenue. The boundary has historically been the cemetery boundary associated with the church since its establishment. The boundary does not include Grace Episcopal Church since the church is located on a separate lot. Even though the Parish Hall occupies the northern half of the same parcel as the cemetery, it is considered not contributing to the boundary since that building has not yet met the 50 year requirement. The Grace Episcopal Church Cemetery and Confederate Monument were surveyed in connection with the Maryland State Highway Administration's (SHA) transportation study of Georgia Avenue from just north of Kimbal Place to Grace Church Road.

ENDNOTES

- (1) Montgomery County Planning Department. No date (n.d.). "Research and Designation." Website. [Accessed January 14, 2013]. < <http://www.montgomeryplanning.org/historic/research.shtm>>.
- (2) Brockett, Anne. 2004. "Grace Episcopal Church Cemetery." Montgomery County Cemetery Inventory. ID # 90. Available at <http://www.montgomeryplanning.org/historic/education/cemeteries.shtm#Top>.
- (3) Hutcheson, Lynn. 2002. "The History of Grace Episcopal Church, Silver Spring Parish." Grace Church Messenger. Available at <http://www.graceepiscopalchurch.org/article/73/meet-the-parish/the-history-of-grace-episcopal-church-silver-spring-parish>;
- McCoy, Jerry A. and the Silver Spring Historical Society. 2005. Historic Silver Spring. Charleston, SC: Arcadia Publishing. 7-8.
- (4) Hutcheson, Lynn. 2002. "The History of Grace Episcopal Church, Silver Spring Parish." Grace Church Messenger. Available at <http://www.graceepiscopalchurch.org/article/73/meet-the-parish/the-history-of-grace-episcopal-church-silver-spring-parish>;
- 1850 United States Federal Census (Free Schedule). Berry's District, Montgomery County, Maryland. P. 358A, family 169, dwelling 166, lines 25-30. July 30, 1850. National Archives Microfilm: Roll M432\_295; Deed of sale from Richard T. Wilson to Vestry of Protestant Episcopal Church. June 2, 1863. Number JGH 9, page 209. Montgomery County Circuit Court: Rockville, MD.
- (5) Hutcheson, Lynn. 2002. "The History of Grace Episcopal Church, Silver Spring Parish." Grace Church Messenger. Available at <http://www.graceepiscopalchurch.org/article/73/meet-the-parish/the-history-of-grace-episcopal-church-silver-spring-parish>.
- (6) Markwood, Louis N. April 1975. "At the Capital's Doorstep." Echoes of History. On file with the Montgomery County Historical Society.
- (7) Markwood, Louis N. April 1975. "At the Capital's Doorstep." Echoes of History. On file with the Montgomery County Historical Society.
- (8) Crawford, Catherine. June 1984. "Woodside Historic District." M: 36-4. MIHP form. Section 8; 1850 United States Federal Census (Free Schedule). Berry's District, Montgomery County, Maryland. P. 358A, family 169, dwelling 166, lines 25-30. July 30, 1850. National Archives Microfilm: Roll M432\_295.
- (9) Crawford, Catherine. June 1984. "Woodside Historic District." M: 36-4. MIHP form. Section 8.
- (10) Crawford, Catherine. June 1984. "Woodside Historic District." M: 36-4. MIHP form. Section 8.
- (11) Markwood, Louis N. April 1975. "At the Capital's Doorstep." Echoes of History. On file with the Montgomery County Historical Society.
- (12) "Grace Church Burned." June 8, 1896. The Evening Star. 10. Genealogy Bank Historical Newspapers.
- (13) Hutcheson, Lynn. 2002. "The History of Grace Episcopal Church, Silver Spring Parish." Grace Church Messenger. Available at <http://www.graceepiscopalchurch.org/article/73/meet-the-parish/the-history-of-grace-episcopal-church-silver-spring-parish>.
- (14) McCoy, Jerry A., Robert E. Oshel, Dana Lee Dembrow. No date (n.d.). "Silver Spring Timeline: 20th Century and Beyond!" Silver Spring Historical Society. [Accessed January 7, 2013]. <<http://silverspringhistory.homestead.com/timeline2.html>>.
- (15) Hutcheson, Lynn. 2002. "The History of Grace Episcopal Church, Silver Spring Parish." Grace Church Messenger. Available at <http://www.graceepiscopalchurch.org/article/73/meet-the-parish/the-history-of-grace-episcopal-church-silver-spring-parish>.
- (16) Markwood, Louis N. April 1975. "At the Capital's Doorstep." Echoes of History. On file with the Montgomery County Historical Society.

<b>MARYLAND HISTORICAL TRUST REVIEW</b>													
Eligibility recommended _____				Eligibility not recommended _____									
Criteria:	___ A	___ B	___ C	___ D	Considerations:	___ A	___ B	___ C	___ D	___ E	___ F	___ G	
MHT Comments:													
_____							_____						
Reviewer, Office of Preservation Services							Date						
_____							_____						
Reviewer, National Register Program							Date						

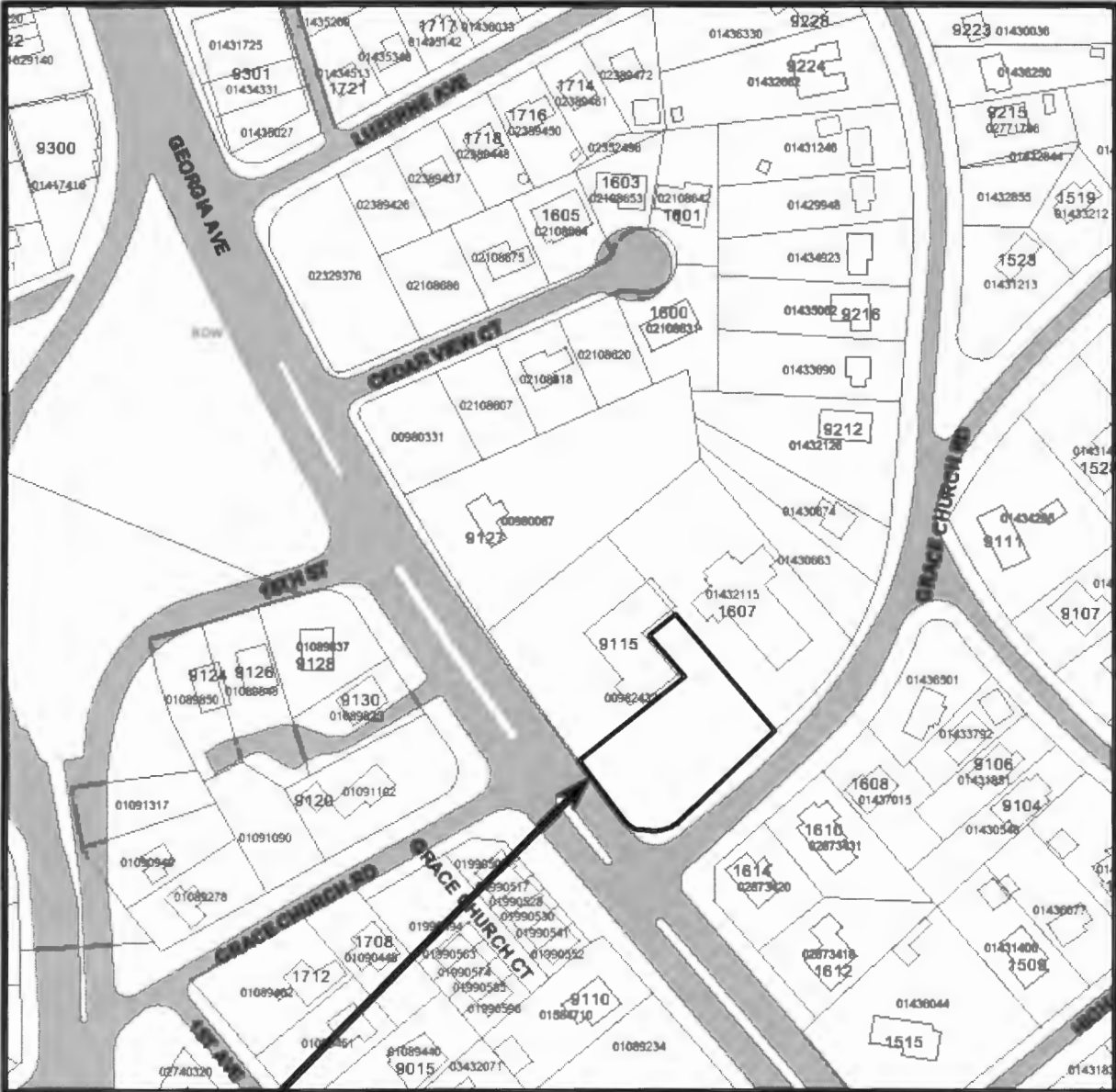

**Grace Episcopal Church Cemetery & Confederate Monument (M: 36-4-1)**  
 Georgia Avenue (MD 97) and Grace Church Road  
 Montgomery County, Maryland 20910  
 Map Courtesy of Montgomery County GIS, 2005  
 EHT Tracerics, 2013



GEORGIA AVENUE



GRACE CHURCH LANDS



Date	1/9/13	Not to Scale
I.D.#	M: 36-4-1	
Address <u>GEORGIA AVENUE &amp; GRACE CHURCH ROAD</u> (GRACE EPISCOPAL CHURCH CEMETERY & CONFEDERATE MONUMENT)		





**Grace Episcopal Church Cemetery & Confederate Monument (M: 36-4-1)**  
 Montgomery County, Maryland  
 Kensington Quadrangle, USGS Topographic Map, 1965, Revised 1979  
 EHT Traceries, 2013



<b>PROJECT NO. MO224A11</b> <b>DIGITAL PHOTOLOG*</b>  <b>MONTGOMERY COUNTY, MARYLAND</b>	M: 36-4-1, Grace Episcopal Church Cemetery & Confederate Monument  Photographer: EHT Tracerics  Date: January 9, 2013
---	---

1. M 36-4-1_2013-01-09_01	Confederate Monument, Looking E
2. M 36-4-1_2013-01-09_02	Confederate Monument with Grace Episcopal Church and Parish Hall in background, Looking NE
3. M 36-4-1_2013-01-09_03	Cemetery, Looking SE
4. M 36-4-1_2013-01-09_04	Cemetery with Parish Hall in background, Looking N
5. M 36-4-1_2013-01-09_05	Cemetery, Looking NW

\*All photographs printed on Epson Ultra Premium Photo Paper with Epson Ultra Chrome K3 Ink.

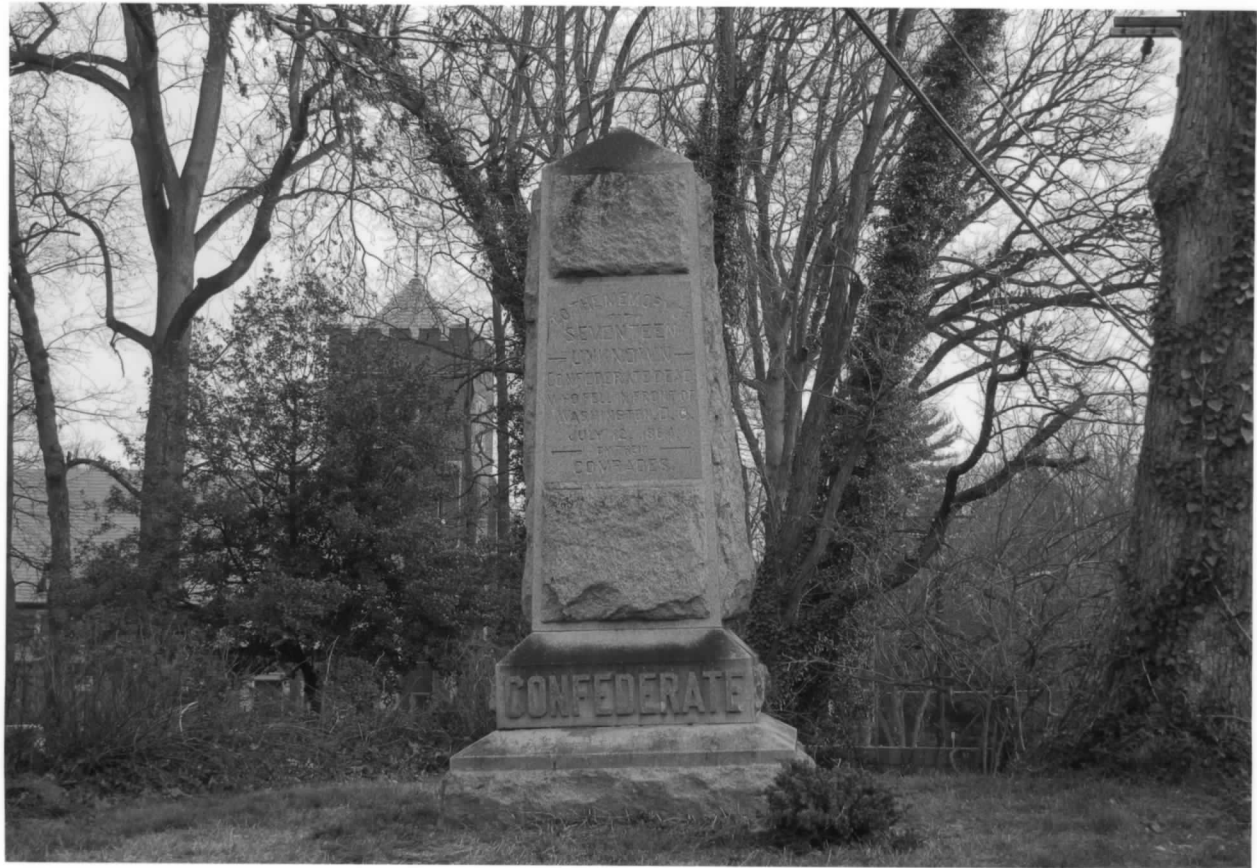

SACRED TO THE  
SEVENTH  
VIRGINIA  
CONFEDERATE  
INFANTRY  
WASHINGTON, D.C.  
JULY 21, 1864  
BY THE  
COMRADES

CONFEDERATE

M:36-4-1

GRACE EPISCOPAL CHURCH CEMETERY & CONFEDERATE MONUMENT  
GEORGIA AVENUE (MD47) AND GRACE CHURCH ROAD  
MONTGOMERY COUNTY, MD

EHT TRACERIES

1/2013

MD SHPO

VIEW OF CONFEDERATE MONUMENT, Looking E  
#1 of 5

M:36-4-1-2013-01-09-01.TIF





M: 36-4-1

GRACE EPISCOPAL CHURCH CEMETERY & CONFEDERATE MONUMENT  
GEORGIA AVENUE (MD 97) AND GRACE CHURCH ROAD  
MONTGOMERY COUNTY, MD

EHT TRACERIES

6/2013

MD SHPO

VIEW OF CONFEDERATE MONUMENT WITH GRACE EPISCOPAL  
CHURCH AND PARISH HALL IN BACKGROUND,  
LOOKING N

#2 OF 5

M 36-4-1-2013-01-09-02.TIF



M: 36-4-1

GRACE EPISCOPAL CHURCH CEMETERY & CONFEDERATE MONUMENT  
GEORGIA AVENUE (MD 97) AND GRACE CHURCH ROAD  
MONTGOMERY COUNTY, MD

EHT TRACERIES

1/2013

MD SHPO

VIEW OF CEMETERY, LOOKING SE

#3 OF 5

M 36-4-1\_2013-01-09\_03.TIF



M: 36-4-1

GRACE EPISCOPAL CHURCH CEMETERY & CONFEDERATE MONUMENT  
GEORGIA AVENUE (MD 97) AND GRACE CHURCH ROAD  
MONTGOMERY COUNTY, MD

EHT TRACERIES

1/2013

MDSHPO

VIEW OF CEMETERY WITH PARISH HALL IN BACKGROUND, LOOKING N  
#4 OF 5

M 36-4-1\_2013-01-09\_04.TIF





M 36-4-1

GRACE EPISCOPAL CHURCH CEMETERY & CONFEDERATE MONUMENT  
GEORGIA AVENUE (MD 97) AND GRACE CHURCH ROAD  
MONTGOMERY COUNTY, MD

EHT TRACERIES

11 2013

MDSHPO

VIEW OF CEMETERY, LOOKING NW

45 OF 5

M 36-4-1\_2013-01-09\_05.TIF

ACHS SUMMARY FORM

M:36-4-1  
(date entered 5-4-80)

1. Name: Grace Episcopal Church Cemetery/Confederate Monument

2. Planning Area/Site Number: 36/4      3. M-NCPPC Atlas Reference: Map 21  
Woodside H.D.      L-8

. Address: Georgia Avenue and Grace Church Road, Silver Spring

5. Classification Summary

Category <u>object</u>	Previous Survey Recording <u>M-NCPPC</u>
Ownership <u>private</u>	Title and Date: Inventory of Historical sites - 1976
Public Acquisition <u>N.A.</u>	
Status <u>occupied</u>	
Accessible <u>yes: unrestricted</u>	Federal <u>    </u> State <u>x</u> County <u>x</u> Local <u>    </u>
Present use <u>religious</u>	

6. Date: 7/12/1864

7. Original Owner:

8. Apparent Condition

a. excellent      b. altered      c. moved - 1898

9. Description: Monument in southwest corner of cemetery commemorates the common grave of 17 Confederates killed in battle in front of Ft. Stevens, D.C. July 10 or 11, 1864. Inscription:

To The Memory Of  
Seventeen  
-- Unknown --  
Confederate Dead  
Who Fell in Front Of  
Washington D.C.  
July 12, 1864  
-- By Their --  
Comrades

10. Significance: This is one of two known Civil War battlefield burial grounds in the County. On July 10, 1864, Confederate Gen. Jubal Early led his troops toward Washington by way of Urbana. On the 11th he advanced to Silver Spring and there engaged in a skirmish with Union soldiers, driving them into the fortifications surrounding Washington. On the 12th the Union rallied in a repeat skirmish, and the Confederates retreated.

The soldiers are believed to have died near the church. They were originally buried in a row near the entrance and moved to a single grave in 1898.

... Researcher and date researched: John M. Hardy - 5/79

12. Compiler: Peg Coleman

13. Date Compiled: 7/79

14. Designation Approval     

15. Acreage: 5,000 sq. ft.

MARYLAND HISTORICAL TRUST

M: 36/4/H  
 Woodside H.D.  
 MAGI#

INVENTORY FORM FOR STATE HISTORIC SITES SURVEY

**1 NAME**

HISTORIC Grace Episcopal Church Cemetery/Confederate Monument  
 AND/OR COMMON

**2 LOCATION**

STREET & NUMBER Georgia Avenue and Grace Church Road  
 CITY, TOWN Silver Spring VICINITY OF CONGRESSIONAL DISTRICT 8  
 STATE Maryland COUNTY Montgomery

**3 CLASSIFICATION**

CATEGORY	OWNERSHIP	STATUS	PRESENT USE
<input type="checkbox"/> DISTRICT	<input type="checkbox"/> PUBLIC	<input checked="" type="checkbox"/> OCCUPIED	<input type="checkbox"/> AGRICULTURE <input type="checkbox"/> MUSEUM
<input type="checkbox"/> BUILDING(S)	<input checked="" type="checkbox"/> PRIVATE	<input type="checkbox"/> UNOCCUPIED	<input type="checkbox"/> COMMERCIAL <input type="checkbox"/> PARK
<input type="checkbox"/> STRUCTURE	<input type="checkbox"/> BOTH	<input type="checkbox"/> WORK IN PROGRESS	<input type="checkbox"/> EDUCATIONAL <input type="checkbox"/> PRIVATE RESIDENCE
<input type="checkbox"/> SITE	<b>PUBLIC ACQUISITION</b>	<b>ACCESSIBLE</b>	<input type="checkbox"/> ENTERTAINMENT <input checked="" type="checkbox"/> RELIGIOUS
<input checked="" type="checkbox"/> OBJECT	<input type="checkbox"/> IN PROCESS	<input type="checkbox"/> YES: RESTRICTED	<input type="checkbox"/> GOVERNMENT <input type="checkbox"/> SCIENTIFIC
	<input type="checkbox"/> BEING CONSIDERED	<input checked="" type="checkbox"/> YES: UNRESTRICTED	<input type="checkbox"/> INDUSTRIAL <input type="checkbox"/> TRANSPORTATION
		<input type="checkbox"/> NO	<input type="checkbox"/> MILITARY <input type="checkbox"/> OTHER:

**4 OWNER OF PROPERTY**

NAME Grace Episcoapl Church Telephone #: 589-0321  
 STREET & NUMBER 1607 Grace Church Road  
 CITY, TOWN Silver Spring VICINITY OF STATE, zip code Maryland

**5 LOCATION OF LEGAL DESCRIPTION**

COURTHOUSE, LIBER #: 3502  
 REGISTRY OF DEEDS, ETC. Folio #: 7  
 STREET & NUMBER Montgomery County Courthouse  
 CITY, TOWN Rockville STATE Maryland 20850

**6 REPRESENTATION IN EXISTING SURVEYS**

TITLE M-NCPPC Inventory of Historical Sites  
 DATE 1976  FEDERAL  STATE  COUNTY  LOCAL  
 DEPOSITORY FOR SURVEY RECORDS Park Historian's Office  
 CITY, TOWN Rockville STATE Maryland 20855

M.36-4-1

**7 DESCRIPTION**

<b>CONDITION</b>		<b>CHECK ONE</b>		<b>CHECK ONE</b>	
<input checked="" type="checkbox"/> EXCELLENT	<input type="checkbox"/> DETERIORATED	<input type="checkbox"/> UNALTERED	<input type="checkbox"/> ORIGINAL SITE	<input checked="" type="checkbox"/> MOVED	DATE <u>1898</u>
<input type="checkbox"/> GOOD	<input type="checkbox"/> RUINS	<input checked="" type="checkbox"/> ALTERED			
<input type="checkbox"/> FAIR	<input type="checkbox"/> UNEXPOSED				

**DESCRIBE THE PRESENT AND ORIGINAL (IF KNOWN) PHYSICAL APPEARANCE**

Monument in southwest corner of cemetery commemorates the common grave of 17 Confederates killed in battle in front of Ft. Stevens, D.C. July 10 or 11, 1864. The inscription reads as follows:

To The Memory Of  
 Seventeen  
 -- Unknown --  
 Confederate Dead  
 Who Fell In Front Of  
 Washington D.C.  
 July 12, 1864  
 -- By Their --  
 Comrades

**CONTINUE ON SEPARATE SHEET IF NECESSARY**



# 8 SIGNIFICANCE

M.36-4-1

PERIOD:	AREAS OF SIGNIFICANCE -- CHECK AND JUSTIFY BELOW				
<input type="checkbox"/> PREHISTORIC	<input type="checkbox"/> ARCHEOLOGY-PREHISTORIC	<input type="checkbox"/> COMMUNITY PLANNING	<input type="checkbox"/> LANDSCAPE ARCHITECTURE	<input type="checkbox"/> RELIGION	
400-1499	<input type="checkbox"/> ARCHEOLOGY-HISTORIC	<input type="checkbox"/> CONSERVATION	<input type="checkbox"/> LAW	<input type="checkbox"/> SCIENCE	
<input type="checkbox"/> 1500-1599	<input type="checkbox"/> AGRICULTURE	<input type="checkbox"/> ECONOMICS	<input type="checkbox"/> LITERATURE	<input type="checkbox"/> SCULPTURE	
<input type="checkbox"/> 1600-1699	<input type="checkbox"/> ARCHITECTURE	<input type="checkbox"/> EDUCATION	<input checked="" type="checkbox"/> MILITARY	<input type="checkbox"/> SOCIAL/HUMANITARIAN	
<input type="checkbox"/> 1700-1799	<input type="checkbox"/> ART	<input type="checkbox"/> ENGINEERING	<input type="checkbox"/> MUSIC	<input type="checkbox"/> THEATER	
<input checked="" type="checkbox"/> 1800-1899	<input type="checkbox"/> COMMERCE	<input type="checkbox"/> EXPLORATION/SETTLEMENT	<input type="checkbox"/> PHILOSOPHY	<input type="checkbox"/> TRANSPORTATION	
<input type="checkbox"/> 1900-	<input type="checkbox"/> COMMUNICATIONS	<input type="checkbox"/> INDUSTRY	<input type="checkbox"/> POLITICS/GOVERNMENT	<input type="checkbox"/> OTHER (SPECIFY)	
		<input type="checkbox"/> INVENTION			

SPECIFIC DATES 7/12/1864

BUILDER/ARCHITECT

### STATEMENT OF SIGNIFICANCE

This is one of two **known** Civil War battlefield burial grounds in Montgomery County. After the battle of Monocacy on July 9, 1864 Gen. Jubal Early camped just south of the Monocacy River. On the morning of Sunday the 10th, the Confederates marched toward Washington by way of Urbana to camp just short of Rockville. On the 11th Early advanced to Silver Spring, on the Seventh Street turnpike where he engaged Union skirmishers and drove them into the fortifications surrounding Washington. The 12th was spent in front of Washington, and Rodes' division had a heavy skirmish with the Federals in the afternoon on the Seventh Street turnpike in front of Early's Silver Spring headquarters.

The night the Confederates retreated, reaching Rockville at daylight on the 13th.

The bodies were originally buried in a row near the entrance to the church. However, in 1898 the Street Railway Company asked the church for a right-of-way for trolley tracks. In response, the church moved these soldiers' remains and re-buried them in a single grave at the southwest corner of the cemetery. A memorial monument was placed over the grave.

The soldiers are believed to have died at either Admiral Lee's Place (in Silver Spring), Glenmont (north of the church), or Osborn Farm (just north of Ft. Stevens). Ft. Stevens is about 2½ miles south of Grace Church; the Confederate lines were about at the main gate of Walter Reed Hospital. The lines stretched for a mile to the left and a mile to the right of the Seventh Street Road (Georgia Ave.) confronting Forts Reno, Stevens and De Russy.

CONTINUE ON SEPARATE SHEET IF NECESSARY

**9 MAJOR BIBLIOGRAPHICAL REFERENCES**

Getty, Mildred Newhold; "Grace Episcoapl Church Cemetery, 1957", Vestry minutes of the time.

Foote, Shelby; The Civil War, Random House, 1958.

CONTINUE ON SEPARATE SHEET IF NECESSARY

**10 GEOGRAPHICAL DATA**

ACREAGE OF NOMINATED PROPERTY 5,000 sq. ft.

VERBAL BOUNDARY DESCRIPTION

Bounded on the west by Georgia Ave., on the south by Grace Church Rd. On the east by Church building and on the north by Grace Church School building.

LIST ALL STATES AND COUNTIES FOR PROPERTIES OVERLAPPING STATE OR COUNTY BOUNDARIES

STATE	COUNTY
STATE	COUNTY

**11 FORM PREPARED BY**

NAME / TITLE

John M. Hardy

ORGANIZATION

Sugarloaf Regional Trails

DATE

5/79

STREET & NUMBER

Box 87

TELEPHONE

926-4510

CITY OR TOWN

Dickerson

STATE

Maryland 20753

The Maryland Historic Sites Inventory was officially created by an Act of the Maryland Legislature, to be found in the Annotated Code of Maryland, Article 41, Section 181 KA, 1974 Supplement.

The Survey and Inventory are being prepared for information and record purposes only and do not constitute any infringement of individual property rights.

RETURN TO: Maryland Historical Trust  
The Shaw House, 21 State Circle  
Annapolis, Maryland 21401  
(301) 267-1438



Montgomery citizens did not forget their Southern bonds. Years after the end of the war, local citizens built a memorial to the Confederate soldiers who had died July 12, 1864, in a skirmish near Silver Spring. Photograph by Dr. Leonard Tuchin

Sandy Spring's Fair Hill School was held in the building pictured. Before and after the school's use of the building, it was a dwelling. Richard Brooke, a Quaker who fought in the Revolutionary War against the pacifistic principles of his religion, constructed the building. Later Whitson Canby, a member of another well-known Quaker family, purchased the house for eight Irish families. The commune manufactured pots and sold their wares at the markets of Mechanicsville (now Olney).

The Baltimore Yearly Meeting, in association with Sandy Spring Friends Meeting, purchased the building in 1815 and later opened

Fair Hill School, where Benjamin Hollowell taught. It remained a school under various names from 1819 until 1865, when Civil War activity closed it.

During the Civil War, troops from both sides crossed the schoolyard, including those of generals Johnson, Burnside, and Hooker. Confederate General J. E. B. Stuart reportedly brought to the girls' school thousands of his troops who stole horses, bivouacked in the fields, burned the fence rails, and dug up four acres of potatoes! Understandably, the girls were terrified. Teacher Mary Coffin hid valuables under the hearth in a box the same size as the bricks. As a result of the invasion, parents withdrew their daughters, and Fair Hill School closed.

A series of private owners lived at Fair Hill until it burned down in the 1970s. This photograph was taken about 1900. Fair Hill's lot is now the site of the Village Mall Shopping Center in Olney. Courtesy of Roger Lamborne

