

123  
PLEASANT VIEW UMC CEMETERY  
11810 DARNESTOWN ROAD  
GALITHERSBURG

# Montgomery County Cemetery Inventory

ID: 123

Name: Pleasant View UMC Cemetery

Alternate name: Mt. of Olives Church

Address: Darnestown Road near ~~Quince Orchard Rd.~~  
11810 <sup>^</sup> AMBANCE DRIVE

Town: GALITHERSBURG

ADC Map Page 27 Grid H-1

Type (METHODIST EPISCOPAL)  
 Religious MT. OF OLIVES CHURCH  
 Family \_\_\_\_\_  
 Private \_\_\_\_\_  
 Other \_\_\_\_\_

Association  
 Free black  
 Enslaved  
 Ethnic \_\_\_\_\_  
 Prehistoric \_\_\_\_\_

Setting  Rural  Urban  Suburban  Forested  Other \_\_\_\_\_

Condition  Excellent  Good  Fair  Poor

Negative Impacts (vandalism, dumping, neglect, encroachment, etc) \_\_\_\_\_  
NONE, WELL MAINTAINED

Approximate no. of burials 70+ Date range of burials 1890-2004 (PRESENT)

Description (markers, materials, arrangement, landscaping, fence, paths and roads, etc.)

SEE ATTACHED  
WRITE-UP FOR  
ADDITIONAL DESCRIPTION.

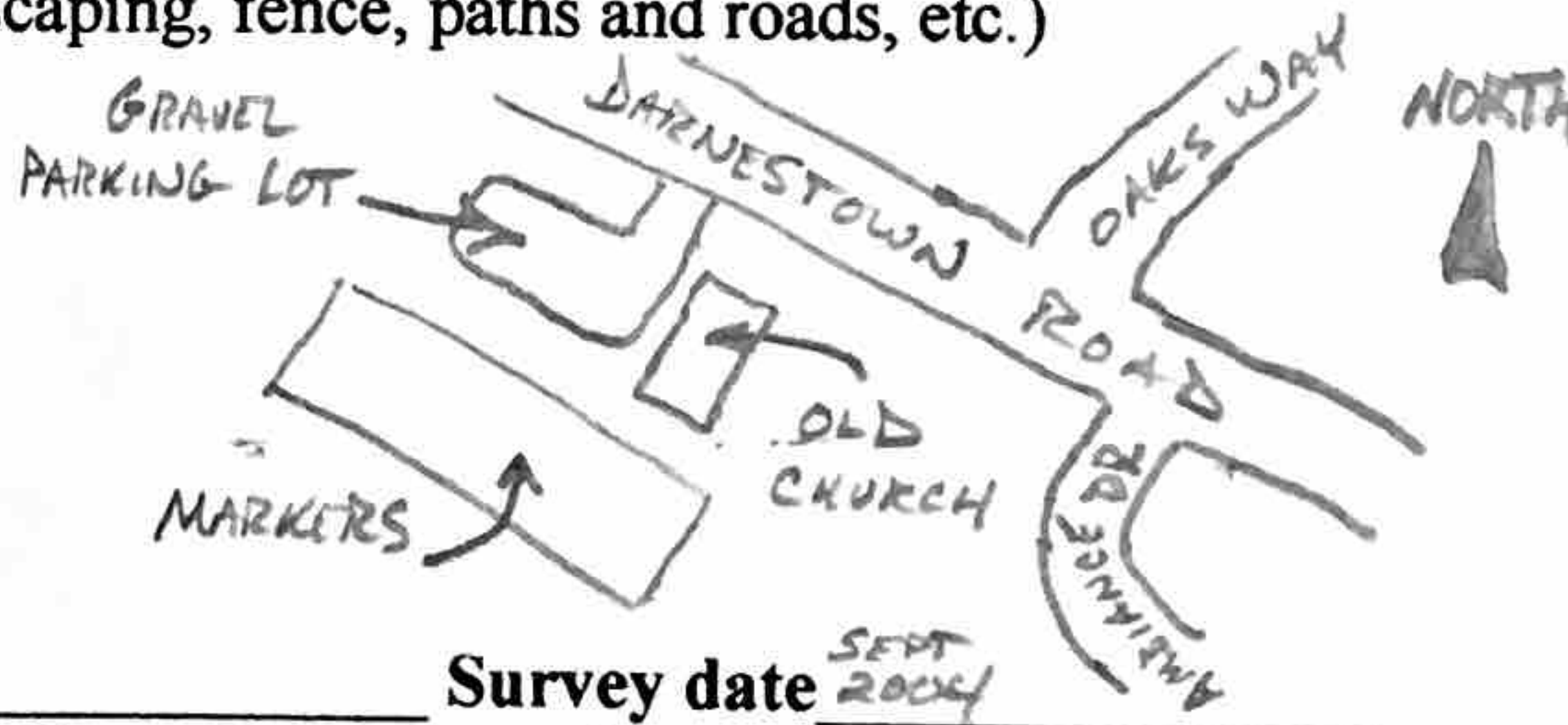

Surveyor(s) CARL PETERSON

Survey date SEPT 2004

Photographer CARL PETERSON

Date SEPT 2004 Photo no. 123-001 thru 123-006

Current owner \_\_\_\_\_  
Address/Phone No. \_\_\_\_\_

Historic Status  Locational Atlas ID \_\_\_\_\_  National Register  
 Master Plan ID \_\_\_\_\_  Other \_\_\_\_\_

UTM 18S 0305920 UTM 4331870

Additional sources of information:



**PLEASANT VIEW UNITED METHODIST CHURCH CEMETERY AT QUINCE ORCHARD (PLEASANT VIEW METHODIST EPISCOPAL CHURCH, MOUNT OF OLIVES CHURCH)**

Directions: Route 28 West, near Quince Orchard. [A.D.C. Map: Montgomery, page 22, grid coordinates H-10.] Condition of cemetery: Well kept. Active cemetery. Earliest known death: 1890. Most recent death: Present. Veterans interred: WWII Vets. In 1937, no vital record books located only a current list of members existed. Date transcribed: 1990. Location of transcribed records: Montgomery County Historical Society Library, 42 West Middle Lane, Rockville, Maryland 20850. Comments: Over 63 marked graves, church organized in 1888.

W 77°15'00" 730,000 FT 11 NW MAP 27

123  
PLEASANT VIEW UMC CEMETERY  
11810 DARNESTOWN ROAD  
GAITHERSBURG

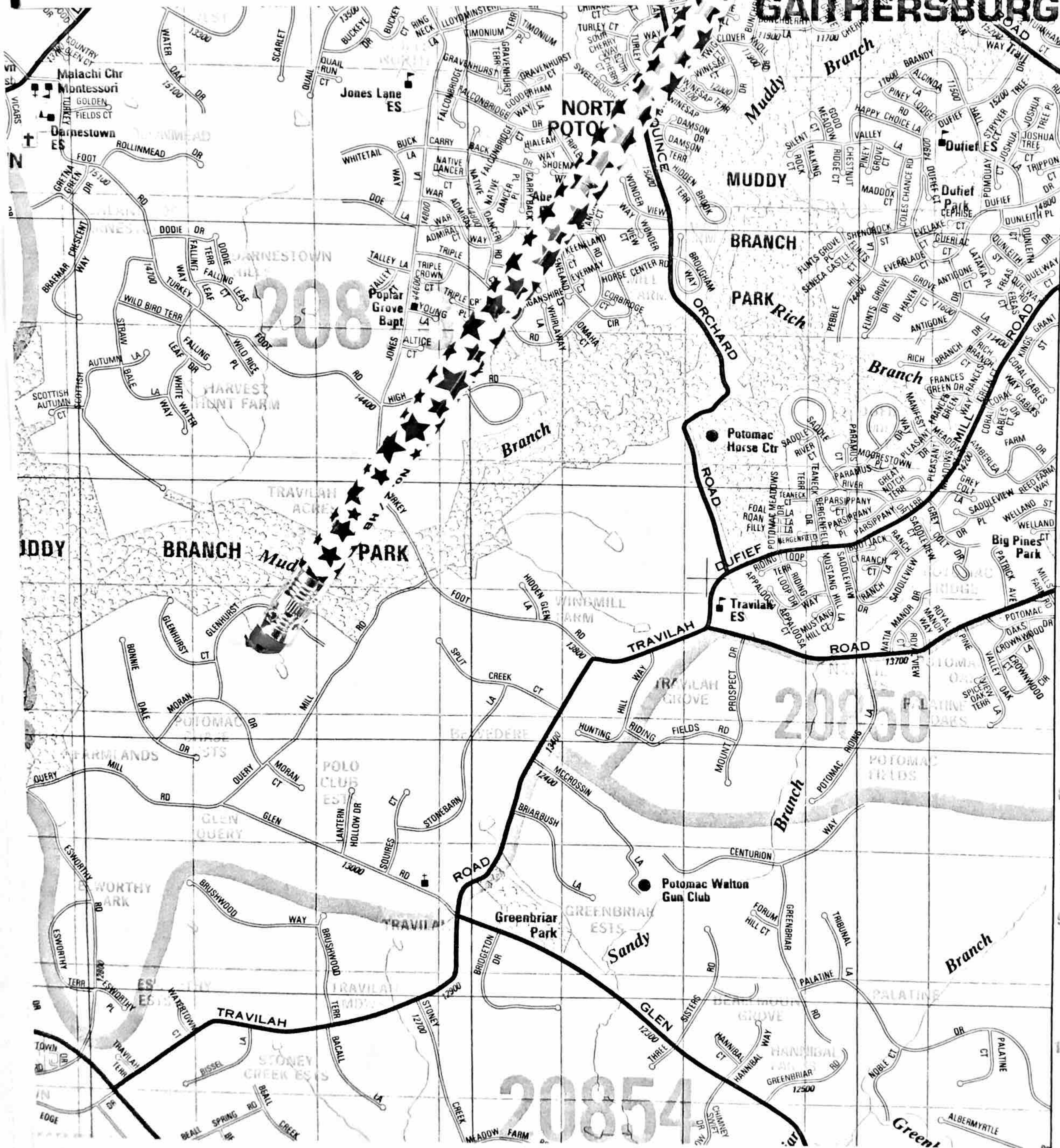

221 NW  
220 NW  
460,000 FT  
219 NW  
218 NW  
39°05'00"  
Joins Map 28  
217 NW  
MD GRID 450,000 FT  
216 NW



**Cemetery Description:**

**PLEASANT VIEW  
ID # 123**

Small cemetery located behind old church (Mt. of Olives) on Pleasant View Historical Site, 11810 Darnestown Road, just east of Ambiance Drive intersection. Parking is available in gravel lot beside church. Active cemetery—burial dates range from 1890 to 2004. Markers are scattered throughout well-maintained, rectangular grassy field. No paths. Chain-link fence is located along back border.

123  
PLEASANT VIEW UMC CEMETERY  
11810 DARNESTOWN ROAD  
GAITHERSBURG







123  
PLEASANT VIEW UMC CEMETERY  
11810 DARNESTOWN ROAD  
GAITHERSBURG



123-001.JPG



123-002.JPG



123-003.JPG



123-004.JPG



123-005.JPG



123-006.JPG