

Saint Mark's United Methodist Church

19620 White Ground Road, Boyds, 20841

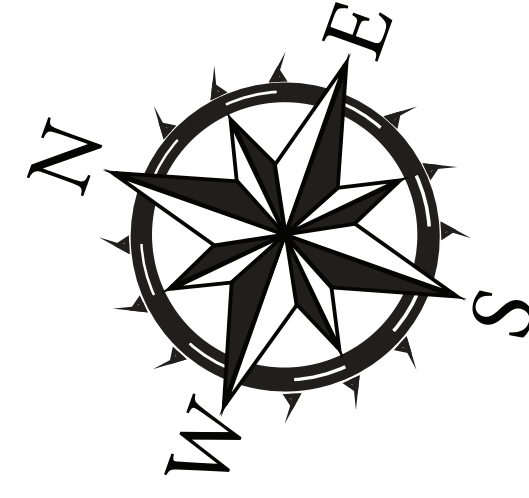

Group of Sites
Location is Unknown

1	2	3	4	5	6	7	8	9	10	11	12	13	14	15	16	17	18	19	20	21	22	23	24	25	26	27	28	29	30	31	32	33	34	35	36	37	38	39	40	41	42	43	44	45	46	47	48	49	50	51	52	53	54	55	56	57	58	59	60	61	62	63	64	65	66	67	68	69	70	71	72	73	74	75	76	77	78	79	80	81	82	83	84	85	86	87	88	89	90	91	92	93	94	95	96	97	98	99	100
---	---	---	---	---	---	---	---	---	----	----	----	----	----	----	----	----	----	----	----	----	----	----	----	----	----	----	----	----	----	----	----	----	----	----	----	----	----	----	----	----	----	----	----	----	----	----	----	----	----	----	----	----	----	----	----	----	----	----	----	----	----	----	----	----	----	----	----	----	----	----	----	----	----	----	----	----	----	----	----	----	----	----	----	----	----	----	----	----	----	----	----	----	----	----	----	----	----	----	-----

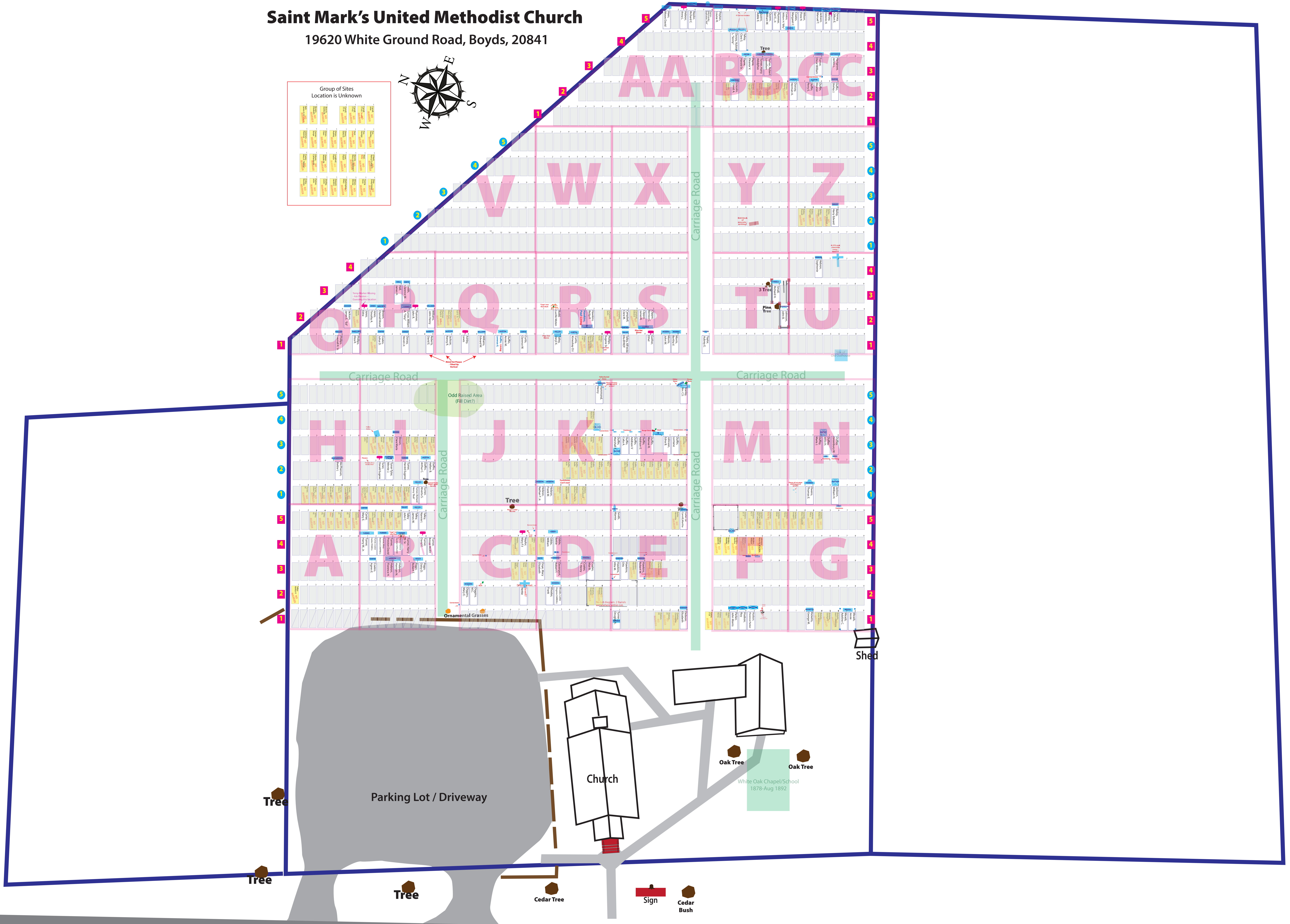

White Ground Road

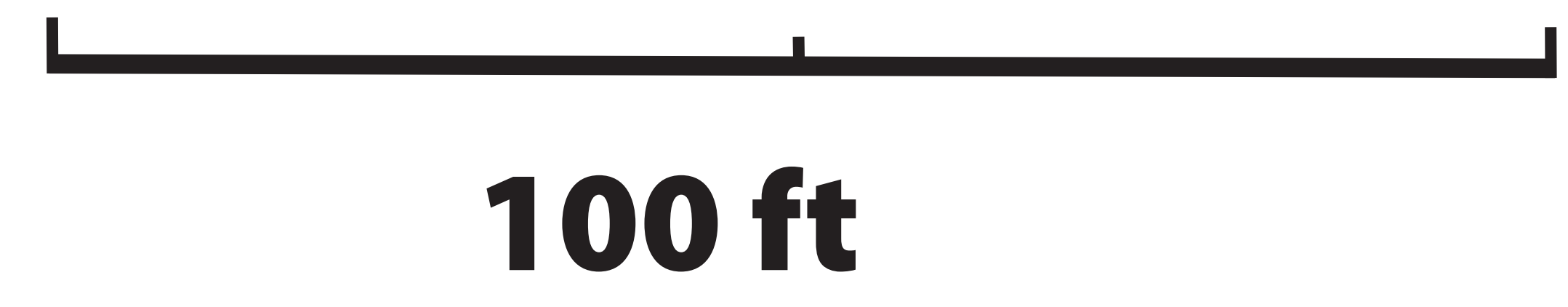

Note: There were MANY names of people buried at St. Mark's, found in 3 or 4 lists made by Nanette Hunter's mother. Her mother had gone several local Funeral Homes and gathered names and dates (but not site location) of the people they buried at St. Mark's. That would include Snowden Funeral Home, Gardner Funeral Home and Hilton Funeral Home. Some of their burial sites are known, but not many. These some of these names are in a box outside the boundary of the cemetery - and others, if they had family names of those already buried at St. Mark's, I placed them AS A GUESS, near their family members - to give a clue to the church members who are still living, and hopefully Nanette will record the members responses as to the REAL burial site location. The boxes have a yellowish tint and NO MARKER on them. Please keep in mind - this map is a work in progress. - ACAllnutt

Map not drawn to scale.