

Montgomery County Cemetery Inventory

ID: 144

Name: Seal Family Cemetery

Alternate name:

Address: ~~on farm off Damascus Road.~~
~~Stone Drive 2 mi. off Damascus Rd.~~

Town: Etchison

between 5210
5520 Damascus
Road

ADC Map Page 11 Grid J-5

Type

Religious
 Family Seal
 Private
 Other

Association

Free black
 Enslaved
 Ethnic
 Prehistoric

Setting Rural Urban Suburban Forested Other

Condition Excellent Good Fair Poor

Negative Impacts (vandalism, dumping, neglect, encroachment, etc) ~~plastic flowers and~~
~~some dumping plastic flower pots thrown in woods around cemetery~~

Approximate no. of burials 75 Date range of burials 1938 - probably 2004

Description (markers, materials, arrangement, landscaping, fence, paths and roads, etc.) ~~covered stones~~

located 2 miles from Damascus Road
~~Driving up gravel driveway through 2 beautiful~~
~~kept farm fields. ~~was cany area~~ depress~~
~~small plot of about 3 graves placed on edge~~
~~of field like a boundary marker so farmer who has farmed~~

Surveyor(s) Amanda and Janet Becker Survey date 3/8/2004

Photographer CARL PETERSON Date Nov 2004 Photo no. 144-01 thru 144-06

Current owner

Address/Phone No.

Historic Status

Locational Atlas ID

National Register

Master Plan ID

Other

UTM 18 S 0317762 UTM 4345411

Additional sources of information:

144
SEAL FAMILY CEMETERY
BETWEEN 5210 & 5520 DAMASCUS RD.
ETCHISON

~~cleans up - nobody ?? - ^{EdH} Attract vandals and
more trash because of ~~can~~ neglectful upkeep
of trash.~~

~~longer than cemetery has been there won't "encroach"
then about turning right and following the
road their is more lush fields and on~~
top of a small rise by the edge of the
woods. ~~at the end of~~ ~~of~~ ~~grave stones,~~ ^{Cemetery} ^{Approximately} ^{1 1/2 acres}
with 2 walnut trees, ~~and~~ 1 locust tree, and
bushes ~~are in the cemetery.~~ Oldest stones
closest to forest. Granite, black granite, few
marbles, metal tablet (from funeral home) and
flat markers are in this folksy cemetery.
3 grave ^{markers} ~~are~~ located separately - about 100 yards south
of other graves.

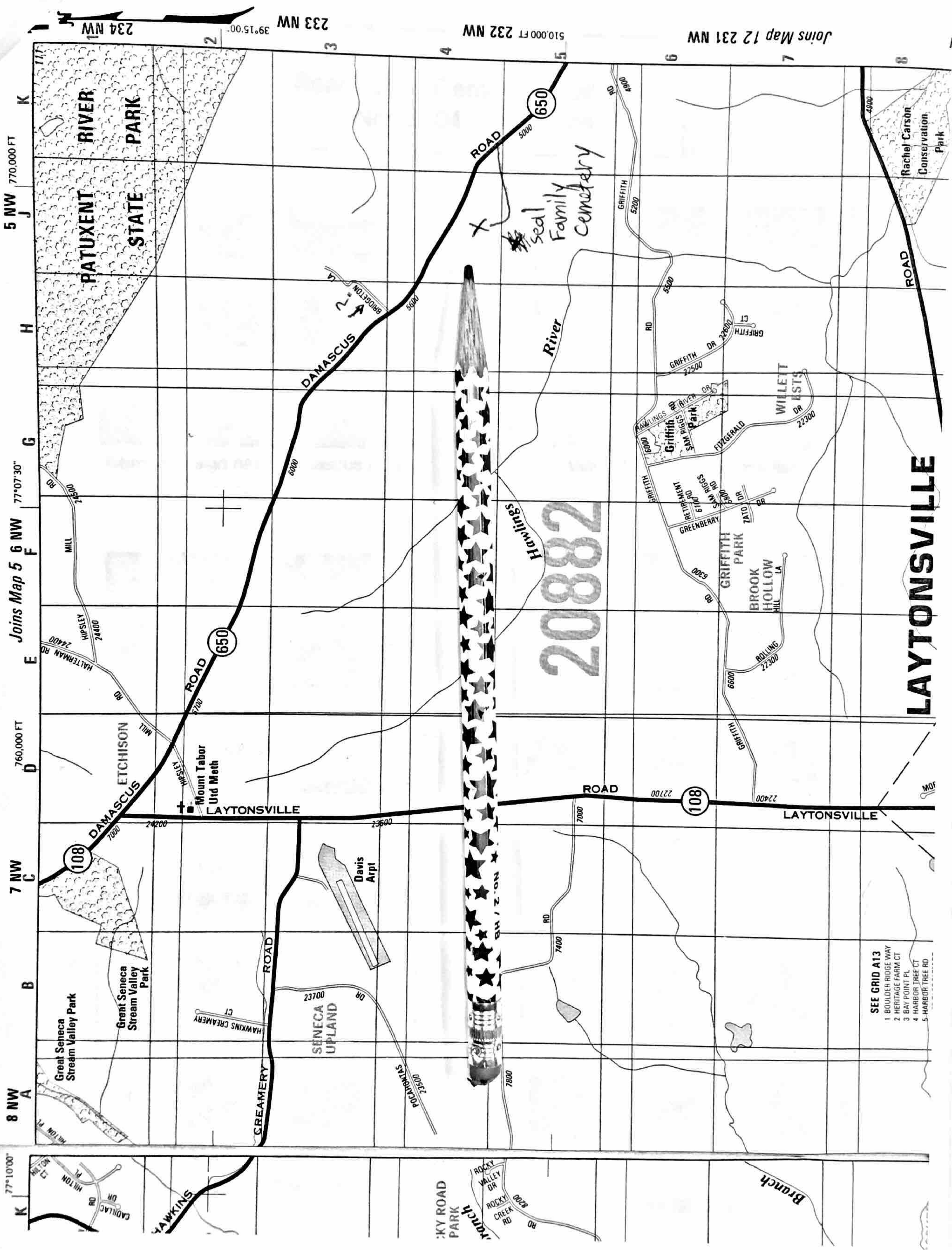

77° 10'00" 77° 07'30" 77° 07'30" 77° 07'30"

8 NW 7 NW 7 NW 5 NW

K J H G F E D C B A

510,000 FT 232 NW 233 NW 234 NW

770,000 FT 760,000 FT

144 SEAL FAMILY CEMETERY
 BETWEEN 5210 & 5520 DAMASCUS RD.
 ETCHISON

- SEE GRID A13
- 1 BOULDER RIDGE WAY
 - 2 HERITAGE FARM CT
 - 3 BAY POINT PL
 - 4 HARBOR TREE CT
 - 5 HARBOR TREE RD

PHOTO LOG
Seal Family Cemetery (ID# 144)
Nov 2004 - 6 photos



Cemetery sign near Damascus Road
144-01.JPG



View of cemetery across field,
looking northwest
144-02.JPG



Main cemetery, looking north
144-03.JPG



"Mathis" and "Seal" markers
144-04.JPG



More "Mathis" and Seal" markers
144-05.JPG



Three "Seal" markers located about
100 yards south of main cemetery
144-06.JPG

144
SEAL FAMILY CEMETERY
BETWEEN 5210 & 5520 DAMASCUS RD.
ETCHISON

find on map p 1

SEAL'S FARM CEM

(all OK)

MARYLAND CEMETERY DIRECTORY HEADINGS

County: *Montgomery*

Type of Cemetery: *Private, but not operated as a business.*

Name of Cemetery: *Seal's Farm Cemetery (about 5700 block) nr. Etchison*

Location of Cemetery: *on farm off Damascus Rd.*

Contact: *Seal*

Condition/Description of Cemetery: *not neglected, but not well-cared for.*

Number of Graves: *marked - 55
unmarked - 12*

Oldest Grave Marker: *1946 - but, ^{at least} two unmarked burials were made before this*

Span of Usage: *c 1946 to present*

Inscriptions Transcribed: *yes*

Date Transcribed: *June 1982 by Lovie Melton*

Transcribed Records Located: *MCHS, Janet Manuel*

Transcribed Records Published:

Comments: *Cemetery started by Abijah and Amanda Seal in the mid-1940's. Must be born in Tennessee to be buried there, (or descendant of a Tennessee family connected with this cem.)
Was established because the Seal family saw a need among Tennessee families in the community.*

144
SEAL FAMILY CEMETERY
BETWEEN 5210 & 5520 DAMASCUS RD.
ETCHISON