

WINTER

Return for dig. photos + address.

MONTGOMERY COUNTY CEMETERY INVENTORY

Name: <sup>Trinity United Methodist Church Cem.</sup> Leaman Family Cemetery ID: Not on Inventory? 147  
 Alternate Name: <sup>Trinity Methodist Episcopal Church Cem.</sup>  
 Address: <sup>left right</sup> side of Clopper Road / near intersection with 118<sup>th</sup> SE corner  
 Town: <sup>quarry north</sup> Germantown

ADC Map Page 18 / C - 5

Type: ~~Family~~ Church

Setting: Suburban

Condition: Poor

Negative Impacts: Cemetery is under the care of the <sup>Trinity United</sup> Methodist church directly across Clopper Road (?), but is very overgrown/is not being maintained. The cemetery is wedged between the back of a baseball field and Clopper Road (?).

Approximate Number of Burials: 7-8?

Date Range of Burials:

Description: There are three large headstones that have been pushed off of their bases (Solomon, Mary Appleby, and Metz). There are 4 or 5 small markers in the western portion that may be marking children's graves. This area is VERY overgrown and required assistance by a family member to find and expose the most prominent markers. There were two benches in the cemetery.

Surveyors: Nancy Kassner and Kari Grabinski  
Photographer: Nancy Kassner Date: 6/14/04

Survey Date: 6/13/04  
Photo No:

Current owner: <sup>contact: Rebecca Leaman</sup>  
Address/Phone Number: ~~REDACTED~~ <sup>moved out of area phone</sup> <sup>her request</sup> <sup>did not by August 2014</sup>

|                 |                     |                   |
|-----------------|---------------------|-------------------|
| Historic Status | Locational Atlas ID | National Register |
|                 | Master Plan ID      | Other             |

UTM

Additional Sources of Information:

According to Rebecca Leaman, who lives across street + whose family is buried here, the church is supposed to take care of the cemetery. Ownership is unclear.

147 TRINITY UNITED METHODIST CHURCH CEMETERY CLOPPER ROAD / GERMAN TOWN ROAD GERMAN TOWN

Trinity Meth Ch. - old location - EST 1866  
(M.E.)

Mary J. Appleby 25 Dec 1846 - 3 Sep 1889

Own mother

Salomon Keaman 17 Mar 1805 - 30 Oct 1877

Husband & father

M. E. M. (Mary E. Metz 16 Sep 1814 - 20 Jul 1879)  
Scharf

C. J. Keaman 5 Oct 1832 - 19 Mar 1896

C. is correct

Martha J. d/o G. T. and M. W. Keaman

(DAR has Martha Jane) d 17 Jul 1876 3 y 9 m Scharf

GAITHERSBURG  
**Marriott**  
WASHINGTONIAN CENTER

Trinity U.M. Church

Fence around it  
Clean up cemetery

Nathaniel Pauley -

301-972-0432

BS Troop 1325 Trinity UMC

Called Susan Soderberg 2/07 who  
gave him EMG's number -

2/26/07 - He's working on his Eagle Scout  
I gave him Linda Tyler's # and  
called Linda to give her his.

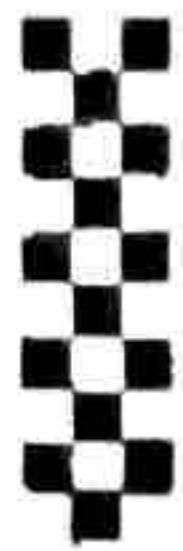

FAX TO ANNE BROCKETT  
202-741-5246

### FAX COVER SHEET

|   |  |
|---|--|
| <b>SEND TO:</b><br>Eileen McGuckian, Executive Director<br>Peerless Rockville | <b>FROM:</b><br>Linda M. Tyler<br>18943 Highstream<br>Germantown, Maryland 20874 |
| <b>ATTENTION:</b>   | <b>DATE:</b> November 27, 2006   |
| <b>PHONE:</b> 301 762-0096  | <b>PHONE:</b> (301) 528-0802   |
| <b>FAX:</b> 301 762-0961  | <b>SUBJECT:</b><br>Historic Cemetery Badly Neglected                             |

Total Pages 5 (including cover sheet)

Comments:  
Dear Ms. McGuckian,

I have found a cemetery lot in Germantown that is badly neglected. It is located at the intersection of Germantown Road Rt. 118 and Clopper Road Rt. 117. I received some information from the Maryland Department of Assessments and Taxation that may help to identify the location that I am researching and I am forwarding it to you. I also spoke with Trinity United Methodist Church which is located across the street from the cemetery and they said they sold the property but they don't know who they sold it to. Please call me and let me know how we can get this cemetery cleaned up. This is sacred land and should be protected from neglect.

Thank you.

Sincerely,  
*Linda Tyler*  
Linda Tyler

147 TRINITY UNITED METHODIST CHURCH CAMPUS,  
CLOPPER ROAD/GERMANTOWN ROAD  
GERMANTOWN

Real Property Search - Individual Report

**Maryland Department of Assessments and Taxation**  
**Montgomery County**  
**Real Property Data Search**

Account Identifier: District - 02 Account Number - 01648322

**Owner Information**

Owner Name: TRINITY METHODIST EPISCOPAL Use: EXEMPT  
 Mailing Address: CHURCH TRUSTEES Principal Residence: NO  
 % R CARLETON BROWNING Deed Reference: 1)  
 GERMANTOWN MD 20874 2)

**Location & Structure Information**

Premises Address  
 CLOPPER RD

*Cemetery Lot*

Legal Description  
 TD 24-410 CEM LT 2ND  
 RES ON FRIEND IN NEED

| Map  | Grid | Parcel | Sub-District | Subdivision | Section | Block | Lot | Assessment Area | Plat No:<br>Plat Ref: |
|------|------|--------|--------------|-------------|---------|-------|-----|-----------------|-----------------------|
| ET33 |      | P052   |              | 1           |         |       |     | 1               |                       |

| Special Tax Areas | Town<br>Ad Valorem<br>Tax Class |
|-------------------|---------------------------------|
|                   | 42                              |

| Primary Structure Built | Enclosed Area | Property Land Area | County Use |
|-------------------------|---------------|--------------------|------------|
| 0000                    |               | 13,939.00 SF       | 691        |

| Stories | Basement | Type | Exterior |
|---------|----------|------|----------|
|         |          |      |          |

**Value Information**

|                    | Base Value | Value As Of 01/01/2004 | Phase-in Assessments As Of 07/01/2006 | As Of 07/01/2007 |
|--------------------|------------|------------------------|---------------------------------------|------------------|
| Land:              | 3,480      | 3,480                  |                                       |                  |
| Improvements:      | 0          | 0                      |                                       |                  |
| Total:             | 3,480      | 3,480                  | 3,480                                 | NOT AVAIL        |
| Preferential Land: | 0          | 0                      | 0                                     | NOT AVAIL        |

**Transfer Information**

|         |        |        |
|---------|--------|--------|
| Seller: | Date:  | Price: |
| Type:   | Deed1: | Deed2: |
| Seller: | Date:  | Price: |
| Type:   | Deed1: | Deed2: |
| Seller: | Date:  | Price: |
| Type:   | Deed1: | Deed2: |

**Exemption Information**

| Partial Exempt Assessments | Class | 07/01/2006 | 07/01/2007 |
|----------------------------|-------|------------|------------|
| County                     | 000   | 0          | 0          |
| State                      | 000   | 0          | 0          |
| Municipal                  | 000   | 0          | 0          |

Tax Exempt: COUNTY AND STATE  
 Exempt Class: CEMETERIES (CHURCH)

Special Tax Recapture:  
 \* NONE \*

147 TRINITY METHODIST CHURCH CEMETERY  
 CLOPPER ROAD/GERMANTOWN ROAD  
 GERMANTOWN

Real Property Search - Individual Report

**Maryland Department of Assessments and Taxation  
Montgomery County  
Real Property Data Search**

Account Identifier: District - 02 Account Number - 00022963

**Owner Information**

Owner Name: MONTGOMERY COUNTY Use: EXEMPT COMMERCIAL  
Principal Residence: NO  
Mailing Address: 101 MONROE ST Deed Reference: 1) /10589/ 463  
ROCKVILLE MD 20850 2)

**Location & Structure Information**

Premises Address: CLOPPER RD Legal Description: FRIEND IN NEED

| Map  | Grid | Parcel | Sub-District | Subdivision | Section | Block | Lot | Assessment Area | Plat No:  |
|------|------|--------|--------------|-------------|---------|-------|-----|-----------------|-----------|
| ET33 |      | P003   |              | 1           |         |       |     | 2               | Plat Ref. |

| Special Tax Areas       | Town Ad Valorem Tax Class | Enclosed Area | Property Land Area | County Use |
|-------------------------|---------------------------|---------------|--------------------|------------|
| Primary Structure Built | 42                        |               | 1,208.00 SF        | 910        |
| 0000                    |                           |               |                    |            |
| Stories                 | Basement                  | Type          | Exterior           |            |

**Value Information**

|                    | Base Value | Phase-in Assessments   |                  |                  |
|--------------------|------------|------------------------|------------------|------------------|
|                    |            | Value As Of 01/01/2005 | As Of 07/01/2006 | As Of 07/01/2007 |
| Land:              | 100        | 100                    |                  |                  |
| Improvements:      | 0          | 0                      |                  |                  |
| Total:             | 100        | 100                    | 100              | 100              |
| Preferential Land: | 0          | 0                      | 0                | 0                |

**Transfer Information**

|                            |             |           |
|----------------------------|-------------|-----------|
| Seller:                    | Date:       | Price:    |
| Type: IMPROVED ARMS-LENGTH | 08/21/1992  | \$349,483 |
| Seller:                    | Deed1:      | Deed2:    |
|                            | /10589/ 463 |           |
| Seller:                    | Date:       | Price:    |
| Type:                      | Deed1:      | Deed2:    |
| Seller:                    | Date:       | Price:    |
| Type:                      | Deed1:      | Deed2:    |

**Exemption Information**

| Partial Exempt Assessments | Class | 07/01/2006 | 07/01/2007 |
|----------------------------|-------|------------|------------|
| County                     | 000   | 0          | 0          |
| State                      | 000   | 0          | 0          |
| Municipal                  | 000   | 0          | 0          |

Tax Exempt: COUNTY AND STATE Special Tax Recapture:  
Exempt Class: OTHER \* NONE \*

147 TRINITY METHODIST CHURCH CENTER  
CLOPPER ROAD/GERMANTOWN ROAD  
GERMANTOWN

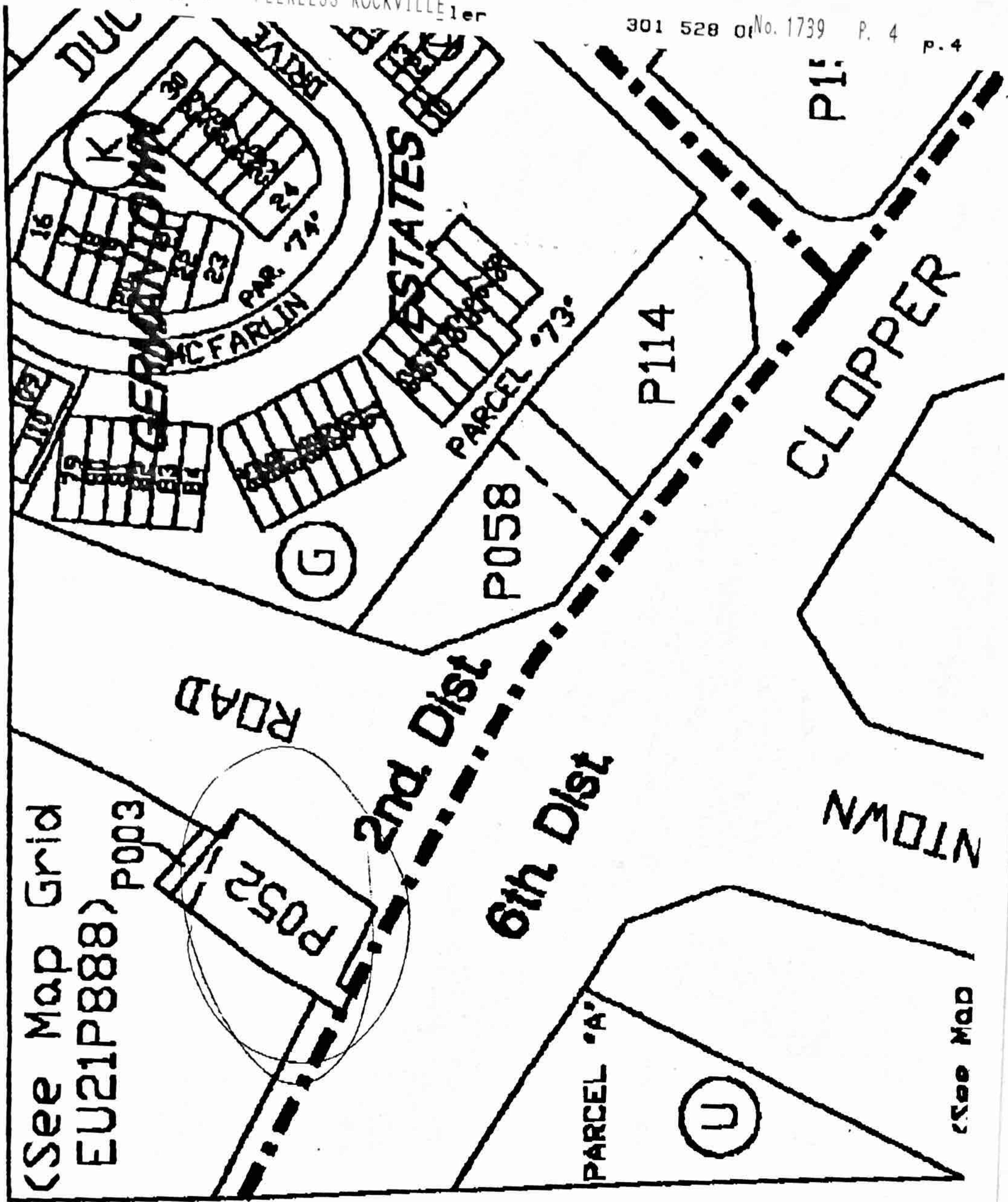

(See Map Grid EU21P888)

(See Map

147 TRINITY METHODIST CHURCH CEMETERY  
CLOPPER ROAD / GERMAN TOWN ROAD  
GERMAN TOWN

Trinity Cemetery, Montgomery Co.

# Trinity United Methodist Church

Northeast corner of Rte. 118 (Germantown Rd) & Rte. 117 (Clopper Road)

Germantown, Montgomery Co., MD

Historic Cemetery Established 1866  
Originally Restored by Ben Mulholland Eagle Scout Troop 1760 in 1985.  
Badly neglected, overgrown and vandalized.

| NAME  | DATE OF BIRTH | DATE OF DEATH                         | INSCRIPTION/NOTES/SHARES STONE  |
|---|---------------|---------------------------------------|---|
| APPLEBY, Mary J.  | 25 Dec 1846   | 03 Sep 1889                           | In Memory Of .. Our Mother<br>Second view of stone & destruction        |
| LEAMAN, Solomon   | 12 Mar 1805   | 30 Oct 1877                           | In Memory of ... Husband & Father /<br>Heaven .. till we meet again ... |
| LEAMAN, C.T.  | Dec 18_2      | Mar 18_6                              | My Husband / Remainder illegible  |
| UNKNOWN   |               |                                       | Appears to be a handmade/handwritten<br>concrete stone                  |
| Photographs showing cemetery destruction, neglect, overgrowth and vandalism |               |                                       |   |
| HISTORIC RESTORATION SIGN   |               | VIEW OF CEMETERY WITH BENCHES         |   |
| TOMBSTONE DESTRUCTION & OVERGROWTH #1                                       |               | TOMBSTONE DESTRUCTION & OVERGROWTH #2 |   |
| TOMBSTONE DESTRUCTION & OVERGROWTH #3                                       |               | TOMBSTONE & PROPERTY OVERGROWTH       |   |
| CEMETERY OVERGROWTH AND NEGLECT   |               | CEMETERY OVERGROWTH AND NEGLECT       |   |
| CEMETERY OVERGROWTH AND NEGLECT   |               | OVERVIEW OF CEMETERY                  |   |

147 TRINITY UNITED METHODIST CHURCH CEMETERY  
CLOPPER ROAD / GERMANTOWN ROAD  
GERMANTOWN

Made available to The USGENWEB Archives by: Donna Guiffre (guiffre@gmail.com)

For inquiries about this or any MD cemetery, burials or to submit a transcription to this Project please contact the MD Tombstone Transcription Project Manager: Kathi Jones-Hudson  
[mdcemmy@yahoo.com](mailto:mdcemmy@yahoo.com)



This page was last updated December 23, 2004  
Copyright © 1997-2005 USGenWeb Tombstone Project & Kathi Jones-Hudson