

MONTGOMERY COUNTY CEMETERY INVENTORY

Survey ID _____

Cemetery name Burdett - Gue Family Cemetery

Alternate name(s) _____

Address (or direction from nearest intersection) 27100 Purdum Road

ADC Map Page 3 Grid J-6 Town West of Damascus

Type
 Religious
 Family
 Private
 Other

Association
 Free black
 Enslaved
 Ethnic
 Prehistoric

Setting Rural Urban Suburban Forested Other

Condition Excellent Good Fair Poor

Negative Impacts (vandalism, dumping, neglect, encroachment, etc)
Extensive overgrowth, cut trees dumped here.

Approximate no. of burials at least 5 Date range of burials 1834 - 1871

Description (markers, materials, arrangement, landscaping, fence, paths and roads, etc.)

Located in stand of trees in plowed field to the north (right) of 27110 Purdum Road. Severely overgrown. Two upright stones were located and 1 overturned slate and lots of fieldstones. → SEE REVERSE.

Surveyor(s) Janet Manuel Survey date 5/22/04

Photographer Anne Brockett Date 5/22/04 Photo no. _____

Current owner _____

Address/Phone No. 27100 Purdum Rd.

Historic Status Locational Atlas ID _____ National Register
 Master Plan ID _____ Other _____

UTM B BURDETT

Additional sources of information: _____

240
 BURDETT - GUE FAMILY
 27100 PURDUM RD
 DAMASCUS VICINITY.

2 stones found on 5/22/04:

Benjamin Burdett d. Jan. 16, 1834 aged 68 years

Elizabeth Burdett d. April 8, 1868 aged 70 years
and 1 month.

According to previous survey by Anne Braun on
June 15, 2003, three additional stones found:

James Burdett b. Jan 18, 1841 d. Feb. 23, 1871 aged 30 yrs

James Gue d. Feb. 7, 1846

Margaret Purdum Gue b. Jan 8, 1796 d. Mar. 12, 1861

Wife of James.

At that time, the cemetery was neglected. Ms.
Braun talked to the owner, who said that one of
the relatives of the deceased used to visit annually,
but no longer comes. The owner talked about
cleaning it up, but this has not been done.

There are likely more stones, but site is too
overgrown to investigate.

240
BURDETT - GUE FAMILY
27100 PURDUM RD
DAMASCUS VICINITY.



CEMETERY TRANSCRIPTION LIBRARY

[Home](#) | [Search](#) | [Journal](#) | [What's New](#) | [Submit Records](#)

[Home](#) > [United States](#) > [Maryland](#) > [Montgomery](#) > **Burdette Family Cemetery**

Burdette Family Cemetery Montgomery County, Maryland

27100 Purdum Road
Damascus, Maryland

Lat: 39° 17' 14"N, Lon: 77° 13' 30"W

Contributed by Anne Braun, Jun 20, 2003 [annieb52@aol.com]. Total records = 5.

In Damascus, from the intersection of Highway 27 (Ridge Road) and Bethesda Church Road, turn on Bethesda Church Road and go 2.5 miles west until you hit Purdum Road. Turn on Purdum and go south about .25 miles until you reach 27100 Purdum which is a farm. Turn there and go up the driveway. The cemetery is in a soybean field about 150-200 yards from the driveway.

This is a small neglected cemetery. The day I was up there the owner said that there used to be one of the relatives that came up there and visited each year however she does not come up anymore. His son took me and showed me where the headstones where. They are talking about cleaning this one up next fall afyer the weather cools down. The Gues and Burdettes are buried there. There are probally more graves or headstones but because of the overgrowth you cannot find them.

This is a work in progress

I walked this cemetery on Jun 15, 2003.

- Anne Braun

- Burdette, Benjamin**, d. Jan 6 1834, age 68 years
- Burdette, Elizabeth**, d. Apr 8 1868
- Burdette, James**, b. Jan 18 1841, d. Feb 23 1871, age 30yr 1mn 5da
- Gue, James**, d. Feb 7 1846
- Gue, Margaret Purdum**, b. Jan 8 1796, d. Mar 12 1861, w/o James

240
BURDETTE - GUE FAMILY
27100 PURDUM RD
DAMASCUS VICINITY.

Nothing on pg 2

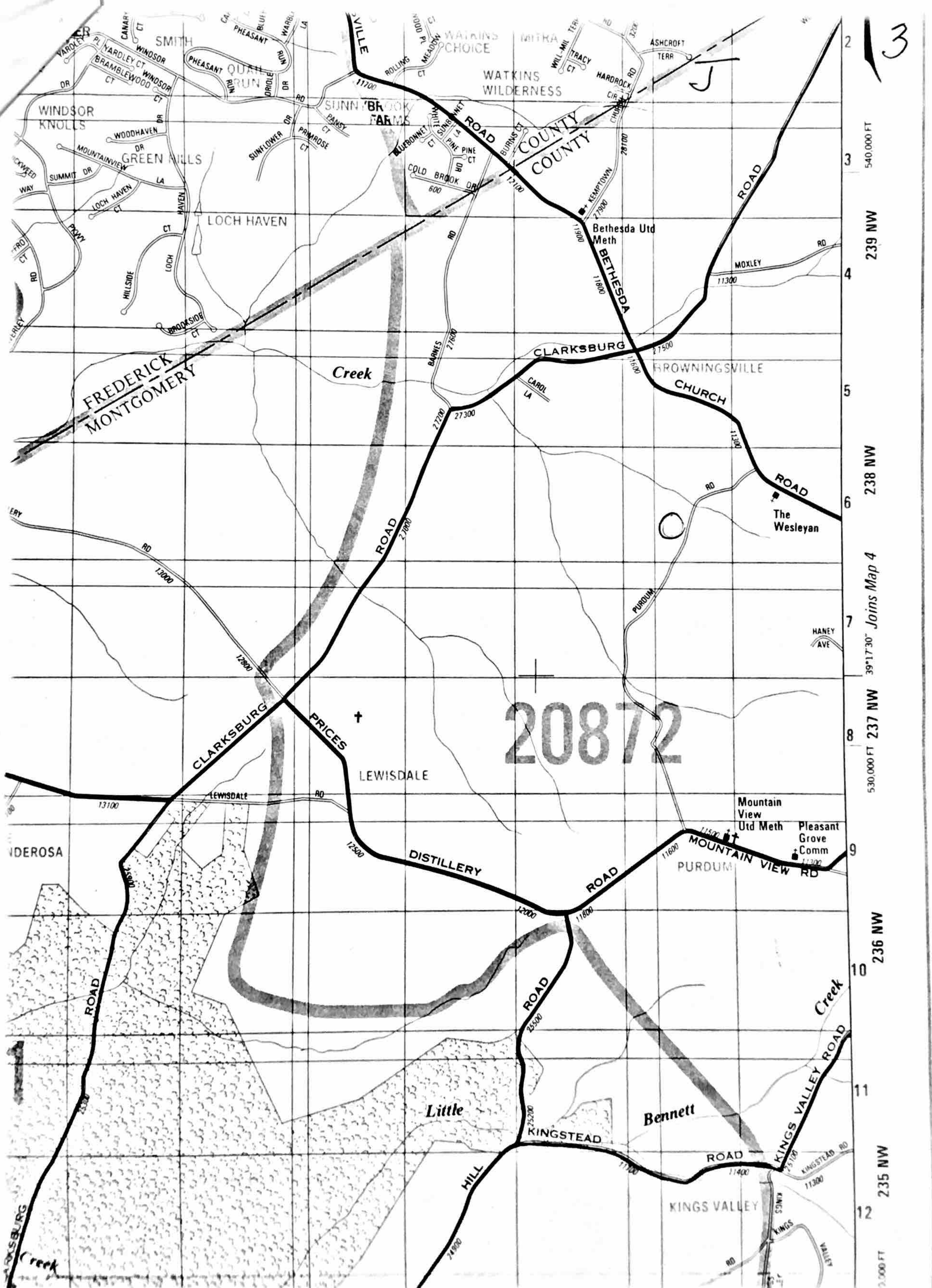

240 BURRETT - GUE FAMILY
 27100 PURDUM RD
 DAMASCUS VICINITY.