

TOWER-DAWSON LTD. PARTNERSHIP L.7393 F.617

PLAT NO.

OWNER'S DEDICATION 18192

WE, TOWER-DAWSON LIMITED PARTNERSHIP, A MARYLAND LIMITED PARTNERSHIP, THE MAYOR AND COUNCIL OF ROCKVILLE, A MUNICIPAL CORPORATION OF THE STATE OF MARYLAND, OWNERS OF THE PROPERTY SHOWN HEREON AND DESCRIBED IN THE SURVEYOR'S CERTIFICATE, HEREBY ADOPT THIS PLAN OF SUBDIVISION AND DEDICATE THE STREET SHOWN HEREON TO PUBLIC USE. WE FURTHER ESTABLISH TEMP. GRADING AND CONSTRUCTION EASEMENTS AS SHOWN HEREON. WE FURTHER GRANT TO THE CITY OF ROCKVILLE, STORM DRAIN / STORM WATER MANAGEMENT EASEMENTS AS SHOWN FOR THE CONSTRUCTION, RECONSTRUCTION, MAINTENANCE AND OPERATION OF STORM DRAIN SYSTEMS AND WATER AND SEWER EASEMENTS FOR THE CONSTRUCTION, RECONSTRUCTION, MAINTENANCE AND OPERATION OF PUBLIC WATER AND SEWER SYSTEMS AS SHOWN HEREON. THERE ARE NO SUITS OF ACTION, LEASES, LIENS OR TRUSTS ON THE PROPERTY INCLUDED IN THIS PLAN OF DEDICATION, EXCEPT A CERTAIN DEED OF TRUST AND THE PARTY IN INTEREST THERE TO HAVE BELOW PARTNERSHIP, GENERAL PARTNER INDICATED THEIR ASSENT.

TOWER-DAWSON LIMITED PARTNERSHIP BY  
DAWSON DEVELOPMENT COMPANY, LIMITED  
INTEREST THERE TO HAVE BELOW PARTNERSHIP, GENERAL PARTNER

ALBERT ABRAMSON, GENERAL PARTNER  
THE MAYOR AND COUNCIL OF ROCKVILLE, MARYLAND

DATE: 10/18/90

Shawn D. ... 4/25/91  
ATTEST: CITY CLERK DATE DOUGLAS DUNCAN, MAYOR.

WE HEREBY ASSENT TO THIS PLAN OF DEDICATION.  
MONTGOMERY COUNTY, MARYLAND

bothamc ... 4/18-91  
WITNESS DATE JOYCE R. STERN, SUBSTITUTE TRUSTEE

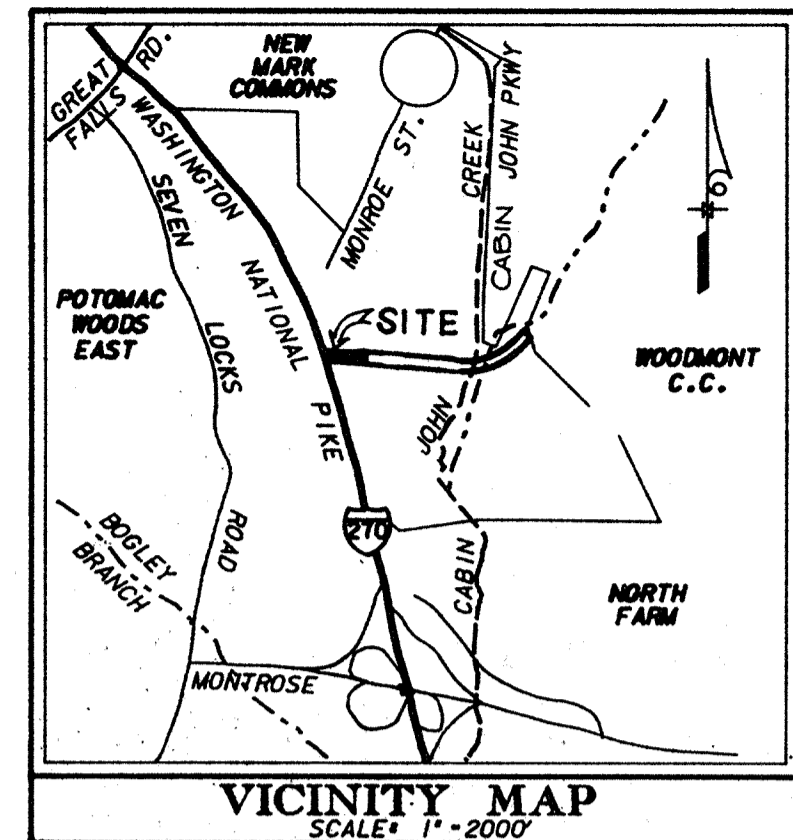

SURVEYOR'S CERTIFICATE

I HEREBY CERTIFY THAT THE PLAN SHOWN HEREON IS CORRECT, THAT IT IS A SUBDIVISION OF A PART OF THE SAME LAND DESCRIBED IN A CONVEYANCE FROM WEST-TOWER-DAWSON LIMITED PARTNERSHIP, A MARYLAND LIMITED PARTNERSHIP, BY DEED DATED NOVEMBER 12, 1986 AND RECORDED IN LIBER 7393 AT FOLIO 617 AND ALSO BEING A PART OF THE SAME LAND AS CONVEYED TO THE MAYOR AND COUNCIL OF ROCKVILLE FROM THE STATE HIGHWAY ADMINISTRATION OF THE DEPARTMENT OF TRANSPORTATION BY DEED DATED SEPTEMBER 18, 1989 AND RECORDED IN LIBER 9306 AT FOLIO 830, ALL RECORDED AMONG THE LAND RECORDS OF MONTGOMERY COUNTY, MARYLAND AND THAT IRON PIPES SHOWN THUS  $\ominus$  AND CONCRETE MONUMENTS SHOWN THUS  $\oplus$  WILL BE SET TO THE FINISHED GRADE AND THE TOTAL AREA INCLUDED IN THIS PLAN OF SUBDIVISION IS 74,667  $\pm$  OR 1.7141 AC.

Martin B. Gallalee  
MARTIN B. GALLALEE  
PROFESSIONAL LAND SURVEYOR  
MARYLAND NO. 5191



WASHINGTON NATIONAL PIKE INTERSTATE I-270  
MSRC PLATS 52026 & 52025

BASE LINE I-270

RIGHT-OF-WAY LINE I-270

MAYOR & COUNCIL OF ROCKVILLE L.9306 F.830

MAYOR AND COUNCIL OF ROCKVILLE L.9306 F.830

TOTAL AREA DED TO PUBLIC USE 74,667  $\pm$  OR 1.7141 AC.

TOWER-DAWSON LIMITED PARTNERSHIP L.7393 F.617

MARYLAND STATE MERIDIAN

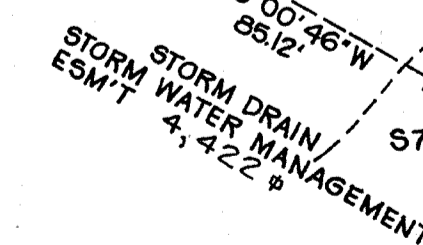

CURVE DATA						
NO.	ARC	RADIUS	DELTA	TANGENT	CHORD	CHORD BEARING
1	134.88	5,879.58	01° 18' 41"	67.29	134.58	N22° 30' 46"W
2	134.35	5,919.58	01° 18' 01"	67.18	134.35	S22° 18' 59"E

NOTE:  
TEMPORARY GRADING AND CONSTRUCTION EASEMENTS  
WILL REVERT TO PROPERTY OWNERS AT COMPLETION OF CONSTRUCTION.

Scale: 1"=50'

Recorded  
Plat Book  
Plat No.

FILED  
MAY - 7 1991

PLAT ONE  
**RITCHIE PARKWAY**  
CITY OF ROCKVILLE  
ELECTION DISTRICT NO. 4  
MONTGOMERY COUNTY, MARYLAND

GREENHORNE & O'MARA INC.  
ENGINEERS-ARCHITECTS-PLANNERS-SURVEYORS  
15020 SHADY GROVE ROAD, SUITE 300  
ROCKVILLE, MARYLAND 20850  
(301) 738-3890

JUNE 1990  
Sect.  
Comp. - Drafter  
BTR  
INC  
File No.  
R-2330-M

City of Rockville Planning Commission

Approved: JULY 11, 1990  
Without commitment as to installation of water, sewer or streets.

Chairman City Manager

51249-222-1

MONTGOMERY COUNTY CIRCUIT COURT (Subdivision Plats, MO) Plat 18192, MSA\_S1245\_24392, Date Available 1990/05/07, Print 12/04/2025