

Site: M:26/10/3 Replacement of 1976 form

Prettyman House

Built: 1841/42

104 West Jefferson Street

Remodeled :1876

Architect:James H.McGill (1876)

Builder:James B. Edmonston (1876)

Private

The vernacular Greek Revival home built for Capt. Zachariah Johnston, USN, in 1841 was remodeled thirty years later to reflect a more fashionable Victorian style. Five generations of the Johnston-Prettyman family resided in the two-story, center hall with wing, frame house. This family was notable for achievements in public service, education, religion, and the military.

Maryland Historical Trust State Historic Sites Inventory Form

Survey No. M:26/10/3

Magi No. 1650192404

DOE ☐ yes ☒ no

NR ☒ yes ☐ no

Replaces 1976 Form

M:26/10/3

(contributing element in W.
Montgomery NR Historic Dist.)

1. Name (indicate preferred name)

historic The Prettyman House

and/or common

2. Location

street & number 104 West Jefferson Street not for publication

city, town Rockville vicinity of congressional district 8

state Maryland county Montgomery (RV Planning Area 1)

3. Classification

Category	Ownership	Status	Present Use
<input type="checkbox"/> district	<input type="checkbox"/> public	<input checked="" type="checkbox"/> occupied	<input type="checkbox"/> agriculture
<input checked="" type="checkbox"/> building(s)	<input checked="" type="checkbox"/> private	<input type="checkbox"/> unoccupied	<input type="checkbox"/> commercial
<input type="checkbox"/> structure	<input type="checkbox"/> both	<input type="checkbox"/> work in progress	<input type="checkbox"/> educational
<input type="checkbox"/> site	Public Acquisition	Accessible	<input type="checkbox"/> entertainment
<input type="checkbox"/> object	<input type="checkbox"/> in process	<input checked="" type="checkbox"/> yes: restricted	<input type="checkbox"/> government
	<input type="checkbox"/> being considered	<input type="checkbox"/> yes: unrestricted	<input type="checkbox"/> industrial
	<input checked="" type="checkbox"/> not applicable	<input type="checkbox"/> no	<input type="checkbox"/> military
			<input type="checkbox"/> museum
			<input type="checkbox"/> park
			<input checked="" type="checkbox"/> private residence
			<input type="checkbox"/> religious
			<input type="checkbox"/> scientific
			<input type="checkbox"/> transportation
			<input checked="" type="checkbox"/> other: office

4. Owner of Property (give names and mailing addresses of all owners)

name John R. Law et ux.

street & number 104 West Jefferson Street telephone no.: 279-0990

city, town Rockville state and zip code Maryland 20850

5. Location of Legal Description

courthouse, registry of deeds, etc. Montgomery Co. Land Records liber 4584

street & number Montgomery Co. Courthouse folio 474

city, town Rockville state Maryland

6. Representation in Existing Historical Surveys

title National Register of Historic Places (1974)

date City of Rockville Historic District (1974) ☒ federal ☐ state ☐ county ☒ local

depository for survey records City of Rockville

city, town Rockville state Maryland

7. Description

Survey No. M: 26/10/3

Condition

☒ excellent
☒ good
☐ fair

☐ deteriorated
☐ ruins
☐ unexposed

Check one

☐ unaltered
☒ altered

Check one

☒ original site
☐ moved date of move _____

Prepare both a summary paragraph and a general description of the resource and its various elements as it exists today.

The subject house faces north on West Jefferson Street, at the intersection of Van Buren on a narrow deep corner lot. The present Van Buren Street originally served as the lane to the house; its dedication reduced the side yard to a small garden enclosed on two sides by the house. Mature trees shade the house and grounds. A brick herringbone walkway leads to the house and surrounds an ancient tree on the street corner. Old boxwoods line the front walk, obstructing the path and hiding the building front. A driveway from Van Buren leads to a carport at the rear of the main block, enclosing the garden on the third side.

This frame 2-story center hall plan house with 2-story wing is L shaped overall. The three-by-two-bay main block is built on a brick foundation and topped with a low hipped roof covered with asbestos shingles. It has wide boxed eaves. The house is sheathed in beaded German siding on the north and east, the facades exposed to the (then) town, and plain German siding on the south and west with wide cornerboards and cornice with frieze and crown. There are two interior brick chimneys in the main block and one in the wing. The 2-story west wing has an asbestos shingled mansard roof and the foundation is parged with cement.

The original house of 1841 was designed as a 1-1/2 story side-gabled vernacular dwelling with a pedimented front portico in a popularized Greek Revival style. The house had an attached 1-1/2 story west wing and a rear wing. Two pedimented gabled dormers were set into the steep roof on both main mass and wing. In 1876 the house was enlarged and remodeled to Victorian tastes with the raising of the main block to a full two stories with attic, addition of a full width porch, a one-story bay on the east facade, and probably the modification of the west wing roof to a dormered mansard roof. Since these changes, the house has been little altered. (See photograph, attachment 7.3)

The north (front) facade consists of the east three-bay, two-story main block and west two-bay, two-story mansard roofed wing. The main block has three regularly spaced windows on the second story, and elongated, nearly door length windows in the first and third bays, first story. The predominant window type is 2/2 double hung sash, but 6/6 is also used as noted. Most have classic projecting crowned and capped lintels with a moulded strip below the sills and wooden louvered shutters except the wing dormer windows. On the east side only, two scroll brackets support the sills. A wood panelled exterior door with one-light rectangular transom and surrounds similar to the windows is in the center bay, flanked by brass carriage lamps. The main block full-width front porch is set on brick piers and has a low hipped roof supported by four square chamfered and fully capitaled columns. The front porch is accessed by three central wooden steps

continued on attachment 7.1

only, two scroll brackets support the sills. A wood panelled exterior door with one-light rectangular transom and surrounds similar to the windows is in the center bay, flanked by brass carriage lamps. The main block full-width front porch is set on brick piers and has a low hipped roof supported by four square chamfered and fully capiteled columns. The front porch is accessed by three central wooden steps flanked by a plain post, rail, and stick balustrade which continues around the perimeters of the porch. The porch rests on brick piers infilled with lattice panels. The slightly hipped seamed tin roof has four chamfered and capiteled wooden columns supporting a wide cornice.

The two-bay wing has four windows, one in each bay first and second story. The mansard roof extends down the facade to the top of the first floor main block windows with approximately a one foot overhang. The two second story dormer windows are set deeply into the mansard roof so that the sills with moulded trim below project only slightly and the flared pediment hoods somewhat more. In appearance, these windows seem almost flush with the roof. The top of the mansard roof has a overhang of several inches which is boxed with a crown moulding as the mainblock eaves. The first floor is nearly obscured by shrubbery.

The west facade consists of the narrow end of the 2-story wing with a one-story shed-roofed office addition and small enclosed entrance portico on the south side, the two-bay west side of the taller main block and a rear south-gabled one-story addition. The wing has one window first and second stories. The main block has one narrow window on the second story, north, by the mansard roof, and a window in the south bay. The first story has a central 6-light wood exterior door and an elongated window in the south bay. To its right is another wood panel exterior door. The addition has one small 6/6 window in the left bay and a larger 6/6 window in the right.

The south (rear) facade has an irregular massing created by additions to both wing and main block. The south side of the wing has two deeply set dormer windows on the second story as described before. The first story is occupied by the office addition with one centered window and 6-light wood panel exterior door. An aluminum storm door is in the entrance portico. The gable end of the rear addition has one 6/6 window and an ornamental weathervane on the gable peak. The rear of the three-bay main block has one window each bay of the second story. A shed-roofed screen porch with a screen door is in the center bay and one mainblock window in the right bay, first story.

The two-bay east facade has one window in the south bay, first and second stories. The north bay has one window, second story, and a flat-roofed, 3-sided, 3-windowed projecting bay on the first story.

continued on attachment 7.2

Interior:

Although updated, many of the original interior features and the floor plan of the main block were retained. Handsome woodwork (baseboards, window and door trims, stair balustrade) and fireplace mantels remain intact. The exception is the black walnut and oak paneled library or rear parlor, described in the 1876 Sentinel (attachment 8.3), which has been removed.

The west wing is accessed through the dining room or front parlor by an enclosed hyphen and descending steps. This area was substantially altered to provide a modern kitchen and informal living room. The second floor now serves as the owner's dental office, accessible through a centrally placed interior stairway.

8. Significance

Survey No. M:26/10/3

Period	Areas of Significance—Check and justify below			
<input type="checkbox"/> prehistoric	<input type="checkbox"/> archeology-prehistoric	<input type="checkbox"/> community planning	<input type="checkbox"/> landscape architecture	<input type="checkbox"/> religion
<input type="checkbox"/> 1400-1499	<input type="checkbox"/> archeology-historic	<input type="checkbox"/> conservation	<input type="checkbox"/> law	<input type="checkbox"/> science
<input type="checkbox"/> 1500-1599	<input type="checkbox"/> agriculture	<input type="checkbox"/> economics	<input type="checkbox"/> literature	<input type="checkbox"/> sculpture
<input type="checkbox"/> 1600-1699	<input checked="" type="checkbox"/> architecture	<input checked="" type="checkbox"/> education	<input type="checkbox"/> military	<input type="checkbox"/> social/humanitarian
<input type="checkbox"/> 1700-1799	<input type="checkbox"/> art	<input type="checkbox"/> engineering	<input type="checkbox"/> music	<input type="checkbox"/> theater
<input checked="" type="checkbox"/> 1800-1899	<input type="checkbox"/> commerce	<input type="checkbox"/> exploration/settlement	<input type="checkbox"/> philosophy	<input type="checkbox"/> transportation
<input type="checkbox"/> 1900-	<input type="checkbox"/> communications	<input type="checkbox"/> industry	<input checked="" type="checkbox"/> politics/government	<input type="checkbox"/> other (specify)
		<input type="checkbox"/> invention	1876 alterations/addition	
	1841-42, altered 1876		James H. McGill architect	
Specific dates	additions 1876	Builder/Architect	James B. Edmonston, builder	
check:	Applicable Criteria:	<input type="checkbox"/> A	<input checked="" type="checkbox"/> B	<input checked="" type="checkbox"/> C <input type="checkbox"/> D
	and/or			
	Applicable Exception:	<input type="checkbox"/> A	<input type="checkbox"/> B	<input type="checkbox"/> C <input type="checkbox"/> D <input type="checkbox"/> E <input type="checkbox"/> F <input type="checkbox"/> G
	Level of Significance:	<input type="checkbox"/> national	<input type="checkbox"/> state	<input checked="" type="checkbox"/> local

Prepare both a summary paragraph of significance and a general statement of history and support.

Significance
The Prettyman house is architecturally noteworthy as an example of an 1840s popularized Greek Revival vernacular house, remodeled and enlarged to its present configuration in 1876. It is associated with five generations of the Johnston-Prettyman family who were notable in public service, education, religion, and the military.

History and Support
Solomon Holland was the Register of Wills for Montgomery County from 1808 until his death in 1839. After his death his late 18th century home on South Washington Street (Site M:26/11/5) devolved to his sons. His wife, Matilda, chose a 13-1/2 acre lot at the western boundary of the Town of Rockville adjoining the Rockville Academy, across from the Baptist Cemetery, and stretching south along the Road to Great Falls. 1/ On this site in 1841-42, the subject house was constructed for Capt. Zachariah T. Johnston and his wife Anne Holland Johnston, daughter of Solomon and Matilda Holland. 2/ The house is specifically mentioned in a receipt dated 1845 for a burial plot in the cemetery.

A photograph of the Prettyman family and the house taken in 1873 shows the appearance of the original house before alteration. The 1-1/2 story frame dwelling had gabled dormers, exterior end chimneys, and a side wing. The front facade was decorated by a pedimented entry porch with classical columns in the Greek Revival style. 3/ (Photo, attachment 7.3)

Capt. Johnston served 41 years in the U.S. Navy. One of his tours of duty included patrolling the Pacific waters off the coast of California during the 1849 Gold Rush. 4/ According to the 1850 census this Rockville residence sheltered his wife, his mother-in-law and his five daughters.

continued on attachment 8.1

Johnston's eldest daughter married Oscar Badger, USN; that branch of the family continued the Naval tradition for three generations. His daughter Mary married Cooke Lockett, teacher and later Principal of the Rockville Academy. His second daughter Lydia was 17 years old in 1850.

Elijah Barrett Prettyman was the son of a Methodist Minister, a graduate of Dickinson College, and a teacher when he came to Rockville in 1851 to read law with Judge Richard Bowie. 5/ He and Lydia Johnston were married in 1855, by which time he had become Principal of the Brookeville Academy. He remained in Brookeville until 1863 when he returned to Rockville to become Clerk of the Circuit Court for Montgomery County, a public office he held for 22 years.

Mrs. Holland sold the 12 acres surrounding the residence to Elijah for \$960 in 1867, but retained title to the house until her death in 1870. Elijah bought the homestead from the other heirs for \$1,440 in 1872. 6/

Washington D.C. Architect James H. McGill was engaged to remodel and enlarge the old house in the newest Victorian style. He substituted a full width "Piazza" on the first floor for the original porch. Changes to the fenestration and roof lines are shown on the extant elevations and plans, "Drawings of Alterations and Additions to the E.B. Prettyman House, Rockville, Md", now held by the present owner. The Sentinel of December, 1876 (see attachment 8.3) noted the completion of the work by local contractor John B. Edmonston and described the size of the house and its custom features such as black walnut panelling in the library, rose tinted wallpaper and the latest silver Latrobe stoves. The kitchen wing is not shown on the architectural drawings, but it is believed that the mansard roof now present on this wing was done at the same time. 7/

Some of the surrounding acreage was sold later as the west end of Rockville became a desirable suburban address. One lot was sold to Mr. Prettyman's deputy R.S. Patterson. Both Marian Prettyman, who married local newspaper publisher Albert Almoney, and the widowed Sophia Higgins purchased lots on the west side of the Prettyman stable lane, later platted as South Van Buren Street.

In 1899 Mr. Prettyman was appointed the third State Superintendent of Schools: at that time the job also included the position as Principal of the State Normal School at Towson. He retired to Rockville in 1905 and died two years later. Lydia Prettyman died in 1919; subsequent occupants of the house included the children and grandchildren of the couple, including the widower Rev. Forrest Prettyman, Chaplain of the U.S. Senate; Miss Lydia Prettyman, Deputy Register of Wills for Montgomery County, and various maiden aunts. 8/ Financial considerations forced the sale of most of the property with its grove of chestnut trees. The land on Falls Road was sold for development, and the stone dairy, stable and other outbuildings disappeared as Van Buren Street was extended southward.

M:26/10/3

The Prettyman House
Attachment 8.2

Charles Wesley Prettyman and his wife Ruth were the last of the family to own the house. Mr. Prettyman was an attorney and member of the Rockville City Council. By the time of their purchase in 1954 the old house was badly deteriorated and required rehabilitation and modernization.

Between 1968 and 1974 James Hathaway owned the house; since 1974 it has been the property of John Law, D.D.S. who maintains his office on the second floor of the old kitchen wing. 9/

This once quiet neighborhood is now threatened by the heavy traffic, pollution and noise which are the products of its proximity to three heavily travelled arteries into Rockville.

Footnotes:

1. Montgomery County Wills W356(1839) and Montgomery County Land Records BS10/300-302 (1840). Boundary Stone II of the Town of Rockville was planted in 1803 at the southwest corner of the Rockville Academy lot, one of the eastern boundaries of the subject property.
2. Land Records, STS 5/212 (1851). The date of construction is based on a rise in the assessed value of the property from \$574 to \$1,800 in the 1841-42 Tax Assessment records.
3. Montgomery County Historical Society Photograph Collection # 066-001-123A, date provided by Prettyman family as Fall, 1873.
4. Montgomery County Sentinel March 25, 1859 obituary. His log book for the "Forty-Niner" period was donated to the Montgomery County Historical Society, but has not been seen for 15 years.
5. Men of Mark in Maryland, Johnson-Wynn Co., (D.C.) 1907, Vol.I, p. 291 and Abstracts of the Minute Books of the Brookeville Academy.
6. Land Records, EBP4/342 (1867) and EBP 10/238 (1872). Although Mr. Prettyman is shown as the owner/occupant of the house on the Martinet & Bond Map of 1865, this is an error as is the outline of Jefferson Street all the way to Falls Road; until the 1890's, Jefferson Street was a dirt path at this point.
7. Two years later, Edmonston constructed a mansard-roofed house for H.W. Talbott nearby at 208 West Montgomery Avenue.
8. Prettyman family genealogies, newspaper articles and church records of various dates 1855-1954.
9. Land Records 2981/648 (1954), 3748/390 (1968) and 4585/474 (1974). The kitchen wing suffered a fire in 1906 which the Sentinel of November 16 said left that portion a "wreck" but did little damage to the main building.

LOCAL AFFAIRS.

A Handsome Residence.—E. B. Prettyman, Esq., Clerk of the Court for this county, has nearly completed the erection of a handsome new dwelling house on his place, directly west of the Academy. The main building is thirty-six by forty feet, two stories high, with porches in front and rear, the east front being decorated with a handsome bay window. The rooms are all large, well lighted and ventilated in the best manner. The contractor for the carpenter's work, Mr. Jno. B. Edmonston, has completed his work in a manner to reflect credit upon himself and assistants. The roofing was executed in good style by Mr. Louis Viatt, of this place. The painting of the entire building was executed by Mr. Jas. Meehan, and for beauty of finish is certainly equal, if not superior, to any work of the kind in this section. The parlor is superbly finished in French embossed paper with light rose tint ceiling, trimmings and doors gloss white. The large library in the rear of the parlor is a very handsome room, finished in black walnut and oak panel with chestnut trimmings, and French black walnut wainscoting. The ceiling is handsomely kalsonined in two different colors and decorated with a beautiful centrepiece. A spacious hall traverses the centre of the building on both floors, and is finished in kalsomine, with black walnut doors and trimmings. The four bed-rooms are beautifully finished, each one being of a different color—blue, pearl, rose and grey. The dining-room is finished in oak with a painted floor. The parlor library and two of the chambers are heated by a "Silver Palace Latrobe Heater." For convenience this building has no superior in this vicinity.

SENTINEL—DEC. 22, 1876

M: 26/10/3
The Prettyman House
Attachment 8.3

MONTGOMERY COUNTY SENTINEL
December, 1876

ROCKVILLE LAND MARKS - House
JEFFERSON ST. # 104
"PRETTYMAN HOUSE"

M: 26/10/3
The Prettyman House
Attachment 7.3

104 West Jefferson before 1876
(tentatively dated by family Fall, 1873)



PHOTO DATED 1873 BY
PRETTYMAN FAMILY
PHOTO - MONT. CO. HISTORICAL SOCIETY

Survey No.M:26/10/3

10. Geographical Data

Quadrangle scale _____

H | | | | |

11. Form Prepared By

PS-2746

ACHS SUMMARY FORM

M: 26-10-3

26-10-3

1. Name Prettyman House

. Planning Area/Site Number 26/10

West Montgomery Avenue HD

4. Address 104 West Jefferson Street
Rockville, Md.

5. Classification Summary

Category buildingOwnership privatePublic Acquisition N/AStatus occupiedAccessible noPresent use private residencePrevious Survey Recording Federal State County Local

MNCPPC-County, Local-1976

National Register-Federal-1975

Rockville Historic District

Commission-1974

6. Date 1851

7. Original Owner Capt. Zachariah
Johnston

8. Apparent Condition

a. excellentc. original siteb. altered

9. Description: This rectangular 2½ story, 3 bay by 2 bay, frame house faces north. The main (east) section of the house is built on brick foundations, and has a low hipped roof covered by asbestos shingles. There are two interior chimneys, and a one story bay window on the first floor. This section has a front porch with quarter hipped roof and balustraded railing. The double windows flanking the front door are unusually long and reach the porch floor.

The west addition was made to the house during a major remodeling in 1876. It has poured concrete foundations, and a mansard roof covered by asbestos shingles. There are 2 dormer windows flush against the north side of the roof. There is an interior chimney in this section. There is a lovely private garden at the back of the house.

10. Significance: This house is one of the oldest in the city of Rockville. For almost 150 years the property has been owned or occupied by one family whose succeeding generations have served Montgomery County and the city of Rockville with distinction in the fields of education, religion, law and the military.

One of the first sheriffs of Montgomery County, Solomon Holland, purchased 13.5 acres here in 1821, and passed it to his daughter Anne Johnston. She and her husband Captain Zachariah Forrest Johnston, U.S.N., built the house about 1851. One of the four Johnston daughters married educator Elijah Barrett Prettyman, who served as principal of the Brookeville Academy from 1853-63, and as Clerk of the Montgomery County Circuit Court from 1863-85. The Prettymans extensively remodeled the house in 1875-6, adding the mansard roof, larger porch, and bay windows on the east side.

The Prettyman son (William) and grandson (Charles) also lived here. They were attorneys, active in County politics, religious, and community affairs. They served as trustees and administrators for the Rockville Academy next door. In 1922, 12 acres was sold off, and the remaining acre passed from the family in 1968. The present owner uses the property as a combined residence and office.

12. Compiler Eileen McGuckian

13. Date Compiled 2/79

14. Designation

Approval

11. Researcher/Date: Anne W. Cissel Nov. 1978

Candy Reed/Architectural Description

15. Acreage: 27,538 sq. ft.

MARYLAND HISTORICAL TRUST

M: 26/10/3
West Montgomery HD
Magi #

INVENTORY FORM FOR STATE HISTORIC SITES SURVEY

1 NAME

HISTORIC

Prettyman House.

AND/OR COMMON

2 LOCATION

STREET & NUMBER

104 West Jefferson Street

CITY, TOWN

Rockville

VICINITY OF

CONGRESSIONAL DISTRICT

8th

STATE

Maryland

COUNTY

Montgomery

3 CLASSIFICATION

CATEGORY

☐ DISTRICT☒ BUILDING(S)☐ STRUCTURE☐ SITE☐ OBJECT

OWNERSHIP

☐ PUBLIC☒ PRIVATE☐ BOTH

PUBLIC ACQUISITION

☐ IN PROCESS☐ BEING CONSIDERED

STATUS

☒ OCCUPIED☐ UNOCCUPIED☐ WORK IN PROGRESS

ACCESSIBLE

☐ YES: RESTRICTED☐ YES: UNRESTRICTED☒ NO

PRESENT USE

☐ AGRICULTURE☐ COMMERCIAL☐ EDUCATIONAL☐ ENTERTAINMENT☐ GOVERNMENT☐ INDUSTRIAL☐ MILITARY☐ MUSEUM☐ PARK☒ PRIVATE RESIDENCE☐ RELIGIOUS☐ SCIENTIFIC☐ TRANSPORTATION☐ OTHER:**4 OWNER OF PROPERTY**

NAME

John and Margaret Law

Telephone #: 279-0990

STREET & NUMBER

104 Jefferson Street

CITY, TOWN

Rockville

VICINITY OF

STATE, zip code

Maryland 20850

5 LOCATION OF LEGAL DESCRIPTIONCOURTHOUSE,
REGISTRY OF DEEDS, ETC.

Montgomery County Courthouse

STREET & NUMBER

Liber #: 4584

Folio #: 474

CITY, TOWN

Rockville

STATE

Maryland 20850

6 REPRESENTATION IN EXISTING SURVEYS

TITLE

Rockville Historic District Commission Survey

DATE

1974

☐ FEDERAL ☐ STATE ☐ COUNTY ☒ LOCALDEPOSITORY FOR
SURVEY RECORDS

Rockville City Hall

CITY, TOWN

Rockville

STATE

Maryland

7 DESCRIPTION

M:26-10-3

CONDITION

☒ EXCELLENT
☐ GOOD
☐ FAIR

☐ DETERIORATED
☐ RUINS
☐ UNEXPOSED

CHECK ONE

☐ UNALTERED
☒ ALTERED

CHECK ONE

☒ ORIGINAL SITE
☐ MOVED DATE _____

DESCRIBE THE PRESENT AND ORIGINAL (IF KNOWN) PHYSICAL APPEARANCE

This rectangular, two and a half story, three bay by two bay, wood frame house is in excellent condition. Built on a corner lot close to West Jefferson Street, near the heart of the city of Rockville, it faces north.

The main (east) house is built on brick foundations while the west addition has poured concrete foundations. The north and east elevations have white novelty siding and the south and west elevations have white clapboarding. There is a porch on the north (front) elevation of the east section. This porch has a quarter hipped roof which is supported by four chamfered wooden posts. A balustraded railing encloses the porch except where the steps from the walk lead up to the porch. The north (front) door is wooden paneled and is surmounted by a single light transom. The double windows flanking the north door are unusually long and reach the porch floor. There is a one story bay window at the first floor in the northeast corner of the east elevation. These windows are all two-over-two double hung. They are surmounted by simple carved wooden lintels and flanked by black wooden louvered shutters.

The main (east) house has a low hipped roof covered by asbestos shingles. The west addition has a mansard roof covered by asbestos shingles. There are two dormer windows sit flush against the north mansard roof. These two-over-two double hung windows have molded lintels with a peak at the center. There are two interior chimneys in the east section and one interior chimney on the west section.

There is a lovely private garden at the back of this house.

CONTINUE ON SEPARATE SHEET IF NECESSARY

PERIOD		AREAS OF SIGNIFICANCE -- CHECK AND JUSTIFY BELOW			
PREHISTORIC	— ARCHEOLOGY-PREHISTORIC	— COMMUNITY PLANNING	— LANDSCAPE ARCHITECTURE	— RELIGION	
1400-1499	— ARCHEOLOGY-HISTORIC	— CONSERVATION	<input checked="" type="checkbox"/> LAW	— SCIENCE	
1500-1599	— AGRICULTURE	— ECONOMICS	— LITERATURE	— SCULPTURE	
1600-1699	<input checked="" type="checkbox"/> ARCHITECTURE	<input checked="" type="checkbox"/> EDUCATION	<input checked="" type="checkbox"/> MILITARY	— SOCIAL/HUMANITARIAN	
1700-1799	— ART	— ENGINEERING	— MUSIC	— THEATER	
<input checked="" type="checkbox"/> 1800-1899	— COMMERCE	— EXPLORATION/SETTLEMENT	— PHILOSOPHY	— TRANSPORTATION	
1900-	— COMMUNICATIONS	— INDUSTRY	— POLITICS/GOVERNMENT	<input checked="" type="checkbox"/> OTHER (SPECIFY)	
		— INVENTION		Local History	

SPECIFIC DATES Built 1851
Remodeled 1876 BUILDER/ARCHITECT

STATEMENT OF SIGNIFICANCE

This house is one of the oldest in the city of Rockville. For almost 150 years the property has been owned or occupied by one family whose succeeding generations have served Montgomery County and the city of Rockville with distinction in the fields of education, religion, law and the military.

As part of the original "Exchange and New Exchange" grant, one of the first Sheriffs of the county, Solomon Holland, purchased 13.5 acres in 1821. Holland was also instrumental in fulfilling the charter for establishment of the Rockville Academy and the establishment of the Rockville Female Seminary. At his death in 1839 his estate passed to his wife and then to his children. In 1840 partition of his estate was made¹, and this 13.5 acre tract was deeded to his daughter Anne Holland Johns(t)on. Anne was married to Captain Zachariah Forrest Johnston, U.S.N. and in 1851 the house was built².

Contemporary photographs of the house circa 1850-1860, show the frame "classical revival" home, with small pedimented porch and dormer windows on both main mass and west wing.³

One of the four Johnston daughters married educator Elijah Barrett Prettyman. From 1853-1863 he served as principal of the Brookeville Academy, returning to Rockville in 1863 to serve as Clerk of the Circuit Court of Montgomery County, a position he held for 22 years. The 1865 Martinet & Bond map names E.B. Prettyman as occupying the house although title did not pass to him and his wife from her mother until later. In 1867 Prettyman purchased the 12 acres surrounding the house for \$960⁴.

In 1872 the final acre, including the house, was sold to him for \$1440⁵.

In 1876 extensive remodeling of the house was undertaken to modernize and introduce the newest architectural details, such as the mansard roof, larger porch and addition of bay windows on the east side. The Montgomery County Sentinel newspaper pronounced the house "nearly complete" in its edition of February 4, 1876.

The Prettyman son (William) and grandson (Charles) continued to occupy the house in later years. They were attorneys, active in county politics, religious and community affairs. Like the Hollands and the elder Prettyman, they served as trustees and administrators for the Rockville Academy which was adjacent to their own property.

Through the years the exterior of the house remained virtually unchanged.⁶

CONTINUE ON SEPARATE SHEET IF NECESSARY

(continued on attachment sheet A)

Attachment Sheet A

In 1922 the surrounding acreage was divided, with 12 acres sold to Lydia Almoney Brunett, one of the Prettyman heirs.⁷ The last acre, including the house lot, passed from the Prettyman family in 1968.⁸ A strip of the lot was deeded to the Mayor and Council of Rockville for street widening in 1969.⁹

The present owner is John Law who uses it as a combined residence and office.¹⁰

Footnotes

1. Land Records of Montgomery County, (BS 10/300; BS 10/302)
2. Montgomery County Assessment Records, 1841-52, p. 230 (See receipt at STS 5/212: "...for \$10.00, from E. Stonestreet, ground in the Baptist Burying Ground, adjoining and north of Captain Johnston's house")
3. (Photo 066-001-123A) (undated), Montgomery County Historical Society's Photograph Collection
4. Land Records of Montgomery County (EBP 4/342)
5. Ibid., (EBP 10/238).
6. (Photo 066-001-23C) (1885), Montgomery County Historical Society's Photograph Collection
7. Land Records of Montgomery County, Md., 328/189.
8. Ibid., 3748/390.
9. Ibid., 3932/149.
10. Ibid., 4585/474 (1974).

9 MAJOR BIBLIOGRAPHICAL REFERENCES

See attached sheet B

CONTINUE ON SEPARATE SHEET IF NECESSARY

10 GEOGRAPHICAL DATA

ACREAGE OF NOMINATED PROPERTY 27,538 square feet, part of tract called "Exchange and New Exchange Enlarged", City of Rockville, Rockville District.

VERBAL BOUNDARY DESCRIPTION

Bounded on the north by West Jefferson Street, on the east by the Rockville Academy lot, on the south by land of (formerly) Lydia Bruntett and on the west by South Van Buren Street.

LIST ALL STATES AND COUNTIES FOR PROPERTIES OVERLAPPING STATE OR COUNTY BOUNDARIES

STATE	COUNTY
STATE	COUNTY

11 FORM PREPARED BY

NAME / TITLE

Anne W. Cissel

Candy Reed

Architectural Description

ORGANIZATION

Sugarloaf Regional Trails

DATE

November 1, 1978

STREET & NUMBER

Box 87

TELEPHONE

926-4510

CITY OR TOWN

Dickerson

STATE

Maryland 20753

The Maryland Historic Sites Inventory was officially created by an Act of the Maryland Legislature, to be found in the Annotated Code of Maryland, Article 41, Section 181 KA, 1974 Supplement.

The Survey and Inventory are being prepared for information and record purposes only and do not constitute any infringement of individual property rights.

RETURN TO: ~~Maryland Historical Trust~~
~~The Shaw House~~ State Circle
~~Annapolis, Maryland 21401~~
~~(301) 267-1438~~

SUGARLOAF REGIONAL TRAILS
 Box 87, Stronghold
 Dickerson, Md. 20753
 (301) 926-4510

BIBLIOGRAPHY

1. Land Records of Montgomery County, Md.
2. Montgomery County Assessment Records: Fourth District (1840), p. 77;
(1841-52) p. 230
Third District (1820-1824)
pp. 28, 84, 157.
3. Will Records, Montgomery County
4. Montgomery County Sentinel
5. Photographs of the Montgomery County Historical Society.
6. Martinet & Bond Map, 1865.
7. Portrait & Biographical Records of the 6th Congressional District,
Chapman Publishing Co., 1898, p. 669.
8. Steiner, Bernard, Men of Mark in Maryland, Washington, D.C.:
1907, p. 291.
9. "Recollections of William F. Prettyman", 1973
10. Undated architectural drawings of house plan in possession of
Dr. and Mrs. Law.
11. C. M. Hopkins (1879) Map, p. 10.
12. Various sources in unpublished Prettyman family histories, Capt.
Johnson's logbook, etc. (Montgomery County Historical Society).

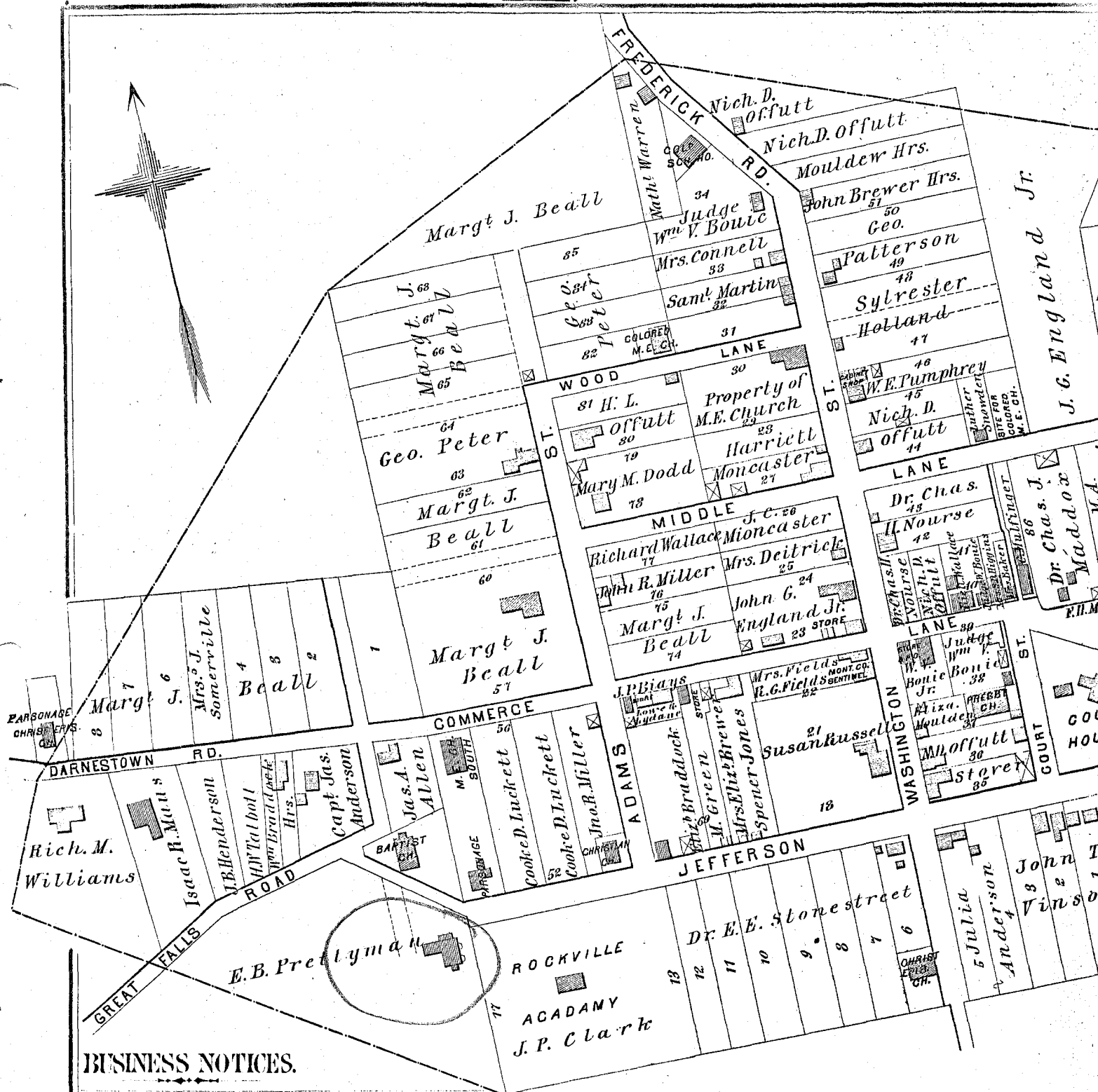

BUSINESS NOTICES.

ATTORNEYS AT LAW.

Spencer C. Jones,
Attorney at Law and Solicitor in
Chancery.
Rockville, Md.

Hatterly W. Talbot,
Attorney at Law,
Office on Perry St.

Anderson & Bouie,
Attys. at Law & Solicitors in Chancery.
Thos. Anderson. W. Bouie, Jr.

James Dawson,
Attorney at Law.

John T. Vinson,
Attorney at Law.

Peter & Henderson,
Attorneys at Law.
Geo. Peter. Jas. P. Henderson.

MERCHANTS.

James P. Biags
Dealer in Dry Goods, Groceries,
Notions, etc.

D.F. Owens,
Dealer in Pure Drugs, Chemicals, Paints,
Glass, Stationery, Seeds, Dyes and
Tobacco and Cigars.

David H. Bouie,
Dealer in Dry Goods, Groceries and
Merchandise Generally.

Stephen B. Lyddane,
Dealer in Groceries, Wines, Lard, Coal,
Fertilizers, Agricultural Implements, etc.
Opp. R.R. Depot.

MISCELLANEOUS.

Henry Anstey,
Manufacturing Jeweller and Mfr. of the
Simple Cam Spring.
Rockville, Md.

W.H. Crismond,
Hair Dressing and Shaving Saloon,
also Music Furnished at shortest Notice,
on reasonable terms.

Alex. Kilgour,
Agent for P.Zell & Sons,
of Baltimore, Md.
Manufacturers of Fertilizers.

Warren Sawin,
Manufacturer and Dealer in Pure
Cider and Cider Vinegar.
P.O. Address: South Attick, Mass.

City of Rockville

scale: 1" = 600'

1982

M: 26/10/3*

1

Prettyman House

104 W. Jefferson Ave.





104 West Jefferson Street

M. 26-10-3



NAME Prettyman House (W. MONTGOMERY HIST. DIST.)
104 W. Jefferson St. M:26-10-3 M:26-10
LOCATION SE CORNER JEFFERSON + VAN BUREN, ROCKVILLE, MD.

FACADE N

PHOTO TAKEN 5/13/75

M. DWYER



RICHARD H. ANDREWS
424-8282
1608 FARRAGUT AVE.
ROCKVILLE, MD 20851

04860205

M: 26/10/3
Prettyman House
104 W. Jefferson St.
Rockville
NE facade
4-86



RICHARD H. ANDREWS
424-8282
1608 FARRAGUT AVE.
ROCKVILLE, MD 20851

04860509

M: 26/10/3

Prettyman House
104 W. Jefferson St.
Rockville
4-86
NW facade



RICHARD H. ANDREWS
424-8282
1608 FARRAGUT AVE.
ROCKVILLE, MD 20851

04860501

m: 26/10/3
Prettyman House
104 W. Jefferson St.
Rockville 4-86
SW facade