

Maryland Historical Trust
 Maryland Inventory of Historic Properties Form
 Intercounty Connector Project

DOE ☐ yes ☐ no

1. Name: (indicate preferred name)

historic Odorian Robey Property

and/or common Evelyn Bean Property

2. Location:

street & number 2509 Briggs Chaney Road ☐ not for publication

city, town Fairland ☒ vicinity of congressional district

state Maryland county Montgomery

3. Classification:

Category	Ownership	Status	Present Use
<input type="checkbox"/> district	<input type="checkbox"/> public	<input checked="" type="checkbox"/> occupied	<input type="checkbox"/> agriculture <input type="checkbox"/> museum
<input checked="" type="checkbox"/> building(s)	<input checked="" type="checkbox"/> private	<input type="checkbox"/> unoccupied	<input type="checkbox"/> commercial <input type="checkbox"/> park
<input type="checkbox"/> structure	<input type="checkbox"/> both	<input type="checkbox"/> work in progress	<input type="checkbox"/> education <input checked="" type="checkbox"/> private
<input type="checkbox"/> site	Public Acquisition	Accessible	<input type="checkbox"/> entertainment <input type="checkbox"/> residence
<input type="checkbox"/> object	<input type="checkbox"/> in process	<input type="checkbox"/> yes: restricted	<input type="checkbox"/> government <input type="checkbox"/> religious
	<input type="checkbox"/> being considered	<input type="checkbox"/> yes: unrestricted	<input type="checkbox"/> industrial <input type="checkbox"/> scientific
	<input checked="" type="checkbox"/> not applicable	<input checked="" type="checkbox"/> no	<input type="checkbox"/> military <input type="checkbox"/> other:
			<input type="checkbox"/> transportation

4. Owner of Property: (give names and mailing addresses of all owners)

name Evelyn M. Bean

street & number 2509 Briggs Chaney Road

telephone no.:

city, town Silver Spring

state and zip code MD 20904

5. Location of Legal Description

Land Records Office of Montgomery County

liber 4334

street & number Montgomery County Judicial Center

folio 16

city, town Rockville

state MD

6. Representation in Existing Historical Surveys

title

date ☐ federal ☐ state ☐ county ☐ local

depository for survey records

city, town

state

7. Description

Survey No. M:34-27

Condition

☐ excellent
☐ good
☒ fair

☐ deteriorated
☐ ruins
☐ unexposed

Check one

☐ unaltered
☒ altered

Check one

☒ original site
☐ moved

date of move _____

Resource Count: 2

Prepare both a summary paragraph and a general description of the resource and its various elements as it exists today.

The Odorian Robey Property is a 2-story, 3-bay I-house located at the southeast corner of the intersection of Briggs Chaney Road and Wildwood Drive in the Fairland vicinity, Montgomery County. Constructed in 1903, the building is L-shaped in plan consisting of the side-gable I-house and a rear ell. A 1-story shed roof addition is attached to the rear of the ell.

The structure has a standing seam metal roof and two interior brick chimneys. The first chimney is located at the east gable end, while the second chimney is located at the intersection of the I-house and rear ell. The building is of wood-frame construction covered with asbestos shingle siding, and it has a parged foundation. The windows are wood double-hung and awning. The house has a 1-story hipped roof porch on the front elevation and a shed roof porch on the rear elevation of the I-house. The front porch has a standing seam metal roof and four square wood posts with decorative wooden brackets. The porch floor and railings have been replaced with a new materials.

The north, or front facade has a central entryway consisting of a wood panel door with a single-light. To the east of the entry, on the first story, is a 2/2 double-hung window. The lights of the double-hung window are horizontally divided, a twentieth century window type rather than the late nineteenth century vertically divided 2/2 windows. West side of the entry is a 6/6 double-hung window. The second story has three windows vertically aligned over the first story openings. The windows are two 6/6 double-hung and one 6/2 double-hung.

The east elevation of the I-house has only one opening, a horizontally divided 2/2 double-hung window on the first story. The east elevation of the rear ell has a wood panel door with a single-light within the rear porch and a 6-light awning window on the first story. The second story has a 6/6 double-hung window. The east elevation of the shed roof addition to the rear ell has a 3-panel wood door with 3-lights.

The south, or rear elevation of the I-house has an entryway consisting of a wood panel door with 4-lights within the rear porch. The porch has a shed roof covered with standing seam metal and is supported by two wood posts. The second story has a 6/2 double-hung window. The rear elevation of the ell has a 1/1 double-hung window on the second story. The rear elevation of the shed roof addition has a 1/1 double-hung window and a single-light awning window.

The west elevation has a 1-story hipped roof porch. The porch extends across the I-house and rear ell and has a concrete slab floor, three wood posts and a standing seam metal roof. Within the porch is a three-sided bay addition. The bay projects from the first story of the I-house. The central bay has a pair of 1/1 double-hung windows, and is flanked by single 1/1 double-hung windows in the other bays. The second story of the I-house has a 6/6 double-hung window. The first story of the rear ell has a 2-panel wood door with a single-light located within the hipped roof porch. The second story has a single 1/1 double-hung window. There is no fenestration on the west elevation of the shed roof addition to the rear ell.

There is one outbuilding associated with this property. A 1½-story garage is located east of the house at the end of a driveway which extends south from Briggs Chaney Road. Constructed circa 1905, the garage is of wood-frame construction with a corrugated metal roof and asbestos shingle siding. The south elevation has an asphalt shingle siding. The first story has two wagon entrances with wood double-doors. The second story has two awning windows.

CONTINUATION SHEET

MARYLAND HISTORICAL TRUST

STATE HISTORIC SITES INVENTORY FORM

RESOURCE NAME: Odorian Robey Property

SURVEY NO.: M:34-27

ADDRESS: 2509 Briggs Chaney Road, Fairland vicinity, Montgomery County

7. Description (Continued)

The property is located on the south side of Briggs Chaney Road and the east side of Wildwood Drive, with residential property on all sides. The residential development immediately adjacent to the property occurred after the subdivision of the house's historically associated land.

8. Significance

Survey No. M:34-27

Period	Areas of Significance—Check and justify below			
<input type="checkbox"/> prehistoric	<input type="checkbox"/> archaeology-prehistoric	<input type="checkbox"/> Community planning	<input type="checkbox"/> landscape architecture	<input type="checkbox"/> religion
<input type="checkbox"/> 1400-1499	<input type="checkbox"/> archeology-historic	<input type="checkbox"/> conservation	<input type="checkbox"/> law	<input type="checkbox"/> science
<input type="checkbox"/> 1500-1599	<input type="checkbox"/> agriculture	<input type="checkbox"/> economics	<input type="checkbox"/> literature	<input type="checkbox"/> sculpture
<input type="checkbox"/> 1600-1699	<input type="checkbox"/> architecture	<input type="checkbox"/> education	<input type="checkbox"/> military	<input type="checkbox"/> social/
<input type="checkbox"/> 1700-1799	<input type="checkbox"/> art	<input type="checkbox"/> engineering	<input type="checkbox"/> music	<input type="checkbox"/> humanitarian
<input type="checkbox"/> 1800-1899	<input type="checkbox"/> commerce	<input type="checkbox"/> exploration/settlement	<input type="checkbox"/> philosophy	<input type="checkbox"/> theater
<input checked="" type="checkbox"/> 1900-	<input type="checkbox"/> communication	<input type="checkbox"/> industry	<input type="checkbox"/> politics/government	<input type="checkbox"/> transportation
		<input type="checkbox"/> invention		<input type="checkbox"/> other:

Specific dates	1903	Builder/Architect	Unknown
----------------	------	-------------------	---------

check: Applicable Criteria: ☐ A ☐ B ☐ C ☐ D
and/or
Applicable Exceptions: ☐ A ☐ B ☐ C ☐ D ☐ E ☐ F ☐ G
Level of Significance: ☐ national ☐ state ☐ local

Prepare both a summary paragraph of significance and a general statement of history and support.

The Odorian Robey Property was originally situated on an approximately 16 hectare (39 acre) parcel of land, part of a tract of land historically known as "Snowden's Mill". During the mid-nineteenth century, Joshua Brown was a large land owner in the Fairland vicinity. In 1899, the western half of Joshua Brown's estate was transferred from Thomas and Harriet Robey to Odorian Robey. The western half of the estate contained 16 hectares (39 acres). According to the tax records of Montgomery County, a house was constructed on the property in 1903. Odorian Robey sold the house and 16 hectares (39 acres) to Harry Harding in 1906. Harding began to subdivide the property into the "Harding Subdivision, near Fairland" as early as 1940. The parcel containing the house became Lot 1 of the subdivision and contained 2.46 hectares (6.086 acres) according to Plat 1308 in Plat Book 21. Lot 1 was sold to C.L. and Mildred Stringer in 1957. The Stringers sold the house and land to Carlton and Evelyn Bean in 1958. Sole ownership of the property was transferred to Evelyn Bean, the current owner, in 1973. After further subdivision the parcel is known as Lot 15 and contains .42 hectares (1.04 acres) of land. The Odorian Robey Property, constructed in 1903, does not appear on Martenet and Bond's 1865 Map of Montgomery County or Hopkins' 1879 Atlas of Montgomery County.

The Odorian Robey Property is located in the Fairland vicinity. Fairland is located on land originally patented to Archibald Edmonston in 1720 as "Deer Park" in what was then Prince George's County. "Deer Park" was grant of 276 hectares (682 acres) of land between the Paint Branch and Little Paint Branch, and from approximately Randolph Road to Briggs Chaney Road (Boyd 1879: 38). The Odorian Robey Property is located in the north portion of the original patent. The settlement of the Fairland area clustered around the present-day intersection of the Old Columbia Pike and Fairland Road, three miles east of Colesville. In 1879, Fairland had fifty residents, a church, school house and store (Boyd 1879, 128). Today, the Fairland area has been infilled with housing developments and shopping centers.

The house on the Odorian Robey Property is an I-house constructed in 1903. The standard I-house is one room deep and two stories tall with three to five openings on each story. Chimneys are located on the interior of the gable ends, however, external chimneys are characteristic in the Chesapeake region. Usually, an I-house has a one-story porch running the length or nearly the length of the long side. On the interior, a central hall separates the two rooms on the first floor; the second floor contains either two or four sleeping chambers. Due to the narrowness of the main core, many I-houses have kitchen wings to the rear. During the Victorian period, pre-cut detailing or a two-tiered porch was commonly grafted onto the traditional I-house. The I-form was popular into the early twentieth century, with examples appearing in catalogs of mass-produced suburban houses (Gowans 1992, 55-6).

CONTINUATION SHEET

MARYLAND HISTORICAL TRUST

STATE HISTORIC SITES INVENTORY FORM

RESOURCE NAME: Odorian Robey Property

SURVEY NO.: M:34-27

ADDRESS: 2509 Briggs Chaney Road, Fairland vicinity, Montgomery County

8. Significance (Continued)

NATIONAL REGISTER EVALUATION:

The Odorian Robey Property, constructed in 1903, is not eligible for the National Register of Historic Places. The property is not eligible under Criterion A, as research conducted indicates no association with any historic events or trends significant in the development of national, state or local history. Historic research indicates that the property has no association with persons who have made specific contributions to history, and therefore, it does not meet Criterion B. The property is not eligible under Criterion C, as it is an undistinguished example of a common building type. The integrity of the property has been compromised by the replacement of various windows, the shed roof addition to the rear ell and the deteriorated condition of the property's only outbuilding. In addition, the site integrity has been altered by the development of the surrounding parcels, on its historically associated lands. Finally, the property has no known potential to yield important information, and therefore, is not eligible under Criterion D.

MARYLAND HISTORICAL TRUST

Eligibility recommended _____ Eligibility Not Recommended X

Comments: _____

Reviewer, OPS: E. Hannold/K. Williams Date: 8/26/1998

Reviewer, NR Program: *B. Kurtz* Date: 2/4/02

9. Major Bibliographical References

Survey No.M:34-27

See Continuation Sheet

10. Geographical Data

Acreage of nominated property _____
Quadrangle name Beltsville, MD

Quadrangle scale 1:24,000

Verbal boundary description and justification

List all states and counties for properties overlapping state or county boundaries

state	code	county	code
-------	------	--------	------

state	code	county	code
-------	------	--------	------

11. Form Prepared By

name/title Caroline Hall/Tim Tamburrino

organization P.A.C. Spero & Company

date October 1996

street & number 40 W. Chesapeake Avenue, Suite 412

telephone (410) 296-1635

city or town Baltimore

state Maryland

The Maryland Historic Sites Inventory was officially created by an Act of the Maryland Legislature to be found in the Annotated Code of Maryland, Article 41, Section 181 KA, 1974 supplement.

The survey and inventory are being prepared for information and record purposed only and do not constitute any infringement of individual property rights.

return to: Maryland Historical Trust
DHCP/DHCD
100 Community Place
Crownsville, MD 21032-2023
(410) 514-7600

CONTINUATION SHEET

MARYLAND HISTORICAL TRUST

STATE HISTORIC SITES INVENTORY FORM

RESOURCE NAME: Odorian Robey Property

SURVEY NO.: M:34-27

ADDRESS: 2509 Briggs Chaney Road, Fairland vicinity, Montgomery County

9. Major Bibliographical References (Continued)

- Boyd, T.H.S. The History of Montgomery County, Maryland, From its Earliest Settlement in 1650 to 1879. Baltimore: Regional Publishing Company, 1968.
- Brugger, Robert A. Maryland, A Middle Temperament 1634-1980. Baltimore and London: Johns Hopkins University Press, 1988.
- Coleman, Margaret Marshall. Montgomery County: A Pictorial History. Norfolk and Virginia Beach: The Donning Company Publishers, 1984, rev. 1990.
- Farquhar, Roger Brooke. Old Homes and History of Montgomery County, Maryland. Washington: Judd and Detweiller, Inc., 1962.
- Gottfried, Herbert and Jan Jennings. American Vernacular Design, 1870-1940. Ames, Iowa: Iowa State University Press, 1988.
- Gowans, Alan. Styles and Types of North American Architecture. New York: Harper Collins, 1992.
- Liebert, Ray Eldon, and Richard K. MacMaster. A Grateful Remembrance: the Story of Montgomery County, Maryland. Rockville, Maryland: Montgomery County Government and the Montgomery County Historical Society, 1976.
- Hopkins, G.M. Atlas of 15 Miles Around Washington including County of Montgomery, Maryland. Philadelphia: G.M. Hopkins, 1879; reprint, Rockville, Maryland: Montgomery County Historical Society, 1975.
- Land Records of Montgomery County, Maryland.
- Martenet, Simon J. Martenet and Bond's Map of Montgomery County, Maryland. Baltimore, Maryland: Simon J. Martenet, 1865; reprint, Rockville, Maryland: Montgomery County Historical Society.
- Tindall, George Brown. America: A Narrative History. 2 vols. New York: W.W. Norton & Company, Inc., 1984.
- Town of Washington Grove Planning Commission. National Register of Historic Places Inventory-Nomination Form: Town of Washington Grove. 1978.

CONTINUATION SHEET

MARYLAND HISTORICAL TRUST

STATE HISTORIC SITES INVENTORY FORM

RESOURCE NAME: Odorian Robey Property

SURVEY NO.: M:34-27

ADDRESS: 2509 Briggs Chaney Road, Fairland vicinity, Montgomery County

10. Geographical Data

Resource Sketch Map:

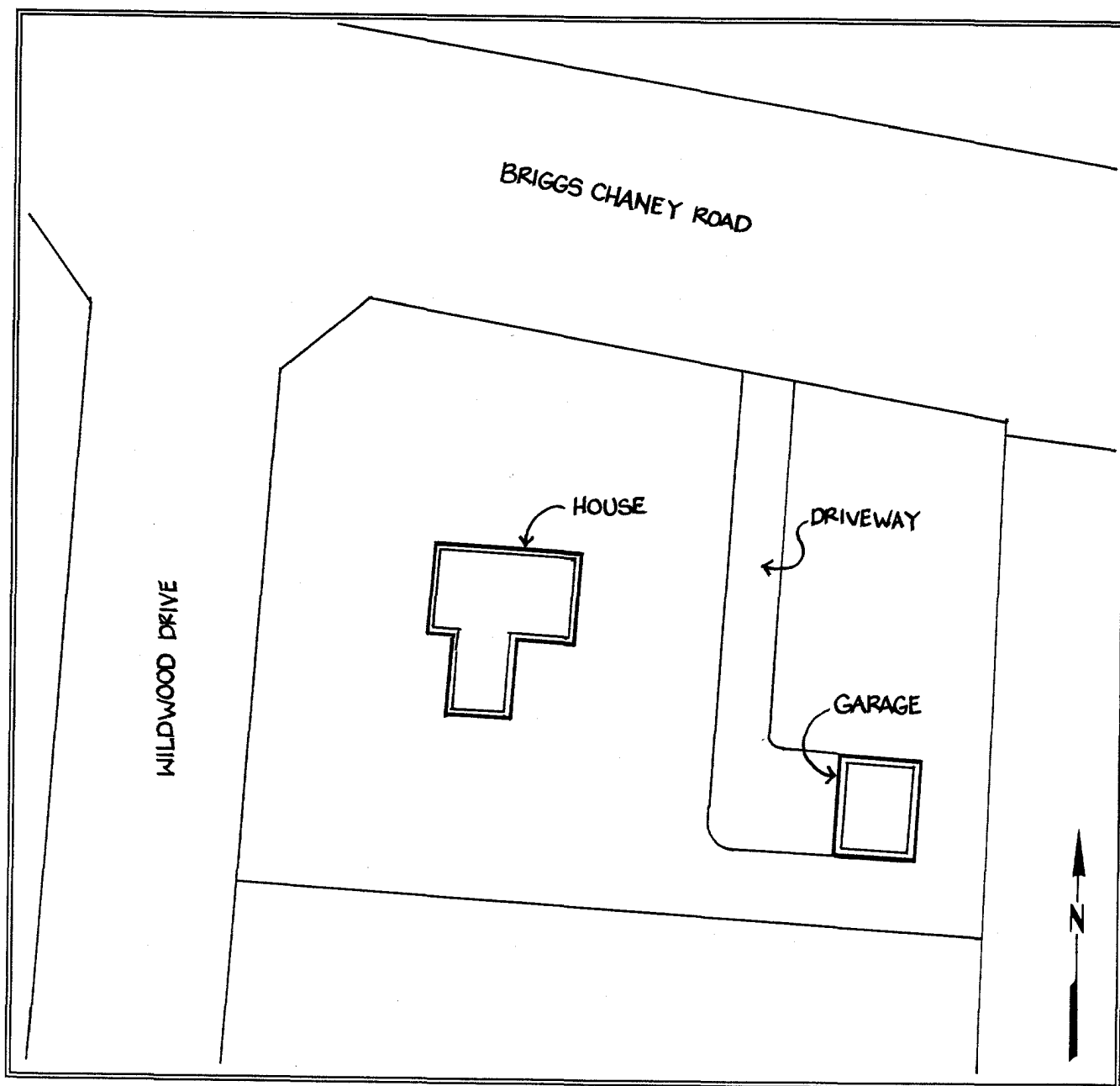

CONTINUATION SHEET

MARYLAND HISTORICAL TRUST

STATE HISTORIC SITES INVENTORY FORM

RESOURCE NAME: Odorian Robey Property

SURVEY NO.: M:34-27

ADDRESS: 2509 Briggs Chaney Road, Fairland vicinity, Montgomery County

Maryland Comprehensive Historic Preservation Plan Data Sheet

Historic Context:

MARYLAND COMPREHENSIVE PRESERVATION PLAN DATA

Geographic Organization: Piedmont

Chronological/Developmental Period Theme (s):

11. Industrial/Urban Dominance A.D. 1870-1930

Prehistoric/Historic Period Theme(s):

2. Architecture

RESOURCE TYPE:

Category (see Section 3 of survey form):

Building

Historic Environment (urban, suburban, village, or rural):

Suburban

Historic Function(s) and Use(s):

Dwelling

Known Design Source (write none if unknown):

None

Preparer:

P.A.C. Spero & Company

October 1996

**Inter County Connector Project
Upgrade Existing Roads Alternative
Quad BELTSVILLE**

Survey No. **M: 34-27**

ODORIAN ROBEY PROPERTY





1) M 34-77

2) 2001-02 Robey Property

3) Montgomery County, MD

4) Tim Tambling, MD

5) October 1996

6) F.A.C. Steno & Company, Towson, MD 21204

7) 2509 Briggs Clancy Road, northeast corner
new SW

8) 1 of 6



1) M: 34-27

2) Odorian Robey Property

3) Montgomery County, MD

4) Tim Tamburino

5) October 1996

6) P.A.C. Speed & Company, Towson, MD 21204

7) 2509 Briggs Chaney Road, front elevation
view S

8) 3 of 6



1) M34-27

2) Odoriam Robay Property

3) Montserrat, MD

4) Tim Tamburrino

5) October 1996

6) F.A.C. Spore & Company, Towson, MD 21204

7) 509 Briques Grande Road, east elevation

8) 2 of 6

view W



1) M: 34-27

2) Cecilian Robey Property

3) Montgomery County, MD

4) In Taxing

5) October 1978

6) P.A.C. Spore & Company, Towson, MD 21204

7) 2009 Eagle Church Road, west elevation
view east

8) d.d.s.



- 1) N. 34-27
- 2) Osman Rebay Property
- 3) Montgomery County, MD
- 4) Tim Tamburino
- 5) October 1996
- 6) PA C. Sproul Company, Towson, MD 21204
- 7) 209 Trigg - Chertow Road, room elevation
view N
- 8) 5 of 6



1) M: 34-27

2) Odorion Robey Property

3) Montgomery, MD

4) Tim Tamburrino

5) October, 1996

6) P.A.C. Space & Co., Towson MD 21204

7) 2509 Bungee Chaucery Road, garage

8) 6 of 6

view east