

SURVEYOR'S CERTIFICATE

I HEREBY CERTIFY THE PLAN SHOWN HEREON IS CORRECT; THAT IT IS A SURVEY OF ALL OF THE LAND CONVEYED BY FRANCES L. HAINES, WIDOW, TO THE MARYLAND-NATIONAL CAPITAL PARK AND PLANNING COMMISSION, BY DEED DATED DECEMBER 12, 1974, AND RECORDED AMONG THE LAND RECORDS OF MONTGOMERY COUNTY, MARYLAND, IN LIBER 4600 AT FOLIO 825; AND ALSO A SURVEY OF PART OF THAT LAND CONVEYED BY DOUGLAS RIGGS RAY AND MARY C. RAY, HIS WIFE, AND PAUL FRANKLIN RAY AND PEGGY L. RAY, HIS WIFE, TO HAINES CONSTRUCTION CO., INC., BY DEED DATED MARCH 24, 1966, AND RECORDED IN LIBER 3484 AT FOLIO 69; AND THAT PROPERTY CORNER MARKERS ARE IN PLACE WHERE INDICATED.

DATE: 1-21-75

Francis J. Tacik

FRANCIS J. TACIK

PROFESSIONAL LAND SURVEYOR
MD. NO. 9164

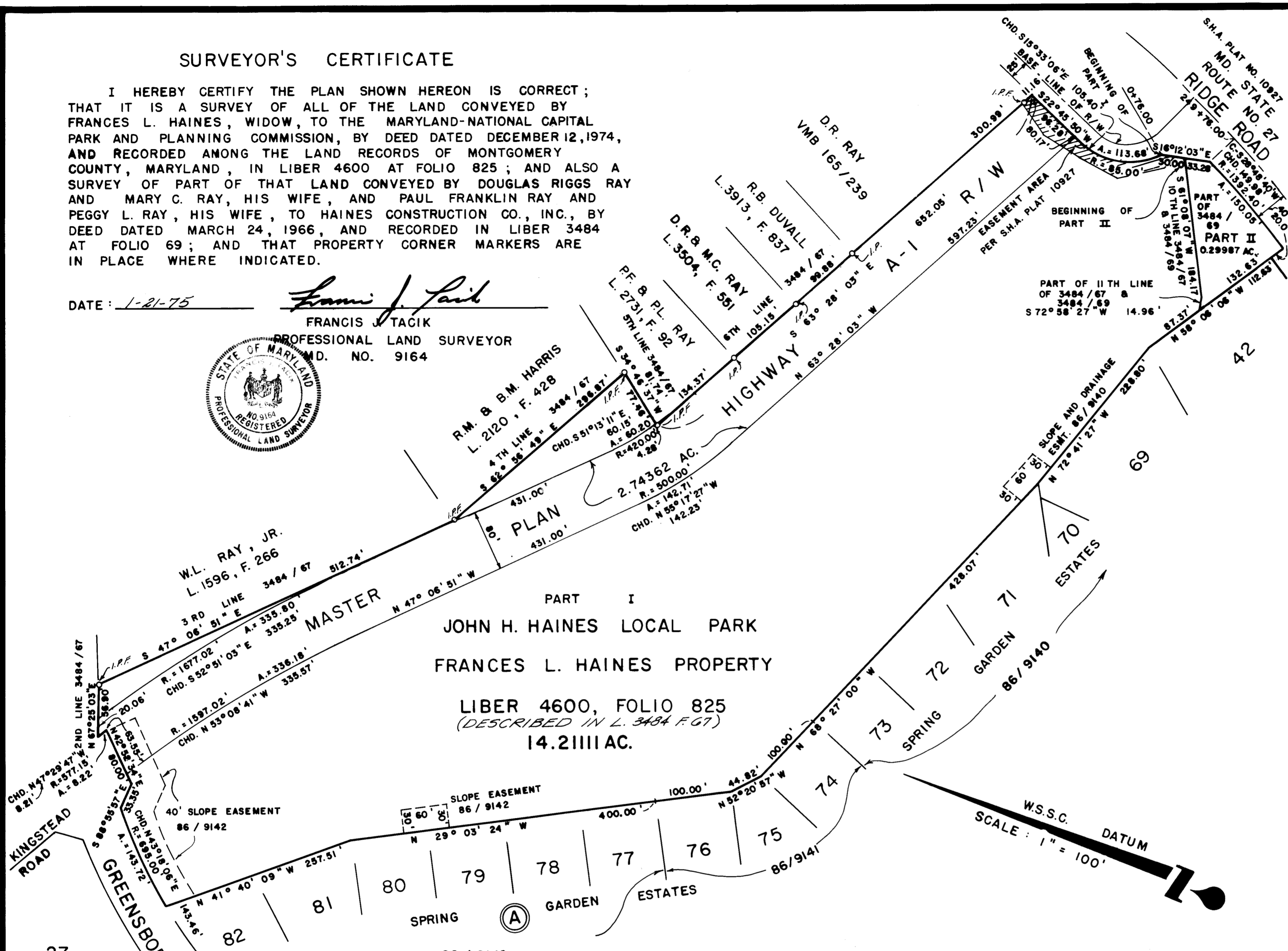

PLAT OF SURVEY
**JOHN H. HAINES LOCAL PARK -
 FRANCES L. HAINES PROPERTY**

LIBER 4600, FOLIO 825
 DAMASCUS ELECTION DISTRICT NO. 12
 MONTGOMERY COUNTY, MARYLAND

SCALE: 1" = 100'
 JANUARY, 1975

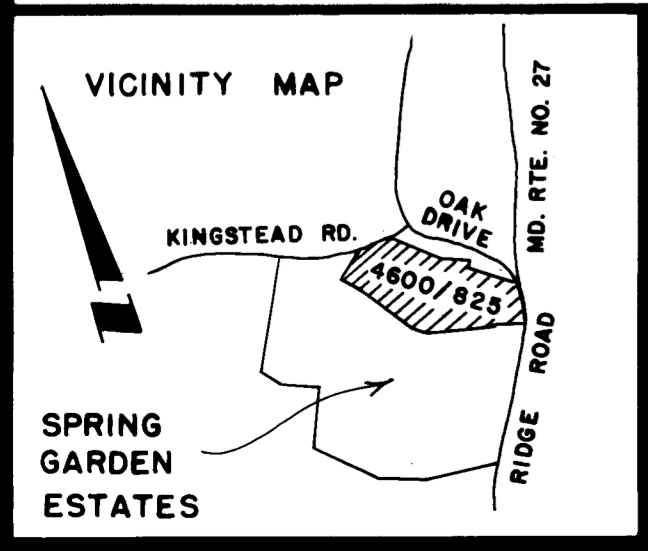

ELDON E. SNIDER & ASSOCIATES
 LAND SURVEYORS
 LAND PLANNING CONSULTANTS
 467 N. FREDERICK AVENUE, GAITHERSBURG, MARYLAND 20760
 248-5100

NEIGHBORHOOD PARK

74-1085