

SITE PLAN  
 OLNEY SQUARE N.P.  
 ASBUILT PLAY AREA 08-14-97  
 ML,MM,MS,

File name: N:\PROJECTS\SURVEY\OLNEY SQ\ASBUILTS\PLAYAREA\AS081497

SCALE: 1" = 10'

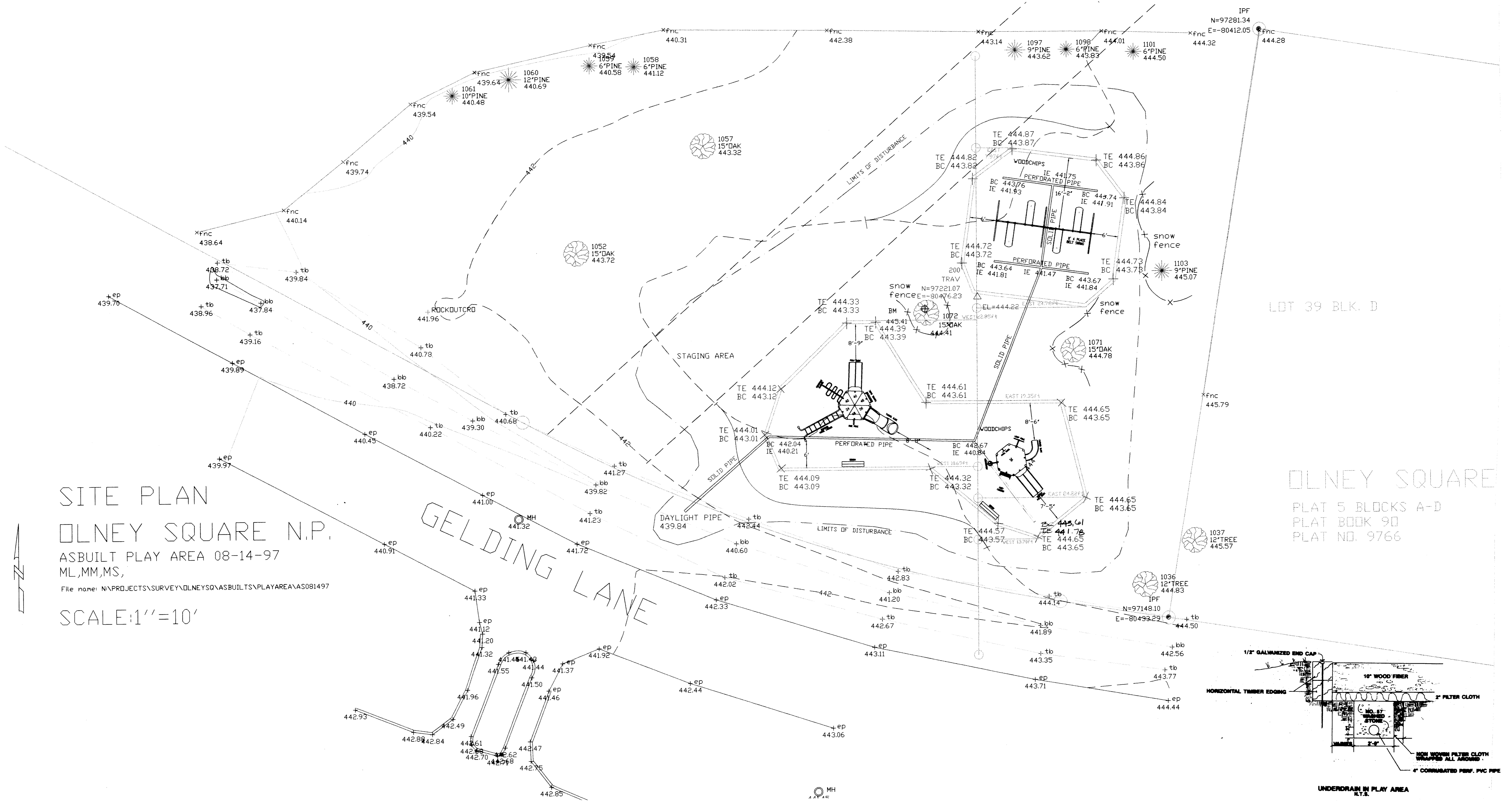

LOT 39 BLK. D  
 OLNEY SQUARE  
 PLAT 5 BLOCKS A-D  
 PLAT BOOK 90  
 PLAT NO. 9766

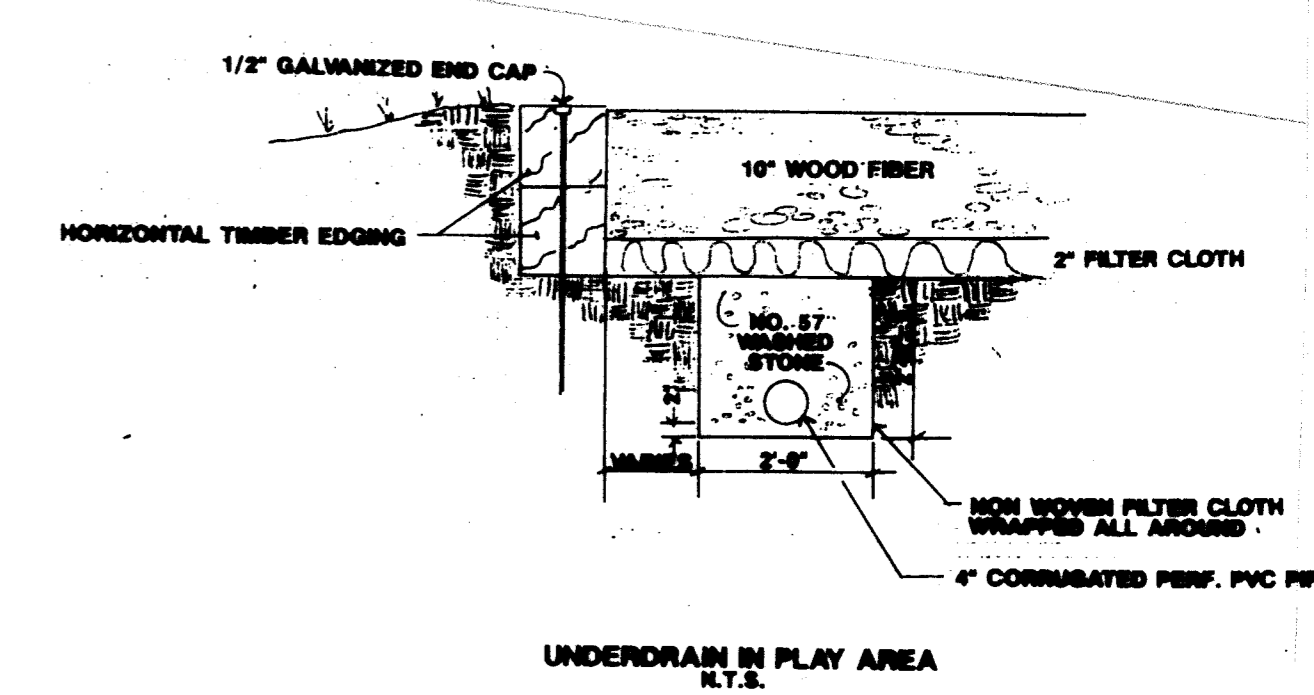

|   |   |   |
|---|---|---|
| design<br><i>[Signature]</i><br>landscape architect | review and approval<br><i>[Signature]</i> 2/4/98<br>park planning and development | review and approval<br>deputy director of parks |
| architect   | central maintenance<br><i>[Signature]</i> 2/5/98                                  | park police                                     |
| engineer  | region<br><i>[Signature]</i> 2/5/98   |   |
| drawn by  | natural resources   |   |

**The Maryland-National Capital Park and Planning Commission**  
 9500 Brunett Avenue  
 Silver Spring, Maryland 20901  
 Montgomery County Department of Parks  
 (301) 495-2535

|             |                                   |
|-------------|-----------------------------------|
| revision:   | project :                         |
|             | OLNEY SQUARE<br>NEIGHBORHOOD PARK |
| description | date                              |