

NOTES:

1. DEED REFERENCES -
LIBER 2937, FOLIO 129
LIBER 1004, FOLIO 351
2. TOTAL AREA = 12.7562 ACRES
3. FOR COMPLETE BOUNDARY AND COORDINATE DATA SEE PLAT OF SURVEY "GLEN HILLS RECREATION CENTER" BY ELDON E. SNIDER & ASSOCIATES, LAND SURVEYORS, SEPT 1966.

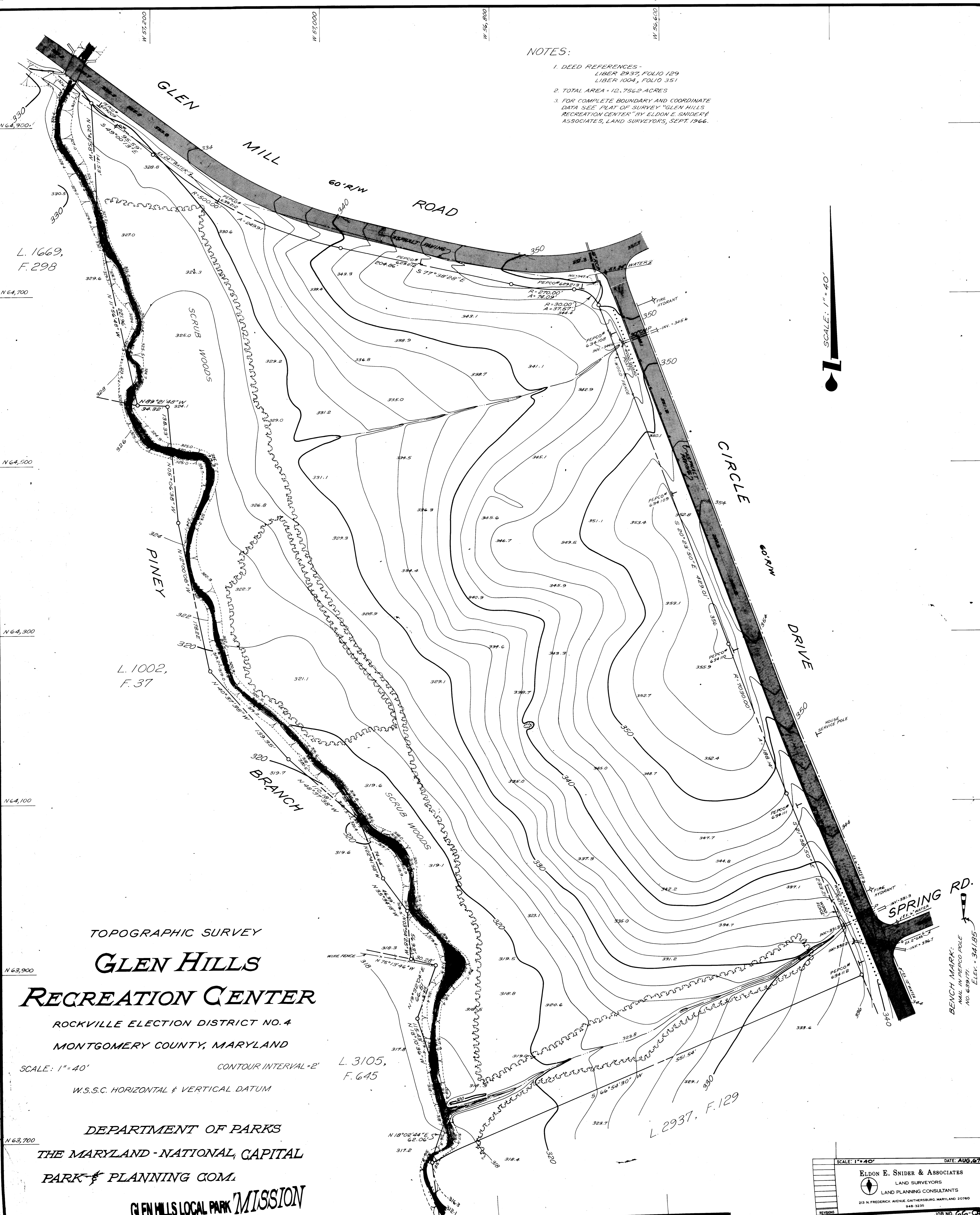

SCALE: 1" = 40'

L. 1669, F. 298

L. 1002, F. 37

L. 3105, F. 645

L. 2937, F. 129

BENCH MARK:
NAIL IN PEPCO POLE
NO. 639171
ELEV. = 341.85

TOPOGRAPHIC SURVEY
**GLEN HILLS
RECREATION CENTER**

ROCKVILLE ELECTION DISTRICT NO. 4
MONTGOMERY COUNTY, MARYLAND

SCALE: 1" = 40' CONTOUR INTERVAL = 2'
W.S.S.C. HORIZONTAL & VERTICAL DATUM

DEPARTMENT OF PARKS
THE MARYLAND - NATIONAL CAPITAL
PARK & PLANNING COM.

GLEN HILLS LOCAL PARK MISSION

SCALE: 1" = 40' DATE: AUG. 67

ELDON E. SNIDER & ASSOCIATES
LAND SURVEYORS
LAND PLANNING CONSULTANTS
213 N. FREDERICK AVENUE, GAITHERSBURG, MARYLAND 20780
948-3235

FILE DRAW. NO. JOB NO. 66-081