

1. All on-site water main construction and materials to be in accordance with the applicable codes and standards.
2. All water pipe to be installed from customer meter to the building and shall be installed in a trench with a minimum depth of 48 inches.
3. Construction to meet inspection and acceptance of existing water main.
4. Approval of this plan does not constitute a compliance for any other code.
5. The contractor shall be responsible for the installation of the water main and shall be responsible for the installation of the water meter and the water meter cap.
6. The contractor shall be responsible for the installation of the water meter and the water meter cap.
7. The contractor shall be responsible for the installation of the water meter and the water meter cap.
8. The contractor shall be responsible for the installation of the water meter and the water meter cap.
9. The contractor shall be responsible for the installation of the water meter and the water meter cap.
10. The contractor shall be responsible for the installation of the water meter and the water meter cap.
11. All water pipe to have a minimum of 4.0' of cover below finished grade.

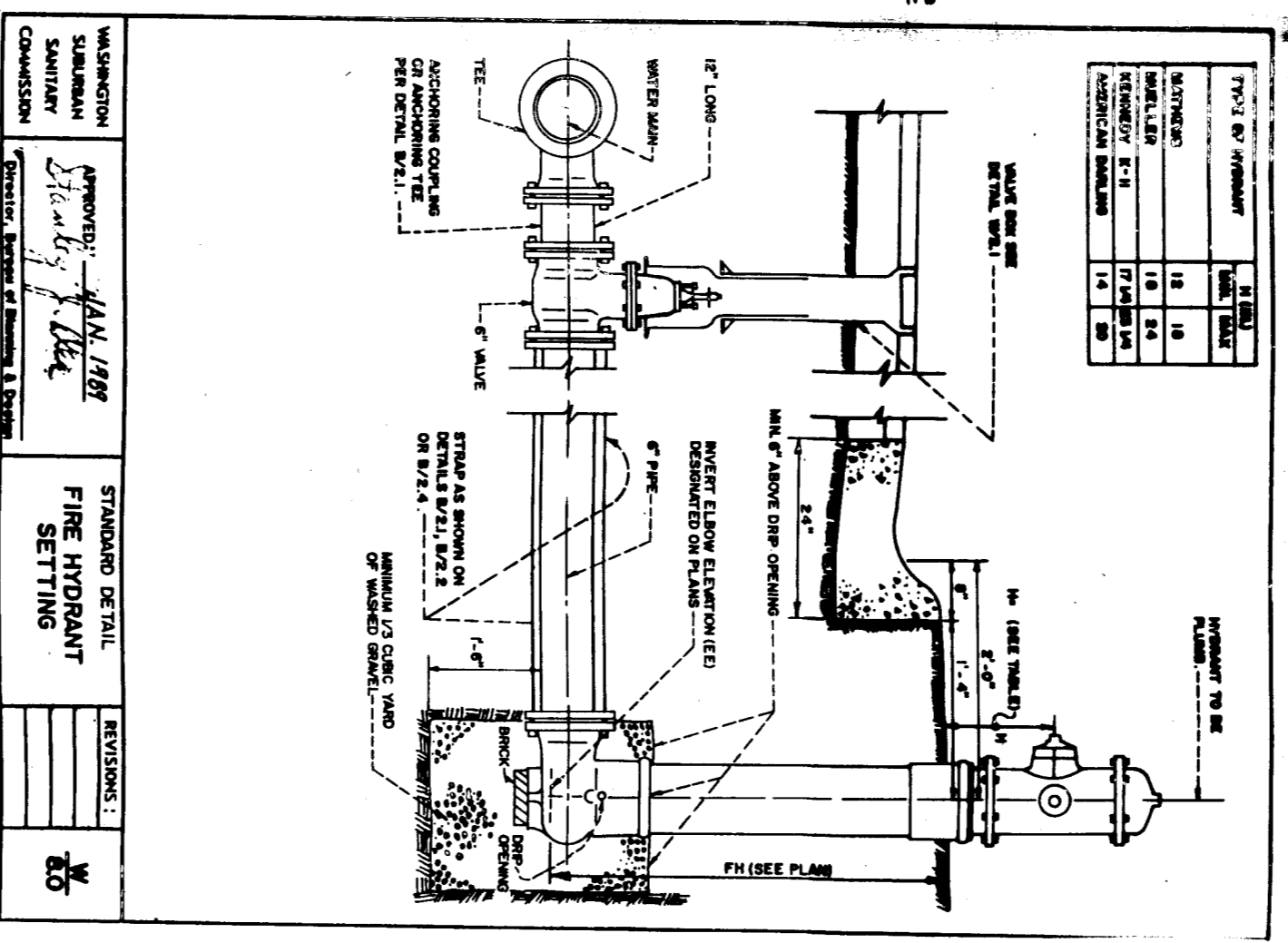

**ITEM NO. 2050-24 - HYDRANT CONNECTION DETAIL**

ITEM NO.	DESCRIPTION	QUANTITY	REMARKS
1	HYDRANT CAP	1	
2	HYDRANT VALVE	1	

**WATER PIPE SCHEDULE**

ITEM NO.	DESCRIPTION	QUANTITY	REMARKS
1	DUCTILE IRON CLASS 50	15'	
2	DUCTILE IRON CLASS 50	98'	
3	DUCTILE IRON CLASS 50	24'	

**LIST OF MATERIALS**

ITEM NO.	DESCRIPTION	QUANTITY	REMARKS
1	DUCTILE IRON CLASS 50	15'	
2	DUCTILE IRON CLASS 50	98'	
3	DUCTILE IRON CLASS 50	24'	

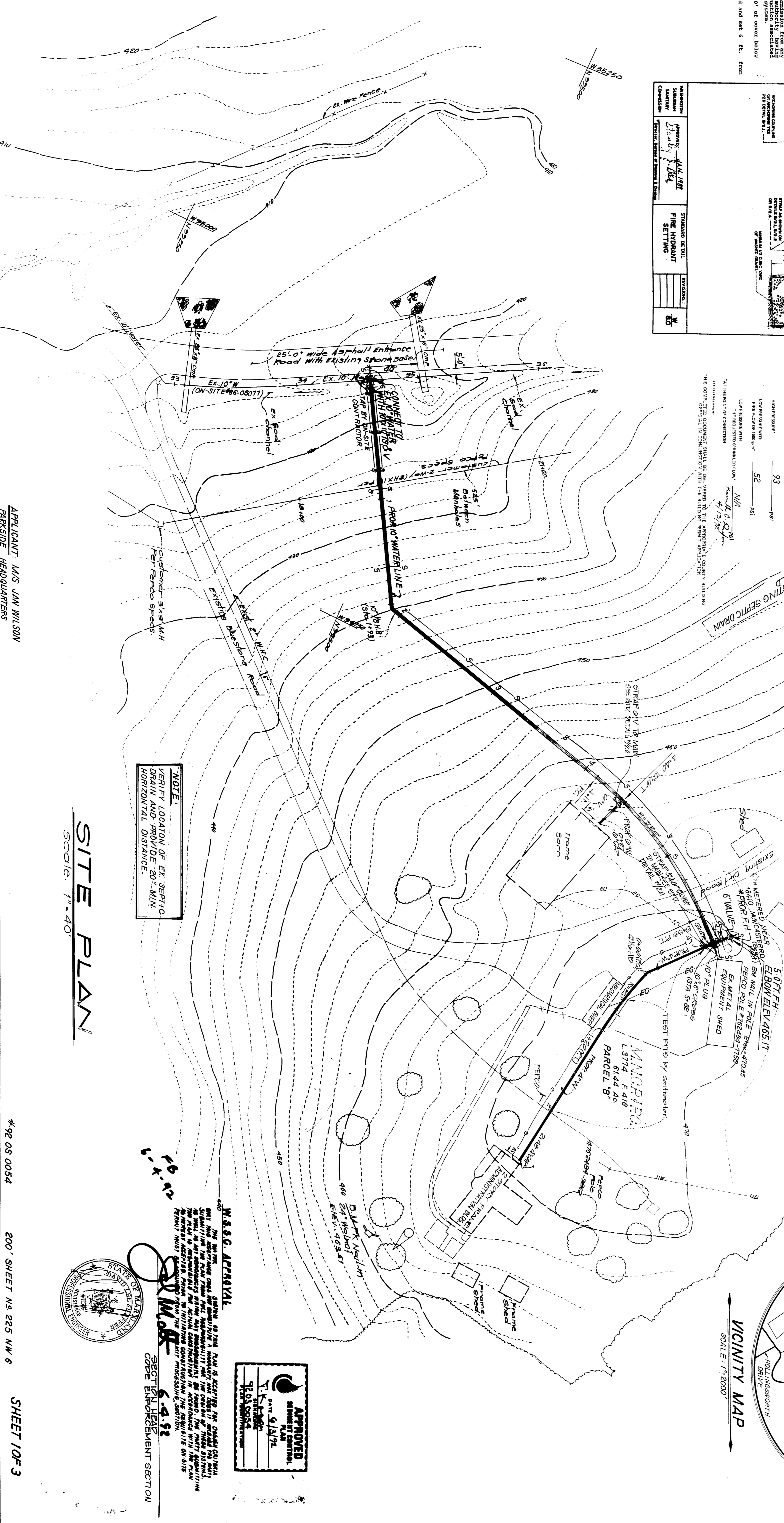
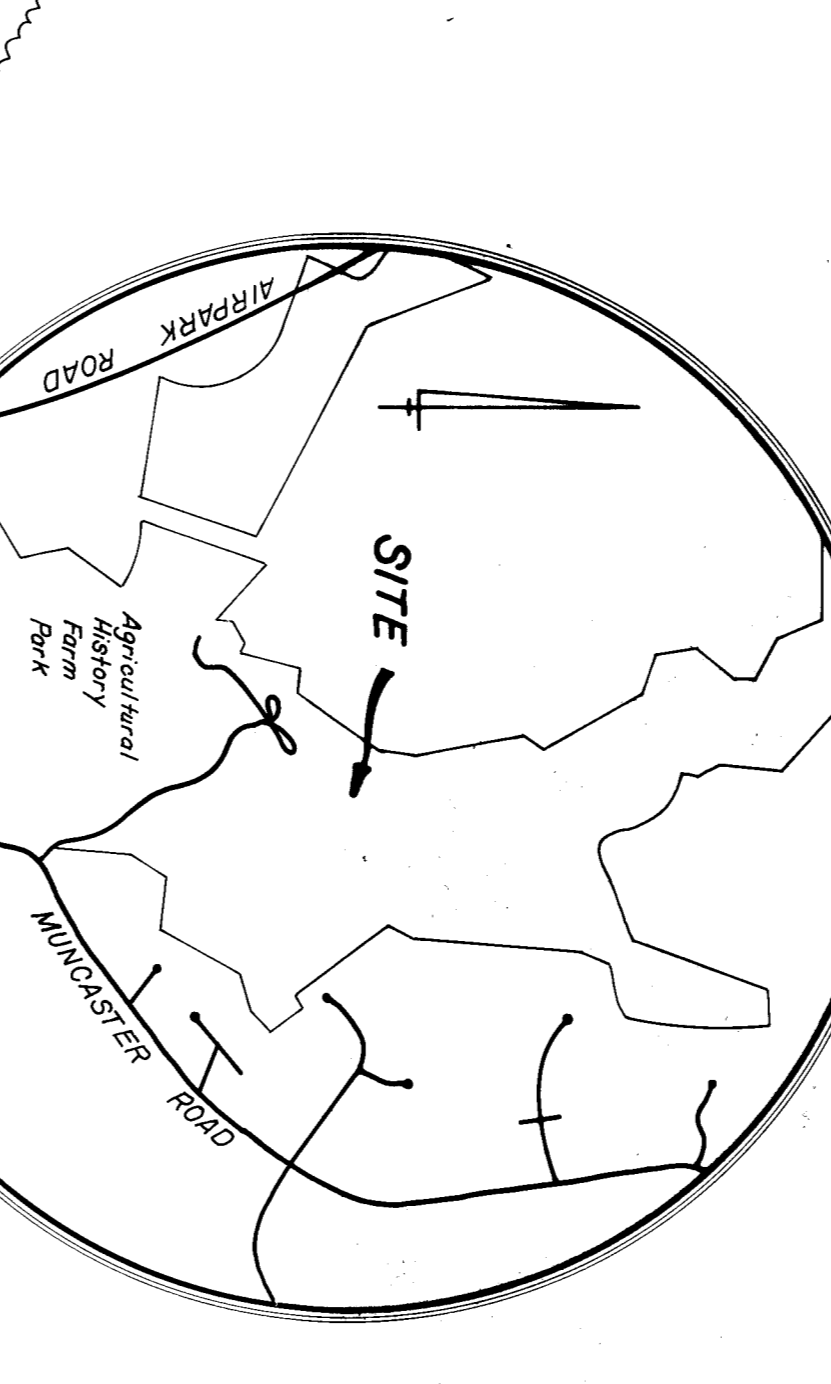
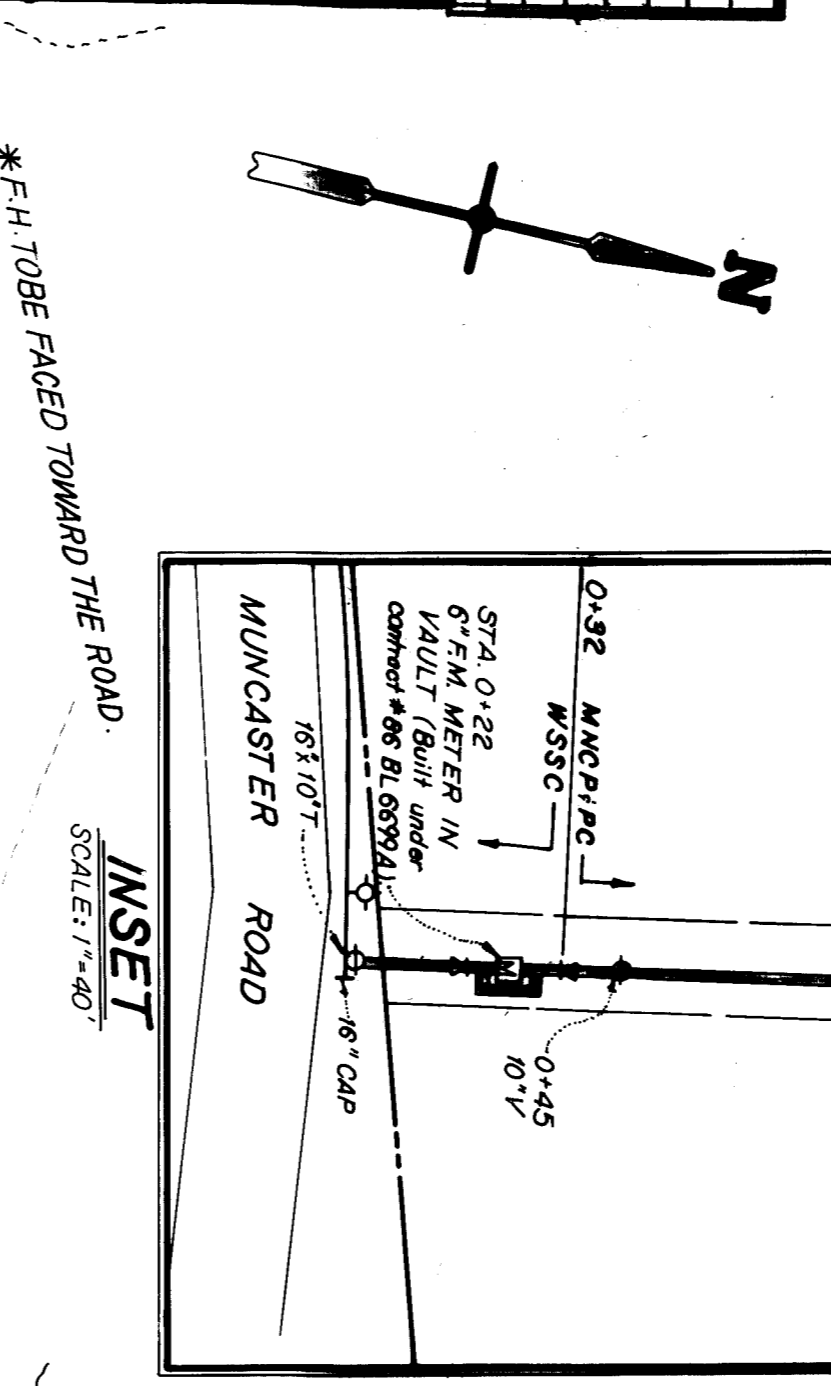

APPLICANT: M/S. JAN WILSON  
 ADDRESS: 1400 SILVER SPRING AVENUE  
 SILVER SPRING, MD 20901  
 TEL: (301) 493-6344

SHAFFER BATTA & ASSOC., INC.  
 ENGINEERS/LAND PLANNERS/SURVEYORS  
 304 WIND RIVER LANE  
 GAITHERSBURG, MARYLAND 20878  
 (301) 417-0344  
 CONTACT: DWG E. SHAFFER

ON SITE WATER EXTENSION PLAN  
 AGRICULTURAL HISTORY FARM PARK  
 MONTGOMERY COUNTY, MARYLAND  
 DATE: 6/15/92

**APPROVED**  
 STATE OF MARYLAND  
 DEPARTMENT OF THE ENVIRONMENT  
 DATE: 6/15/92

**WATER**  
 STATE OF MARYLAND  
 DEPARTMENT OF THE ENVIRONMENT  
 DATE: 6/15/92

**WATER**  
 STATE OF MARYLAND  
 DEPARTMENT OF THE ENVIRONMENT  
 DATE: 6/15/92