

K.B. MOORE et al,  
PARCEL 3  
AREA = 48.5670 AC.  
5369/247  
P-167

CLIFTON W. McDONALD ETAL.  
PARCEL 2  
13467/179  
P-359

CHARLES H. JAMISON INC.  
208.30 AC.  
10613/793

PARCEL 4  
TOTAL = 100.3708 AC.

MOORE TO  
RICKMAN  
OCT. 8, 1986  
7346/552

**SURVEYOR'S CERTIFICATE**

I, hereby certify that the plan shown hereon is correct according to conveyance from BLANCHE MENIDE MOORE, ETUX. to WILLIAM M. RICKMAN for parcels 2 and 4, described in said deed recorded in Liber 7906 at Folio 552, among the land records of Montgomery County, Maryland.

NOTES: This plot is not a boundary survey prepared from deeds records. Property corners not guaranteed by this plan. No title reported furnished for this plan. Subject to Rights of Way and Easements of Record.

April 9, 1997  
JOHN E. POOLE, JR. SURVEYOR  
PROPERTY LINE SURVEYOR # 588



PLAT - OF  
PARTS OF TRACTS OF LAND CALLED  
"ALBANY" & ETC.  
PART OF THE WILLIAM. RICKMAN PROPERTY  
BARNESVILLE (11TH) DISTRICT  
MONTGOMERY COUNTY, MARYLAND  
SCALE: 1" = 200' MARCH - 1997

R.K. MADDOX SURVEYS  
115 PARK AVENUE  
ROCKVILLE, MARYLAND 20850  
301-279-7725

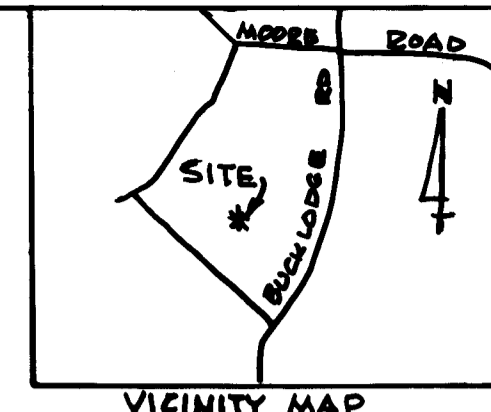

VICINITY MAP

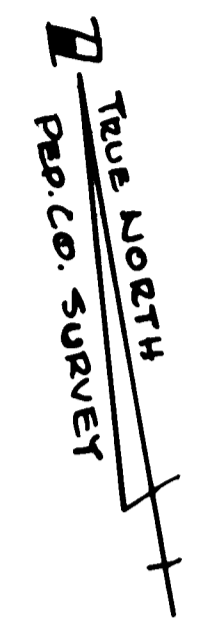

BUCKLUDGE ROAD

MD#117

ROAD

A.D. WEDMEYER - TRUSTEE  
5649/31  
156.24 AC.