

Gaither Farm/Rolling Acres
M:23-35
Montgomery County, MD

The property known alternatively as Gaither Farm or Rolling Acres is located on a 90-acre parcel of land at 3111 Mt. Carmel Cemetery Road in rural northeastern Montgomery County. The property is a rare surviving example of an intact farm complex from the early to mid-19th century. The property consists of an 1806 stone farmhouse (enlarged in the mid-19th century) and several attendant outbuildings, including a 1-1/2-story stone kitchen/slave quarters, along with several historic agricultural buildings, including a large and impressive stone bank barn. The property was originally owned by Frederick Gaither, a member of the locally prominent Gaither family and has been maintained as a working farm throughout its history.

The property meets Criterion C of the Maryland Inventory of Historic Properties and the National Register of Historic Places.

Inventory No. M-23-35

historic name Gaither Farm

common/other name Rolling Acres

street & number 3111 Mt. Carmel Cemetery Road

not for publication

city or town Brookeville vicinity X state Maryland code MD

county Montgomery code _____ zip code 20833

3. State/Federal Agency Certification

N/A

4. National Park Service Certification

N/A

Ownership of Property (Check all that apply)

X private

public-local

public-State

public-Federal

Category of Property (Check only one box)

 X building(s)

_____ district

_____ site

X structure

object

Number of Resources within Property

Contributing	ⁱ Noncontributing
--------------	---------------------------------

7

2

9

buildings

sites

structures

objects

Total

Is this property listed in the National Register?

Yes	<u> </u>	Name of Listing_____	No	X
-----	---------------	----------------------	----	---

Maryland Inventory of Historic Properties
Gaither Farm
Montgomery County, Maryland

Inventory No. M-23-35
Page 2

=====

6. Function or Use

=====

Historic Functions (Enter categories from instructions)

Cat: <u>Domestic</u>	Sub: <u>Single Dwelling</u>
<u>Domestic</u>	<u>Quarters/Kitchen</u>
<u>Agriculture/Subsistence</u>	<u>Barns; equipment sheds;</u>
	<u>meat house; wood shed</u>

Current Functions (Enter categories from instructions)

Cat: <u>Domestic</u>	Sub: <u>Single Dwelling</u>
<u>Agriculture/Subsistence</u>	<u>Barns; equipment sheds;</u>
	<u>storage; wood shed</u>

=====

7. Description

=====

Architectural Classification (Enter categories from instructions)

Federal

Materials (Enter categories from instructions)

foundation	<u>Stone</u>
roof	<u>Gable: Standing Seam Metal</u>
walls	<u>Stone</u>
other	_____

Narrative Description (Describe the historic and current condition of the property.)

See Continuation Sheet No. 7-1

=====

8. Statement of Significance

=====

Applicable National Register Criteria (Mark "x" in one or more boxes for the criteria qualifying the property for National Register listing)

- ☐ A Property is associated with events that have made a significant contribution to the broad patterns of our history.
- ☐ B Property is associated with the lives of persons significant in our past.
- ☒ C Property embodies the distinctive characteristics of a type, period, or method of construction or represents the work of a master, or possesses high artistic values, or represents a significant and distinguishable entity whose components lack individual distinction.
- ☐ D Property has yielded, or is likely to yield information important in prehistory or history.

Criteria Considerations (Mark "X" in all the boxes that apply.)

- ☐ A owned by a religious institution or used for religious purposes.
- ☐ B removed from its original location.
- ☐ C a birthplace or a grave.
- ☐ D a cemetery.
- ☐ E a reconstructed building, object, or structure.
- ☐ F a commemorative property.
- ☐ G less than 50 years of age or achieved significance within the past 50 years.

Maryland Inventory of Historic Properties
Gaither Farm
Montgomery County, Maryland

Inventory No. M-23-35
Page 4

=====
Areas of Significance (Enter categories from instructions)

Architecture

Agriculture

Period of Significance 1806-1938

Significant Dates 1806

circa 1856

Significant Person (Complete if Criterion B is marked above)

Cultural Affiliation

Architect/Builder unknown

Narrative Statement of Significance (Explain the significance of the property.)

See Continuation Sheet No. 8-1

=====

9. Major Bibliographical References

=====

(Cite the books, articles, legal records, and other sources used in preparing this form.)

Annals of Sandy Spring, Vols. I-V, Sandy Spring, MD.: Privately Printed.

Boyd, T.H.S., *History of Montgomery County*, 1879. Reprint. Baltimore, MD: Clearfield Comp., 1989.

Farquhar, Roger Brooke. *Old Homes and History of Montgomery County, MD.* Silver Spring, MD., 1952, 1962.

MacMaster, Richard K. and Ray Eldon Hiebert. *A Grateful Remembrance: The Story of Montgomery County, Maryland, 1776-1976.* Rockville, MD.: Montgomery County Historical Society, 1976.

Montgomery County Historical Society, Rockville, MD., Vertical Files.

Montgomery County Land Records, Montgomery County, Maryland.

Mutual Assurance Society Records, Montgomery County Historical Society.

Nesbitt, Martha C. and Mary Reading Miller. *Chronicles of Sandy Spring Friends Meeting and Environs.* Sandy Spring, MD., 1987.

Noble, Allen G. and Richard K. Cleek. *The Old Barn Book: A Field Guide to North American Barns and other Farm Structures.* New Brunswick, NJ: Rutgers University Press, 1995.

Sandy Spring Museum, Sandy Spring, Maryland, Vertical Files.

Genealogical Abstracts, *Montgomery County Sentinel* 1855-1899.

Maps and Drawings and Photographs

Hopkins, G.M., comp. *Atlas of Fifteen Miles around Washington, including the County of Montgomery, Maryland*, 1879. Reprint. Rockville, MD.: Montgomery County Historical Society, 1975.

Martenet, Simon L. *Martenet and Bond's Map of Montgomery County*, 1865.

Maryland Inventory of Historic Properties
Gaither Farm
Montgomery County, Maryland

Inventory No. M-23-35
Page 6

=====

10. Geographical Data

=====

Acreage of Property 90.33 acres

Verbal Boundary Description (Describe the boundaries of the property.)

Rolling Acres/Gaither Farm occupies Parcel 555 on Montgomery County Tax Map HW.

Boundary Justification (Explain why the boundaries were selected.)

This parcel of land is part of a larger parcel that has been associated with this property since the construction of the main dwelling in 1806.

=====

11. Form Prepared By

=====

name/title Kimberly Williams/Michele Naru, Architectural Historians
organization M-NCPPC date _____
street & number 8787 Georgia Avenue telephone 301/563-3403
city or town Silver Spring state MD zip code 20910

=====

12. Property Owner

=====

name Patty and Kevin Foster
street & number 3111 Mt. Carmel Cemetery Rd. telephone 301 774-9269
or town Brookeville state MD zip code 20833

=====

MARYLAND INVENTORY OF HISTORIC PROPERTIES

CONTINUATION SHEET

Section 7 Page 1

Inventory No. M-23-35

Gaither Farm

name of property

Montgomery County, MD

county and state

=====

ARCHITECTURAL DESCRIPTION

The property known alternatively as Gaither Farm or Rolling Acres is located on a 90-acre parcel of land at 3111 Mt. Carmel Cemetery Road in rural northeastern Montgomery County. The property includes an early 19th-century stone house (enlarged mid-19th century), a secondary dwelling built in 1941, and eight associated domestic and agricultural buildings, including a large stone barn, and a two-story stone kitchen/slave quarters.

Exterior Description: Main Dwelling

Built in two phases, the main house on the property is a 2-1/2 story, five-bay stone structure covered with a gable roof. The building is set upon a stone foundation and features two rebuilt brick end chimneys and a new standing seam metal roof. The original section of the house, located to the south, was built in 1806 by owner/builder Frederick Gaither as a three-bay, side-passage plan structure. A date stone located in the south gable end of this section reads "FG 1806" (FG being the initials of Frederick Gaither.) The second phase, completed by 1856, included the two-bay extension of the house, converting it into a five-bay, central-passage-plan structure.¹ A corbeled brick cornice, added during this phase of construction, extends across the front and rear elevation of the building, while stone quoining is found at the four corners of the rubble stone structure. A contemporary stone kitchen addition is located at the northeastern corner of the dwelling.

The south (main) elevation of the house is five bays wide with the original side-passage entry located off-center with single windows to either side. The entry, set deep into the stone walls, features a four-paneled wood door with a three-light transom surrounded by deteriorating wood trim. A long lintel stone surmounts the door opening. All of the windows on the first story have 9/6 wood sash and long stone lintels above, while those on the second story have 6/6 wood sash and rubble stone lintels. A single-story wood porch which spans the facade of the house is currently under construction.

The west elevation has only two openings located in the gable end at the attic level, to either side of the centrally placed chimney.

¹ This date is based upon an 1856 Mutual Assurance Society policy on the property that described the house as a two-story stone structure 30 by 40 feet. These dimensions correspond with the five-bay structure.

MARYLAND INVENTORY OF HISTORIC PROPERTIES

CONTINUATION SHEET

Section 7 Page 2

Inventory No. M-23-35

Gaither Farm

name of property

Montgomery County, MD

county and state

=====

The north elevation consists of five bays of irregularly grouped windows, the western two bays of which are obscured by the new stone kitchen wing. Of particular note on this elevation is the corbeled brick cornice, which extends the full length of the wall, and is noticeably sagging towards the center. On this elevation, windows in the original three-bay section have been replaced, while those in the two-bay extension retain the original 9/6 and 6/6 sash configuration on the first and second stories, respectively. A rear door is located in the second bay from the north. The gable roof has been altered to accommodate five skylight windows.

The east elevation includes two small, six-light windows in the attic level of the gable end and single, 6/6 windows in the rear bay of both the first and second stories.

The contemporary addition is a single-story stone structure covered with a gable roof, clad with standing seam metal. It features a shed roof, wood, entry bay with a bank of windows opening along the south elevation.

Secondary Dwelling

The secondary dwelling is a 2-1/2-story Colonial Revival-style brick building that was constructed on the site in 1941. It is a five-bay, central-passage-plan house characterized by Colonial Revival details such as the double-story, Mount Vernon-like porch; the broken pedimented door surround; gable dormers; and lower side wings flanking the main block. It is located southwest of the original stone house and sits upon a hill overlooking the entry drive and pond beyond.

Domestic Outbuildings

Immediately east of the house are two domestic outbuildings, including a kitchen and slave/servants quarters and a spring house.

Kitchen/quarters: Located just southeast of the stone dwelling and built into the hillside, the kitchen/quarters is a two-story stone structure featuring a room-over-room plan. Likely contemporaneous to the house, it is raised upon a stone foundation and is covered with a gable roof with a rebuilt brick end chimney. The south (front) elevation of whitewashed rubble stone has a shed roof porch extending across the second story. This porch shelters a side entry door and single, 9-light window. The raised foundation, or first story, has a single, 9-light window. The west end wall is of rubble stone with a single opening in the gable end. The east end wall is of rubble stone with no openings and a rebuilt exterior end brick chimney.

MARYLAND INVENTORY OF HISTORIC PROPERTIES

CONTINUATION SHEET

Section 7 Page 3

Inventory No. M-23-35

Gaither Farm

name of property

Montgomery County, MD

county and state

=====

Spring house: The spring house is located east of the main dwelling and north of the kitchen/quarters. Probably contemporaneous to the 1806 dwelling, it is a stone structure measuring approximately 10' x 6'. It is covered with a gable roof, clad with standing seam metal and features board and batten gable end walls. The only opening into the spring house is a single, board and batten door located in the west end wall.

Agricultural Buildings:

North of the stone dwelling and its associated domestic buildings is a group of five barn buildings, all neatly clustered around the circular farm drive.

Corn crib/garage: Located just northeast of the stone dwelling, this single-vehicle crib barn is a log structure, clad with vertical board walls, and covered with a gable roof, clad with standing seam metal.

Drive-in corn crib with shed wing: Just north of the crib barn/garage is a drive-thru corncrib. It is constructed of wood frame with vertical board walls and is covered with a gable roof. The driveway is without doors, front and back, and is flanked by side cribs, historically used for the storage of corn. A loft is located above the driveway and reached from the exterior by a loft door of vertical boards. The side shed aisle is used for the storage of equipment.

Stone Bank Barn: The largest agricultural building and focus of the complex is the large stone bank barn, located at the northeast end of the group of agricultural buildings. Constructed by 1856, it is a substantial rubble stone structure, built into a slight incline, and covered with a gable roof. It has been extended three bays to the northeast by a frame wing and features an animal feeding shed extension, with a corn silo between the wings. The original stone structure has a single double door opening on the long, northwest side wall, and small ventilating holes on the east end wall. An earthen ramp leads up to the double door opening.

Equipment Shed: A five-bay frame equipment shed with a gable roof is located north of the main house, west of the stone bank barn. This structure sits upon a concrete block foundation and has vertical board walls, and a standing seam metal roof. A shed wing extends across the northeastern elevation of this equipment shed.

Stable: A long, low-lying wood stable building is located west of the stone bank barn.

MARYLAND INVENTORY OF HISTORIC PROPERTIES

CONTINUATION SHEET

Section 8 Page 1

Inventory No. M-23-35

Gaither Farm

name of property

Montgomery County, MD

county and state

=====

STATEMENT OF SIGNIFICANCE

The Gaither Farm/Rolling Acres, located west of Triadelphia Reservoir in rural, northeastern Montgomery County, is a rare surviving example of an intact example of an early to mid-19th-century farm complex. The property consists of an 1806 stone farmhouse, with contemporaneous domestic outbuildings, and historic, 19th-century agricultural buildings, including a large and impressive stone bank barn. The property was originally owned by Frederick Gaither, a member of the locally prominent Gaither family. The property meets Criterion C of the Maryland Inventory of Historic Properties and the National Register of Historic Places.

Historic Context:

The Gaither Farm is located on a tract of land which was originally part of the 516-acre land grant dubbed "Benjamin's Lot," made to Benjamin Gaither in 1725, and part of the "Addition to Brooke Grove," surveyed in 1762 by James Brooke. The land on which the Gaither farm was built remained in the Gaither family throughout the 18th century. By 1806, the property was inherited by Frederick Gaither (1770-1845), who, based upon the date stone on the house, constructed the house that year. Frederick Gaither is also buried in the cemetery on the property.

In 1843, two years before his death, Frederick gave the property to his son, Daniel Henry Gaither. Daniel Henry retained ownership of the property until 1854, when it passed to John "Fletcher" and Deborah (Gaither) Magruder. In 1856, John Fletcher Magruder insured several buildings on his property against fire with the Mutual Fire Insurance Company of Montgomery County.² The policy included \$1,500 worth of insurance on a dwelling house, valued at \$2,000; \$300 on household furniture, valued at \$400, \$500 on a barn and shed, valued at \$800 and \$400 on hay and grain in the barn. The policy further describes the dwelling and detached kitchen as "a two-story stone dwelling house 30 feet by 40 feet; a 1-1/2-story stone back building 17 by 18 feet. 3 chambers, Portico in front 10 by 12 feet." The barn was described as being about 70 yards northeast from the dwelling 55 by 35 feet. These descriptions correspond with the stone dwelling, as enlarged, the detached kitchen building (back building) and the large stone bank barn, all still standing.

Fletcher Magruder held onto the property until his death in 1896.

² Mutual fire Insurance Company, Policy #1614, 1856.

MARYLAND INVENTORY OF HISTORIC PROPERTIES

CONTINUATION SHEET

Section 8 Page 2

Inventory No. M-23-35

Gaither Farm

name of property

Montgomery County, MD

county and state

=====

At that point, the 234-acre property was designated "Frederick's Grove" and was sold to Jacob L. and Carrie M. Oland. The Olands were from Frederick County, but upon their purchase of the property, moved to Montgomery County to farm the land. Following Jacob Oland's death in 1920, the farming operation was carried on by his sons, and the property willed to his wife. In 1938, Carrie Oland sold the property to Malcolm and Virginia White. In 1941, the Whites built the large, Colonial Revival-style dwelling on the property, leaving the original stone structure untouched. Since then, the property has changed hands several times and is currently owned by Patty and Kevin Foster. The Fosters are currently restoring the stone house and have just completed a kitchen addition to it. The property is still operated as a farm, and many of the farm buildings are used for their originally intended purpose.

MARYLAND INVENTORY OF HISTORIC PROPERTIES
CONTINUATION SHEET

Inventory No. M-23-35

Gaither Farm/Rolling Acres
name of property
Montgomery County, MD
county and state

=====

HISTORIC CONTEXT:

Geographic Organization: Piedmont

Chronological/Development Period (s): Rural Agrarian Intensification

Prehistoric/Historic Period Theme (s): Agriculture; Architecture,
Landscape Architecture, and Community Planning.

RESOURCE TYPE(S)

Category: Standing Structure

Historic Environment: Rural

Historic Function (s): Domestic; Agricultural

Known Design Source:

MARYLAND INVENTORY OF HISTORIC PROPERTIES
CONTINUATION SHEET

Inventory No. M-23-35
Rolling Acres/Gaither Farm
name of property
Montgomery County, MD
county and state

=====

Chain of Title:

August 21, 1783	Henry Gaither to his son, Frederick Gaither. (Abstract of Wills, p52)
	"Benjamins Lot, Frederick's Grove, Gaither's Forest, Addition, and Fox Hall."
1806	Frederick Gaither builds stone house. (From datestone located in the stone house's gable end)
August 1, 1843	Frederick Gaither to his son, Daniel Henry Gaither. (SSM files)
September 13, 1854	Daniel Henry Gaither to John Fletcher D. and Deborah J. Gaither Magruder, wife. (Deed Book JGH 3 Folio 376)
	Property designated as "Frederick's Grove", containing 234 1/8 acres.
January 10, 1896	James F. D. Magruder died. (Sentinel, p237)
	James F. D. Magruder's will gives his estate to his wife, Martha L. Magruder and upon her death to his daughter Martha W. Magruder. (Will Book GCD 2 Folio 106)
April 7, 1896	Martha J. and Martha W. Magruder to Jacob L. and Carrie M. Oland, wife. (Deed Book JA 53 Folio 226)
	Property designated as "Frederick's Grove", containing 234-1/8 acres.
February 29, 1920	Jacob L. Oland died. (Referenced to in Deed Book 791 Folio 352)
	Jacob L. Oland's property was willed to his wife Carrie M. Oland. (Will Book HCA 22 Folio 283)
August 14, 1940	Carrie M. Oland to Malcolm H. and Virginia A. White. (Deed Book 791 Folio 352)
	Property designated as "Frederick's Grove", containing 234-1/8 acres.

1941

Malcolm White builds new house.

May 15, 1972

Malcolm H. and Virginia A. White to Samuel G. and Janice P. Nicholson. (Deed Book 4214 Folio 220)

Part of the property designated as "Frederick's Grove", containing 90.3367 acres

1998

Samuel G. and Janice P. Nicholson to Patty(daughter)and Kevin Foster. (Interview with Janice Nicholson 3-16-99)

GAITHER FARM (M: 23-35)



Visual User Application



MONTGOMERY COUNTY DEPARTMENT OF PARK AND PLANNING
THE MARYLAND-NATIONAL CAPITAL PARK AND PLANNING COMMISSION
8787 Georgia Avenue - Silver Spring, Maryland 20910-3760



Scale 1" = 600'



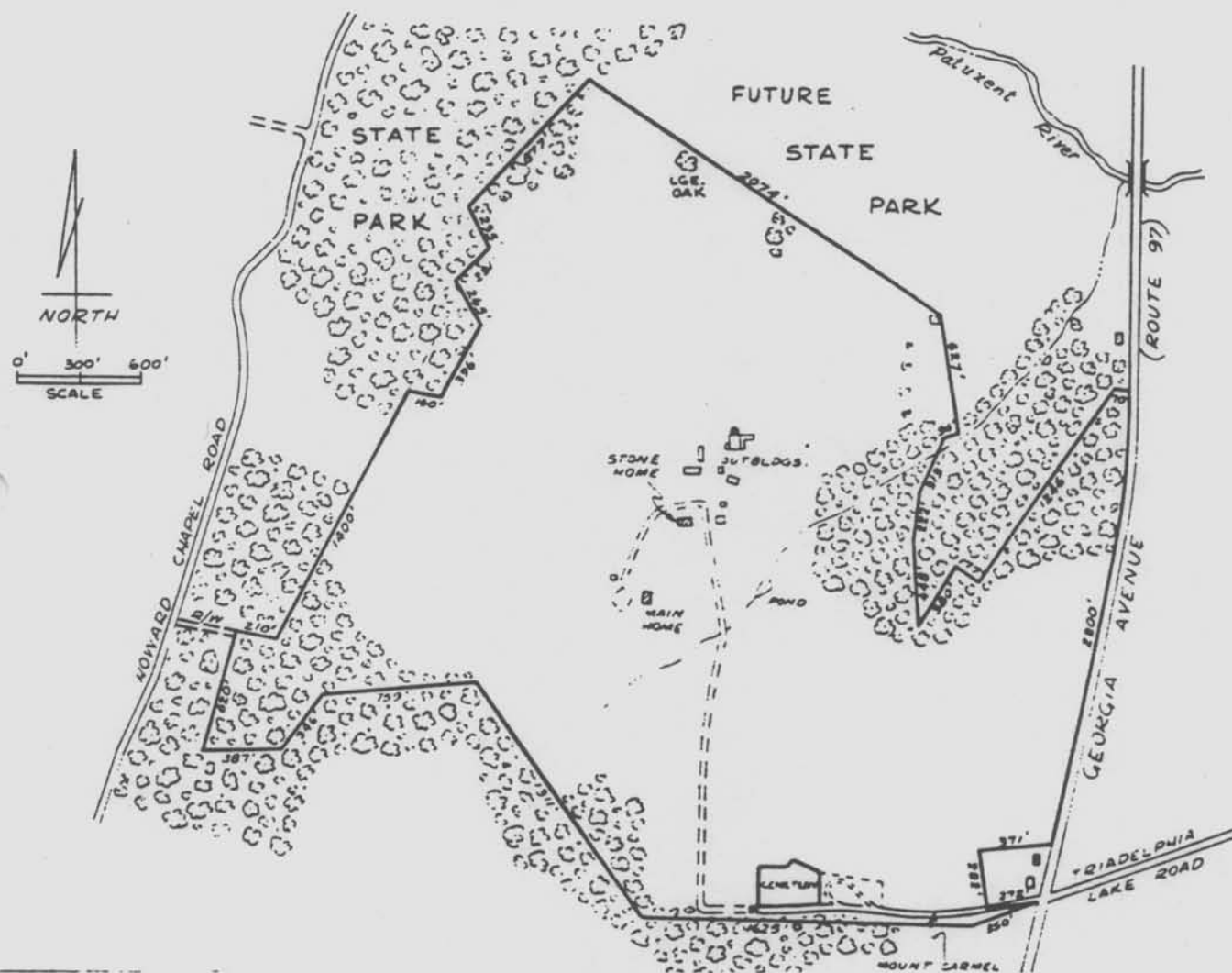

M:23/35

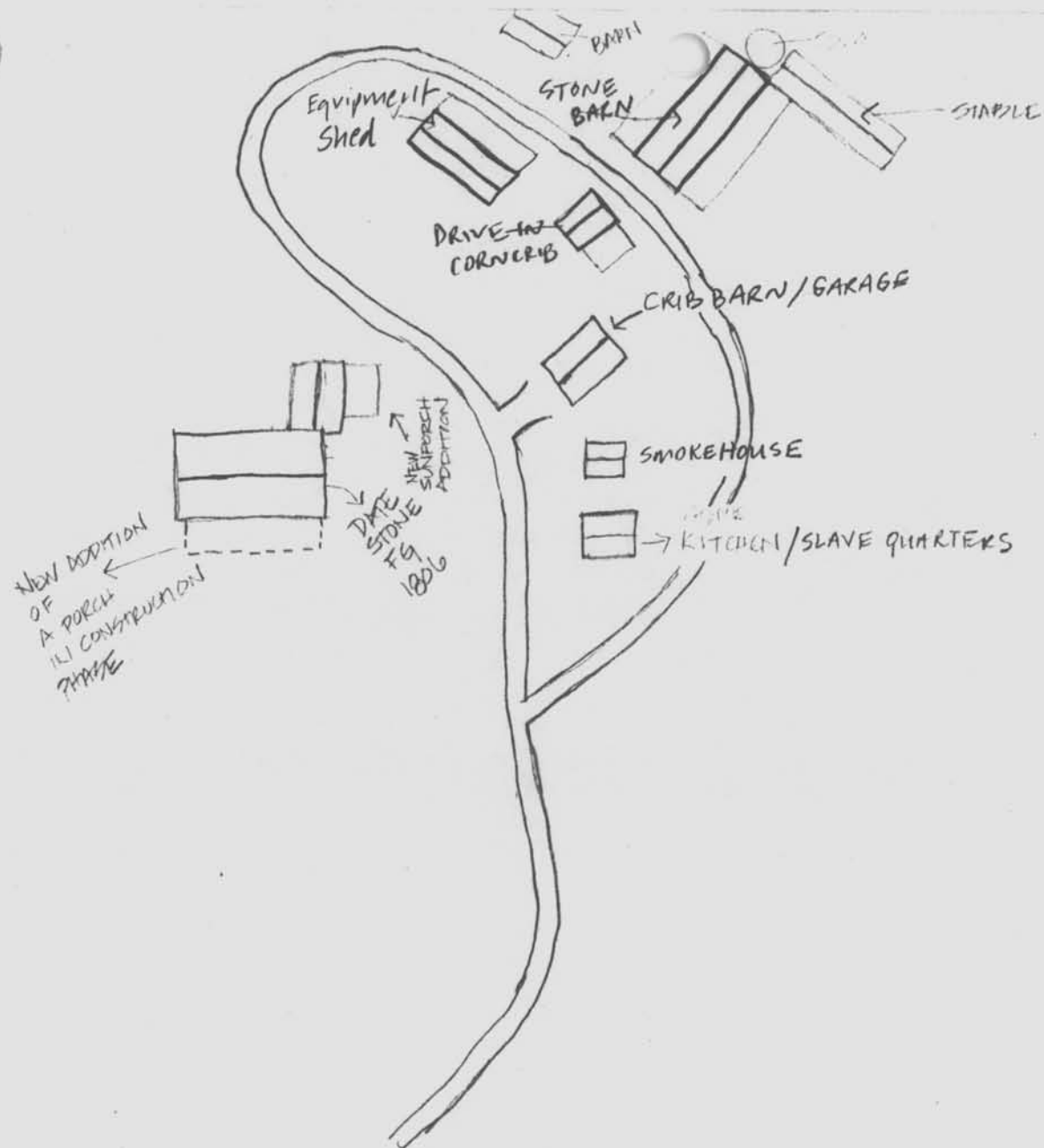

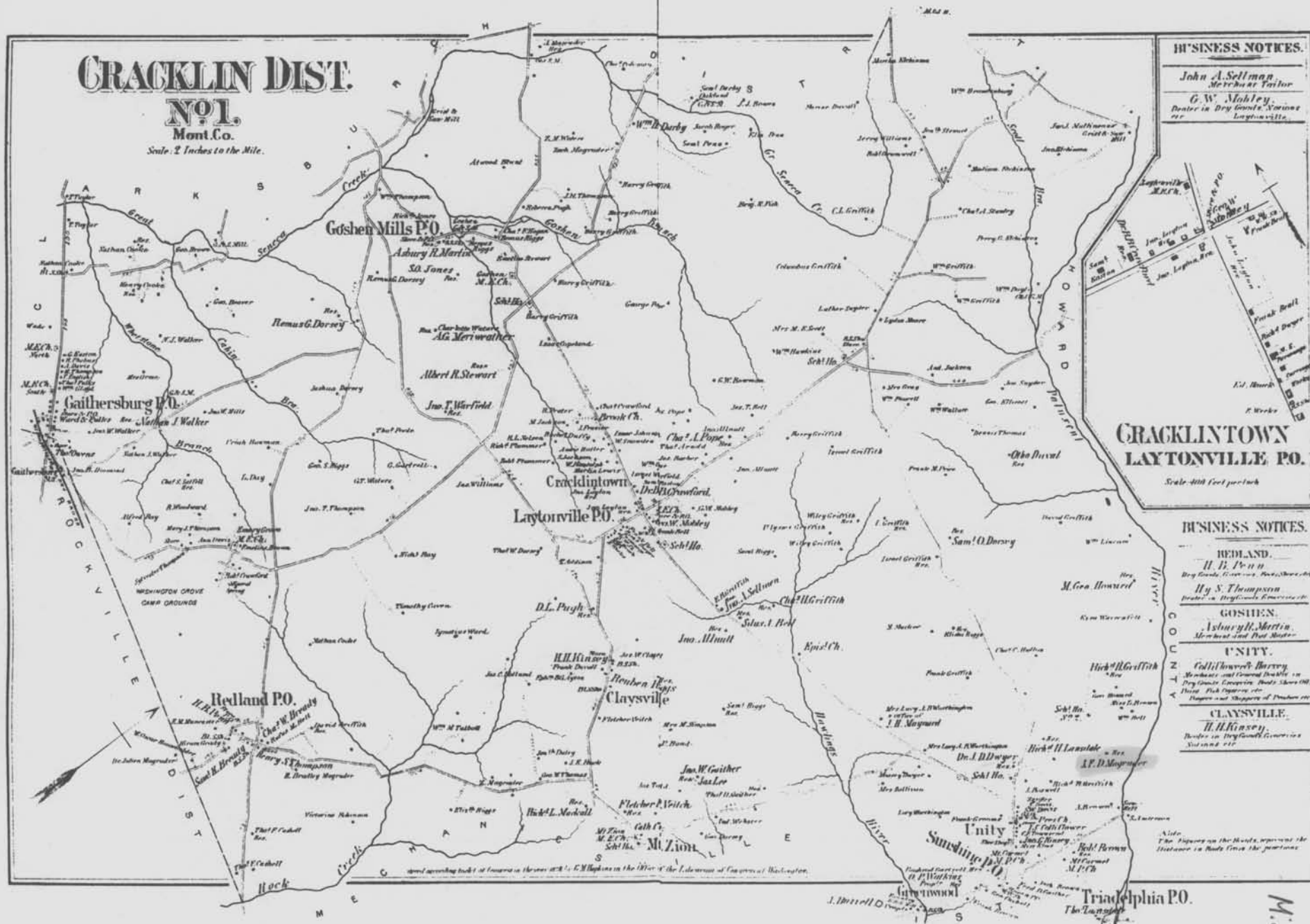

Hopkins, G.M., comp. Atlas of Fifteen Miles around Washington, including the County of Montgomery, Maryland, 1879. Reprint. Rockville, MD.: Montgomery County Historical Society, 1975.

M:23-35

UNITED STATES
DEPARTMENT OF THE ARMY
CORPS OF ENGINEERS

★ M: 23-08a



Name: SANDY SPRING
Date: 7/13/99
Scale: 1 inch equals 2000 feet

Location: 039° 13' 41.8" N 077° 03' 32.3" W
Caption: GAITHER FARM/ROLLING ACRES (M: 23-35)
3111 Mt. Carmel Cemetery Rd.



M:

23-35

ROLLING MUES / GATHER FARM

MONTGOMERY CO., MD

KIM WILLIAMS

2-22-99

MARYLAND SHPO

SOUTHEAST OBLIQUE LOOKING NORTHWEST

1 OF 11



M:

23-35

ROLLING ACRES/GATHER FARM

MONTGOMERY CO., MD

KIM WILLIAMS

2-22-99

MARYLAND SHPO

NORTH ELEVATION

2 of 11

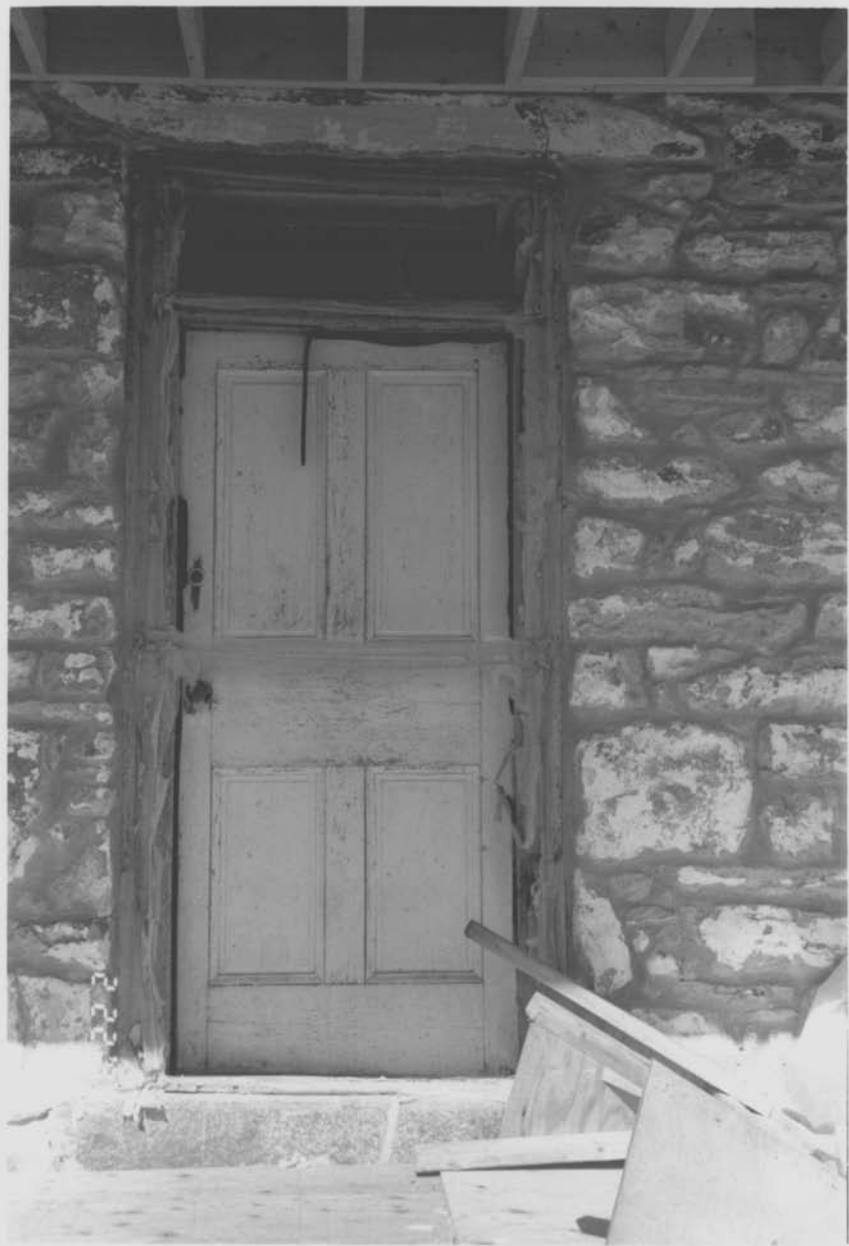

M:

23-35

ROLLING ACRES / GATHER FARM

MONTGOMERY CO., MD

KIM WILLIAMS

2-22-09

MARTLAND SHPO

FRONT ENTRY, LOCATED ON SOUTH ELEVATION

30F11



Mi
23-35

ROLLING ACRES / GATHER FARM
MONTGOMERY CO., MD

KIM WILLIAMS

2-22-99

MARYLAND SHPO

DATSTONE, LOCATED ON EAST ELEVATION'S
GABLE END

40F11



M:

23-35

ROWING ACRES / GANTHER FARM

MONTGOMERY CO., MD

KIM WILLIAMS

2-22-99

MARYLAND SHPO

SOUTH ELEVATION OF KITCHEN

50#11



M.
23-35

ROLLING ACRES/GATHER FARM

MONTGOMERY CO, MD

KIM WILLIAMS

2-22-99

MARYLAND SHPO

SOUTHEAST OBLIQUE OF KITCHEN

6 OF 11



M:
23-35

ROLLING ACRES / GANTHER FARM
MONTGOMERY CO., MD

KIM WILLIAMS

2-22-99

MARYLAND SHPO

VIEW OF SMOKEHOUSE + CRIB BARN

LOOKING NORTHEAST

7 OF 11



23-35

ROLLING ACRES/GATHER FARM
MONTGOMERY CO., MD

KIM WILLIAMS

2-22-99

MARYLAND SHPO

VIEW OF SMOKEHOUSE + CRIB BARN
LOOKING NORTHWEST

80F 11



M.
23-35

POWING ACRES / GANTHER FARM

MONTGOMERY CO., MD

KIM WILLIAMS

2-22-99

MARYLAND SHPO

VIEW OF DRIVE - IN CORN CRIB LOOKING NE

9 OF 11



M:
23-35

ROLLING ACRES / GATHER FARM

MONTGOMERY CO, MD

KIM WILLIAMS

2-22-09

MARYLAND SHPO

VIEW OF WEST ELEVATION OF BANK BARN

10 OF 11



M:
23-35

FOUNING ACRES/GATHER FARM

MONTGOMERY CO., MD

KIM WILLIAMS

2-22-99

MARYLAND SHPO

VIEW OF NORTHEAST FACADE OF
EQUIPMENT SHED

11 OF 11

M.

1605405304

MARYLAND HISTORICAL TRUST WORKSHEET

NOMINATION FORM
for the
NATIONAL REGISTER OF HISTORIC PLACES, NATIONAL PARKS SERVICE

SEE INSTRUCTIONS

1. NAME				
COMMON: Rolling Acres				
AND/OR HISTORIC: Gaither Farm				
2. LOCATION				
STREET AND NUMBER: Georgia Ave (Rte. 97) and Mt. Carmel Cemetery Road				
CITY OR TOWN: Brookeville				
STATE Maryland		COUNTY: Montgomery		
3. CLASSIFICATION				
CATEGORY (Check One)		OWNERSHIP		STATUS
<input type="checkbox"/> District <input checked="" type="checkbox"/> Building <input type="checkbox"/> Site <input type="checkbox"/> Structure <input type="checkbox"/> Object		<input type="checkbox"/> Public <input checked="" type="checkbox"/> Private <input type="checkbox"/> Both		<input checked="" type="checkbox"/> Occupied <input type="checkbox"/> Unoccupied <input type="checkbox"/> Preservation work in progress
		Public Acquisition: <input type="checkbox"/> In Process <input type="checkbox"/> Being Considered		ACCESSIBLE TO THE PUBLIC Yes: <input type="checkbox"/> Restricted <input type="checkbox"/> Unrestricted <input checked="" type="checkbox"/> No
PRESENT USE (Check One or More as Appropriate)				
<input checked="" type="checkbox"/> Agricultural <input type="checkbox"/> Government <input type="checkbox"/> Park <input type="checkbox"/> Transportation <input type="checkbox"/> Comments				
<input type="checkbox"/> Commercial <input type="checkbox"/> Industrial <input checked="" type="checkbox"/> Private <input type="checkbox"/> Other (Specify)				
<input type="checkbox"/> Educational <input type="checkbox"/> Military <input type="checkbox"/> Religious				
<input type="checkbox"/> Entertainment <input type="checkbox"/> Museum <input type="checkbox"/> Scientific				
4. OWNER OF PROPERTY				
OWNER'S NAME: Samuel G. Nicholson				
STREET AND NUMBER: 3111 Mt. Carmel Cemetery Road				
CITY OR TOWN: Brookeville		STATE: Maryland		
5. LOCATION OF LEGAL DESCRIPTION				
COURTHOUSE, REGISTRY OF DEEDS, ETC: Montgomery County Courthouse				
STREET AND NUMBER:				
CITY OR TOWN: Rockville		STATE: Maryland		
Title Reference of Current Deed (Book & Pg. #):				
6. REPRESENTATION IN EXISTING SURVEYS				
TITLE OF SURVEY: Historic American Buildings Survey				
DATE OF SURVEY: 1936 <input checked="" type="checkbox"/> Federal <input type="checkbox"/> State <input type="checkbox"/> County <input type="checkbox"/> Local				
DEPOSITORY FOR SURVEY RECORDS: Library of Congress				
STREET AND NUMBER: 10 First St. SE				
CITY OR TOWN: Washington, DC		STATE:		

7. DESCRIPTION

CONDITION	(Check One)					
	<input type="checkbox"/> Excellent	<input checked="" type="checkbox"/> Good	<input type="checkbox"/> Fair	<input type="checkbox"/> Deteriorated	<input type="checkbox"/> Ruins	<input type="checkbox"/> Unexposed
	(Check One)			(Check One)		
	<input checked="" type="checkbox"/> Altered	<input type="checkbox"/> Unaltered	<input type="checkbox"/> Moved	<input checked="" type="checkbox"/> Original Site		

DESCRIBE THE PRESENT AND ORIGINAL (If known) PHYSICAL APPEARANCE

The house is a two story, stone structure with a five bay, main (south) facade. The two west bays are an addition to the original three bay house. The central doorway has a transom light. At either end are flush gable chimneys. The cornice consists of three courses of brick. On the older end, the top course is headers moulded with an ogee profile; the middle course is headers; the bottom course is headers moulded to form a cove. On the two added bays, the bricks are stretchers covered with plaster. The windows are 9/6 on the ground floor and 6/6 on the second floor.

To the north is a one story stone wing with a small internal chimney at the north end. It has a boxed cornice and A-roof.

There are several other buildings on the site. The most northern building is a stone and frame bankbarn. There is a frame corncrib sitting on stone piloti. Adjacent to the house is a two story slave quarters; the second floor is approached by outside stairs that lead to a galleried porch across the south front. Behind the slave quarters is a stone springhouse with an A-roof.

SEE INSTRUCTIONS

8. SIGNIFICANCE

PERIOD (Check One or More as Appropriate)

☐ Columbian☐ 16th Century☐ 18th Century☐ 20th Century☐ 15th Century☐ 17th Century☒ 19th Century

SPECIFIC DATE(s) (If Applicable and Known) 1806 (Date stone in east gable)

AREAS OF SIGNIFICANCE (Check One or More as Appropriate)

Aboriginal

☐ Prehistoric☐ Historic☐ Agriculture☐ Architecture☐ Art☐ Commerce☐ Communications☐ Conservation☐ Education☐ Engineering☐ Industry☐ Invention☐ Landscape☐ Architecture☐ Literature☐ Military☐ Music☐ Political☐ Religion/Phi-

losophy

☐ Science☐ Sculpture☐ Social/Human-

itarian

☐ Theater☐ Transportation☐ Urban Planning☐ Other (Specify)

STATEMENT OF SIGNIFICANCE

The house is dated 1806 and was built by Frederick Gaither.

SEE INSTRUCTIONS

9. MAJOR BIBLIOGRAPHICAL REFERENCES

10. GEOGRAPHICAL DATA

LATITUDE AND LONGITUDE COORDINATES DEFINING A RECTANGLE LOCATING THE PROPERTY				OR	LATITUDE AND LONGITUDE COORDINATES DEFINING THE CENTER POINT OF A PROPERTY OF LESS THAN TEN ACRES				
CORNER	LATITUDE				LONGITUDE				
	Degrees	Minutes	Seconds	Degrees	Minutes	Seconds	Degrees	Minutes	Seconds
NW	°	'	"	°	'	"	°	'	"
NE	°	'	"	°	'	"	°	'	"
SE	°	'	"	°	'	"	°	'	"
SW	°	'	"	°	'	"	°	'	"

APPROXIMATE ACREAGE OF NOMINATED PROPERTY:

Acreage Justification:

LIST ALL STATES AND COUNTIES FOR PROPERTIES OVERLAPPING STATE OR COUNTY BOUNDARIES

STATE:		COUNTY:	
STATE:		COUNTY:	
STATE:		COUNTY:	
STATE:		COUNTY:	

11. FORM PREPARED BY

NAME AND TITLE: Christopher Owens, Park Historian		DATE 16 July 74
ORGANIZATION: M-NCPPC		
STREET AND NUMBER: 8787 Georgia Avenue		
CITY OR TOWN: Silver Spring	STATE: Maryland	

12. State Liaison Officer Review: (Office Use Only)

Significance of this property is:

National ☐ State ☐ Local ☐

Signature

SEE INSTRUCTIONS

Farquhar, Sr., which has been outfitted and equipped beautifully with every modern convenience, even luxuries, has in 1961 been leased

by Dr. Schwartzman to U. S. Army Major Lannigan, with wife and five children. They do no farming whatever.

Rolling Acres

THE substantial rough stone house shown is one of several built by, or for the Gaither family of Montgomery County. It is one of the few houses which the hurricane of 1896 was unable to batter down in that area.

The massive house, two stories high with thick walls, was built in 1806 as shown by the date on one end near the peak of the roof. According to information given by members of this prominent Maryland family, the house was built by Frederick Gaither who married Jane Gartell in November, 1800. His remains lie buried under a marble slab in the family plot behind the house. Upon his tombstone are chiseled: "Frederick Gaither. Departed this life July 10, 1845. Aged 75 years." His second wife, Ann, died June, 1864, and is buried beside him.

On April 8, 1725, a land grant of 516 acres called Benjamin's Lot was made to Benjamin Gaither. Rolling Acres stands on part of that grant, and also on part of "Addition to Brooke Grove."

According to Scharf's *History of Western Maryland*, the will of Edward Gaither was probated in 1777. He was a son of Benjamin. In this instrument he devised plots of land to his numerous sons, and it is believed that ultimately some of this land, which is difficult to identify, including Rolling Acres, passed into possession of Samuel, Greenbury and Perry Gaither, all of a later generation. Frederick was probably a son of Edward, and the father of Samuel, Greenbury and Perry Gaither. According to family records, Perry fell heir to the Rolling Acres farm.

Among the markers in the burial plot near the old home are to: "Samuel Gaither, B—January 2, 1800, D—August 8, 1860," and to "Greenbury Gaither, B—April 16, 1820, D—September 24, 1848," and another, presumably the son of Frederick, is marked by a slab inscribed with: "Perry Gaither, who departed this life March 3, 1854, aged 43 years."



NO. 94 C-9 FREDERICK GAITHER 1806
STONE

Following Perry Gaither, the farm seems to have descended, according to an in-law of the Gaithers, to a sister of Daniel Gaither, Sr. Daniel Gaither, Sr.'s, wife Henrietta, is recorded by a marker as "having departed this life April 4, 1854, aged 85 years." A son of this couple, Daniel, Jr., was born in this old stone house, and moved to Roxbury Mills in Howard County. He was for many years a County Commissioner of Howard County, a position he filled with much acclaim from his fellow citizens of that county. For years he was an efficient agent of the Mutual Fire Insurance Company of Montgomery County.

About the time of the Civil War, this old Gaither plantation passed to the Magruder family, in which family it remained for about fifty years. One of the latter family, John Fletcher D. Magruder, about that time married Deborah J. Gaither, and she died not long after their marriage. It is reported that he then—too soon after his wife's death for good taste—married her niece, Martha Jane Gaither. Through one or both of these marriages he acquired ownership of the valuable property. He was a farmer all his life. Fletcher Magruder placed a fine marker over the grave of wife No. 1, which is there today to testify to his esteem. It is chiseled in marble: "Deborah J., wife of John

F. D. Magruder, B. Aug. 1, 1815, D. 6-24-1864. Blessed are the dead who die in the Lord, for they rest from their labor and their works do follow them."

It is reliably stated that Fletcher Magruder's third venture into the sea of matrimony, not long before his death, was only a short time after the death of his second spouse. This time he married Martha Lumsden, who out-lived him a dozen years. One of the distant Magruder cousins was a pallbearer at Martha (Lumsden) Magruder's funeral about 1912, and followed her remains on a long railroad journey to Georgetown to lay them beside her husband buried there.

About 1898 the old plantation which then con-

tained about 200 acres of land was sold by the heirs of Fletcher Magruder to Jacob Oland of Frederick County who brought a large family to Montgomery. Oland was an excellent farmer, and his sons are among the best in the county of their adoption. The father died in 1920, and the sons carried on the home place for the mother.

In 1938 Mrs. Oland sold the farm to Malcolm H. White, of Washington, who is the present owner. She moved into a pleasant new bungalow on the highway near Sunshine. Mr. and Mrs. White left the old stone mansion intact with its memories and built a handsome Colonial type brick house on an elevation above the old house. It has extensive views.

Rolling Ridge

THE unusually picturesque house shown here is located in the western edge of the town of Laytonsville. The type of four-chimney house, very rare in Montgomery County, is quite common in the tidewater area of Maryland. It was built about 1790 by Robert Ober, a prosperous merchant of Georgetown.

Ober was of English descent and married Catharine Tenney, a daughter of Dr. Samuel Tenney, Surgeon General in the Revolutionary War. They had both come from New England and settled on the farm until it passed to the Warfield family. Ober was known to have been an influential and loyal supporter of the United States in the War of 1812.

A daughter of Robert and Catharine was Martha J. Ober, born November, 1809. In 1829 she married Elisha Riggs Griffith who was born in June, 1805. Martha O. Griffith died in 1833, and Elisha Griffith married Elizabeth Gaither who was a daughter of Frederick and Jane (Gartrell) Gaither. A daughter of this last-named couple, Maria G. Gaither, born in 1838, was married in 1860 to Israel Griffith Warfield.

During the Civil War, as Israel G. Warfield, Sr., was needed on the farm, he was allowed to purchase a substitute in the Army, which he did for \$750.

When Israel G. Warfield was four years old his father, Robert Warfield of Howard County,

bought Rolling Ridge Farm in 1836 and moved to Montgomery County. In due time Israel Warfield inherited the farm. Israel and Maria Warfield had nine children. One daughter, Lena, became the wife of Dr. V. H. Dyson who was a life-long resident of the neighborhood and a revered physician. They lived in a home on the farm within the edge of the village of Laytonsville. Another daughter, Elizabeth, married F. C. Webb of Washington. She died in September, 1942.

One of the four sons died before maturity. When the three remaining became of age, their father called them together and announced: "Now that you are grown it is time for you to go out and make your own way in the world. This farm of 250 acres cannot properly support such a large family."

Robert C. Warfield, the oldest, went to Baltimore, learned dentistry, and practiced that profession for forty-seven years in Rockville from 1889 to 1936. Another son, Israel Griffith Warfield, Jr., practiced dentistry for many years in Gaithersburg and died a number of years ago. The third son, Elisha G. Warfield, living at the age of 84, is a retired paint manufacturer in New Jersey.

An interesting incident involves Elisha G. Warfield, the only one living of this large family to tell the tale, which he heard from the lips of



NAME

#23-35 ROLLING ACRES

LOCATION

OFF RTE. 97, SUNSHINE, MD.

FACADE

SW

PHOTO TAKEN

7/16/74 M. DWYER