

Resolution No.: 17-1028
Introduced: March 25, 2014
Adopted: March 25, 2014

**COUNTY COUNCIL FOR MONTGOMERY COUNTY, MARYLAND
SITTING AS THE DISTRICT COUNCIL FOR THAT PORTION
OF THE MARYLAND-WASHINGTON REGIONAL DISTRICT
WITHIN MONTGOMERY COUNTY, MARYLAND**

By: District Council

SUBJECT: Approval of Planning Board Draft Amendment to the Master Plan for Historic Preservation: Maryland-National Capital Park and Planning Commission (M-NCPPC) Park Resources

1. On January 8, 2014, the Montgomery County Planning Board transmitted the Planning Board Draft Amendment to the Master Plan for Historic Preservation: M-NCPPC Park Resources (hereafter referred to as the Amendment) to the Council.
2. The attached Planning Board recommended amendment to the Master Plan for Historic Preservation would designate 7 historic resources that are currently owned or operated by the Parks Department:

Wheaton Youth Center	11711 Georgia Avenue, Silver Spring	#31/48
Stubbs Barn, Wheaton Regional Park	2000 Shorefield Road, Wheaton	#31/3-2
Rock Creek Recreation Center	7901 Meadowbrook Lane, Chevy Chase	#36/90
Pinecrest Recreation Center	301 St. Lawrence Drive, Silver Spring	#32/31
Ken-Gar Palisades Recreation Center	4140 Wexford Drive, Kensington	#31/49
Veirs Mill Recreation Center	4425 Garrett Park Road, Wheaton	#31/50
Norbeck Rosenwald School	4101 Muncaster Mill Road, Rockville	#23/113-2
3. The County Executive did not submit any comments on the Amendment.
4. On February 25, 2014, the Council held a public hearing on the Amendment. The Amendment was referred to the Planning, Housing, and Economic Development Committee for review and recommendation.
5. On March 24, 2014, the Planning, Housing, and Economic Development Committee held a worksession to review the issues raised in connection with the Amendment.

6. On March 25, 2014, the County Council reviewed the Amendment and the recommendations of the Planning, Housing, and Economic Development Committee to designate all resources recommended by the Planning Board, with the exception of the Wheaton Youth Center.

Action

The County Council for Montgomery County, Maryland, sitting as the District Council for that portion of the Maryland-Washington Regional District in Montgomery County, Maryland, approves the following resolution:

The Planning Board Draft Amendment to the Master Plan for Historic Preservation: M-NCPPC Park Resources is approved with revisions. Council's revisions are identified below. Some entire pages are deleted, and those deletions are so indicated by page number. Deletions to the text of the Plan on a retained page are indicated by [brackets], additions by underscoring.

Page 1 (cover): **[Planning Board Draft January 2014] March 2014**

Pages 2-28 (all footers): M-NCPPC Park Resources [Planning Board Draft]

Page 2: **[Planning Board Draft] M-NCPPC Park Resources
An Amendment to the Master Plan for Historic Preservation in Montgomery County**

A B S T R A C T

This document contains the text and supporting graphics for the [Planning Board Draft] Amendment to the Master Plan for Historic Preservation: M-NCPPC Park Resources. [If adopted by the County Council and approved by the M-NCPPC, this] This document amends the Master Plan for Historic Preservation in Montgomery County, Maryland (1979), as amended; the Master Plan for the Communities of Kensington-Wheaton (1989), as amended; the North and West Silver Spring Master Plan (2000), as amended; the Four Corners Master Plan (1996), as amended; the Olney Master Plan (2005), as amended; The General Plan (on Wedges and Corridors) for the Physical Development of the Maryland-Washington Regional District in Montgomery and Prince George's Counties (1964), as amended; and the Revised Master Plan of Highways for the Maryland-Washington Regional District in Montgomery and Prince George's Counties Maryland (1955), as amended.

This amendment [considers] considered the historic designation of eight M-NCPPC park-related resources—located in Planning Area 23 (Olney), Planning Area 31 (Kensington-Wheaton), and Planning Area 32 (Kemp Mill-Four Corners)—that [have been] were nominated for addition to the Locational Atlas and Index of Historic Sites in Montgomery County Maryland and designation on the Master Plan for Historic Preservation.

Page 3: **[Planning Board Draft January 2014] March 2014**

Page 8: The Amendment

Resources [Recommended for Master Plan Designation] Designated in the Master Plan for Historic Preservation

[Wheaton Youth Center, 11711 Georgia Avenue, Silver Spring, #31/48]

* * *

[Resource] Resources Considered but Not [Recommended for Master Plan Designation] Designated in the Master Plan for Historic Preservation

Wheaton Youth Center, 11711 Georgia Avenue, Silver Spring, #31/48

Stubbs House, 2000 Shorefield Road, Wheaton Regional Park, #31/3-1

Maps

Resource Locations

[Wheaton Youth Center Proposed Environmental Setting]

Page 9: **The Amendment**

This Amendment [considers] considered the designation of eight potential historic resources that are owned or maintained by M-NCPPC. The Amendment [recommends designation of 7] designates 6 historic sites on the Master Plan for Historic Preservation and does not [recommend designation of one] designate 2 nominated [resource] resources. [If] Resources designated on the Master Plan[, a resource would be] are protected by the County’s Historic Preservation Ordinance, Chapter 24A of the Montgomery County Code. [If listed in the Locational Atlas, the resource would be protected under one provision of the Ordinance, being Chapter 24A-10, the Moratorium on Demolition and Substantial Alteration.]

Individual Sites [Recommended for Master Plan Designation] Designated in the Master Plan for Historic Preservation

- [Wheaton Youth Center, 11711 Georgia Avenue, Silver Spring, #31/48]
- Stubbs Barn, 2000 Shorefield Road, Wheaton Regional Park, #31/3-2
- Rock Creek Recreation Center, 7901 Meadowbrook Lane, Chevy Chase, #36/90
- Pinecrest Recreation Center, 301 St. Lawrence Drive, Silver Spring, #32/31
- Ken-Gar Palisades Recreation Center, 4140 Wexford Drive, Kensington, #31/49
- Veirs Mill Recreation Center, 4425 Garrett Park Road, Wheaton, #31/50
- Norbeck Rosenwald School, 4101 Muncaster Mill Road, Rockville, #23/113-2

[Resource] Resources Considered but Not [Recommended for Master Plan Designation] Designated in the Master Plan for Historic Preservation

- Wheaton Youth Center, 11711 Georgia Avenue, Silver Spring, #31/48
- Stubbs House, 2000 Shorefield Road, Wheaton Regional Park, #31/3-1

Pages 10-13: Delete all pages.

Pages 19, 21, 23, 25, and 27: amend the last sentence on each page as follows:

Site changes, [that are considered normal park operations including] such as the installation of playground equipment, may be done through staff-level review and do not require a Historic Area Work Permit. Such changes would have no material effect on the historic resource.

Page 28: **[Resource] Resources Considered but Not [Recommended for Master Plan Designation] Designated in the Master Plan for Historic Preservation**

Wheaton Youth Center (1963), 11711 Georgia Avenue, Silver Spring, #31/48

Editor’s note - Add a small map and picture and the following text:

The Wheaton Youth Center is an example of modern design executed for a simple and relatively inexpensive community building. The Wheaton Youth Center won an award from the American Institute of Architect’s Potomac Valley Chapter and was featured in the first edition of the AIA’s Guide to the Architecture of Washington D.C. (1965). The signature design feature is the double-curved form of the vaulted roof of the main auditorium block, which becomes a motif for the complex, echoed in the roofs of activity wing and entrance pavilion, as well as interior stage wall.

The resource represents the work of Keyes, Lethbridge & Condon, an architectural firm recognized for setting high standards for modern architecture in the Washington, D.C. region. The principal architect was Arthur Keyes.

The Wheaton Youth Center has historic significance for representing the youth culture of the post-war era. In 1956, the Commission embarked on a new initiative to build a series of youth centers to meet the needs of teenagers. From 1965 to 1970, the facility was a major local music venue, reaching a regional audience in the days before the large-scale concert venue.

A newly combined library and recreation center requires increased open space. The Council found that the public interest is best served by not designating the resource.

All pages - General instructions:

The text, maps, and tables are to be revised, as necessary, to achieve clarity and consistency, to update factual information, and to convey the actions of the District Council.

This is a correct copy of Council action.

Linda M. Lauer, Clerk of the Council

7. Description

Inventory No.

Condition

excellent deteriorated
 good ruins
 fair altered

Prepare both a one paragraph summary and a comprehensive description of the resource and its various elements as it exists today.

SUMMARY

The Veirs Mill Recreation Building, also known as the Veirs Mill Village Recreation Center, is located off Garrett Park Road in the Veirs Mill Local Park in Veirs Mill, Maryland. Constructed in 1954, Veirs Mill embodies the architectural trends of the mid-20th century and is a good representative of the standardization of county recreation buildings in the Cold War years. The building still functions in its original role and retains its original fabric.

SITE

Veirs Mill Recreation Building is located on 17.52 acres at Garrett Park Road. The building is still surrounded to the west by an open lawn that includes playground equipment. The site has a rectangular, paved parking area in front of the building. The area to the north of the building that was originally designated for picnicking amid woodland is now made up of recreational fields, accessed via a series of descending steps. Basketball courts sit at the edge of the wooded trail that threads along Beach Drive in Rock Creek Park.

EXTERIOR

The Veirs Mill Recreation Building is a west-facing, one-story, brick rectangular structure resting on a concrete foundation. It has a one-story wing to its right.

The building's basic planning components are intact to their construction period, and include an open recreation room; an open, but covered front terrace; small projecting front storage and rear kitchen nodes; and a restroom wing. The short kitchen extension to the rear and the restroom block to the south (which is set back from the façade) both serve to vary the otherwise uniform massing of the building. The short side of the building faces the street, but the parking lot immediately gives access and a view to the facade. The brick is laid in common bond and the roof is asphalt clad.

The main, or west, façade is composed of two identical wall sections that frame a massive red-brick chimney that used to have a working exterior fireplace (now bricked in). The wall sections to either side of the chimney feature a pair of solid double doors flanked by a wall that follows the modular rhythm of two by fours. The two by fours define areas of wallboard versus doors and also define a series of transoms overhead, now enclosed with wooden boards. The open terrace covering that runs the length of the façade is supported on exposed steel I-beams and the underside of its covering is tongue-and-groove board. The outdoor deck flooring is a simple concrete slab on grade, and picnic tables are situated on it. A short driveway off the parking lot leads right up to the southern of the two pairs of main doors to accommodate deliveries. An adjacent concrete path and stoop lead to a service door where there once probably was separate concrete stoop

The low, side-gable roof is covered in asphalt shingles.

Maryland Historical Trust

Maryland Inventory of Historic Properties Form

Inventory No.

Name Veirs Mill Recreation Building
Continuation Sheet

Number 7 Page 1

In addition to the main brick chimney, there is a second, smaller chimney, presumably for the boiler, that is located at the southern corner of the restroom block.

The south side elevation contains small, privacy-type windows, midway up the wall which defines the restroom. These have brick sills defined by a soldier course and are currently covered in metal grilles.

Windows and doors on the restroom wing have been closed up or altered over time, apparent in the different brickwork and wider mortar joints. A single pedestrian door leads into the bathroom wing on the gable end.

The east elevation contains banded windows composed of three pairs of casements. These windows are not original to the period of construction. They pierce the wall at a height slightly higher than midway and extend up to the eave line, defined only by brick sills.

The north elevation is all brick since one very large window has been enclosed. The change in brickwork makes this alteration obvious.

INTERIOR

The interior of the main block has a large, open room finished in newer materials. Floors are vinyl tile. The ceiling is made of acoustic drop-in tiles with a regular pattern of infill fluorescent lighting. The facility has a kitchen, bathrooms, and ample storage.

Maryland Historical Trust Maryland Inventory of Historic Properties Form

Inventory No.

Name Veirs Mill Recreation Building
Continuation Sheet

Number 7 Page 2

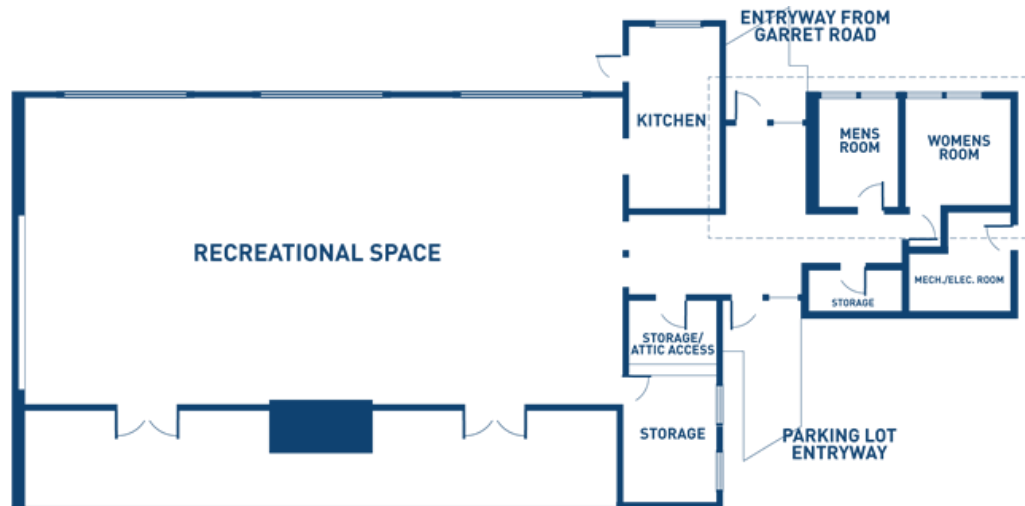

8. Significance

Inventory No. _____

Period	Areas of Significance	Check and justify below		
<input type="checkbox"/> 1600-1699	<input type="checkbox"/> agriculture	<input type="checkbox"/> economics	<input type="checkbox"/> health/medicine	<input type="checkbox"/> performing arts
<input type="checkbox"/> 1700-1799	<input type="checkbox"/> archeology	<input type="checkbox"/> education	<input type="checkbox"/> industry	<input type="checkbox"/> philosophy
<input type="checkbox"/> 1800-1899	<input checked="" type="checkbox"/> architecture	<input type="checkbox"/> engineering	<input type="checkbox"/> invention	<input type="checkbox"/> politics/government
<input checked="" type="checkbox"/> 1900-1999	<input type="checkbox"/> art	<input checked="" type="checkbox"/> entertainment/ recreation	<input type="checkbox"/> landscape architecture	<input type="checkbox"/> religion
<input type="checkbox"/> 2000-	<input type="checkbox"/> commerce	<input type="checkbox"/> ethnic heritage	<input type="checkbox"/> law	<input type="checkbox"/> science
	<input type="checkbox"/> communications	<input type="checkbox"/> exploration/ settlement	<input type="checkbox"/> literature	<input type="checkbox"/> social history
	<input type="checkbox"/> community planning		<input type="checkbox"/> maritime history	<input type="checkbox"/> transportation
	<input type="checkbox"/> conservation		<input type="checkbox"/> military	<input type="checkbox"/> other: _____

Specific dates

Architect/Builder M-NCPPC
(possibly staff Landscape Architect R. H. Porsch)¹

Construction dates 1954

Evaluation for:

 National Register Maryland Register not evaluated

Prepare a one-paragraph summary statement of significance addressing applicable criteria, followed by a narrative discussion of the history of the resource and its context. (For compliance projects, complete evaluation on a DOE Form – see manual.)

SUMMARY

Maryland-National Capital Park and Planning Commission (M-NCPPC) was founded in 1927 as a stream-valley park system protecting the headwaters of the Anacostia and Potomac Rivers. In addition, the Commission's charge was to oversee subdivision review and the creation and maintenance of a recreational park system. Along the stream valleys and, later, in the neighborhood and regional parks, the Commission augmented the natural landscape with the construction of buildings to house indoor recreation activities, such as parties, club meetings, scouts, daycare, and summer camps.

As M-NCPPC approaches its 100th anniversary and out of a mission to provide cultural resource stewardship, the Montgomery County Department of Parks has identified park recreation buildings worthy of preservation. Currently, there are 30 buildings that serve or have operated as recreation buildings (now termed park activity buildings) throughout the 35,000 acre park system². Originally, there were at least 41 of these community facilities. Some of these structures were "purpose-built," while others were converted to recreational use. In order to show a history of the evolution of park activity buildings over the lifetime of the Maryland-National Capital Park and Planning Commission (1927 to present), the Department of Parks' Cultural Resources Stewardship Section proposes to preserve at least one building from each of the five respective park community/recreation building eras.³

¹ There are no known original architectural drawings for the Veirs Mill Recreation Building at Parkside. However, an undated drawing of Glenmont was produced by Landscape Architect R. H. Porsch. Both facilities have the same plan.

² 2007 M-NCPPC *Catalog of Recreation and Ancillary Buildings* defines recreation buildings as "operated for the benefit of the general public, rented by the hour with Fees set by the Park Commission, reserved through Park Permits, and maintained by the Department of Parks Central Maintenance Divisions."

³ In addition to recognizing the recreation buildings still standing, it is worth identifying the (at least) eleven structures that have since been demolished or transferred to the Montgomery County Recreation Department: Cabin John Recreation Center (off MacArthur Blvd.), Garrett Park Estates Community Building, Jesup-Blair Cabin, Kensington Park Community Building (off Frederick Ave.), Long Branch Recreation Center, Randolph Hills Recreation Center, Rosemary Hills Recreation Center, Scotland Community Building, Sligo Avenue Recreation Center, Sligo Cabin, and Wheaton Woods Recreation Center.

Maryland Historical Trust

Maryland Inventory of Historic Properties Form

Inventory No.

Name: Veirs Mill Recreation Building
Continuation Sheet

Number 8 Page 1

***Era I: The Origins of the M-NCPPC Park System: 1927-1940**

***Era II: The World War II-Era Buildings: 1941-1946**

***Era III: Conversion of World War II Federal Surplus Buildings: 1953-1956**

***Era IV: Purpose-Built Community Recreation Centers during Cold War Suburbanization: 1950-1990**

***Era V: Repurposing Structures to Become Activity Buildings, 1937-1968**

Five recreation buildings are being nominated to the *Master Plan for Historic Preservation*. Each is the best representative of each of the different eras. Veirs Mill was selected to represent Era IV.⁴

The Veirs Mill Recreation Building is a large brick structure constructed in 1954 for the Veirs Mill Local Park. Standardized in form and material, Veirs Mill reflected the need of M-NCPPC to efficiently and economically mass produce this high-demand public amenity in post-war Montgomery County. This facility has strong architectural integrity, retaining details that harkened back to the mid-20th century period. The land nearby it remains undeveloped. Therefore, Veirs Mill Recreation Building meets the following criteria of the Montgomery County Historic Preservation Ordinance, Section 24A-3:

1(a) has character, interest, or value as part of the development, heritage, or cultural characteristics of the County, State, or Nation;

1(d) exemplifies the cultural, economic, social, political, or historic heritage of the County and its communities;

2(a) embodies the distinctive characteristics of a type, period, or method of construction;

NARRATIVE HISTORY

By the time M-NCPPC released the 1956 *Master Plan of Schools, Parks, and Recreation*, Montgomery County had developed 39 local parks. As a result, the Commission opted to not develop any new local parks in the “built-up portion of the Regional District,” the area south of Kensington.⁵ Instead, emphasis was placed on creating larger regional parks, beginning at Wheaton, followed by Rock Creek, Cabin John, Northwest Branch, Little Bennett, and Black Hill. Small local parks, however, made a resurgence in the 1960s, with 28 land acquisitions that created new parks throughout the county as the jurisdiction of M-NCPPC extended beyond the original 294 square-mile metropolitan district established in 1927. In addition, M-NCPPC today maintains 95 neighborhood parks and of that total, 57 were initiated between 1968 and 1990. The focal point of several of these new local and neighborhood parks was an accommodating recreational center. A significant number of these buildings were either designed or ultimately reviewed by M-NCPPC Chief Landscape Architect Joseph Kondis, who would eventually serve as Chief of the Engineering and Design Division of Montgomery County Parks.

⁴ For further information on the various design periods, see MIHP nomination forms for Meadowbrook, Pinecrest, Ken-Gar, and Norbeck.

⁵ M-NCPPC, *Master Plan of Schools, Parks, and Recreation* (Silver Spring, 1956).

Maryland Historical Trust

Maryland Inventory of Historic Properties Form

Inventory No.

Name: Veirs Mill Recreation Building
Continuation Sheet

Number 8 Page 2

Emphasis was placed on creating larger structures, with more overall square footage, and promoting longevity with the use of primarily brick and/or concrete (CMU) block as the major building material. Architectural forms designed for recreation centers became more standardized, with distinction found in the application of various materials. One interesting stylistic detail that evolved over time was the shape and location of windows. While previous recreation facilities had large windows for users to partake of the scenic views from within an enclosed structure, in this era, the number of windows decreased, as did the size of these openings, with the application of 'privacy windows.' This design was intentional, as these narrow and highly placed windows kept spectators from viewing special private events that took place within these permitted public facilities.

Era IV: Purpose-Built Community Recreation Centers during Cold War Suburbanization: 1950-1990

Recreational buildings in the parks constructed during the second half of the 20th century are fairly numerous, and have been categorized into different sub-typologies based on building materials and design aesthetics. Below is the breakdown, and it can be seen that Veirs Mill is representative of a popular type:

Representative Buildings:

a. Log Building

- North Four Corners (1947/alterd 1956)

Address: North Four Corners Local Park, 211 Southwood Avenue, Silver Spring

b. Contemporary

1. 1950s: Eave Centered Chimney, Original Curtain Windows, and Over-hang covered patio

- Glenmont (1954)

Address: Glenmont Local Park, 3201 Randolph Road, Wheaton

- Lynnbrook (1950)

Address: Lynnbrook Local Park, 8008 Newdale Road, Bethesda

- Veirs Mill (1954)

Address: Veirs Mill Local Park, 4425 Garrett Park Road, Veirs Mill

2. 1960s: Gable-End Chimney, Ribbon Windows, Brick and Wood siding

- Clarksburg (1968)

Address: Clarksburg Neighborhood Park, 22501 Weems Road, Clarksburg

- Kemp Mill Estates (1967)

Address: Kemp Mill Estates Local Park, 120 Claybrook Drive, Wheaton

- North Chevy Chase (1968)

Address: North Chevy Chase Local Park, 4105 Jones Bridge Road, Chevy Chase

Maryland Historical Trust

Maryland Inventory of Historic Properties Form

Inventory No.

Name: Veirs Mill Recreation Building
Continuation Sheet

Number 8 Page 3

- Pilgrim Hill (1965)
Address: Pilgrim Hill Local Park, 1615 East Randolph Road, Silver Spring
- Sligo-Dennis (1960)
Address: Sligo-Dennis Avenue Local Park, 10200 Sligo Creek Parkway, Silver Spring
- Stoneybrook (1962)
Address: Stoneybrook Local Park, 4105 Harvard Street, Wheaton
- Tilden Woods (1965-1969)
Address: Tilden Woods Local Park, 6800 Tilden Lane, Potomac
- c. *Post War Functional: Concrete-Block Minimalism***
- Capitol View-Homewood (1951/major renovation 1988)
Address: Capitol View-Homewood Local Park, 2929 Edgewood Road, Kensington
- Colesville (1959)
Address: Colesville Local Park, 610 Hobbs Drive, Colesville
- Maplewood-Alta Vista (1961)
Address: Maplewood-Alta Vista Local Park, 5209 Alta Vista Road, Bethesda
- Nolte (1958)
Address: Nolte Local Park, 200 Denver Road, Silver Spring
- d. *Agricultural Influenced: Gambrel Roof, Barn-Like***
- Indian Spring Terrace (1973)
Address: Indian Spring Terrace Local Park, 9717 Lawndale Drive, Silver Spring
- Owens (1970)
Address: Owens Local Park, 19900 Beallsville Road, Beallsville
- Quince Orchard Valley (1973-1974)
Address: Quince Orchard Valley Neighborhood Park, 12015 Suffolk Terrace, Gaithersburg
- e. *Post-1975 Modern*⁶**
- Argyle (1990)
Address: Argyle Local Park, 1030 Forest Glen Road, Silver Spring
- Spencerville/Mildred Pumphrey (1979)
Address: Spencerville Local Park, 15701 Good Hope Road, Spencerville

⁶ Until 1984, M-NCPPC-owned Park Activity buildings were the only publicly owned rental options available to county citizens. Since then, the Montgomery County Recreation Department, Montgomery County Board of Education, and Montgomery County Public Libraries have provided other alternatives.

Maryland Historical Trust

Maryland Inventory of Historic Properties Form

Inventory No.

Name: Veirs Mill Recreation Building
Continuation Sheet

Number 8 Page 4

- Sligo Avenue- (1976, renovated 1985)

Address: Sligo Avenue Neighborhood Park, 500 Sligo Avenue, Silver Spring

Candidate(s) for Preservation:

- Veirs Mill: eligible for the *Master Plan for Historic Preservation*
- Tilden Woods: future consideration for the *Master Plan for Historic Preservation* in **2015**.

Both Veirs Mill and Glenmont-Connecticut Avenue (now known as Glenmont) were constructed in the Wheaton vicinity and opened in May 1954 – several years prior to the opening of Wheaton Regional Park in 1961. Their dedication ceremonies occurred on the exact same day, at 10 AM for Viers Mill Local Park and the “formal send-off” an hour-and-a-half later at Glenmont Local Park.⁷ At a cost of \$45,000 per structure, these new facilities included “community rooms, kitchen facilities, porches, and shortage space.”⁸ In fact, these structures have the exact same floor plan. The larger activity room has a smaller side ell attachment containing the bathrooms, but initially it was utilized as an apartment most likely for Parks staff (usually a Ranger and/or Manager). The kitchen and storage closets are located in between the main block and the ell. With the completion of these two buildings, there were 33 recreation centers in Montgomery County.

The Veirs Mill Village Recreation Center represents a Mid-Century Modern example of architecture applied to a community building. The structure has the trademark characteristics of the style: A massive exterior brick chimney that pierces through the eaves to the roofline; a substantial overhanging front eave over an open covered terrace; a wall fenestration pattern based upon a standard module; an open interior floor plan; and a simple, unadorned style.

The building’s *Preliminary Development Plan and Planting Plan* dates to March 1954, coinciding with the development of the surrounding community. The original planting plan for the recreation building site included American Holly, Flowering Dogwood, American Redbud, Pink Indigo Azalea, and other decorative plants situated right up close up to the building, none of which appear to remain today.

Today Veirs Mill remains an excellent example of the standardization process seen in mid-20th century Montgomery County recreational facilities. It serves as an intact representative reminder of this important period of expansion within the Parks system.

⁷ “Recreation Centers Will Be Dedicated,” *Washington Post* 29 April 1954.

⁸ “New Play Spots for County,” *Washington Post* 2 May 1954.

9. Major Bibliographical References

Inventory No.

M-NCPPC Archives, Saddlebrook. Collection includes M-NCPPC *Annual Reports*.
M-NCPPC Papers (Minutes/Proceedings), Maryland State Archives
Veirs Mill File, Parkside.

10. Geographical Data

Acreage of surveyed property 64.39 acres (originally part of Rock Creek Stream Valley Park)
Acreage of historical setting 17.52 acres (Veirs Mill Local Park)
Quadrangle name Kensington Quadrangle scale: 1:24000

Verbal boundary description and justification

The historic environmental setting includes that part of the parcel associated with the recreation building and its functions in the Veirs Mill Local Park. The additional acreage in the parcel that is associated with Rock Creek Stream Valley Park (Units 4 and 5 of the original park acquisition) does not function in association with the recreation building, and are therefore not part of the setting.

11. Form Prepared by

name/title	Jamie F. Kuhns, Senior Historian, Cultural Resources Stewardship Section		
organization	M-NCPPC, Montgomery Parks	date	15 August 2013
street & number	9500 Brunett Avenue	telephone	301-450-4362
city or town	Silver Spring	state	MD

The Maryland Inventory of Historic Properties was officially created by an Act of the Maryland Legislature to be found in the Annotated Code of Maryland, Article 41, Section 181 KA, 1974 supplement.

The survey and inventory are being prepared for information and record purposes only and do not constitute any infringement of individual property rights.

return to: Maryland Historical Trust
Maryland Department of Planning
100 Community Place
Crownsville, MD 21032-2023
410-514-7600

Maryland Historical Trust Maryland Inventory of Historic Properties Form

Inventory No.

Name: Veirs Mill Recreation Building
Continuation Sheet

Number 8 Page 1

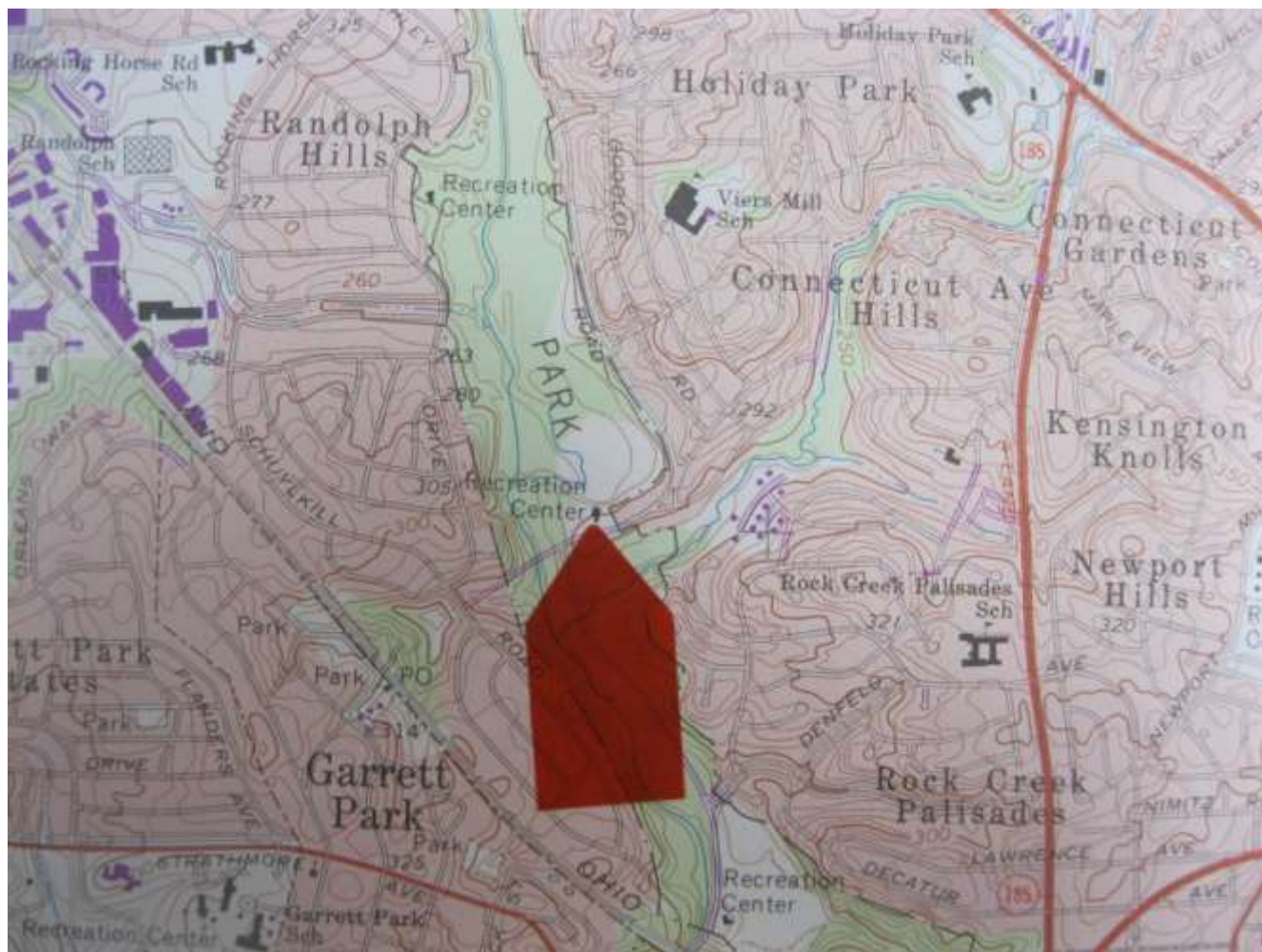

Figure 1. USGS Kensington Quad
Courtesy: M-NCPPC.

Maryland Historical Trust Maryland Inventory of Historic Properties Form

Inventory No.

Name: Veirs Mill Recreation Building
Continuation Sheet

Number 8 Page 3



Figure 3. Aerial view of Veirs Mill Recreation Building at Veirs Mill Local Park, 2008.
Courtesy: M-NCPPC.

Maryland Historical Trust Maryland Inventory of Historic Properties Form

Inventory No.

Name: Veirs Mill Recreation Building
Continuation Sheet

Number 8 Page 4

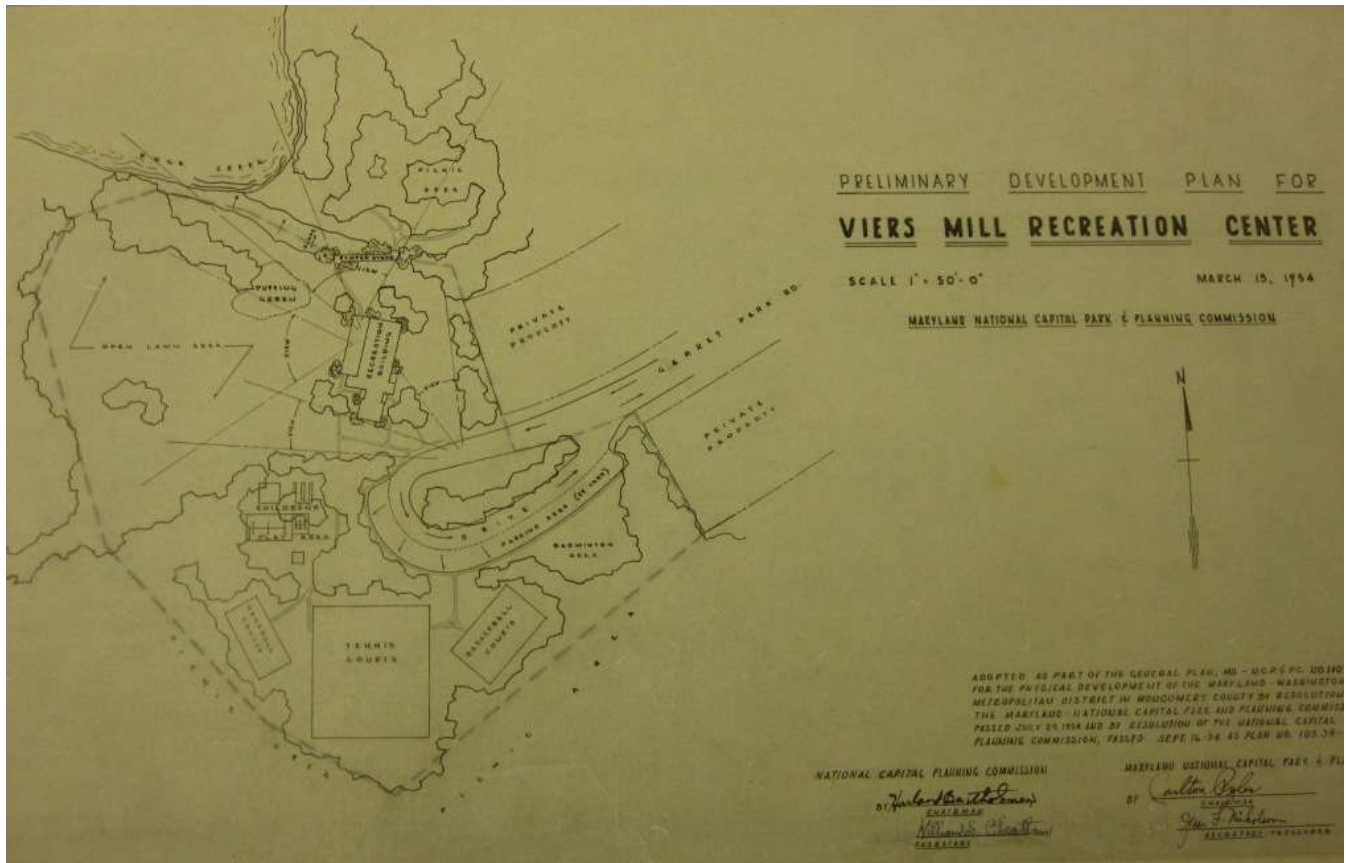

Figure 4. "Preliminary Development Plan for Viers Mill Recreation Center, 1954."
Courtesy: M-NCPPC.

Maryland Historical Trust Maryland Inventory of Historic Properties Form

Inventory No.

Name: Veirs Mill Recreation Building
Continuation Sheet

Number 8 Page 5

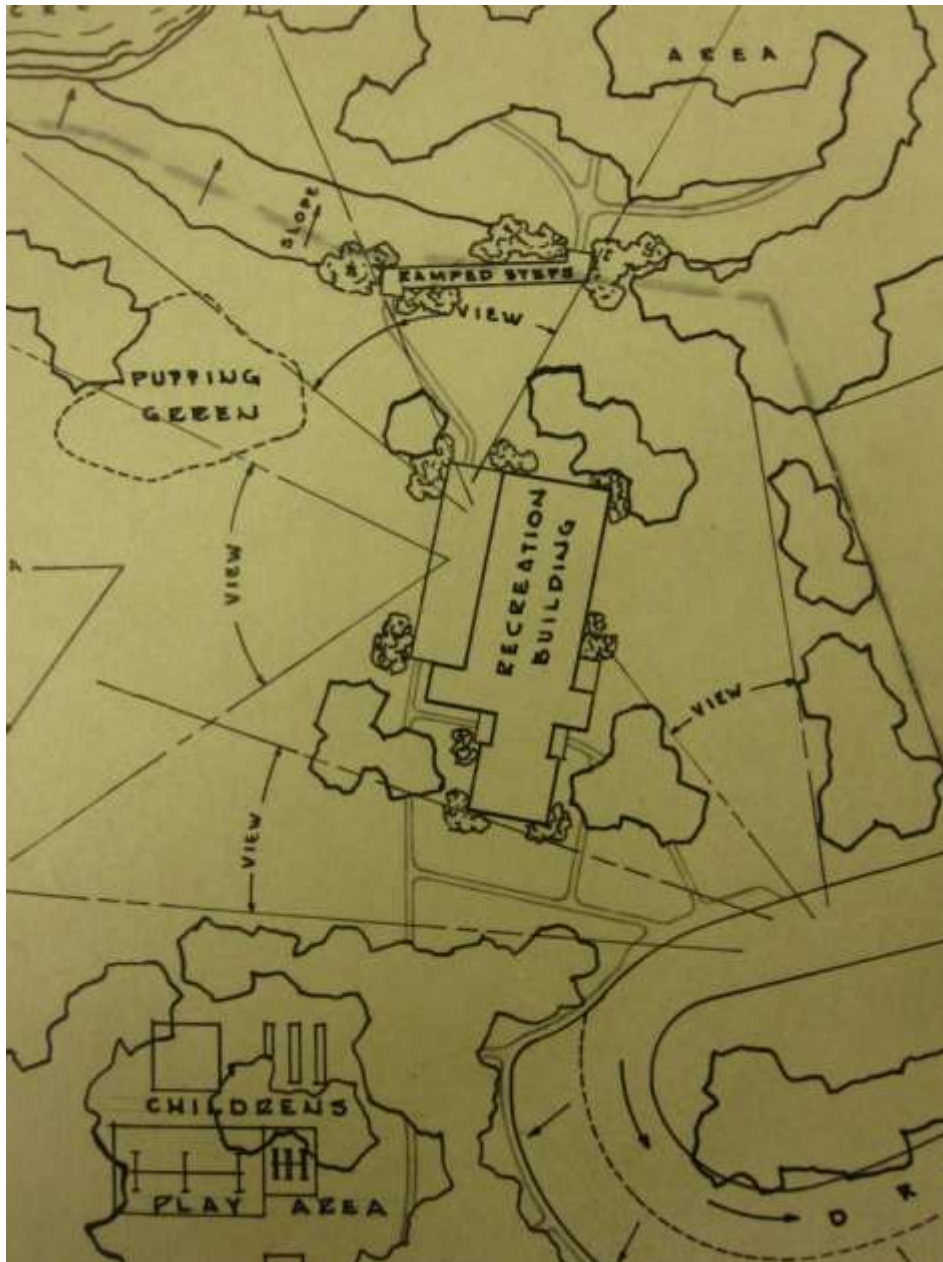

Figure 5. Detail of Veirs Mill Recreation Building in the 1954 Preliminary Development Plan.
Courtesy: M-NCPPC.

Maryland Historical Trust Maryland Inventory of Historic Properties Form

Inventory No.

Name: Veirs Mill Recreation Building
Continuation Sheet

Number 8 Page 6

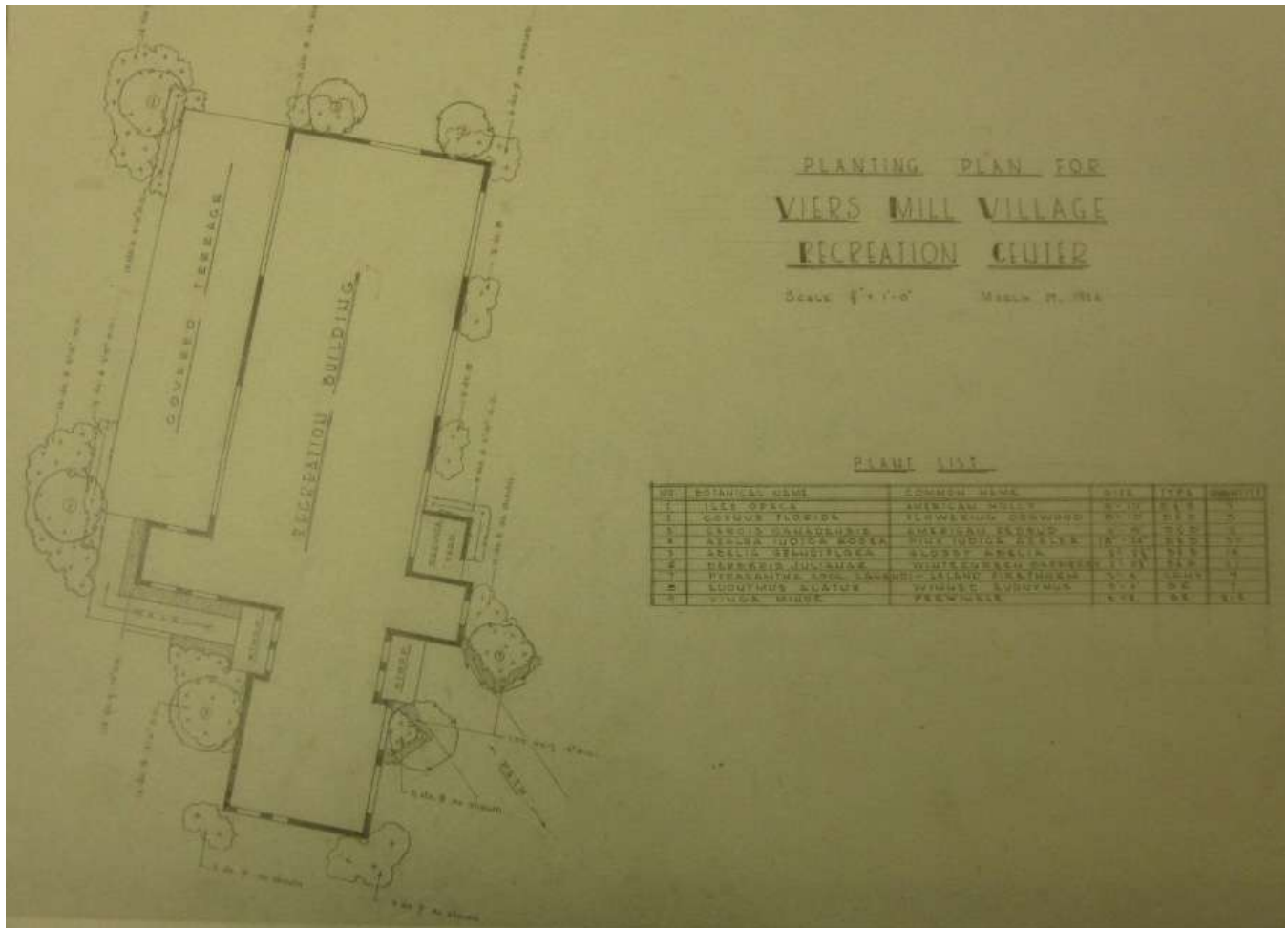

Figure 6. "Planting Plan for Viers Mill Village Recreation Center, 1954."
Courtesy: M-NCPPC.

Maryland Historical Trust Maryland Inventory of Historic Properties Form

Inventory No.

Name: Veirs Mill Recreation Building
Continuation Sheet

Number 8 Page 7

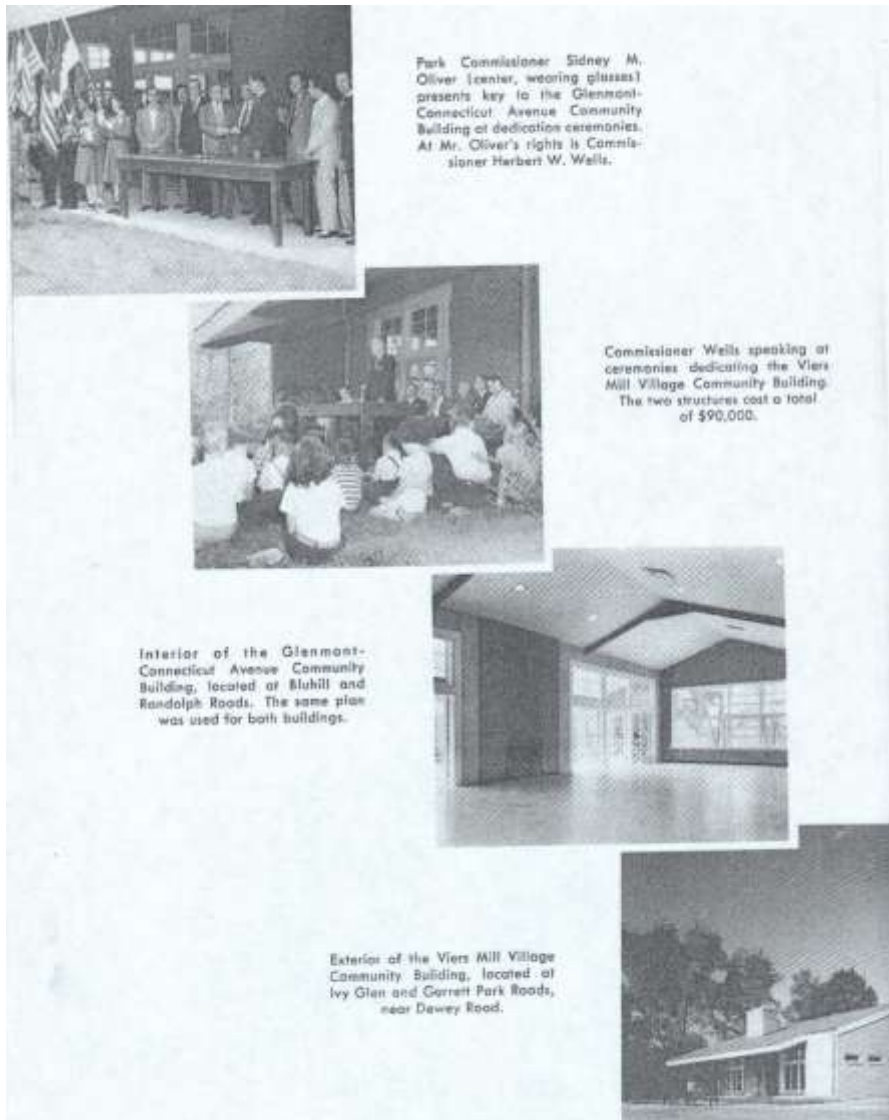

Figure 7. Black and white photos documenting the official opening and dedication of both Veirs Mill and Glenmont Recreation Buildings in the M-NCPPC *Annual Report 1954-1955*.

Courtesy: M-NCPPC.

Maryland Historical Trust Maryland Inventory of Historic Properties Form

Inventory No.

Name: Veirs Mill Recreation Building
Continuation Sheet

Number 8 Page 8



Figure 8. View of Veirs Mill Recreation Building, east elevation/front façade.

Maryland Historical Trust Maryland Inventory of Historic Properties Form

Inventory No.

Name: Veirs Mill Recreation Building
Continuation Sheet

Number 8 Page 9



Figure 9. View of Veirs Mill Recreation Building, northeast corner.

Maryland Historical Trust Maryland Inventory of Historic Properties Form

Inventory No.

Name: Veirs Mill Recreation Building
Continuation Sheet

Number 8 Page 10



Figure 10. View of Veirs Mill Recreation Building, north elevation.

Maryland Historical Trust Maryland Inventory of Historic Properties Form

Inventory No.

Name: Veirs Mill Recreation Building
Continuation Sheet

Number 8 Page 11



Figure 11. View of Veirs Mill Recreation Building, west (rear) elevation.

Maryland Historical Trust Maryland Inventory of Historic Properties Form

Inventory No.

Name: Veirs Mill Recreation Building
Continuation Sheet

Number 8 Page 12



Figure 12. View of Veirs Mill Recreation building, west (rear) elevation.

Maryland Historical Trust Maryland Inventory of Historic Properties Form

Inventory No.

Name: Veirs Mill Recreation Building
Continuation Sheet

Number 8 Page 13



Figure 13. View of Veirs Mill Recreation Building, south elevation.

Maryland Historical Trust Maryland Inventory of Historic Properties Form

Inventory No.

Name: Veirs Mill Recreation Building
Continuation Sheet

Number 8 Page 14



Figure 14. Interior detail of open space, Veirs Mill Recreation Building.