

SECTIONAL MAP AMENDMENT H-109

for the

ASPEN HILL MINOR MASTER PLAN AMENDMENT



CERTIFICATION

This is to certify that the Master Plan Map index displaying the changes involved in this application, and base maps as shown herein are certified copies of the digital zoning map on which existing and proposed zone boundaries are delineated by both line and text, are correct as shown; and by this certification, they are hereby part of the Maryland-National Capital Park and Planning Commission's Application as required by the Zoning Ordinance, for the Maryland-Washington Regional District in Montgomery County, Maryland.

4-8-15

Date

Glenn Kreger

Glenn Kreger
Division Chief
Area 2 Division

SECTIONAL MAP AMENDMENT FOR ASPEN HILL MINOR MASTER PLAN AMENDMENT

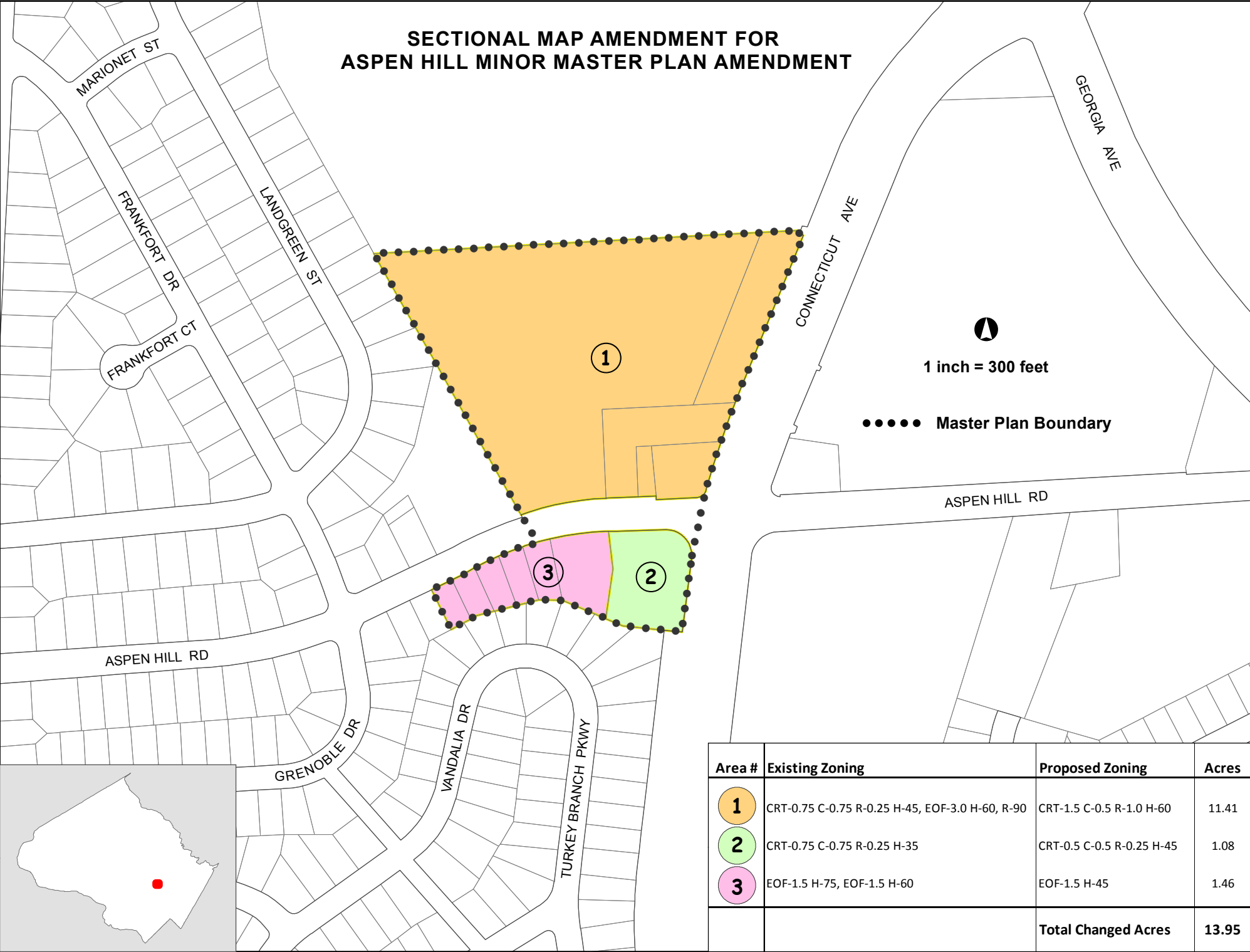

Area #	Existing Zoning	Proposed Zoning	Acres
1	CRT-0.75 C-0.75 R-0.25 H-45, EOF-3.0 H-60, R-90	CRT-1.5 C-0.5 R-1.0 H-60	11.41
2	CRT-0.75 C-0.75 R-0.25 H-35	CRT-0.5 C-0.5 R-0.25 H-45	1.08
3	EOF-1.5 H-75, EOF-1.5 H-60	EOF-1.5 H-45	1.46
Total Changed Acres			13.95

Existing Zoning

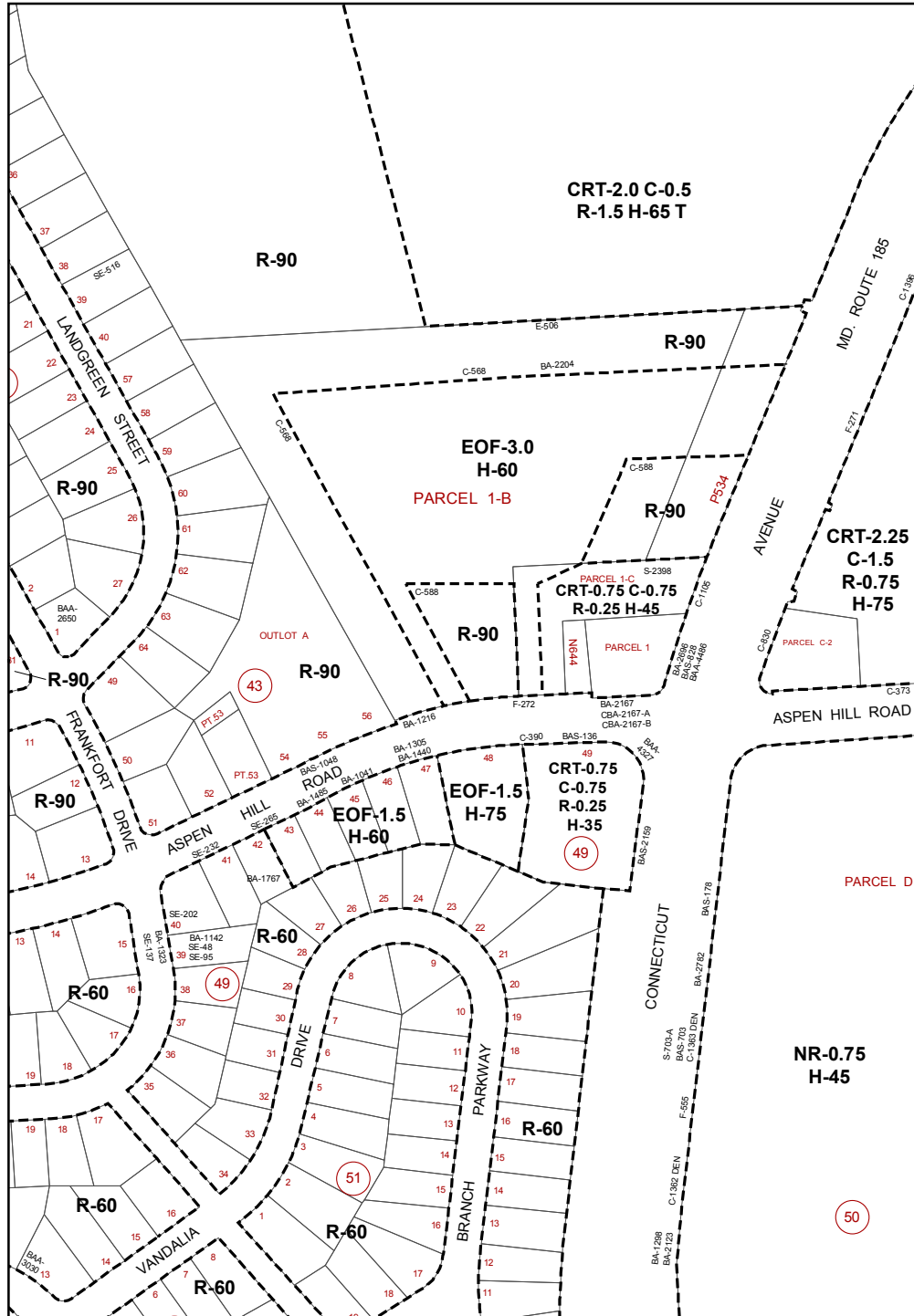

Proposed Zoning

