



---

## CERTIFICATION

This is to certify that the Sector Plan Map index displaying the changes involved in this application, and base maps as shown herein are certified copies of the digital zoning map on which existing and proposed zone boundaries are delineated by both line and text, are correct as shown; and by this certification, they are hereby part of the Maryland-National Capital Park and Planning Commission's Application as required by the Zoning Ordinance, for the Maryland-Washington Regional District in Montgomery County, Maryland.

---

7.20.20

---

Date

---

Elza Hisel-McCoy  
Division Chief  
Area 1 Division

# Attachment 1 - Map 2

## SECTIONAL MAP AMENDMENT (H-137) FOR FOREST GLEN / MONTGOMERY HILLS SECTOR PLAN

1 inch = 1,400 feet

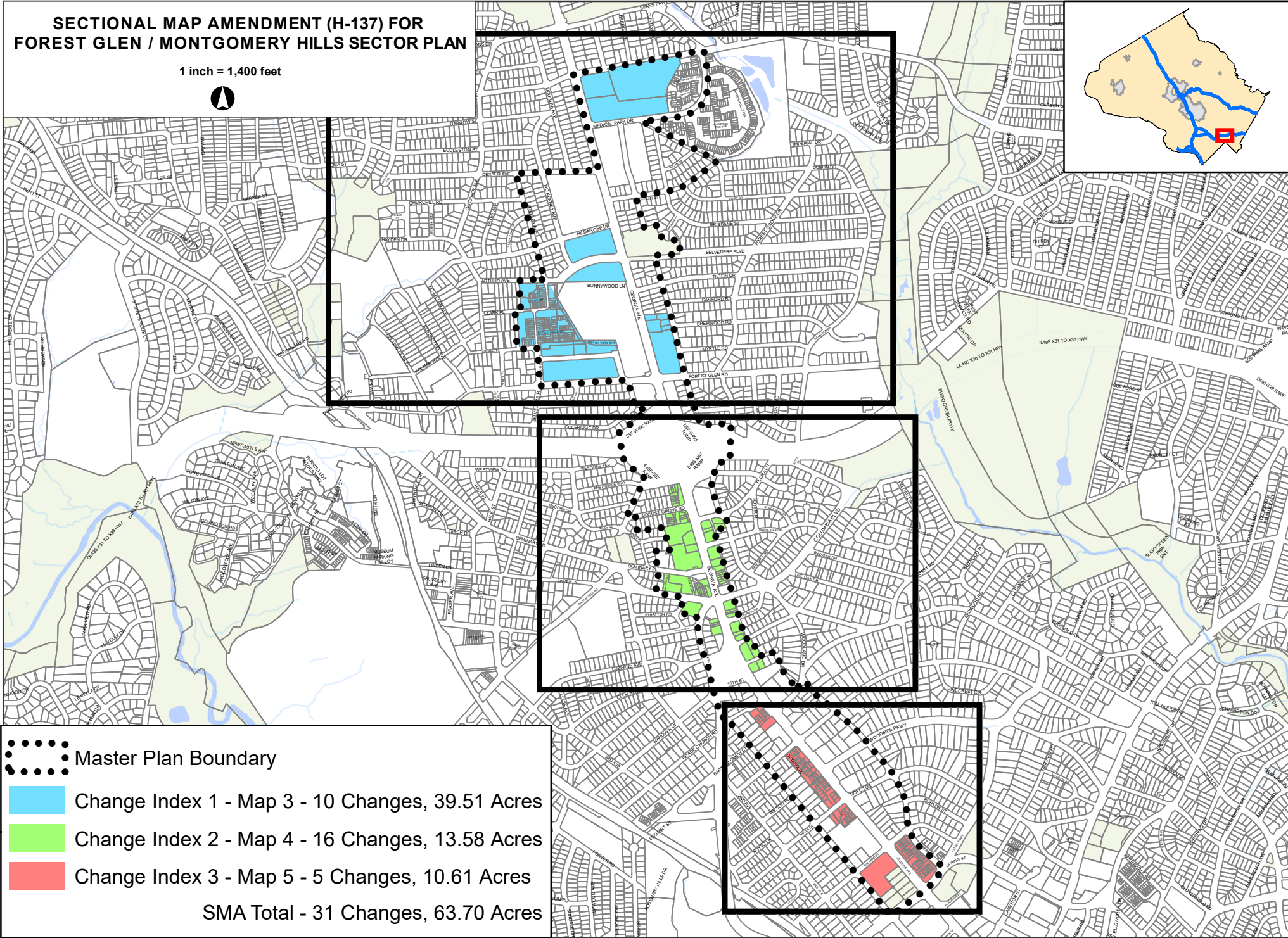

- Master Plan Boundary
- Change Index 1 - Map 3 - 10 Changes, 39.51 Acres
- Change Index 2 - Map 4 - 16 Changes, 13.58 Acres
- Change Index 3 - Map 5 - 5 Changes, 10.61 Acres
- SMA Total - 31 Changes, 63.70 Acres

# Attachment 1 - Map 3 (Change Index 1 of 3)

## SECTIONAL MAP AMENDMENT (H-137) FOR FOREST GLEN / MONTGOMERY HILLS SECTOR PLAN

1 inch = 600 feet

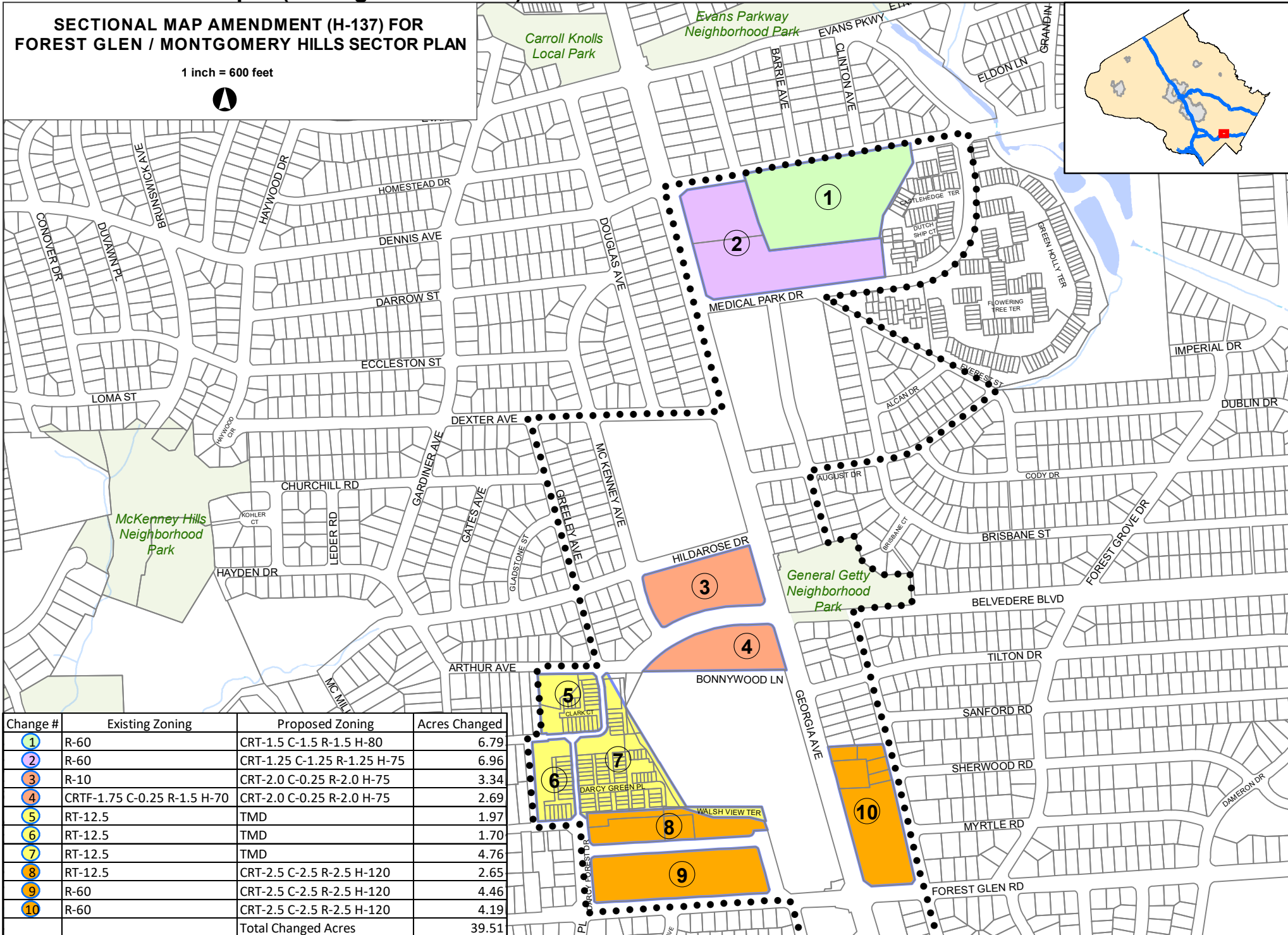
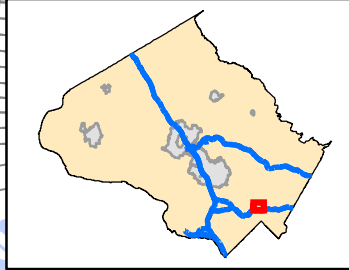

Change #	Existing Zoning	Proposed Zoning	Acres Changed
①	R-60	CRT-1.5 C-1.5 R-1.5 H-80	6.79
②	R-60	CRT-1.25 C-1.25 R-1.25 H-75	6.96
③	R-10	CRT-2.0 C-0.25 R-2.0 H-75	3.34
④	CRTF-1.75 C-0.25 R-1.5 H-70	CRT-2.0 C-0.25 R-2.0 H-75	2.69
⑤	RT-12.5	TMD	1.97
⑥	RT-12.5	TMD	1.70
⑦	RT-12.5	TMD	4.76
⑧	RT-12.5	CRT-2.5 C-2.5 R-2.5 H-120	2.65
⑨	R-60	CRT-2.5 C-2.5 R-2.5 H-120	4.46
⑩	R-60	CRT-2.5 C-2.5 R-2.5 H-120	4.19
		Total Changed Acres	39.51



# Attachment 1 - Map 4 (Change Index 2 of 3)

## SECTIONAL MAP AMENDMENT (H-137) FOR FOREST GLEN / MONTGOMERY HILLS SECTOR PLAN

1 inch = 350 feet

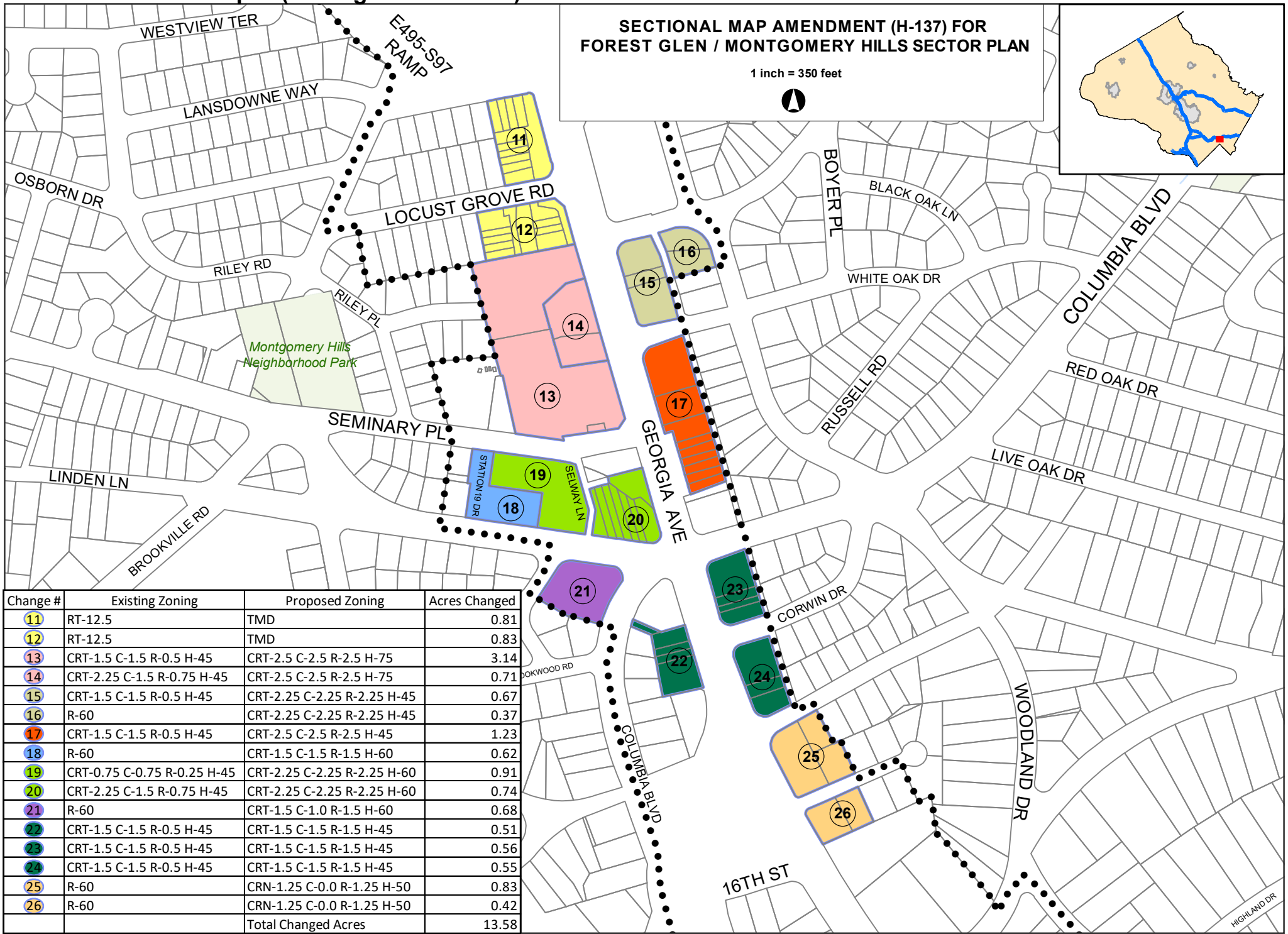

Change #	Existing Zoning	Proposed Zoning	Acres Changed
11	RT-12.5	TMD	0.81
12	RT-12.5	TMD	0.83
13	CRT-1.5 C-1.5 R-0.5 H-45	CRT-2.5 C-2.5 R-2.5 H-75	3.14
14	CRT-2.25 C-1.5 R-0.75 H-45	CRT-2.5 C-2.5 R-2.5 H-75	0.71
15	CRT-1.5 C-1.5 R-0.5 H-45	CRT-2.25 C-2.25 R-2.25 H-45	0.67
16	R-60	CRT-2.25 C-2.25 R-2.25 H-45	0.37
17	CRT-1.5 C-1.5 R-0.5 H-45	CRT-2.5 C-2.5 R-2.5 H-45	1.23
18	R-60	CRT-1.5 C-1.5 R-1.5 H-60	0.62
19	CRT-0.75 C-0.75 R-0.25 H-45	CRT-2.25 C-2.25 R-2.25 H-60	0.91
20	CRT-2.25 C-1.5 R-0.75 H-45	CRT-2.25 C-2.25 R-2.25 H-60	0.74
21	R-60	CRT-1.5 C-1.0 R-1.5 H-60	0.68
22	CRT-1.5 C-1.5 R-0.5 H-45	CRT-1.5 C-1.5 R-1.5 H-45	0.51
23	CRT-1.5 C-1.5 R-0.5 H-45	CRT-1.5 C-1.5 R-1.5 H-45	0.56
24	CRT-1.5 C-1.5 R-0.5 H-45	CRT-1.5 C-1.5 R-1.5 H-45	0.55
25	R-60	CRN-1.25 C-0.0 R-1.25 H-50	0.83
26	R-60	CRN-1.25 C-0.0 R-1.25 H-50	0.42
Total Changed Acres			13.58

# Attachment 1 - Map 5 (Change Index 3 of 3)

## SECTIONAL MAP AMENDMENT (H-137) FOR FOREST GLEN / MONTGOMERY HILLS SECTOR PLAN

1 inch = 350 feet

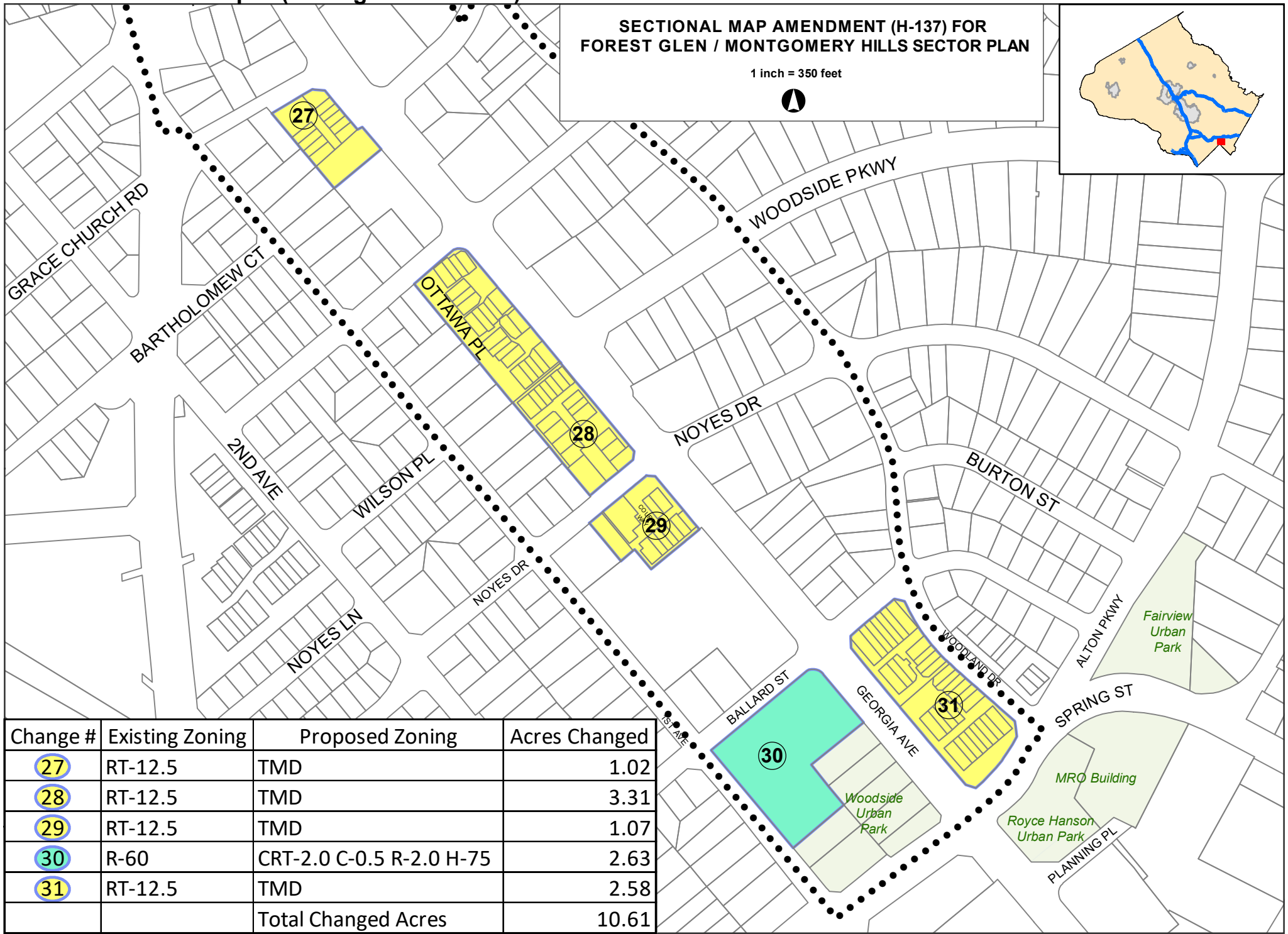

Change #	Existing Zoning	Proposed Zoning	Acres Changed
27	RT-12.5	TMD	1.02
28	RT-12.5	TMD	3.31
29	RT-12.5	TMD	1.07
30	R-60	CRT-2.0 C-0.5 R-2.0 H-75	2.63
31	RT-12.5	TMD	2.58
		Total Changed Acres	10.61

# Attachment 1 - Map 6

## Existing Zoning

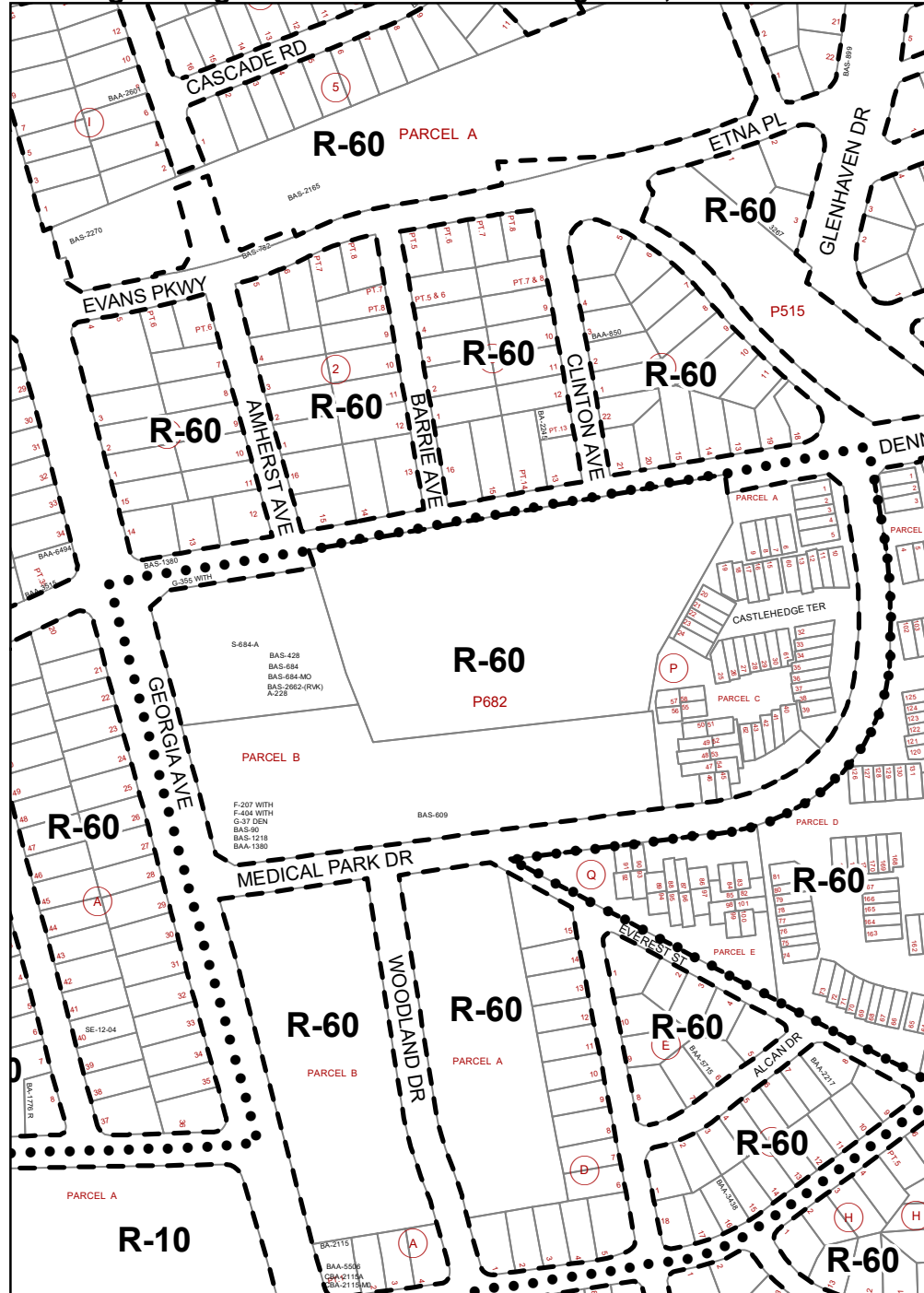

## Changes # 1,2

## Proposed Zoning

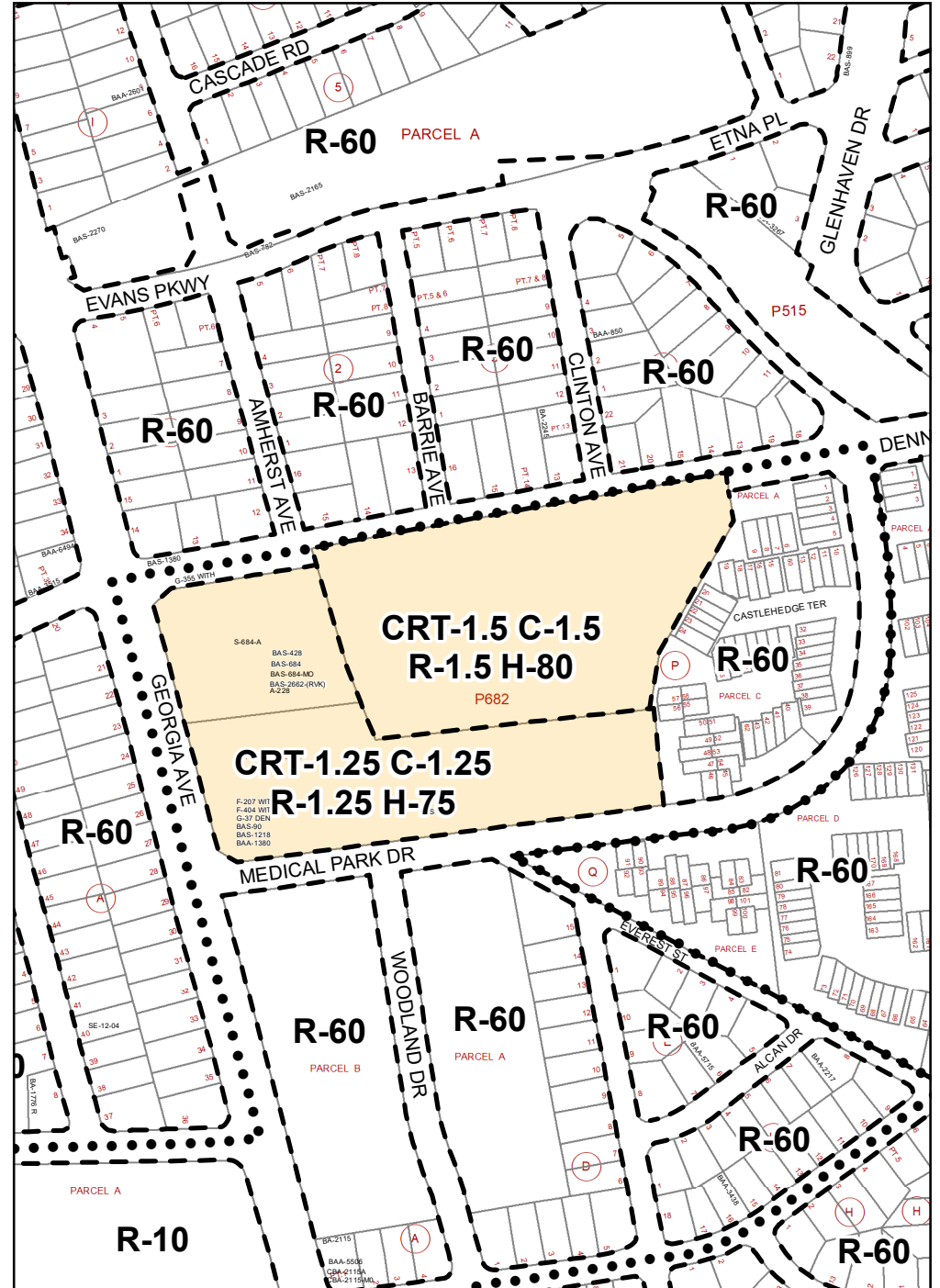

Map Grid: 213NW02

Master Plan Boundary

1 in = 350 ft



# Attachment 1 - Map 7

## Existing Zoning

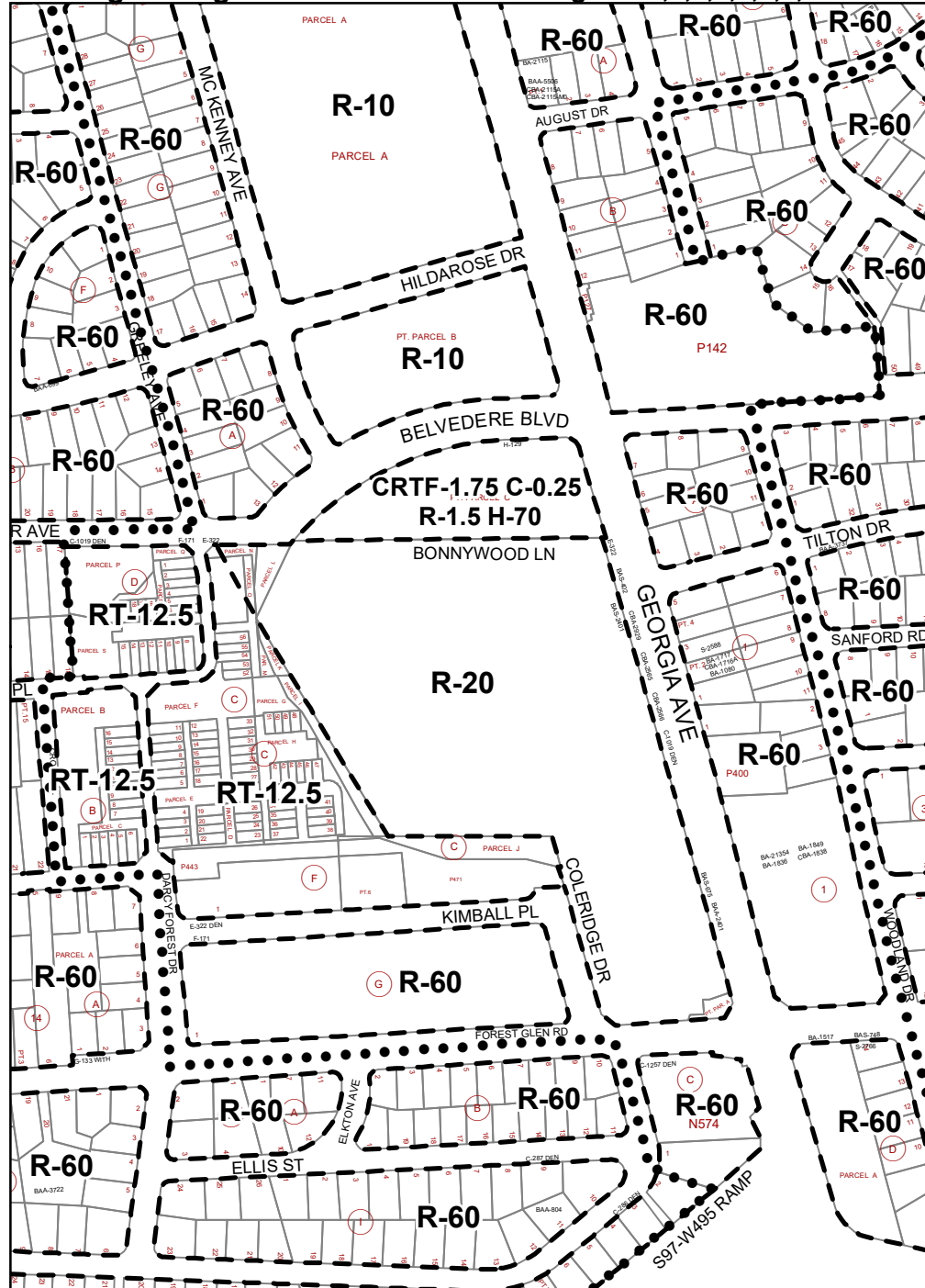

## Changes # 3,4,5,6,7,8,9,10

## Proposed Zoning

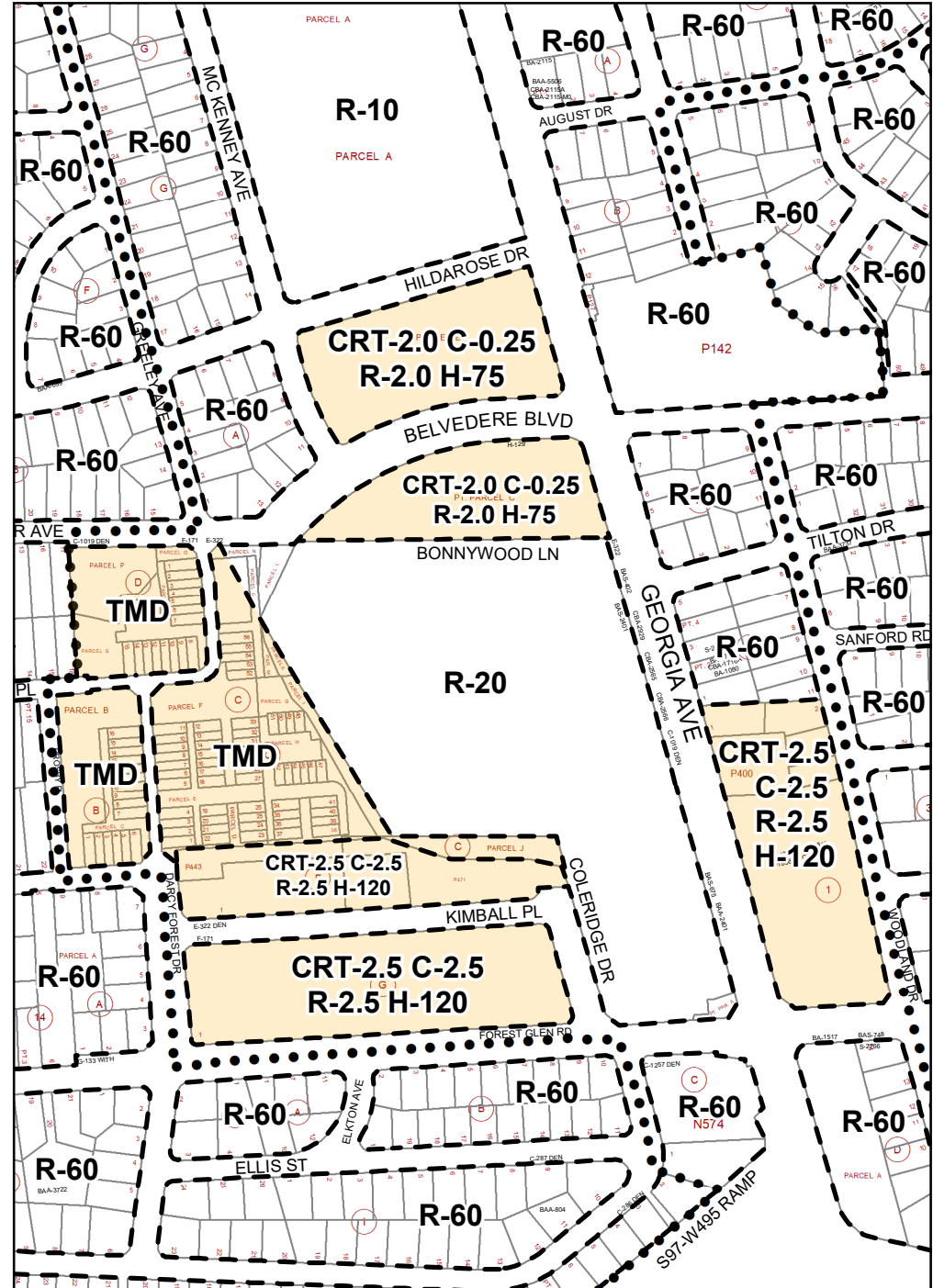

Map Grid: 212NW02

Master Plan Boundary

1 in = 400 ft

# Attachment 1 - Map 8

## Existing Zoning

Changes # 11,12,13,14,15,16,17,18,19,20

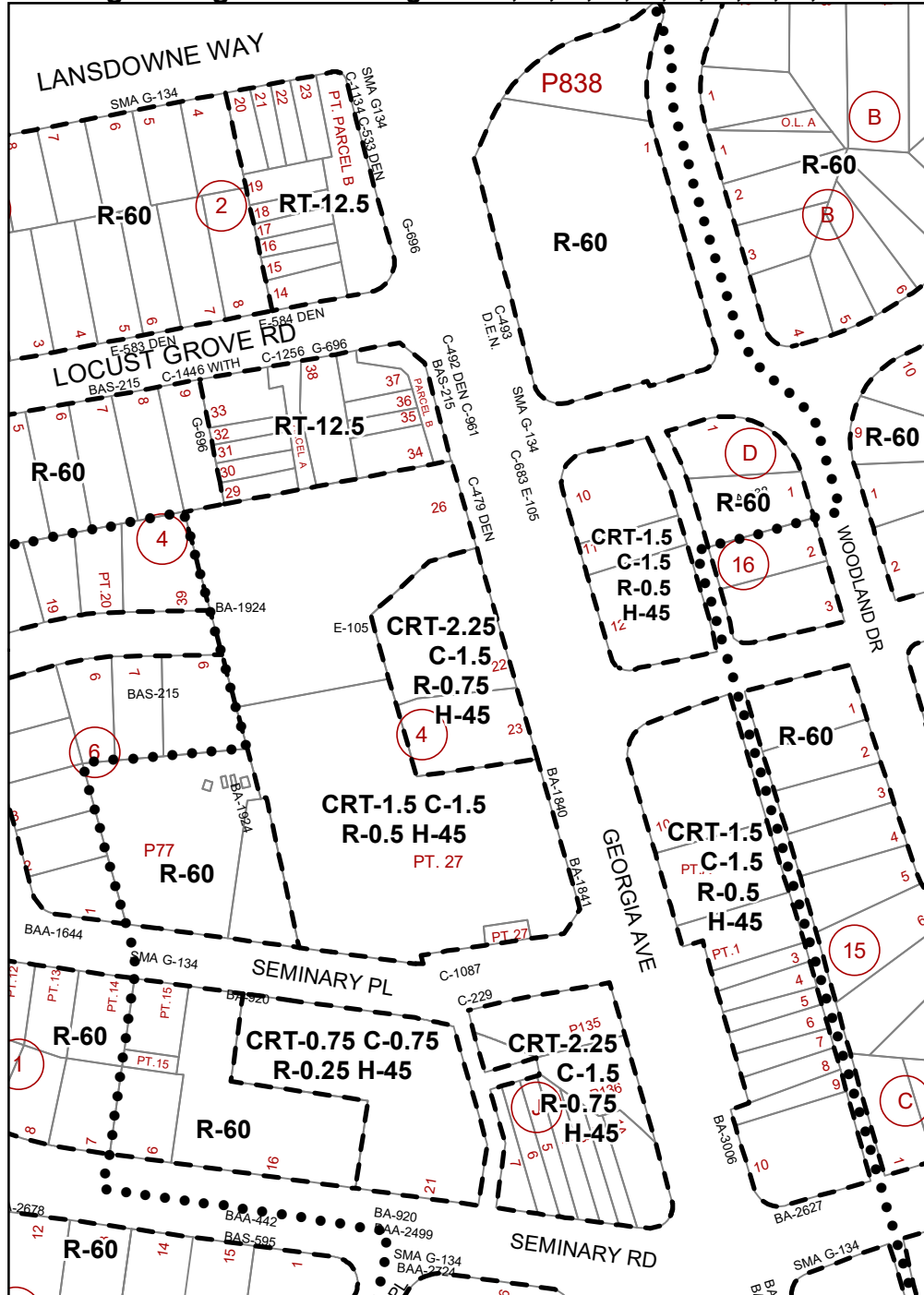

Map Grids: 212NW02 (North) and 211NW02 (South)

## Proposed Zoning

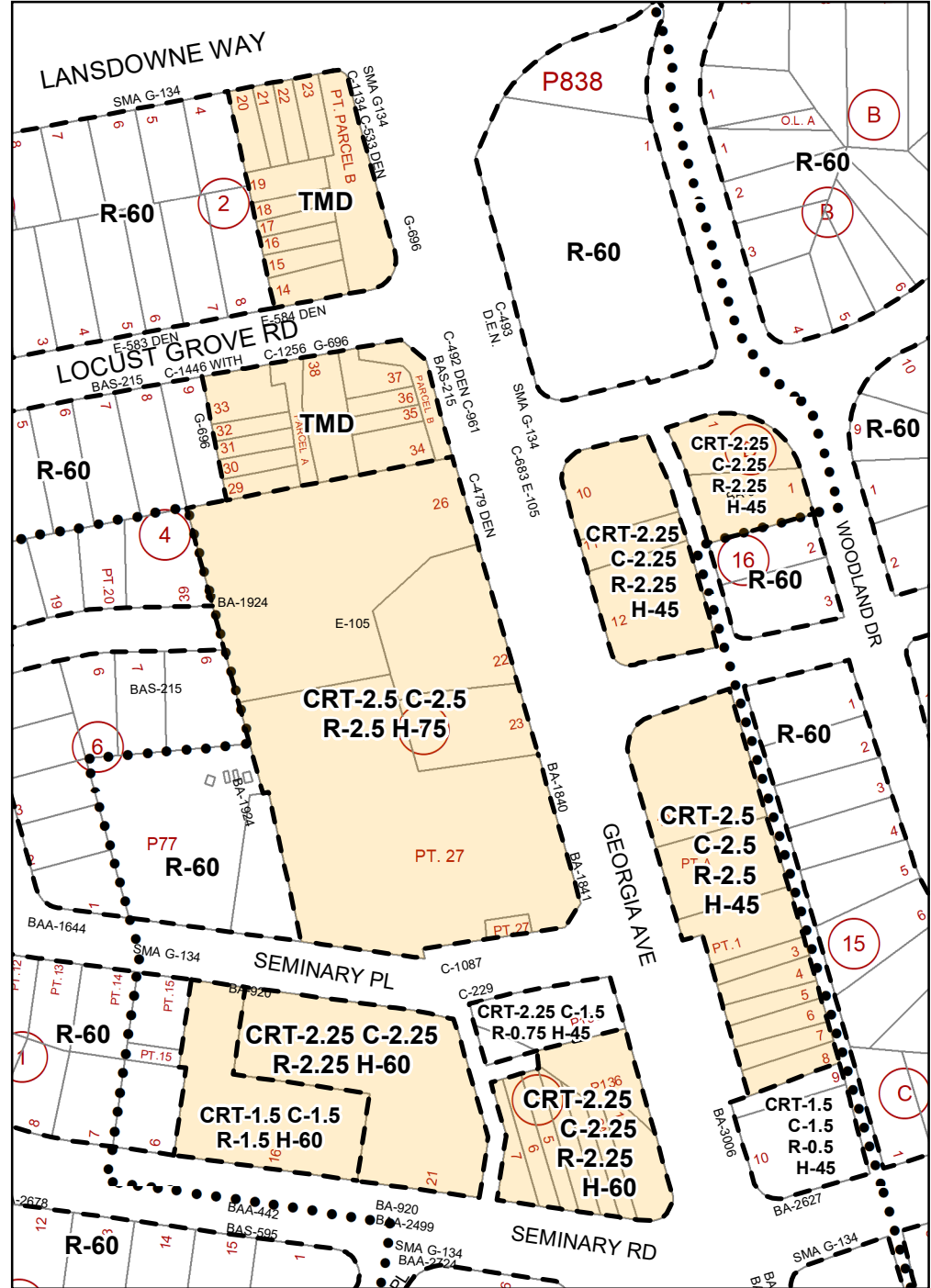

Master Plan Boundary

1 in = 200 ft





# Attachment 1 - Map 10

## Existing Zoning

Changes # 23,24,25,26

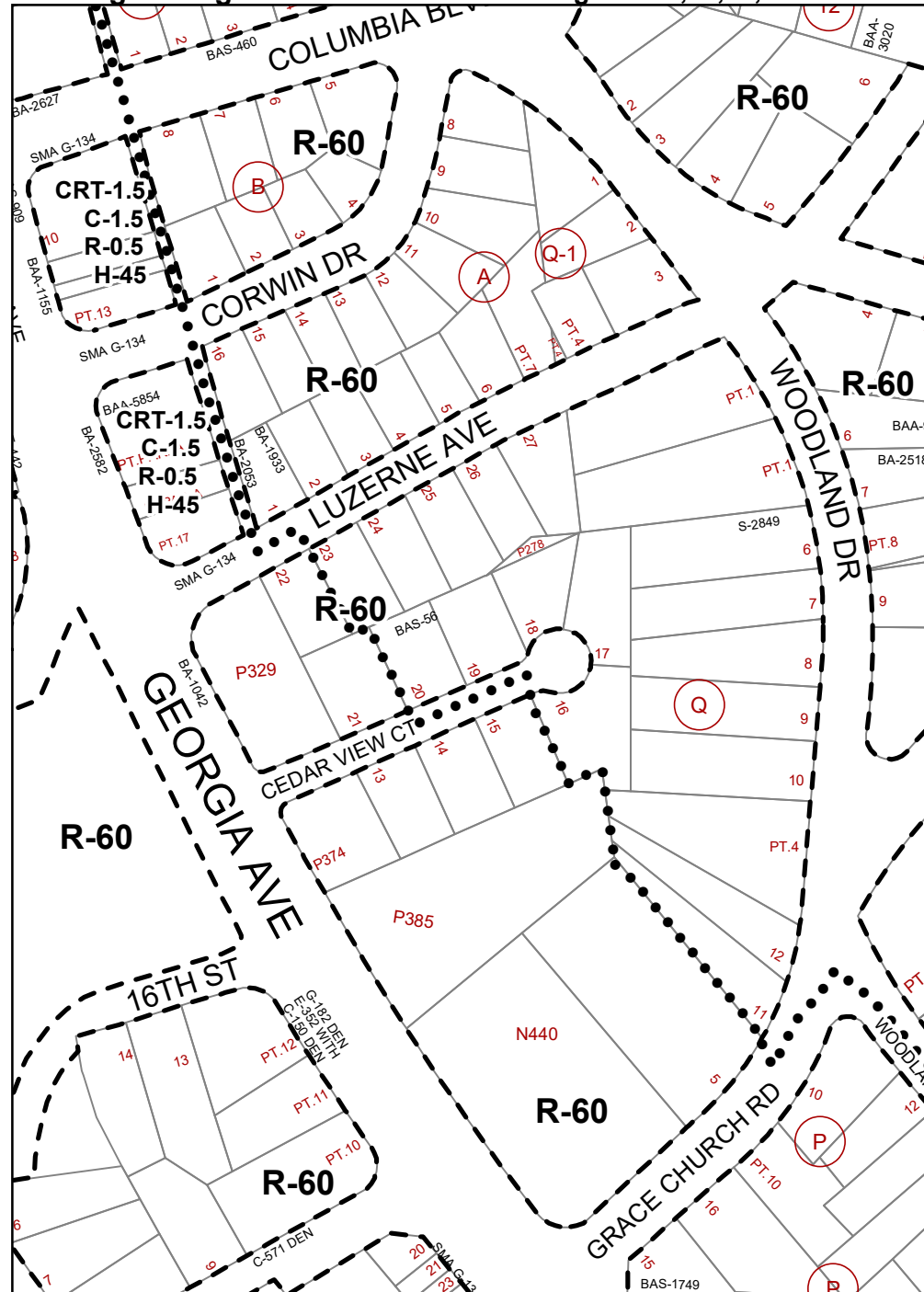

Map Grid: 211NW02

## Proposed Zoning

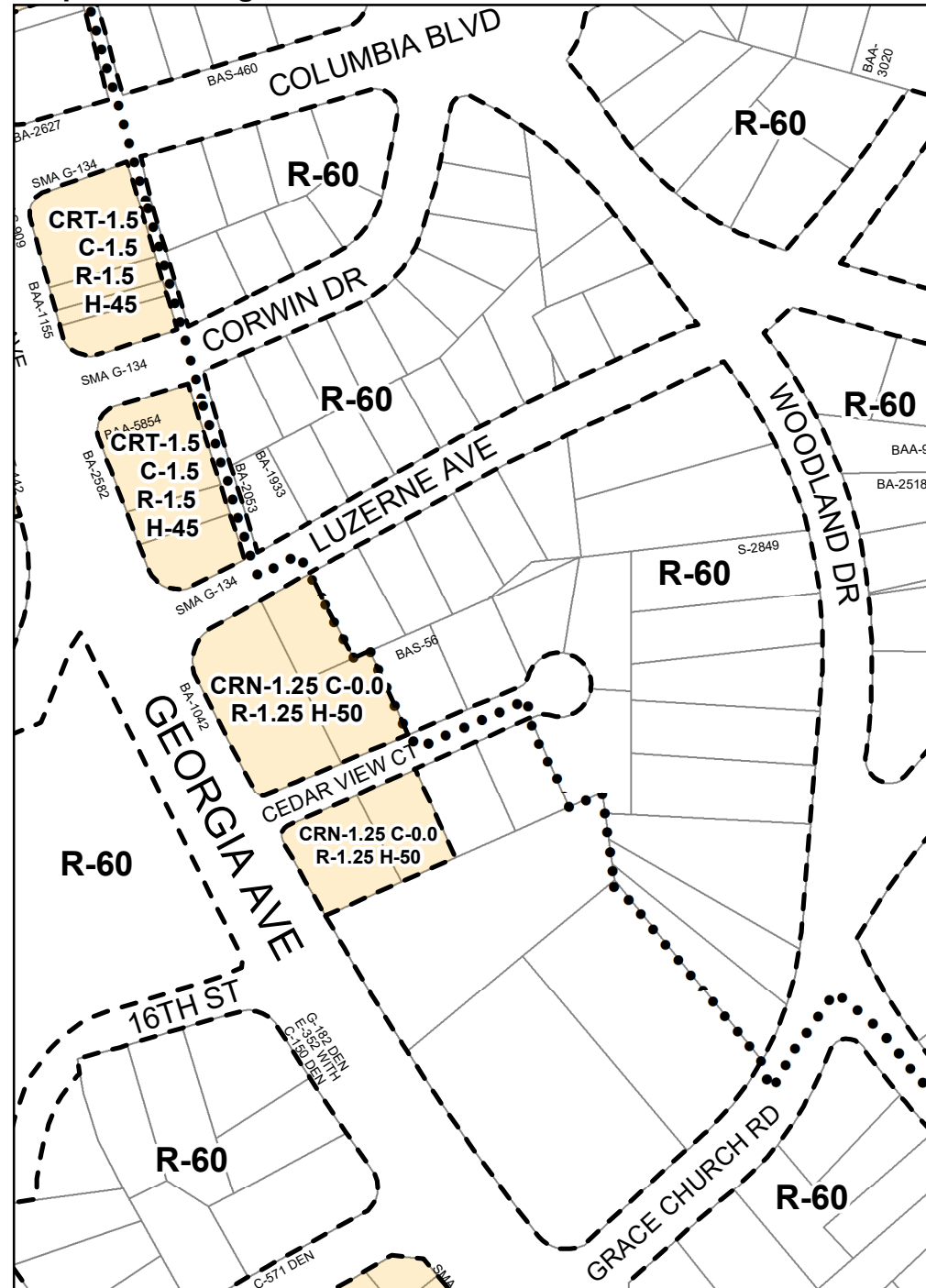

Master Plan Boundary

1 in = 200 ft

# Attachment 1 - Map 11

## Existing Zoning

## Change # 27,28,29

## Proposed Zoning

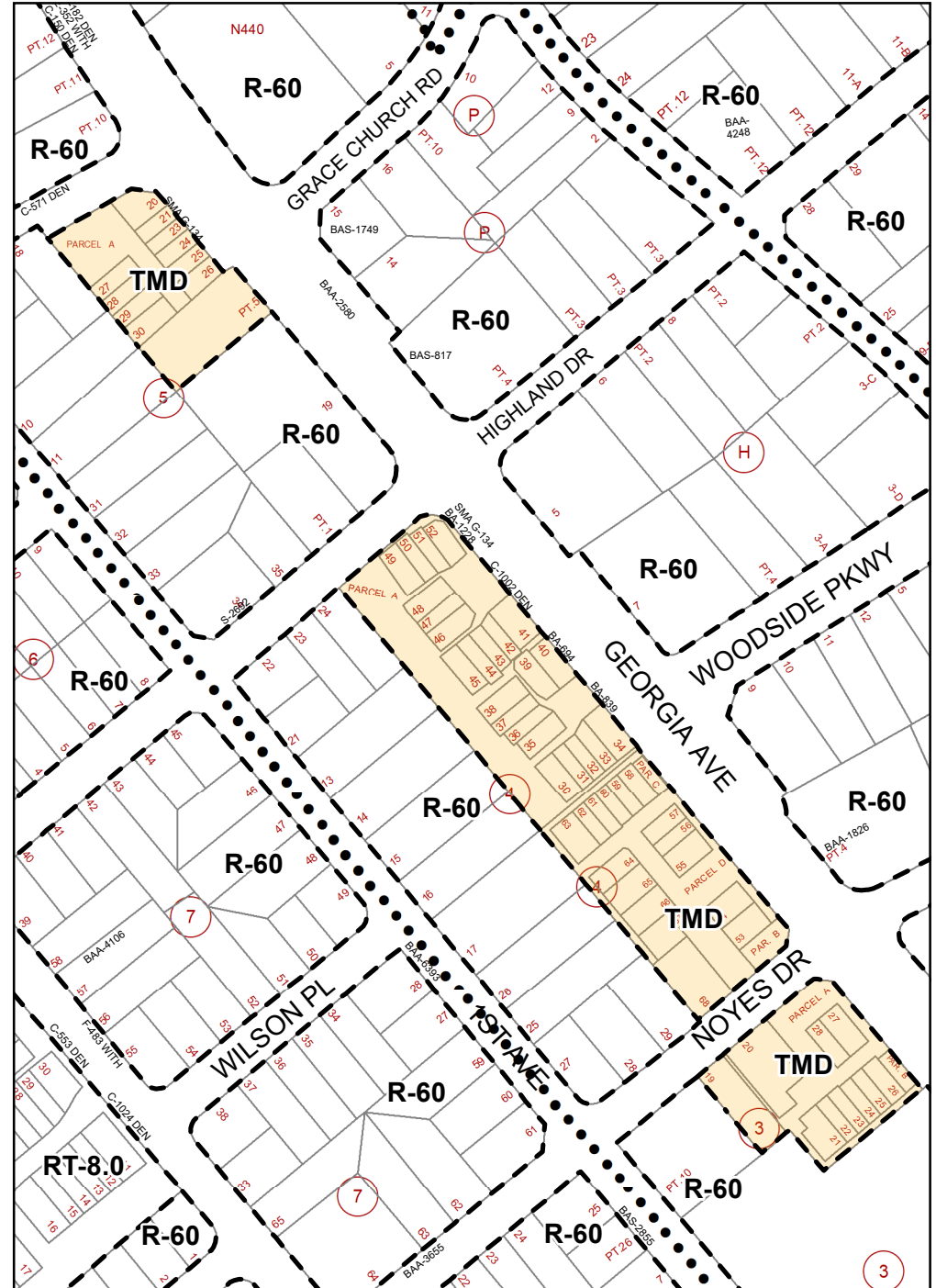
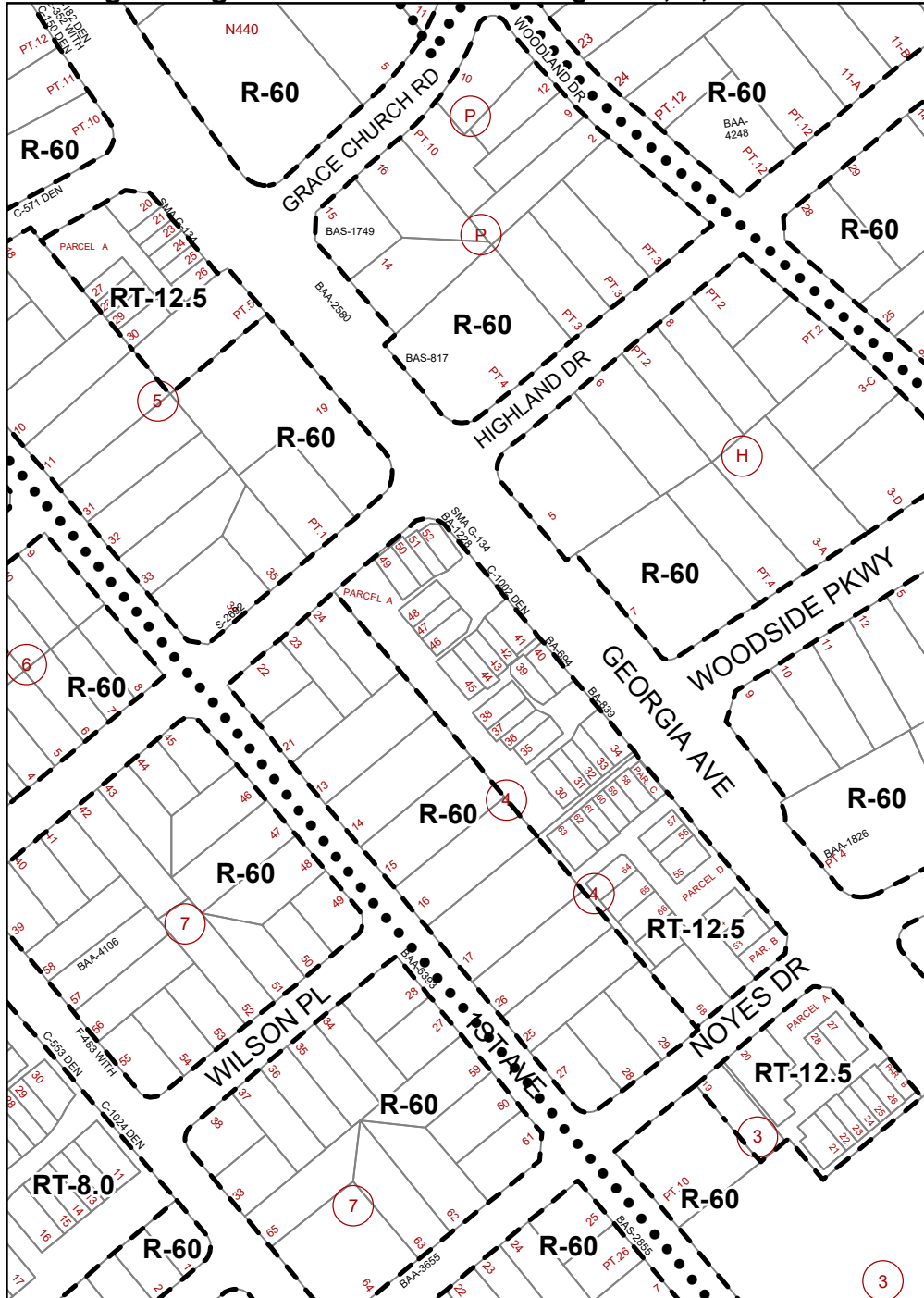

Map Grids: 211NW02 (North) and 210NW02 (South)

 Master Plan Boundary

1 in = 250 ft



# Attachment 1 - Map 12

## Existing Zoning

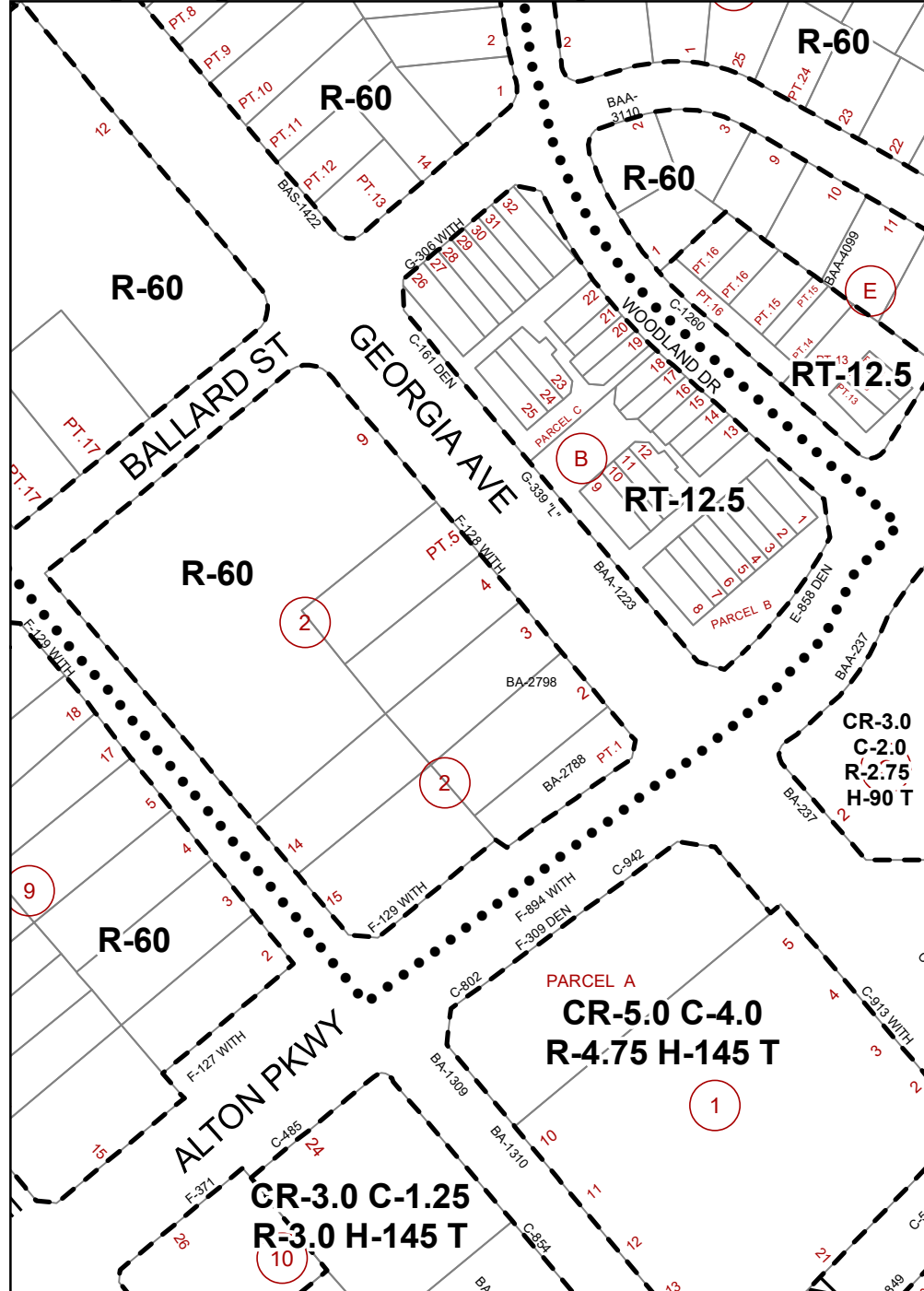

## Changes # 30,31

## Proposed Zoning

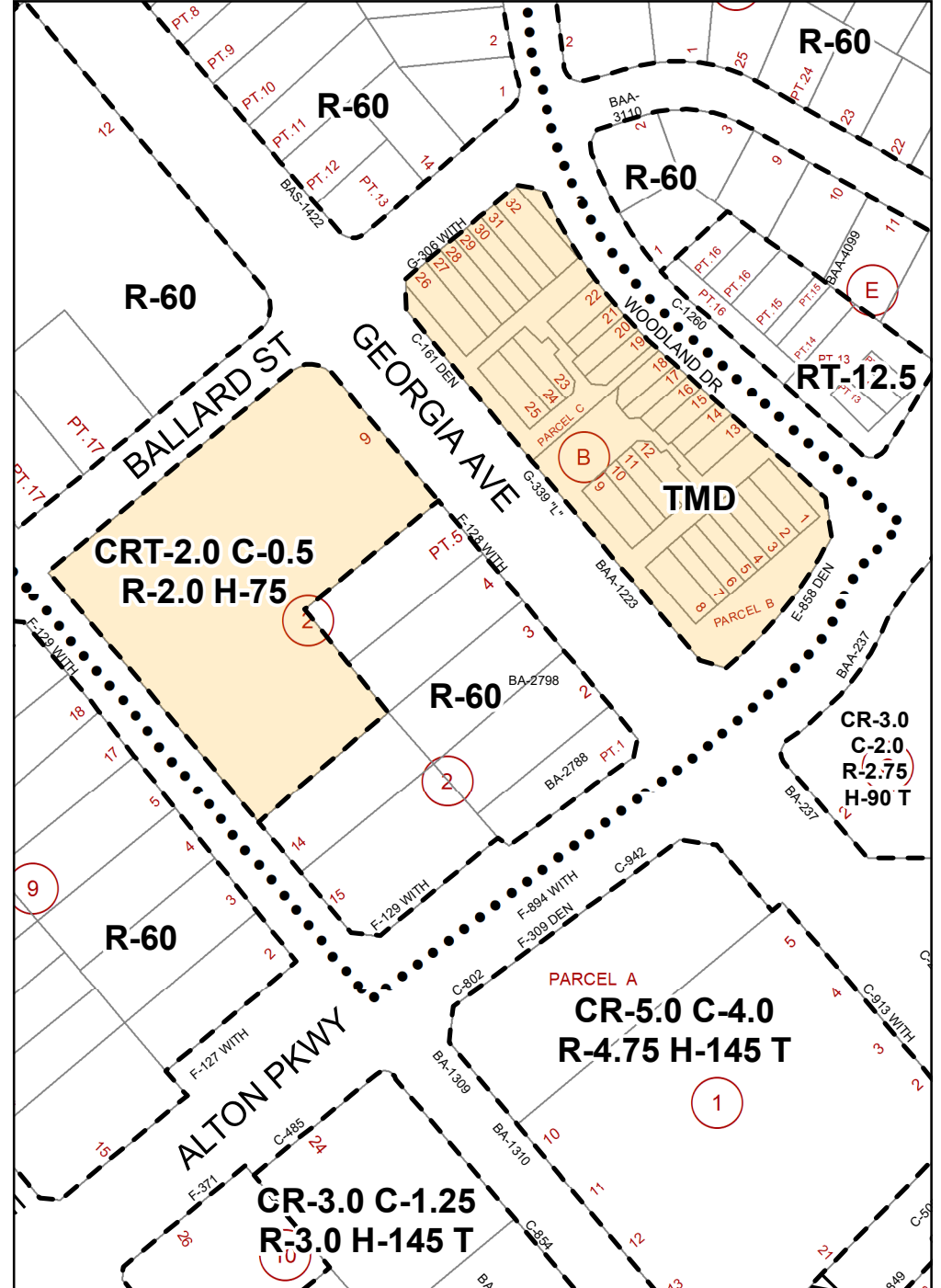

Map Grids: 211NW02 (North) and 210NW02 (South)

Master Plan Boundary

1 in = 200 ft