

SECTIONAL MAP AMENDMENT H-126
for the
ROCK SPRING MASTER PLAN

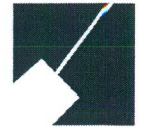

CERTIFICATION

This is to certify that the Sector Plan Map index displaying the changes involved in this application, and base maps as shown herein are certified copies of the digital zoning map on which existing and proposed zone boundaries are delineated by both line and text, are correct as shown; and by this certification, they are hereby part of the Maryland-National Capital Park and Planning Commission's Application as required by the Zoning Ordinance, for the Maryland-Washington Regional District in Montgomery County, Maryland.

1/2/18

Date

Carrie Sanders

Carrie Sanders
Division Chief
Area 2 Division

**SECTIONAL MAP AMENDMENT (H-126) FOR
ROCK SPRING MASTER PLAN**

1 inch = 800 feet

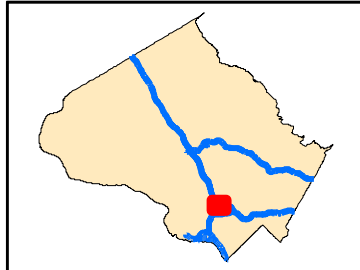

Change#	Existing Zoning	Proposed Zoning	Acres Changed
1	CRT-2.25 C-1.5 R-0.75 H-75, EOF-1.5 H-75	CRT-2.25 C-1.5 R-0.75 H-150	23.15
2	CRT-2.5 C-1.5 R-2.0 H-75	CRT-2.5 C-1.5 R-2.0 H-150	4.09
3	EOF-1.0 H-100 T	THD	9.05
4	EOF-1.25 H-150	CR-1.5 C-1.25 R-0.75 H-200	14.93
5	EOF-0.75 H-100 T	CR-1.5 C-0.75 R-0.75 H-150	33.68
6	EOF-1.0 H-110 T	CR-1.5 C-1.0 R-0.75 H-150	16.18
7	EOF-1.0 H-100 T	CR-1.5 C-1.0 R-0.75 H-100	3.93
8	EOF-1.5 H-100 T	CR-1.5 C-1.5 R-0.75 H-100	7.65
9	EOF-1.25 H-100 T	CR-1.5 C-1.25 R-0.75 H-100	3.94
10	EOF-1.0 H-100 T	CR-1.5 C-1.0 R-0.75 H-100	15.57
11	EOF-1.0 H-100 T	CR-1.5 C-1.0 R-0.75 H-200	9.07
12	CR-1.5 C-0.75 R-0.75 H-275 T	CR-1.5 C-0.75 R-0.75 H-275	3.27
13	CR-1.5 C-0.75 R-0.75 H-275 T	CR-1.5 C-0.75 R-1.0 H-275	47.26
14	NR-0.75 H-45	CRT-1.5 C-1.0 R-0.75 H-75	10.46
15	R-90, NR-0.75 H-45, CRT-0.75 C-0.75 R-0.25 H-35	CRT-1.25 C-0.75 R-0.75 H-50	11.77
16	EOF-1.0 H-100 T	EOF-1.0 H-100	31.05
Total Changed Acres			245.05

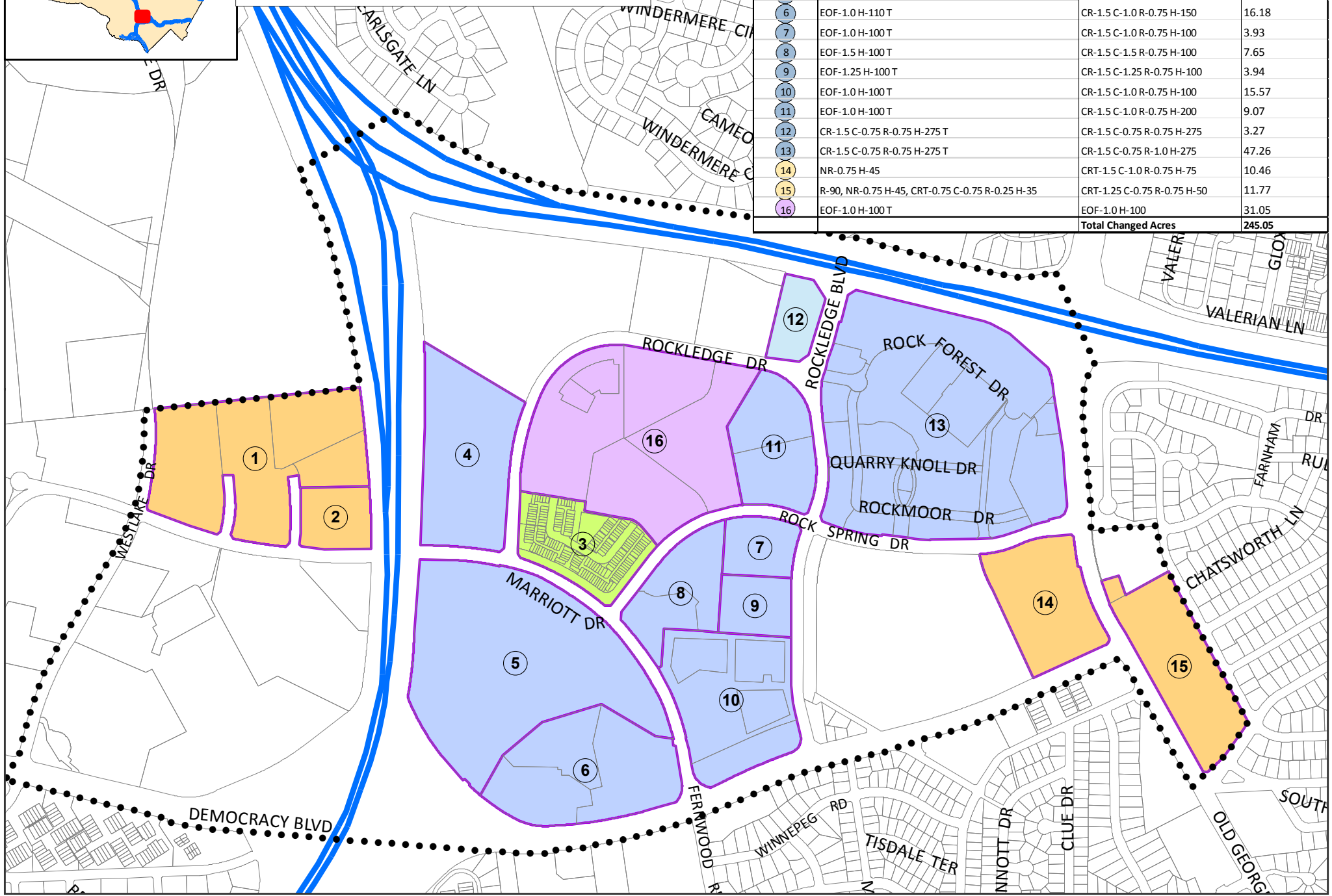

Attachment 1 - Map 3
Existing Zoning

Changes 1, 2

Proposed Zoning

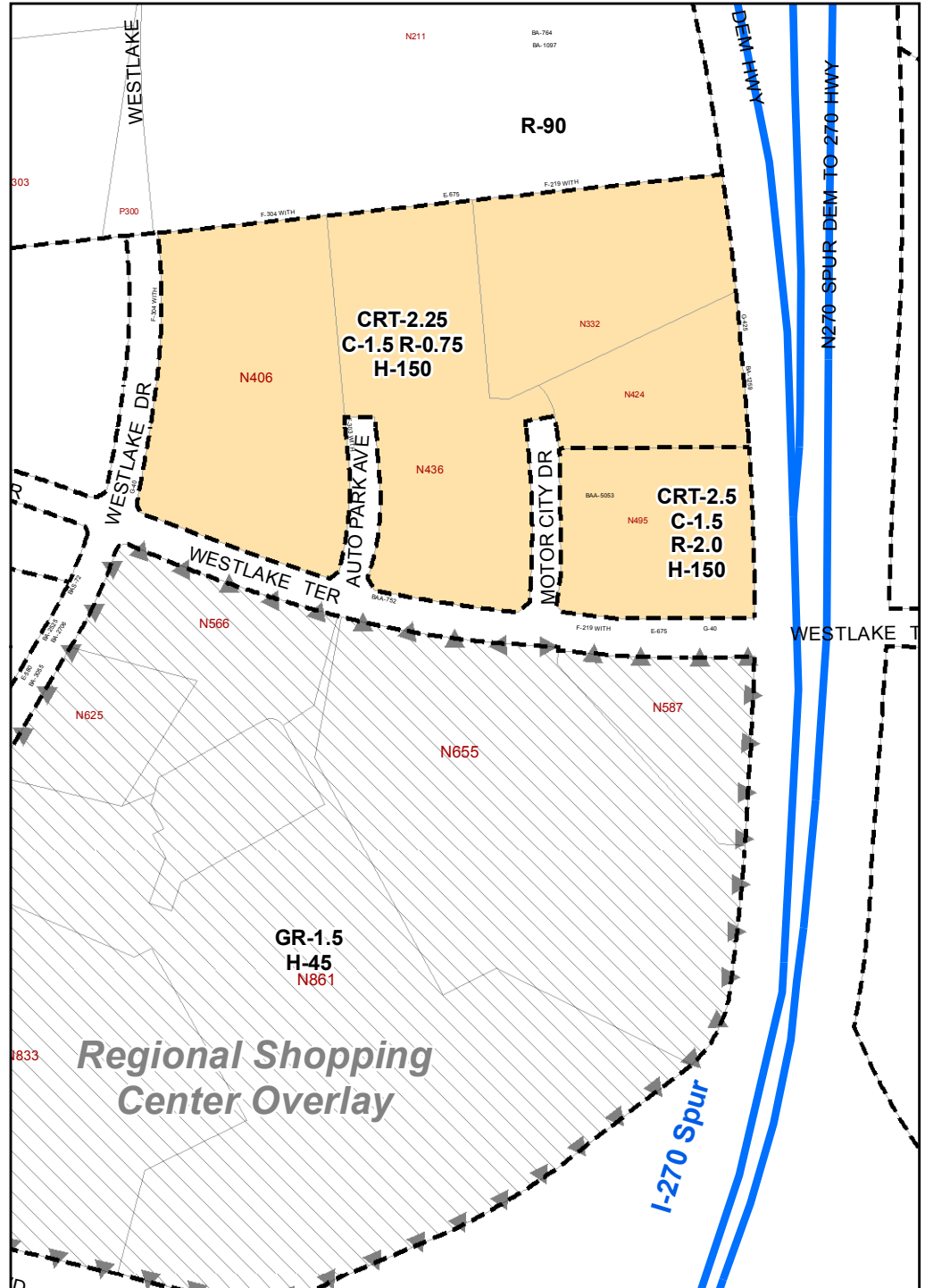
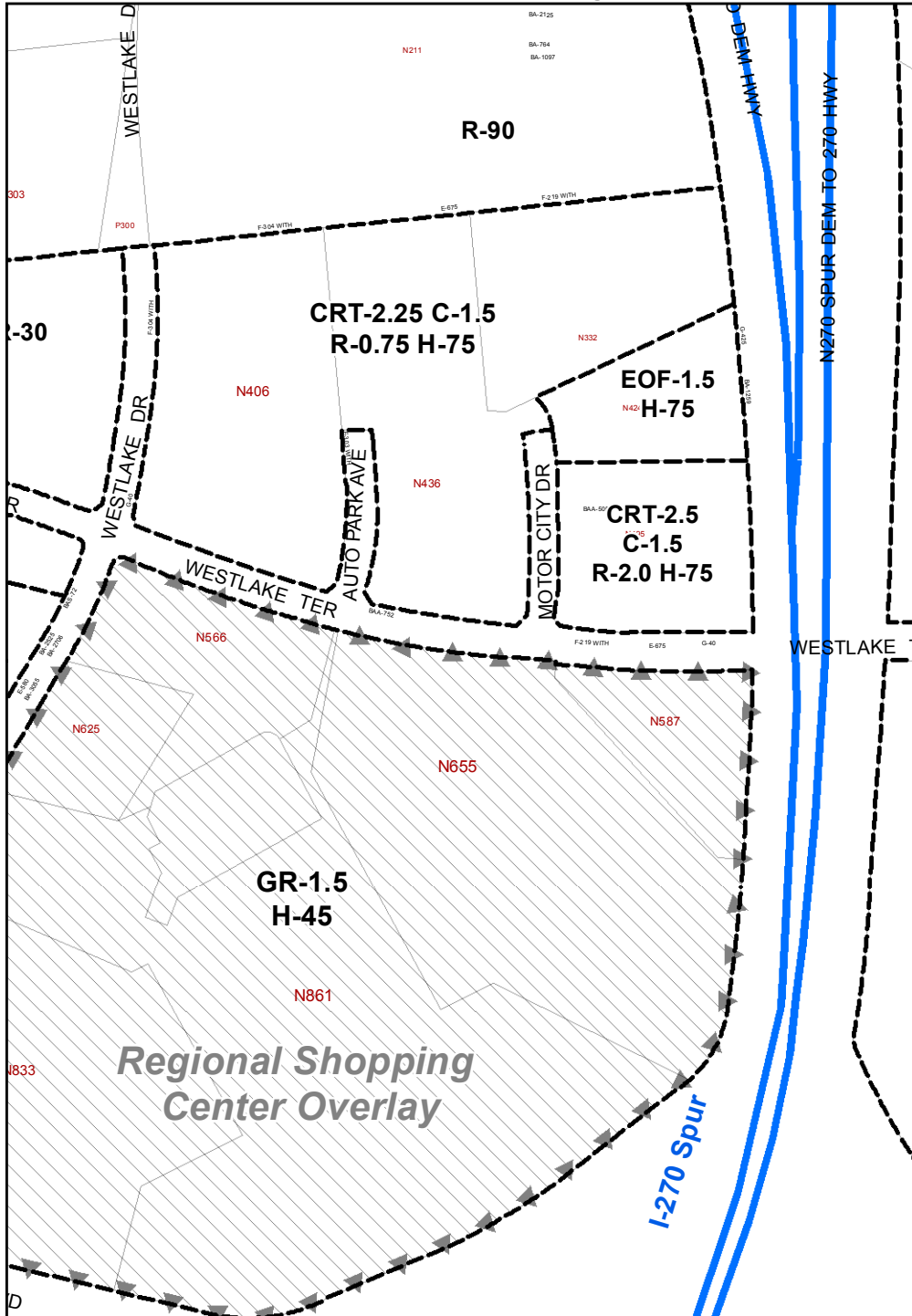

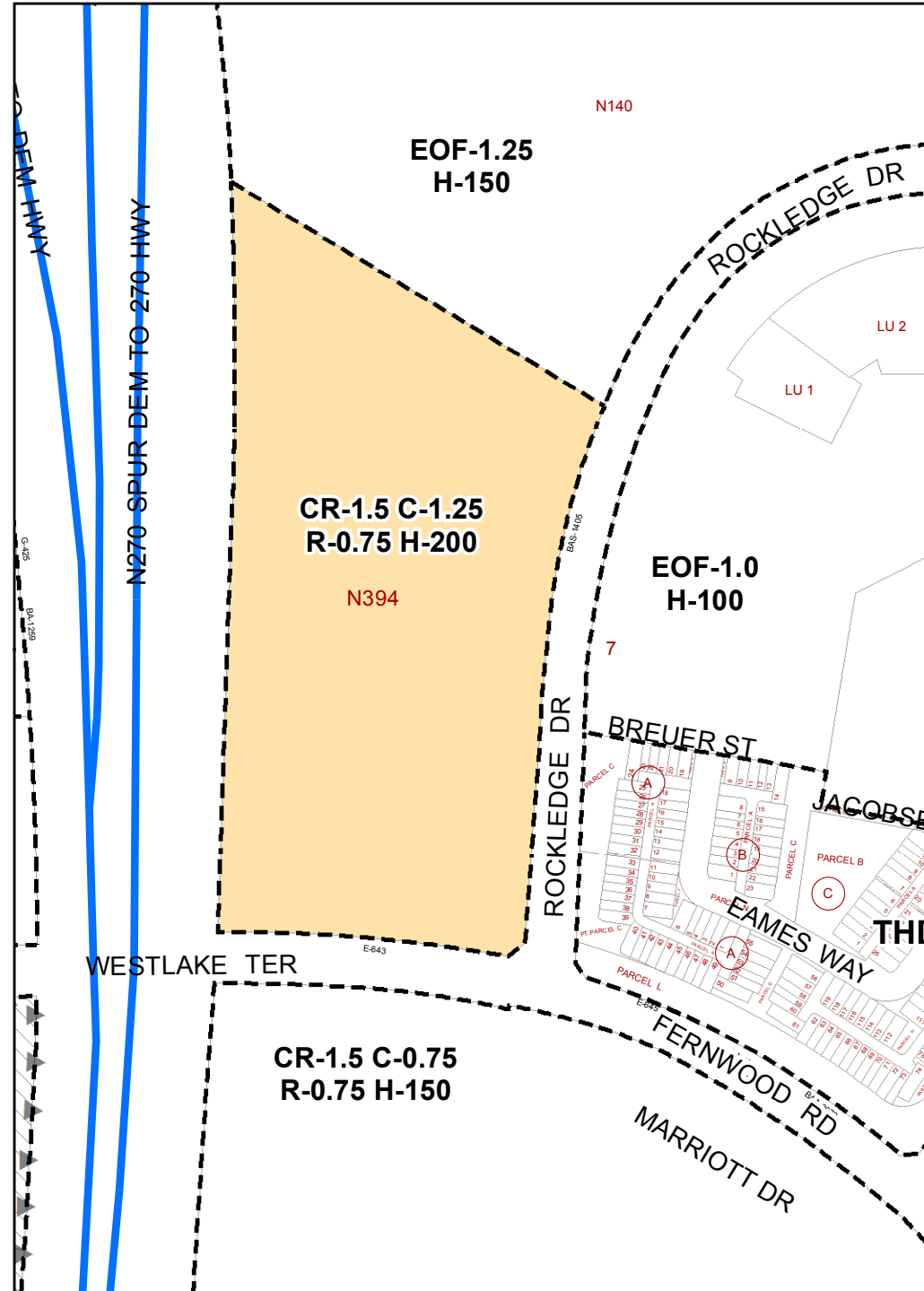
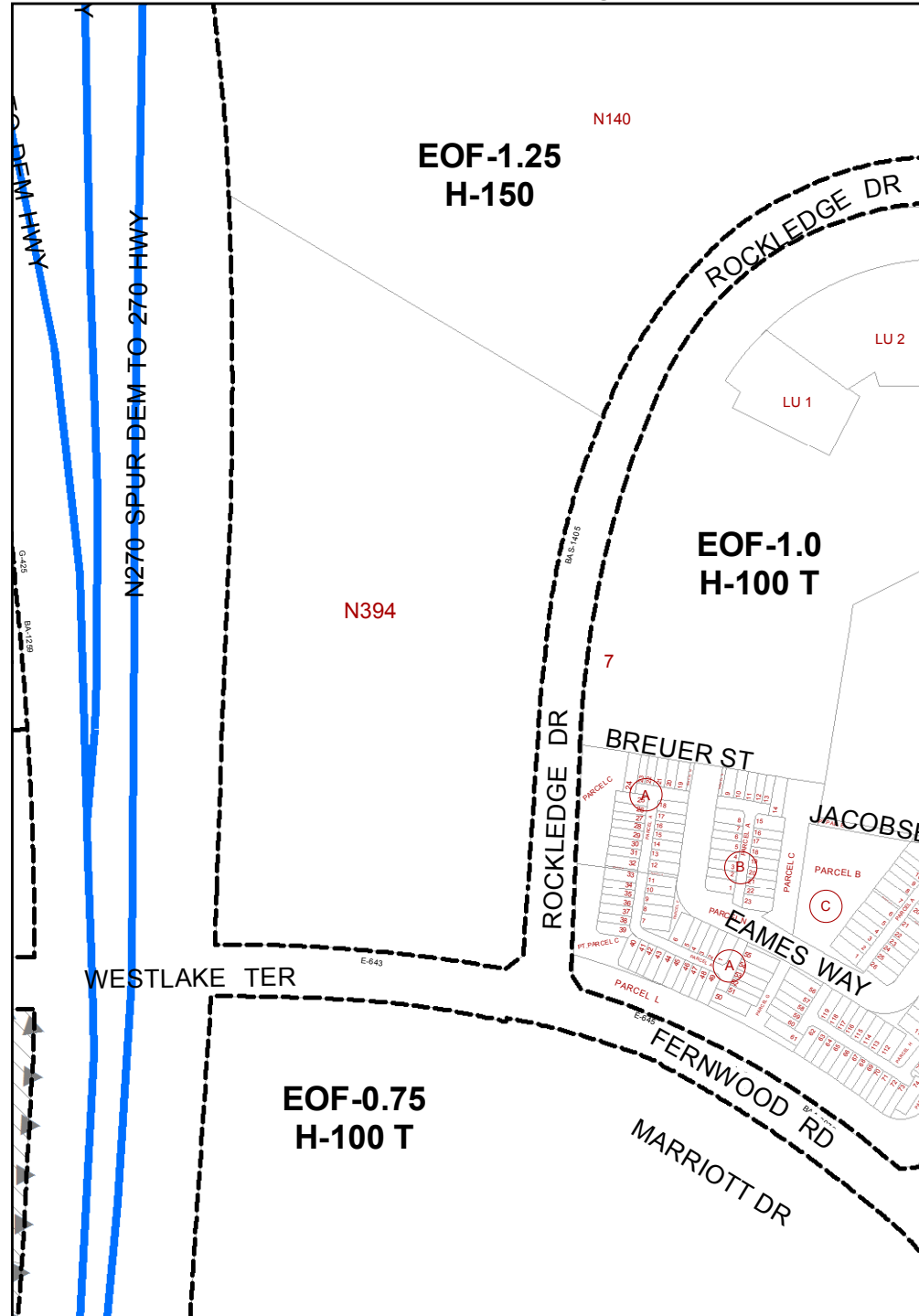

Attachment 1 - Map 5
Existing Zoning

Changes: 3, 5, 6

Proposed Zoning

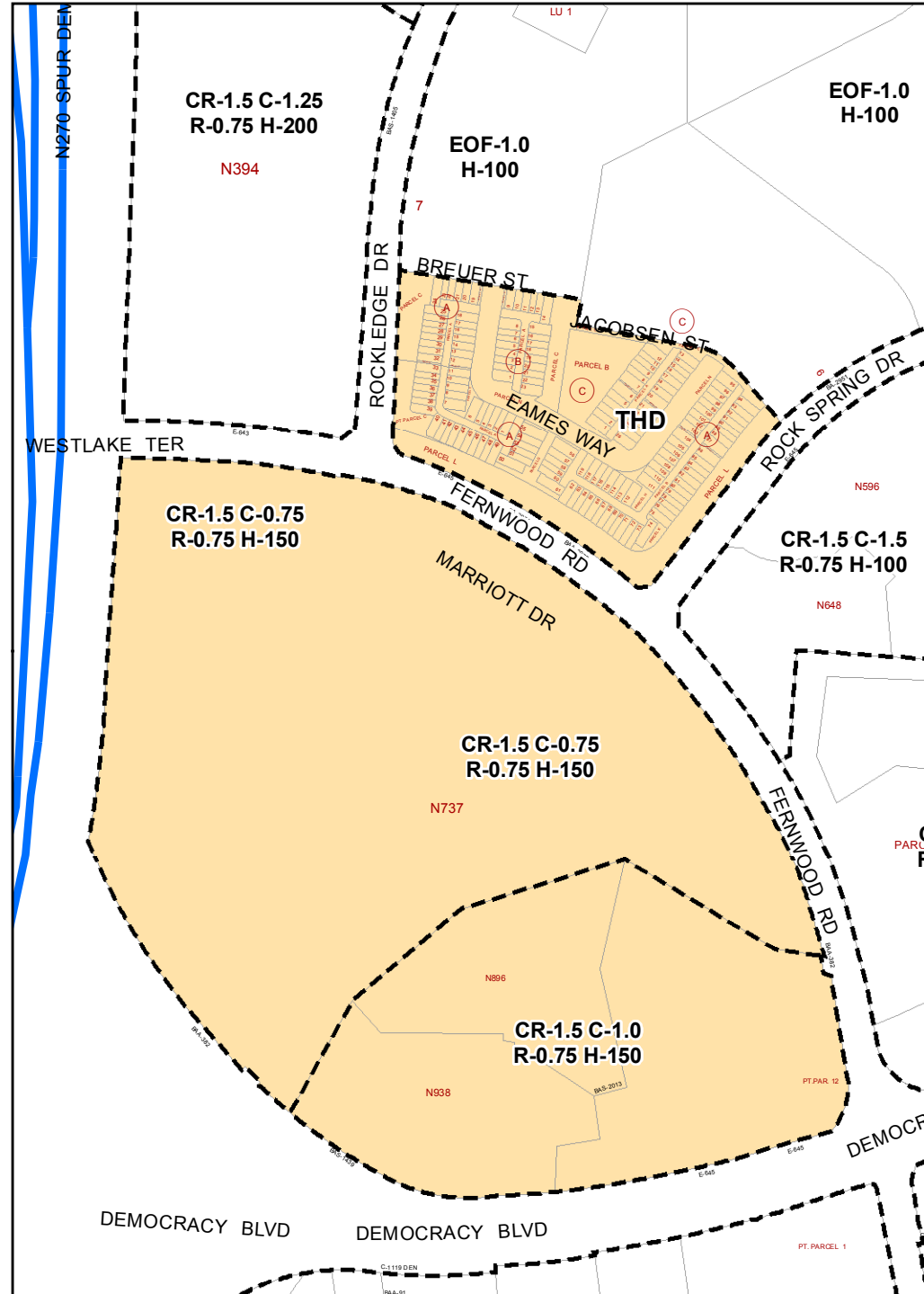
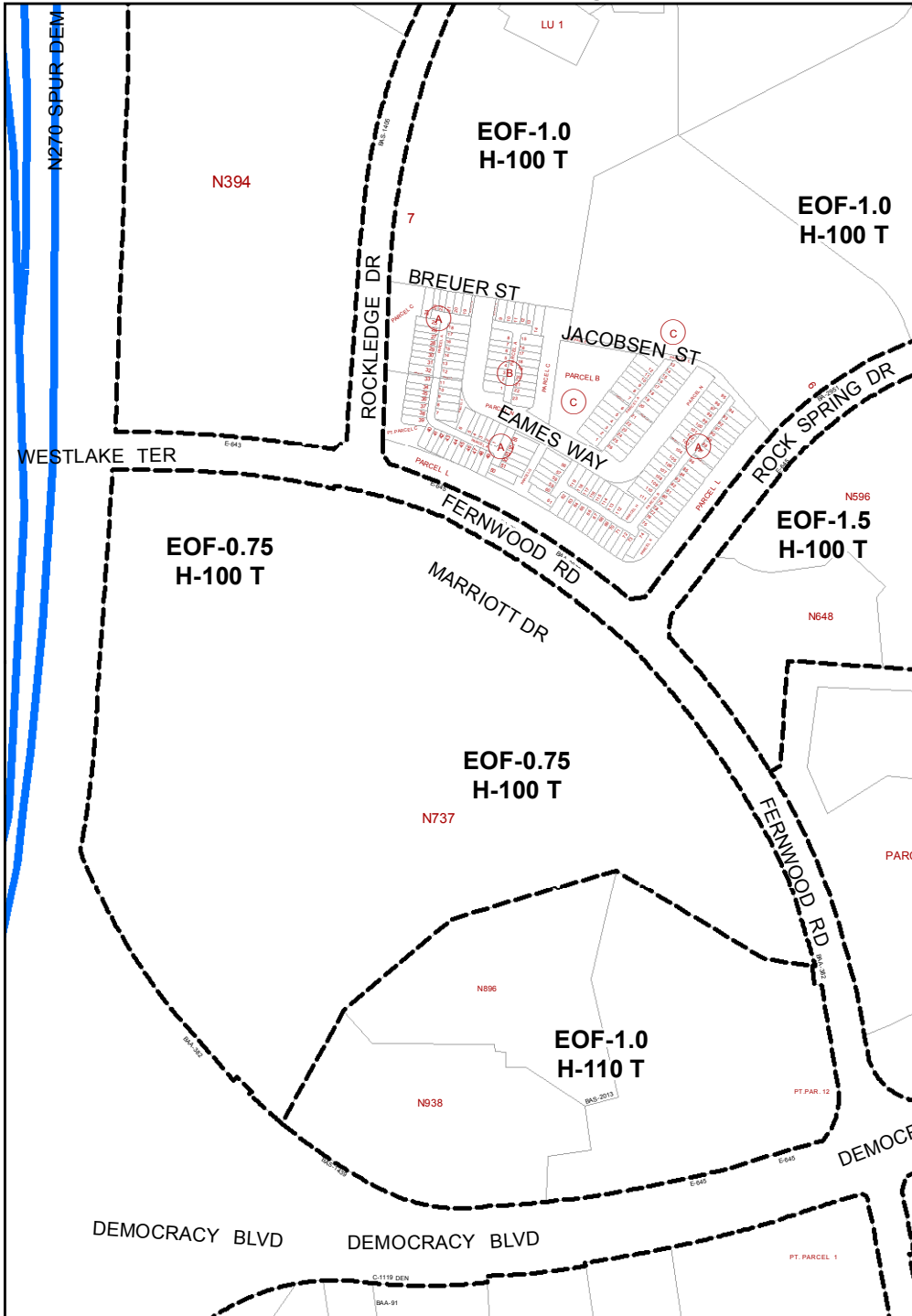

Attachment 1 - Map 6
Existing Zoning

Changes: 11, 12, 16

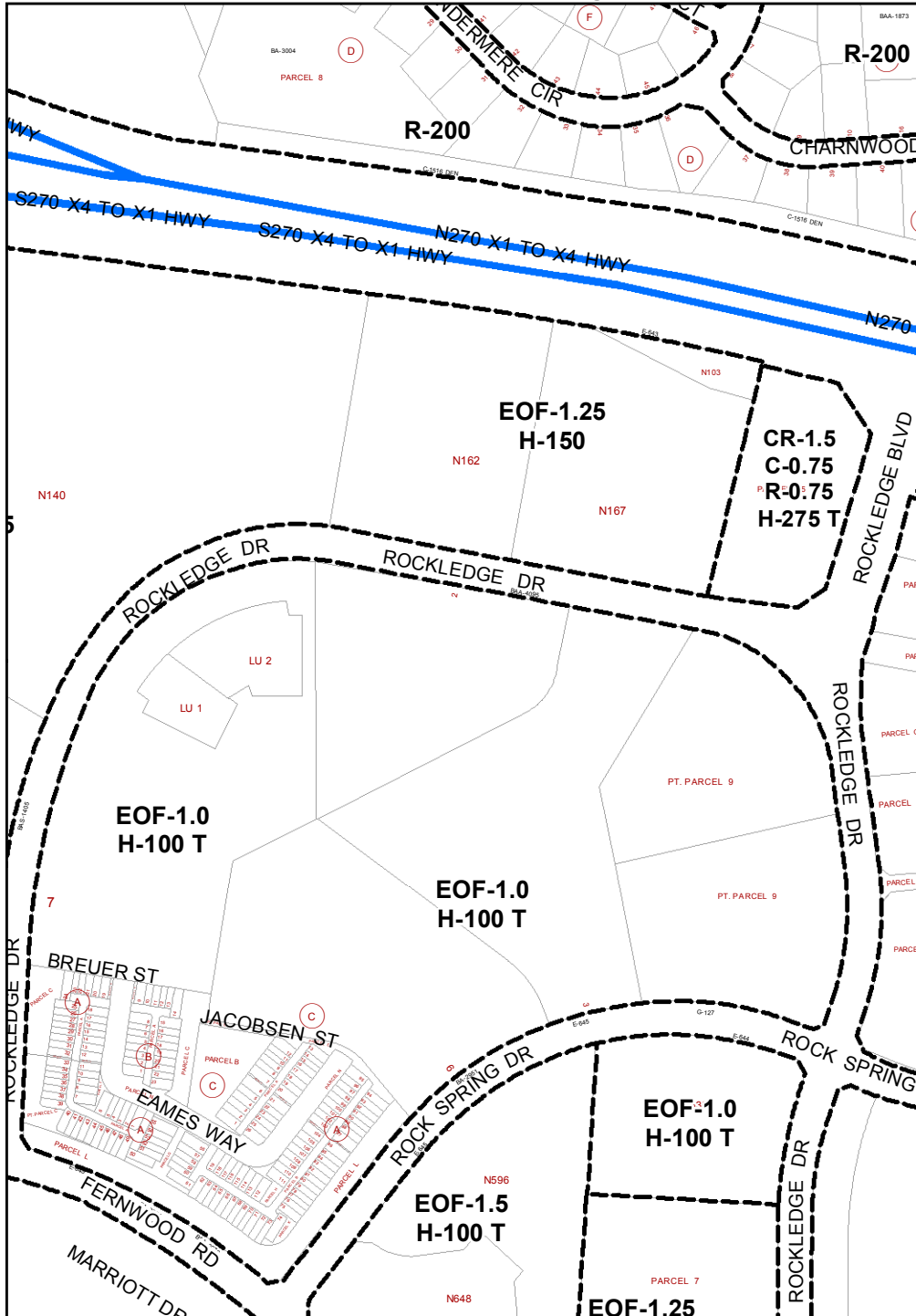

Proposed Zoning

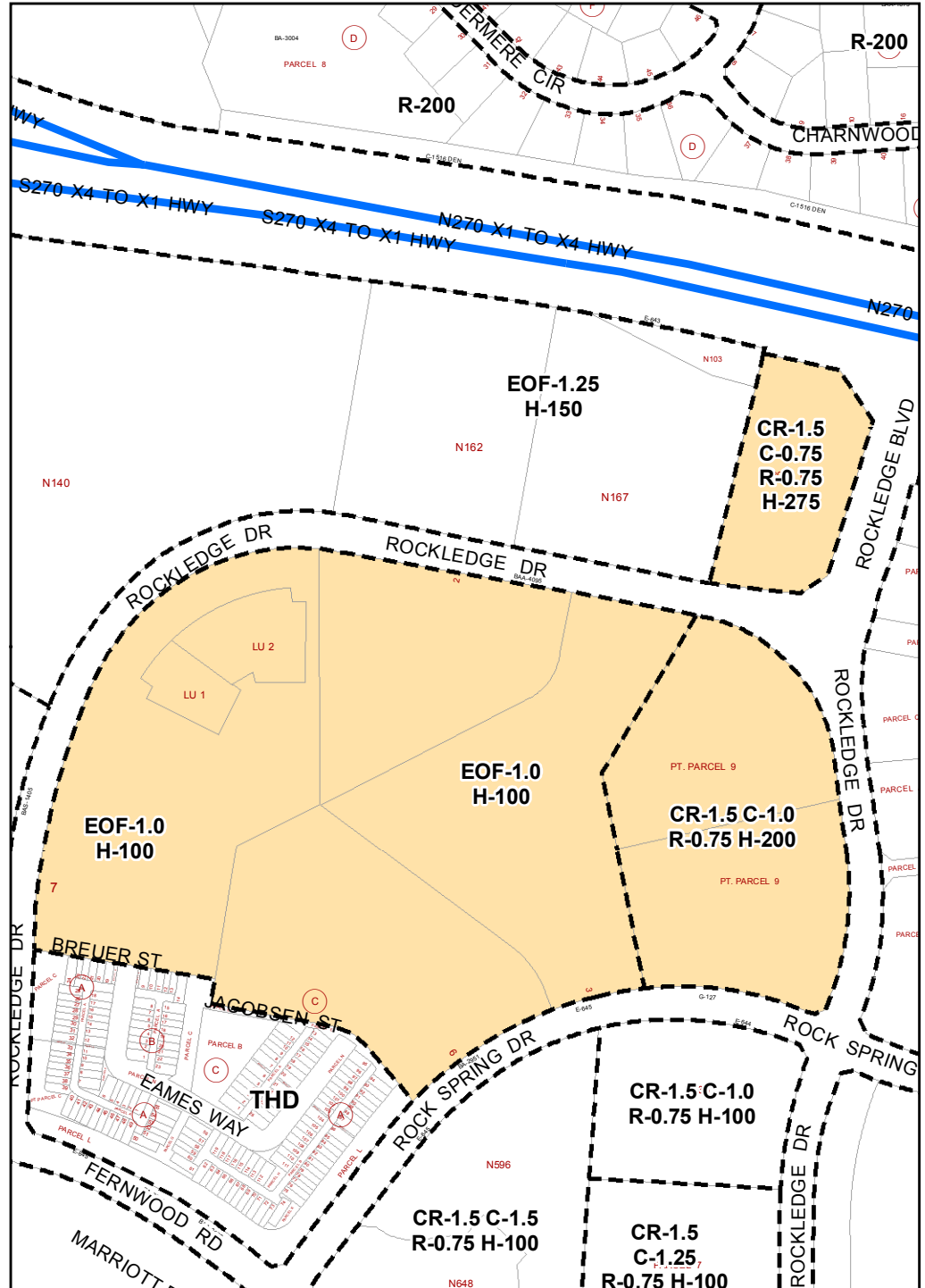

Attachment 1 - Map 7
Existing Zoning

Changes: 7, 8, 9, 10

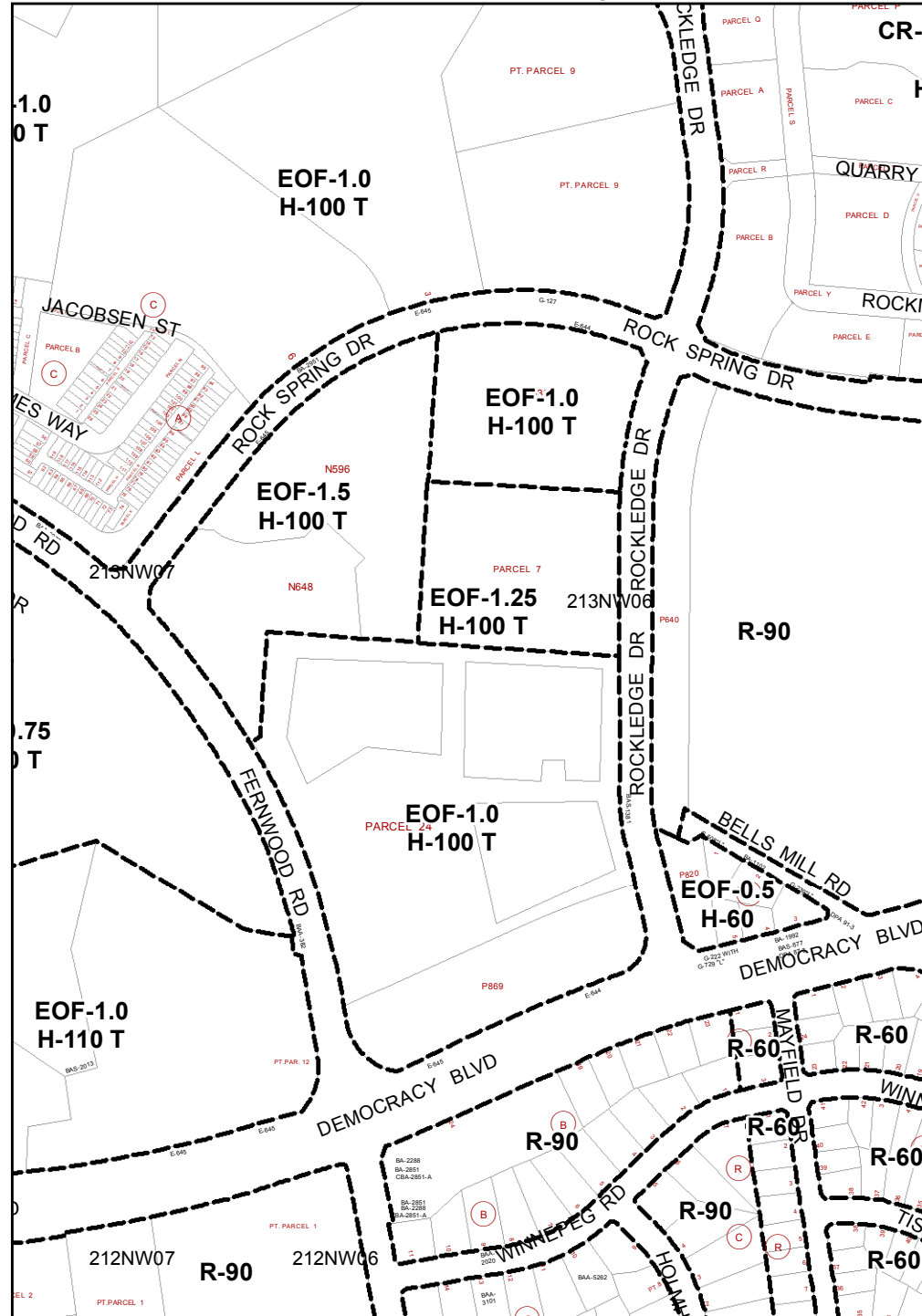

Proposed Zoning

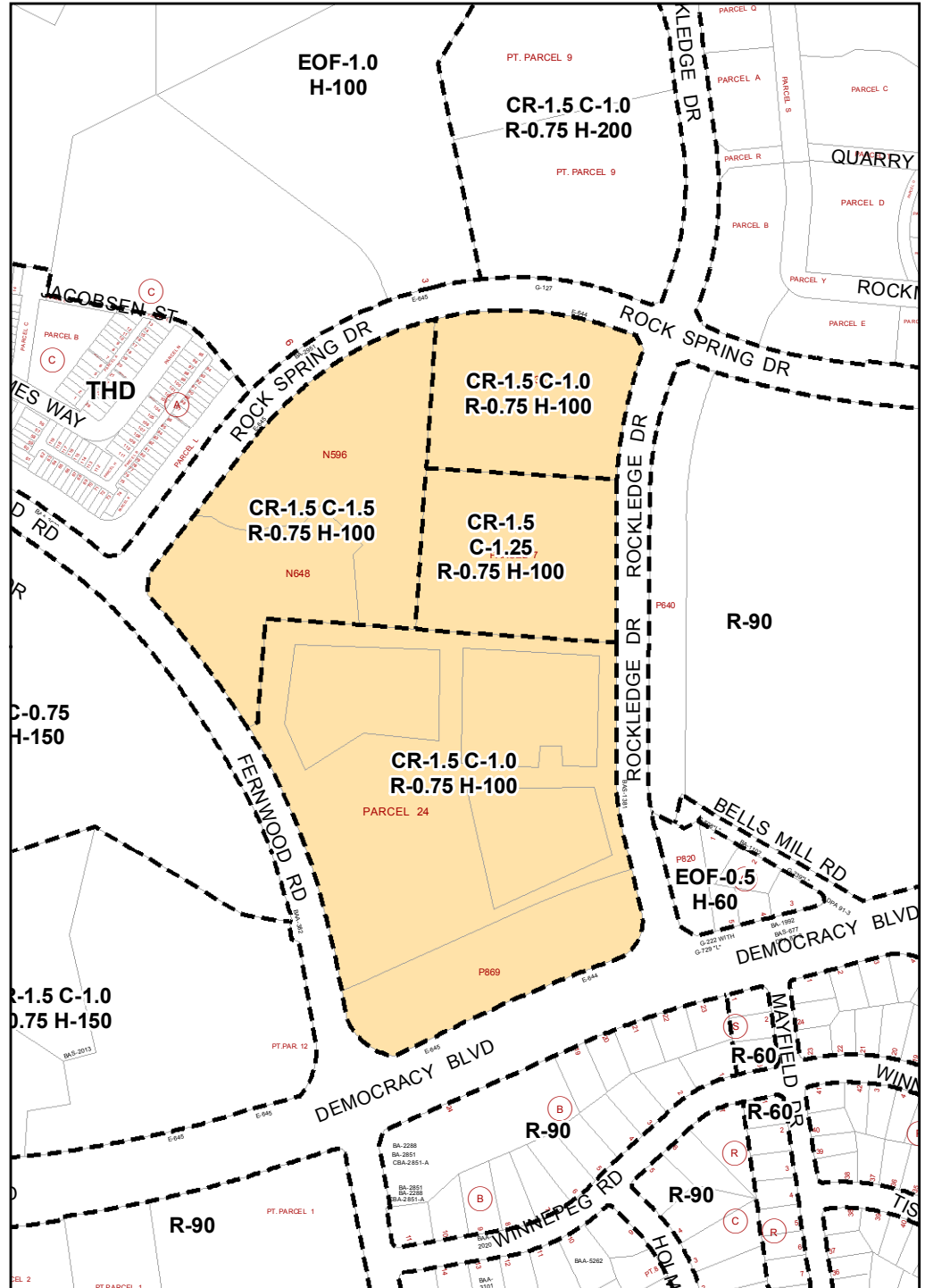

Map Grid: 213NW07, 213NW06

1 in = 400 ft

Attachment 1 - Map 8

Existing Zoning

Changes: 13

Proposed Zoning

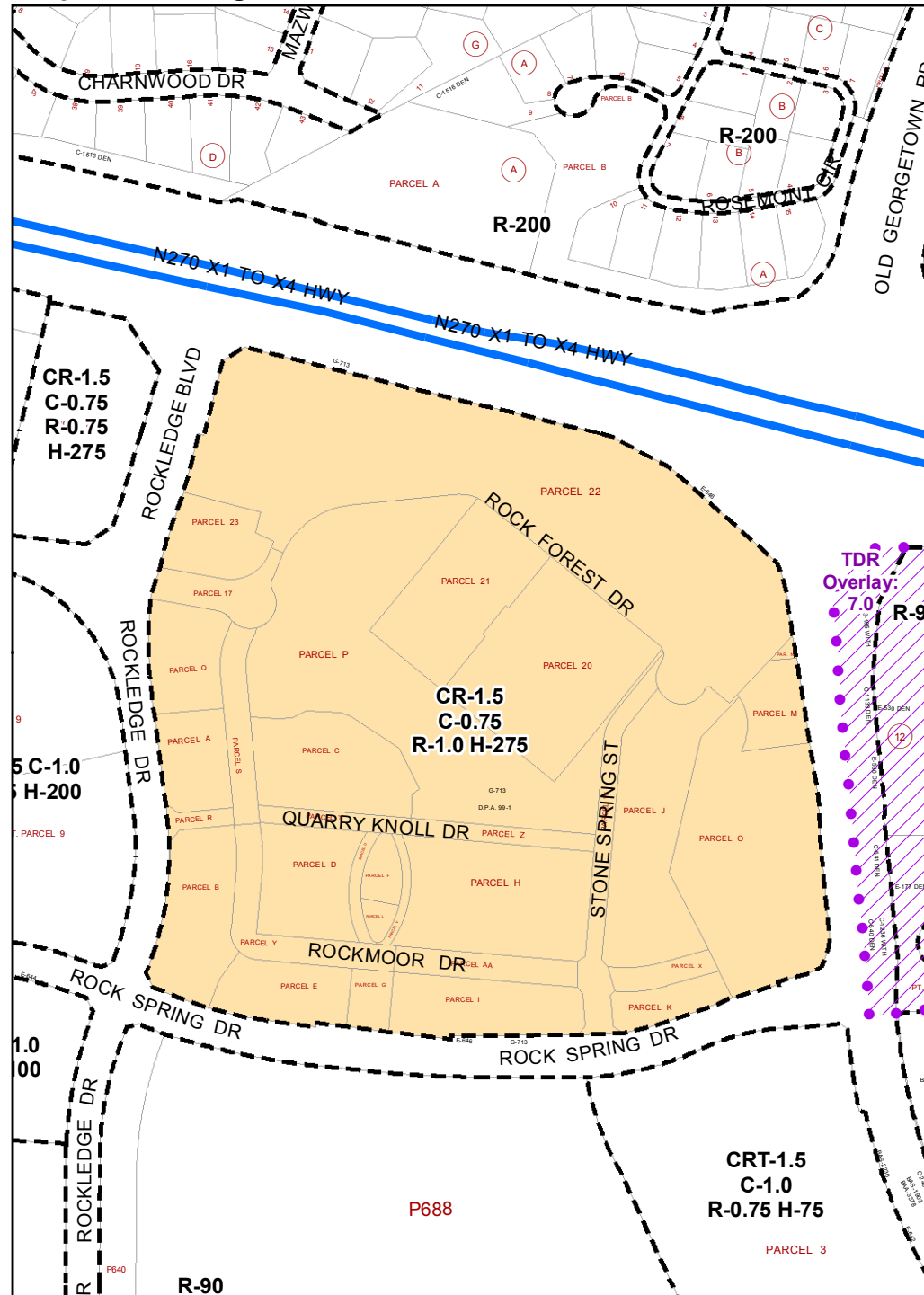
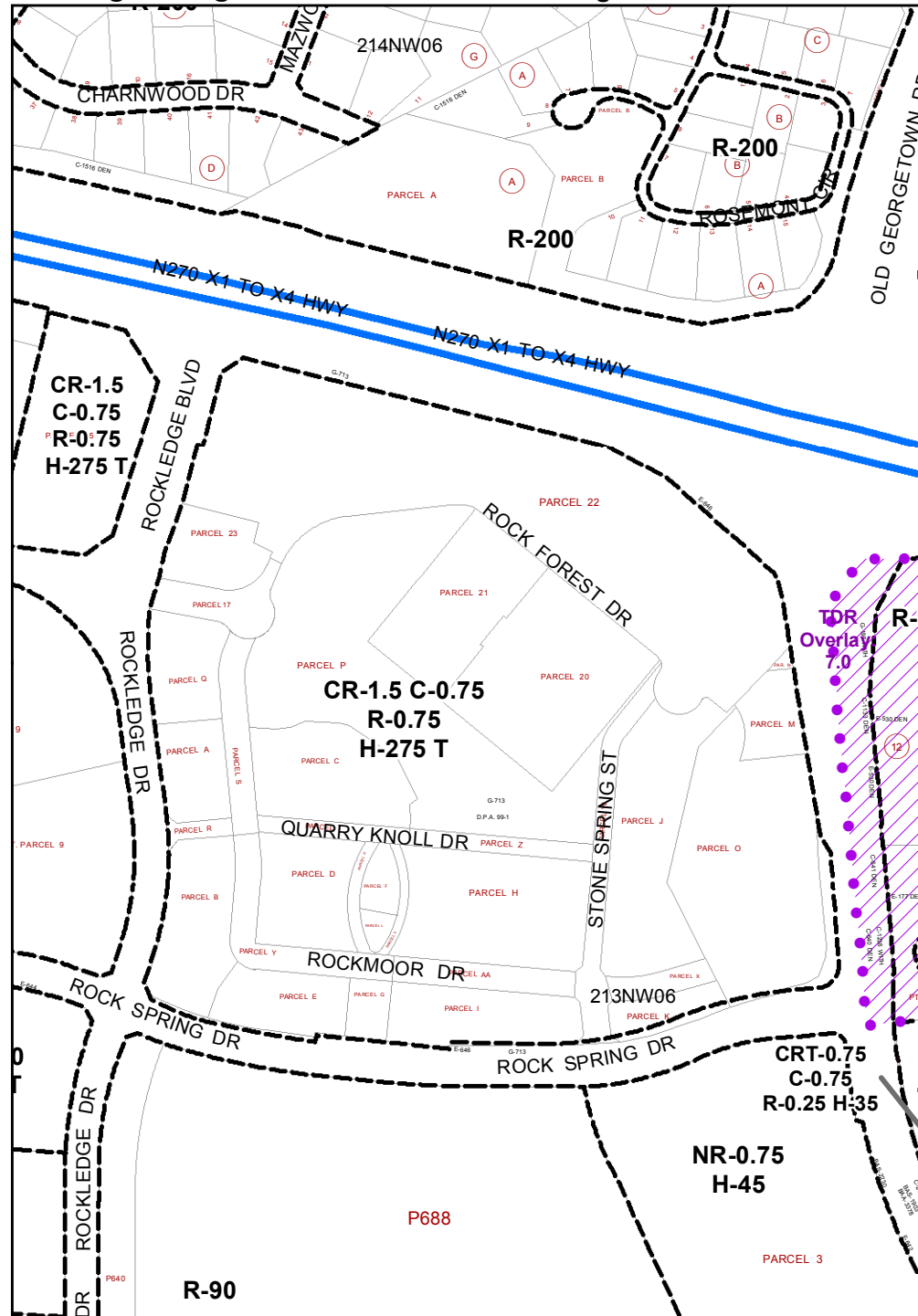

Attachment 1 - Map 9
Existing Zoning

Changes: 14, 15

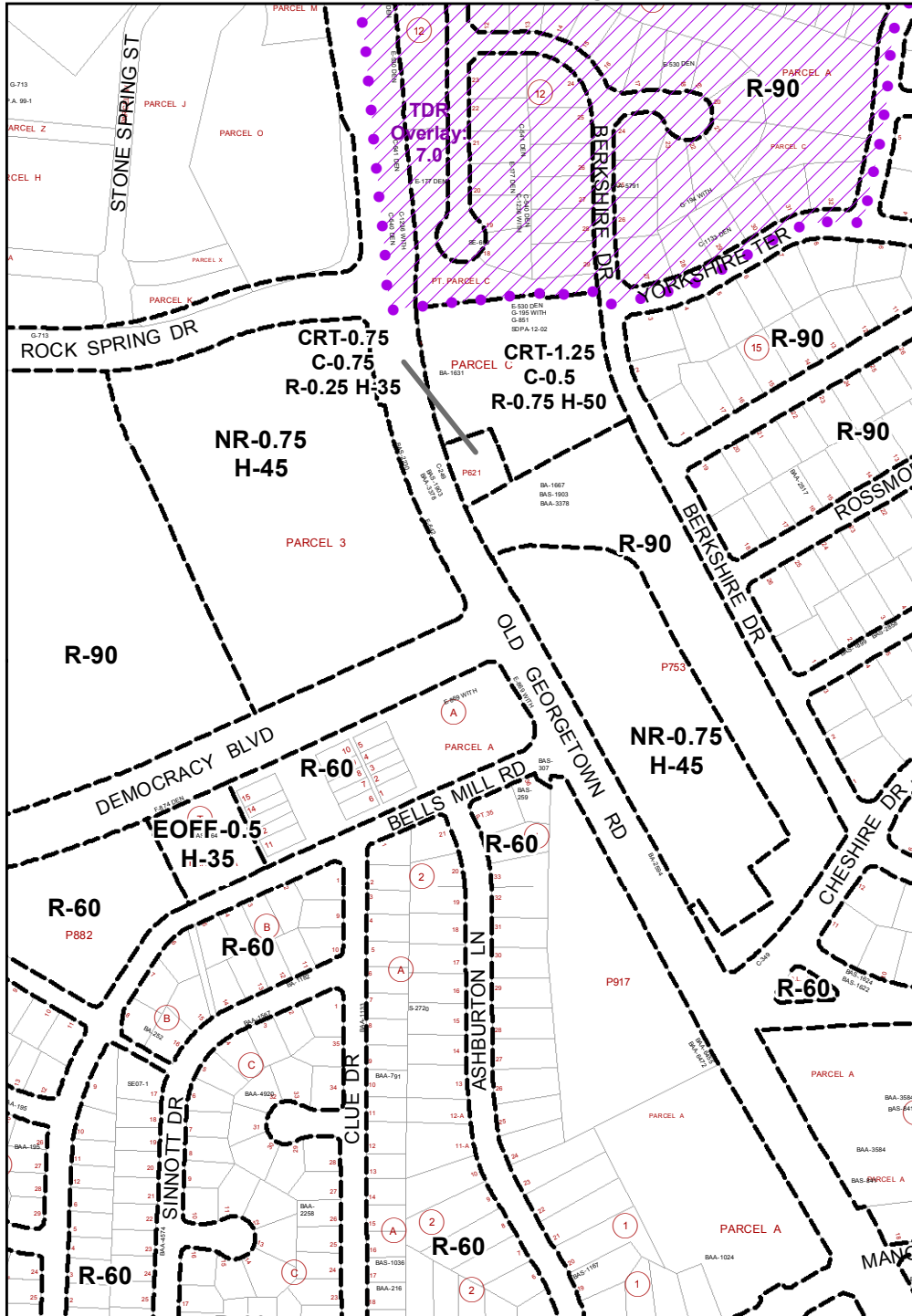

Proposed Zoning

