



HISTORIC PRESERVATION COMMISSION

Marc Elrich
County Executive

Robert K. Sutton
Chairman

Date: July 29, 2022

MEMORANDUM

TO: Mitra Pedoeem
Department of Permitting Services

FROM: Michael Kyne
Historic Preservation Section
Maryland-National Capital Park & Planning Commission

SUBJECT: Historic Area Work Permit # 998841: Accessory Structure/Shed Construction

The Montgomery County Historic Preservation Commission (HPC) has reviewed the attached application for a Historic Area Work Permit (HAWP). This application was **Approved** at the July 27, 2022 HPC meeting.

The HPC staff has reviewed and stamped the attached construction drawings.

THE BUILDING PERMIT FOR THIS PROJECT SHALL BE ISSUED CONDITIONAL UPON ADHERENCE TO THE ABOVE APPROVED HAWP CONDITIONS AND MAY REQUIRE APPROVAL BY DPS OR ANOTHER LOCAL OFFICE BEFORE WORK CAN BEGIN.

Applicant: Daniel Martin
Address: 10310 Freeman Place, Kensington

This HAWP approval is subject to the general condition that the applicant will obtain all other applicable Montgomery County or local government agency permits. After the issuance of these permits, the applicant must contact this Historic Preservation Office if any changes to the approved plan are made. Once work is complete the applicant will contact Michael Kyne at 301.563.3403 or michael.kyne@montgomeryplanning.org to schedule a follow-up site visit.





APPLICATION FOR HISTORIC AREA WORK PERMIT
HISTORIC PRESERVATION COMMISSION
301.563.3400

FOR STAFF ONLY:
HAWP# _____
DATE ASSIGNED _____

APPLICANT:

Name: _____ E-mail: _____
Address: _____ City: _____ Zip: _____
Daytime Phone: _____ Tax Account No.: _____

AGENT/CONTACT (if applicable):

Name: _____ E-mail: _____
Address: _____ City: _____ Zip: _____
Daytime Phone: _____ Contractor Registration No.: _____

LOCATION OF BUILDING/PREMISE: MIHP # of Historic Property _____

Is the Property Located within an Historic District? Yes/District Name _____
No/Individual Site Name _____

Is there an Historic Preservation/Land Trust/Environmental Easement on the Property? If YES, include a map of the easement, and documentation from the Easement Holder?

Are other Planning and/or Hearing Examiner Approvals /Review (Conditional Use, Variance, Record Plat, etc.?) If YES, include info supplementing the application? _____

Building Number: _____ Street: _____
Town/City: _____ Nearest Cross Street: _____
Lot: _____ Block: _____ Subdivision: _____ Parcel: _____

APPROVED
Montgomery County
Historic Preservation Commission
[Signature]

REVIEWED
By Michael Kyne at 10:40 am, Jul 29, 2022

TYPE OF WORK PROPOSED: See the checklist on Page 4 to verify that all supporting items for proposed work are submitted with this application. Incomplete Applications will not be accepted for review. Check all that apply:

- Checkboxes for: New Construction, Addition, Demolition, Grading/Excavation, Deck/Porch, Fence, Hardscape/Landscape, Roof, Shed/Garage/Accessory Structure, Solar, Tree removal/planting, Window/Door, Other.

I hereby certify that I have the authority to make the foregoing application, that the application is correct and accurate and that the construction will comply with plans reviewed and approved by all necessary agencies and hereby acknowledge and accept this to be a condition for the issuance of this permit.

Signature of owner or authorized agent _____ Date _____ 5

Adjacent and Confronting Properties:

Kensington, MD 20895

10314 Freeman Place

3906 Warner Street

3915 Warner Street

3913 Warner Street

3911 Warner Street

3824 Warner Street

REVIEWED
By Michael Kyne at 10:40 am, Jul 29, 2022

APPROVED
Montgomery County
Historic Preservation Commission

Description of Property: Please describe the building and surrounding environment. Include information on significant structures, landscape features, or other significant features of the property:

Description of Work Proposed: Please give an overview of the work to be undertaken:

REVIEWED

By Michael Kyne at 10:40 am, Jul 29, 2022

APPROVED

Montgomery County

Historic Preservation Commission



Work Item 1: _____	
Description of Current Condition:	Proposed Work:

Work Item 2: _____	
Description of Current Condition:	Proposed Work:

REVIEWED
By Michael Kyne at 10:40 am, Jul 29, 2022

APPROVED
Montgomery County
Historic Preservation Commission

Work Item 3: _____	
Description of Current Condition:	Proposed Work:

**HISTORIC AREA WORK PERMIT
CHECKLIST OF
APPLICATION REQUIREMENTS**

	Required Attachments						
Proposed Work	I. Written Description	2. Site Plan	3. Plans/Elevations	4. Material Specifications	5. Photographs	6. Tree Survey	7. Property Owner Addresses
New Construction	*	*	*	*	*	*	*
Additions/Alterations	*	*	*	*	*	*	*
Demolition	*	*	*		*		*
Deck/Porch	*	*	*	*	*	*	*
Fence/Wall	*	*	*	*	*	*	*
Driveway/Parking Area	*	*		*	*	*	*
Grading/Excavation/Landscaping	*	*		*	*	*	*
Tree Removal	*	*		*	*	*	*
Siding/ Roof Changes	*	*	*	*	*		*
Window/Door Changes	*	*	*	*	*		*
Masonry Repair/Repoint	*	*	*	*	*		*
Signs	*	*	*	*	*		*

REVIEWED
By Michael Kyne at 10:40 am, Jul 29, 2022

APPROVED
Montgomery County
Historic Preservation Commission



Painted Classic Dutch Barn

10x14

SYMBOL LEGEND

- C1: 24x 36 Window with Trim
- C2: 18 x 36 Window with Trim
- C3: Standard Door - 5' Double

REVIEWED
By Michael Kyne at 10:40 am, Jul 29, 2022

APPROVED
Montgomery County
Historic Preservation Commission
[Signature]

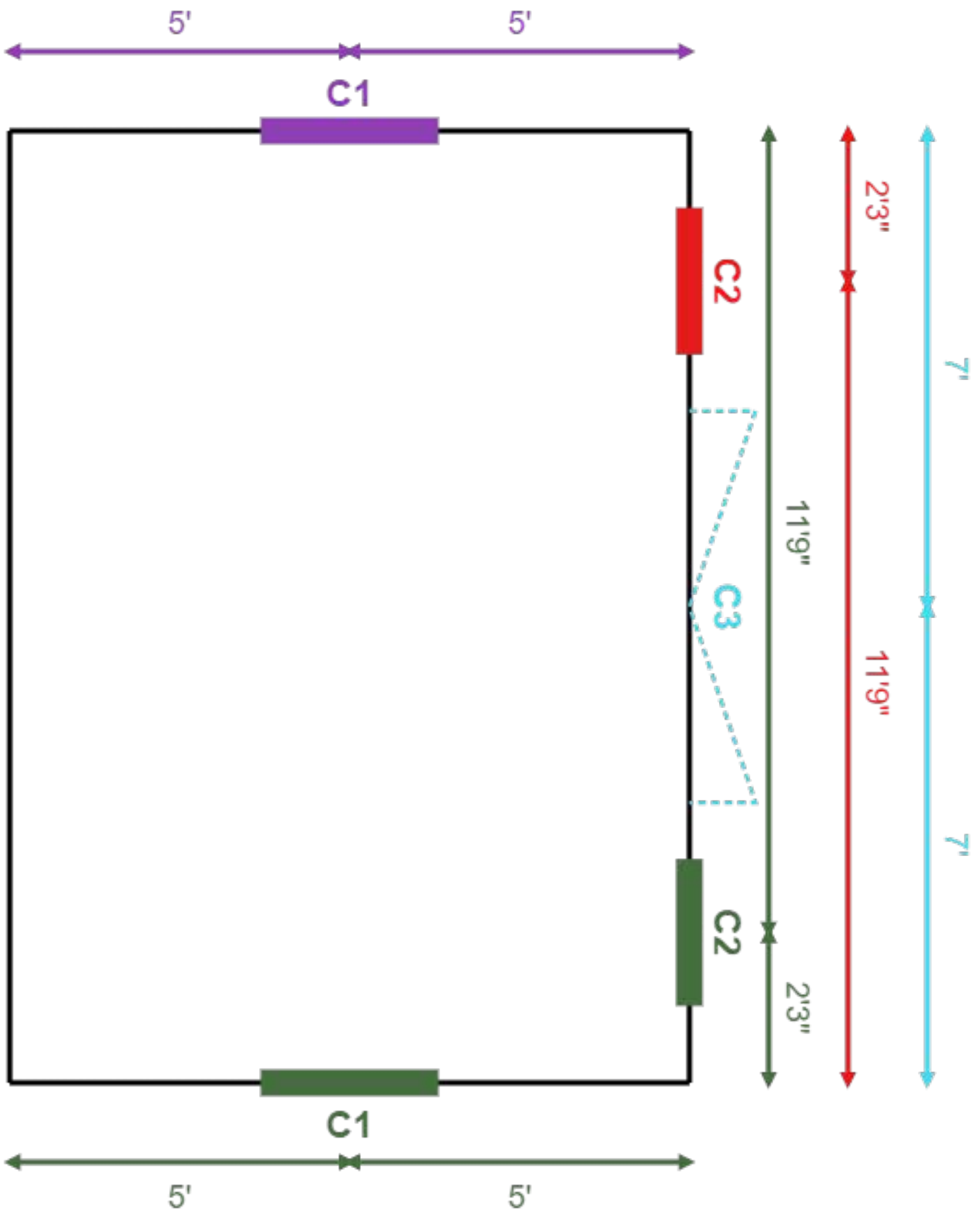

Your request for a quote has been received!

1 message

Sunrise Structures <no-reply@creativeoutdoorsheds.com>
 Reply-To: info.sunrisestructures@gmail.com
 To: fleischkase@gmail.com

Sun, Jun 26, 2022 at 10:35 PM

REVIEWED

By Michael Kyne at 10:40 am, Jul 29, 2022

APPROVED
 Montgomery County
 Historic Preservation Commission





Thank you for your request

Hi Daniel Martin,
 Just to let you know — we've received your Request a Quote #4732, and it is now being processed:

[Order #265] (June 26, 2022)

Product	Quantity
Painted Classic Dutch Barn Shareable Link: Model URL *Click the model URL to check its customized specs 2D Floor Plan: 2D Floor Plan Structure details Layout: Default Size: 10x14 Siding & Trim: Duratemp, Belmont Blue Siding, White Trim Roof: Shingle (Architecture), Slate Exteriors Front: <ul style="list-style-type: none"> • One Vent Louver Archtop 12x16 • One 24x 36 Window with Trim (Top: 6'5", Bottom: 4'9", Left: 5', Right: 5') Back: <ul style="list-style-type: none"> • One Vent Louver Archtop 12x16 • One 24x 36 Window with Trim (Top: 6'5", Bottom: 4'9", Left: 5', Right: 5') Right: <ul style="list-style-type: none"> • One 18 x 36 Window with Trim (Top: 2'3", Bottom: 4'9", Left: 2'3", Right: 11'9") • One 18 x 36 Window with Trim (Top: 2'3", Bottom: 4'9", Left: 11'9", Right: 2'3") 	1
Note: Mike – This is a slight update to my original design after talking with Matt. Matt also believes the shed can be brought in whole...with a little prep work.	11

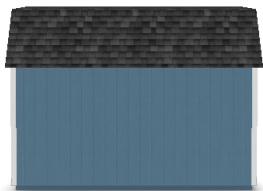
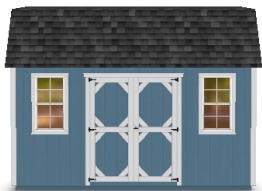
Product	Quantity
<ul style="list-style-type: none"> One Standard Door - 5' Double (Top: 3'11", Bottom: 3'1", Left: 7', Right: 7') <p>Images</p> <div style="display: flex; justify-content: space-around; align-items: center;"> <div style="text-align: center;">  <p>Perspective</p> </div> <div style="text-align: center;">  <p>Front</p> </div> <div style="text-align: center;">  <p>Back</p> </div> </div> <div style="display: flex; justify-content: space-around; align-items: center; margin-top: 20px;"> <div style="text-align: center;">  <p>Left</p> </div> <div style="text-align: center;">  <p>Right</p> </div> </div>	

Note:

Mike – This is a slight update to my original design after talking with Matt. Matt also believes the shed can be brought in whole...with a little prep work.

Contact information

Daniel Martin
 10310 Freeman Place
 Kensington, MD 20895
 410-241-4198
 fleischkase@gmail.com

Shipping address

Daniel Martin
 10310 Freeman Place
 Kensington, MD 20895

REVIEWED

By Michael Kyne at 10:40 am, Jul 29, 2022

Creative Outdoor Sheds — Powered

APPROVED
 Montgomery County
 Historic Preservation Commission



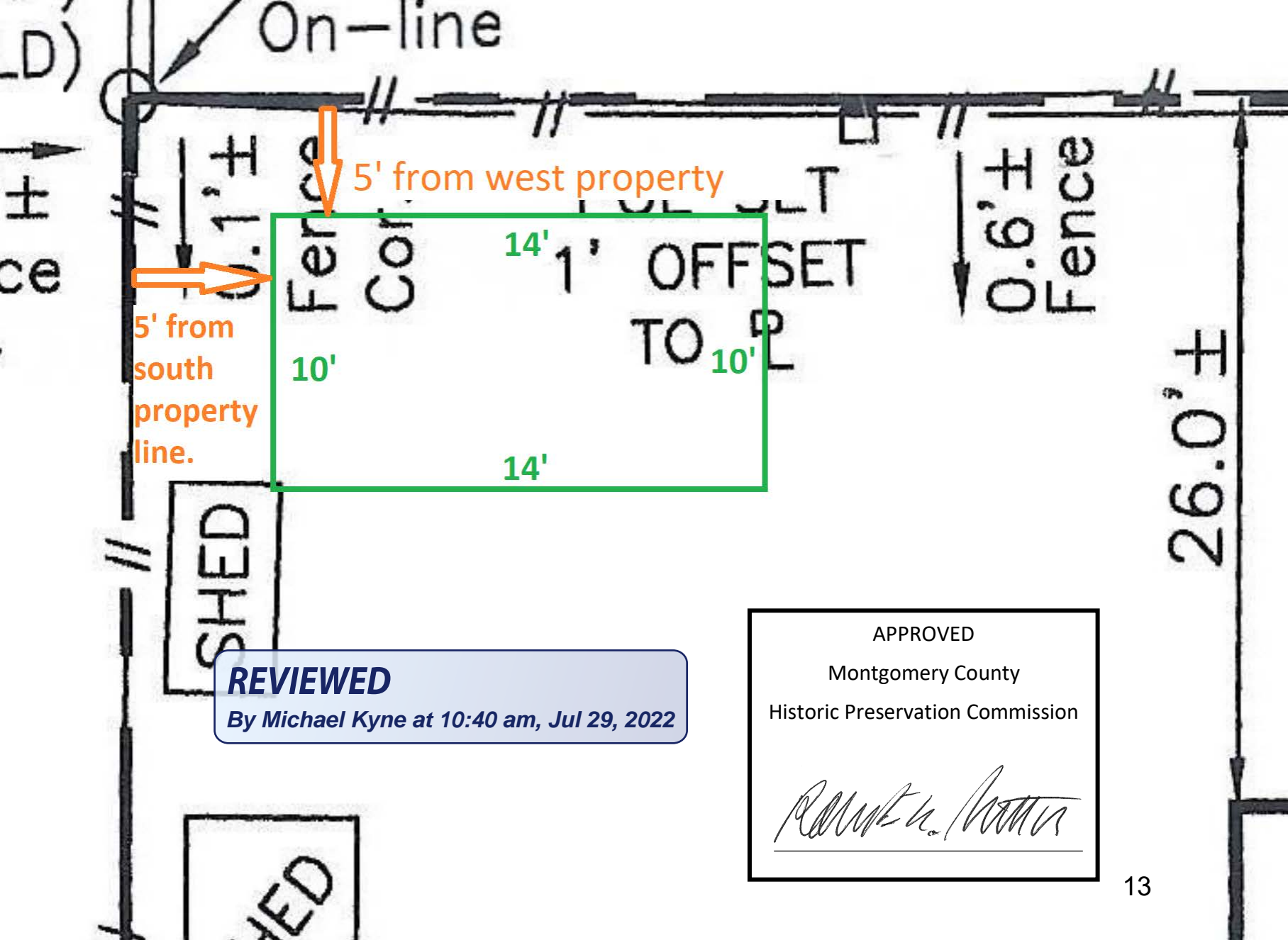

REVIEWED

By Michael Kyne at 10:40 am, Jul 29, 2022

APPROVED

Montgomery County

Historic Preservation Commission

REBAR & CAP
SET 10833 ON CAP
FOUND (HELD)

Fence
Corner
On-line

Fence
Cor.
0.7'±

0.5'±
Fence

OPEN PIPE
FOUND (HELD)

0.2'±
Fence
Cor.

Fence
Cor.
5.5'±

1.6'±
Fence
Cor.

S 77°02'20" E 106.24'

4.0'±
Fence
Cor.

WARNER STREET
(50' R/W PER PLAT)

0.3'±
Fence
Cor.

Fence
Co.

POL SET
1' OFFSET
TO

0.6'±
Fence

26.0'±

BRICK PATIO

POL SET
1' OFFSET
TO R

Fence
Cor.
0.2'±

**Location of
new shed
on property.**

**Failing
wood
shed.**

**Failing
storage
shed.**

SHED

SHED

A/W

FRAME
PORCH

33.6'±

BRICK WALK

2 STORY
FRAME
#10310

30.5'

40.4'

40.5'

POL

Fence
Cor.
0.5'±

2.1'±
Fence
Cor.

40.8'±

30.4'

WOOD PORCH

Fence
Corner
On-line

LOT 3

N 77°02'20" W 134.02'



REVIEWED
By Michael Kyne at 10:40 am, Jul 29, 2022

LOT 11

APPROVED
Montgomery County
Historic Preservation Commission
Robert H. ...

REBAR & CAP SET

2.0'±
Fence
Cor.
0.2'±

Fence
Cor.
0.4'±

Fence
0.6'±

S 32°35'

REBAR &
CAP SET

REBAR &
CAP SET

S 11°41'20" W 80.03'

Town of Kensington

9710 Mitchell Street

Kensington, MD 20895

301-949-2424 (Office) 301-949-4925 (Fax)

Town@tok.md.gov

REVIEWED

By Michael Kyne at 10:40 am, Jul 29, 2022

(Fax)



Attention Department

ices (DPS)

TOWN OF KENSINGTON APPLICATION

Please be advised that the following applicant has applied for a Shed Permit with the Town of Kensington, and they must send all approved County Permits to the Town to complete the Permitting process.

APPLICATION #	<u>20220054</u>	HAS BEEN RELEASED
THE OWNER	<u>MARTIN JR DANIEL EARL JOY MELISSA ANN</u>	AT
SITE ADDRESS	<u>10310 FREEMAN PL</u>	
HAVING PAID	<u>\$50.00</u>	
PROJECT	<u>Shed 10' x 14'</u>	
DATED	<u>07/05/2022</u>	<u>Alex Marini</u>

The Staff signature only releases the permit for DPS review and does not represent an approval of the permit application by the Town. All County permits must be submitted before Town review and approval.

****This form does not represent an approved Town of Kensington Permit, and serves only as notification to Montgomery County****