



HISTORIC PRESERVATION COMMISSION

Marc Elrich
County Executive

Robert K. Sutton
Chairman

Date: October 29, 2021

MEMORANDUM

TO: Mitra Pedoeem
Department of Permitting Services

FROM: Michael Kyne
Historic Preservation Section
Maryland-National Capital Park & Planning Commission

SUBJECT: Historic Area Work Permit # 968340: Window and door replacement

The Montgomery County Historic Preservation Commission (HPC) has reviewed the attached application for a Historic Area Work Permit (HAWP). This application was **Approved** at the October 27, 2021 HPC meeting.

The HPC staff has reviewed and stamped the attached construction drawings.

THE BUILDING PERMIT FOR THIS PROJECT SHALL BE ISSUED CONDITIONAL UPON ADHERENCE TO THE ABOVE APPROVED HAWP CONDITIONS AND MAY REQUIRE APPROVAL BY DPS OR ANOTHER LOCAL OFFICE BEFORE WORK CAN BEGIN.

Applicant: Zhong Yu
Address: 3 Church Street, Brookeville

This HAWP approval is subject to the general condition that the applicant will obtain all other applicable Montgomery County or local government agency permits. After the issuance of these permits, the applicant must contact this Historic Preservation Office if any changes to the approved plan are made. Once work is complete the applicant will contact Michael Kyne at 301.563.3403 or michael.kyne@montgomeryplanning.org to schedule a follow-up site visit.





FOR STAFF ONLY:
HAWP# 968340
DATE ASSIGNED _____

APPLICATION FOR HISTORIC AREA WORK PERMIT

HISTORIC PRESERVATION COMMISSION
301.563.3400

APPLICANT:

Name: Zhong Yu
Address: 3 church st
Daytime Phone: 3013469856

E-mail: benyu1128@gmail.com
City: brookeville Zip: 20833
Tax Account No.: _____

AGENT/CONTACT (if applicable):

Name: _____
Address: _____
Daytime Phone: _____

E-mail: _____
City: _____ Zip: _____
Contractor Registration No.: _____

LOCATION OF BUILDING/PREMISE: MIHP # of Historic Property _____

Is the Property Located within an Historic District? Yes/District Name _____

Individual Site Name none

Is there an Easement/Restriction/Land Trust/Environmental Easement on the Property? If YES, include a map of the property and describe the easement/restriction. **REVIEWED**
By Michael Kyne at 1:49 pm, Oct 29, 2021

Are other Planning and/or Hearing Examiner Approvals /Review (Conditional Use, Variance, Record Plat, etc.?) If YES, include in supplemental information.

Building Number: _____ Street: _____
Town/City: _____ Nearest Cross Street: _____
Lot: _____ Block: _____ Subdivision: _____ Parcel: _____

APPROVED
Montgomery County
Historic Preservation Commission
[Signature]

TYPE OF WORK PROPOSED: See the checklist on Page 4 to verify that all supporting items for proposed work are submitted with this application. Incomplete Applications will not be accepted for review. Check all that apply:

- | | | |
|---------------------------------------------|----------------------------------------------|----------------------------------------------------------|
| <input type="checkbox"/> New Construction | <input type="checkbox"/> Deck/Porch | <input type="checkbox"/> Shed/Garage/Accessory Structure |
| <input type="checkbox"/> Addition | <input type="checkbox"/> Fence | <input type="checkbox"/> Solar |
| <input type="checkbox"/> Demolition | <input type="checkbox"/> Hardscape/Landscape | <input type="checkbox"/> Tree removal/planting |
| <input type="checkbox"/> Grading/Excavation | <input type="checkbox"/> Roof | <input checked="" type="checkbox"/> Window/Door |
| | | <input type="checkbox"/> Other: _____ |

I hereby certify that I have the authority to make the foregoing application, that the application is correct and accurate and that the construction will comply with plans reviewed and approved by all necessary agencies and hereby acknowledge and accept this to be a condition for the issuance of this permit.

zhong hao yu

09/26/2021

Signature of owner or authorized agent

Date

Description of Property: Please describe the building and surrounding environment. Include information on significant structures, landscape features, or other significant features of the property:

building is surrounding by mostly grass in a 0.81 land.

Description of Work Proposed: Please give an overview of the work to be undertaken:

we will need to repair some un open windows. and replace the broken windows and doors.

REVIEWED

By Michael Kyne at 1:49 pm, Oct 29, 2021

APPROVED

Montgomery County

Historic Preservation Commission



Work Item 1: door

Description of Current Condition:
bad conditions
air are coming
in.

Proposed Work:
replace and insulated new doors

Work Item 2: windows

Description of Current Condition: bad conditions.
airs and bugs
are coming in.

Proposed Work:
insualted new windows and seals all
gaps

REVIEWED
By Michael Kyne at 1:49 pm, Oct 29, 2021

APPROVED
Montgomery County
Historic Preservation Commission

Work Item 3: _____

Description of Current Condition:

Proposed Work:

**HISTORIC AREA WORK PERMIT
CHECKLIST OF
APPLICATION REQUIREMENTS**

	Required Attachments						
Proposed Work	I. Written Description	2. Site Plan	3. Plans/Elevations	4. Material Specifications	5. Photographs	6. Tree Survey	7. Property Owner Addresses
New Construction	*	*	*	*	*	*	*
Additions/Alterations	*	*	*	*	*	*	*
Demolition	*	*	*		*		*
Deck/Porch	*	*	*	*	*	*	*
Fence/Wall	*	*	*	*	*	*	*
Driveway/Parking Area	*	*		*	*	*	*
Grading/Excavation/Landscaping	*	*		*	*	*	*
Tree Removal	*	*		*	*	*	*
Window/Door Changes	*	*	*	*			
Masonry Repair/Repoint	*	*	*	*			
Signs	*	*	*	*			

REVIEWED
By Michael Kyne at 1:49 pm, Oct 29, 2021

APPROVED

Montgomery County

Historic Preservation Commission



PROPOSED REMODELING PLAN FOR 3 CHURCH ST , BROOKEVILLE, MD 20833

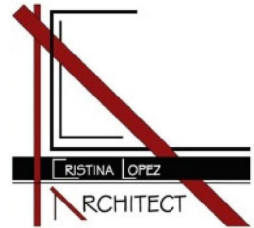
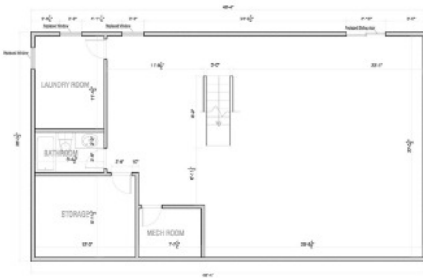

SCOPE OF WORK:

1. INSTALL FLOORS
2. REPLACE WINDOWS/DOORS
3. REPAINT INTERIOR/EXTERIOR
4. ADD RECESSED LIGHTS
5. DRYWALL OVER EXISTING PANESL
6. PATCH DRYWALL
7. UPGRADE BATHROOM

NOTES
NON ESTRUCTURAL MODIFICATIONS

WALL LEGEND:

EXISTING WALLS /NO MODIFICATIONST

REVIEWED

By Michael Kyne at 1:50 pm, Oct 29, 2021

- A-1 TITLE PAGE. COVER SHEET
- A-2 1 ST FLOOR EXISTING
- A-3 BASEMENT EXISTING
- A-4 PROPOSED PLAN 1 ST
- A-5 PROPOSED PLAN BAS

APPROVED
Montgomery County
Historic Preservation Commission

DRAWING
COVER SHEET

ADDRESS
3 CHURCH ST
BROOKEVILLE, MD 20833

DATE
9/7/2021

SCALE 1/4"= 1'0" (T)

DRAWING NUMBER	A/1
-------------------	------------

TITLE PAGE. COVER SHEET

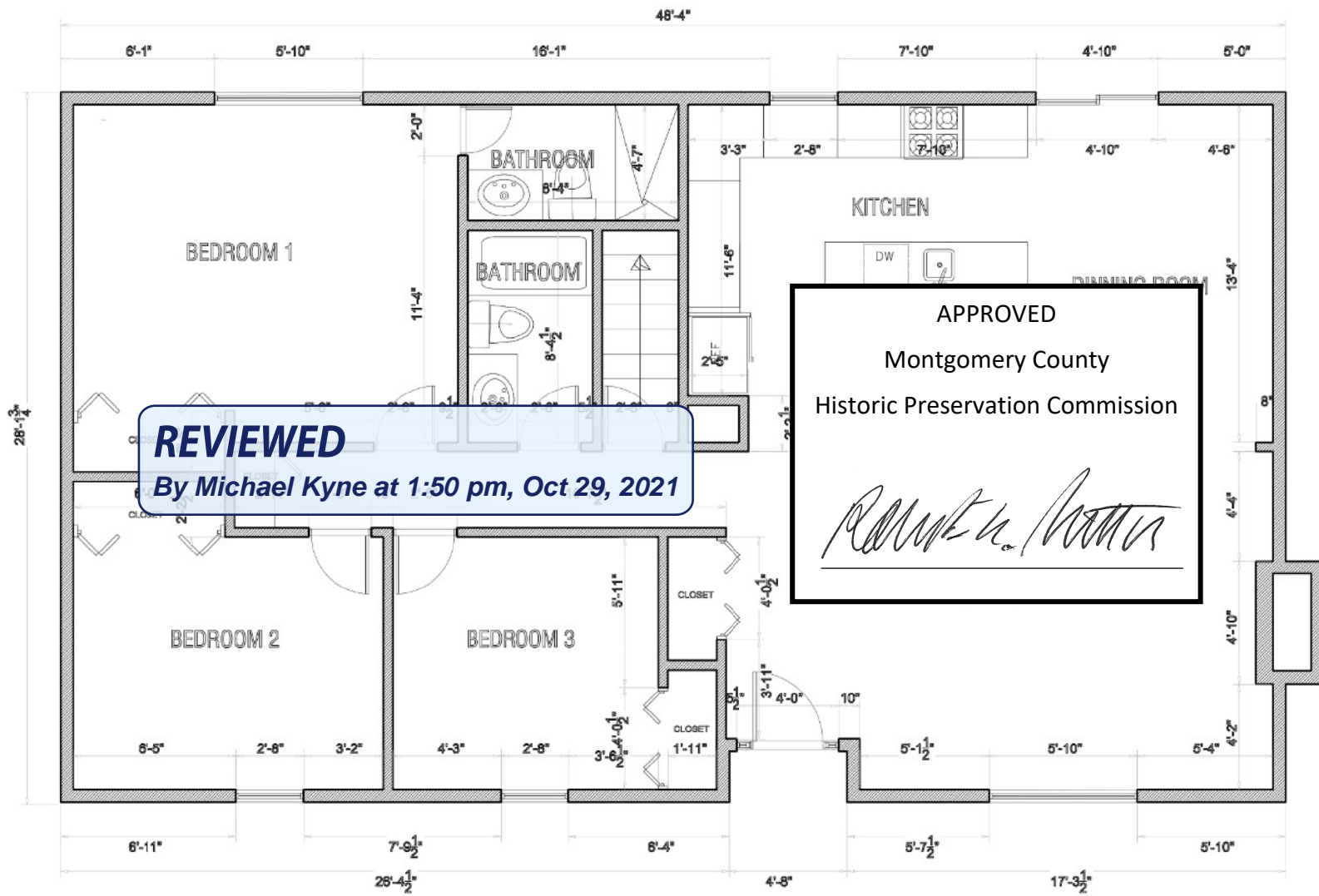

REVIEWED
 By Michael Kyne at 1:50 pm, Oct 29, 2021

APPROVED
 Montgomery County
 Historic Preservation Commission
[Signature]



- SCOPE OF WORK:**
1. INSTALL FLOORS
 2. REPLACE WINDOWS/DOORS
 3. REPAINT INTERIOR/EXTERIOR
 4. UPGRADE KITCHEN
 5. ADD RECESSED LIGHTS
 6. DRYWALL OVER EXISTING PANELS
 7. PATCH DRYWALL
 8. UPGRADE PANELS
 9. REPLACE SHIGLES
 10. UPGRADE BATHROOMS

NOTES
 NON ESTRUCTURAL MODIFICATIONS

DRAWING
 EXISTING CONDITIONS
 1ST FLOOR

ADDRESS
 3 CHURCH ST
 BROOKEVILLE, MD 20833

DATE
 9/7/2021

SCALE 1/4" = 1'0" (T)

DRAWING NUMBER A-2

EXISTING CONDITIONS 1ST FLOOR

SCALE 1/4" = 1'0" (1:50)

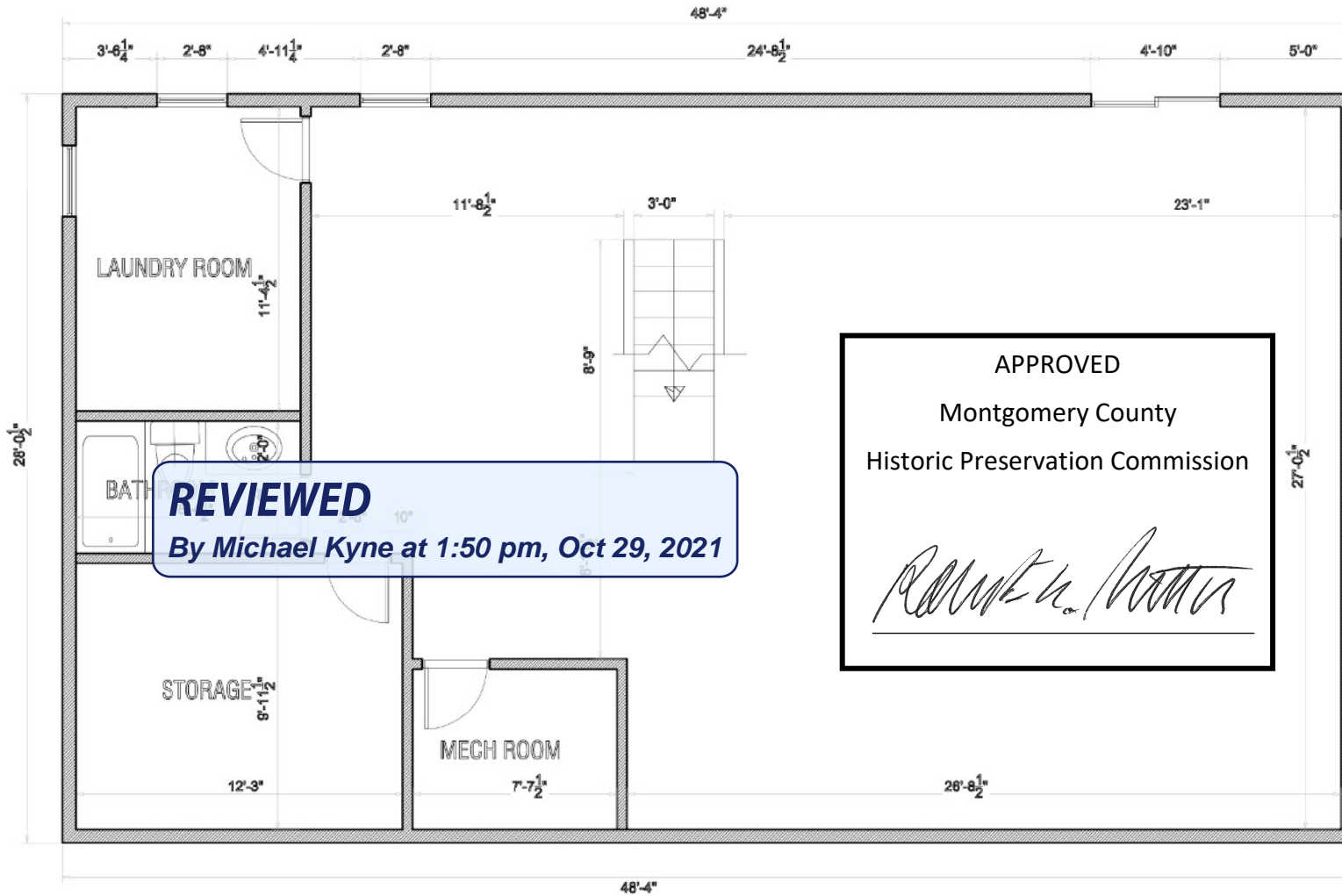

SCOPE OF WORK:

1. INSTALL FLOORS
2. REPLACE WINDOWS/DOORS
3. REPAINT INTERIOR/EXTERIOR
4. UPGRADE KITCHEN
5. ADD RECESSED LIGHTS
6. DRYWALL OVER EXISTING PANELS
7. PATCH DRYWALL
8. UPGRADE PANELS
9. REPLAC SHIGLES
10. UPGRADE BATHROOMS

NOTES

NON ESTRUCTURAL MODIFICATIONS

DRAWING
EXISTING CONDITIONS
BASEMENT

ADDRESS
3 CHURCH ST
BROOKEVILLE, MD 20833

DATE
9/7/2021

SCALE 1/4" = 1'0" (T)

DRAWING
NUMBER

A-3

EXISTING CONDITIONS BASEMENT

SCALE 1/4" = 1'0" (1:50)

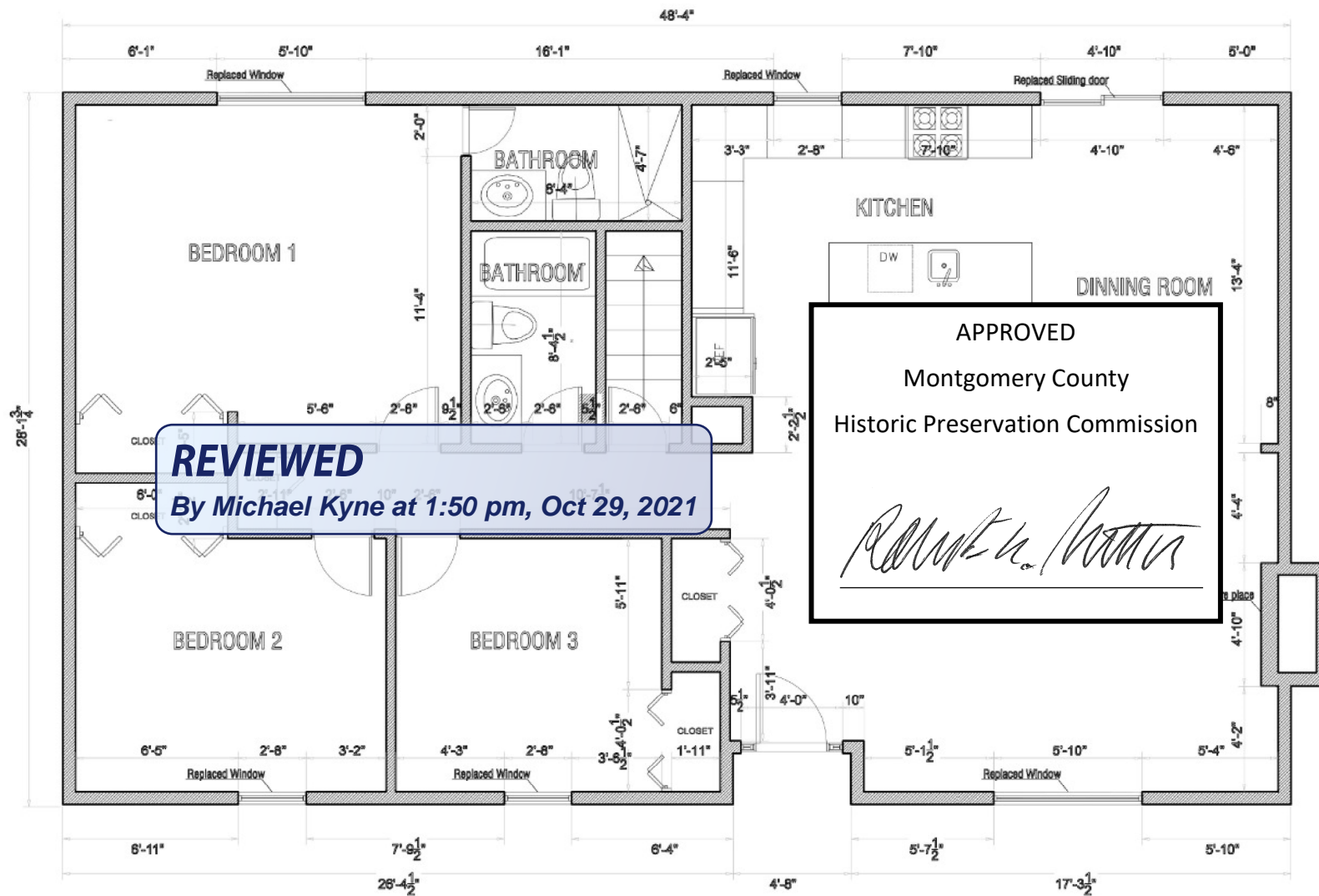

PROPOSED PLAN 1ST FLOOR

SCALE 1/4" = 1'0" (1:50)



SCOPE OF WORK:

1. INSTALL FLOORS
2. REPLACE WINDOWS/DOORS
3. REPAINT INTERIOR/EXTERIOR
4. UPGRADE KITCHEN
5. ADD RECESSED LIGHTS
6. DRYWALL OVER EXISTING PANELS
7. PATCH DRYWALL
8. UPGRADE PANELS
9. REPLACD SHIGLES
10. UPGRADE BATHROOMS

NOTES

NON ESTRUCTURAL MODIFICATIONS

DRAWING
SCOPE OF WORK

ADDRESS
3 CHURCH ST
BROOKVILLE, MD 20833

DATE
9/7/2021

SCALE 1/4" = 1'0" (T)

DRAWING
NUMBER

A-4

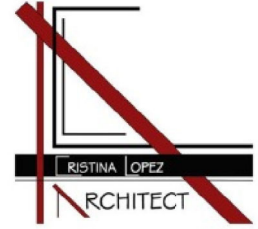
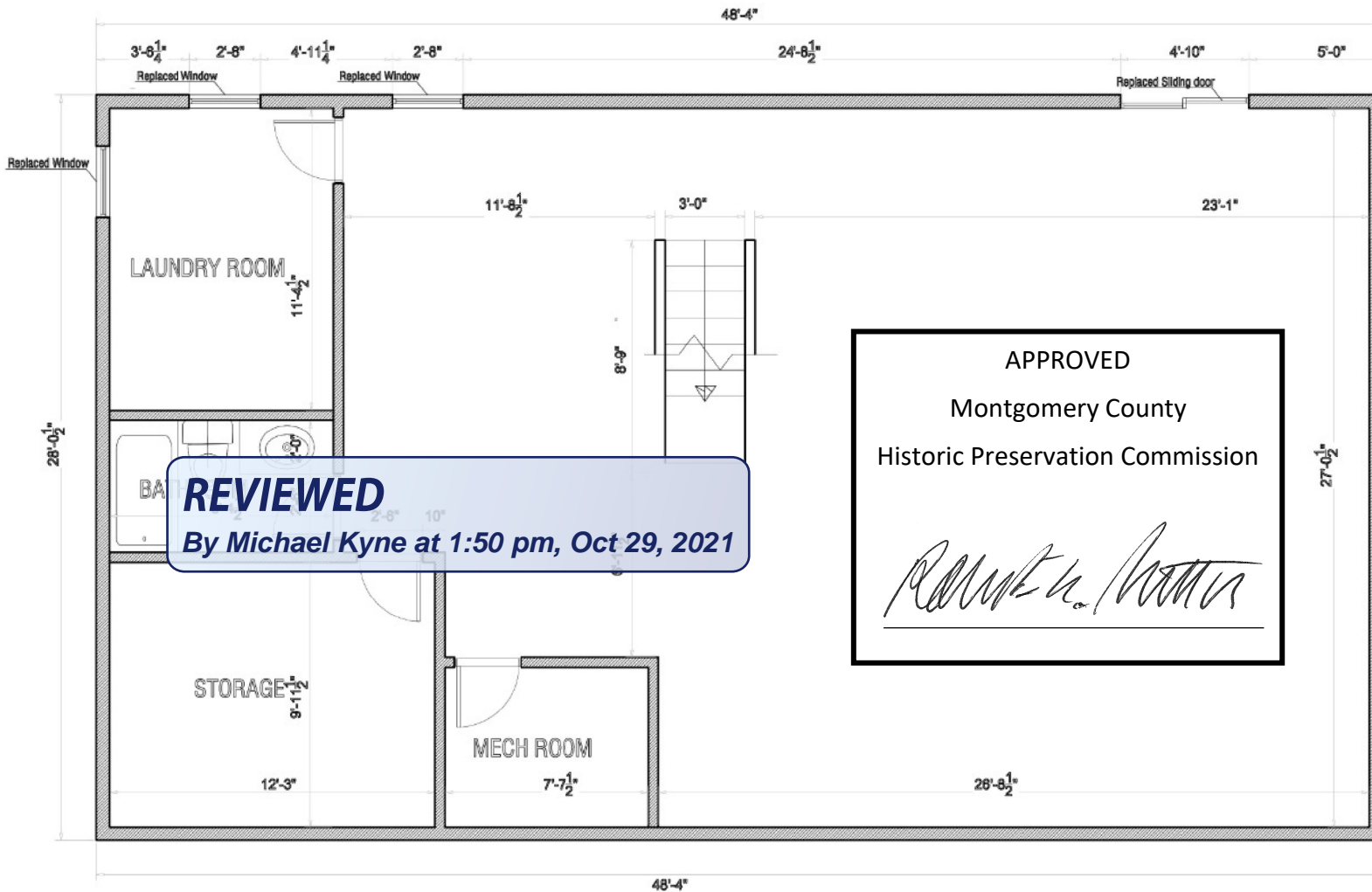

SCOPE OF WORK:

1. INSTALL FLOORS
2. REPLACE WINDOWS/DOORS
3. REPAINT INTERIOR/EXTERIOR
4. ADD RECESSED LIGHTS
5. DRYWALL OVER EXISTING PANELS
6. PATCH DRYWALL
7. UPGRADE BATHROOM

NOTES
NON STRUCTURAL MODIFICATIONS

DRAWING
SCOPE OF WORK

ADDRESS
3 CHURCH ST
BROOKVILLE, MD 20833

DATE
9/7/2021

SCALE 1/4" = 1'0" (T)

DRAWING NUMBER **A-5**

PROPOSED PLAN BASEMENT

SCALE 1/4" = 1'0" (1:50)



You're shopping
Eldersburg
CLOSED until 6 am

Delivering to
21784

Search



Cart | 0 items

Home / Doors & Windows / Windows / Double Hung Windows

Internet #203157173 Model #50 DH BUCK Store SKU #478542

Best Seller



American Craftsman
27.75 in. x 53.25 in. 50 Series Double Hung White Vinyl Window with Buck
Frame

★★★★★ (99) Questions & Answers (34)

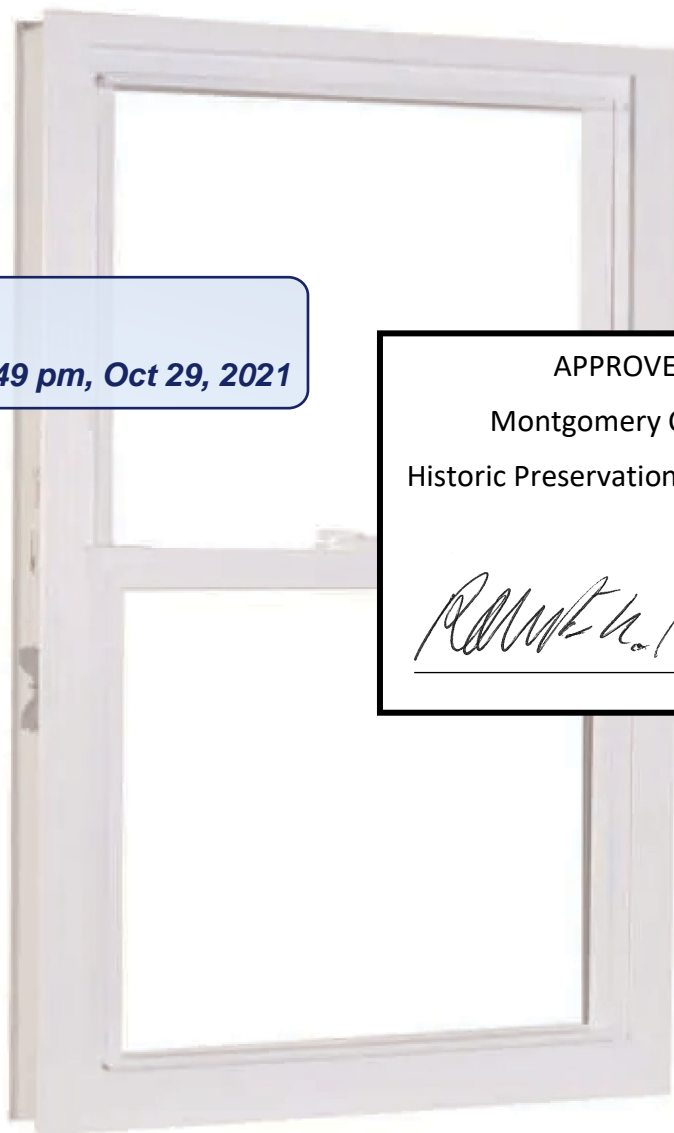

REVIEWED
By Michael Kyne at 1:49 pm, Oct 29, 2021

APPROVED
Montgomery County
Historic Preservation Commission

Feedback

Hover Image to Zoom

\$139⁰⁰



Save up to \$100 on your qualifying purchase.
Apply for a Home Depot Consumer Card

Width (in.) x Height (in.): 27.75 x 53.25

27.75 x 53.25



How to Get It

Delivering to: 21784 | Change



Buy in Store

Limited stock at
Eldersburg

Check Nearby Stores



Ship to Home

Not available for this
item



Scheduled Delivery

As soon as
Tomorrow
\$8.99

Feedback



23 available for delivery to 21784. Schedule at checkout.

How It Works

REVIEWED

By Michael Kyne at 1:49 pm, Oct 29, 2021

APPROVED

Montgomery County

Historic Preservation Commission

-

1

+

Add to Cart



Speak to an

EXPERT

about Doors & Windows



Have More Questions?

Speak to a Door and Window expert.
Available daily from 9 am - 8 pm EST.

Get Started



Product Overview

The 50 Series Double Hung Buck Vinyl Windows by American Craftsman provides aesthetic appeal, energy efficiency and low-maintenance, all in a modestly priced window. This replacement Double Hung window lets you create a space that will fit your budget and your needs.

Info & Guides

You will need Adobe® Acrobat® Reader to view PDF documents. [Download](#) a free copy from the Adobe Web site.

REVIEWED

By Michael Kyne at 1:49 pm, Oct 29, 2021

APPROVED

Montgomery County

Historic Preservation Commission

A handwritten signature in black ink, appearing to read "Robert H. [unclear]", written over a horizontal line.



You're shopping
Gaithersburg
CLOSED until 6 am

Delivering to
20877

Search



Cart | 0 items

Home / Doors & Windows / Exterior Doors / Front Doors / Fiberglass Doors / Fiberglass Doors With Glass

Internet #204487446 Model #GK3190 Store SKU #1000021886 Store SO SKU #806449

Feather River Doors
36 in. x 80 in. 6 Lite Clear Craftsman Unfinished Smooth Left-Hand Inswing
Fiberglass Prehung Front Door

★★★★★ (211) Questions & Answers (111)



Live Chat

Feedback



REVIEWED
By Michael Kyne at 1:49 pm, Oct 29, 2021

APPROVED
Montgomery County
Historic Preservation Commission

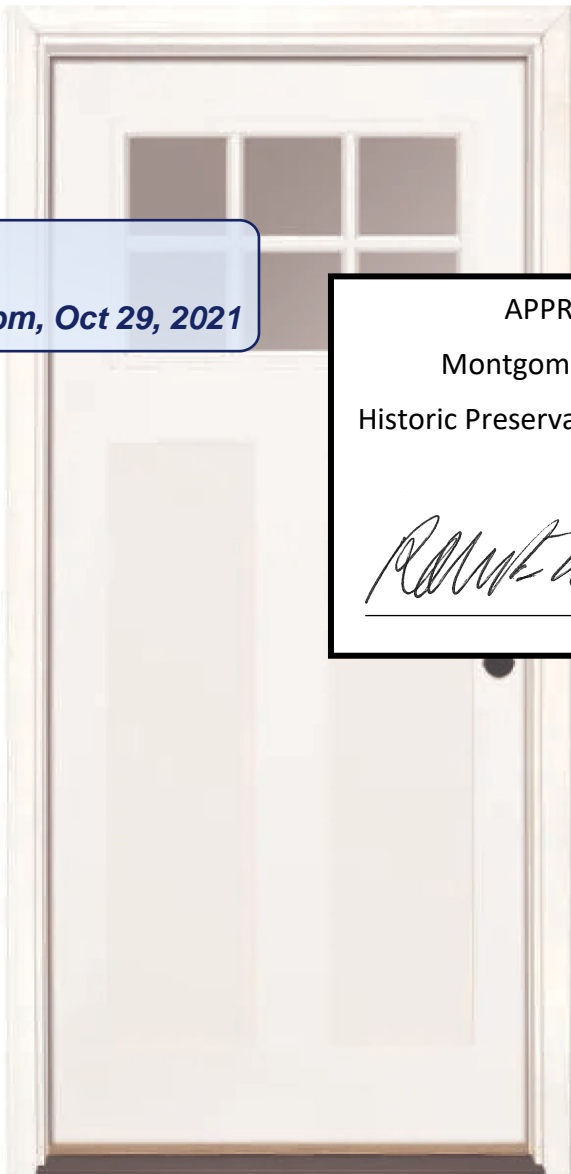
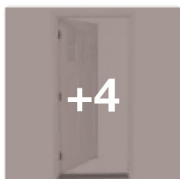
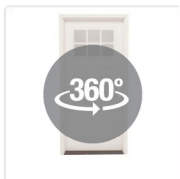
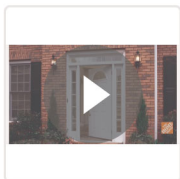
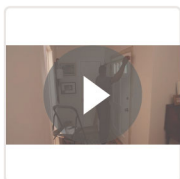

Hover Image to Zoom

\$298⁰⁰



Save up to \$100 on your qualifying purchase.
Apply for a Home Depot Consumer Card

Common Door Size (WxH) in.: 36 x 80

32 x 80

36 x 80

Door Hanging: Left-Hand/Inswing

Left-Hand/Inswing

Right-Hand/Inswing

Live Chat
Feedback

How to Get It

Delivering to: 20877 | Change

Buy **REVIEWED** **By Michael Kyne at 1:49 pm, Oct 29, 2021** Ship to Home
 Limited quantity available as of 10/29/21 at 1:49 pm. Item
 GaitHERSBOURGH
 Check Nearby Stores

Scheduled Delivery
 Tomorrow
 \$79.00

APPROVED
 Montgomery County
 Historic Preservation Commission



6 available for delivery to 20877. Schedule at checkout.
How It Works

- 1 +

Add to Cart



Speak to an
EXPERT
 about Doors & Windows



Have More Questions?

Speak to a Door and Window expert.
Available daily from 9 am - 8 pm EST.

Get Started

Or call 1-833-432-7766



REVIEWED
By Michael Kyne at 1:49 pm, Oct 29, 2021

Product Overview

Feather River Doors 6 Lite External Grille Clear Glass Craftsman is a Smooth Fiberglass Door Ready to Paint any color to match your homes decor. This classic design will provide instant curb appeal to any opening and has the true Craftsman look. The rich 2-Panel design with square profile is patterned off a true wood door design to give the door the warmth and feel of wood with the long lasting benefits of fiberglass. This door is true elegance. This door has all the long lasting benefits associated with fiberglass doors, a great look, along with a load of features and benefits usually viewed as upgrades with other doors plus energy efficient and ENERGY STAR qualified. Door specification: 36 in. x 80 in. prehung door, 4-9/16 in. primed jamb, left-hand inswing, fits rough opening of 38-1/4 in. x 82-1/8 in.



DF
Web
site.



You're shopping
Eldersburg

CLOSED until 6 am

Delivering to
21784

Search



Cart | 0 items

Home / Doors & Windows / Exterior Doors / Patio Doors

Internet #205626712 Model #60557LA Store SKU #1001226979

American Craftsman
72 in. x 80 in. 50 Series White Vinyl Left-Hand Sliding Patio Door

★★★★☆ (58) Questions & Answers (79)



Live Chat

Feedback

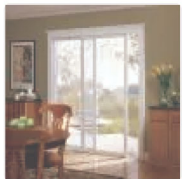

REVIEWED
By Michael Kyne at 1:49 pm, Oct 29, 2021

APPROVED
Montgomery County
Historic Preservation Commission
[Signature]

Hover Image to Zoom

\$328⁰⁰





\$55.00 /mo* suggested payments with 6 months* financing Apply Now [i](#)

How to Get It

Delivering to: **21784** | [Change](#)

 **Store Pickup**
Available
(11.0 mi)
FREE

 **Ship to Home**
Not available for this
item

 **Scheduled Delivery**
As soon as
Tomorrow
\$79.00

Not in stock at Eldersburg

2 in stock at **Ellicott City** (11.0 mi away)

[Check Nearby Stores](#)

 This item may not be available for pickup until **tomorrow**.

[Live Chat](#)
[Feedback](#)

- **REVIEWED** [Add to Cart](#)
By Michael Kyne at 1:49 pm, Oct 29, 2021

Buy now with **PayPal**

APPROVED
Montgomery County
Historic Preservation Commission



Speak to an
EXPERT
about Doors & Windows



Have More Questions?

Speak to a Door and Window expert.
Available daily from 9 am - 8 pm EST.

[Get Started](#)



Product Overview

The American Craftsman, an Andersen Company, 50 PD Assembled 72 in. x 80 in. Vinyl White Prehung Left-Hand Sliding Patio Door has a 4 in. thickness, LowE insulating glass, weather-stripping and airtight construction that qualify it for Energy Star savings. A pre-installed matching handle and self-leveling ball-bearing rollers allow it to slide effortlessly. It is fully assembled and offers a unique blend of aesthetic appeal, energy efficiency and affordable convenience.

Info & Guides

You will need Adobe® Acrobat® Reader to view PDF documents. [Download](#) a free copy from the Adobe Web site.

REVIEWED

By Michael Kyne at 1:49 pm, Oct 29, 2021

APPROVED
Montgomery County
Historic Preservation Commission



REVIEWED
By Michael Kyne at 1:50 pm, Oct 29, 2021

APPROVED
Montgomery County
Historic Preservation Commission
Robert H. Norton



REVIEWED
By Michael Kyne at 1:50 pm, Oct 29, 2021

APPROVED
Montgomery County
Historic Preservation Commission
Robert H. [Signature]



REVIEWED
By Michael Kyne at 1:50 pm, Oct 29, 2021

APPROVED
Montgomery County
Historic Preservation Commission
Robert H. Patton



REVIEWED
By Michael Kyne at 1:50 pm, Oct 29, 2021

APPROVED
Montgomery County
Historic Preservation Commission
Robert H. [Signature]





REVIEWED
By Michael Kyne at 1:50 pm, Oct 29, 2021

APPROVED
Montgomery County
Historic Preservation Commission
Robert H. Adams

REVIEWED

By Michael Kyne at 1:50 pm, Oct 29, 2021

APPROVED

Montgomery County
Historic Preservation Commission

Robert A. ...

REVIEWED

By Michael Kyne at 1:50 pm, Oct 29, 2021

APPROVED
Montgomery County
Historic Preservation Commission

Robert A. Norton



REVIEWED

By Michael Kyne at 1:50 pm, Oct 29, 2021

APPROVED
Montgomery County
Historic Preservation Commission

Robert A. Norton



REVIEWED
By Michael Kyne at 1:50 pm, Oct 29, 2021

APPROVED
Montgomery County
Historic Preservation Commission
Ronald H. Patton

REVIEWED

By Michael Kyne at 1:50 pm, Oct 29, 2021

APPROVED

Montgomery County

Historic Preservation Commission

Robert A. Norton

REVIEWED

By Michael Kyne at 1:50 pm, Oct 29, 2021

APPROVED

Montgomery County
Historic Preservation Commission

Robert A. ...

REVIEWED

By Michael Kyne at 1:50 pm, Oct 29, 2021

APPROVED

Montgomery County
Historic Preservation Commission

Ronald A. ...

REVIEWED

By Michael Kyne at 1:50 pm, Oct 29, 2021

APPROVED

Montgomery County
Historic Preservation Commission





REVIEWED

By Michael Kyne at 1:50 pm, Oct 29, 2021

APPROVED
Montgomery County
Historic Preservation Commission

Robert A. Norton



REVIEWED
By Michael Kyne at 1:50 pm, Oct 29, 2021

APPROVED
Montgomery County
Historic Preservation Commission

Robert A. Norton