



HISTORIC PRESERVATION COMMISSION

Marc Elrich
County Executive

Sandra I. Heiler
Chairman

Date: April 1, 2020

MEMORANDUM

TO: Hadi Mansouri
Department of Permitting Services

FROM: Michael Kyne
Historic Preservation Section
Maryland-National Capital Park & Planning Commission

SUBJECT: Historic Area Work Permit #902785: Hardscape and landscape alterations

The Montgomery County Historic Preservation Commission (HPC) has reviewed the attached application for a Historic Area Work Permit (HAWP). This application was **Approved** at the February 12, 2020 HPC meeting.

The HPC staff has reviewed and stamped the attached construction drawings.

THE BUILDING PERMIT FOR THIS PROJECT SHALL BE ISSUED CONDITIONAL UPON ADHERENCE TO THE ABOVE APPROVED HAWP CONDITIONS AND MAY REQUIRE APPROVAL BY DPS OR ANOTHER LOCAL OFFICE BEFORE WORK CAN BEGIN.

Applicant: Tony Marra and Mary Sheehan (Janet Conroy, Agent)
Address: 30 West Kirke Street, Chevy Chase

This HAWP approval is subject to the general condition that the applicant will obtain all other applicable Montgomery County or local government agency permits. After the issuance of these permits, the applicant must contact this Historic Preservation Office if any changes to the approved plan are made. Once work is complete the applicant will contact Michael Kyne at 301.563.3403 or michael.kyne@montgomeryplanning.org to schedule a follow-up site visit.



REVIEWED

By Michael Kyne at 4:38 pm, Apr 01, 2020

APPROVED
Montgomery County
Historic Preservation Commission

Sandra L. Heiler



FRONT STOOP & LANDING



EXISTING FRONT YARD

REVIEWED

By Michael Kyne at 4:38 pm, Apr 01, 2020

APPROVED
Montgomery County
Historic Preservation Commission

Sandra L. Heiler



FRONT OF HOUSE



FRONT STOOP, LAMP, LANDING

REVIEWED

By Michael Kyne at 4:38 pm, Apr 01, 2020

APPROVED
Montgomery County
Historic Preservation Commission

Sandra D. Heiler



-to be replaced w/ Vilagio pavers on concrete (see cut sheet)



Existing asphalt driveway @ sidewalk

REVIEWED

By Michael Kyne at 4:39 pm, Apr 01, 2020

APPROVED

Montgomery County
Historic Preservation Commission

Sandra J. Heiler



*existing brick pad to be replaced with
pavers to match new driveway*

REVIEWED

By Michael Kyne at 4:39 pm, Apr 01, 2020

APPROVED
Montgomery County
Historic Preservation Commission

Sandra L. Heiler



site of new patio



site of new patio (asphalt lifted)

REVIEWED

By Michael Kyne at 4:39 pm, Apr 01, 2020

APPROVED
Montgomery County
Historic Preservation Commission
Sandra L. Heiler

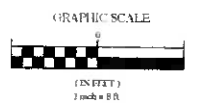
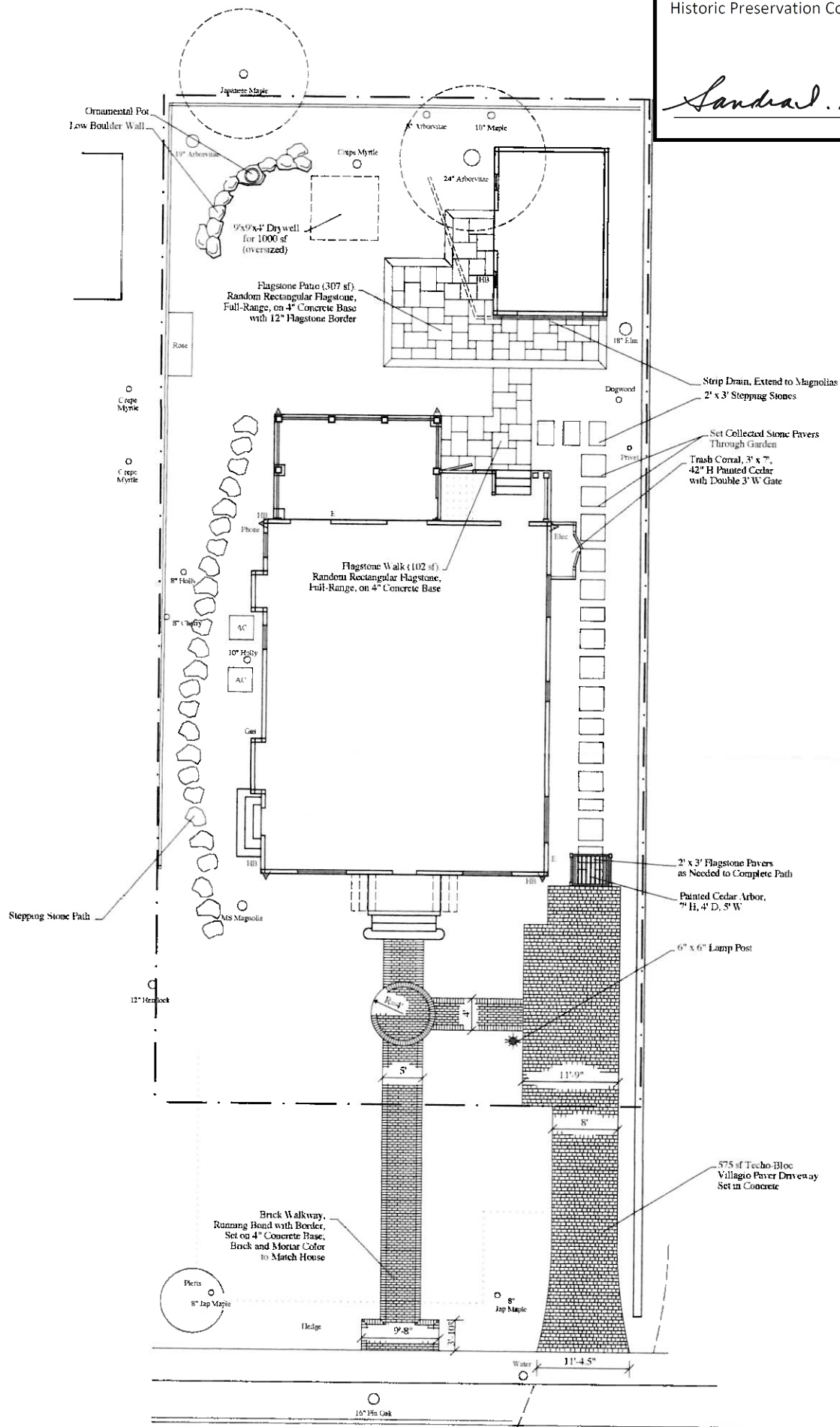

EVERETT

GARDEN DESIGNS LLC
202.465.5740
www.everettgardendesigns.com

TITLE: **HARDSCAPE PLAN**
for Permitting

DATE: 10-7-19, 10-14-19, 10-23-19, 11-12-19
1-20-20, 1-21-20

SHEEHAN-MARRA RES

30 West Kirke St.
Chevy Chase, MD

SCALE: 1/8" = 1'

NORTH:



REVIEWED

By Michael Kyne at 4:39 pm, Apr 01, 2020



APPROVED
Montgomery County
Historic Preservation Commission
Sandra L. Heiler



New Walpole Outdoors Lamp post
Avon - SKU 795431
5 1/2" SQ, 76 1/2" H.

New Walpole Outdoors Arbor SKU 79610X
4" SQ POSTS



REVIEWED

By Michael Kyne at 4:40 pm, Apr 01, 2020

Villagio

DESCRIPTION: Paver TEXTURE: Beveled

PALLET OVERVIEW

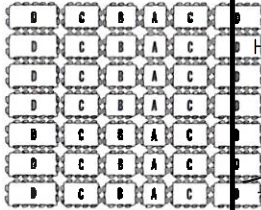

APPROVED
 Montgomery County
 Historic Preservation Commission
 Specifications per pallet
 Imperial Metric
 FULL PALLET 117 ft² 10.88 m²
 *HALF-PALLET 53.18 ft² 4.94 m²
 FULL PALLET 3 029 lbs 1 374 kg
 *HALF-PALLET 1 354 lbs 614 kg
 FULL PALLET 11
 *HALF-PALLET 5
 Coverage per row 10.64 ft² 0.99 m²
 Linear coverage per row 24.94 lin. ft 7.61 lin. m
 Void space 8.0 %
 Joint Depth 3/8" to 9/16" 9 to 15 mm

Weight
 Number of rows
Sandra L. Heiler



The Villagio paver allows for gentle curves and winding pathways, eliminating the need for cuts.

NOTES

* Colors only available in half-pallets.

See 48 to 51 for more technical information, and page 87 to 93 when used as a permeable pavement application.

01 | Linear pattern

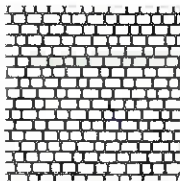

02 | Modified Herringbone pattern

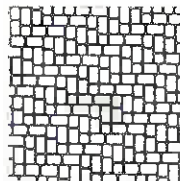





03 | Modified Herringbone pattern

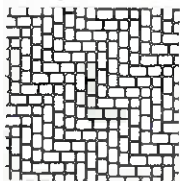

04 | Modified Herringbone pattern



Patterns are for design inspiration only. The installer is responsible to calculate & purchase the correct amount of material.

| | Unit dimensions | in | mm | Units/pallet |
|---|-----------------|--------|-----|--------------|
|  | Height | 2 3/8 | 60 | 77 units |
| | Depth | 5 1/8 | 130 | |
| | Length | 5 1/8 | 130 | |
|  | Height | 2 3/8 | 60 | 77 units |
| | Depth | 5 1/8 | 130 | |
| | Length | 6 5/16 | 160 | |
|  | Height | 2 3/8 | 60 | 154 units |
| | Depth | 5 1/8 | 130 | |
| | Length | 7 5/16 | 185 | |
|  | Height | 2 3/8 | 60 | 154 units |
| | Depth | 5 1/8 | 130 | |
| | Length | 8 7/16 | 215 | |

PREFERRED COLOR



sandlewood shale grey mojavé beige champlain grey harvest gold chestnut brown onyx black* chocolate brown*

