



## HISTORIC PRESERVATION COMMISSION

Marc Elrich  
*County Executive*

Sandra I. Heiler  
*Chairman*

Date: March 12, 2020

### MEMORANDUM

TO: Hadi Mansouri  
Department of Permitting Services

FROM: Dan Bruechert  
Historic Preservation Section  
Maryland-National Capital Park & Planning Commission

SUBJECT: Historic Area Work Permit #905473: Accessory Structure

---

The Montgomery County Historic Preservation Commission (HPC) has reviewed the attached application for a Historic Area Work Permit (HAWP). This application was **approved** at the March 11, 2020 HPC meeting.

The HPC staff has reviewed and stamped the attached construction drawings.

THE BUILDING PERMIT FOR THIS PROJECT SHALL BE ISSUED CONDITIONAL UPON ADHERENCE TO THE ABOVE APPROVED HAWP CONDITIONS AND MAY REQUIRE APPROVAL BY DPS OR ANOTHER LOCAL OFFICE BEFORE WORK CAN BEGIN.

Applicant: Waverly Real Estate Group  
Address: 16834 Georgia Ave., Olney

This HAWP approval is subject to the general condition that the applicant will obtain all other applicable Montgomery County or local government agency permits. After the issuance of these permits, the applicant must contact this Historic Preservation Office if any changes to the approved plan are made. Once work is complete the applicant will contact Dan Bruechert at 301.563.3400 or [dan.bruechert@montgomeryplanning.org](mailto:dan.bruechert@montgomeryplanning.org) to schedule a follow-up site visit.



APPROVED  
Montgomery County  
Historic Preservation Commission

*Sandra L. Heiler*

**REVIEWED**

*By Dan.Bruechert at 3:11 pm, Mar 12, 2020*

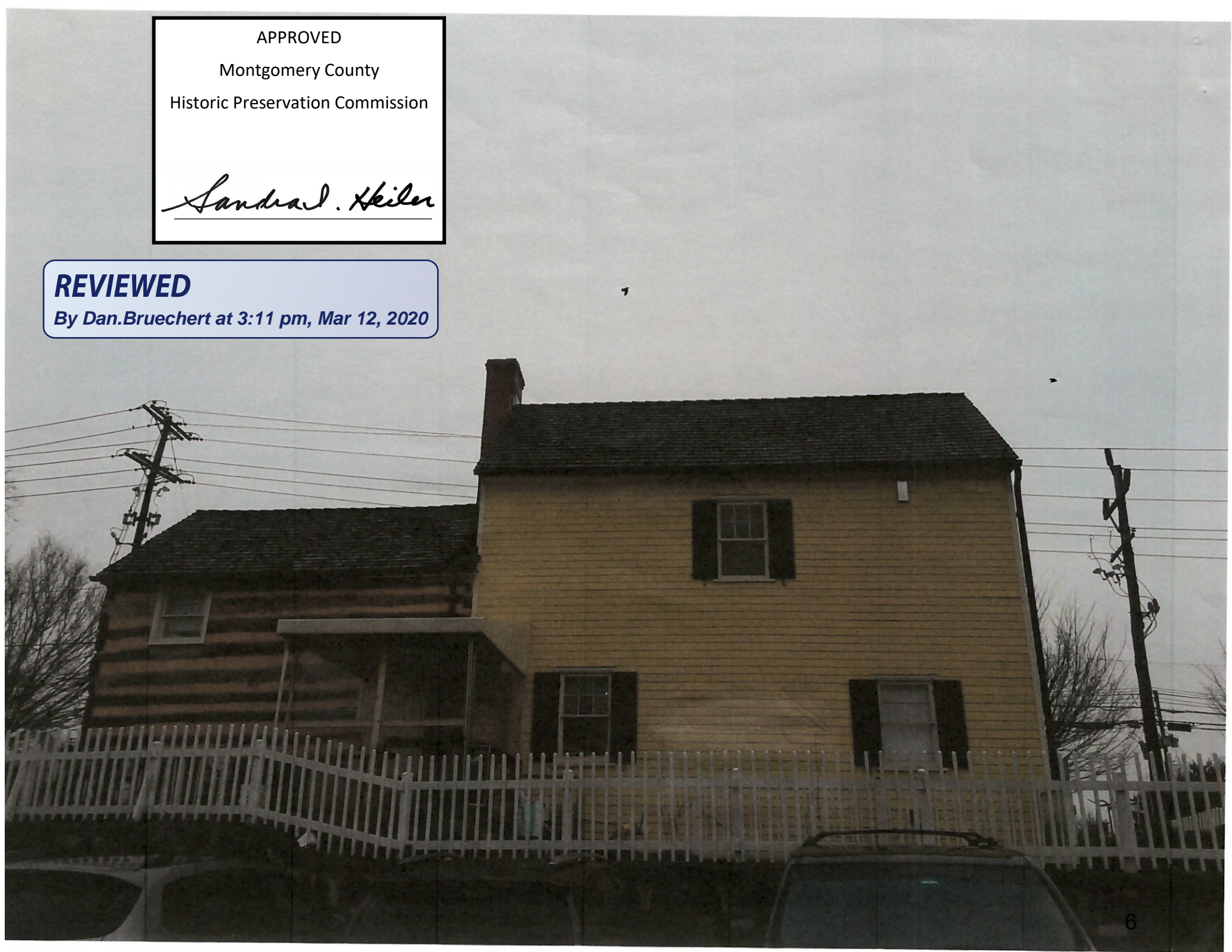

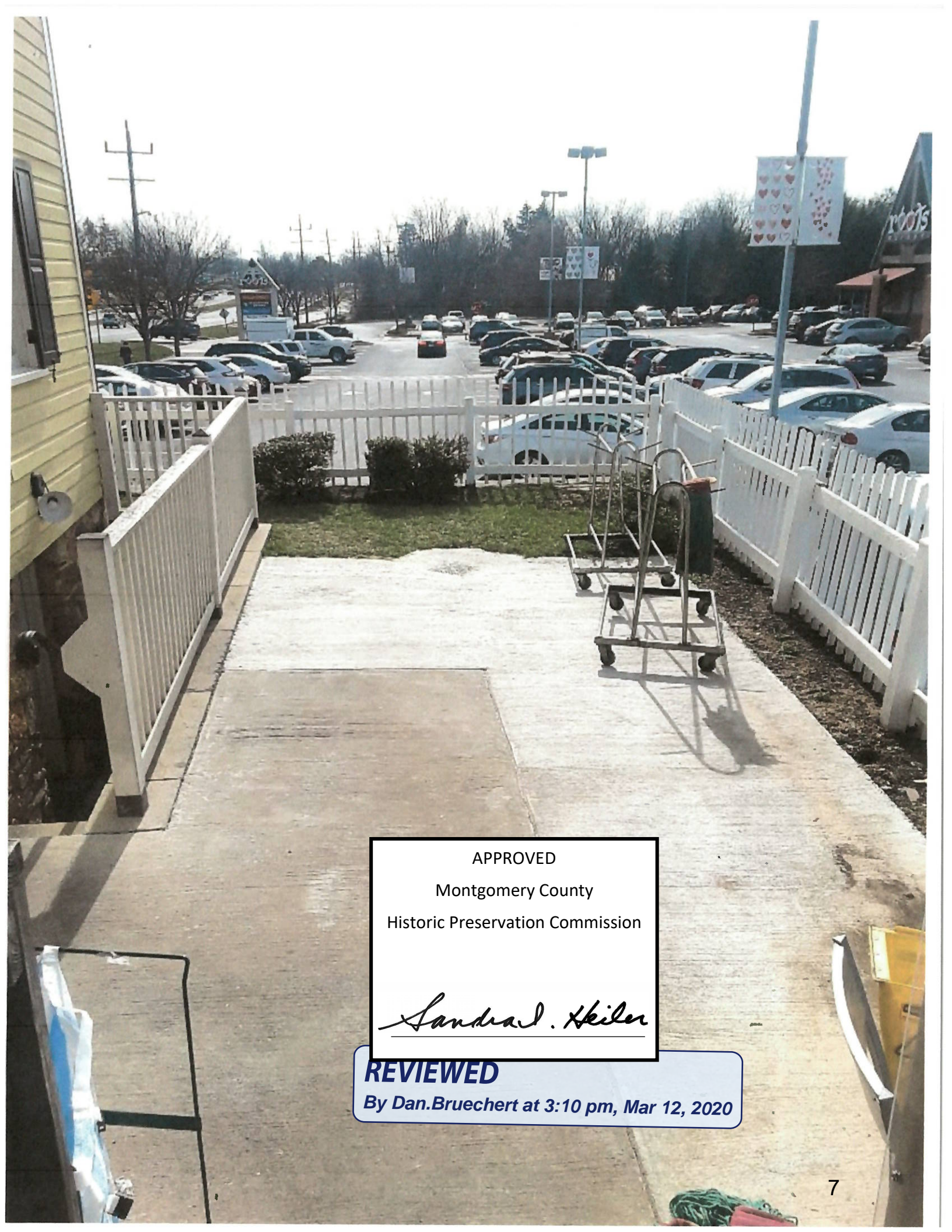

APPROVED  
Montgomery County  
Historic Preservation Commission

*Sandra L. Heiler*

**REVIEWED**  
By Dan.Bruechert at 3:10 pm, Mar 12, 2020

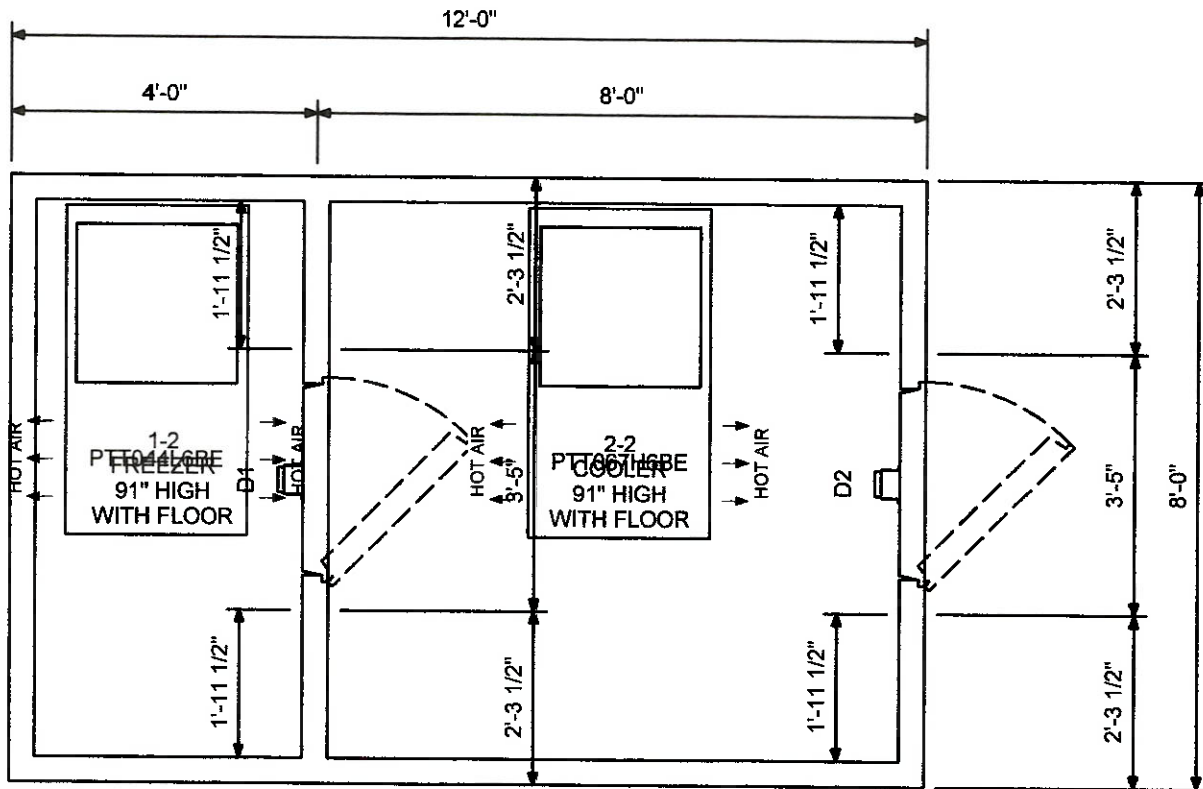

**-SPECIFICATION-**

**Box Height:** Freezer 7'-7" (6'-11" Interior)

Cooler 7'-7" (6'-11" Interior)

**Insulation:** 4" thick AK-XPS4 Extruded foam UL classified core flame spread 15, Smoke rating less than 165

**Compartment 1 - Freezer**

D1 - (1) Standard 30" x 76" Left hinged flush door with brushed hardware. Interior & Exterior finish: 26 Ga. Stucco Embossed Acrylume. Energy saving temperature regulating thermostat heater wire and heated relief vent. Heavy duty deadbolt handle latch. Digital LED Thermometer with pilot light switch. 1807 11w, Vapor Proof, 120V. LED fixture. 82 Lumens /watt Angled face . Requires 115vac. 2.2 amps.

**Refrigeration:**

(1) 1 HP Pro3 Outdoor Top Mount Self-contained Refrig. Unit, Model PTT044L6BE, 208-230/60/1, MCA 15.9 Amps, Low Temperature, R404A, 2 years compressor and parts warranty from date of shipment within Continental USA.

(1) Extended 3 year compressor Warranty for PTT044L6BE

**Wall Panels**

Interior Finish: 26 Ga. Stucco Embossed Acrylume

Exterior Finish: 26 Ga. Stucco Embossed Acrylume

**Ceiling Panels**

Interior Finish: 26 Ga. Stucco Embossed Acrylume

Exterior Finish: 26 Ga. Stucco Embossed Acrylume

**Floor Panels**

Standard NSF Floor panel rated for 600 LBS/ SQ. FT.

.050 Smooth Aluminum Integral

Application: Foot Traffic - No Rolling Carts

**REVIEWED**  
By Dan.Bruechert at 3:10 pm, Mar 12, 2020

APPROVED  
Montgomery County  
Historic Preservation Commission  
*Sandra L. Heiler*

Quote #: Revision:	Project: 8 x 12 Outdoor Combo	Date: 10/01/2019
Customer:	Page 1 of 3	



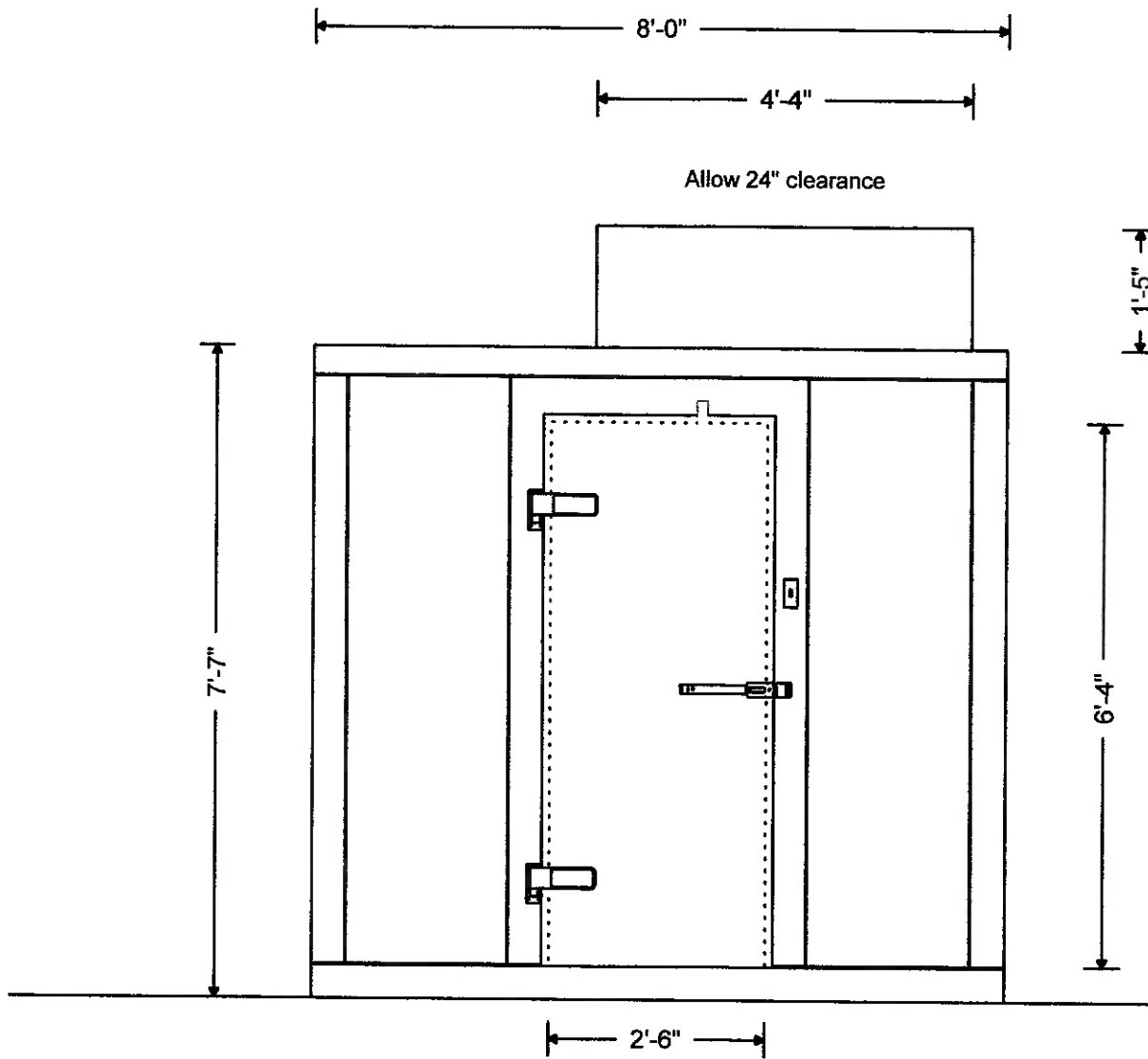

**-SPECIFICATION-Continued**

**Compartment 2 - Cooler**

D2 - (1) Standard 30" x 76" Left hinged flush door with brushed hardware. Interior & Exterior finish: 26 Ga. Stucco Embossed Acrylume. Heavy duty deadbolt handle latch. Digital LED Thermometer with pilot light switch. 1807 11w, Vapor Proof, 120V. LED fixture. 82 Lumens /watt Angled face . Requires 115vac. 1 amps.

**Refrigeration:**

(1) 3/4 HP Pro3 Outdoor Top Mount Self-contained Refrig. Unit, Model PTT067H6BE, 208-230/60/1, MCA 11.5 Amps, BTUH 6860, Medium Temperature, R404A, 2 years compressor and parts warranty from date of shipment within Continental USA.

(1) Extended 3 year compressor Warranty for PTT067H6BE Wall Panels

Interior Finish: 26 Ga. Stucco Embossed Acrylume  
Exterior Finish: 26 Ga. Stucco Embossed Acrylume

**Ceiling Panels**

Interior Finish: 26 Ga. Stucco Embossed Acrylume  
Exterior Finish: 26 Ga. Stucco Embossed Acrylume

**Floor Panels**

Standard NSF Floor panel rated for 600 LBS/ SQ. FT.  
.050 Smooth Aluminum Integral

Application: Foot Traffic - No Rolling Carts

**Accessories Shipped Loose**

(96) Rain roof membrane w/ 10 ft. long with termination bars with 1 screw every 12inch (per sq.ft.)

(1) DOOR HOOD FROM 30" TO 42" LONG ACRYLUME STUCCO EMBOSSED, WITH 4 TEK SCREWS (LOOSE)

APPROVED  
Montgomery County  
Historic Preservation Commission

*Sandra L. Heiler*

Quote #: Revision:

Project: 8 x 12 Outdoor Combo

Date: 10/01/2019

Customer:

Page 2 of 3

**REVIEWED**

By Dan.Bruechert at 3:10 pm, Mar 12, 2020

