



HISTORIC PRESERVATION COMMISSION

Marc Elrich
County Executive

Robert Sutton
Chairman

Date: May 19, 2021

MEMORANDUM

TO: Mitra Pedoeem
Department of Permitting Services

FROM: Michael Kyne
Historic Preservation Section
Maryland-National Capital Park & Planning Commission

SUBJECT: Historic Area Work Permit #949849: Construction of new fences

The Montgomery County Historic Preservation Commission (HPC) has reviewed the attached application for a Historic Area Work Permit (HAWP). This application was **Approved** at the May 12, 2021 HPC meeting.

The HPC staff has reviewed and stamped the attached construction drawings.

THE BUILDING PERMIT FOR THIS PROJECT SHALL BE ISSUED CONDITIONAL UPON ADHERENCE TO THE ABOVE APPROVED HAWP CONDITIONS AND MAY REQUIRE APPROVAL BY DPS OR ANOTHER LOCAL OFFICE BEFORE WORK CAN BEGIN.

Applicant: Kathleen Dunne Schroeder
(Address: 7401 Carroll Avenue, Takoma Park)

This HAWP approval is subject to the general condition that the applicant will obtain all other applicable Montgomery County or local government agency permits. After the issuance of these permits, the applicant must contact this Historic Preservation Office if any changes to the approved plan are made. Once work is complete the applicant will contact Michael Kyne at 301.563.3403 or michael.kyne@montgomeryplanning.org to schedule a follow-up site visit.





FOR STAFF ONLY:
HAWP# 949489
DATE ASSIGNED _____

APPLICATION FOR HISTORIC AREA WORK PERMIT

HISTORIC PRESERVATION COMMISSION
301.563.3400

APPLICANT:

Name: kathleen dunne schroeder
Address: 7401 Carroll Avenue
Daytime Phone: 2403057042

E-mail: mefa146@gmail.com
City: Takoma Park Zip: 20912
Tax Account No.: _____

AGENT/CONTACT (if applicable):

Name: n/a

E-mail: _____

City: _____ Zip: _____

REVIEWED
By Michael Kyne at 12:33 pm, May 19, 2021

APPROVED
Montgomery County
Historic Preservation Commission
[Signature]

LOCATION OF BUILDING/PREMISE: MIHP # of H _____

Is the Property Located within an Historic District? _____

Is there an Historic Preservation/Land Trust/Envir _____
map of the easement, and documentation from th _____

Are other Planning and/or Hearing Examiner App _____
(Conditional Use, Variance, Record Plat, etc.?) If YES, include information on these reviews as
supplemental information.

Avenue

koma

? If YES, include a
application.

this Application?

Building Number: 7401 Street: Carroll Avenue

Town/City: Takoma Park Nearest Cross Street: Manor Circle

Lot: P1 Block: 45 Subdivision: _____ Parcel: _____

TYPE OF WORK PROPOSED: See the checklist on Page 4 to verify that all supporting items for proposed work are submitted with this application. Incomplete Applications will not be accepted for review. Check all that apply:

- | | | |
|---------------------------------------------|----------------------------------------------|----------------------------------------------------------|
| <input type="checkbox"/> New Construction | <input type="checkbox"/> Deck/Porch | <input type="checkbox"/> Shed/Garage/Accessory Structure |
| <input type="checkbox"/> Addition | <input checked="" type="checkbox"/> Fence | <input type="checkbox"/> Solar |
| <input type="checkbox"/> Demolition | <input type="checkbox"/> Hardscape/Landscape | <input type="checkbox"/> Tree removal/planting |
| <input type="checkbox"/> Grading/Excavation | <input type="checkbox"/> Roof | <input type="checkbox"/> Window/Door |
| | | <input type="checkbox"/> Other: _____ |

I hereby certify that I have the authority to make the foregoing application, that the application is correct and accurate and that the construction will comply with plans reviewed and approved by all necessary agencies and hereby acknowledge and accept this to be a condition for the issuance of this permit.

Kathleen Dunne (moore) Schroeder

April 11, 2021

Signature of owner or authorized agent

Date

HAWP APPLICATION: MAILING ADDRESSES FOR NOTIFYING
 [Owner, Owner's Agent, Adjacent and Confronting Property Owners]

Owner's mailing address

7401 Carroll Ave
 Takoma Park, MD. 20912

Owner's Agent's mailing address

1312 Cresthaven Dr.
 Silver Spring, MD. 20903

REVIEWED
 By Michael Kyne at 12:33 pm, May 19, 2021

APPROVED
 Montgomery County
 Historic Preservation Commission

7403 Carroll Ave

Ave

7402 Carroll Ave

7403 Carroll Ave

7335 Carroll Ave

2280 Manor Circle

Description of Property: Please describe the building and surrounding environment. Include information on significant structures, landscape features, or other significant features of the property:

Contributing Resource within the Takoma Park Historic District STYLE: Craftsman bungalow. DATE: c. 1920s. Located on the corner of Manor Circle and Carroll Avenue. Recent addition to the home (HPC Case No. 37/03-19GG)

The Multi-family unit behind is not in historic.

Description of Work Proposed: Please give an overview of the work to be undertaken:

Two Fences

We wish to install a privacy fence to both block the view of the neighbors garbage and parking lot as well as to increase security from the adjacent multi unit housing unit. There is an existing chain link fence dividing the properties. We have had continuous issues and complaints on file due to overflowing trash and abandoned cars.

We require a privacy fence to be able to enjoy our outdoor space. The fence will 38' long, 5.5' high from the base of the concrete lot. We will use 6" wide stained pine boards.

We also want to install fencing along the perimeter of the yard facing the sidewalk as laid out in our original plan. We will use 4' high black metal fence panels that will tie in with the original black railing on the front porch. There will be a gate near the homes entrance and driveway.

REVIEWED

By Michael Kyne at 12:33 pm, May 19, 2021

APPROVED

Montgomery County
Historic Preservation Commission



Work Item 1: Wood Privacy Fence

Description of Current Condition: Existing chainlink on property line. Requesting approval for a privacy fence

Proposed Work: Propose 38' run of a 5.5' high pine slatted fence. Installed on owners side of existing chainlink. Not visible to public view from adjacent streets, Manor Circle or Carroll Avenue.

Work Item 2: Black metal property fence

Description of Current Condition: None

Proposed Work: Following site plan on original permit, we propose a 4' metal railing fence on the perimeter of our side yard. This will match our porch railing.

REVIEWED
By Michael Kyne at 12:33 pm, May 19, 2021

APPROVED
Montgomery County
Historic Preservation Commission

Work Item 3: _____

Description of Current Condition:

Proposed

Supplemental



Owner's view from 7401
Carroll Ave yard. Neighbors
trash and parking lot.

Fencing proposed on owners side of chain link
fencing.

REVIEWED

By Michael Kyne at 12:33 pm, May 19, 2021



Fencing would go here.



Neighbor sideview from Manor Circle





37' long 5'6" high stained pine fence to block view, prevent trash overflow, and add safety.



Fence bottom starts at Concrete pad.

REVIEWED
By Michael Kyne at 12:33 pm, May 19, 2021

APPROVED
Montgomery County
Historic Preservation Commission

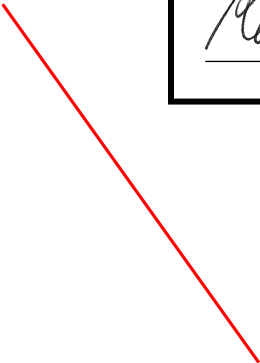
Shows fence base at level with concrete pad





Street views doesn't show fencing from either Carroll Avenue or Manor Circle

7401 Carroll From Carroll



Fence would be located here, behind existing shed.

Black metal fencing would follow lawn.

7401 Carroll Side View from Manor Circle

REVIEWED
By Michael Kyne at 12:33 pm, May 19, 2021

APPROVED
Montgomery County
Historic Preservation Commission
Robert H. [Signature]

Proposed fencing for side along Manor circle and drive way.

- 1 row of
- 1 row --- feet
- 1 row with gate

REVIEWED

By Michael Kyne at 12:33 pm, May 19, 2021

APPROVED

Montgomery County

Historic Preservation Commission



Natural Reflections Standard-Duty 4 ft. H x 6 ft. W Black Aluminum Pre-Assembled Fence Panel

<https://www.homedepot.com/p/Barrette-Outdoor-Living-Natural-Reflections-Standard-Duty-4-ft-H-x-6-ft-W-Black-Aluminum-Pre-Assembled-Fence-Panel-73002245/202891613>

- Barrette Outdoor Living Pre-Assembled Aluminum fence panels are an economical solution to the classic look of wrought iron fence. Our patented ProLock technology secures panels from the inside, creating a clean look, seamless finish and superior strength. Additionally, Barrette Outdoor Living aluminum fence products resist rust and corrosion and are backed by a transferable limited lifetime warranty. Coordinating posts sold separately: line post - model # 73002255, corner post - model # 73002256, end post - model # 73002257, gate post - model # 73002258, blank post - model # 73002392
- Coordinating gates sold separately: arched top - model # 73009462 or straight top - model # 73009465
- Picket size is 5/8 in. x 5/8 in, with 3.85 in. space between pickets
- Panel will adjust to the slope of your yard at a rate of 38 in. over 6 ft. panel
- Panel can be cut down to your desired size
- Made from powder coated aluminum that resists rust, corrosion and discoloration
-

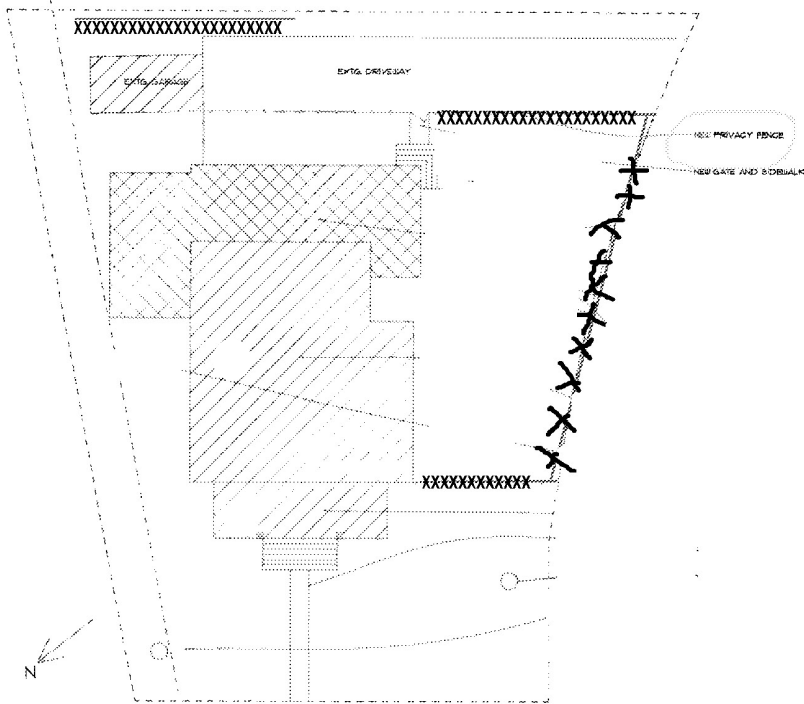

SITE PLAN

REVIEWED

By Michael Kyne at 12:33 pm, May 19, 2021

14

APPROVED

Montgomery County

Historic Preservation Commission

REVIEWED

By Michael Kyne at 12:35 pm, May 19, 2021

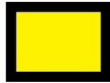

4' Aluminum Picket



5.5' Wooden Privacy

APPROVED
Montgomery County
Historic Preservation Commission
Robert H. Adams



A photograph of a wooden fence made of horizontal planks. A string of black outdoor lights with white bulbs is strung across the fence. On the left side, there is a basket of colorful flowers, including purple and orange ones. The background shows a house and trees.

REVIEWED

By Michael Kyne at 12:35 pm, May 19, 2021

APPROVED

Montgomery County
Historic Preservation Commission

A handwritten signature in black ink, which appears to read "Robert A. Patton". The signature is written in a cursive style and is positioned above a horizontal line.

Robert A. Patton

REVIEWED

By Michael Kyne at 12:35 pm, May 19, 2021

APPROVED

Montgomery County

Historic Preservation Commission

Robert H. Patton

REVIEWED

By Michael Kyne at 12:35 pm, May 19, 2021

APPROVED

Montgomery County

Historic Preservation Commission



Robert H. Potter

#1 Home Improvement Retailer



You're shopping Silver Spring

OPEN until 10 pm

Delivering to 20910

Search



Cart | 0 items

Home / Lumber & Composites / Fencing / Metal Fencing / Metal Fence Panels

Internet #202891613 Model #73002245 Store SO SKU #1001088238

REVIEWED

By Michael Kyne at 12:35 pm, May 19, 2021

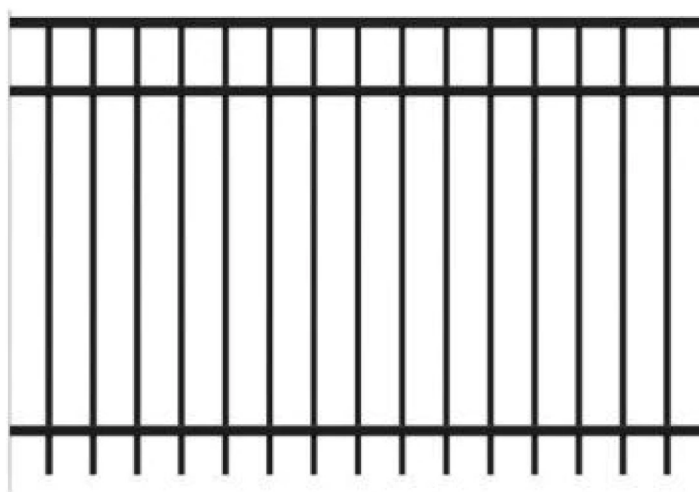
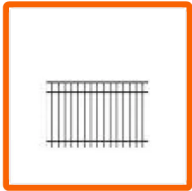

Hover Image to Zoom

247

Natural Reflections Standard-Duty 4 ft. H x 6 ft. W Black Aluminum Pre-Assembled Fence Panel

by Barrette Outdoor Living

★★★★★ (40) Write a Review Questions & Answers (78)

\$87⁴⁶

REVIEWED

By Michael Kyne at 12:35 pm, May 19, 2021



Save up to \$100 on your qualifying purchase.
Apply for a Home Depot Consumer Card

Color/Finish: **Black**



Nominal Panel Height x Width (ft.): **4 ft x 6 ft**



How to Get It

Delivering to: **20910** | [Change](#)

<p>Ship to Store Pickup May 18 - May 21 FREE</p>	<p>Ship to Home Expect it May 26 - Jun 1 Standard Delivery</p>	<p>Scheduled Delivery Not available for this item</p>
----------------------------------------------------------------------------	-----------------------------------------------------------------------------------	------------------------------------------------------------------

We'll send up to **439** to **Silver Spring** for **free pickup**
Curbside pickup available.
[Change Store](#)

- 1 + [Add to Cart](#)

Your Fastest Checkout ⓘ

[Turn on Instant Checkout](#)

— or —

Buy now with **PayPal**