



HISTORIC PRESERVATION COMMISSION

Marc Elrich
County Executive

Robert K. Sutton
Chairman

Date: June 15, 2023

MEMORANDUM

TO: Rabbiah Sabbakhan
Department of Permitting Services

FROM: Dan Bruechert
Historic Preservation Section
Maryland-National Capital Park & Planning Commission

SUBJECT: Historic Area Work Permit #1028583 - Fence Installation

The Montgomery County Historic Preservation Commission (HPC) has reviewed the attached application for a Historic Area Work Permit (HA WP). This application was **Approved** at the June 14, 2023 HPC meeting.

The HPC staff has reviewed and stamped the attached construction drawings.

THE BUILDING PERMIT FOR THIS PROJECT SHALL BE ISSUED CONDITIONAL UPON ADHERENCE TO THE ABOVE APPROVED HAWP CONDITIONS AND MAY REQUIRE APPROVAL BY DPS OR ANOTHER LOCAL OFFICE BEFORE WORK CAN BEGIN.

Applicant: Laura Braden
Address: 12 E. Melrose St., Chevy Chase

This HAWP approval is subject to the general condition that the applicant will obtain all other applicable Montgomery County or local government agency permits. After the issuance of these permits, the applicant must contact this Historic Preservation Office if any changes to the approved plan are made. Once work is complete the applicant will contact Dan Bruechert at 301.563.3400 or dan.bruechert@montgomeryplanning.org to schedule a follow-up site visit.





Celebrating 40 Years!

301-663-4000 • 800-493-3623 • 301-663-0017 (Fax) • www.frederickfence.com

P.O. Box 4187
Frederick, MD 21705
MHC # 16416

OWNERS NAME(S): Margaret McKay	DATE: 3/21/2023
JOB ADDRESS: 12 E. Melrose St	EMAIL: lesliemckay57@gmail.com
CITY STATE & ZIP: Chevy Chase MD 20815	HOME: 0 CELL: 203-803-3769
BILLING ADDRESS: Same	

DESCRIPTION OF WORK TO BE COMPLETED BY CONTRACTOR: **FENCE WILL BE POOL CODE COMPLIANT**

Furnish labor and materials to install approximately 192 linear feet of 6' tall cedar Sandwich Board fence. Fence constructed using 1x6 vertical boards. Inside/outside framework to be all 2x6 boards teco clipped to 6x6 posts. Includes 1x6 cap board.

All posts to be pressure treated 6x6's with Seneca tops and secured in the ground using Dry Packed concrete.

Furnish labor and materials to install approximately 38 linear feet of 4' Tall Cedar Spindle Sandwich Picket Fence. Fence constructed using 2x2 vertical pickets with a pointed top. Top and bottom runners will be 2x4 boards, fastened to the posts with Teco clips.

All posts to be pressure treated 6x6's with Seneca tops and secured in the ground using Dry Packed concrete.

Deposit of \$5,320.00 received 6/14/21, price increase applied to remaining 2/3rd balance

APPROVED
Montgomery County
Historic Preservation Commission



REVIEWED
By Dan.Bruechert at 10:46 am, Jun 15, 2023

Frederick Fence Company to obtain required Permit(s).
Remove and Haul approximately (230) linear feet of Chain Link Fence.

HOMEOWNER TO DO BEFORE INSTALL

- DISCLAIMERS:**
- If property pins are not present, we recommend a boundary survey. Customer responsible for boundary lines and fence location.
 - Customer will confirm start and stop points with foreman at start of installation.
 - Frederick Fence does not haul away dirt or rocks.
 - Frederick Fence not responsible for damage to underground sprinklers, dog fences, or private utilities.
 - No refunds or returns on special order materials (Includes Vinyl, Aluminum, & Steel Fence).
- Owner Initials: Leslie McKay

NOTES FOR INSTALLATION:

PARTIALLY digger accessible

PAYMENT TERMS:

For the above services and/or materials & equipment (also permits where required) the OWNER agrees to pay the CONTRACTOR the total amount stated in the box labeled "Contract Total". A deposit will be required before project start and may not exceed 1/3 of the total contract price. A second deposit will be required at the start of the job for all jobs exceeding \$20,000 and must not exceed 1/3 of the total contract price. The final balance will be due upon completion.

APPROXIMATE STARTING AND COMPLETING:
Work under this contract will start in approx. **4-6 weeks** subject to circumstances beyond the control of the contractor, (including weather and delays) and will be completed in approximately **4-5 days.**

CREDIT CARD INFORMATION:

Card # Exp. CSV Would you like us to charge your card upon completion?
 Yes No

CONTRACT ACCEPTANCE:

The undersigned CONTRACTOR and OWNER agree and accept the terms and conditions set forth in pages 1 through 4 and further agree that this contract contains the final and entire agreement between the parties here to and neither they nor their agents shall be bound by any terms, conditions, statements, warranties, or representations, oral or written, not herein contained. This contract is not binding upon FREDERICK FENCE CO, INC. until accepted. You, the buyer, may cancel this transaction at any time prior to midnight of the fifth business day or seventh business day if the buyer is at least 65 years old, after the date of this transaction.

Date: Mar 21, 2023 Owner Signature: Leslie McKay
 Lic. No. 0 Salesman: _____ Brody _____

Pricing and approx. lead time on this contract is only valid for 2 weeks from estimate date and will need to be re-quoted if date of signing is after 4/4/2023

rec'd 3/21/23
Page 1 of 4
11

OWNER(S) NAME: Margaret McKay

DRAWING: OWNER TO GO OVER LOCATION OF FENCE & GATES WITH FOREMAN

Owner Initials:

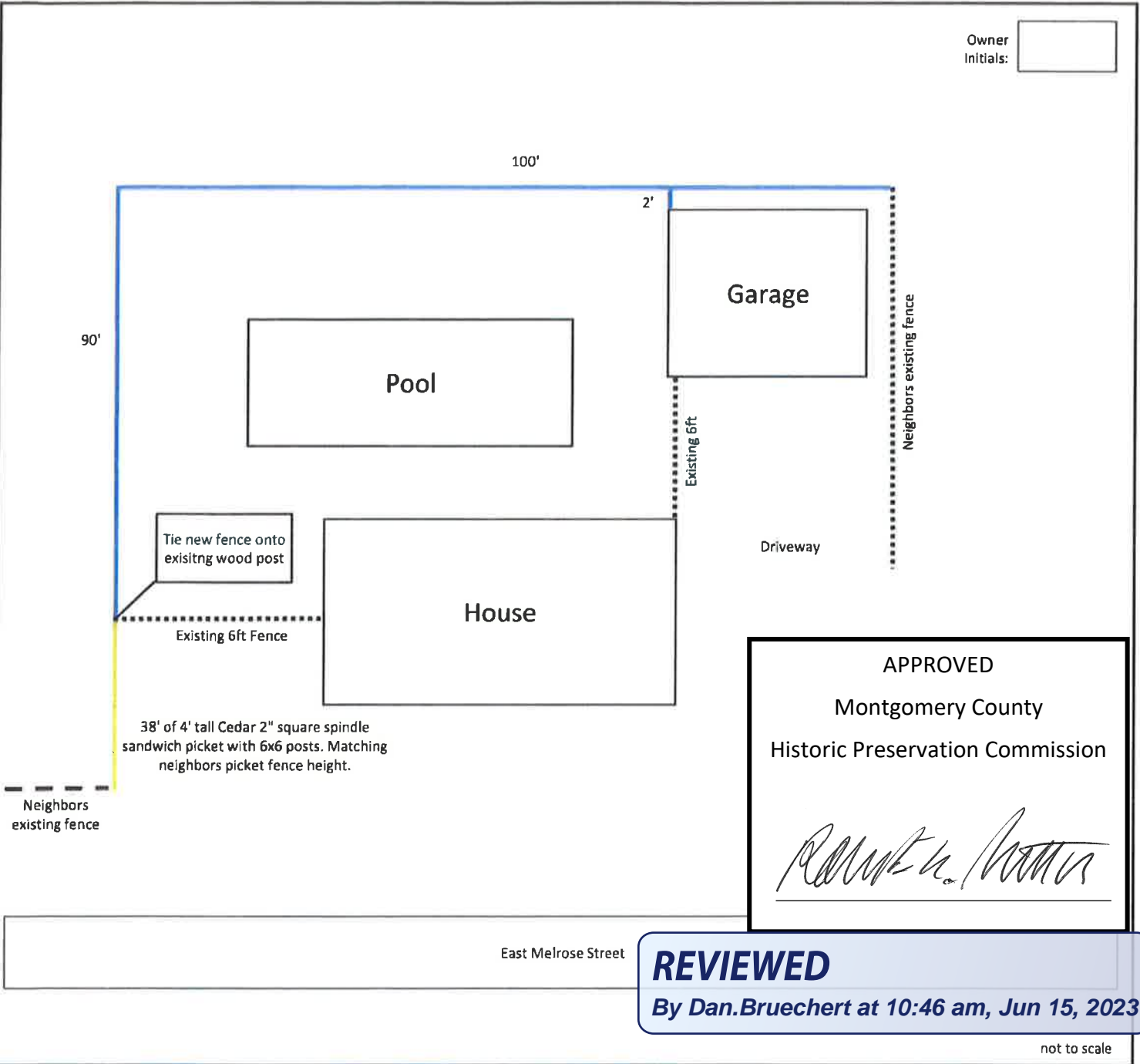

DISCLAIMERS

- Customer responsible for boundary lines and fence location and will confirm start and stop points with foreman at start of installation.
- Property Pins are the best way to ensure property boundaries. A plat/survey can be used but the Homeowner is responsible for any subsequent consequences.
- Frederick Fence does not haul away dirt or rocks. Customer to Indicate to foreman location to spread or pile dirt.
- Frederick Fence is not responsible for damage to underground sprinklers, dog fences, or private utilities.
- No refunds or returns on special order materials (Includes Vinyl, Aluminum, & Steel Fence).

MONTGOMERY COUNTY
DIVISION OF BUILDING CONSTRUCTION

THE FREAR RESIDENCE
12 MELROSE STREET, CHEVY CHASE, MD
SINGLE FAMILY DETACHED HOME RENOVATION

ARCHITECTURAL SITE PLAN
Donation Attention Attention
Existing Structural Integrity

GENERAL NOTES FOR RESIDENTIAL CONSTRUCTION M/C

REVIEWED
By Dan.Bruechert at 10:46 am, Jun 15, 2023

SYMBOL LEGEND

LIST OF ABBREVIATIONS

INTERNATIONAL BUILDING CODE DATA 2012 IRC

SITE PLAN
SCALE: 1/8" = 1'-0"

4" tall wood picket fence
6" tall wood sandwich board privacy fence

APPROVED
Montgomery County
Historic Preservation Commission

Robert K. Kramer



KRAMER ARCHITECTS INC.

BOWA

PROJECT: FREAR RESIDENCE RENOVATION
12 EAST MELROSE STREET
CHEVY CHASE, MD, 20815

SHEET TITLE: COVER SHEET

REVISIONS PERMIT

Date: 06-18-2023
Scale: AS NOTED
Project Number: 1320

CS.02

#729230

Example of fence to be installed on back portion of side property line and on rear property line.



APPROVED
Montgomery County
Historic Preservation Commission
Ronald H. [Signature]

REVIEWED
By Dan.Bruechert at 10:46 am, Jun 15, 2023

Example of fence to be installed on the front portion of the left side property line



APPROVED
Montgomery County
Historic Preservation Commission



REVIEWED
By Dan.Bruechert at 10:46 am, Jun 15, 2023