



HISTORIC PRESERVATION COMMISSION

Marc Elrich
County Executive

Sandra I. Heiler
Chairman

Date: July 17, 2020

MEMORANDUM

TO: Mitra Pedoeem
Department of Permitting Services

FROM: Dan Bruechert
Historic Preservation Section
Maryland-National Capital Park & Planning Commission

SUBJECT: Historic Area Work Permit # 915816 - Tree Removal

The Montgomery County Historic Preservation Commission (HPC) has reviewed the attached application for a Historic Area Work Permit (HAWP). This application was **approved** at the July 15, 2020 HPC meeting.

The HPC staff has reviewed and stamped the attached construction drawings.

THE BUILDING PERMIT FOR THIS PROJECT SHALL BE ISSUED CONDITIONAL UPON ADHERENCE TO THE ABOVE APPROVED HAWP CONDITIONS AND MAY REQUIRE APPROVAL BY DPS OR ANOTHER LOCAL OFFICE BEFORE WORK CAN BEGIN.

Applicant: Annie Kneedler & Sam Bryson
Address: 5 Columbia Ave., Takoma Park

This HAWP approval is subject to the general condition that the applicant will obtain all other applicable Montgomery County or local government agency permits. After the issuance of these permits, the applicant must contact this Historic Preservation Office if any changes to the approved plan are made. Once work is complete the applicant will contact Dan Bruechert at 301.563.3400 or dan.bruechert@montgomeryplanning.org to schedule a follow-up site visit.



REVIEWED

By Dan.Bruechert at 4:46 pm, Jul 17, 2020

APPROVED

Montgomery County

Historic Preservation Commission

Sandra L. Heiler

CITY OF TAKOMA PARK • PUBLIC WORKS DEPARTMENT
31 OSWEGO AVENUE • TAKOMA PARK, MD 20910
301-891-7633/301-585-2405 FAX

TREE REMOVAL APPLICATION

Waiver Fee: \$25.00

Permit Fee: \$50.00

(Fees are non-refundable)

Address: 5 Columbia Ave

Is tree located in Historic District? Y
(Refer to General Information Page)

Applicant: Samuel Bryson

Daytime Phone Number: 202-340-2924

Applicant following: Homeowner Tenant

EMAIL: sam.bryson@gmail.com

Address (if different from tree location):

In order to remove any tree (alive or dead), greater than 24" in circumference or 7 5/8" in diameter at 4.5 feet from the base, a permit or waiver is required. If tree removal is for construction of a building, site plans and County permits must be presented prior to an issuance of a permit. If tree removal is for a driveway, a City driveway apron permit may be required. See General Information page for details.

Number of trees to be removed: 5

Reason for removal: (1) invasive species (2) retaining wall impact (3) house impact (4) _____

You must mark tree(s) to be removed with a ribbon after submitting this application. If tree(s) is— not marked, your application may not be able to be processed.

Provide a diagram of the property below and indicate location of the tree(s) to be removed. If a diagram is not provided, your application may not be able to be immediately processed. Diagram can be sketched below or on separate page.

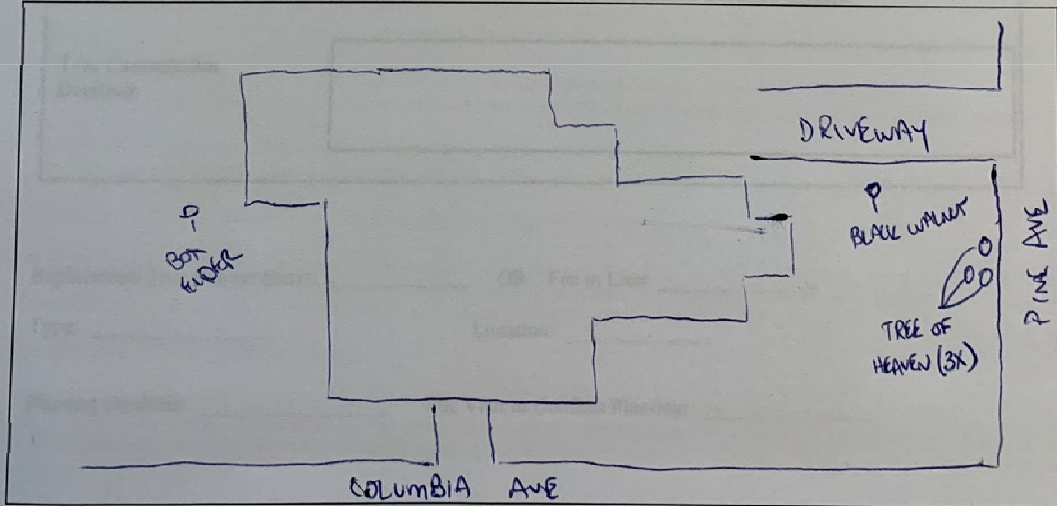

Applicant's Signature: _____

Date: 6/5/2020



APPROVED
 Montgomery County
 Historic Preservation Commission

Sandra L. Heiler

Box Elder

REVIEWED
 By Dan.Bruechert at 4:46 pm, Jul 17, 2020

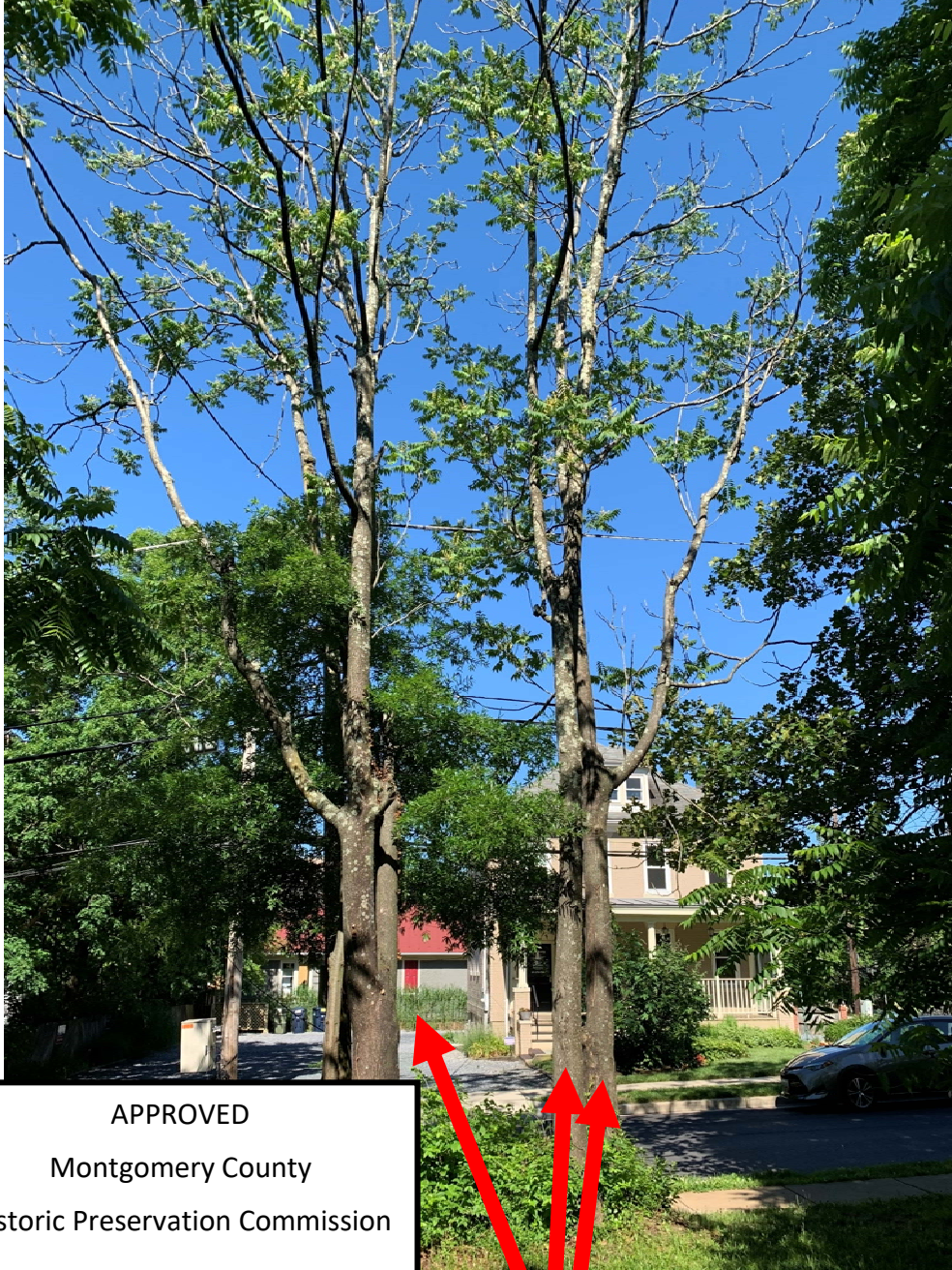

APPROVED
Montgomery County
Historic Preservation Commission

Sandra L. Heiler

Tree of Heaven (3x)

REVIEWED

By Dan.Bruechert at 4:46 pm, Jul 17, 2020

APPROVED
Montgomery County
Historic Preservation Commission

Sandra L. Heiler

REVIEWED

By Dan.Bruechert at 4:46 pm, Jul 17, 2020



Black Walnut (American Elm to the right of the Black Walnut to remain)