



## HISTORIC PRESERVATION COMMISSION

Marc Elrich  
*County Executive*

Robert K. Sutton  
*Chairman*

Date: July 10, 2023

### MEMORANDUM

TO: Rabbiah Sabbakhan, DPS Director Department of  
Permitting Services

FROM: Winnie Cargill  
Historic Preservation Section  
Maryland-National Capital Park & Planning Commission

SUBJECT: Historic Area Work Permit #1032767 - Conforming  
Outbuilding

---

The Montgomery County Historic Preservation Commission (HPC) has reviewed the attached application for a Historic Area Work Permit (HAWP). This application was **Approved** by the HPC Staff.

The HPC staff has reviewed and stamped the attached construction drawings.

THE BUILDING PERMIT FOR THIS PROJECT SHALL BE ISSUED CONDITIONAL UPON ADHERENCE TO THE ABOVE APPROVED HAWP CONDITIONS AND MAY REQUIRE APPROVAL BY DPS OR ANOTHER LOCAL OFFICE BEFORE WORK CAN BEGIN.

Applicant: Pamela Loomis  
Address: 19210 Forest Brook Rd. Gaithersburg

This HAWP approval is subject to the general condition that the applicant will obtain all other applicable Montgomery County or local government agency permits. After the issuance of these permits, the applicant must contact this Historic Preservation Office if any changes to the approved plan are made. Once work is complete the applicant will contact Winnie Cargill at 301.495.2108 or [winnie.cargill@montgomeryplanning.org](mailto:winnie.cargill@montgomeryplanning.org) to schedule a follow-up site visit.





## HISTORIC PRESERVATION COMMISSION

HAWP #: \_\_\_\_\_ at: \_\_\_\_\_

submitted on: \_\_\_\_\_

has been reviewed and determined that the proposal fits into the following category/categories:

Repair or replacement of a masonry foundation with new masonry materials that closely match the original in appearance;

Installation of vents or venting pipes in locations not visible from the public right-of-way;

New gutters and downspouts;

Removal of vinyl, aluminum, asbestos, or other artificial siding when the original siding is to be repaired and/or replaced in kind;

Removal of accessory buildings that are not original to the site or non-historic construction;

Repair or replacement of missing or deteriorated architectural details such as trim or other millwork, stairs or stoops, porch decking or ceilings, columns, railings, balusters, brackets shutters, etc., with new materials that match the old in design, texture, visual characteristics, and, where possible materials, so long as the applicant is able to provide one extant example, photographic evidence, or physical evidence that serves as the basis for the work proposed;

Construction of wooden decks that are at the rear of a structure and are not visible from a public right-of-way;

Roof replacement with -compatible roofing materials, or with architectural shingles replacing 3-Tab asphalt shingles;

Installation of storm windows or doors that are compatible with the historic resource or district;

Repair, replacement or installation of foundation-level doors, windows, window wells, and areaways, or foundation vents, venting pipes, or exterior grills that do not alter the character-defining features and/or the historic character of the resource;

Construction of fences that are compatible with the historic site or district in material, height, location, and design;

Fence is lower than 48" in front of rear wall plane;

Construction of walkways, parking pads, patios, driveways, or other paved areas that are not visible from a public right-of-way and measure no more than 150 square feet in size;

Replacement of existing walkways, parking pads, patios, driveways, or other paved areas with materials that are compatible with the visual character of the historic site and district and that are no greater than the dimensions of the existing hardscape;

Construction of small accessory buildings no larger than 250 square feet in size that are not visible from the public right-of-way;

Installations of skylights on the rear of a structure that will not be visible from the public right-of-way, and would not remove or alter character-defining roof materials;

Installation of solar panels and arrays in locations that are not readily visible from the public right-of-way or that are designed so as to have a minimal impact on the historic resource or the historic district (e.g., systems that are ground-mounted in areas other than the front or side yard of a corner lot, located on accessory or outbuildings, on non-historic additions, or on rear facing roof planes);

Installation of car charging stations in any location on a property or in the right-of-way;

Installation of satellite dishes;

Removal of trees greater than 6" in diameter (d.b.h.) that are dead, dying, or present an immediate hazard.

Removal of trees greater than 6" in diameter (d.b.h.) in the rear of the property that will not impact the overall tree canopy of the surrounding district or historic site;

Replacement tree required as a condition; and,

Other minor alterations that may be required by the Department of Permitting Services post-Commission approval that would have no material effect on the historic character of the property.

Staff finds the proposal complies with Chapter 24A, the Secretary of the Interior's Standards for Rehabilitation, and any additional requisite guidance. Under the authority of COMCOR No. 24A.04.01, this HAWP is approved by Christina Cargill on \_\_\_\_\_. The approval memo and stamped drawings follow.



APPLICATION FOR HISTORIC AREA WORK PERMIT
HISTORIC PRESERVATION COMMISSION
301.563.3400

FOR STAFF ONLY:
HAWP#
DATE ASSIGNED

APPLICANT:

Name:
Address:
Daytime Phone:
E-mail:
City:
Zip:
Tax Account No.:

AGENT/CONTACT (if applicable):

Name:
Address:
Daytime Phone:
E-mail:
City:
Zip:
Contractor Registration No.:

LOCATION OF BUILDING/PREMISE: MIHP # of Historic Property

Is the Property Located within an Historic District? Yes/District Name
No/Individual Site Name

Is there an Historic Preservation/Land Trust/Environmental Easement on the Property? If YES, include a map of the easement, and documentation from the Easement Holder supporting this application.

Are other Planning and/or Hearing Examiner Approvals /Reviews Required as part of this Application? (Conditional Use, Variance, Record Plat, etc.?) If YES, include information on these reviews as supplemental information.

Building Number: Street:

Town/City: Nearest Cross Street:

Lot: Block: Subdivision: Parcel:

TYPE OF WORK PROPOSED: See the checklist on Page 4 to verify that all supporting items for proposed work are submitted with this application. Incomplete Applications will not be accepted for review. Check all that apply:

- Checklist of work types: New Construction, Addition, Demolition, Grading/Excavation, Deck/Porch, Fence, Hardscape/Landscape, Roof, Shed/Garage/Accessory Structure, Solar, Tree removal/planting, Window/Door, Other.

I hereby certify that I have the authority to make the foregoing application, that the application is correct and accurate and that the construction will comply with plans reviewed and approved by all necessary agencies and hereby acknowledge and accept this to be a condition for the issuance of this permit.

Signature of owner or authorized agent

Date

**HAWP APPLICATION: MAILING ADDRESSES FOR NOTIFYING**  
[Owner, Owner's Agent, Adjacent and Confronting Property Owners]

<b>Owner's mailing address</b>	<b>Owner's Agent's mailing address</b>
<b>Adjacent and confronting Property Owners mailing addresses</b>	

Description of Property: Please describe the building and surrounding environment. Include information on significant structures, landscape features, or other significant features of the property:

Description of Work Proposed: Please give an overview of the work to be undertaken:

**REVIEWED**

*By Winnie Cargill at 11:22 am, Jul 10, 2023*



Work Item 1: \_\_\_\_\_

Description of Current Condition:

Proposed Work:

**REVIEWED**  
By Winnie Cargill at 11:22 am, Jul 10, 2023

APPROVED  
Montgomery County  
Historic Preservation Commission  

\_\_\_\_\_

Condition:

Proposed Work:

Work Item 3: \_\_\_\_\_

Description of Current Condition:

Proposed Work:

	Emp #	Date
Field	11 & 25	10-29-98
Comp	11	10-30-98
Graphics	25	10-30-98
Checked	10	11-16-98

Street Address: 19210 Forest Brook Road

Building Permit Number: 9712310063

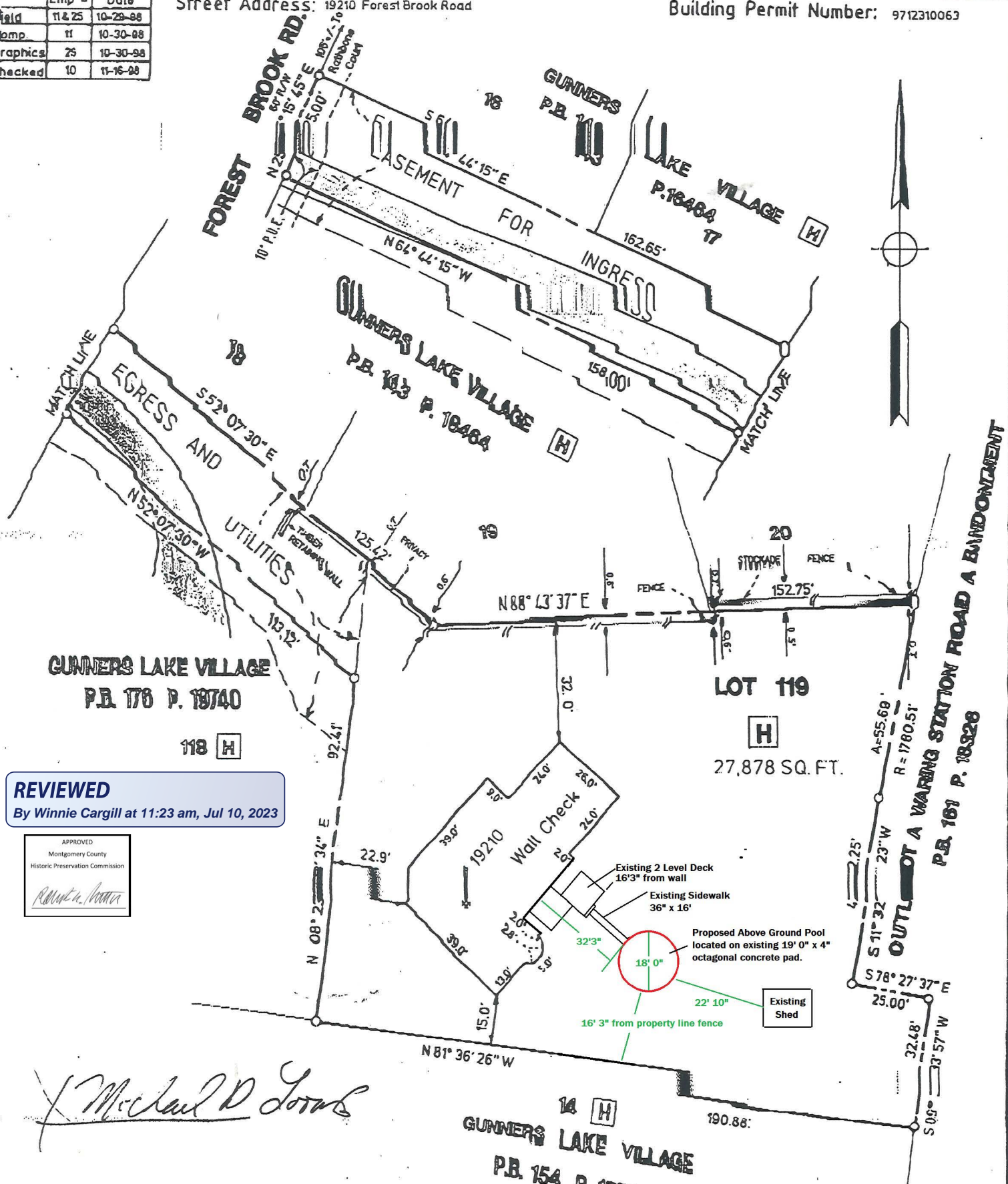

**REVIEWED**  
By Winnie Cargill at 11:23 am, Jul 10, 2023

APPROVED  
Montgomery County  
Historic Preservation Commission  
*Robert A. Vetter*

*Michael D. Lott*

**SURVEYOR'S CERTIFICATE**

This survey has been completed to satisfy requirements of a transfer, a financing or a refinancing of the subject site; it does not reflect a boundary survey to be relied upon for the accurate location of property lines, construction of fences or other improvements.

I hereby certify that the property indicated hereon is shown in

accordance with the Subdivision Plat and/or description of record; that the improvements, as shown, have been located by acceptable survey practices; and that all visible improvements are shown.

10-29-98 (Wall Check)  
Date

*John R. Witmer*  
JOHN R. WITMER  
Professional Land Surveyor  
MD. No. 10668

**W** WITMER ASSOCIATES, LLC

Land Surveying, Land Planning & Design  
354-A Hungerford Drive, Rockville, MD 20850  
Tele: (301) 309-8600 Fax: (301) 309-8603

Tolerance for setback measurements to property lines indicated hereon = 0.25' :

91035 A

**WALL CHECK**  
**LOT 119 BLOCK H**  
**GUNNERS LAKE**  
**VILLAGE**

PLAT BOOK 176 PLAT 19740  
MONTGOMERY COUNTY, MARYLAND  
SCALE: 1" = 40' OCTOBER, 1998



**REVIEWED**  
By Winnie Cargill at 11:24 am, Jul 10, 2023

APPROVED  
Montgomery County  
Historic Preservation Commission  
*Robert H. Nutter*





# Bestway®



## OWNER'S MANUAL

**Para la instrucción en español,  
visite [bestwaycorp.com/support](http://bestwaycorp.com/support)**

Visit Bestway YouTube channel 



## WARNING

smooth out the bottom

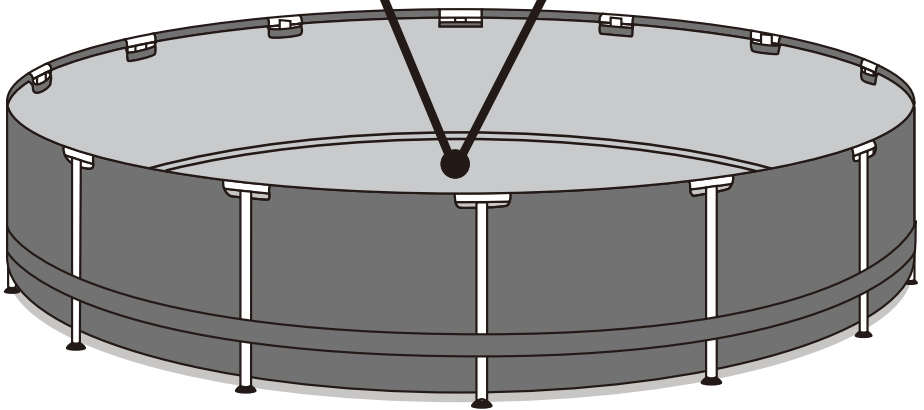
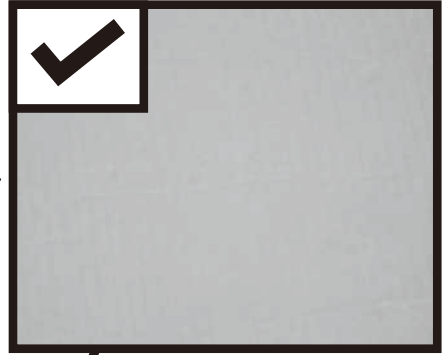

Put 1 in. to 2 in. water in the pool to cover the floor. Once pool floor is slightly covered, gently smooth out all wrinkles. Start in the center of the pool and work your way clockwise to the outside.

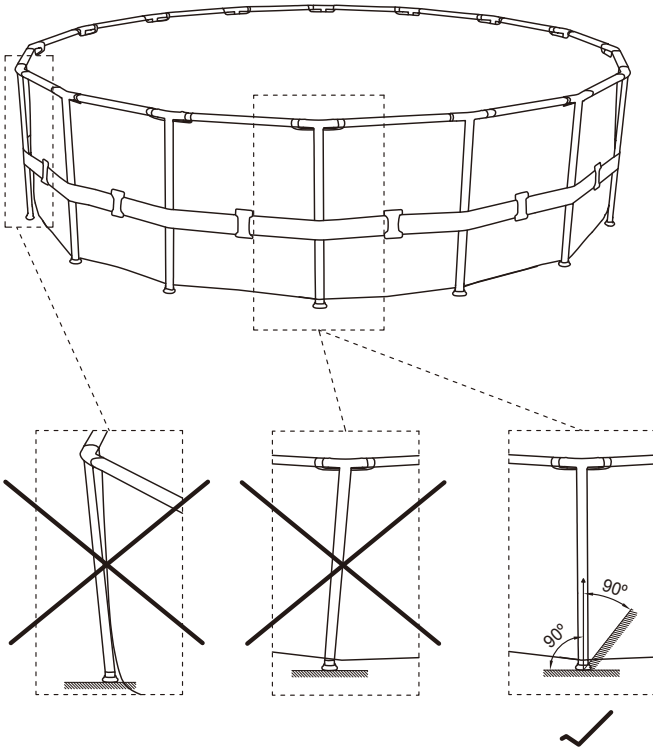

After the installation of the pool's steel frame is completed, ensure that the verticals are perpendicular to the ground. If they aren't, the verticals could be bent or deformed.

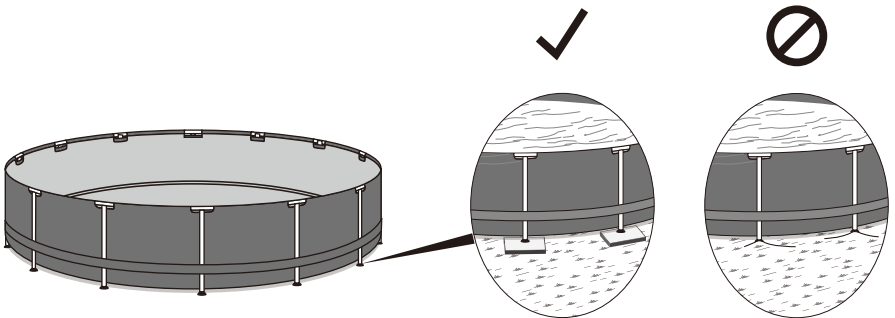

Do not assemble with pool legs on soft lawn. If you must assemble the pool on a soft surface, timber boards (not included) must be placed under the feet of the vertical support rods for even weight distribution.

The timber board must meet two conditions:

- 1). The thickness is less than 1cm.
- 2). The board should not touch the pool liner.

# WARNING

**IMPORTANT SAFETY INSTRUCTIONS**  
**Read and Follow All Safety Information and Instructions. Keep for future reference. Failure to follow these warnings and instructions can result in serious injury or death to users, especially children.**

## ⚠️ WARNING

### Prevent Drowning



Children under 5 are at highest risk for drowning. Closely watch children who are in or near this pool.

## ⚠️ WARNING

### No Diving



You can break your neck and be paralyzed!

## ⚠️ WARNING

### Electrocution Risk



Keep all electrical lines, radios, speakers, and other electrical devices away from pool. Do not place pool near or under overhead electrical lines.

## ⚠️ WARNING

### Stay away from drains & suction fittings



If drain or suction outlet cover is missing or broken, your hair, body, and jewelry can get sucked into drain. You could be held under water & drown! Do not use pool if drain or suction outlet cover is missing or broken.

### Prevent Young Children From Drowning:

Install fencing or approved barrier around all sides of pool. State or local laws or codes may require fencing or other approved barriers. Check state or local laws and codes before setting up pool. Drowning occurs silently and quickly. Assign an adult to supervise pool and wear provided water watcher tag. Keep children in your direct sight when they are in or near pool and when you are filling and emptying pool. When searching for a missing child, check pool first, even if you think your child is in the house. Pool presents a drowning hazard even during filling and draining of the pool. Maintain constant supervision of children and do not remove any safety barriers until the pool is completely empty and stowed away. Refer to the list of barrier recommendations and guidelines as described in CPSC Publication No.362. Assign an adult to be responsible for watching children in the pool. Give this person a "water watcher" tag and ask that they wear it the entire time they are in charge of supervising children in the pool. If they need to leave for any reason, ask this person to pass the "water watcher" tag and the supervision responsibility to another adult. Locate pumps and filters in such a way that children cannot climb on them to gain access to pool. If you have a ladder, refer to the ladder's manual for instructions. If you have a pump, refer to the pump's manual for instructions.

### Prevent Young Children From Gaining Access to Pool:

Remove pool ladders before leaving pool. Toddlers can climb ladder and get into pool. Position furniture away from pool so that children cannot climb and gain access to pool. When leaving pool, remove floats and toys from pool that might attract a child.

### Be Prepared to Respond to an Emergency:

Keep a working phone and list of emergency numbers near pool. Become certified in cardiopulmonary resuscitation (CPR) so you can respond to an emergency.

### Electrocution Risk:

Keep all electrical lines, radios, speakers, and other electrical devices away from pool. Do not place pool near or under overhead electrical lines.

### Suction Risk:

Replacement pump should never exceed the maximum flow rate marked on the suction fitting.

For further safety tips check out the following websites:

[www.homesafetycouncil.org](http://www.homesafetycouncil.org)  
<http://www.safety-council.org/info/child/water.html>  
[www.safekids.org](http://www.safekids.org)  
[www.nspi.org](http://www.nspi.org)

### Safety Barrier Guidelines for Residential Swimming Pool

#### Section I: Outdoor swimming pool

An outdoor swimming pool, including an inground, aboveground, or onground pool, hot tub, or spa, should be provided with a barrier which complies with the following:

1. The top of the barrier should be at least 48 inches above grade measured on the side of the barrier which faces away from the swimming pool. The maximum vertical clearance between grade and the bottom of the barrier should be 4 inches measured on the side of the barrier which faces away from the swimming pool. Where the top of the pool structure is above grade, such as an aboveground pool, the barrier may be at ground level, such as the pool structure, or mounted on top of the pool structure. Where the barrier is mounted on top of the pool structure, the maximum vertical clearance between the top of the pool structure and the bottom of the barrier should be 4 inches.
2. Openings in the barrier should not allow passage of a 4-inch diameter sphere.
3. Solid barriers, which do not have openings, such as a masonry or stone wall, should not contain indentations or protrusions except for normal construction tolerances and tooled masonry joints.
4. Where the barrier is composed of horizontal and vertical members and the distance between the tops of the horizontal members is less than 45 inches, the horizontal members should be located on the swimming pool side of the fence. Spacing between vertical members should not exceed 1-3/4 inches in width. Where there are decorative cutouts, spacing within the cutouts should not exceed 1-3/4 inches in width.
5. Where the barrier is composed of horizontal and vertical members and the distance between the tops of the horizontal members is 45 inches or more, spacing between vertical members should not exceed 4 inches. Where there are decorative cutouts, spacing within the cutouts should not exceed 1-3/4 inches in width.
6. Maximum mesh size for chain link fences should not exceed 1-3/4 inch square unless the fence is provided with slats fastened at the top or the bottom which reduce the openings to no more than 1-3/4 inches.
7. Where the barrier is composed of diagonal members, such as a lattice fence, the maximum opening formed by the diagonal members should be no more than 1-3/4 inches.
8. Access gates to the pool should comply with Section I, Paragraphs 1 through 7, and should be equipped to accommodate a locking device. Pedestrian access gates should open outward, away from the pool, and should be self-closing and have a self-latching device. Gates other than pedestrian access gates should have a self-latching device. Where the release mechanism of the self-latching device is located less than 54 inches from the bottom of the gate, (a) the release mechanism should be located on the pool side of the gate at least 3 inches below the top of the gate and (b) the gate and barrier should have no opening greater than 1/2 inch within 18 inches of the release mechanism.
9. Where a wall of a dwelling serves as part of the barrier, one of the following should apply:
  - (a) All doors with direct access to the pool through that wall should be equipped with an alarm which produces an audible warning when the door and its screen, if present, are opened. The alarm should sound continuously for a minimum of 30 seconds within 7 seconds after the door is opened. Alarms should meet the requirements of UL2017 General-Purpose Signaling Devices and Systems, Section 77. The alarm should have a minimum sound pressure rating of 85 dBA at 10 feet and the sound of the alarm should be distinctive from other household sounds, such as smoke alarms, telephones, and door bells. The alarm should automatically reset under all conditions. The alarm should be equipped with manual means, such as touchpads or switches, to temporarily deactivate the alarm for a single opening of the door from either direction. Such deactivation should last for no more than 15 seconds. The deactivation touchpads or switches should be located at least 54 inches

above the threshold of the door.

(b) The pool should be equipped with a power safety cover which complies with ASTM F1346-91 listed below.

(c) Other means of protection, such as self-closing doors with self-latching devices, are acceptable so long as the degree of protection afforded is not less than the protection afforded by (a) or (b) described above.

10. Where an aboveground pool structure is used as a barrier or where the barrier is mounted on top of the pool structure, and the means of access is a ladder or steps, then (a) the ladder to the pool or steps should be capable of being secured, locked or removed to prevent access, or (b) the ladder or steps should be surrounded by a barrier which meets Section I, Paragraphs 1 through 9. When the ladder or steps are secured, locked, or removed, any opening created should not allow the passage of a 4-inch diameter sphere.

## Section II: Barrier Locations

Barriers should be located so as to prohibit permanent structures, equipment or similar objects from being used to climb the barriers.

 <b>WARNING</b>	
<b>NO DIVING!</b> Shallow water.  You can be permanently injured.	<b>PREVENT DROWNING</b>  Watch children at all times.

Only for outdoor use.

Teach your children to swim.

Never dive, jump, or slide into the pool.

Adult supervision is always required.

Parents should learn CPR.

Never swim alone.

Keep all electrical radios, speakers and other appliances away from the swimming pool.

When you touch the filter, pump, or electrical parts, be sure the ground under your feet is "Bone Dry."

All electrical outlets should have a GFCI and connections should be a minimum of 5 feet (1.52 m) from the outside perimeter of the wall of the pool. From 5–10 feet (1.52–3.05 m), there should be either a fixed connection (outlet box) or twistlock connection with a GFCI.

Connect power cords to a 3-wire grounding-type outlet only.

Keep all breakable objects out of the pool area.

Alcohol consumption and pool activities do not mix. Never allow anyone to swim, dive or slide under the influence of alcohol or drugs.

Severe electrical shock could result if you install your pump or filter on a deck.

The pump or filter could fall into the water, causing severe shock or electrocution. Do not install on a deck or other surface at, above, or slightly below the top rail of the pool.

Do not use the pool during severe weather conditions, i.e. electrical storms, tornadoes, etc.

Be aware of overhead power lines when vacuuming your pool or using a telescoping pole.

Do not allow diving, climbing, sitting, or standing on the top rails of the pools.

Do not allow roughhousing and horseplay.

Do not engage in extended breath holding activities underwater; you may black out and drown.

Install a pool ladder(s) or staircase for entry and exit from the pool.

Keep deck clean and clear of objects that may create a tripping hazard.

Check regularly for signs of wear or loose bolts that could make the deck unsafe.

Instruct pool users about the proper use of all pool ladder(s) and staircases.

Face ladder going up or down.

Allow only one person at a time on the ladder.

Check all nuts and bolts regularly to ensure that the ladder stays sturdy.

Remove or secure the ladder to prevent entry to pool when not in use.

Please contact pool site dealer or manufacturer for additional safety signs if deemed necessary.

For pool service, select a certified pool professional.

Any equipment connected to the circulation systems shall be positioned so as to prevent their being used as a means of access to the pool by young children.

The installation must comply with the codes of the authority having jurisdiction and may require permits for building, plumbing electrical, zoning, etc.

The pool shall be located a minimum distance of 6 ft. (1.83 m) from any electrical

receptacle.

All 125 volt, 15 and 20 ampere receptacles located within 20 ft. (6.0 m) of the pool shall be protected by a ground fault circuit interrupter (GFCI). The 20 ft. (6 m) distance is measured via the shortest straight line distance the supply cord would follow without piercing a floor, wall, ceiling, doorway, window, or other permanent barrier.

Prior to use of the pool, the installer shall affix all no diving signs and safety signs in accordance with installation instructions so they can be easily visible.

A barrier is necessary to provide protection against potential drowning and near drowning and that barriers are not a substitute for the constant supervision of children.

A list of emergency telephone numbers shall be posted, such as the nearest available police, fire, ambulance, and/or rescue unit. These numbers are to be kept near the telephone that is closest to the pool.

Toys, chairs, tables, or similar objects that a young child could climb shall be at least 4 feet (1219 mm) from the pool.

If deck is used by the installer, it will need to comply with APSP-8.

Basic lifesaving equipment, including one of the following, shall be on hand at all times: a. A light, strong, rigid pole (shepherd's crook) not less than 12 ft. (3.66 m) long. b. A minimum ¼ in. (6 mm) diameter rope as long as 1½ times the maximum width of the pool or 50 feet (15.24 m), whichever is less, which has been firmly attached to a Coast Guard-approved ring buoy, or a similarly approved flotation devices.

The swimming pool cover is not designated as a safety barrier.

Please use artificial lighting during nighttime pool use, to illuminate all safety signs, ladders, steps, deck surfaces and walks.

The pool is subject to wear and deterioration. If not maintained properly, certain types of excessive or accelerated deterioration can lead to failure of the pool structure that might release large quantities of water that could cause bodily harm and property damage.

The bottom of the pool shall be visible at all times from the outside perimeter of the pool.

The installer of the vinyl liner shall affix on the original or replacement liner, or on the pool structure, all safety signs in accordance with the manufacturer's instructions.

If you have a filter pump, refer to the pump's manual for instructions.

The ladder shall be located on a solid base and the ladder shall be installed per the ladder's instructions.

Publications are available that describe the risk of drowning, entrapment, and diving accidents. Available publications related to pool safety include the Association of Pool and Spa Professionals' (APSP) booklets entitled: The Sensible Way to Enjoy Your Aboveground/Onground Swimming Pool; Children Aren't Waterproof; Pool and Spa Emergency Procedures for Infants and Children; Layers of Protection, and the latest published edition of ANSI/APSP-8 Model Barrier Code for Residential Swimming Pools, Spas, and Hot Tubs.

For additional safety information, see [www.APSP.org](http://www.APSP.org).

**THIS PRODUCT IS COMPLIANT TO ANSI/APSP 4 AMERICAN NATIONAL STANDARD FOR ABOVEGROUND POOLS / ONGROUND RESIDENTIAL SWIMMING POOLS & INTERNATIONAL SWIMMING POOL & SPA CODE (ISPS)**

(Only for USA & only for pools with a water depth of more than 36in.(914mm))

**NOTE:** If your purchased pool set do not have any circulation system, you can purchase separately. But please make sure the equipment can turn over total volume of pool water no less than once every 12 hr. You can check the water capacity on packaging to select suitable circulation system. Pump provided for the circulation of water shall be tested by a Nationally Recognized Testing Laboratory and certified to conform to UL1081.

Also make sure the selected suction outlet sold with the pump should be tested by a Nationally Recognized Testing Laboratory and certified to conform to ASME/ANSI A112.19.8 or its successor standard ANSI/APSP-16, in order to prevent suction entrapment.

**Please read carefully and keep for future reference**

## CHOOSE THE CORRECT LOCATION

The surface chosen to install the pool must respect the following technical characteristics:

1. Because of the combined weight of the water inside the pool and the pool users, it is extremely important that the surface chosen to install the pool is capable of uniformly supporting the total weight for the entire time the pool is installed. When choosing the surface, take into consideration that water may come out of the pool when in use or in the rain. If the water softens the surface, it may lose its capability to support the pool weight.
2. Check regularly the position of the vertical legs and the U-supports. They must be on the same level as the bottom of the pool at all times. If the vertical leg or the U-support starts to sink into the ground, drain the water

- immediately to avoid the pool collapsing due to the uneven loading on the frame structure. Change the location of the pool or modify the surface material.
- We recommend positioning the pool away from any objects children could use to climb into the pool.
  - Position the pool near an adequate drainage system to deal with overflow or to discharge the pool.
  - The surface must be flat and smooth. If the surface is inclined or uneven, it can create an unbalanced loading on the structure of the pool. This situation can damage the welding point of the liner and bend the frame. In the worst cases, the pool can collapse, causing serious personal injury and/or damage to personal property.
  - The selected surface must be clear of any type of object. Due to the weight of the water, any object under the pool could damage or perforate the bottom of the pool.
  - The selected surface must be clear of aggressive plants and weed species. Those types of strong vegetation could grow through the liner and create water leakage. The grass or other vegetation that may cause odor or slime to develop have to be eliminated from the set-up location.
  - The selected location must not have overhead power lines or trees. Be sure the location does not contain underground utility pipes, lines or cables of any kind.
  - The selected position must be far from house entrance. Do not position any equipment or other furniture around the pool. The water that comes out of the pool during the use or due to a faulty product can damage the furniture inside the house or surrounding the pool.
  - The selected surface must be flat and without holes that can damage the material of the liner.

Follow the important instructions above to choose the correct surface and location to set up your pool. Damaged parts of the pool, due to the fact that the set-up surface and location does not match the instructions, will not be considered as manufacture defect and will avoid the warranty and any service claims.

**Suggested set-up surfaces:** grass, ground, **concrete**, and all other surfaces that respect the above set-up conditions.

**Not suggested surfaces:** mud, sand, gravel, deck, balcony, driveway, platform, soft/loose soil or other surface that does not meet the above set-up conditions.

**NOTE:** Check with your local city council for by-laws relating to fencing, barriers, lighting and safety requirements and ensure you comply with all laws.

**NOTE:** If have a filter pump, refer to the pump's manual for instructions.

**NOTE:** The ladder must match the pool size and should be used only for entering and exiting the pool. It is forbidden to exceed the permitted payload of the ladder. Check regularly if the ladder is properly assembled.

## COMPONENTS LIST

**NOTE:** Some parts already have been installed on the pool.

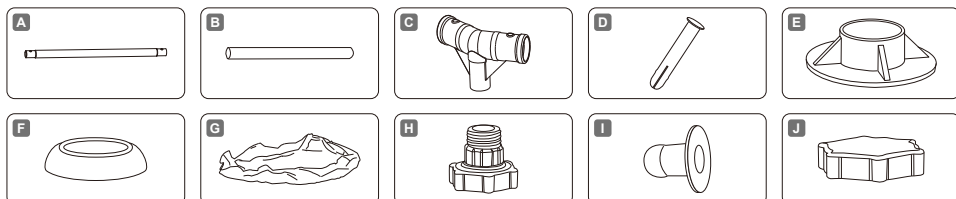

STEEL PRO™	9 ft. x 26 in. (2.74 m x 66 cm)	10 ft. x 26 in. (3.05 m x 66 cm)	10 ft. x 30 in. (3.05 m x 76 cm)	12 ft. x 30 in. (3.66 m x 76 cm)	13 ft. x 33 in. (3.96 m x 84 cm)
	256002001312	256002001254	256002001257	256002001261	256002001425
<b>A</b>	x9	x10	x10	x12	x13
<b>B</b>	x9	x10	x10	x12	x13
<b>C</b>	x9	x10	x10	x12	x13
<b>D</b>	x20	x22	x22	x26	x28
<b>E</b>	x9	x10	x10	x12	x13
<b>F</b>	x20	x22	x22	x26	x28
<b>G</b>	x1	x1	x1	x1	x1
<b>H</b>	x1	x1	x1	x1	x1
<b>I</b>	x3	x3	x3	x3	x3
<b>J</b>	x1	x1	x1	x1	x1

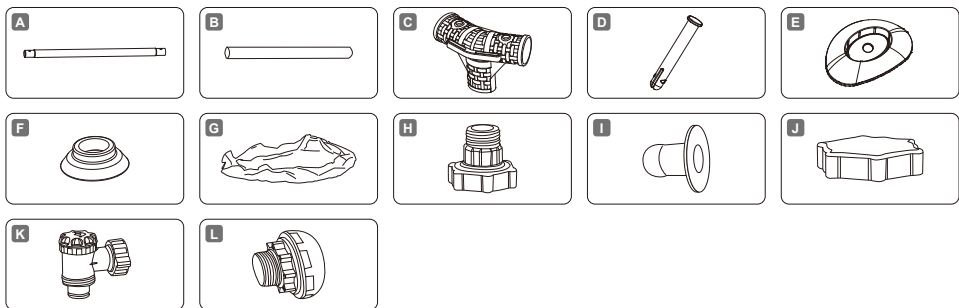

STEEL PRO MAX™	10 ft. x 30 in. (3.05 m x 76 cm)	12 ft. x 30 in. (3.66 m x 76 cm)	12 ft. x 39.5 in. (3.66 m x 1.00 m)	12 ft. x 48 in. (3.66 m x 1.22 m)	13 ft. x 48 in. (3.96 m x 1.22 m)	14 ft. x 33 in. (4.27 m x 84 cm)
	256002001266 256002001267	256002001269	256002001421 256002001433	256002001422	256002001407	256002001427
<b>A</b>	x10	x12	x12	x12	x13	x14
<b>B</b>	x10	x12	x12	x12	x13	x14
<b>C</b>	x10	x12	x12	x12	x13	x14
<b>D</b>	x22	x26	x26	x26	x28	x30
<b>E</b>	x10	x12	x12	x12	x13	x14
<b>F</b>	x22	x26	x26	x26	x28	x30
<b>G</b>	x1	x1	x1	x1	x1	x1
<b>H</b>	x1	x1	x1	x1	x1	x1
<b>I</b>	x3	x3	x3	x3	x3	x3
<b>J</b>	x1	x1	x1	x1	x1	x1
<b>K</b>	x0	x0	x0	x0	x0	x0
<b>L</b>	x0	x0	x0	x0	x0	x0

STEEL PRO MAX™	14 ft. x 42 in. (4.27 m x 1.07 m)	14 ft. x 48 in. (4.27 m x 1.22 m)	15 ft. x 42 in. (4.57 m x 1.07 m)	15 ft. x 48 in. (4.57 m x 1.22 m)	16 ft. x 48 in. (4.88 m x 1.22 m)	18 ft. x 48 in. (5.49 m x 1.22 m)
	256002001429 256002001437	256002001431 256002001445	256002001439	256002001441	256002001289 256002001446	256002001292 256002001415
<b>A</b>	x14	x14	x15	x15	x16	x18
<b>B</b>	x14	x14	x15	x15	x16	x18
<b>C</b>	x14	x14	x15	x15	x16	x18
<b>D</b>	x30	x30	x32	x32	x34	x38
<b>E</b>	x14	x14	x15	x15	x16	x18
<b>F</b>	x30	x30	x32	x32	x34	x38
<b>G</b>	x1	x1	x1	x1	x1	x1
<b>H</b>	x1	x1	x1	x1	x1	x1
<b>I</b>	x3	x3	x3	x3	x2	x2
<b>J</b>	x1	x1	x1	x1	x1	x1
<b>K</b>	x0	x0	x0	x0	x1	x1
<b>L</b>	x0	x0	x0	x0	x1	x1

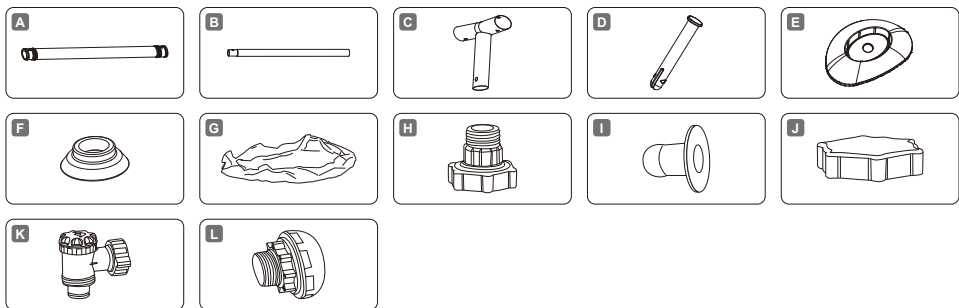

POWER STEEL™	13 ft. x 42 in. (3.96 m x 1.07 m)	16 ft. x 48 in. (4.88 m x 1.22 m)	18 ft. x 48 in. (5.49 m x 1.22 m)
	256002001443	256002001409	256002001411
A	x13	x16	x18
B	x13	x16	x18
C	x13	x16	x18
D	x28	x34	x38
E	x13	x16	x18
F	x28	x34	x38
G	x1	x1	x1
H	x1	x1	x1
I	x3	x2	x2
J	x1	x1	x1
K	x0	x1	x1
L	x0	x1	x1

## INSTALLATION

Installation usually takes approximately 20-30 minutes with 2-3 people excluding earthworks and filling.

Assembly of the Frame Pool can be completed without tools. To lengthen the life of your pool, it is important to sprinkle the top rail with the Talcum Powder before assembly. Talcum Powder is not included and easily available in the market.

Bestway will not be responsible for damage caused to the pool due to mishandling or failure to follow these instructions.

1. Lay out all parts and check that you have the correct quantities as listed in the components list. For assistance or FAQs, please visit the support section on our website, [www.bestwaycorp.com](http://www.bestwaycorp.com).
2. Spread out the pool and make sure the pool is right side up; let it sit exposed to direct sunlight for 1 hour or more so that the pool is more flexible during set up.
3. Place the pool near an adequate drainage system to deal with overflow water and ensure the pool's inlet A and outlet B are correctly positioned to allow your filter pump to connect to a power source.

**NOTE:** Do not use extension power cords to power your pump.

**ATTENTION:** Do not drag the pool on the ground, this can damage the pool.

**NOTE:** Drawings for illustration purpose only. May not reflect actual product. Not to scale.

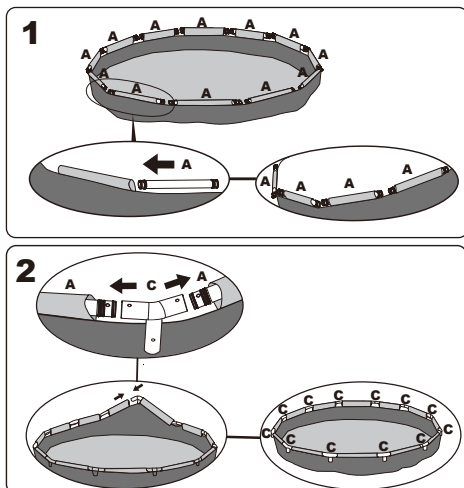



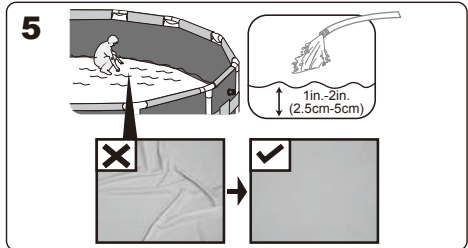
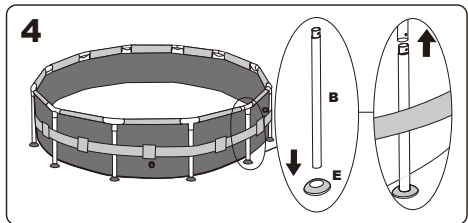
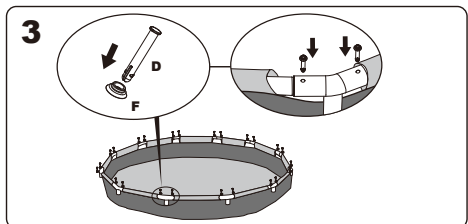

### CONNECTION VALVE ASSEMBLY

For pool with connection valve.

**NOTE:** If you want to connect other pool cleaning kits to the pool through the connection valve, disassemble the Debris Screen from the Connector.

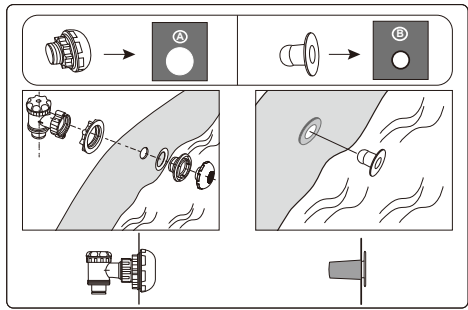

### FILLING POOL WITH WATER

**ATTENTION:** Do not leave pool unattended while filling with water.

1. Fill the pool until the water reaches the welding line located 2.0in.-7.9in. (5cm-20cm) from the top of the pool. **DO NOT OVERFILL** as this could cause the pool to collapse. In times of heavy rainfall you may need to empty some of the water to ensure the level is correct.
2. When filling the pool is completed, check that the water is not collecting on any side to ensure the level is level.

**IMPORTANT:** If pool is not level, drain water and re-level ground by digging out. Never attempt to move the pool with water in it, serious personal injury or damage to the pool may result.

**WARNING:** Your pool may contain a great deal of pressure. If your pool has any bulge or uneven side then the pool is not level, the sides may burst and the water may discharge suddenly causing serious personal

injury and/or damage to property.  
3. Check pool for any leaks at valves or seams, check any evident water loss. Do not add chemicals until this has been done.

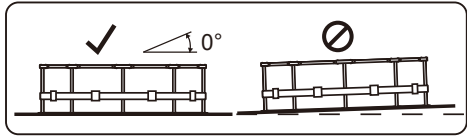
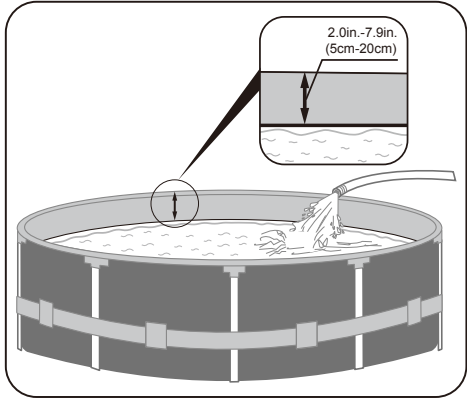

### POOL MAINTENANCE

If you do not adhere to the maintenance guidelines below, your health might be at risk, especially that of your children.

Using chemical tablets (not included):

**NOTE:** Chemconnect or Chemical Floater must be used when you perform chemical maintenance with tablets. Your purchased item may not include any of those dispensers, in this case you can purchase it by visiting our website [www.bestwaycorp.com](http://www.bestwaycorp.com) or at the nearest pool dealer.

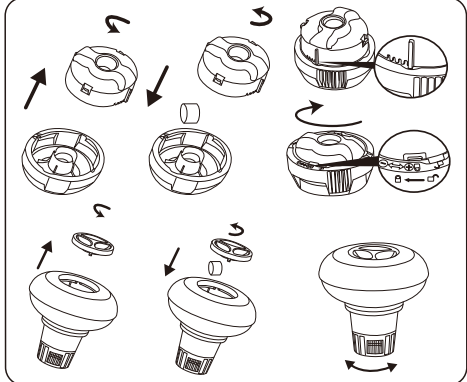

**IMPORTANT:** Don't use granulate tablets or throw the tablet directly in the water. The chemicals can deposit on the bottom, damage the material and discolor the PVC.

Using chemical liquid (not included):

**IMPORTANT:** Add chemical liquid in small doses and in the center of the pool to avoid direct contact between the chemicals and the PVC surface. Direct contact can damage the material and discolor the surface.

**NOTE:** Remove the chemical dispenser from pool when the pool is in use.

**IMPORTANT:** After performing chemical maintenance and before using the pool, use a test kit (not included) to test the water chemistry. We recommend maintaining your water according to the following table.

TEST	IDEAL VALUES
pH value	7.4 – 7.6
Cyanuric acid	30 – 50 ppm
Free chlorine	2 – 4 ppm
Chlorine compound	0
Algae	None visible
Calcium hardness	200 – 400 ppm

**NOTE:** Damage resulting from chemical imbalance is not covered by the warranty. Pool chemicals are potentially toxic and should be handled with care. There are serious health risks from chemical vapors and the incorrect labeling and storage of chemical containers. Please consult your local pool supply retailer for more information about chemical maintenance. Pay close attention to the chemical manufacturer's instructions. Pool damage resulting from misuse of chemicals and mismanagement of pool water is not covered by the warranty.

**IMPORTANT:** Over usage of chemicals can discolor the printing and all points of the pool material. It can also damage the structure of the pool liner.

**To keep your pool clean:**

1. Contact your local pool supply shop for advice and purchase of chemicals and pH kits. One of the most important factors to increase the life of the liner is to keep continuously clean and healthy water. Please strictly follow the instructions from professional technicians for the water treatment through the use of chemicals.
2. Locate a bucket of water next to pool to clean users' feet before entering pool.
3. Cover the pool when not in use.
4. Skim pool regularly to avoid settled dirt.
5. Check and wash the filter cartridge regularly.
6. Gently clean any scum from below the top ring with a clean cloth.
7. Please be careful in case of rain water, kindly check that the water level is not higher than the expected. If so, YOU HAVE TO DISCHARGE THE EXCESS WATER.
8. If it rains, check that the water level is not higher than the specified level. If water exceeds the specified levels, drain the pool to the specified level.

**Proper maintenance can maximize the life of your pool.**

During the season of use of the swimming pool, the filtration system must be necessarily put into service every day, enough time to assure at least a complete renewal of the volume of water.

**NOTE:** The pump is used to circulate the water and to filter small particles. In order to keep your pool water clean and hygienic, you must also

add chemicals.

## REPAIR

In the event of a leak, patch your pool using the underwater adhesive repair patch provided. You can find the instructions in FAQs on the support section of our website, [www.bestwaycorp.com](http://www.bestwaycorp.com).

## DISMANTLING

1. Unscrew the drain valve cap on the outside of the pool counter clockwise and remove.
2. Connect the adaptor to the hose and put the other end of the hose in the area where you are going to drain your pool. (Check local regulations for drainage by-laws).
3. Screw control ring of the hose adaptor clockwise onto the drain valve. The drain valve will be open and water will start to drain automatically.

**ATTENTION:** Water flow can be controlled with the control ring.

4. When draining is finished, unscrew the control ring to close the valve.
5. Disconnect the hose.
6. Screw the cap back onto the drain valve.
7. Air dry pool.

**ATTENTION:** Do not leave the drained pool outside.

## STORAGE

1. Please remove all the accessories and spare parts of the pool and store them clean and dry.
2. Once pool is completely dry, sprinkle with talcum powder to prevent pool from sticking together, fold pool carefully. If pool is not completely dry, mold may result and will damage the pool liner.
3. Store liner and accessories in a dry place with a moderate temperature between 5°C / 41°F and 38°C / 100°F.
4. During the rainy season, pool and accessories should be stored as per above instructions also.
5. Improper draining of the pool might cause serious personal injury and/or damage to personal property.
6. We strongly recommend the pool is disassembled during the off season (winter months). Store in a dry location out of children's reach.

For support please visit us at:  
[bestwaycorp.com/support](http://bestwaycorp.com/support)

**©2021 Bestway Inflatables & Material Corp.**

All rights reserved/Tous droits réservés/Todos los derechos reservados/Alle Rechte vorbehalten/Tutti i diritti riservati

Trademarks used in some countries under license from/

Marques utilisées dans certains pays sous la licence de/

Marcas comerciales utilizadas en algunos países bajo la licencia de/

Die Warenzeichen werden in einigen Ländern verwendet unter Lizenz der/

Marchi utilizzati in alcuni paesi concessi in licenza a

**Bestway Inflatables & Material Corp., Shanghai, China**

Manufactured, distributed and represented in the European Union by/

Fabriqué, distribué et représentés dans l'Union Européenne par/Fabricado, distribuido y representado en la Unión Europea por/

Hergestellt, vertrieben und in der Europäischen Union vertreten von/Prodotto, distribuito e rappresentato nell'Unione Europea da

**Bestway (Europe) S.r.l., Via Resistenza, 5, 20098 San Giuliano Milanese (Milano), Italy**

Distributed in Latin America by/Distribué en Amérique latine par/Distribuido en Latinoamérica por/Distribuido na América Latina por

**Bestway Central & South America Ltda, Salar Ascotan 1282, Parque Enea, Pudahuel, Santiago, Chile**

Distributed in Australia & New Zealand by **Bestway Australia Pty Ltd, Unit 2/98-104 Carnarvon St Silverwater, NSW 2128, Australia**

Tel: Australia: (+61) 29 0371 388; New Zealand: 0800 142 101

Distributed in United Kingdom by **Bestway Corp UK Ltd, 8 Wentworth Road, Heathfield Industrial Estate, Newton Abbot, Devon, TQ12 6TL**

Exported by/Exporté par/Exportado por/Exportiert von/Esportado da

**Bestway (Hong Kong) International Ltd./Bestway Enterprise Company Limited**

**Suite 713, 7/Floor, East Wing, Tsim Sha Tsui Centre, 66 Mody Road, Kowloon, Hong Kong**

Tel: +86 21 69135588 (For U.S. and Canada)

[www.bestwaycorp.com](http://www.bestwaycorp.com)

**Bestway**

# TRANSPORTATION TIPS



Easy to haul  
In a truck or SUV

Box Size: 20.87 in. x 51.18 in. x 20.28 in.



Box requires  
2 adults to lift

Weighs about 178.15 lbs.

# WHAT'S IN THE BOX?



**FILTER PUMP**

110-120V~, 1.8A  
Pump flow rate:  
1,500 GAL. / H (5.7 M<sup>3</sup> / H)  
System flow rate:  
1,050 GAL. / H (4.0 M<sup>3</sup> / H)



**FILTER  
CARTRIDGE**



**LADDER**



**POOL  
COVER**



## CUSTOMER SUPPORT

The Bestway Swimming Pool Set is supported by Bestway's comprehensive customer support services, offering both online support (FAQs, Manuals, Parts, Videos, etc.) as well as live customer service team members to answer your calls and questions.



1 Year Warranty  
on Filter Pumps



90 Day Warranty on  
Liner & Accessories



YOU CAN'T AFFORD NOT  
TO HAVE ONE!™

*Installation Instructions*  
*Water Warden™ Above Ground Pool Fence*



## ***SAFETY REMINDERS:***

### **WARNING:**

**THERE IS NO SUBSTITUTE FOR COMPETENT ADULT SUPERVISION AROUND A SWIMMING POOL. THE WATER WARDEN™ POOL FENCE IS NOT DESIGNED TO BE A SUBSTITUTE FOR ADULT SUPERVISION, NOR IS IT A GUARANTEE AGAINST ACCESS TO THE POOL.**

- Any pool safety product is only effective as a level of protection against unauthorized pool access if used correctly.
- Layers of protection around your pool, such as a fence or wall can reduce unauthorized use if used correctly.
- Pool entrance should always have a self closing and latching gate that is properly maintained.
- Never leave children unattended near pool.
- Check local building codes before installation to be sure you are in compliance with local safety regulations.
- The Water Warden™ Above Ground Pool Fence is designed to meet the ANSI/NSPI – 1996 Model Barrier Code for Above Ground or On Ground swimming pools. The Water Warden™ Above Ground Pool Fence is not intended to be a handrail around the pool and does NOT meet handrail codes.

## ***Installation Instructions*** ***Water Warden™ Above Ground Pool Fence***

### **Before you start:**

Inspect pool for any irregularities which may interfere with location of fence mounting brackets and posts. Locate pool skimmer to ensure that it will not hinder pool fence installation.

### **Necessary tools and materials:**

Electric power drill with Phillips head screwdriver  
Saw  
Measuring Tape  
Pencil  
Adhesive glue, such as “Liquid Nails”

### **Installing the Fence:**

**1. Assemble mounting brackets.** Slide bottom fence support into mounting bracket. Screw 2 #8 screws into each side of the support, attaching it to the mounting bracket. Ensure that support is inserted flush to the back of the mounting base. *See Fig. 1*

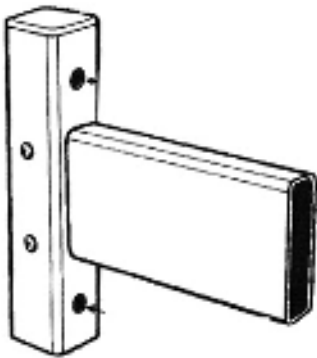

***Fig. 1***

**2. Install mounting brackets.** One mounting bracket should be attached to each of the pool's uprights. Brackets should be attached so that there is a **maximum** of 4" between the pool's top-rail and the bottom rail of the fence. *See Fig 2*

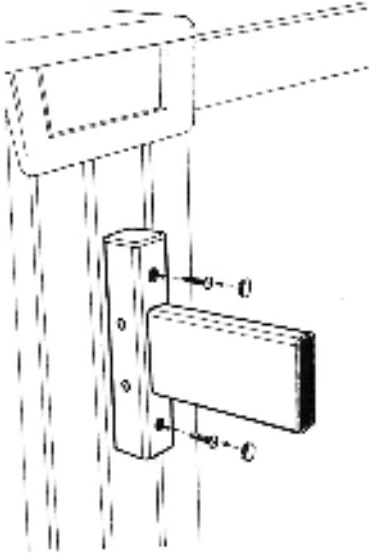

**Fig. 2**

***How to determine bracket spacing:***

Slide one fence post into a mounting bracket but do NOT permanently attach to bracket yet. Place this bracket up against a pool upright. Measure the space between the pool's top-rail and the hole in the bottom rail of the fence. An acceptable gap is anywhere from 1-4". Mark the position of the bracket with a pencil. Remove the fence rail from the bracket and attach mounting bracket to upright using two #12x1 self-tapping screws. Once bracket is attached, measure the gap between the bottom of the pool's top-rail and the top of the bracket. Use this measurement to attach the rest of the brackets in the same way.

***NOTE: It is extremely important to keep the spacing of the brackets consistent on each upright, as this will determine the levelness of the fence.***

**2a. For pools with a deck or A-Frame Ladder:**

Position the ladder right next to one of the pool's uprights. This upright will hold the fence on one side. You will use a 4x4 wooden post on the other side to act as a "substitute upright" in order to hold the fence on the other side of the ladder. Determine the location of the 4x4 post and dig a hole approximately 6" into the ground. Measure the distance from the bottom of the hole to the top of the pool and cut the 4x4 post to fit this size. Place the 4x4 post into the hole flush with the pool wall, tucking the top of the post under the top-rail of the pool. Attach the post to the top-rail by screwing down into the post through the top-rail with a 2" sheet metal screw. Fill in around the base of the 4x4 post with dirt, packing it well to ensure stability. Attach a support bracket to this "substitute upright" as described above in **step 2**. ***See Fig. 3***

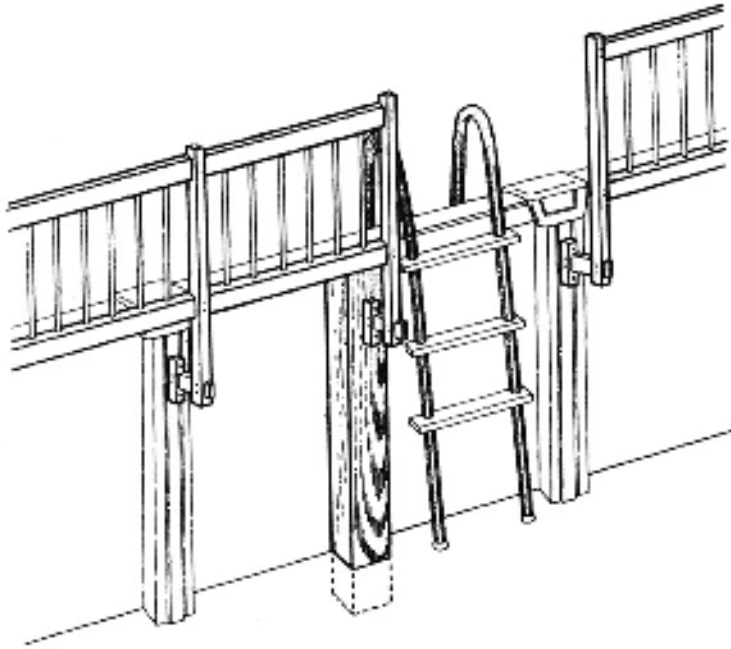
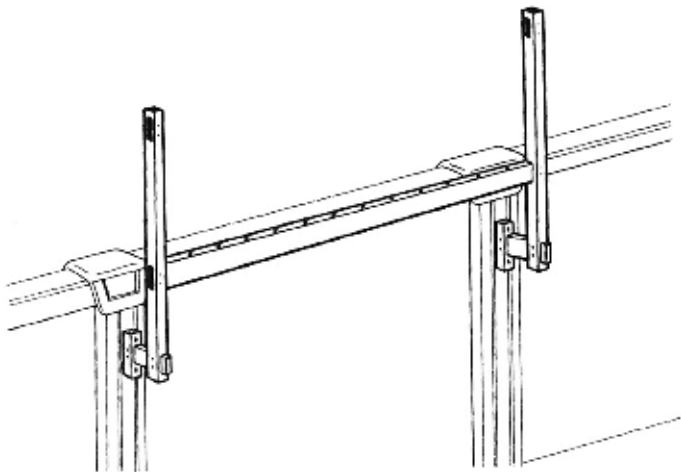

**Fig. 3**

**NOTE:** *Ensure that pool entrance has a self-closing and latching gate.*

### **3. Install Fence Posts.**

The fence end-posts must be installed first. You can identify the end-posts by the pre-cut rail holes. The end-posts have holes on only ONE side. The end-posts should be installed into the brackets where the fence will begin and end. Slide a fence post into the pre-installed mounting brackets. Allow a minimum of ½” between the post and the pool’s top-cap. This space will allow for installation of a winter cover over the pool. Attach the fence post to the bracket support using 4 #8 screws. . Mount the remaining fence posts to the brackets in the same way. Ensure that the spacing between the post and the pool’s top-cap is consistent throughout. *See Fig. 4*



**Fig. 4**



#### 4. Install Fence Bottom-Rail.

Measure the distance between any two fence posts and add 1" to the measurement. Cut bottom rail to this size. Cut off equal amounts from the two ends of the bottom rail to ensure even spacing of the spindle holes. Each side of the bottom rail should extend ½" on each side into the fence post. Measure and repeat **SEPARATELY** for each section of bottom rail, as distance between each pool upright may vary.

*See Fig. 5*

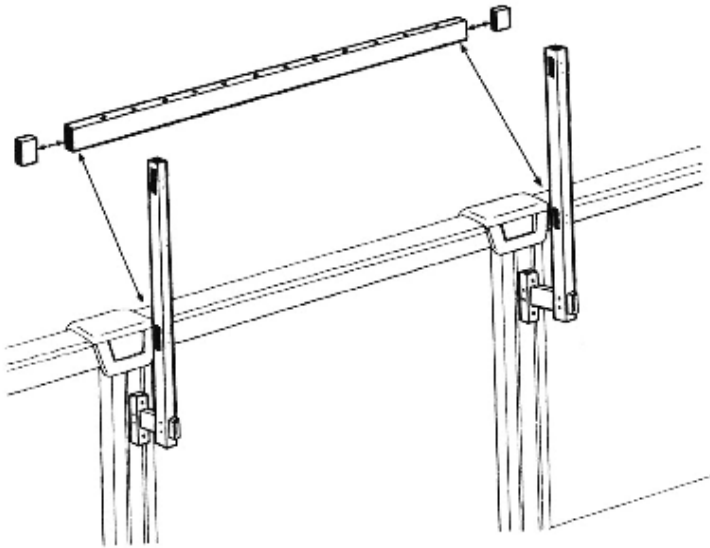

*Fig. 5*

#### 5. Install fence spindles.

Insert one spindle into each spindle hole, all around the bottom rail of the fence. *See Fig. 6*

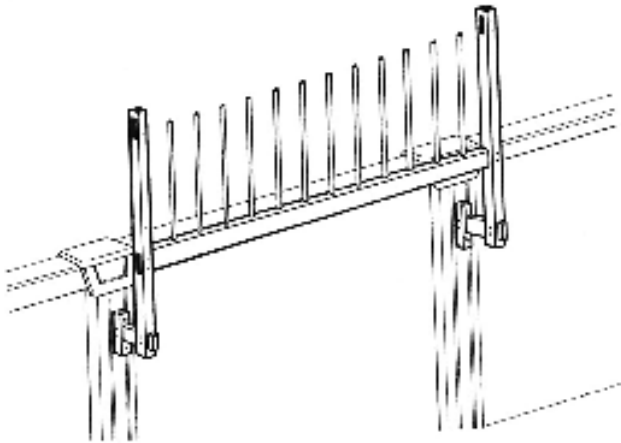

*Fig. 6*

#### 6. Install Fence Top-Rail.

Cut and attach top-rail following the same instructions as for bottom rail, above in **Step 4**. **Make sure to keep top rail spacing even and consistent so that spindles will fit into spindle holes.** *See Fig. 7*

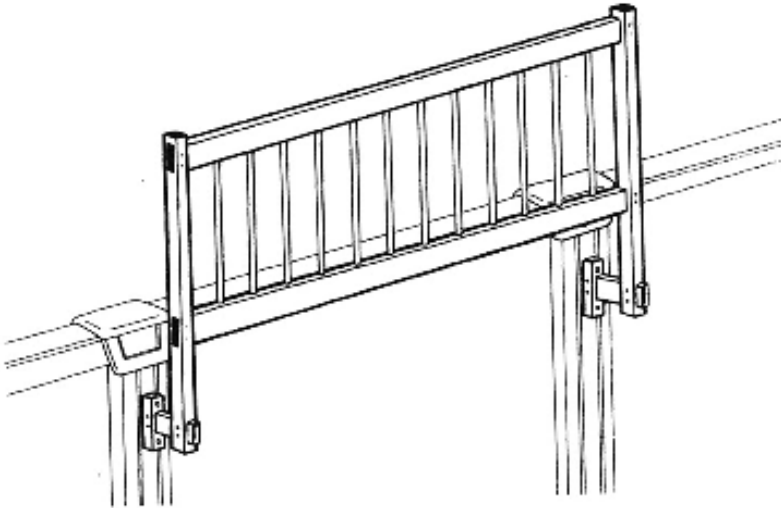

*Fig. 7*

**7. Install Fence End-Caps.**

Insert one white end-cap into the top of each post, at the top of each bracket and at the end of each fence support. Use glue such as “Liquid Nails” if necessary, to hold the top-caps in place. *See Fig. 8*

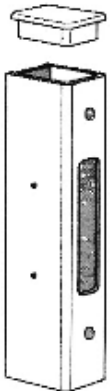

*Fig. 8*

**CHECK STABILITY AND SECURITY OF FENCE BY LIGHTLY TUGGING ON EACH SECTION OF FENCE TO BE SURE ALL SCREWS ARE TIGHTENED AND SECURE.**

## ***SAFETY REMINDERS:***

### **WARNING:**

**THERE IS NO SUBSTITUTE FOR COMPETENT ADULT SUPERVISION AROUND A SWIMMING POOL. THE WATER WARDEN™ POOL FENCE IS NOT DESIGNED TO BE A SUBSTITUTE FOR ADULT SUPERVISION, NOR IS IT A GUARANTEE AGAINST ACCESS TO THE POOL.**

- Any pool safety product is only effective as a level of protection against unauthorized pool access if used correctly.
- Layers of protection around your pool, such as a fence or wall can reduce unauthorized use if used correctly.
- Pool entrance should always have a self closing and latching gate that is properly maintained.
- Never leave children unattended near pool.
- Check local building codes before installation to be sure you are in compliance with local safety regulations.
- The Water Warden™ Above Ground Pool Fence is designed to meet the ANSI/NSPI – 1996 Model Barrier Code for Above Ground or On Ground swimming pools. The Water Warden™ Above Ground Pool Fence is not intended to be a handrail around the pool and does NOT meet handrail codes.

To activate 5 year limited warranty, register within 10 days of purchase at  
[www.thewaterwarden.com](http://www.thewaterwarden.com)  
or return completed warranty form on back page to:

Water Warden™ Pool Safety Products  
4837 NE 12<sup>th</sup> Ave  
Oakland Park, FL 33334

## **Water Warden™ Pool Fence Five Year Limited Warranty/One Year Full**

1. The Manufacturer warrants that the Water Warden™ Pool Fence is free from defects in workmanship and materials for a period of five (5) years.
2. This warranty extends to the original purchaser of the Water Warden™ Pool Fence only.
3. This warranty covers materials and workmanship but does not cover incidental or consequential damages, metal finishes or installation of the Water Warden™ Pool Fence. Installation is warranted by the installer only, and only to the extent of express warranties provided by the installer.
4. In the event of a defect or other failure of the Water Warden™ Pool Fence not caused by any misuse, abuse, neglect, improper maintenance or damage to the Water Warden™ Pool Fence while in possession of consumer, manufacturer will remedy the failure or defect, without charge to the consumer. The remedy will consist of repair or replacement of the product, at the warrantor's option.
5. If manufacturer is unable to provide replacement or repair, a refund will apply as follows: manufacturer will refund what is unserviceable during the first year; after the first year the Water Warden™ Pool Fence will be refunded at a rate of 1/84 of MSRP for each month remaining of the 84 months from the original purchase date.
6. If the Water Warden™ Pool Fence is reported to be unserviceable, the Water Warden™ Pool Fence must be made available to manufacturer's representative to determine its serviceability.
7. We reserve the right to inspect the Water Warden™ Pool Fence for any claim against this warranty, to determine the cause of failure or loss of serviceability.

CUSTOMER HAS THE SOLE RESPONSIBILITY FOR PERIODICALLY INSPECTING PRODUCT AND REPORTING DEFECTS OR FAILURES. THIS WARRANTY SHALL NOT APPLY TO ANY ITEM WHICH HAS BEEN IMPROPERLY ASSEMBLED, INSTALLED, USED, STORED, OR MAINTAINED. THIS WARRANTY SHALL NOT APPLY TO ANY ITEM WHICH HAS BEEN REPAIRED OR SERVICED BY ANY OTHER THAN A CERTIFIED REPRESENTATIVE OF THE MANUFACTURER. THIS WARRANTY SHALL NOT APPLY TO ANY ITEM WHICH HAS BEEN SUBJECTED TO EXTERNAL SOURCES OF HEAT SUCH AS, BUT NOT LIMITED TO, POOL HEATERS, COOKING DEVICES OR OPEN FLAMES. THIS WARRANTY SHALL NOT APPLY TO ANY ITEM THAT HAS BEEN SUBJECTED TO MISUSE, ACCIDENTS OR ACTS OF GOD. MANUFACTURER DOES NOT WANT TO CREATE A FALSE SENSE OF SECURITY. THE WATER WARDEN™ POOL FENCE IS NOT INTENDED TO BE A SUBSTITUTE FOR PROPER ADULT SUPERVISION NOT IS IT A GUARANTEE AGAINST ACCESS TO THE POOL.

**WARNING!**  
**THERE IS NO SUBSTITUTE FOR  
COMPETENT ADULT SUPERVISION  
IN A SWIMMING POOL  
ENVIRONMENT! NO POOL SAFETY  
PRODUCT IS A GUARANTEE  
AGAINST UNAUTHORIZED ACCESS  
TO A POOL.**

To file a claim:  
Please call 1-877-402-SAFE (7233)  
Monday – Friday  
8:00 AM – 4:30 PM Eastern Time  
Please allow 2-4 weeks for  
warranty claims to be processed.

**Water Warden™ Above Ground Pool Fence  
Five Year Limited Warranty/One Year Full**

Register your warranty at [www.thewaterwarden.com](http://www.thewaterwarden.com) or return this  
completed warranty registration and copy of purchase receipt, within ten days of purchase to:

**Water Warden™ Pool Safety Products  
4837 NE 12<sup>th</sup> Ave,  
Oakland Park FL 33334**

Purchaser's Name: (please print) \_\_\_\_\_ Purchase Date: \_\_\_\_\_  
Address: \_\_\_\_\_  
Phone Number: \_\_\_\_\_ Size of Pool: \_\_\_\_\_  
Dealer's Name: \_\_\_\_\_  
Dealer's Address: \_\_\_\_\_  
Dealer's Phone Number: \_\_\_\_\_ Dealer's Email: \_\_\_\_\_  
Purchaser's Signature: \_\_\_\_\_

# 18' x 48" Bestway Above Ground Pool

## Top View

**REVIEWED**

By Winnie Cargill at 11:23 am, Jul 10, 2023

APPROVED  
Montgomery County  
Historic Preservation Commission

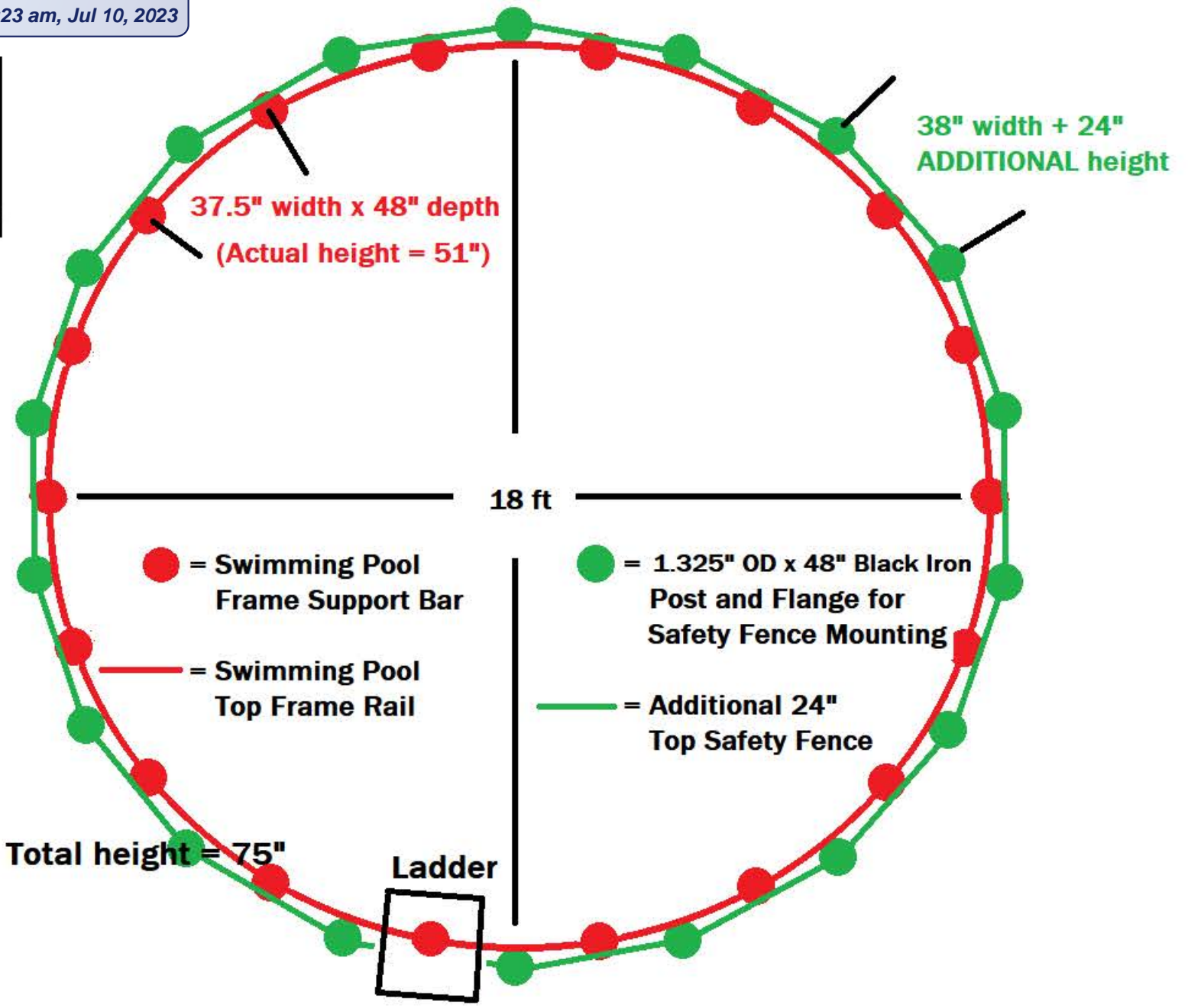
Aqua Select Above Ground  
Swimming Pool Safety Fence

## Side View

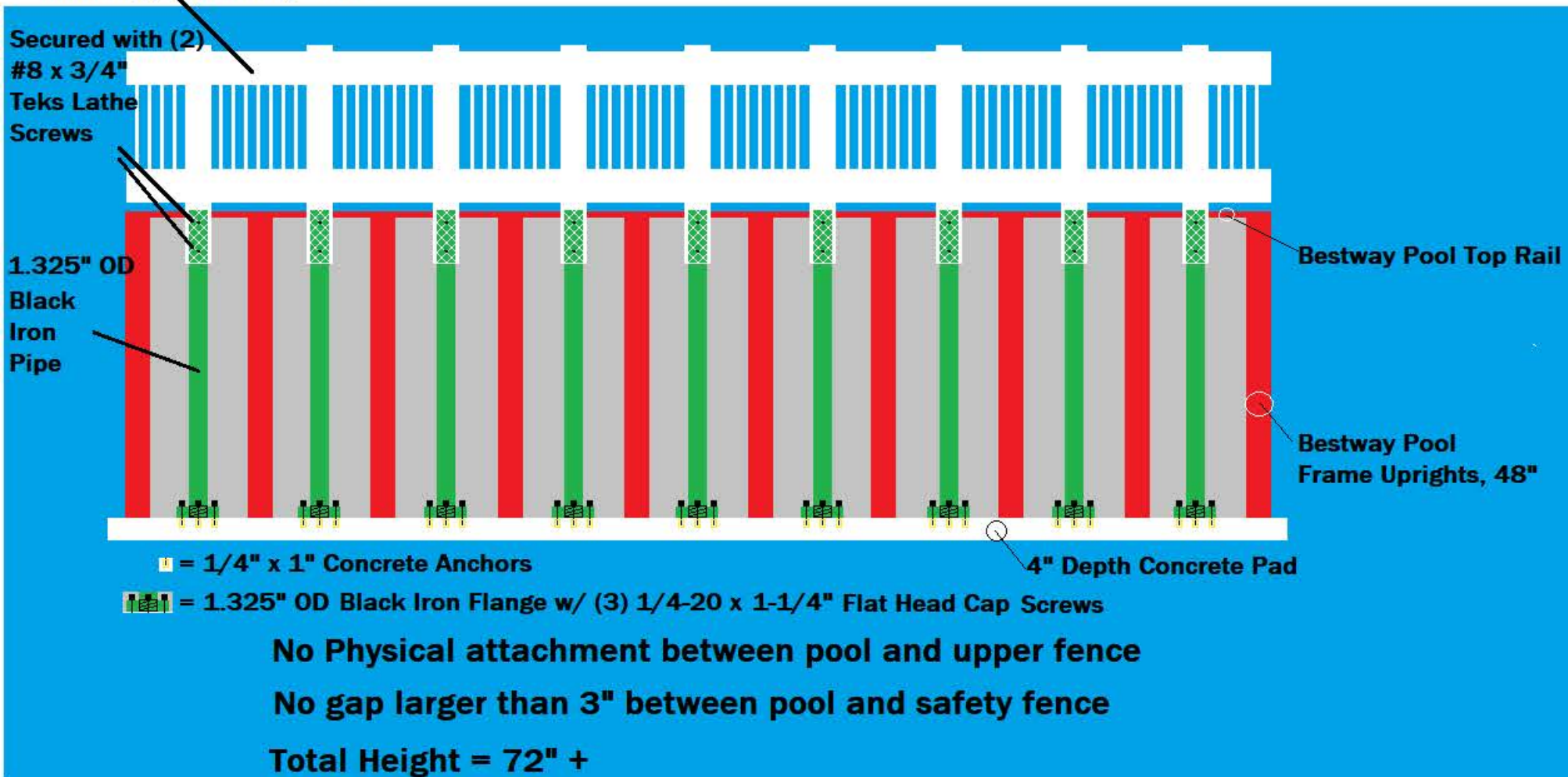

Actual fence will be assembled in accordance with manufacturers instructions except:  
**Mounting system will be upgraded from a plastic attachment screwed to the side of the pool upright to (18) 1.325" OD Black Iron pipe each mounted with a STEEL FLANGE and (3) 1/4" x 1" concrete anchors, secured with 1/4"-20 x 1-1/4" stainless steel screws fastened into an existing 19ft diameter, 4" depth concrete pad, around the complete circumference of the pool.**

**There will be no gaps between the safety fence and swimming pool greater than 3" in any location.**

**This will mount the safety fence much stronger than the manufacturers original method and exceed current code requirements for fence height (60" required, 72"+ upon completion).**

# MODEL# SLA001-3 "SLIDE & LOCK" A-FRAME POOL LADDER



**IMPORTANT INSTRUCTIONS:** Read all instructions carefully & completely to become familiar with parts, assembly, safety and proper use of this product. Failure to follow these instructions may result in serious personal injury. **SWIM RESPONSIBLY & SAFELY!**

**TOOLS REQUIRED:** 7/16" socket, nut driver & wrench, measuring tape, Phillips (star) screwdriver, 1/8" + 1/4" drill bits & drill, pencil or marker, a level and a PAD LOCK

### SAFETY INSTRUCTIONS & PROPER USE - ASSEMBLY & INSTALLATION

- This above-ground pool ladder has a 300 lb load capacity - one person - when properly installed
- This pool ladder is designed & intended for use with an above ground pool only - flat bottom pool
- Your above ground pool has shallow water - absolutely **NO DIVING** or **NO JUMPING** into the pool
- This product conforms to the latest revisions of the ANSI/APSP recommended standards for above ground / on ground swimming pool ladders
- For entry & exit of the pool, face ladder at all times. Utilize handrails for safe climbing
- This pool ladder is designed for use by only one person at all times
- This ladder is designed with a "Slide & Lock" exterior ladder section; a safety feature to assist in preventing access to the swimming pool. When pool is not in use, make certain exterior section is locked securely (**Lock not included**)
- Locate ladder on a solid base and free from high traffic areas around the pool. Use of a ladder pad is highly recommended
- Secure ladder to top rail of pool for greater stability and safety as outlined in this assembly manual
- Keep top platform and treads free from obstructions to avoid possible injury. Do not secure any items to the ladder. Such objects (eg. thermometers, play toys, ropes) may create a potential for tripping or entrapment
- **NEVER ALLOW CHILDREN TO SWIM UNATTENDED** - Nothing replaces parental supervision
- **Assemble & install this a-frame pool ladder as per the manufacturer's instructions. Do not deviate from these instructions**

### PARTS INCLUDED



Ladder Section (2)



Handrails (2 each)



Support Legs (2 each)



Top Platform (1)

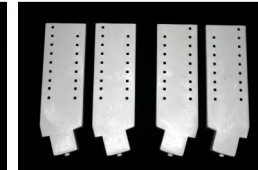

Adjustable Base Supports (2 each)



Base Treads (2)

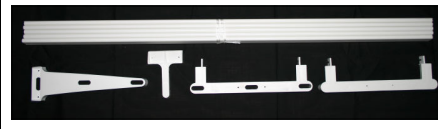

Anti-Entrapment Barrier Parts  
(1 part BA, BB, BC & BD + 5 pickets)



3" Bolt



2-1/2" Carriage Bolt



3/4" Carriage Bolt



3/4" Screw



1/2" Barrier Screw



Washer



Nut

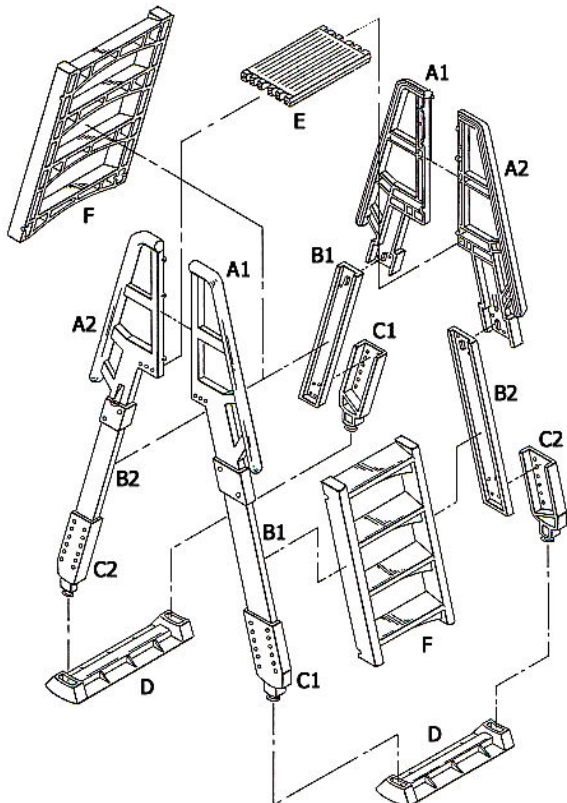

### Hardware Measurement Guide

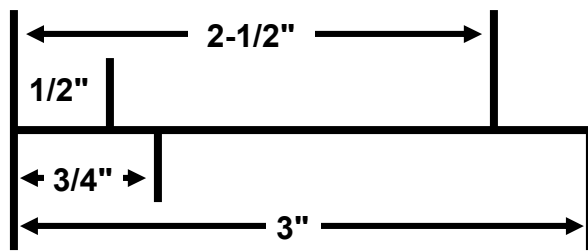

**MAKE CERTAIN TO READ ALL INSTRUCTIONS CAREFULLY & IDENTIFY ALL PARTS BEFORE STARTING THE ASSEMBLY & INSTALLATION OF THIS POOL LADDER. FOR WARRANTY INFORMATION PLEASE VISIT OUR WEBSITE. REVIEW SAFETY INSTRUCTIONS BEFORE USE.**

**NOTHING REPLACES PARENTAL SUPERVISION**  
**SWIM SAFELY & NEVER SWIM ALONE**



877-VINYL WK



www.vinylworkscanada.com

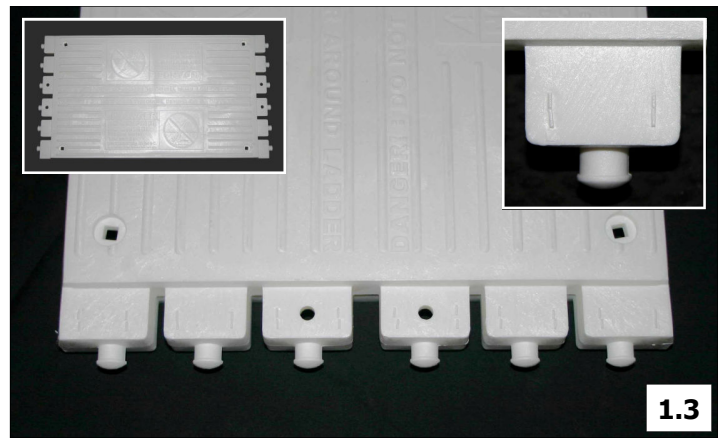
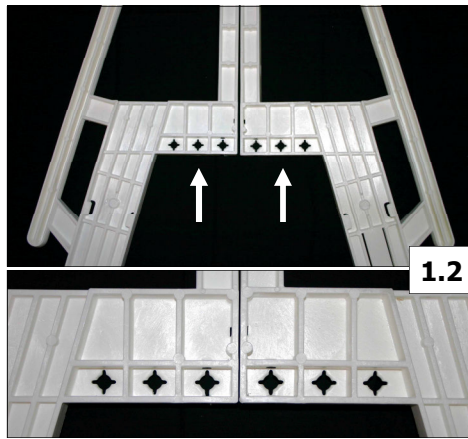
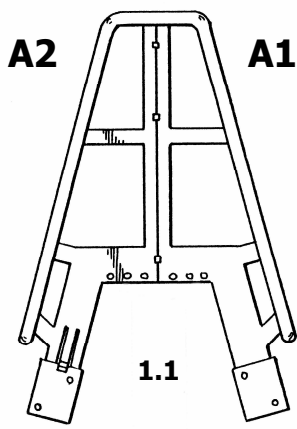

1. Position A1 & A2 handrail sets together as shown (1.1). Each handrail has holes to accept the top platform (1.2). The ends of the platform are designed to fit within these holes and snap & lock into place (1.3). Fit the platform, with anti-skid surface and warning labels facing upward, into the handrails (1.4). Gently tap outside of handrails so the button-lock tabs protrude through and secure platform in place. Make certain tabs lock securely (1.5). Repeat for both sets of handrails.

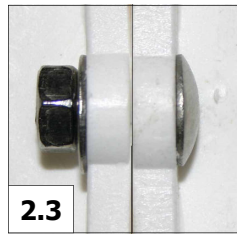
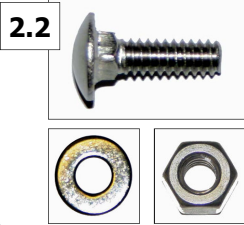
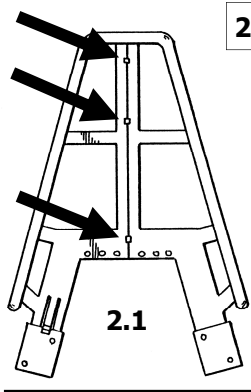

2. With top platform snapped into handrail sets, secure A1 & A2 handrails together. Use a 3/4" carriage bolt with washer & nut at each of the three positions shown (2.1-2.2). The hardware fits on the inside face of the handrails. Tighten hardware with an open end wrench (2.3). Repeat for both handrail sets.

3. Measure both the inside depth and outside height of the pool to determine the height adjustment of the ladder (Detail 3.1). Measure at the point you plan to position the ladder as the measurements may vary

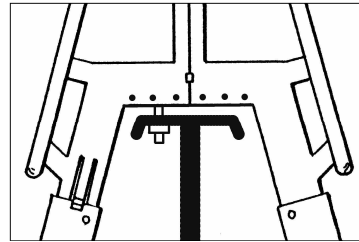

around the pool. Make certain to choose a location that has a solid base and is free from high traffic. Be advised: when the ladder is installed in the pool, the top platform of the ladder should be just above the top rail of the pool so the ladder itself, not the top rail of the pool, supports the weight load on the ladder (see 3.2). Thus, add approximately 1 inch to your measurements inside and outside of the pool. Double check your measurements and record them for use later in this assembly. **Measure accurately.**

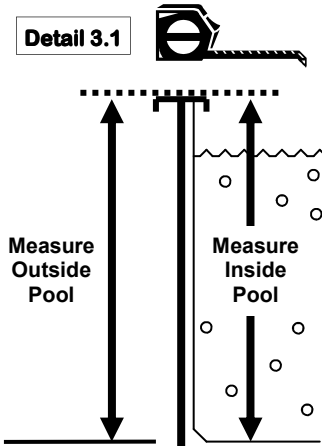
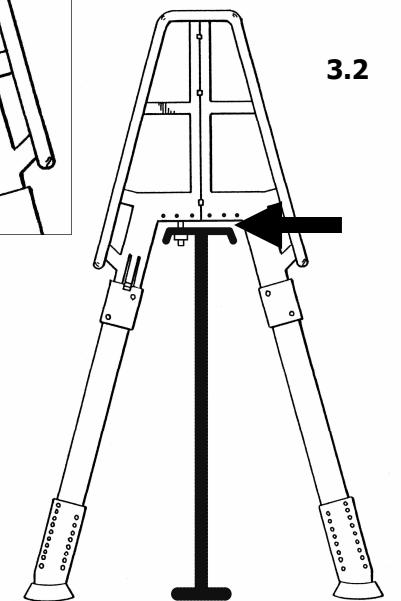

4. Understand the height adjustment. Note that the support legs B1 & B2 have measurement guides (markings) stamped in each part (4.1). Use these to set the height of the ladder both inside & outside the pool. The adjustable foot supports C1 & C2 fit over the support legs B1 & B2 respectively and align at the marking for the appropriate height required (see 4.2).

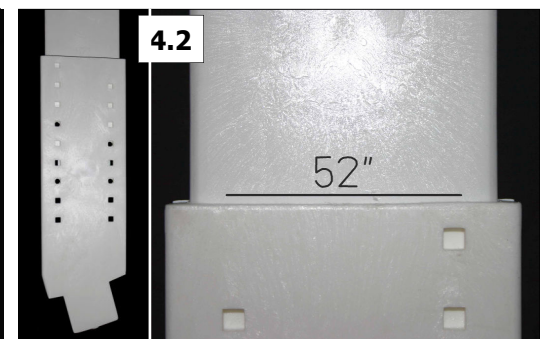
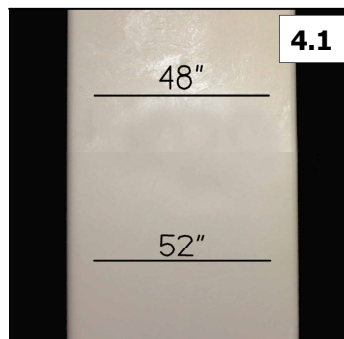





5. Lay the assembled handrails and platform on edge (5.1). Start with the top support leg positions (5.1). Identify the raised ribs on the B1 & B2 support legs (5.2). The ribs on the B1 & B2 support legs fit into a channel in the A1 & A2 handrails (5.3). Fit the B1 & B2 into the A1 & A2 handrails respectively (A1 + B1 & A2 + B2 - see 5.4 & 5.5). The bolt holes will align when the support legs are fitted into the handrails properly. Secure both “top” support legs using two 3/4 carriage bolts with washers & nuts on the inside face.

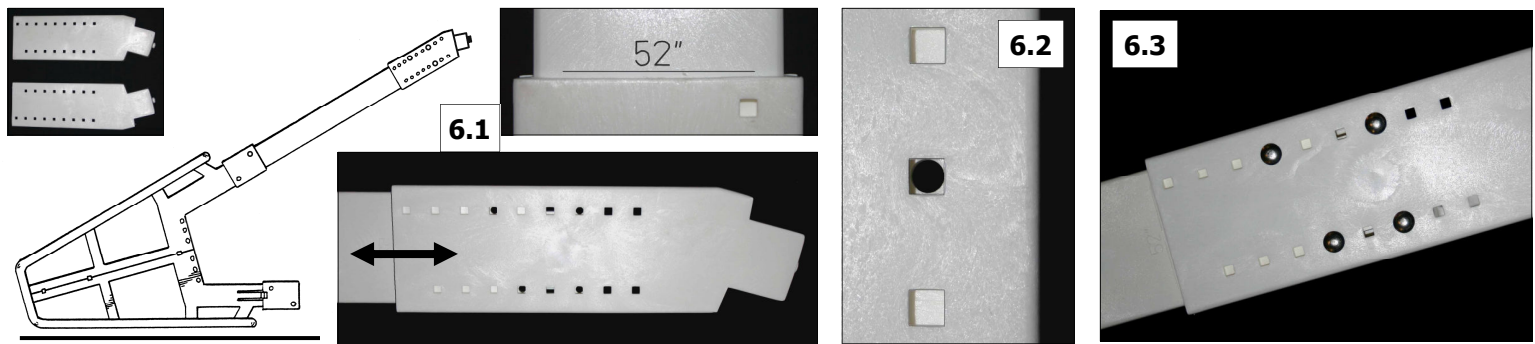
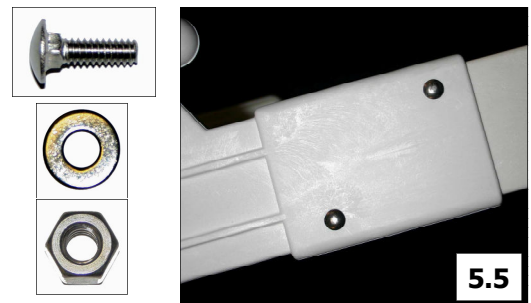

6. **NOTE:** This side of ladder will be adjusted for OUTSIDE of the pool. The adjustable base supports (C1 & C2) fit over the support legs (B1 & B2) at the bottom. Snap the adjustable base supports over the bottom of the support legs and slide them up / down to the outside measurement using the measurement guide markings (6.1). Don't forget to add approximately 1 inch for clearance above the pool (from step 3). Align square bolt holes in base supports with round bolt holes in support legs (6.2). Make certain the measurement settings of the two support legs match, the two that are assembled currently. Secure both adjustable base supports using four 3/4 carriage bolts with washers & nuts on the inside face (6.3).

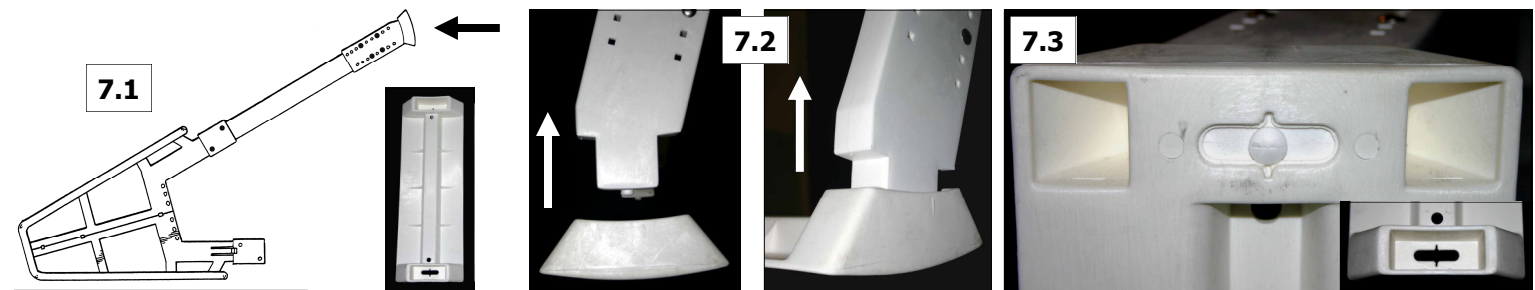

7. With the sub-assembled ladder on edge (7.1), fit a base tread D onto the C1 & C2 adjustable base supports (7.2). The base tread has a pocket at both ends that fits over the C1 & C2 base supports. The C1 & C2 base supports have a locking tab on the ends; press the base tread onto the base supports until the button-lock tab snaps through the bottom channels of the base tread (see 7.3). Position the locking tab in the center of the channel and snap firmly in place (7.4).

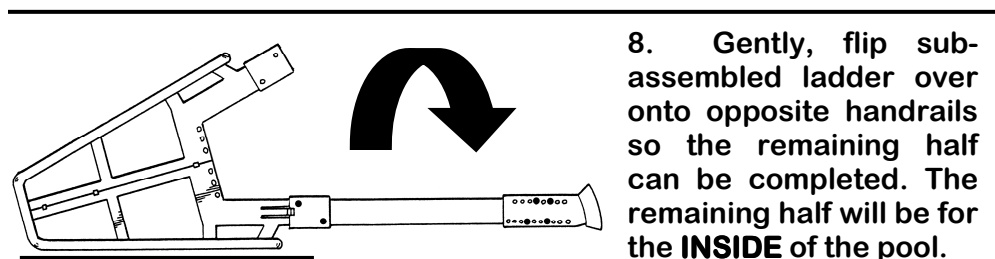

8. Gently, flip sub-assembled ladder over onto opposite handrails so the remaining half can be completed. The remaining half will be for the INSIDE of the pool.



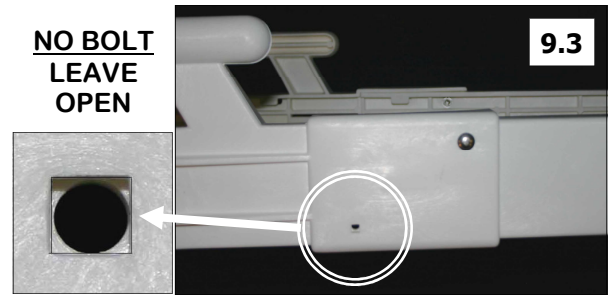
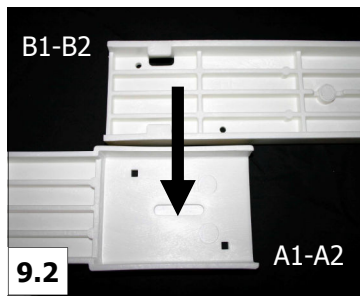
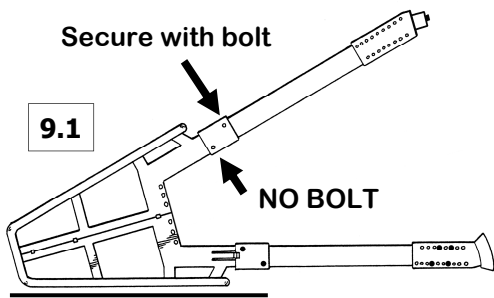

9. Similar to step 5 previously; fit two remaining support legs B1 & B2 into the A1 & A2 handrails respectively (A1+B1 & A2+B2 - see step 5 & 9.2). Secure connecting parts at **ONLY** one bolt location (see 9.1 & 9.3). The open bolt hole in parts A1-B1 & A2-B2 will be addressed in step 13 to follow. Secure with single 3/4 carriage bolt with washers & nuts on the inside face of each support leg / handrail set.

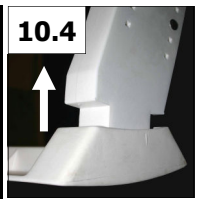
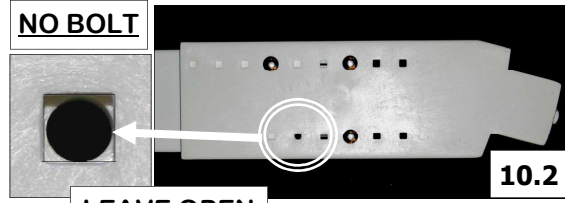
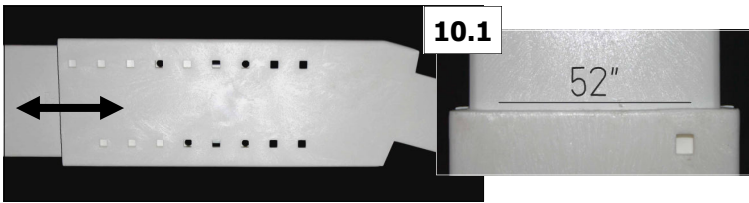

10. **NOTE:** This side of the ladder will be adjusted for the **INSIDE** of the pool. Similar to step 6; fit two remaining adjustable base supports (C1 & C2) over support legs (B1 & B2). Adjust the base supports to the **inside** measurement using the measurement guide markings (10.1). Make certain to add the 1 inch for pool clearance. Adjust both inside support legs the same. Align bolt holes & secure each base support at **ONLY** three locations (10.2 & 10.3), leaving indicated bolt hole open until step 13. Similar to step 7, fit remaining base tread D (10.4).

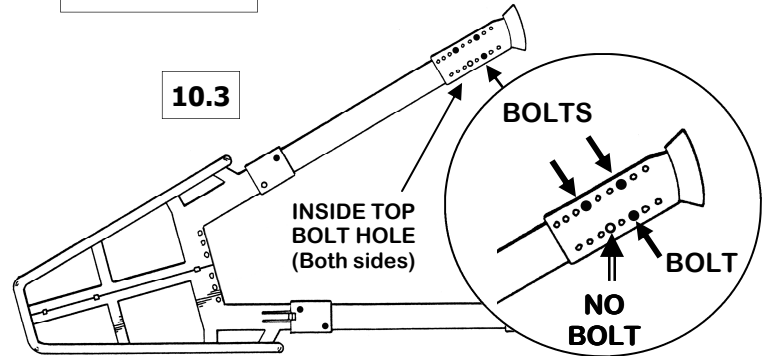

11. Stand ladder in upright position on a flat surface. Base treads are pivotal; they can be adjusted back & forth so ladder is stable. Adjust both treads appropriately (11.1). Using a 1/8 drill bit, drill a pilot hole through both ends of base tread & base support (11.2). Secure using 3/4 screw provided (11.3). Repeat for both base treads

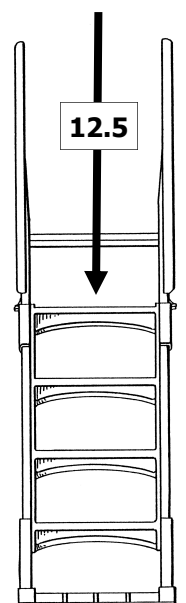
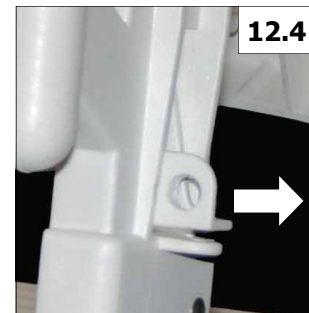
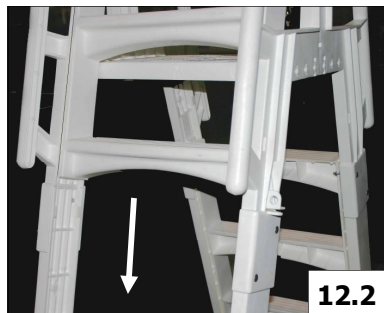
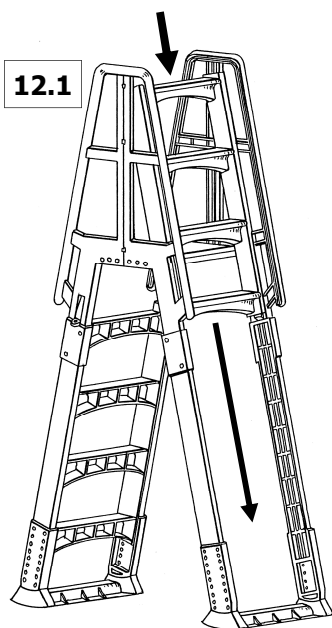
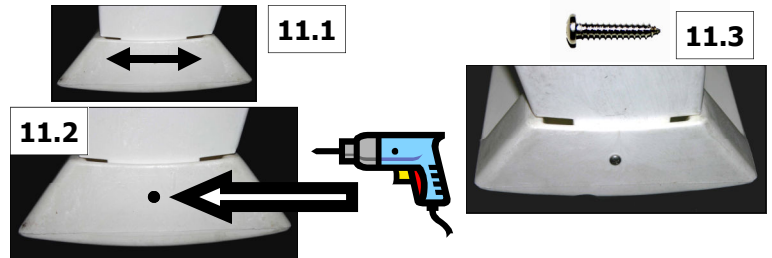

12. For both inside (in-pool) & outside (exterior) portions of ladder, fit ladder sections F into assembled frame. Slide ladder sections down the channels of the handrails and support legs, left and right, from top to bottom (12.1 & 12.2). The ladder section will only slide down as far as the catch of the locking mechanism (12.3). Using the finger hole on the outside of the locking mechanism (A2 handrail - right side) pull the locking mechanism out allowing the ladder section to continue to slide down (12.4). Gently fit & slide ladder sections down to bottom on both sides of the ladder (12.5).



**13. VERY IMPORTANT - SECURE IN-POOL LADDER SECTION.** The inside / in-pool ladder section F must be secured in place for greater strength & stability. The inside ladder section **MUST NOT** be allowed to slide up. Identify the inside / in-pool side of your ladder with the “missing” hardware connection points from steps 9 & 10. Make certain ladder section F is all the way to the bottom. At the four bolt locations identified in 13.1 (left from step 9 & 10 - see 13.4 & 13.5), pass a 2-1/2 carriage bolt through the open bolt hole, from the outside in, and secure using a washer and nut (13.7). The bolts will pass through an open slot in the ladder section at all four corners (see 13.2, 13.3 & 13.6), two at the top of the ladder section and two at the bottom. Tighten all four bolts equally to slightly beyond snug - as you tighten, you will see the washer and nut pull the ladder section tight to the support frame. Do not over-tighten.

**14. VERY IMPORTANT - COMPLETE ASSEMBLY AND INSTALLATION OF ANTI-ENTRAPMENT LADDER BARRIER ON REVERSE OF THIS PAGE BEFORE INSTALLING LADDER INTO THE POOL.** The barrier is included with this ladder to prevent children from swimming through or behind pool ladder. Failure to complete assembly & installation may result in serious personal injury or drowning.

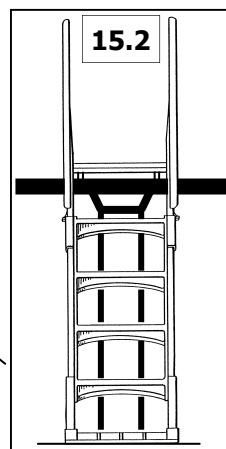
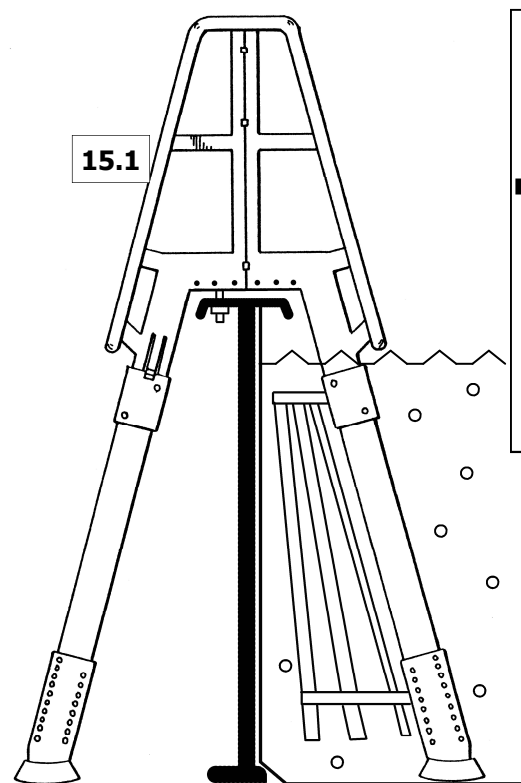

**15.** Position ladder in the pool at desired location (15.1) making certain the anti-entrapment barrier is away from the pool liner. Position ladder above an upright support post of pool for greater stability (15.2). You **MUST** secure the ladder to the pool top rail for strength & stability. The top platform of the ladder has 4 possible bolt holes; choose 2 that best suit your positioning & pool top rail. Mark bolt locations on pool top rail & drill 1/4" holes. Using the 3" bolts, washers & nuts, secure ladder to top rail (15.3). Tighten hardware. **IMPORTANT:** When pool is not in use slide up exterior ladder section & secure with lock (15.4). Remove & store for pool closure / winterization.

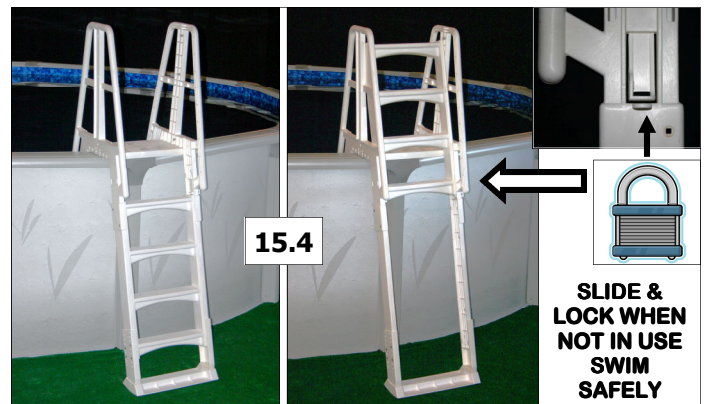
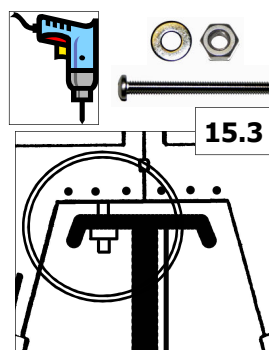

**SLIDE & LOCK WHEN NOT IN USE SWIM SAFELY**

## MODEL SLA001-3 - ANTI-ENTRAPMENT BARRIER INSTRUCTION

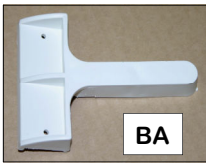

**IDENTIFY  
BARRIER  
PARTS**

BA

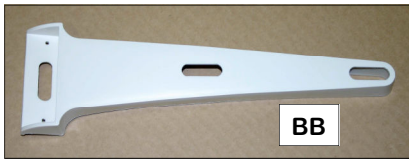

BB

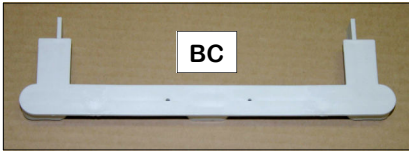

BC

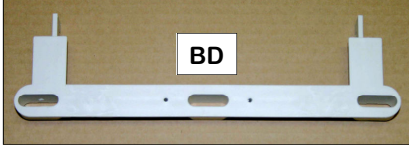

BD



**BARRIER  
PICKETS  
5 PIECES**

BP

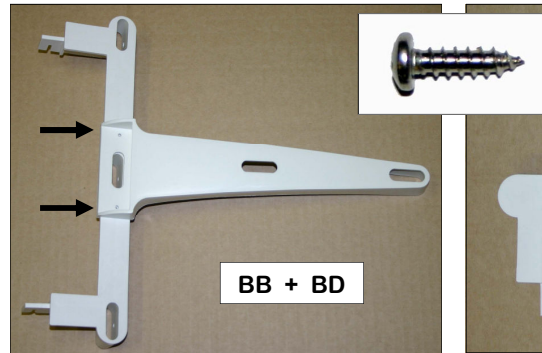

BB + BD

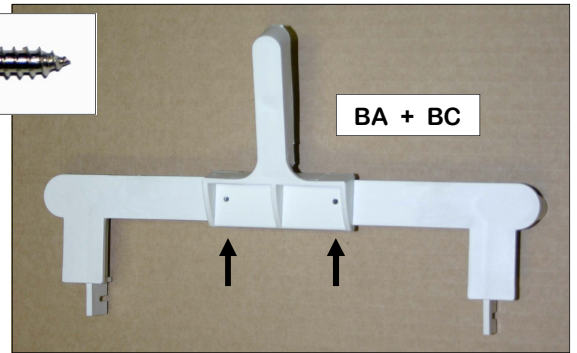

BA + BC

1. Fit parts together ( BA + BC & BB + BD ), align small screw holes and secure with 1/2" barrier screws as shown above

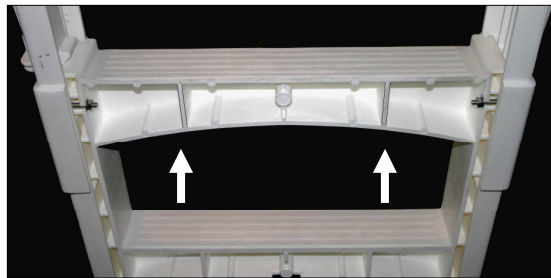

2. Fit sub-assembled BA+BC to back of in-pool ladder section F, behind top ladder tread/rung. The extended screw tabs on Part BC fit on the outside of the strengthening ribs of the tread/rung. Slide to top of ribs and secure in place using a 1/2" screw on both left & right sides.

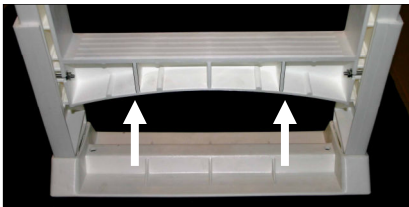

3. Similar to step 2 above, fit sub-assembled BB+BD to back of in-pool ladder section F, behind bottom ladder tread/rung. The extended screw tabs on Part BD fit on the outside of the strengthening ribs of the tread/rung. Slide to top of ribs and secure in place using a 1/2" screw on both left & right sides

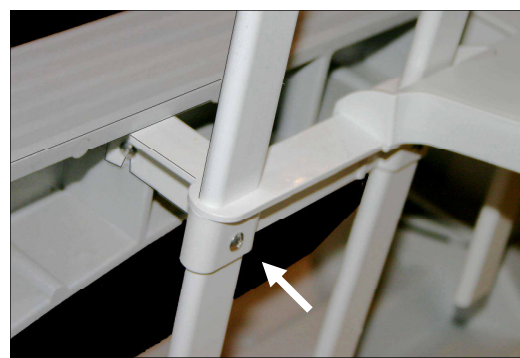

4. Fit 3 barrier pickets through slots in BB+BD at bottom & slide up into slots of BA+BC and secure all with 1/2" screws as shown by arrow



5. Fit 2 barrier pickets through slots in BB at bottom & slide up into slots of BA and secure both with 1/2" screws as shown

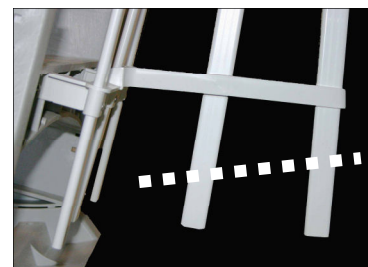

6. Trim bottom of barrier pickets if required as not to damage pool liner. Leave space between pickets and liner (6" maximum).