



## HISTORIC PRESERVATION COMMISSION

Marc Elrich  
*County Executive*

Sandra I. Heiler  
*Chairman*

Date: November 10, 2020

### **MEMORANDUM**

TO: Mitra Pedoeem  
Department of Permitting Services

FROM: Dan Bruechert  
Historic Preservation Section  
Maryland-National Capital Park & Planning Commission

SUBJECT: Historic Area Work Permit # 921025 - Tree Removal, Deck Replacement, and Hardscape

---

The Montgomery County Historic Preservation Commission (HPC) has reviewed the attached application for a Historic Area Work Permit (HAWP). This application was **approved** at the September 9, 2020 HPC meeting.

The HPC staff has reviewed and stamped the attached construction drawings.

THE BUILDING PERMIT FOR THIS PROJECT SHALL BE ISSUED CONDITIONAL UPON ADHERENCE TO THE ABOVE APPROVED HAWP CONDITIONS AND MAY REQUIRE APPROVAL BY DPS OR ANOTHER LOCAL OFFICE BEFORE WORK CAN BEGIN.

Applicant: Michale Sloss  
Address: 313 Baltimore Ave., Takoma Park

This HAWP approval is subject to the general condition that the applicant will obtain all other applicable Montgomery County or local government agency permits. After the issuance of these permits, the applicant must contact this Historic Preservation Office if any changes to the approved plan are made. Once work is complete the applicant will contact Dan Bruechert at 301.563.3400 or [dan.bruechert@montgomeryplanning.org](mailto:dan.bruechert@montgomeryplanning.org) to schedule a follow-up site visit.





**REVIEWED**

*By Dan.Bruechert at 2:04 pm, Sep 16, 2020*

APPROVED

Montgomery County

Historic Preservation Commission

*Sandra L. Skiler*

**Property Owners:** Michael Sloss & Nancy Smith

Michael Sloss [msloss@rocusa.org](mailto:msloss@rocusa.org)  
603.513.2813

Nancy Smith [nsmith10@umd.edu](mailto:nsmith10@umd.edu)  
301-351-5413

**Property Address:**

7313 Baltimore Ave  
Takoma Park 20912

APPROVED  
Montgomery County  
Historic Preservation Commission  
*Sandra L. Skiler*

**REVIEWED**  
By Dan.Bruechert at 2:04 pm, Sep 16, 2020

**1. Deck Railing**

Two options:

I. Aluminum rail- black finish

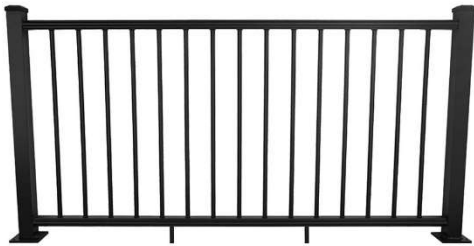

II. Wood Rail (replace in Kind) with aluminum baluster



**2. Stone Material**

A. Local wall stone for wall veneer



B. PA Flagstone





C. Paver Cobbles Stone for Driveway entrance and walkway border details



APPROVED  
Montgomery County  
Historic Preservation Commission  
*Sandra L. Heiler*

**REVIEWED**  
By Dan.Bruechert at 2:05 pm, Sep 16, 2020

**3. Barn Steps**



**4. Gravel for paths and driveway**

¾ Seneca Chip







BALTIMORE AVE. RESIDENCE  
THIS NEIGHBORING RESIDENCE DEMONSTRATES A FENCE ALONG A PROPERTY LINE

APPROVED  
Montgomery County  
Historic Preservation Commission

*Sandra A. Heiler*

**REVIEWED**  
By Dan.Bruechert at 2:05 pm, Sep 16, 2020



THIS IS THE PROPOSED 6' FENCE WITH SPINDLE TOP



THIS IS THE CORNER WHERE THE 6' FENCE WILL CONNECT TO THE HOUSE



PROPOSED 4' WOOD PICKET FENCE TO THE POINT OF THE NEIGHBOR'S PICKET FENCE



7316 BALTIMORE AVE.  
THIS NEIGHBORING RESIDENCE DEMONSTRATES A STONE WALL AND WALKWAY AS CONTEXT FOR THIS PROPOSED PROJECT



SAMPLE OF STONE WALL WORK

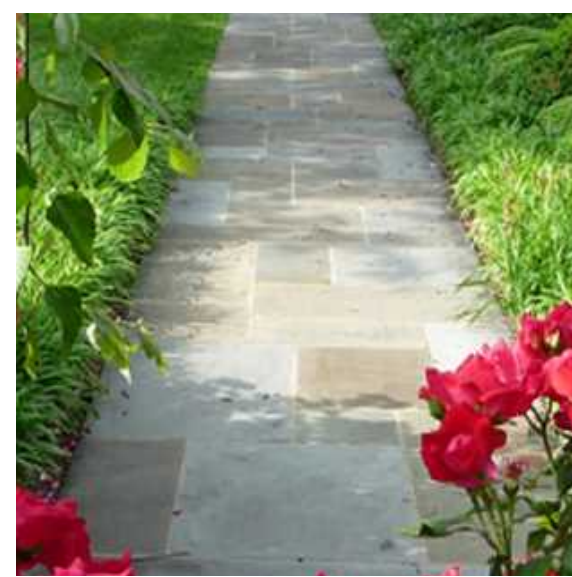

SAMPLE OF FLAGSTONE WALKWAY

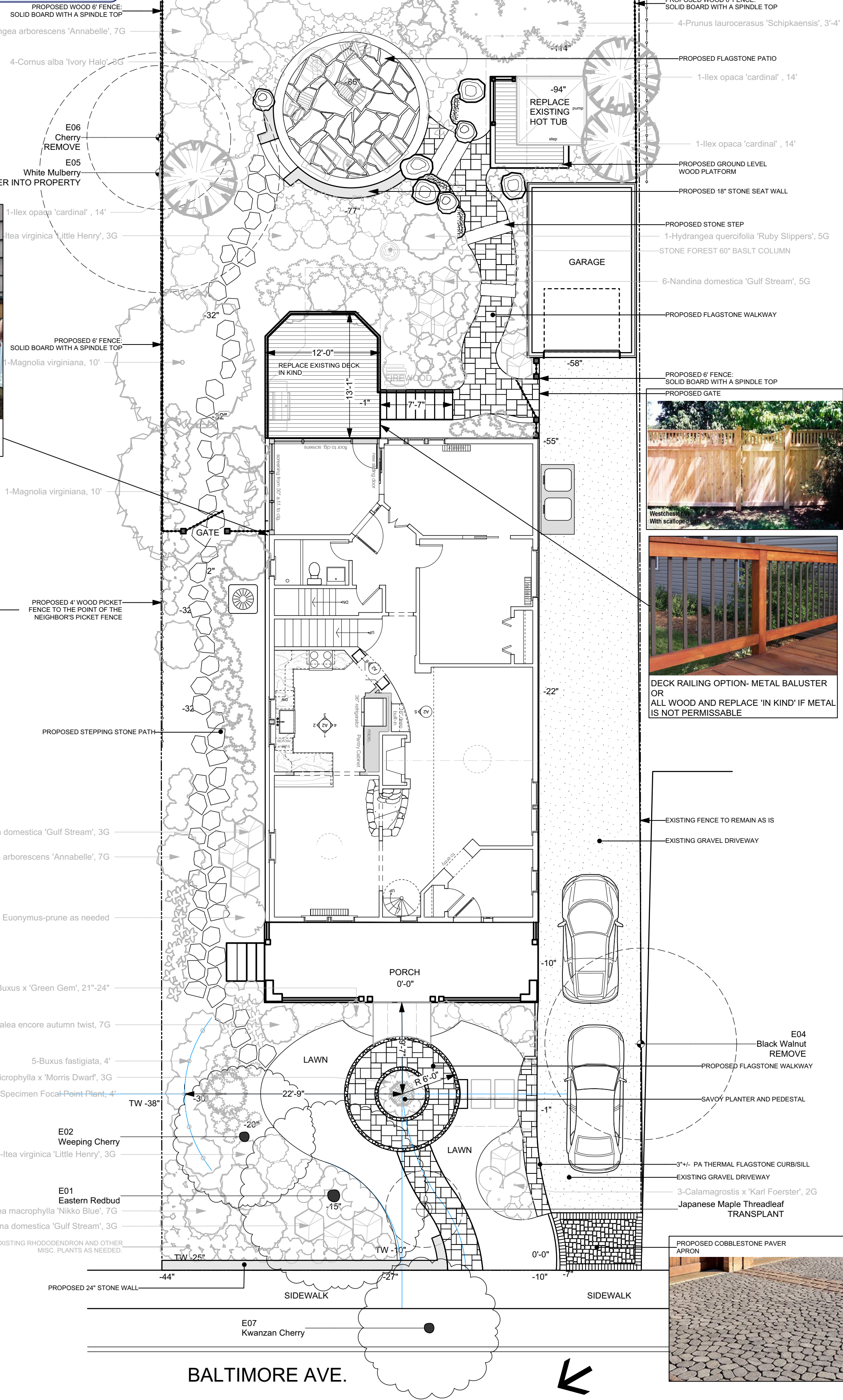

DECK RAILING OPTION- METAL BALUSTER OR ALL WOOD AND REPLACE 'IN KIND' IF METAL IS NOT PERMISSIBLE

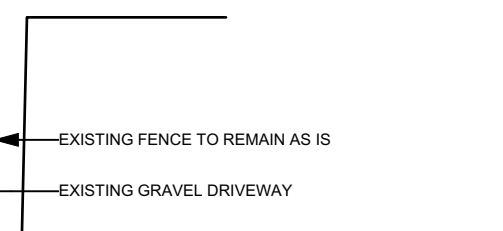

EXISTING GRAVEL DRIVEWAY

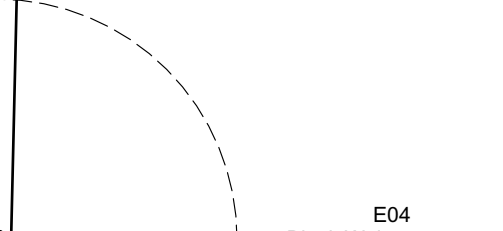

PROPOSED FLAGSTONE WALKWAY



PROPOSED COBBLESTONE PAVER APRON

BALTIMORE AVE.



DATE:	7-01-2020
REVISION DATE:	7-23-2020
7-08-2020	7-25-2020
7-14-2020	8-03-2020
7-16-2020	8-21-2020
DRAWN BY:	Stephen Wiodarczyk, PLA
JOB #	

**THE SLOSS-SMITH RESIDENCE**  
7313 BALTIMORE AVE.  
TAKOMA PARK, MARYLAND 20912

**Historic Area Work**  
**Permit #921025**  
SCALE 1/8" = 1'-0"

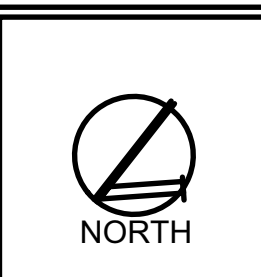

**McHALE**  
LANDSCAPE DESIGN, INC.  
McLEAN, VA 22101  
(703) 760-8600  
FAX (703) 506-3940  
www.mchalelandscape.com