



## HISTORIC PRESERVATION COMMISSION

Isiah Leggett  
County Executive

William Kirwan  
Chairman

Date: October 25, 2018

### MEMORANDUM

TO: Diane Schwartz Jones  
Department of Permitting Services

FROM: Michael Kyne  
Historic Preservation Section  
Maryland-National Capital Park & Planning Commission

SUBJECT: Historic Area Work Permit #853162: Hardscape Alterations

---

The Montgomery County Historic Preservation Commission (HPC) has reviewed the attached application for a Historic Area Work Permit (HAWP). This application was **Approved** at the October 24, 2018 Historic Preservation Commission (HPC) meeting.

The HPC staff has reviewed and stamped the attached construction drawings.

THE BUILDING PERMIT FOR THIS PROJECT SHALL BE ISSUED CONDITIONAL UPON ADHERENCE TO THE ABOVE APPROVED HAWP CONDITIONS AND MAY REQUIRE APPROVAL BY DPS OR ANOTHER LOCAL OFFICE BEFORE WORK CAN BEGIN.

Applicant: David and Lisa Miller  
Address: 7120 Willow Ave., Takoma Park

This HAWP approval is subject to the general condition that the applicant will obtain all other applicable Montgomery County or local government agency permits. After the issuance of these permits, the applicant must contact this Historic Preservation Office if any changes to the approved plan are made. Once work is complete the applicant will contact Dan Bruechert at 301.563.3403 or [dan.bruechert@montgomeryplanning.org](mailto:dan.bruechert@montgomeryplanning.org) to schedule a follow-up site visit.



**HAWP APPLICATION - 7120 Willow ave Takoma Park MD 20912 Miller Residence**

This Project has been approved by the City Arborist of Takoma Park

**WRITTEN DESCRIPTION OF PROJECT:**

Remove existing 9' x 40' concrete driveway and replace with concrete pavers.

Remove existing 4' x 23' concrete front walkway and replace with concrete pavers.

Install new 14' x 21' flagstone patio in the back yard

**MATERIALS SPECIFICATIONS:**

**Driveway and walkway Materials**

EP Henry - Chiseled stone pavers (Pewter blend color)

6 x 9 pavers (6 1/4" x 9 7/16" x 2 3/8" thick )

Running bond pattern

Set on CR6 compacted aggregate base and bedding sand.

**Patio Materials**

Pa flagstone 1.5" thick - straight cut, laid in a random pattern

Set on a stone dust base.

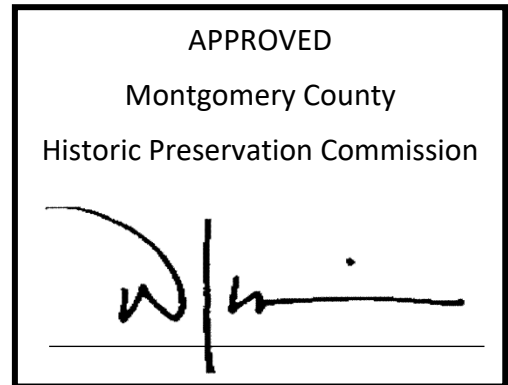

Site Plan

Miller Residence  
7120 Willow Ave  
Takoma Park MD

LOT 9  
7,500 S.F.

APPROVED  
Montgomery County  
Historic Preservation Commission

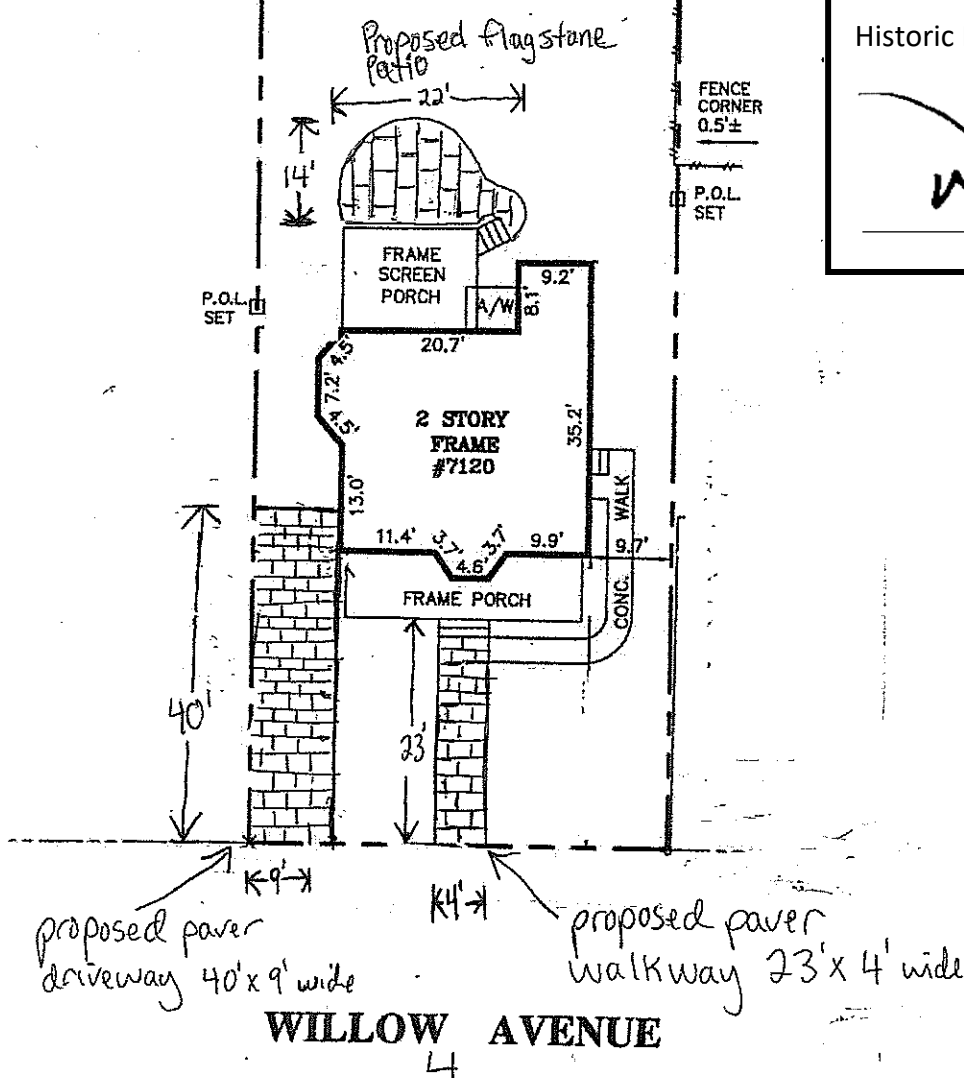



Lisa + David Miller  
7120 Willow ave  
Takoma Park MD 20912

5

7120 willow ave . viewed from the right side  
Side walk and Driveway

APPROVED  
Montgomery County  
Historic Preservation Commission

