

31/6 3820 Warner St.
OM 45-87

Smith
©

No. 509-BR

HASTINGS, MINN.
3825 ANGELESCO
MONTROSE, TX - LECHEST GROVE, GA



Historic Preservation Commission

100 Maryland Avenue, Rockville, Maryland 20850
279-1327

APPLICATION FOR HISTORIC AREA WORK PERMIT

AX ACCOUNT # 1025984

NAME OF PROPERTY OWNER Gilbert E + Mary L Prine TELEPHONE NO. 301 949 7319
(Contract/Purchaser) (Include Area Code)

ADDRESS 3820 Warner St. Kensington MD 20895
CITY STATE ZIP

CONTRACTOR — TELEPHONE NO. —

PLANS PREPARED BY Gilbert E Prine CONTRACTOR REGISTRATION NUMBER —
 TELEPHONE NO. 301 949 7319
(Include Area Code)

REGISTRATION NUMBER —

LOCATION OF BUILDING/PREMISE

House Number 3820 Street Warner St., Kensington

Town/City Kensington MD Election District —

Nearest Cross Street Connecticut

Block 4 Subdivision RB Detrick's Subdivision

Lot 4, 5, 6 Folio — Parcel —

1. TYPE OF PERMIT ACTION: (circle one)
 Construct Extend/Add Alter/Renovate Repair
 Wreck/Raze Move Install Revocable Revision
 Circle One: A/C Slab Room Addition
 Porch Deck Fireplace Shed Solar Woodburning Stove
 Fence/Wall (complete Section 4) Other —

2. CONSTRUCTION COSTS ESTIMATE \$ 4000

3. IF THIS IS A REVISION OF A PREVIOUSLY APPROVED ACTIVE PERMIT SEE PERMIT # —

4. INDICATE NAME OF ELECTRIC UTILITY COMPANY PEPCO

5. IS THIS PROPERTY A HISTORICAL SITE? Yes

PART TWO: COMPLETE FOR NEW CONSTRUCTION AND EXTEND/ADDITIONS

1. TYPE OF SEWAGE DISPOSAL
 01 WSSC 02 () Septic
 03 () Other —

2B. TYPE OF WATER SUPPLY
 01 WSSC 02 () Well
 03 () Other —

PART THREE: COMPLETE ONLY FOR FENCE/RETAINING WALL

1. HEIGHT — feet — inches

2. Indicate whether the fence or retaining wall is to be constructed on one of the following locations:
 1. On party line/Property line —
 2. Entirely on land of owner —
 3. On public right of way/easement — (Revocable Letter Required).

I hereby certify that I have the authority to make the foregoing application, that the application is correct, and that the construction will comply with laws approved by all agencies listed and I hereby acknowledge and accept this to be a condition for the issuance of this permit.

Gilbert E Prine 9/10/87
 Signature of owner or authorized agent (agent must have signature notarized on back) Date

APPROVED X For Chairperson, Historic Preservation Commission
 DISAPPROVED — Signature Roberta Hale Date 9/24/87

APPLICATION/PERMIT NO: OM 45-87 FILING FEE: \$ —
 DATE FILED: — PERMIT FEE: \$ —
 DATE ISSUED: — BALANCE \$ —
 OWNERSHIP CODE: — RECEIPT NO: — FEE WAIVED: —

SEE REVERSE SIDE FOR INSTRUCTIONS

THE FOLLOWING ITEMS MUST BE COMPLETED AND THE REQUIRED DOCUMENTS MUST ACCOMPANY THIS APPLICATION

DESCRIPTION OF PROPOSED WORK: (including composition, color and texture of materials to be used:)

1) Remove asbestos shingles and paint original wood siding that is underneath. Color will be gray.

2) Install 4 Anderson roof windows. ~~and~~

3) Paint tin roof with gray paint.

(If more space is needed, attach additional sheets on plain or lined paper to this application)

ATTACH TO THIS APPLICATION (2) COPIES OF: SUCH SITE PLANS (lot dimensions, building location with dimensions, drives, walks, fences, patios, etc. proposed or existing) and/or ARCHITECTURAL DRAWINGS (floor plans, elevations, etc.), PHOTOGRAPHS OF THE AREA AFFECTED, as are necessary to fully describe the proposed work.

MAIL OR DELIVER THE APPLICATION AND ALL REQUIRED DOCUMENTS TO THE:
HISTORIC PRESERVATION COMMISSION
100 MARYLAND AVENUE
ROCKVILLE, MARYLAND 20850



Historic Preservation Commission

100 Maryland Avenue, Rockville, Maryland 20850
279-1327

APPLICATION FOR HISTORIC AREA WORK PERMIT

TAX ACCOUNT # _____

NAME OF PROPERTY OWNER _____ TELEPHONE NO. _____
(Contract/Purchaser) _____ (Include Area Code) _____

ADDRESS _____ CITY _____ STATE _____ ZIP _____

CONTRACTOR _____ TELEPHONE NO. _____

PLANS PREPARED BY _____ CONTRACTOR REGISTRATION NUMBER _____

REGISTRATION NUMBER _____

LOCATION OF BUILDING/PREMISE

House Number _____ Street _____

Town/City _____ Election District _____

Nearest Cross Street _____

Lot _____ Block _____ Subdivision _____

Liber _____ Folio _____ Parcel _____

1A. TYPE OF PERMIT ACTION: (circle one)

Construct	Extend/Add	Alter/Renovate	Repair	Circle One: A/C	Slab	Room Addition
Wreck/Raze	Move	Install	Revocable	Porch	Deck	Fireplace
			Revision	Fence/Wall (complete Section 4)	Shed	Solar
						Woodburning Stove
						Other _____

1B. CONSTRUCTION COSTS ESTIMATE \$ _____

1C. IF THIS IS A REVISION OF A PREVIOUSLY APPROVED ACTIVE PERMIT SEE PERMIT # _____

1D. INDICATE NAME OF ELECTRIC UTILITY COMPANY _____

1E. IS THIS PROPERTY A HISTORICAL SITE? Yes

PART TWO: COMPLETE FOR NEW CONSTRUCTION AND EXTEND/ADDITIONS

2A. TYPE OF SEWAGE DISPOSAL

01 <input checked="" type="checkbox"/> WSSC	02 () Septic
03 () Other _____	

2B. TYPE OF WATER SUPPLY

01 <input checked="" type="checkbox"/> WSSC	02 () Well
03 () Other _____	

PART THREE: COMPLETE ONLY FOR FENCE/RETAINING WALL

4A. HEIGHT _____ feet _____ inches

4B. Indicate whether the fence or retaining wall is to be constructed on one of the following locations:

- On party line/Property line _____
- Entirely on land of owner _____
- On public right of way/easement _____ (Revocable Letter Required).

I hereby certify that I have the authority to make the foregoing application, that the application is correct, and that the construction will comply with plans approved by all agencies listed and I hereby acknowledge and accept this to be a condition for the issuance of this permit.

Signature of owner or authorized agent (agent must have signature notarized on back) _____ Date _____

APPROVED _____ For Chairperson, Historic Preservation Commission

DISAPPROVED _____ Signature _____ Date _____

APPLICATION/PERMIT NO: _____ FILING FEE: \$ _____

DATE FILED: _____ PERMIT FEE: \$ _____

DATE ISSUED: _____ BALANCE \$ _____

OWNERSHIP CODE: _____ RECEIPT NO: _____ FEE WAIVED: _____

SEE REVERSE SIDE FOR INSTRUCTIONS

THE FOLLOWING ITEMS MUST BE COMPLETED AND THE REQUIRED DOCUMENTS MUST ACCOMPANY THIS APPLICATION

DESCRIPTION OF PROPOSED WORK: (including composition, color and texture of materials to be used:)

(If more space is needed, attach additional sheets on plain or lined paper to this application)

ATTACH TO THIS APPLICATION (2) COPIES OF: SUCH SITE PLANS (lot dimensions, building location with dimensions, drives, walks, fences, patios, etc. proposed or existing) and/or ARCHITECTURAL DRAWINGS (floor plans, elevations, etc.), PHOTOGRAPHS OF THE AREA AFFECTED, as are necessary to fully describe the proposed work.

MAIL OR DELIVER THE APPLICATION AND ALL REQUIRED DOCUMENTS TO THE:
HISTORIC PRESERVATION COMMISSION
100 MARYLAND AVENUE
ROCKVILLE, MARYLAND 20850

THE FOLLOWING ITEMS MUST BE COMPLETED AND THE REQUIRED DOCUMENTS MUST ACCOMPANY THIS APPLICATION

DESCRIPTION OF PROPOSED WORK: (including composition, color and texture of materials to be used:)

1) Remove asbestos shingles and paint original wood siding that is underneath. Color will be gray.

2) Install 4 Anderson roof windows. ~~and~~

3) Paint tin roof with gray paint.

(If more space is needed, attach additional sheets on plain or lined paper to this application)

ATTACH TO THIS APPLICATION (2) COPIES OF: SUCH SITE PLANS (lot dimensions, building location with dimensions, drives, walks, fences, patios, etc. proposed or existing) and/or ARCHITECTURAL DRAWINGS (floor plans, elevations, etc.), PHOTOGRAPHS OF THE AREA AFFECTED, as are necessary to fully describe the proposed work.

MAIL OR DELIVER THE APPLICATION AND ALL REQUIRED DOCUMENTS TO THE:
HISTORIC PRESERVATION COMMISSION
100 MARYLAND AVENUE
ROCKVILLE, MARYLAND 20850

Primary Resources
 1880-1910 /// Colonial
 styles
 1910-1930 ●●●



NOTE: This survey for title purposes only - not to be used for determining property lines. Property corner Markers Not guaranteed by this survey.

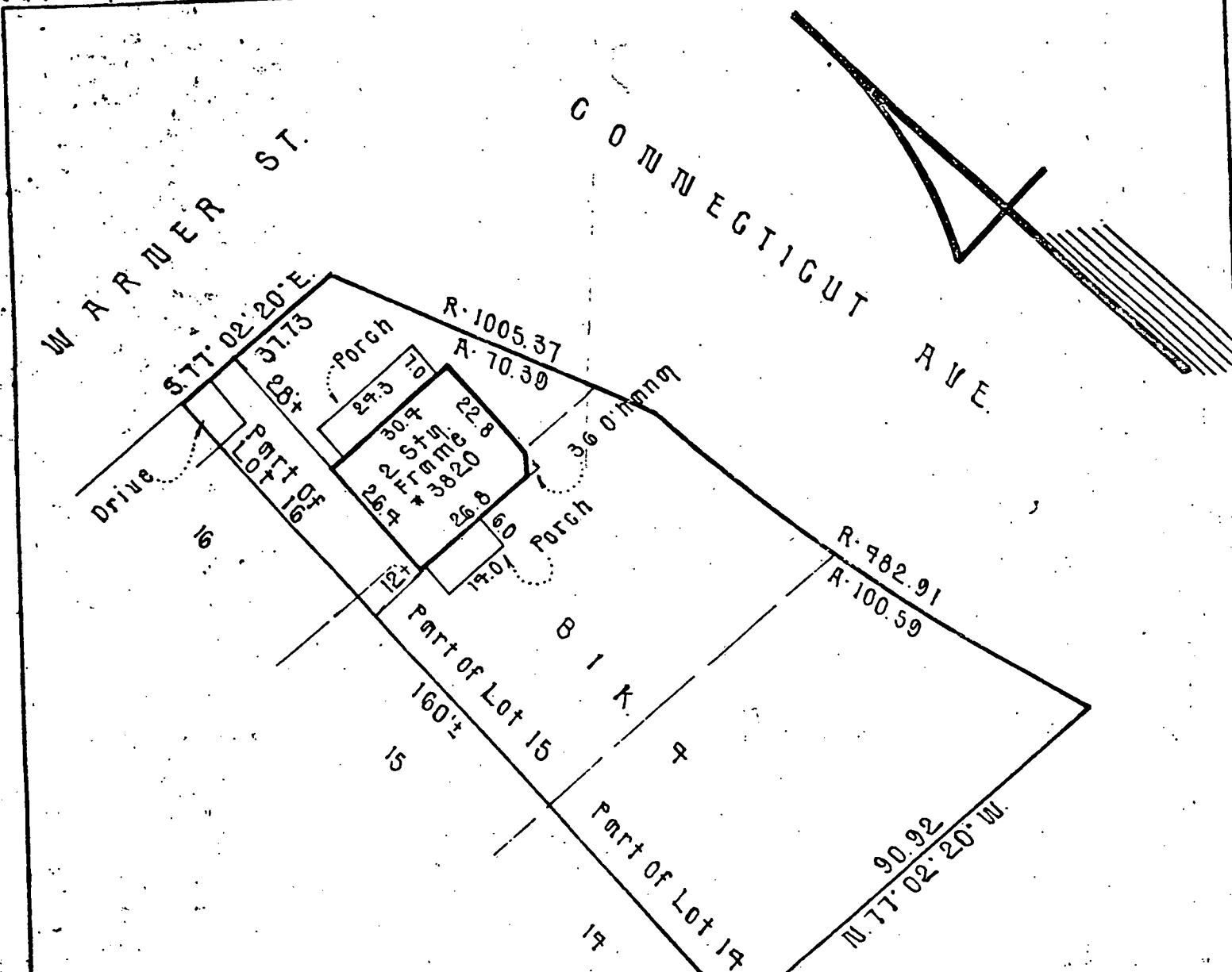

HOUSE LOCATION
 PART OF LOTS 14, 15 & 16 BLOCK 7
 ALL THOSE PARTS OF LOTS 14, 15 & 16
 IN BLOCK 7 OF R.B. DETRICK'S SUBDIVISION
 OF LOTS 21, 22, & 23 OF THE REAL ESTATE OF
 LURANER KNOWLES
 KENSINGTON - MONTGOMERY COUNTY, MD.

SURVEYOR'S CERTIFICATE I HEREBY CERTIFY THAT THE POSITION OF ALL THE EXISTING IMPROVEMENTS ON THE ABOVE DESCRIBED PROPERTY HAS BEEN CAREFULLY ESTABLISHED BY A TRANSIT-TAPE SURVEY AND THAT UNLESS OTHERWISE SHOWN, THERE ARE NO ENCROACHMENTS. <i>A. M. ...</i>	REFERENCES PLAT BK. B PLAT NO. 30	ANDJON ASSOCIATES PROFESSIONAL LAND SURVEYOR LAND PLANNING CONSULTANTS 11748 ASHWORTH COURT GERMANTOWN, MARYLAND 2076 (301) 428-0481
	DATE OF SURVEYS	SCALE: None

MONTGOMERY COUNTY HISTORIC PRESERVATION COMMISSION

LOCAL ADVISORY COMMITTEE REVIEW FORM

EXTERIOR ALTERATIONS

I. Location of property

a. Located within the KENSINGTON historic district.

b. This is a Master Plan Atlas historic district (circle one).

c. Address of Property: 3820 WARNER ST.

KENSINGTON MD

d. Property owner's name, address and phone number:

GILBERT E. & MARY L. PRINE

ABOVE

(h) 949-7319 (w) _____

e. Is this property a contributing resource within the historic district? Yes No _____

f. On a map of the district locate this property and any adjacent historic resources. Will this work impact other contributing historic resources? Yes No _____

II. Description of work proposed

a. Briefly describe proposed work:

- REMOVE ASBESTOS SHINGLES & REFURBISH WOOD SIDING
- NEW SKYLIGHTS
- REPAIR & PAINT TIN ROOF

b. Is this work on the front, rear, or side of the structure?

c. Is the work visible from the street? YES

d. What are the materials to be used? GLASS SKYLIGHTS

e. Are these materials compatible with existing materials? How? If not, why?

FLAT SKYLIGHTS ARE UNOBTUSIVE TO RESIDENCE

III. Recommendation of the Local Advisory Committee

a. Approval of Work

1. Which criteria found in the Ordinance for Historic Preservation (Sec. 24A-8-b of the Montgomery County Code) does this work meet?

1) 2)

2. What conditions, if any, must be met in order for the proposed work to meet the above criteria? (example: the proposed windows should be double hung to conform with existing windows)

b. Disapproval of Work

1. On what grounds is disapproval recommended? Refer to Sec. 24A-8.

2. How could this proposal be altered so as to be approved?

IV. Additional comments

Date on which application received: 9.10.87

Date of LAC meeting at which application was reviewed: 9.14.87

Form completed by: Donald H. Little Title: CHRMN

Member of: KENSINGTON LAC

Date: SEPT 24, 1987

Front Roof

RW 2134

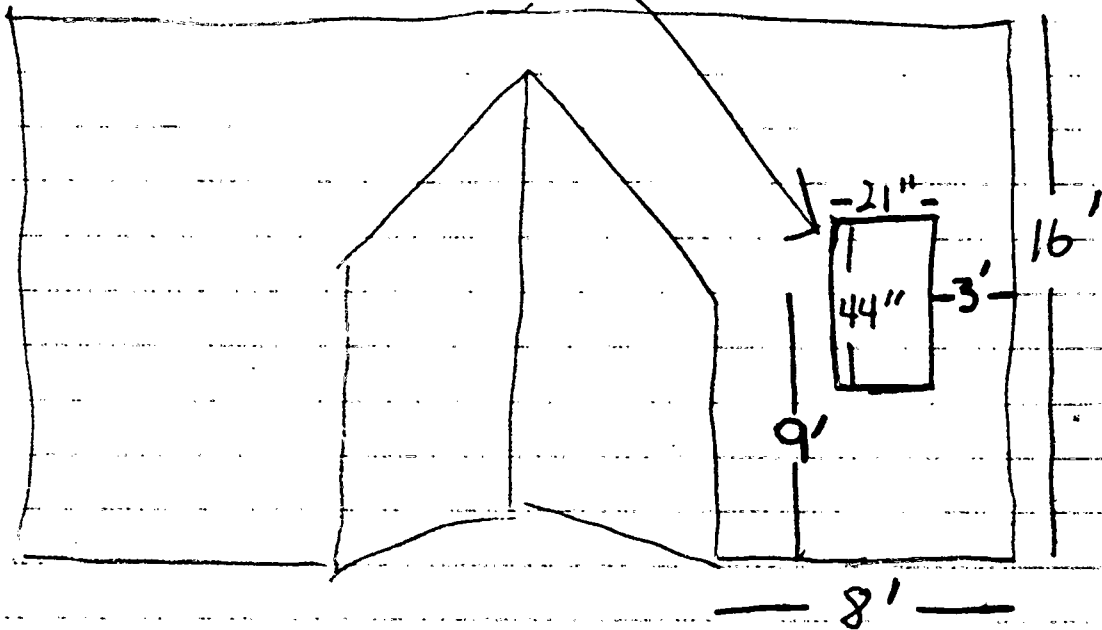

RW 2944

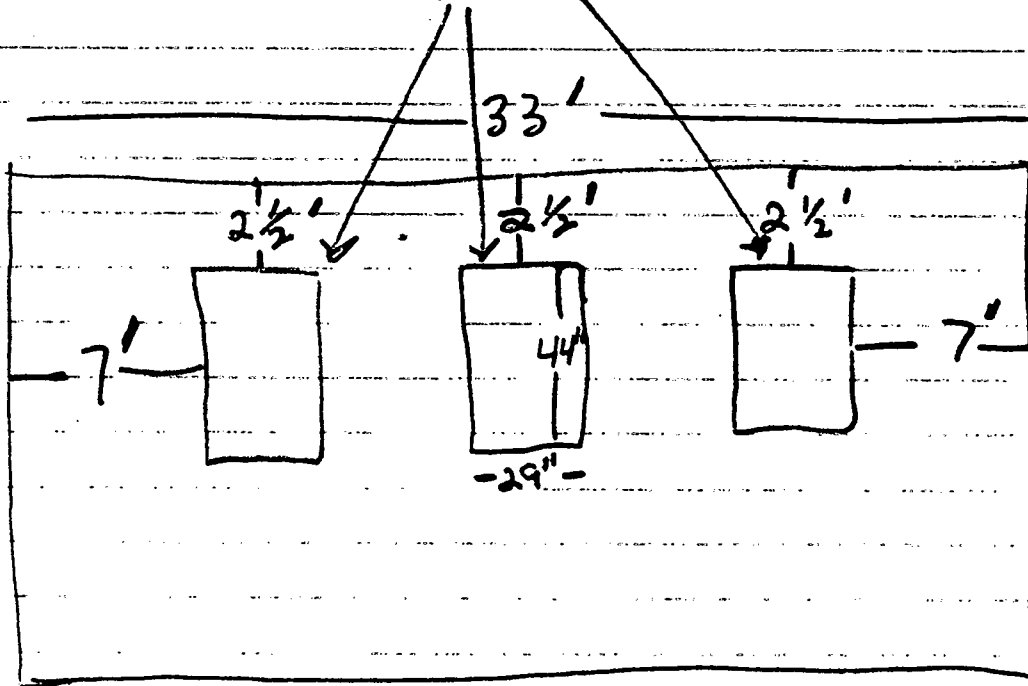

Front Roof

RW 2034

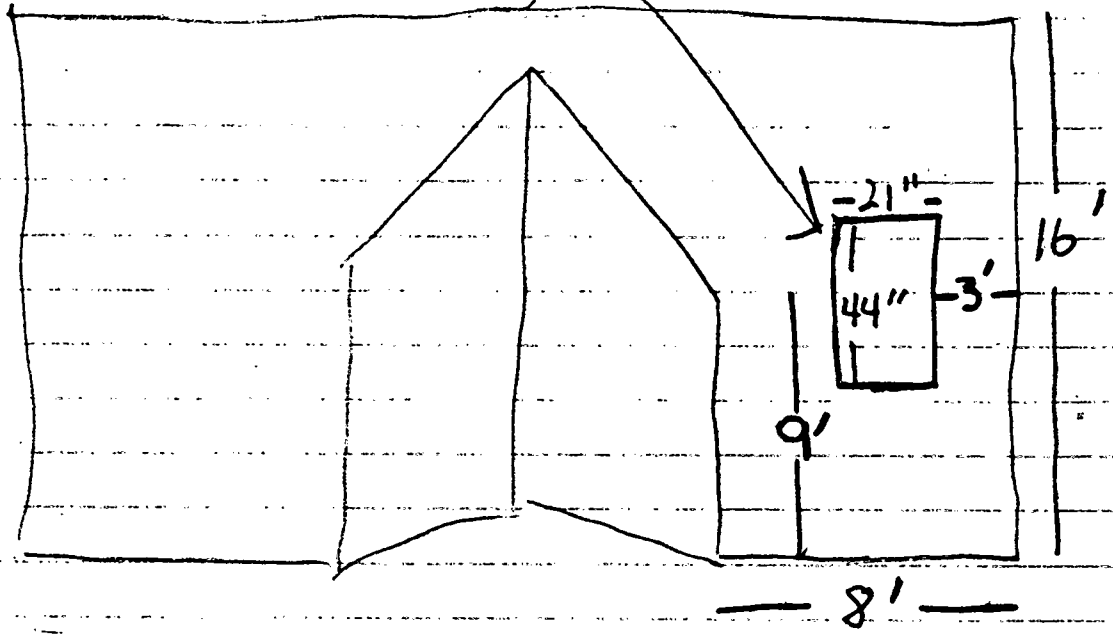

RW 2944

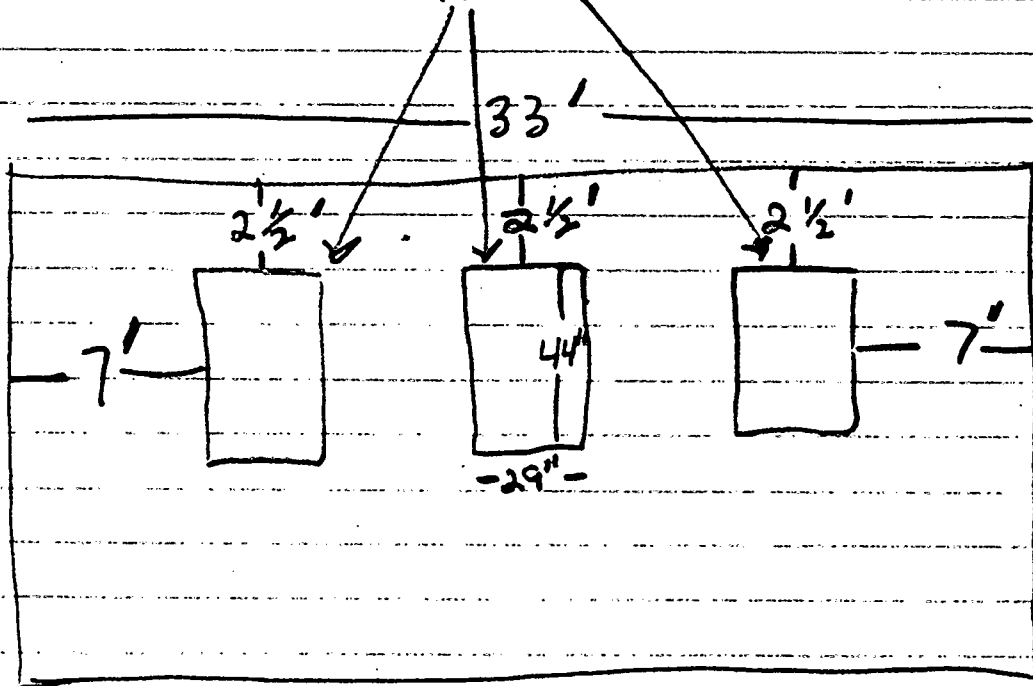

NOTE: This survey for title purposes only - not to be used for determining property lines. Property corner Markers Not guaranteed by this survey.

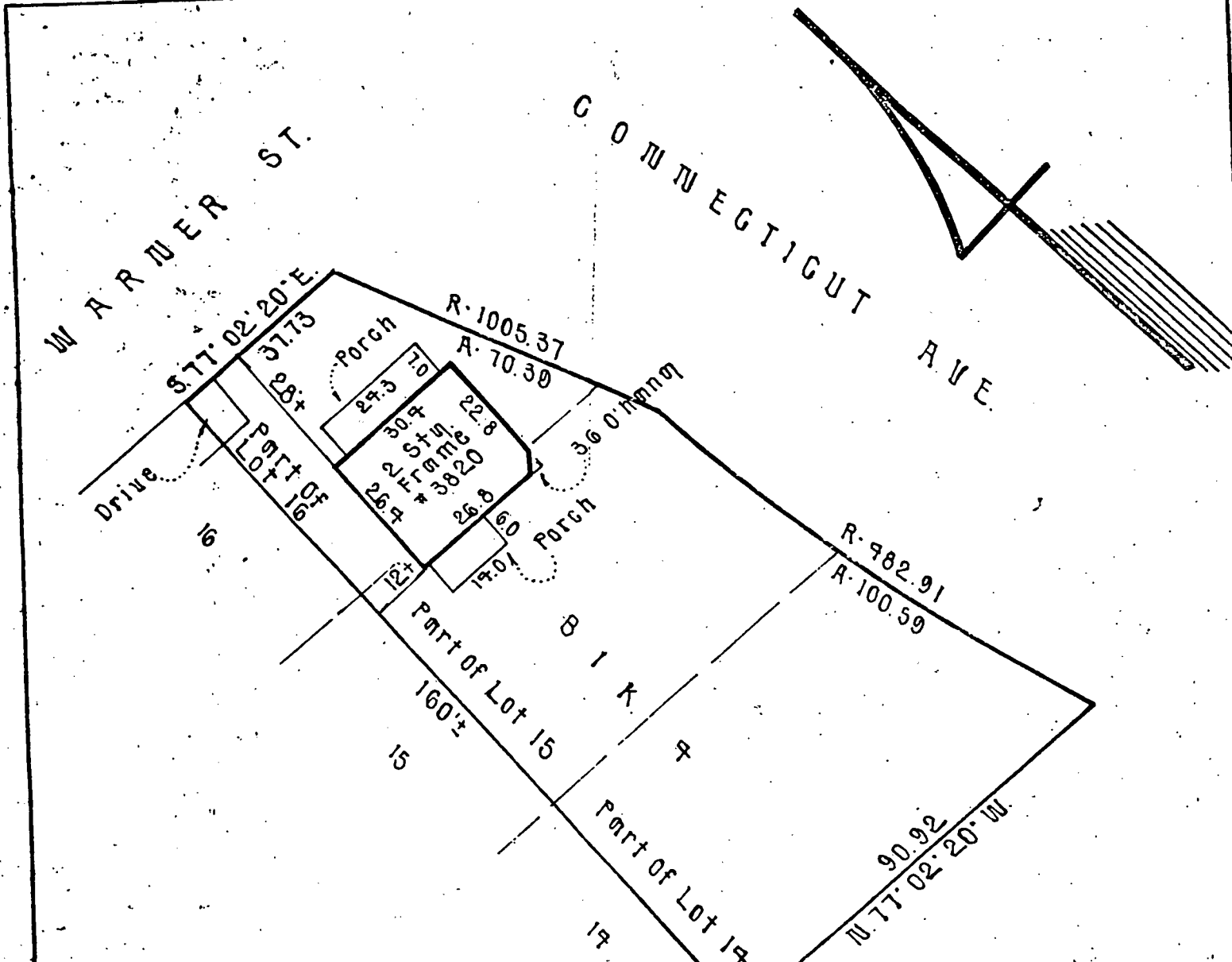

HOUSE LOCATION
 PART OF LOTS 14, 15 & 16 BLOCK 7
 ALL THOSE PARTS OF LOTS 14, 15 & 16
 IN BLOCK 7 OF R.B. DETRICKS SUBDIVISION
 OF LOTS 21, 22, & 23 OF THE REAL ESTATE OF
 LURANER KNOWLES
 KENSINGTON - MONTGOMERY COUNTY, MD.

SURVEYOR'S CERTIFICATE
 I HEREBY CERTIFY THAT THE POSITION OF ALL THE
 EXISTING IMPROVEMENTS ON THE ABOVE DESCRIBED
 PROPERTY HAS BEEN CAREFULLY ESTABLISHED BY A
 TRANSIT-TAPE SURVEY AND THAT UNLESS OTHER-
 WISE SHOWN, THERE ARE NO ENCROACHMENTS.
A. M. O. L...

REFERENCES	
PLAT BK.	B
PLAT NO.	30

ANDJON ASSOCIATES
 PROFESSIONAL LAND SURVEYOR
 LAND PLANNING CONSULTANTS
 11748 ASHWORTH COUR
 GERMANTOWN, MARYLAND 20784
 (301) 428-0481
 DATE OF SURVEYS
 SCALE: None

New from
ANDERSEN[®]

A revolutionary new roof window everyone will be looking up to.

Wind[™]
General Windows
Manufacturing Co.

Windowland

11623 Nebel Street
Rockville, Maryland 20852
(301) 468-4833

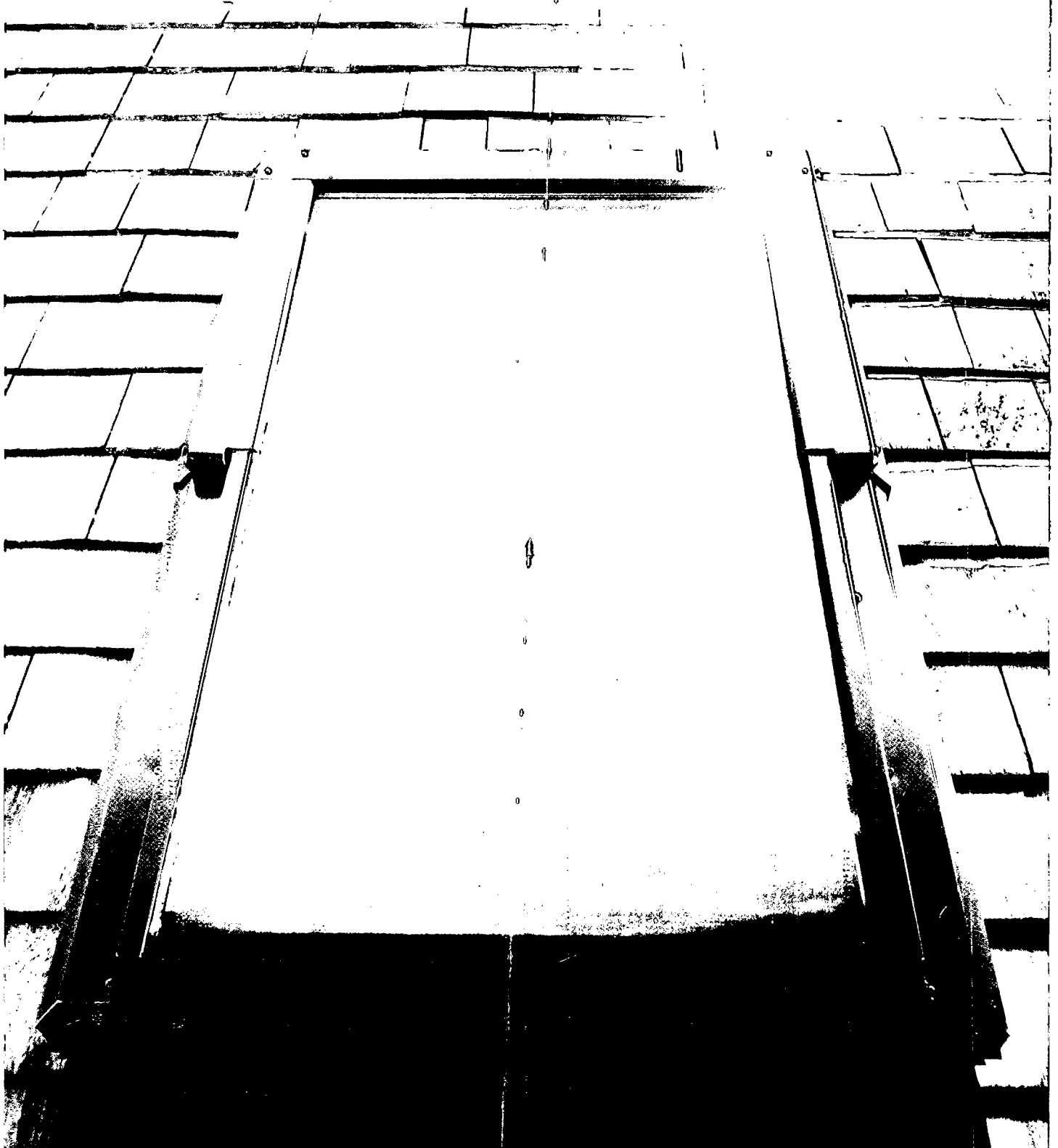

The Andersen® roof window. It offers you more beautiful features than any other roof window.

Imagine this. A roof window that is more weathertight, more energy efficient and more versatile than any roof window designed today.

A roof window that adds maximum energy efficiency to passive solar designs. A roof window that gives homes new dimensions in weathertightness and smooth operation. And fills commercial buildings with new feelings of warmth, space and beauty.

Introducing the new Andersen® roof window. It includes features so far above and beyond other

roof windows that, whether you're thinking of new construction, renovating or remodeling, you'll discover it's the only roof window worth looking up to.

Why? Read on.

Opens three different ways, not just one.

Our roof window operation is so unique, so versatile, the hardware alone has over 200 patents.

Yet it's easy to operate, with a simple handle that controls a spring counterbalanced system permitting smooth, worry-free operation.

First, open the roof window in the awning position for easy ventilation. Notice that our weathertight design lets you leave the window open during light rain for ventilation (Fig. 1).

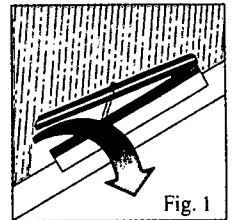

Second, open the sash in the pivoting position for ideal air circulation (Fig. 2). Adjustable springs in the operating hardware provide just enough tension to keep the window in place on windy days. And see how our sash pivots higher in the frame, maximizing headroom. So you can not only walk near it, you can design living around it.

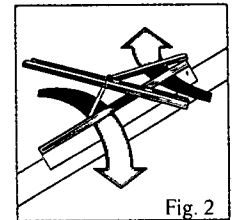

Our third opening position permits easy glass cleaning from *inside*. Also notice how the sash safely "locks" into place.

Closed, our operating hardware locks the window at *four separate points*, not just one, for maximum weathertightness and security.

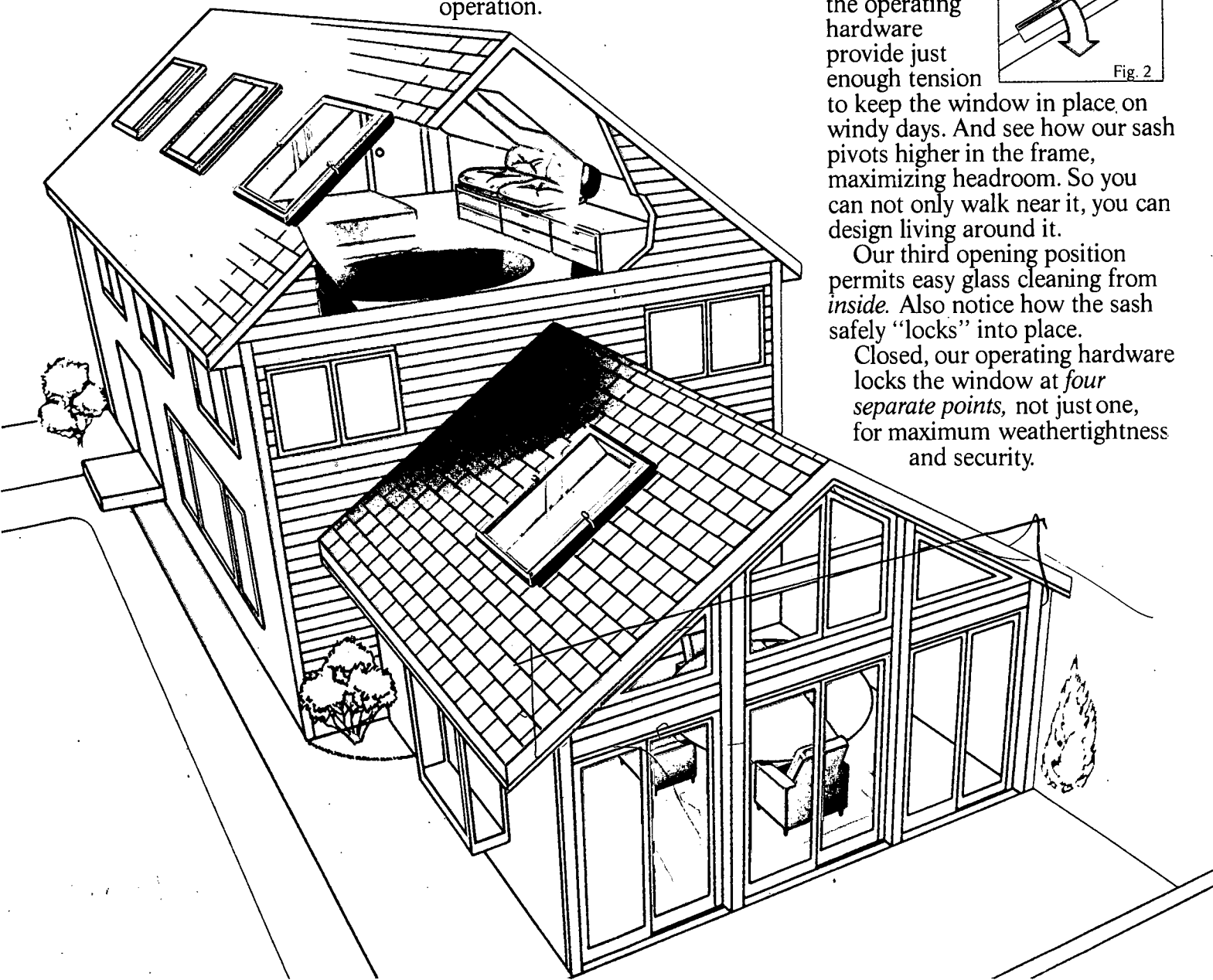

VERTICAL DETAIL

scale: 3" = 1'0"

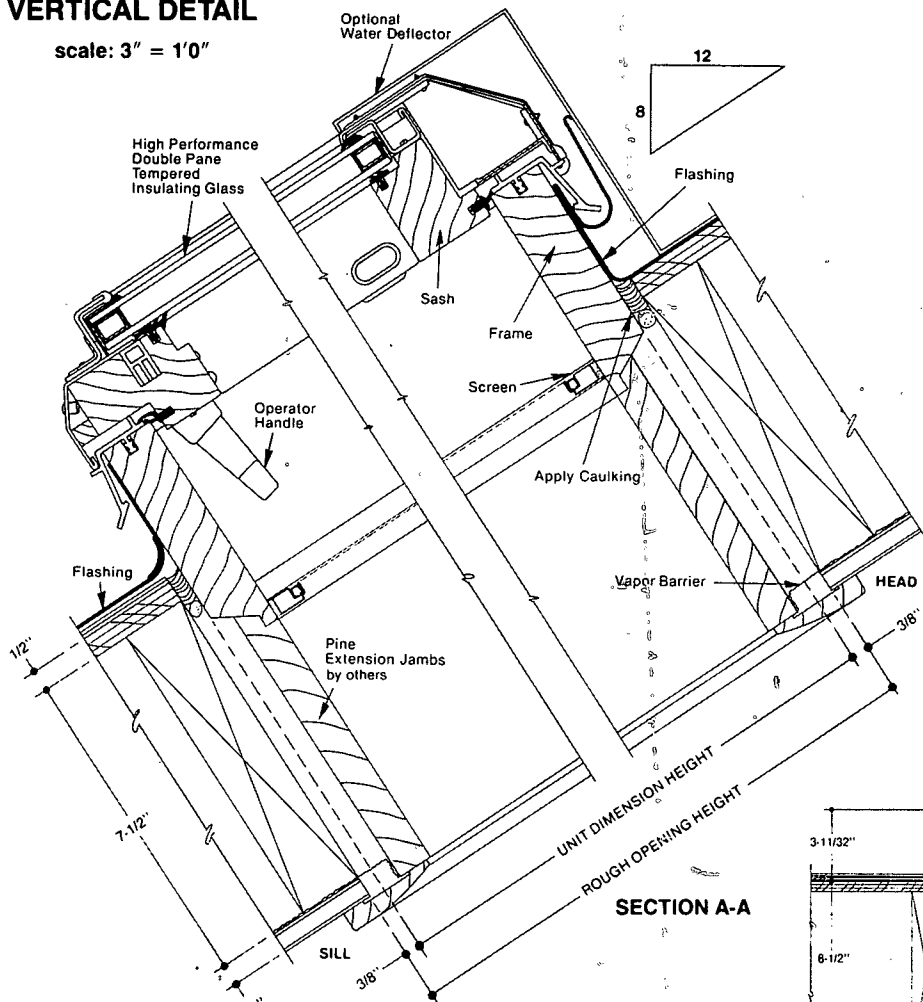

SECTION A-A

Recommended installation from 9° to 80°.
34°-8/12 Roof pitch shown. For complete specifications see installation instructions.

BASIC SIZES

UNIT DIM	1'-9 1/4"	2'-5 1/8"	3'-5 5/16"
RGH. OPG.	1'-10"	2'-5 7/8"	3'-6"
GLASS	15 1/16"	23"	35 3/16"

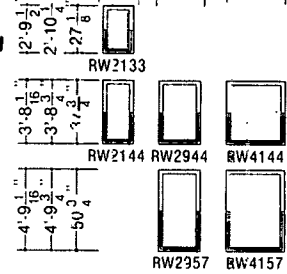

HORIZONTAL DETAIL

scale: 1 1/2" = 1'0"

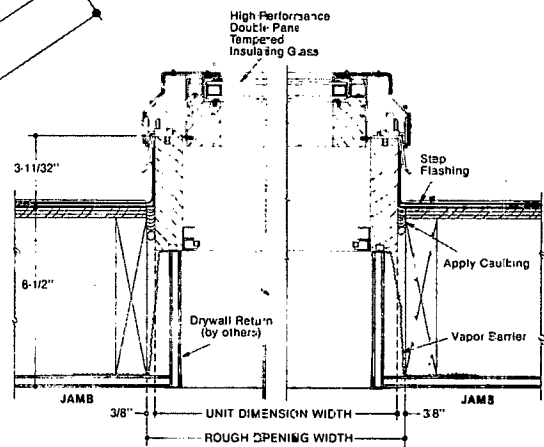

SECTION B-B

Come home to quality. Come home to Andersen.™

Andersen Windowalls
ANDERSEN CORPORATION BAYPORT, MINNESOTA 55003



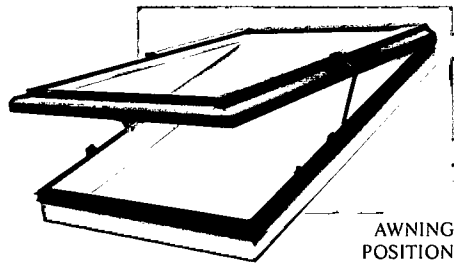
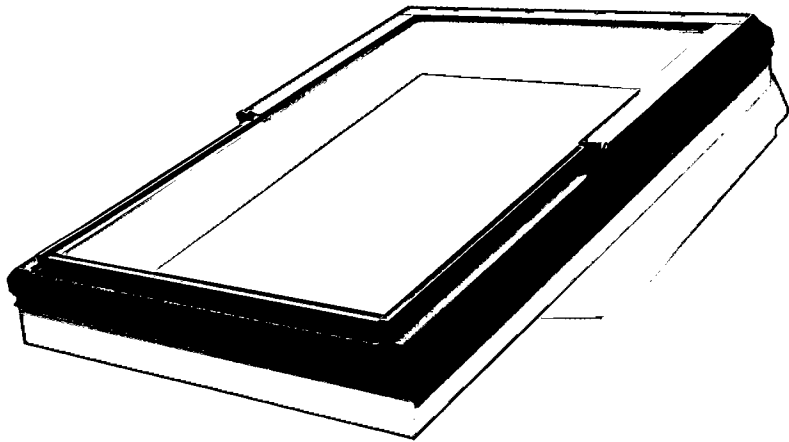

AWNING POSITION

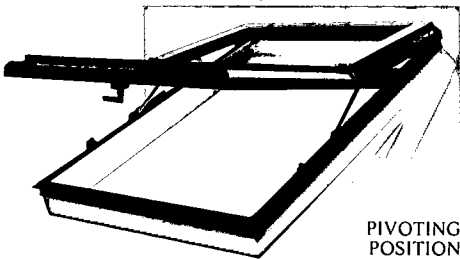

PIVOTING POSITION

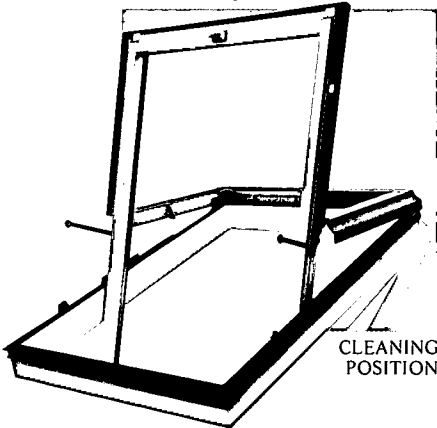

CLEANING POSITION

The Andersen roof window even locks *with a key*.

In addition, see how the Andersen roof window conveniently includes a minimum ventilation opening in the *key locked* position, for a *fourth* opening possibility.

Just the extra touch of performance you expect from Andersen.

Announcing a new insulating material so advanced, you can see through it.

Our new high performance double-pane tempered insulating glass has an invisible coating that helps reduce conduction of heat through the glass, for energy-efficiency that exceeds triple-pane ratings.

That gives our roof window greater insulating advantages compared to units with double-pane insulating glass.

In winter, the glass bounces 90% of radiant heat back into the room, keeping comfort levels up, energy costs down.

In summer, it reduces the amount of exterior heat conducted into the room.

So you can install our new roof window with energy-minded confidence in virtually any design, any climate.

Weathertightness and energy efficiency come first, beauty is second nature.

The only thing our new roof window doesn't cover up is the view.

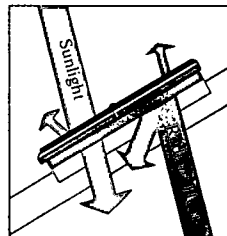

Winter

Our sash shield [1], made of rugged aluminum finished with low maintenance Terratone™ color acrylic, is contoured to direct ice, rain and snow *away* from the window opening. It also contacts with our seamless gasket weatherstripping [2] around the *entire sash and frame*. For a weathertight seal that even years of bad weather cannot penetrate.

And our special weatherstripping material won't deteriorate

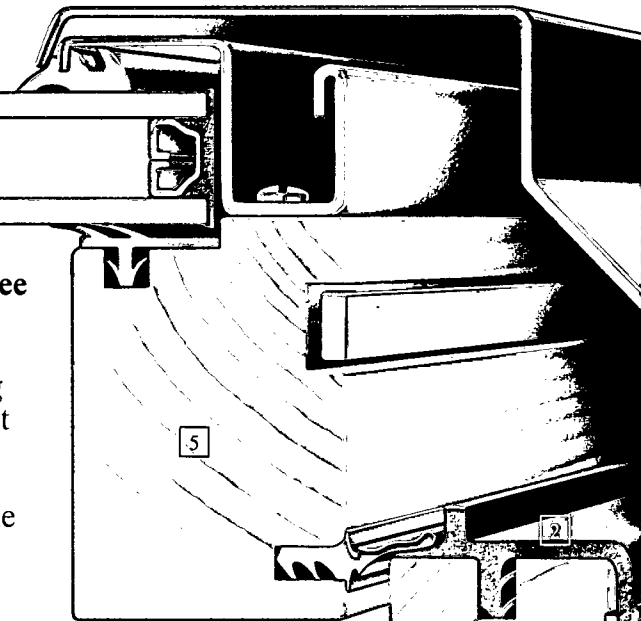

like butyl or compound systems.

Next, look at the Andersen step flashing system [3]. Installed beneath both weatherstripping [2] and roof shingles or tile [4], it creates a weathertight system that comes closest to a roof's own weather-tightness. Providing generous protection against heavy rains in summer, ice and snow build-up in winter.

Our preservative-treated wood core on both sash and frame [5] permits interior beauty that

can be painted or stained to match any decor.

With the Andersen roof window, installation isn't something you work at.

Installation can be made in any roof slope from 9° to 80°. And because our roof window comes ready to install, it's one of the easiest jobs you'll ever encounter.

Four brackets help you position the roof window in the opening.

Then simply square and fix in place.

Our step flashing system [3] slips easily between the flexible gasket weatherstripping [2] and roof window frame [5].

Spring tension in our operating hardware can be fine-tuned to match roof slope. A special water deflector is also available for slopes steeper than 60°. So you can be assured of easy operation and weathertightness no matter where you install.

Sensible options come with Andersen quality.

In addition to our aluminum mesh insect screen (standard), the Andersen roof window comes with three options.

Choose our horizontal window blinds for a contemporary designer look. Or a special reflector shade that helps minimize sun glare. Plus a telescoping pole that makes window operation easier from floor level.

Take a look at the new Andersen roof window today. Discover for yourself why it's the only roof window worth looking up to.

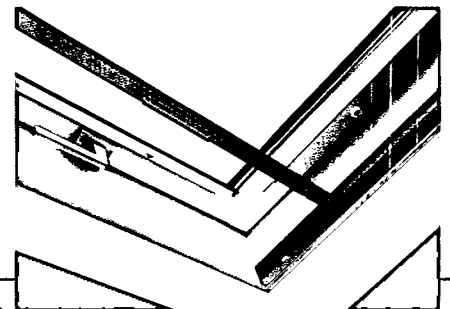
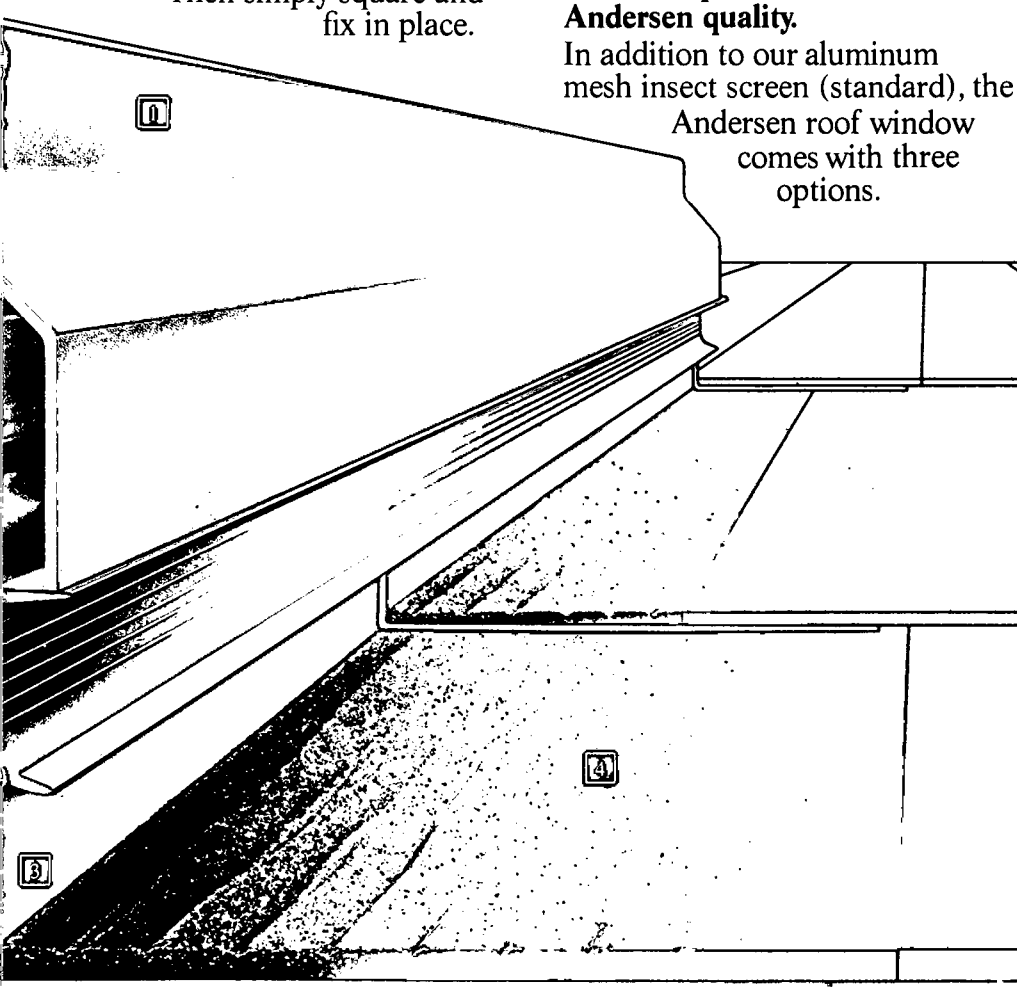

Insect screen

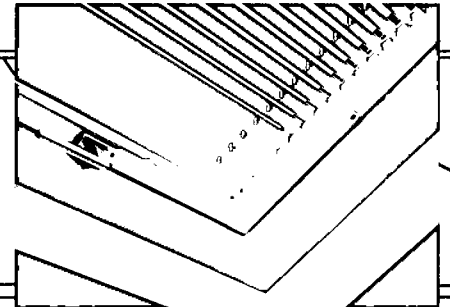

Horizontal blinds

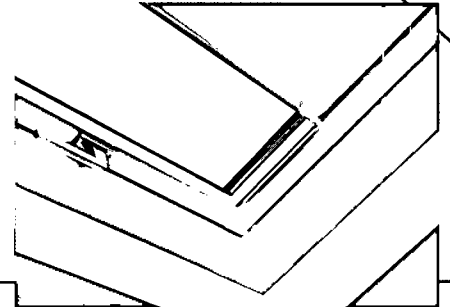

Reflector shade

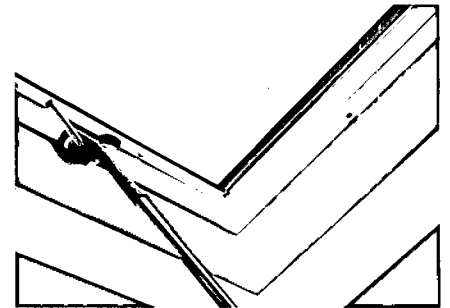

Telescoping operating pole

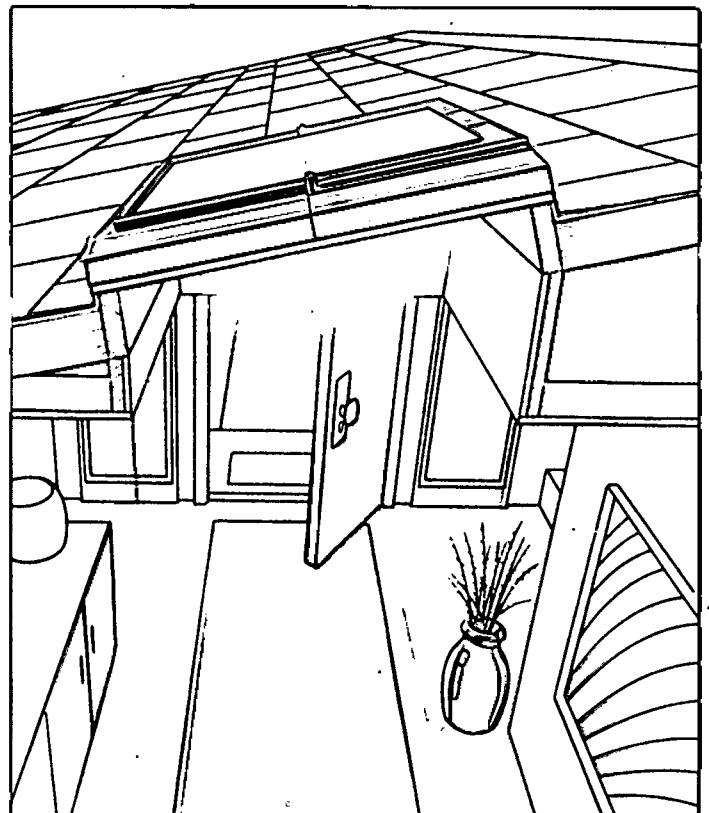
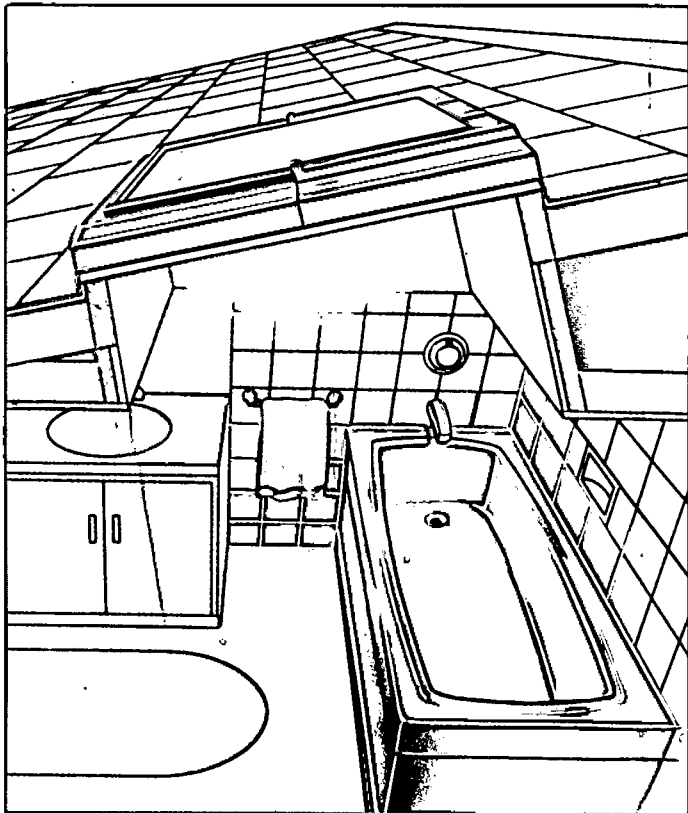
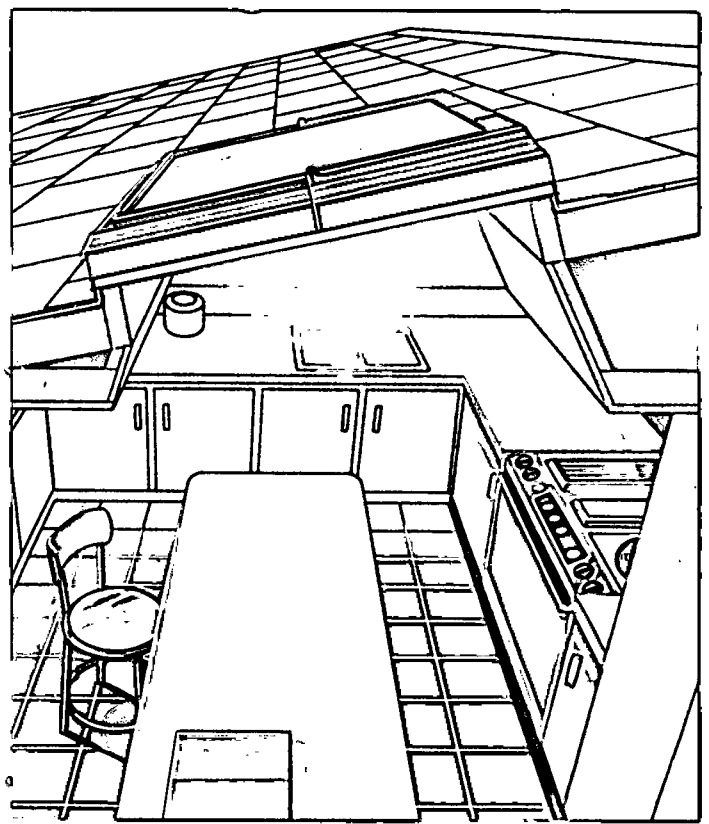
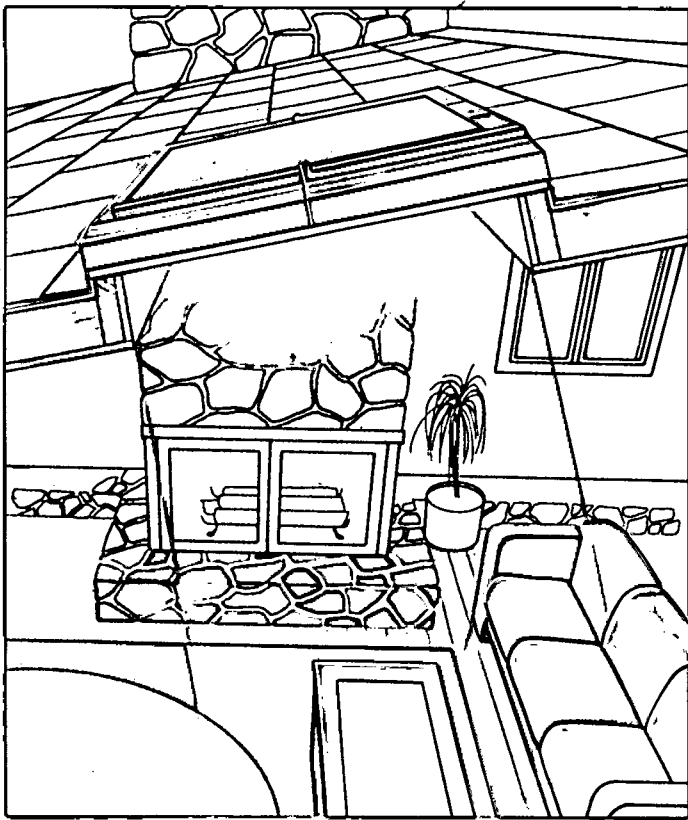

Light shafts. If you've never thought about them, here are four brilliant suggestions.

Look up. Plunge skyward. But first decide how the new Andersen® roof window can help design light into your plans.

The examples above illustrate four typical methods of light management. Use a straight shaft to focus sunlight in your direction. Or angle the roof shaft in any of the ways shown to disperse

light and cover more square area. And add stimulating light with a sunny, sky-filled view.

No matter whether you're renovating dingy attic space, giving a kitchen or bedroom a new look, or creating a dramatic entranceway, how you shape the light shaft determines how light comes into the picture.

Try it. You'll be surprised by what beautiful things can happen at sky level.