

31/6 10310 Kensington Pkwy.
31/6-89I

January 12, 1989

Flinn Park Committee Report
Submitted by Elizabeth Koontz, Chairman

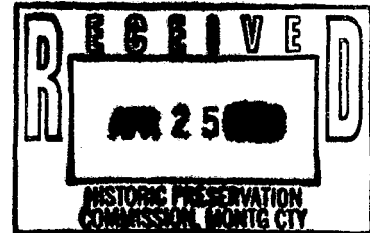

After reviewing the completed Flinn Park questionnaires, the Flinn Park Committee has reached the following conclusions about the use of Flinn Park. The results of the questionnaire indicated to us that the citizens wish Flinn Park to be used primarily for passive recreation including picnicking, sitting, and strolling as well as an occasional Town celebration such as a concert or art show.

We know from observation that the primary use people make of Flinn Park is walking through the Park from the Montgomery Avenue steps at the rear to the Post office and/or shopping area and back again.

The response on the look of the Park - formal versus rambling - was quite close and difficult for us to interpret. We feel that some of the citizens who responded for keeping the present look were actually trying to tell us they wish to keep the Park open and uncluttered rather than filled with plantings as is the case in Kennedy Park.

Since the response on the Gazebo question was also so close, we decided not to include a gazebo in our Plans as the type of gazebo we would recommend would be an authentic turn-of-the-century gazebo on a raised platform which would be quite expensive and possibly too large in mass for such a small Park.

Based on these conclusions, we are submitting two Plans we feel address the wishes and needs of the citizens. However, we are submitting Plan A only because of the financial constraints that have been put upon us due to the extraordinarily high expenditures which have been made for this Park already, with or without the Open Space Program Grant. Plan A is submitted as an immediate solution to the brick pad and walk remaining after the removal of the gazebo. Plan B is the Plan we feel best suits the citizens and the space, and Plan B is our official submission and long-term goal for Flinn Park.

PLAN A - Please refer to the drawing.

In Plan A, we suggest keeping everything in the Park as is except for the following changes:

1. Add a low natural fence of evergreen shrubbery along the front walk to define the entrance to the Park and give the Park a sense of separation from the busy street.

2. Place a bronze plaque on a waist-high pedestal at the entrance to explain something of the history of Kensington and the Historic District. The Historical Society may wish to contribute this item, but in any case should be consulted as to the wording on the plaque.

3. To the right of the walk near the front entrance, we suggest placing a bench under the lamppost as indicated for people to sit and watch the street scene. To facilitate looking at the plaque and walking to the front bench, we suggest ending the existing flower beds several yards from the street with a curve to soften the straight lines of the walk and brick pad and to allow people to walk to the plaque and to the bench at the lamppost. We suggest replacing that portion of the flower beds with grass.

4. To allow people to traverse the Park, we suggest putting in a mulch or bark path from the pad to the rear steps.

5. We suggest placing two benches on or around the brick pad.

6. To further reduce expenditures on this Park, we suggest planting low evergreens in the existing flower beds to eliminate the cost of planting and maintaining annuals and/or bulbs, and we feel the two small pyramidal evergreens could be moved up front to further define the entrance to the Park.

7. Last of all, we strongly urge the Town to remove the seven hawthorn trees around the pad. Trees with large thorns are inappropriate in a Park used by pedestrians and particularly dangerous for small children. Also, I read that hawthorn tree blossoms may give off a bad odor to attract flies for fertilization purposes when they bloom. Perhaps these trees could be grouped in another Park where people are not likely to walk or play near them.

PLAN B - Please refer to the drawing.

Plan B is the plan for Flinn Park we wish to see implemented eventually as funds become available.

1. We suggest having two entrances to the Park defined by breaks in the low evergreen border described in Plan A. Both walks would lead to the rear steps and could be mulch or bark eliminating the need for snow and ice removal. The area behind

the walks could be completely mulched and Planted using low maintenance shrubbery that could be donated as memorials or Arbor Day gifts from a specific list of desired Plantings Kept in the Town Office. There are already a few memorial Plantings in Flinn Park. The central green could be easily mowed with little or no trimming or mowing around trees and objects.

2. Benches could be Placed along the walk facing the Green center. One bench at the right front entrance could face the street for street watching.

3. The historical Plaque could be Placed at either front entrance or where the Paths split at the rear steps. There could be a Victorian Gate or arbor at the steps, and the whole Park could serve as a special entry into the Historic District.

We feel Plan B has distinct advantages in terms of long-term maintenance and also solves the functional Problem of Pedestrian traffic through the Park. When People leave the steps, they can take a Path toward the shopping area or Post office or simply enter the Green space and use the Park. The front entrances beckon People to come in and stroll around the Park or just have a seat and rest for awhile. The circular Path Pattern allows People to actually stroll around the Park, not just through it. The grassy central Green area would allow space for all the Possible uses suggested by the citizens in the Questionnaires, the Passive recreation uses as well as ball and frisbee tossing.

Plan B is the Plan we are submitting as the design we feel best fulfills the many citizen requests, and Plan B is the Plan endorsed by the LAC in the work session we had with them yesterday.

Both Plans obviously require further Professional development before they can be submitted to the HPC. We wonder whether the Open Space Program Grant would cover the fee for an impartial Professional to draw up site Plans. In any case, accurate site Plans are needed and should be available at a Town Meeting for inspection before any more Planting or work is done in Flinn Park.

In conclusion, we wish to make a few general suggestions.

Some members of the committee believe the bricks in Flinn Park are of poor quality and that the construction of the walks is inferior. We urge the Town Council to examine the walks and consider removing the brick walk and Pad in the Park as a possible solution if the walk is already deteriorating. If the bricks and/or construction are determined to be inferior, we urge the Council to seek financial compensation from the firm

who did the job.

In conjunction with this, we urge the Council to connect the Flinn Park sidewalk to the older sidewalk coming around Kensington Parkway. It makes no sense to have a sidewalk that abruptly ends at both ends.

Also, we hope the Council will Pursue the Possibility of removing some or all of the bricks in the Park and still have the cost covered by the Open Space Program Grant as Part of the Park Plan revision required by the HPC. It seems some compromise could be worked out.

Finally, we feel the Problems surrounding the Flinn Park development could be avoided at other Parks in the future if there were an ongoing Park advisory committee to Provide expertise and continuity to the ever changing Council members in charge of the Town Parks. Please give this idea some consideration.

Thank You very much.

Copies to:

Mayor Stuart
 Members of the Town Council
 Mr. Steven Karr, HPC Chairman
 Mr. Andrew Dempster, LAC Chairman
 Miss Edith Saul, Town Historian
 Concerned Flinn Park Neighbors:
 Gloria Capron, Connie Kelly,
 Lorraine Kennedy, Ray Shulman
 Flinn Park Committee Members:
 Arlene Bickel, Anne Elsbree,
 Yvonne Gurney, Judy Hanks-Henn,
 and Julie O'Malley.

Flinn Park
Plan (A)



mulch

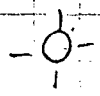
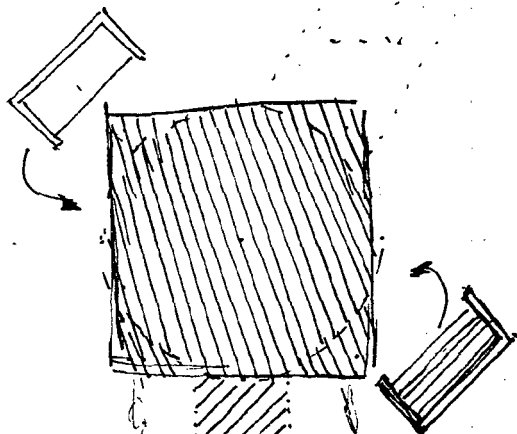

PLAQUE

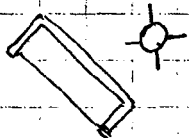

PYRAMID EVERGREENS

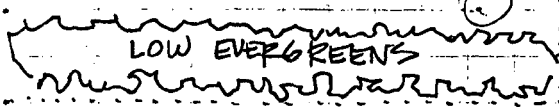

LOW EVERGREENS

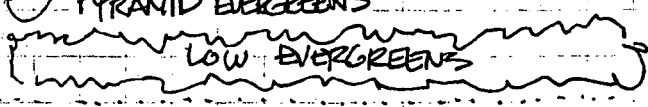

LOW EVERGREENS

(A)

Flinn Park - 0 -
Plan (B)

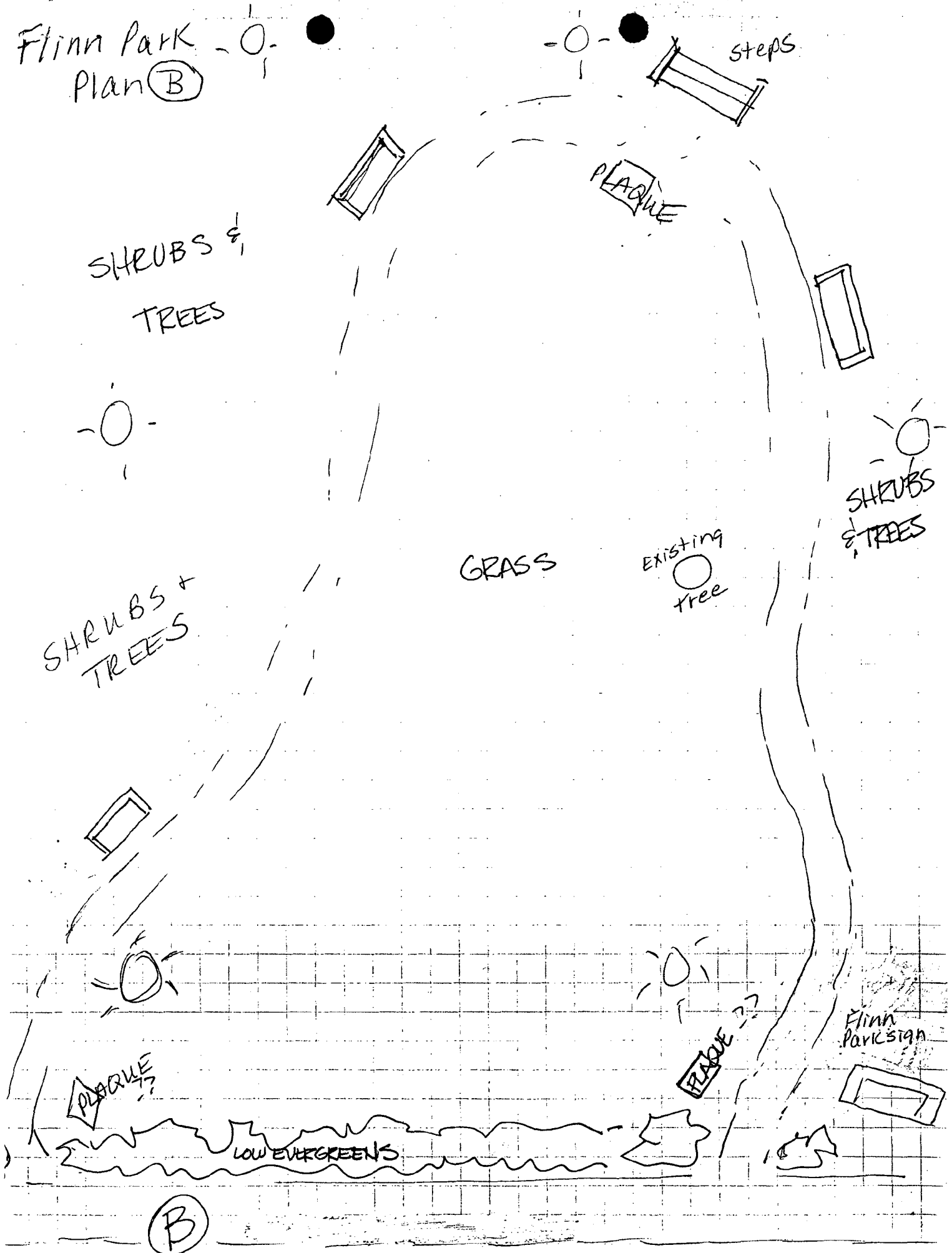

HISTORIC PRESERVATION COMMISSION STAFF REPORT

PREPARED BY: Jared B. Cooper

DATE: April 26, 1989

CASE NUMBER: #31/6 - 89I

TYPE OF REVIEW: HAWP

SITE/DISTRICT NAME: Kensington

PROPERTY ADDRESS: Flinn Park
Kensington Parkway

DISCUSSION:

In response to earlier Commission concerns, the Town of Kensington has submitted a revised plan for Flinn Park. This revised plan is a temporary design solution, until such time as the town begins preparations for further improvements as part of the centennial celebration. Essentially, the revised plan includes the removal of the gazebo and Hawthorne trees; and the addition/retention of brick walkways, sundial, shrubbery, and light fixtures (see attached specifications). Staff has requested that the applicant complete and submit a revised HAWP application.

STAFF RECOMMENDATION:

Staff recommends approval of the revised plan for Flinn Park. The proposed work is sensitive and does not constitute a negative impact in the district.

ATTACHMENTS:

1. Applicant's Written Proposal
2. Applicant's Sketch
3. Photographs

COMMISSION ACTION:

JBC:av
1079E

FLINN PARK PROPOSAL

In an effort to arrive at a satisfactory solution to the problems involving the use of Flinn Park and the clearance required for work done within the confines of the Historic District of Kensington, we formed a committee, opened our decision-making process to all town citizens by way of conversations and a park-use opinion survey circulated to every household in town.

After reading the results of the survey and talking with property owners living adjacent to the Park property, we proposed several suggestions. The Flinn Park Committee members and the Town government representatives reached an agreement as to what might be presented for Historical Preservation Commission clearance.

Our long range goal is to develop an extensive re-working plan for the Park in time for the Town's Centennial celebration. Meanwhile, so that the Park may be used and enjoyed and so that money already expended by the Town may not be wasted, we propose an interim plan which we would like to implement immediately.

Details of that plan are on the following pages.



Benches will be placed on either side of the pad and Hawthorn trees will be removed.

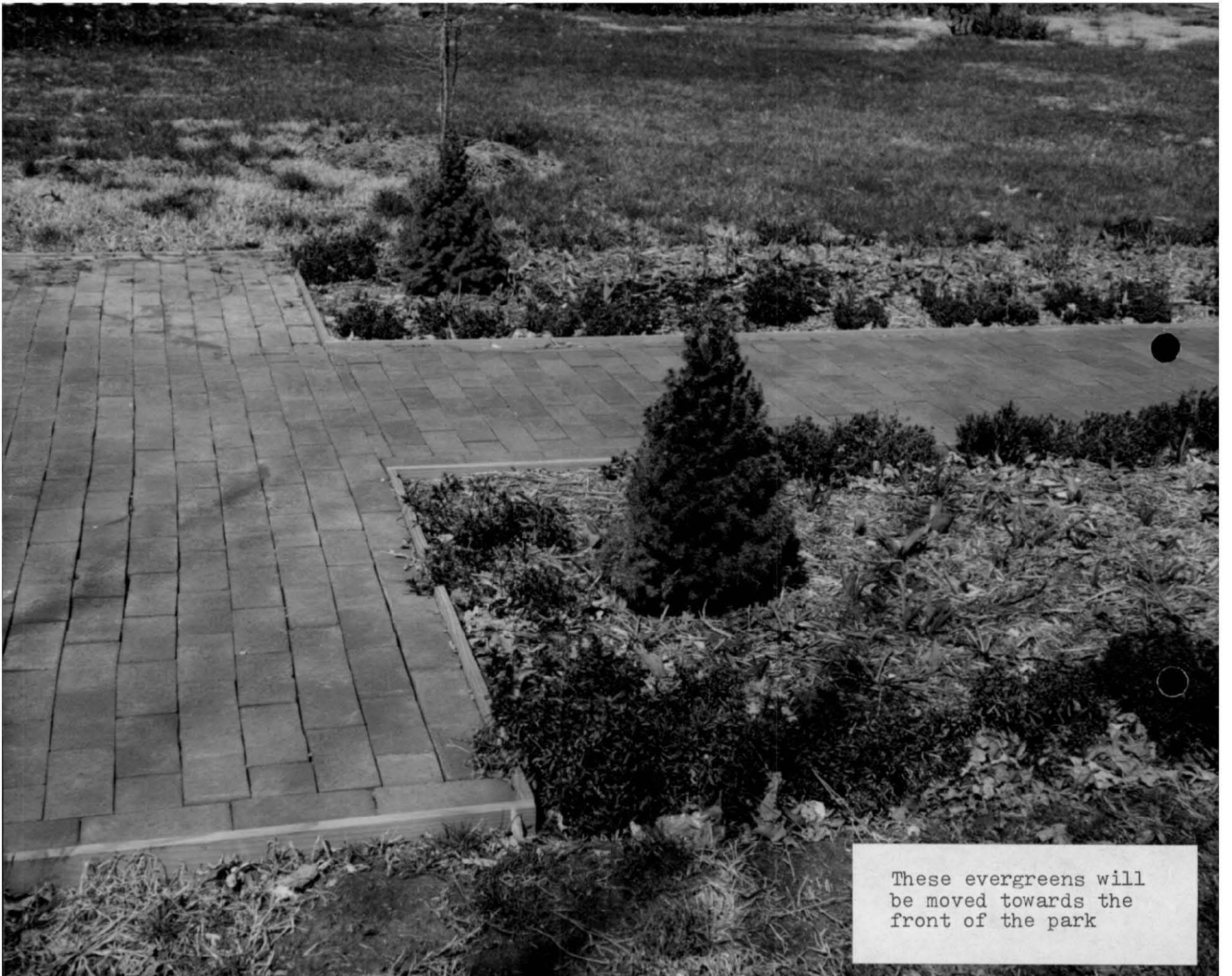

These evergreens will
be moved towards the
front of the park



Brick used on walks is
the same quality as brick
used throughout Historic
District, but Flinn Park
bricks are flat, not
curved for easier walking

A sun dial will be purchased and placed in the center of the brick pad as a focal point of the park.

The brick used in the sidewalk and the center brick pad is the same type brick used to construct sidewalks in the rest of the historic district.

The garden on the north side of the park beside the chainlink fence of neighboring property shall continue to be used by the Garden Club of Kensington for their memorial plantings.



◀ "AMIDST THE FLOWERS I TELL THE HOURS"

Two benches of the same type as now used in Clum-Kennedy Gardens will be placed in the Park with one on either side of the brick pad.



A curved mulch path (similar to those in Clum-Kennedy Gardens) will lead from the rear of the brick pad to the steps at the rear of the Park on the Montgomery Avenue side. (See attached diagram as well)





The Hawthorn trees surrounding the central brick pad will be removed from the Park and placed in other locations. The gazebo has already been removed





To further soften the effect of the park garden, the two bushes currently growing near the center brick pad will be moved towards the sidewalk where they will create the effect of the entrance to the park.





The plantings which grow beside the brick walk are currently set in a formal garden configuration. This effect will be softened by curving the ends of the garden plot (see attached drawing as well) to create a softer, gentler effect that is casual in feeling as reflected by Kensington's other garden park - the Clum Kennedy Gardens.



The lamps which have been re-wired and refurbished with new globes will remain in the park.



The sign which was furnished by Park & Planning to conform with other Kensington Park signs will remain until a donor for an artistically designed sign can be found.



CONCLUSION

BY making these changes:

- removal of gazebo
- removal of Hawthorn trees
- building mulch path to rear park entrance
- softening planting lines by curving the borders
- adding benches
- adding a sundial

We feel that the Committee and the Town representatives have worked together to bring about the best, most economically feasible solution to the problem and to meet the guidelines suggested by the Historical Preservation Committee.

Before the Centennial celebration in Kensington, the Kensington Flinn Park Committee hopes to develop a plan and a method of financing a more comprehensive park design. This design might incorporate an appropriate plaque and other rambling paths through the Park. Plans for these changes will be submitted to the HPC before actual work begins.

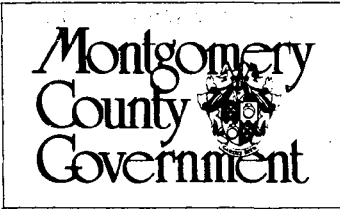

Historic Preservation Commission

51 Monroe Street, Suite 1001, Rockville, Maryland 20850
217-3625

APPLICATION FOR HISTORIC AREA WORK PERMIT

TAX ACCOUNT # _____

NAME OF PROPERTY OWNER Town of Kensington TELEPHONE NO. 301-949-2424
(Contract/Purchaser) (Include Area Code)

ADDRESS 3710 Mitchell St., Kensington, Md. 20895
CITY STATE ZIP

CONTRACTOR _____ TELEPHONE NO. _____

PLANS PREPARED BY Anne Kortf / D. Johnson CONTRACTOR REGISTRATION NUMBER _____
(Include Area Code) TELEPHONE NO. same as above

REGISTRATION NUMBER _____

LOCATION OF BUILDING/PREMISE

House Number 10310 Street Kensington Pkwy. (Flinn Park)

Town/City Kensington Election District _____

Nearest Cross Street Montgomery Avenue

Lot 2,3 Block 3 Subdivision Kensington Park, Plat 1890

Liber _____ Folio _____ Parcel _____

1A. TYPE OF PERMIT ACTION: (circle one)

Construct	Extend/Add	Alter/Renovate	Repair	Circle One: A/C	Slab	Room Addition
Wreck/Raze	Move	Install	Revocable	Porch Deck	Fireplace	Shed Solar
			<u>Revision</u>	Fence/Wall (complete Section 4)	Other	Woodburning Stove

1B. CONSTRUCTION COSTS ESTIMATE \$ 20,000.00

1C. IF THIS IS A REVISION OF A PREVIOUSLY APPROVED ACTIVE PERMIT SEE PERMIT # no

1D. INDICATE NAME OF ELECTRIC UTILITY COMPANY _____

1E. IS THIS PROPERTY A HISTORICAL SITE? part of District

PART TWO: COMPLETE FOR NEW CONSTRUCTION AND EXTEND/ADDITIONS

2A. TYPE OF SEWAGE DISPOSAL

01 () WSSC	02 () Septic
03 () Other _____	

2B. TYPE OF WATER SUPPLY

01 () WSSC	02 () Well
03 () Other _____	

PART THREE: COMPLETE ONLY FOR FENCE/RETAINING WALL

4A. HEIGHT _____ feet _____ inches

4B. Indicate whether the fence or retaining wall is to be constructed on one of the following locations:

- On party line/Property line _____
- Entirely on land of owner _____
- On public right of way/easement _____ (Revocable Letter Required).

I hereby certify that I have the authority to make the foregoing application, that the application is correct, and that the construction will comply with plans approved by all agencies listed and I hereby acknowledge and accept this to be a condition for the issuance of this permit.

Debra Johnson 5/2/89
 Signature of owner or authorized agent (agent must have signature notarized on back) Date

APPROVED X For Chairperson, Historic Preservation Commission

DISAPPROVED _____ Signature [Signature] Date 5/15/89

APPLICATION/PERMIT NO: _____ FILING FEE: \$ _____

DATE FILED: _____ PERMIT FEE: \$ _____

DATE ISSUED: _____ BALANCE \$ _____

OWNERSHIP CODE: _____ RECEIPT NO: _____ FEE WAIVED: _____

SEE REVERSE SIDE FOR INSTRUCTIONS

THE FOLLOWING ITEMS MUST BE COMPLETED AND THE REQUIRED DOCUMENTS MUST ACCOMPANY THIS APPLICATION

DESCRIPTION OF PROPOSED WORK: (including composition, color and texture of materials to be used:)

(If more space is needed, attach additional sheets on plain or lined paper to this application)

ATTACH TO THIS APPLICATION (2) COPIES OF: SUCH SITE PLANS (lot dimensions, building location with dimensions, drives, walks, fences, patios, etc. proposed or existing) and/or ARCHITECTURAL DRAWINGS (floor plans, elevations, etc.), PHOTOGRAPHS OF THE AREA AFFECTED, as are necessary to fully describe the proposed work.

MAIL OR DELIVER THE APPLICATION AND ALL REQUIRED DOCUMENTS TO THE:
HISTORIC PRESERVATION COMMISSION
100 MARYLAND AVENUE
ROCKVILLE, MARYLAND 20850

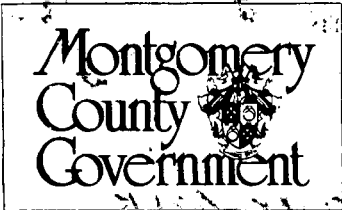

Historic Preservation Commission

51 Monroe Street, Suite 1001, Rockville, Maryland 20850
217-3625

APPLICATION FOR HISTORIC AREA WORK PERMIT

TAX ACCOUNT # _____

NAME OF PROPERTY OWNER Town of Kensington TELEPHONE NO. 301-949-2124
(Contract/Purchaser) (Include Area Code)

ADDRESS 3710 Mitchell St, Kensington, Md. STATE MD ZIP 20845

CONTRACTOR _____ TELEPHONE NO. _____

CONTRACTOR REGISTRATION NUMBER _____

PLANS PREPARED BY Anne Kortt / D. Johnson TELEPHONE NO. same as above
(Include Area Code)

REGISTRATION NUMBER _____

LOCATION OF BUILDING/PREMISE

House Number 10310 Street Kensington Park, Kensington Park

Town/City Kensington Election District _____

Nearest Cross Street Montgomery Avenue

Lot 2, 3 Block 3 Subdivision Kensington Park, Plat 1890

Liber _____ Folio _____ Parcel _____

1A. TYPE OF PERMIT ACTION: (circle one)

Construct	Extend/Add	Alter/Renovate	Repair	Circle One: A/C	Slab	Room Addition			
Wreck/Raze	Move	Install	Revocable	Porch	Deck	Fireplace	Shed	Solar	Woodburning Stove
			<u>Revision</u>	Fence/Wall (complete Section 4)	Other				

1B. CONSTRUCTION COSTS ESTIMATE \$ 20,000.00

1C. IF THIS IS A REVISION OF A PREVIOUSLY APPROVED ACTIVE PERMIT SEE PERMIT # NO

1D. INDICATE NAME OF ELECTRIC UTILITY COMPANY _____

1E. IS THIS PROPERTY A HISTORICAL SITE? part of district

PART TWO: COMPLETE FOR NEW CONSTRUCTION AND EXTEND/ADDITIONS

2A. TYPE OF SEWAGE DISPOSAL

01 () WSSC	02 () Septic
03 () Other _____	

2B. TYPE OF WATER SUPPLY

01 () WSSC	02 () Well
03 () Other _____	

PART THREE: COMPLETE ONLY FOR FENCE/RETAINING WALL

4A. HEIGHT _____ feet _____ inches

4B. Indicate whether the fence or retaining wall is to be constructed on one of the following locations:

- On party line/Property line _____
- Entirely on land of owner _____
- On public right of way/easement _____ (Revocable Letter Required).

I hereby certify that I have the authority to make the foregoing application, that the application is correct, and that the construction will comply with plans approved by all agencies listed and I hereby acknowledge and accept this to be a condition for the issuance of this permit.

Debra Johnson _____ Date 5/2/89
Signature of owner or authorized agent (agent must have signature notarized on back)

APPROVED X For Chairperson, Historic Preservation Commission

DISAPPROVED _____ Signature [Signature] Date 5/15/89

APPLICATION/PERMIT NO: _____ FILING FEE: \$ _____

DATE FILED: _____ PERMIT FEE: \$ _____

DATE ISSUED: _____ BALANCE \$ _____

OWNERSHIP CODE: _____ RECEIPT NO: _____ FEE WAIVED: _____

SEE REVERSE SIDE FOR INSTRUCTIONS

THE FOLLOWING ITEMS MUST BE COMPLETED AND THE REQUIRED DOCUMENTS MUST ACCOMPANY THIS APPLICATION

DESCRIPTION OF PROPOSED WORK: (including composition, color and texture of materials to be used:)

(If more space is needed, attach additional sheets on plain or lined paper to this application)

ATTACH TO THIS APPLICATION (2) COPIES OF: SUCH SITE PLANS (lot dimensions, building location with dimensions, drives, walks, fences, patios, etc. proposed or existing) and/or ARCHITECTURAL DRAWINGS (floor plans, elevations, etc.), PHOTOGRAPHS OF THE AREA AFFECTED, as are necessary to fully describe the proposed work.

MAIL OR DELIVER THE APPLICATION AND ALL REQUIRED DOCUMENTS TO THE:
HISTORIC PRESERVATION COMMISSION
100 MARYLAND AVENUE
ROCKVILLE, MARYLAND 20850

F-44

Mr. Steven Karr and
members of the HPC

Regarding Town of Kensington application for
retroactive HAWP for Flinn Park development
last discussed November 3

January 12, 1989

Flinn Park Committee Report
Submitted by Elizabeth Koontz, Chairman

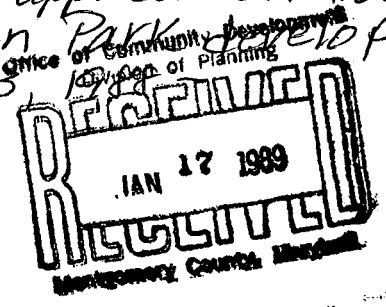

After reviewing the completed Flinn Park questionnaires, the Flinn Park Committee has reached the following conclusions about the use of Flinn Park. The results of the questionnaire indicated to us that the citizens wish Flinn Park to be used primarily for passive recreation including picnicking, sitting, and strolling as well as an occasional Town celebration such as a concert or art show.

We know from observation that the primary use people make of Flinn Park is walking through the park from the Montgomery Avenue steps at the rear to the post office and/or shopping area and back again.

The response on the look of the park - formal versus rambling - was quite close and difficult for us to interpret. We feel that some of the citizens who responded for keeping the present look were actually trying to tell us they wish to keep the park open and uncluttered rather than filled with plantings as is the case in Kennedy Park.

Since the response on the gazebo question was also so close, we decided not to include a gazebo in our plans as the type of gazebo we would recommend would be an authentic turn-of-the-century gazebo on a raised platform which would be quite expensive and possibly too large in mass for such a small park.

Based on these conclusions, we are submitting two plans we feel address the wishes and needs of the citizens. However, we are submitting Plan A only because of the financial constraints that have been put upon us due to the extraordinarily high expenditures which have been made for this park already, with or without the Open Space Program grant. Plan A is submitted as an immediate solution to the brick pad and walk remaining after the removal of the gazebo. Plan B is the plan we feel best suits the citizens and the space, and Plan B is our official submission and long-term goal for Flinn Park.

PLAN A - Please refer to the drawing...

In Plan A, we suggest keeping everything in the park as is except for the following changes:

1. Add a low natural fence of evergreen shrubbery along the front walk to define the entrance to the Park and give the Park a sense of separation from the busy street.

2. Place a bronze plaque on a waist-high pedestal at the entrance to explain something of the history of Kensington and the Historic District. The Historical Society may wish to contribute this item, but in any case should be consulted as to the wording on the plaque.

3. To the right of the walk near the front entrance, we suggest placing a bench under the lamppost as indicated for people to sit and watch the street scene. To facilitate looking at the plaque and walking to the front bench, we suggest ending the existing flower beds several yards from the street with a curve to soften the straight lines of the walk and brick pad and to allow people to walk to the plaque and to the bench at the lamppost. We suggest replacing that portion of the flower beds with grass.

4. To allow people to traverse the Park, we suggest putting in a mulch or bark path from the pad to the rear steps.

5. We suggest placing two benches on or around the brick pad.

6. To further reduce expenditures on this Park, we suggest planting low evergreens in the existing flower beds to eliminate the cost of planting and maintaining annuals and/or bulbs, and we feel the two small pyramidal evergreens could be moved up front to further define the entrance to the Park.

7. Last of all, we strongly urge the Town to remove the seven hawthorn trees around the pad. Trees with large thorns are inappropriate in a Park used by pedestrians and particularly dangerous for small children. Also, I read that hawthorn tree blossoms may give off a bad odor to attract flies for fertilization purposes when they bloom. Perhaps these trees could be grouped in another Park where people are not likely to walk or play near them.

PLAN B - Please refer to the drawings.

Plan B is the plan for Flinn Park we wish to see implemented eventually as funds become available.

1. We suggest having two entrances to the Park defined by breaks in the low evergreen border described in Plan A. Both walks would lead to the rear steps and could be mulch or bark, eliminating the need for snow and ice removal. The area behind

the walks could be completely mulched and Planted using low maintenance shrubbery that could be donated as memorials or Arbor Day gifts from a specific list of desired Plantings kept in the Town Office. There are already a few memorial Plantings in Flinn Park. The central Green could be easily mowed with little or no trimming or mowing around trees and objects.

2. Benches could be Placed along the walk facing the Green center. One bench at the right front entrance could face the street for street watching.

3. The historical Plaque could be Placed at either front entrance or where the Paths split at the rear steps. There could be a Victorian Gate or arbor at the steps, and the whole Park could serve as a special entry into the Historic District.

We feel Plan B has distinct advantages in terms of long-term maintenance and also solves the functional Problem of Pedestrian traffic through the Park. When People leave the steps, they can take a Path toward the shopping area or Post office or simply enter the Green space and use the Park. The front entrances beckon People to come in and stroll around the Park or just have a seat and rest for awhile. The circular Path Pattern allows People to actually stroll around the Park, not just through it. The grassy central Green area would allow space for all the possible uses suggested by the citizens in the questionnaires, the passive recreation uses as well as ball and frisbee tossing.

Plan B is the Plan we are submitting as the design we feel best fulfills the many citizen requests, and Plan B is the Plan endorsed by the LAC in the work session we had with them yesterday.

Both Plans obviously require further Professional development before they can be submitted to the HPC. We wonder whether the Open Space Program Grant would cover the fee for an impartial Professional to draw up site Plans. In any case, accurate site Plans are needed and should be available at a Town Meeting for inspection before any more Planting or work is done in Flinn Park.

In conclusion, we wish to make a few general suggestions.

Some members of the committee believe the bricks in Flinn Park are of poor quality and that the construction of the walks is inferior. We urge the Town Council to examine the walks and consider removing the brick walk and Pad in the Park as a possible solution if the walk is already deteriorating. If the bricks and/or construction are determined to be inferior, we urge the Council to seek financial compensation from the firm.

who did the job.

In conjunction with this, we urge the Council to connect the Flinn Park sidewalk to the older sidewalk coming around Kensington Parkway. It makes no sense to have a sidewalk that abruptly ends at both ends.

Also, we hope the Council will Pursue the Possibility of removing some or all of the bricks in the Park and still have the cost covered by the Open Space Program Grant as Part of the Park Plan revision required by the HPC. It seems some compromise could be worked out.

Finally, we feel the Problems surrounding the Flinn Park development could be avoided at other Parks in the future if there were an ongoing Park advisory committee to Provide expertise and continuity to the ever changing Council members in charge of the Town Parks. Please give this idea some consideration.

Thank You very much.

Copies to:

Mayor Stuart
 Members of the Town Council
 Mr. Steven Karr, HPC Chairman
 Mr. Andrew Dempster, LAC Chairman
 Miss Edith Saul, Town Historian
 Concerned Flinn Park Neighbors:
 Gloria Capron, Connie Kelly,
 Lorraine Kennedy, Ray Shulman
 Flinn Park Committee Members:
 Arlene Bickel, Anne Eisbree,
 Yvonne Gurney, Judy Hanks-Henn,
 and Julie O'Malley.

Flinn Park
Plan (A)



mulch

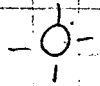
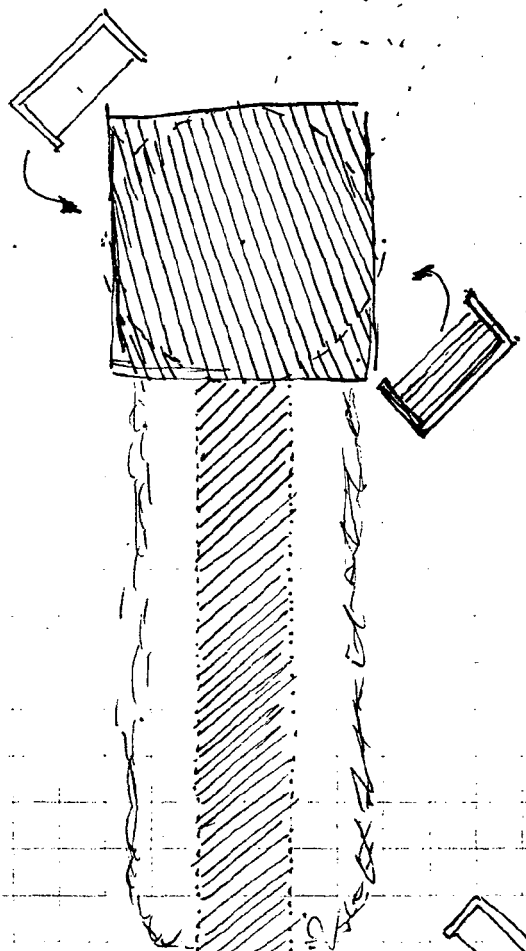

PLAQUE



LOW EVERGREENS

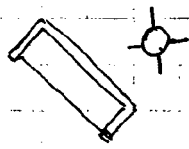

PYRAMID EVERGREENS

LOW EVERGREENS

(A)

Flinn Park
Plan (B)

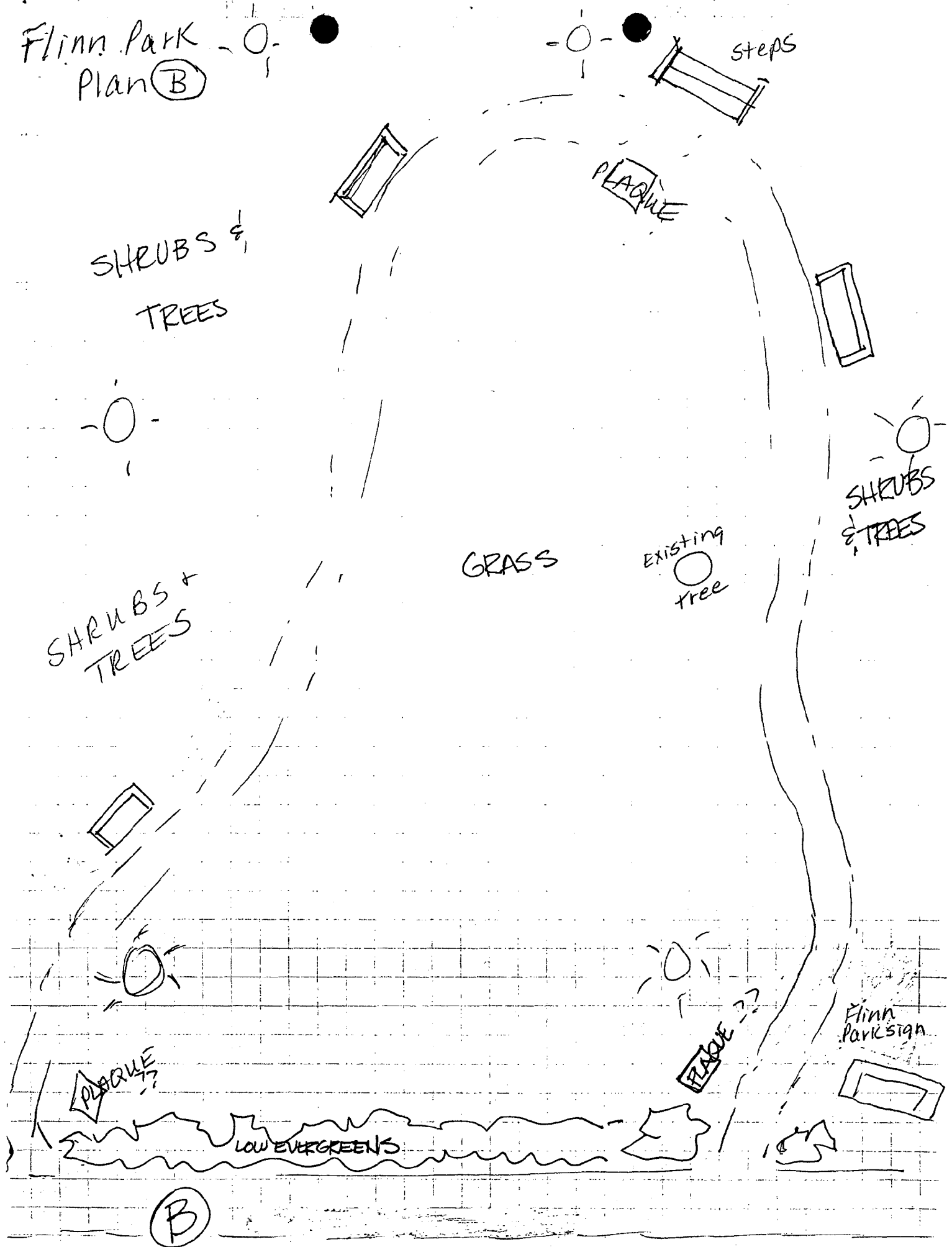

QUESTIONNAIRE ABOUT FLINN PARK

Please let us know your wishes about the uses of Flinn Park.

1. How often do you and your family members use Flinn Park?
21 Often 13 Once A Month 10 Seldom 9 Never
1 visually *1 visually* *1 physically*

2. Please check each of the following activities which you think the park should be used for by town citizens:

12 playing ball 10 playing frisbee 28 staging concerts

31 eating lunch 34 picnicking 39 sitting quietly
✓ 1 bake sales, 1 weddings, 1 strolling (6), 1 holiday
 other uses (name them) 1 gatherings for children
and teens

3. Do you think there should be a gazebo in the Park 18 yes 20 no
 If "yes" where do you think it should be located? 4 3
separate spouse votes

8 on the brick pad in place of the old one *also 2 votes*
8 center lot but further back *for a bandstand +*
11 to the rear under the trees *3 for a wooden gazebo only*

3 on the right side near Park Sign
1 right hand rear corner; *also, see 2 drawings*
 other location (name) *1 return the gazebo that was there*

4. Do you feel the straight walk and neat, formal garden plantings now in the park should be retained or should the look be more rambling as in Kennedy Park?

23 keep present look 20 change to rambling
4 spouse votes 4 spouses

5. How would you design the park --- you can change the brick walkways and plantings -- to enhance its appearance while minimizing the expense of changing the walks, plantings, etc.

remove everything & return it to grass = 11
spouse = 1
sell to a developer to build house(s) = 1

Name: _____ Address: _____
remove hawthorne trees = (3)

see attached sheet for more
 Please return this form to Town Office no later than December 16
citizen comments

Citizens suggestions under item #5

use of brick pad: sundial

- fountain
- plaque with brief history of Kensington
- create softer lines around the pad and walk

gazebo: wooden

- seats inside
- appropriate design

park benches: wooden Chippendale benches around the park

- place them around the perimeter both in shade and sun
 - construct brick areas in front of benches (or some other substance such as mulch) to make seating areas more inviting
 - place a couple picnic tables to the left (try to have them donated)
 - put benches on circular brick pad and remove walk and return that area to grass
 - place benches along walk or path from front to rear steps
 - avoid hardware city type picnic benches
- the path to the steps: continue from pad to steps
- meander down side of park to steps
 - have mulched path - front to rear, rambling around perimeter with low maintenance gardens along path; open green center;

- have dirt path as in Kennedy Park (or mulch)
- have no walk or path; people will walk in a straight line to get across park depending on destination as they leave the steps; they will ignore a meandering indirect path

- flowers and trees, etc: put more trees + shrubs in
- keep flower beds along perimeter of park only as the beds are ugly when flowers are not in bloom
 - have flowers here and there along path from steps to front walk
 - expand the current plan to include more formal gardens or have a formal Victorian box hedge garden
 - all plantings should be along sides so as not to interfere with open space
 - have a garden club take on the project
 - hawthorne trees have thorns and are too dangerous for a park setting

15 NOV 88

Subject: Flinn Park Proposal
From: John E. Thompson
Councilmember
To: Flinn Park Committee

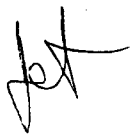

In response to the questions posed by the Flinn Park Committee I submit the following reply.

Question 1 How would you and members of your family like to use Flinn Park?

Passive recreational activity

Question 2 Do you want a gazebo in Flinn Park?

No

Question 3 Do you have any ideas to enhance the appearance and use of the brick walkway and minimize the expense of redesign?

Leave the walkway as presently configured.

Suggestion

I have recently traveled to Frederick County and happened to see an abandoned windmill reminiscent of the Victorian era. Photographs of early Kensington show many windmills throughout the town. Perhaps one (windmill) could be acquired and placed on the brick pad at the end of the walk. I believe that this addition would be compatible with the character of the historic district and relate directly to the early town.

QUESTIONNAIRE ABOUT FLINN PARK

Please let us know your wishes about the uses of Flinn Park.

1. How often do you and your family members use Flinn Park?

Often Once A Month Seldom Never

2. Please check each of the following activities which you think the park should be used for by town citizens:

playing ball playing frisbee staging concerts

eating lunch picnicking sitting quietly

other uses (name them) *Walk across to get from steps to shopping org*

3. Do you think there should be a gazebo in the Park yes no

If "yes" where do you think it should be located?

on the brick pad in place of the old one

center lot but further back

to the rear under the trees

on the right side near Park Sign

Other location (name)

4. Do you feel the straight walk and neat, formal garden plantings now in the park should be retained or should the look be more rambling as in Kennedy Park?

keep present look change to rambling

5. How would you design the park --- you can change the brick walkways and plantings -- to enhance its appearance while minimizing the expense of changing the walks, plantings, etc.

attached

Name: *Edith Ray Paul* Address: *10310 Jansett St.*

Please return this form to Town Office no later than December 16

reen sv
ees and
known
pad I
ly enla
or comp
istory
ould t
d's end
pt low
an in
s shoul
ss and
rees ar
owering
n-of-th
through
B.
-Dawes
Farm
ending
al has
k wall
in fron
of ap
s who
plannin
tury K
ment o
in-pub

27 November 1988

I regret the passing of Flinn Park's green sward with tables and benches around the sides among the existing trees and shrubbery. It had the flavor of the Kensington I have always known!

However if we are stuck with the brick pad I offer the following suggestions:

1. Redesign the end of the pad, slightly enlarging it so as to hold a handsome pedestal of stone (or composition) on which is a bronze plaque bearing a capsule history of Kensington. After all we are historic by law and we should tell the public why.
2. A pair of low seats to share the pad's end with the pedestal. If this grouping of furniture is kept low it might do something to correct the mistake of centering an intrusion onto the very center of the park.
3. Maybe each set of tables-and-benches should have a well designed pad under it to protect from dampness and insects?
4. PLANTING.

Why not a Fragrant Garden with trees and shrubs selected for a succession of sweet flowering?

Why not a Period Garden with turn-of-the-century flora? Most historic districts throughout the country are developing period gardens. We have several in our area - Poole House, Beall-Dawson House, Heurich Mansion, Accotek Colonial Farm, etc.

Lastly, I suggest that the Town organize a standing Advisory Committee on Parks & Street Trees. The War Memorial has not been finished and is in need of maintenance. The brick wall along Railroad is slowly losing its plantings. The park in front of Prevention of Blindness needs to be screened from backs of apartment buildings on Fawcett Street.

Such a standing committee of residents who have some horticultural design interest would give continuity in planning and maintaining our public grounds. In the late 19th century Maryland felt the need for "municipalities" so as to bring government close to the people. Let's think of structuring such resident in-put!

E.R.Saul
10310 Fawcett Street

QUESTIONNAIRE ABOUT FLINN PARK

Please let us know your wishes about the uses of Flinn Park.

How often do you and your family members use Flinn Park?

Often Once A Month Seldom Never

Please check each of the following activities which you think the park should be used for by town citizens:

playing ball playing frisbee staging concerts

eating lunch picnicking sitting quietly

other uses (name them)

Do you think there should be a gazebo in the Park yes no

If "yes" where do you think it should be located?

on the brick pad in place of the old one

center lot but further back

to the rear under the trees

on the right side near Park Sign

other location (name)

Do you feel the straight walk and neat, formal garden plantings now in the park should be retained or should the look be more rambling as in Kennedy Park?

keep present look change to rambling

How would you design the park --- you can change the brick walkways and plantings -- to enhance its appearance while minimizing the expense of changing the walks, plantings, etc.

Name: Spencer, Barbara Harrell Address: 3810 Warner St.

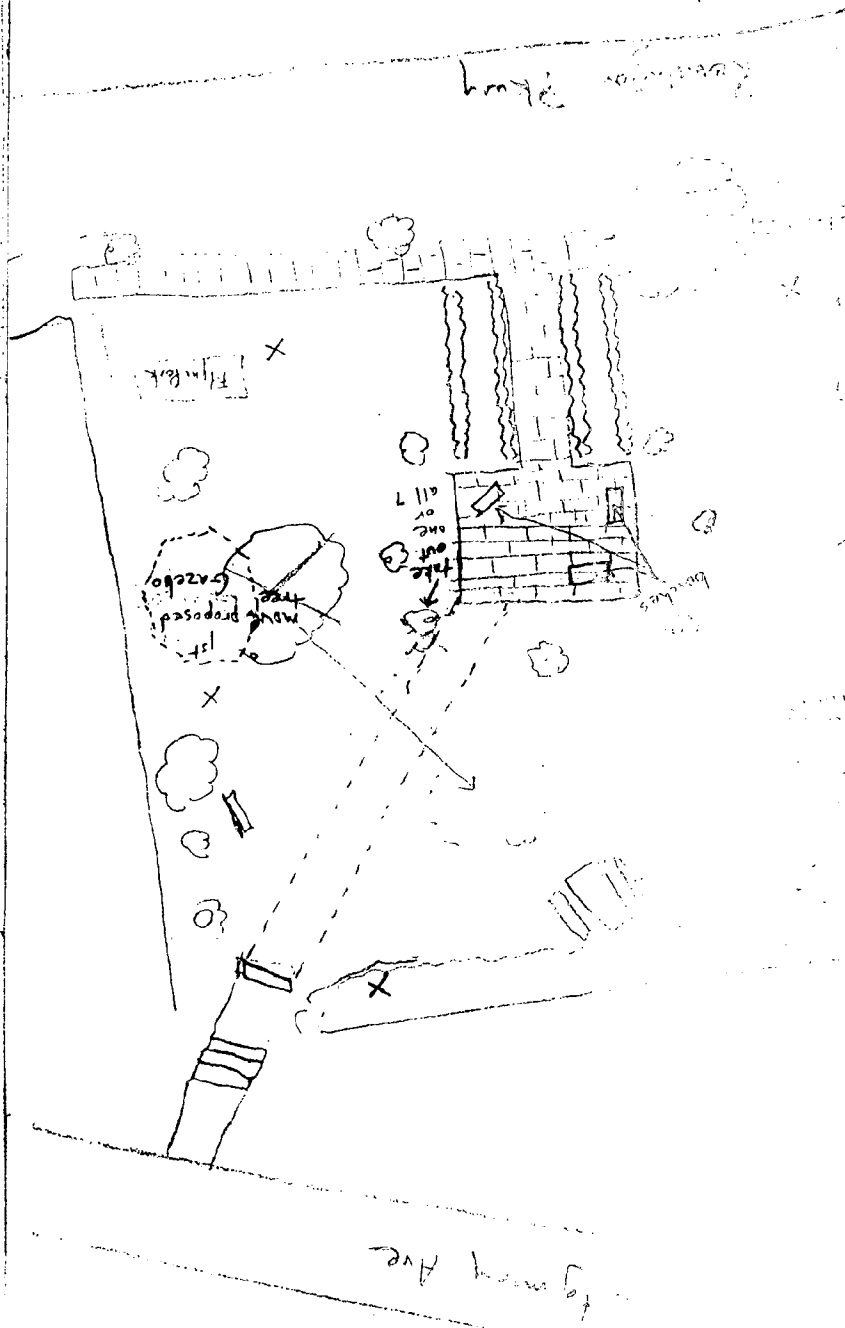

Please return this form to Town Office no later than December 16

background
 if enough
 should use the
 way for their
 would that is
 the park
 for a playground
 every street
 with ball or
 ground

H. U. S. R.

sum of this
 time should
 let at least
 to provide a
 to identify
 that the
 it could be
 not let
 numbers
 the gold
 small
 in areas
 park to be proud of

Kennedy
 azaleas Rhodod.

Place to be
 used more
 for a
 almost there
 in
 to

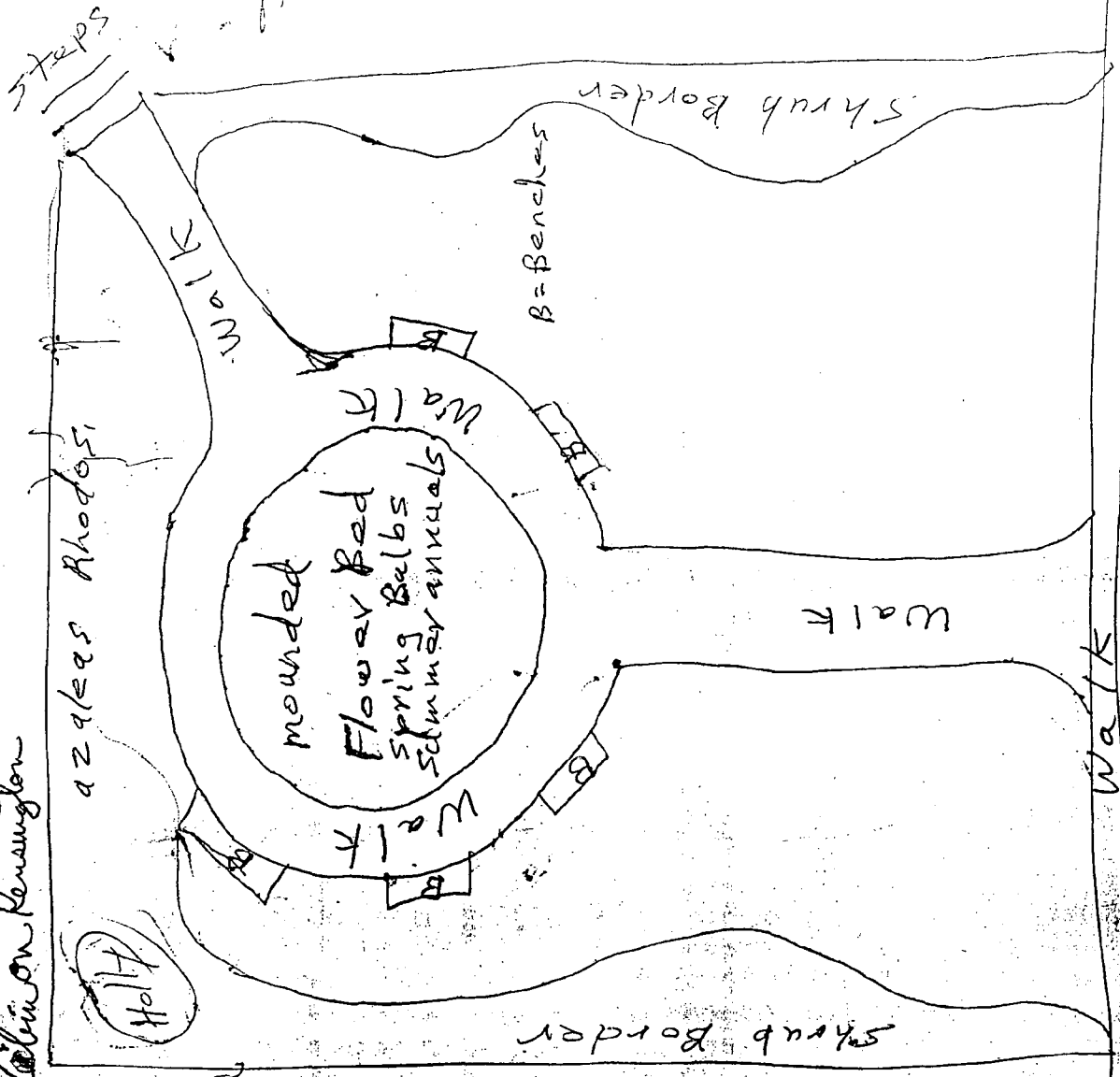

House

QUESTIONNAIRE ABOUT FLINN PARK

Please let us know your wishes about the uses of Flinn Park.

1. How often do you and your family members use Flinn Park?

Often _____ Once A Month ~~_____~~ Seldom _____ Never

2. Please check each of the following activities which you think the park should be used for by town citizens:

_____ playing ball _____ playing frisbee _____ staging concerts

_____ eating lunch _____ picnicking sitting quietly

_____ other uses (name them) *(Not a playground
gets cabin on parkway not large enough)*

3. Do you think there should be a gazebo in the Park yes no

If "yes" where do you think it should be located?

_____ on the brick pad in place of the old one

_____ center lot but further back

_____ to the rear under the trees

_____ on the right side near Park Sign

_____ Other location (name)

4. Do you feel the straight walk and neat, formal garden plantings now in the park should be retained or should the look be more rambling as in Kennedy Park?

keep present look *with modification (See over side)* _____ change to rambling ~~_____~~

5. How would you design the park --- you can change the brick walkways and plantings -- to enhance its appearance while minimizing the expense of changing the walks, plantings, etc.

Name: Dorothy R. Sherman Address: 3602 Kambell *over*

Please return this form to Town Office no later than December 10.

December 20, 1988

Dear Flinn Park Committee Members,

I am so glad each of you called and asked to be on this committee. Each of you brings a different area of expertise to the group, and I couldn't have chosen a better committee.

Enclosed is a summary of the results of the questionnaire on Flinn Park. I believe the citizens were somewhat confused about question #4. When Anne Koiff used Kennedy Park as an example of an informal garden in preparing the questionnaire, I believe some people felt the choice was between a Flinn Park totally filled with plantings or Flinn Park as open space. In marking "Keep present look", some may have been telling us they wish to keep a look of open space, not necessarily a formal garden. I got this feeling from some of the comments written on the questionnaires. At any rate, I don't believe the question #4 results adequately reflect citizen attitudes.

Here is the timeframe as it stands now.

1. You think about the design and get your ideas back to me somehow by the morning of Tuesday, January 3rd. I will be out of town from Sunday, Dec-25th until late Tuesday, Dec. 27th

and again from Thursday night, Dec-29th until late Monday, Jan. 2nd. Maybe you could mail your ideas or leave them between the back door and storm door on our back porch.

I have arranged with most of you a way for you to see the copies of the questionnaires. The citizen comments are very helpful, I think, so I hope all of you can find an hour to read them.

2. The week of January 2nd I will meet with Charlie Stuart and Ray Shulman representing the LAC, together if we can arrange it or separately, to get their input.

3. Then ^{postponed to} Monday, ^{Wednesday,} January 9th I'll take all the ideas before the LAC for an informal work session. It would be helpful if each of you could attend this meeting, too. Call me that Monday for the time.

4. Then I'm hoping we as a committee can have a meeting at my house one evening shortly thereafter to brainstorm and really put a plan together.

5. The town is supposed to return to the HPC for their first meeting in February to present the park plan or plans, however I think this can be postponed

if necessary.

Two final points -

First, we are an ad hoc advisory committee to the town Council only. We will give our suggestions to them and hope for the best.

Second, I think we should be designing the park as a two-part plan. We should propose an immediate and inexpensive solution to the current situation as well as a long-term plan in which different elements are added over some years as funds become available or perhaps as memorial plantings are donated, etc. While it is my understanding the Project Open Space grant obtained by the town will cover 75% of the park development expenses, over \$20,000⁰⁰ has already been spent. The original cost estimate given to Project Open Space with the town's application for the 75% grant was only \$11,300⁰⁰. I'm not sure how much of a cost overrun Project Open Space will tolerate. In any case, Charlie has told me we should try to keep expenses to a minimum right now.

Please call back often to exchange ideas if you feel like it.

Committee Members: Bitay Koontz 946-5451

Arlene Buckel 933-1375

Ann Elstree 949-7825 - Ann will be
away the first two weeks in January

Yvonne Gurney 942-2639

Judy Hanks-Henn 942-0963

Julie O'Malley 942-8933

Concerned neighbors who have expressed
ideas and could be consulted:

Gloria Capron 933-3992

Terraine Kennedy 949-2583

Connie Kelly 949-3447

Gene Shulman 949-0395

My cohort at all the HPC meetings, Edith
Saul, has many ideas - see attached
sheet - and could be consulted
949-7635

Andrew Dempster, Chairman of the LAC,
also attended all pertinent meetings
and may be consulted H: 949-4670

W: 495-4527

Ray Shulman is representing the LAC
and will be in on everything and
may be consulted 949-0395

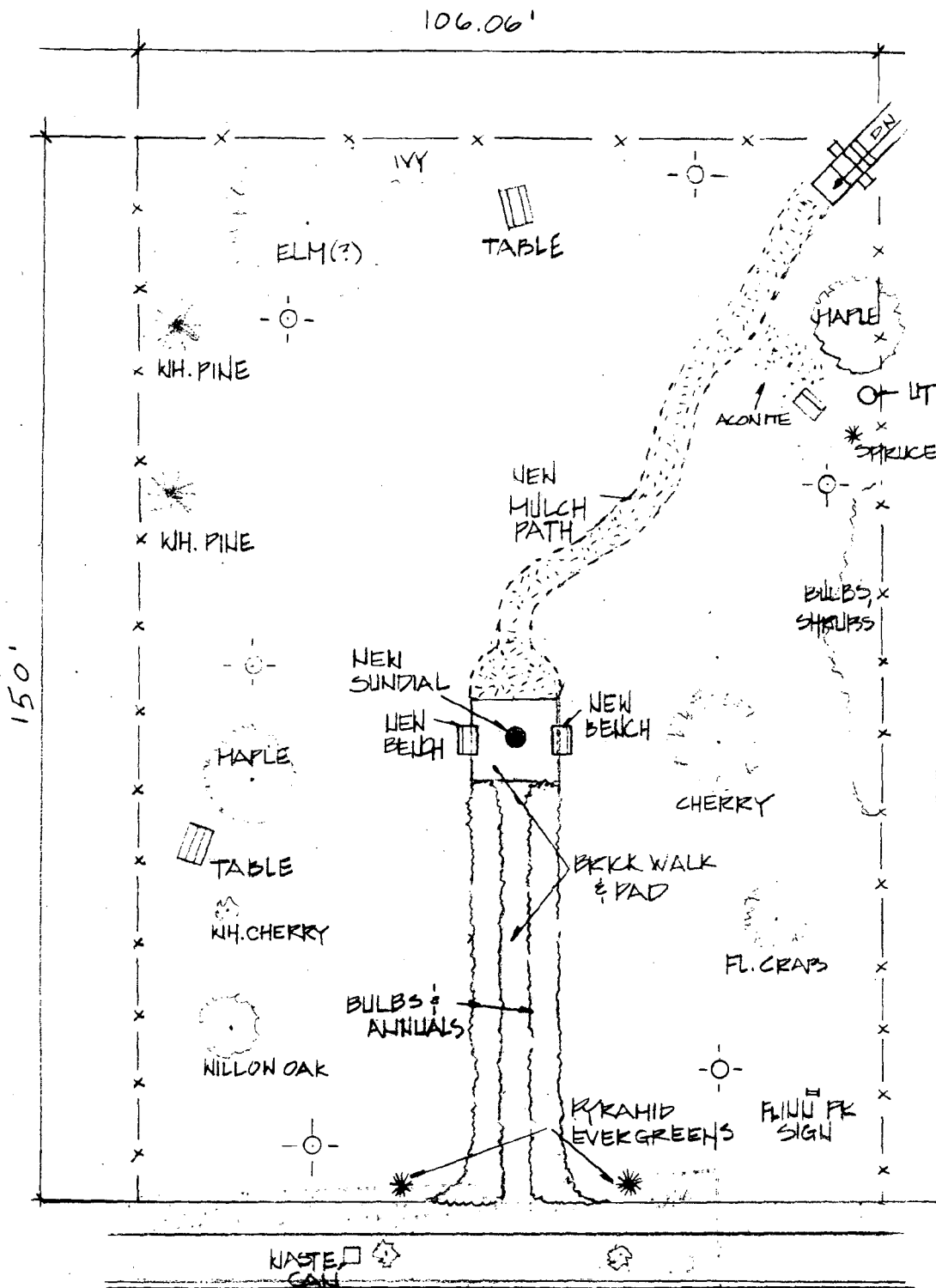

RECEIVED
MAY - 9 1989
HISTORIC PRESERVATION
COMMISSION, MONTG. CTY

SCALE
1" = 20'-0"

KENNINGTON PKWY

KENSINGTON PARK
BLOCK 3, LOTS 2 & 3
PLAT: 1890

FLINN PARK
KENSINGTON, MD
APRIL 2, 1989

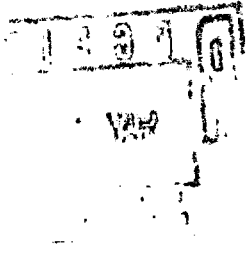

MONTGOMERY COUNTY HIST. PRES. COMM.	
Case No. <u>31/6-891</u>	Meeting Date <u>5/4/89</u>
Approved <u>X</u>	Denied _____
Conditions <u>per revised drawing</u>	

Signature <u>[Handwritten Signature]</u>	Date <u>5/5/89</u>