

31/7 10005 Pratt Pl.
HAWP 23-88

g



Historic Preservation Commission

100 Maryland Avenue, Rockville, Maryland 20850
~~279-1327~~
279-8097

51 Monroe Street, Rm. 1009
Rockville, MD 20850

APPLICATION FOR HISTORIC AREA WORK PERMIT

TAX ACCOUNT # _____

NAME OF PROPERTY OWNER Elizabeth P. Rabben d TELEPHONE NO. 301 588 1323
(Contract/Purchaser) Mason B FLAGG (Include Area Code)

ADDRESS 1005 PRATT Place Silver Spring CITY STATE MD ZIP 20910

CONTRACTOR Long Fence Co. TELEPHONE NO. 428 9040
CONTRACTOR REGISTRATION NUMBER _____

PLANS PREPARED BY E. Rabben TELEPHONE NO. 588 1323
(Include Area Code)

REGISTRATION NUMBER _____

LOCATION OF BUILDING/PREMISE

House Number 1005 Street PRATT PL.

Town/City Silver Spring Md. Election District _____

Nearest Cross Street Capitol View

Lot 3B Block 29 Subdivision Capitol View Park

Liber 6547 Folio 493 Parcel _____

1A. TYPE OF PERMIT ACTION: (circle one)

<input checked="" type="checkbox"/> Construct	<input type="checkbox"/> Extend/Add	<input type="checkbox"/> Alter/Renovate	<input type="checkbox"/> Repair	Circle One: A/C	Slab	Room Addition
<input type="checkbox"/> Wreck/Raze	<input type="checkbox"/> Move	<input type="checkbox"/> Install	<input type="checkbox"/> Revocable	<input type="checkbox"/> Porch	<input type="checkbox"/> Deck	<input type="checkbox"/> Fireplace
			<input type="checkbox"/> Revision	<input checked="" type="checkbox"/> Fence/Wall (complete Section 4)	<input type="checkbox"/> Shed	<input type="checkbox"/> Solar
					<input type="checkbox"/> Woodburning Stove	<input type="checkbox"/> Other _____

1B. CONSTRUCTION COSTS ESTIMATE \$ \$2000.

1C. IF THIS IS A REVISION OF A PREVIOUSLY APPROVED ACTIVE PERMIT SEE PERMIT # n/a

1D. INDICATE NAME OF ELECTRIC UTILITY COMPANY n/a

1E. IS THIS PROPERTY A HISTORICAL SITE? No

PART TWO: COMPLETE FOR NEW CONSTRUCTION AND EXTEND/ADDITIONS

2A. TYPE OF SEWAGE DISPOSAL

01 () WSSC	02 () Septic
03 () Other _____	

2B. TYPE OF WATER SUPPLY

01 () WSSC	02 () Well
03 () Other _____	

PART THREE: COMPLETE ONLY FOR FENCE/RETAINING WALL

4A. HEIGHT 4 feet 0 inches

4B. Indicate whether the fence or retaining wall is to be constructed on one of the following locations:

- On party line/Property line Adjoining property owners have approved property line fence.
- Entirely on land of owner _____
- On public right of way/easement _____ (Revocable Letter Required).

I hereby certify that I have the authority to make the foregoing application, that the application is correct, and that the construction will comply with plans approved by all agencies listed and I hereby acknowledge and accept this to be a condition for the issuance of this permit.

E.P. Rabben Signature of owner or authorized agent (agent must have signature notarized on back)

M.B. Flagg _____ Date 6/30/88

APPROVED For Chairperson, Historic Preservation Commission

DISAPPROVED _____ Signature Adrian Hahn Date 7/25/88

APPLICATION/PERMIT NO: HAWP 23-88 FILING FEE: \$ _____

DATE FILED: _____ PERMIT FEE: \$ _____

DATE ISSUED: _____ BALANCE \$ _____

OWNERSHIP CODE: _____ RECEIPT NO: _____ FEE WAIVED: _____

SEE REVERSE SIDE FOR INSTRUCTIONS

Condition: two gates are to be added to the fence to allow traffic to flow through the common open space

THE FOLLOWING ITEMS MUST BE COMPLETED AND THE REQUIRED DOCUMENTS MUST ACCOMPANY THIS APPLICATION

DESCRIPTION OF PROPOSED WORK: (including composition, color and texture of materials to be used:)

4 FT Picket fence - Vertical Pickets to be made
of Cedar, Posts to be of Pressure Treated
Pine. 5' Pickets to be placed in low land areas.
Stairway - from 1st story deck onto Back yard
from left side of house - To be of Pressure
Treated Lumber.

Adjoining Property Owners Take no exception to
extending fence line to Enclose a portion of Common
area to the rear of property line (Toward B+O R.R.).
Applicants agree to maintain enclosed common area at or
exceeding present standards, and agree to waive any right of
ownership by virtue of "common law" possession of the common area.
(If more space is needed, attach additional sheets on plain or lined paper to this application)

ATTACH TO THIS APPLICATION (2) COPIES OF: SUCH SITE PLANS (lot dimensions, building location with dimensions, drives, walks, fences, patios, etc. proposed or existing) and/or ARCHITECTURAL DRAWINGS (floor plans, elevations, etc.), PHOTOGRAPHS OF THE AREA AFFECTED, as are necessary to fully describe the proposed work.

MAIL OR DELIVER THE APPLICATION AND ALL REQUIRED DOCUMENTS TO THE:
HISTORIC PRESERVATION COMMISSION
100 MARYLAND AVENUE
ROCKVILLE, MARYLAND 20850

MONTGOMERY COUNTY HISTORIC PRESERVATION COMMISSION

LOCAL ADVISORY COMMITTEE REVIEW FORM

EXTERIOR ALTERATIONS

I. Location of property

a. Located within the CAPITOL VIEW historic district.

? b. This is a Master Plan/Atlas historic district (circle one).

c. Address of Property: 10005 PRATT PLACE

SILVER SPRING, MD. 20910

d. Property owner's name, address and phone number:

ELIZABETH P. RABBEH + MASON B. FLAGG

10005 PRATT PLACE, SILVER SPRING, MD 20910

(h) 588-1323 (ELIZABETH) (w) 639-2138 (ELIZABETH)

e. Is this property a contributing resource within the historic district? Yes _____ No

f. On a map of the district locate this property and any adjacent historic resources. Will this work impact other contributing historic resources? Yes _____ No

II. Description of work proposed

a. Briefly describe proposed work:

Picket Fence approximately 4' high to be placed on property line and to enclose a portion of common area to the rear of property line (towards B & O Railroad).

Would also like to build a stairway from the dock onto the back yard.

b. Is this work on the front, rear, or side of the structure?

Side and Rear of house

c. Is the work visible from the street?

Very slightly

d. What are the materials to be used?

Fence: Cedar Vertical Pickets and Pressure Treated Pine posts.
Steps: Pressure Treated Lumber.

e. Are these materials compatible with existing materials? How? If not, why? yes

III. Recommendation of the Local Advisory Committee

a. Approval of Work

1. Which criteria found in the Ordinance for Historic Preservation (Sec. 24A-8-b of the Montgomery County Code) does this work meet?

2, 3

2. What conditions, if any, must be met in order for the proposed work to meet the above criteria? (example: the proposed windows should be double hung to conform with existing windows)

b. Disapproval of Work

1. On what grounds is disapproval recommended? Refer to Sec. 24A-8.

2. How could this proposal be altered so as to be approved?

IV. Additional comments.

Date on which application received: 28 June 1988

Date of LAC meeting at which application was reviewed: 28 June 1988

Form completed by: Carol Ireland Title: Secretary

Member of: Capitol View Park LAC

Date: 29 June 1988

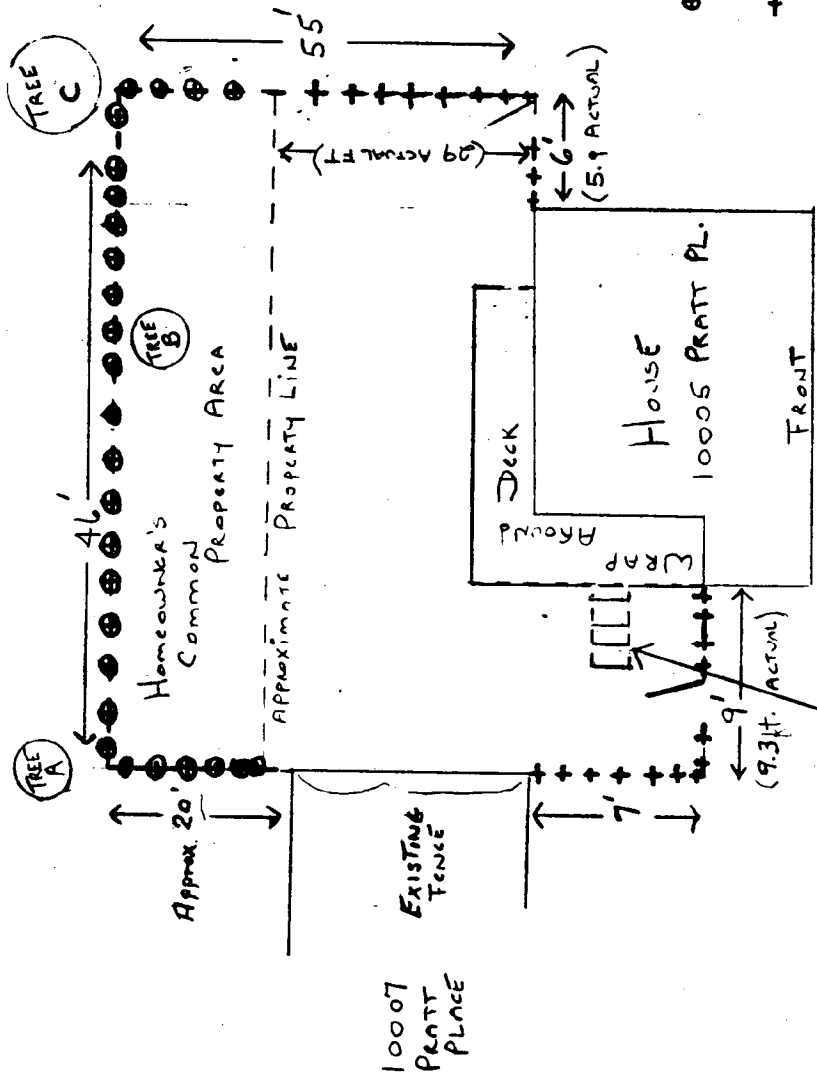
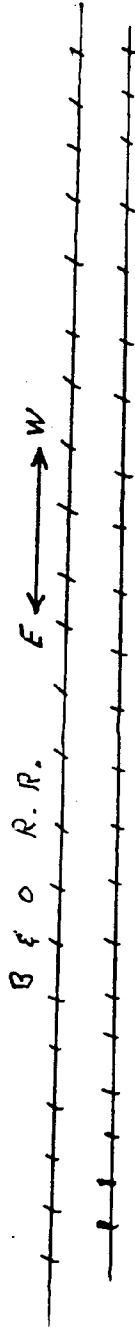

NOT TO SCALE

- ⊕ ⊕ ⊕ ⊕ = Proposed Area For 5' Picket Fence (For Low Areas)
- + + + + = Proposed Area For 4' Picket Fence
- = Proposed Staircase For deck (From 1st Floor To Ground)

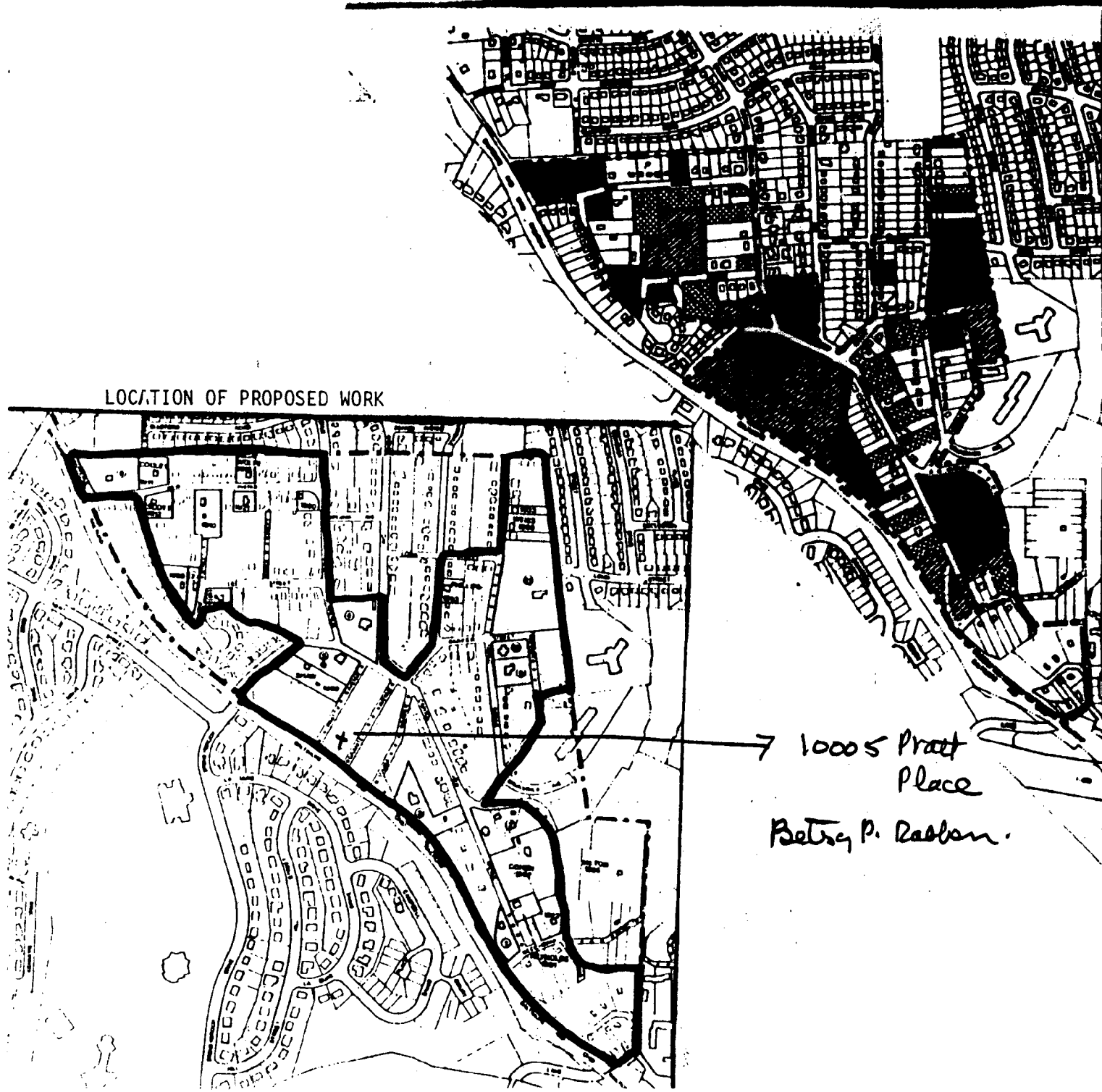

LOCATION OF PROPOSED WORK

→ 10005 Praet Place
Betsey P. Rabson.

HISTORIC DISTRICT

--- Historic District Boundary

RESOURCES

- 1870 - 1916
- 1917 - 1935
- Nominal | 1935 -
- Spatial

Bobbi -

Betsy gave me DEP Building Permit
Application to show signatures of
neighbors on either side.

C.



Historic Preservation Commission

100 Maryland Avenue, Rockville, Maryland 20850

279-1327

279-8037

31 Monroe Street, Tel. 2082
Rockville, MD 20850

APPLICATION FOR HISTORIC AREA WORK PERMIT

TAX ACCOUNT # _____

NAME OF PROPERTY OWNER Elizabeth P. Robbins TELEPHONE NO. 301 480 1223
 (Contract/Purchaser) Wanda S. Hase (Include Area Code)
 ADDRESS 16008 Platt Place Silver Spring MD 20910 STATE MD ZIP
 CITY
 CONTRACTOR Late Power Co. TELEPHONE NO. 420 9040
 CONTRACTOR REGISTRATION NUMBER _____
 PLANS PREPARED BY J. Hatten TELEPHONE NO. 581 1213
 (Include Area Code)
 REGISTRATION NUMBER _____

LOCATION OF BUILDING/PREMISE

House Number 16008 Street Platt Place
 Town/City Silver Spring MD Election District _____
 Nearest Cross Street Capital View
 Lot 218 Block 2 Subdivision Capital View Park
 Liber 6097 Folio 452 Parcel _____

1A. TYPE OF PERMIT ACTION: (circle one)

<input checked="" type="checkbox"/> Construct	<input type="checkbox"/> Extend/Add	<input type="checkbox"/> Alter/Renovate	<input type="checkbox"/> Repair	<input type="checkbox"/> Wreck/Raze	<input type="checkbox"/> Move	<input type="checkbox"/> Install	<input type="checkbox"/> Revocable	<input type="checkbox"/> Revision
---	-------------------------------------	---	---------------------------------	-------------------------------------	-------------------------------	----------------------------------	------------------------------------	-----------------------------------

Circle One: A/C Slab Room Addition
 Porch Deck Fireplace Shed Solar Woodburning Stove
 Fence/Wall (complete Section 4) Other _____

1B. CONSTRUCTION COSTS ESTIMATE \$ 12000

1C. IF THIS IS A REVISION OF A PREVIOUSLY APPROVED ACTIVE PERMIT SEE PERMIT # 46

1D. INDICATE NAME OF ELECTRIC UTILITY COMPANY WPA

1E. IS THIS PROPERTY A HISTORICAL SITE? NO

PART TWO: COMPLETE FOR NEW CONSTRUCTION AND EXTEND/ADDITIONS

2A. TYPE OF SEWAGE DISPOSAL

01 () WSSC	02 () Septic
03 () Other _____	

2B. TYPE OF WATER SUPPLY

01 () WSSC	02 () Well
03 () Other _____	

PART THREE: COMPLETE ONLY FOR FENCE/RETAINING WALL

4A. HEIGHT 4 feet 0 inches

4B. Indicate whether the fence or retaining wall is to be constructed on one of the following locations:

- On party line/Property line Adjoining property owners have approved property line
- Entirely on land of owner _____
- On public right of way/easement _____ (Revocable Letter Required).

I hereby certify that I have the authority to make the foregoing application, that the application is correct, and that the construction will comply with plans approved by all agencies listed and I hereby acknowledge and accept this to be a condition for the issuance of this permit.

Signature of owner or authorized agent (agent must have signature notarized on back) _____ Date 6/20/20

APPROVED _____ For Chairperson, Historic Preservation Commission

DISAPPROVED _____ Signature _____ Date 1/20/21

APPLICATION/PERMIT NO: _____ FILING FEE: \$ _____
 DATE FILED: _____ PERMIT FEE: \$ _____
 DATE ISSUED: _____ BALANCE \$ _____
 OWNERSHIP CODE: _____ RECEIPT NO: _____ FEE WAIVED: _____

SEE REVERSE SIDE FOR INSTRUCTIONS

Additional work may need to be added to the fence to allow traffic to flow
 through the corner area \$ _____



Montgomery County Government

Department of Housing and Community Development
Division of Planning
51 Monroe Street
Rockville, Maryland, 20850

Rabben
H. J. H.



SPACE PICKET



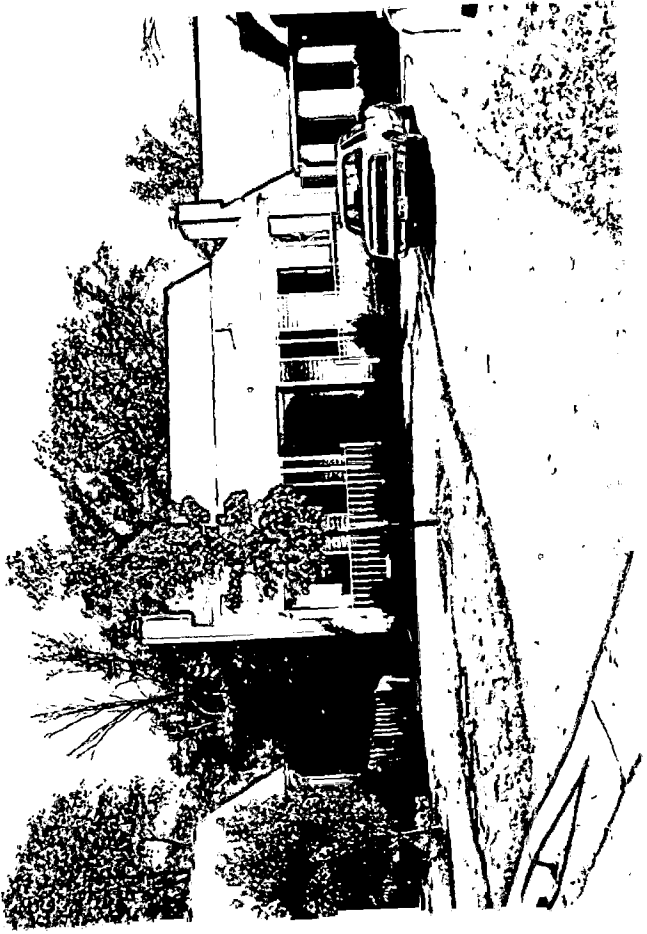

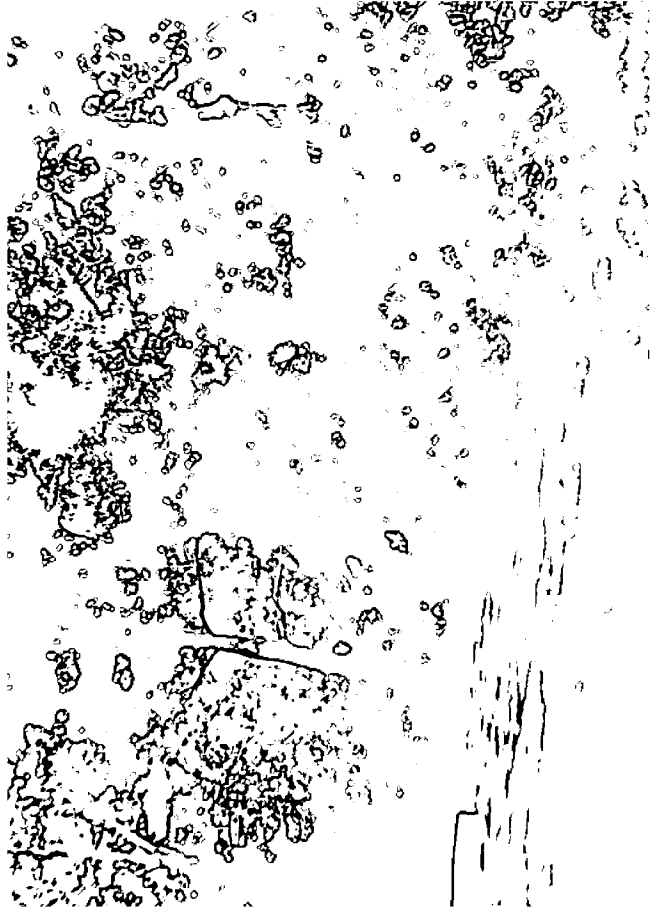

See Sketch -
From L to R , Large Trees A, B, B.C.

BY
←
W

PROCESSED BY
Kodak
JUN 1988 W

PROCESSED BY
Kodak
JUN 1988 W



