

THE SANDY SPRING  
28/36

1991 SUBDIV  
PRELIM. PLAN

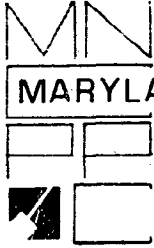

THE MARYLAND-NATIONAL CAPITAL PARK AND PLANNING COMMISSION

8787 Georgia Avenue • Silver Spring, Maryland 20907

FROM: Subdivision Office - M-NCPPC

NAME: Sandy Spring Property  
FILE NO.: 1-92009

Enclosed please find the information checked below. This material will be discussed at the Subdivision Review Committee Meeting of 8 FEB. 10, 1992 (no meeting scheduled if blank).

- New preliminary plan application with supporting material as appropriate
- Supporting material for previously reviewed preliminary plan
- Revised preliminary plan drawing
- New pre-preliminary plan application

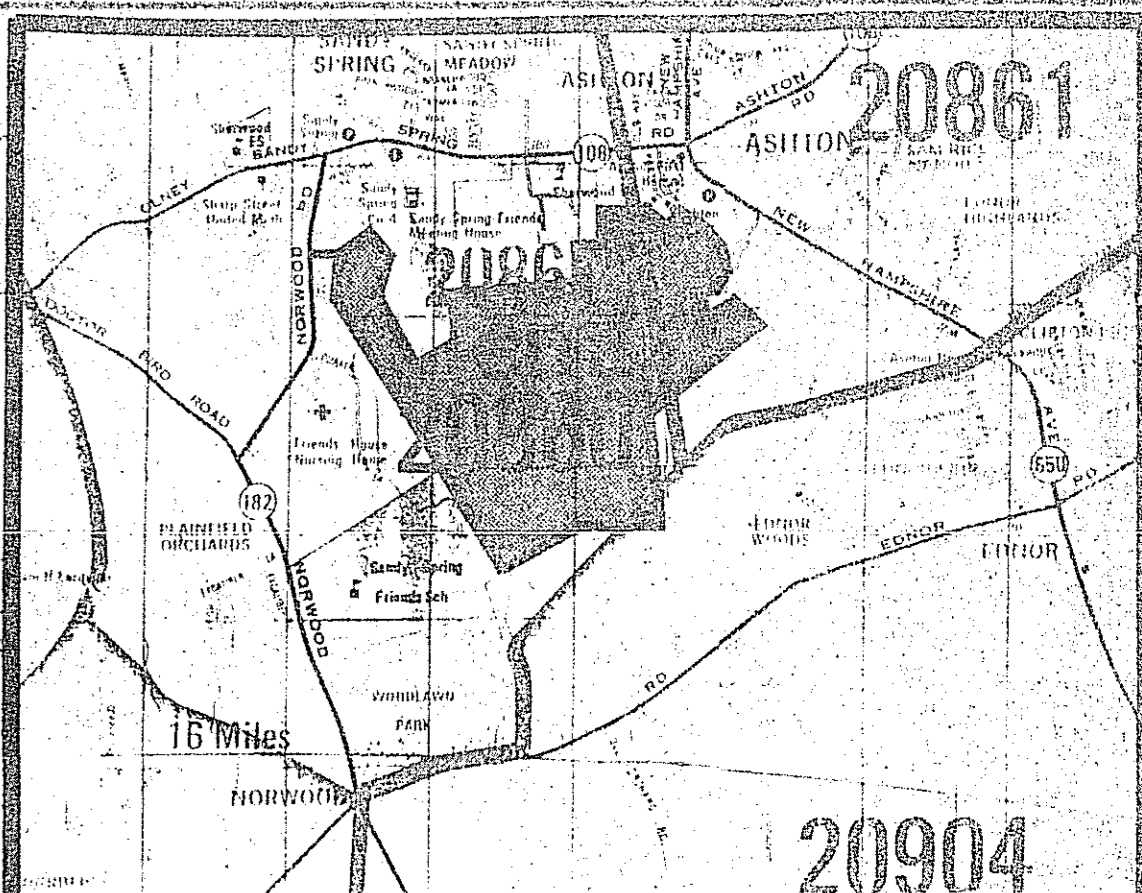
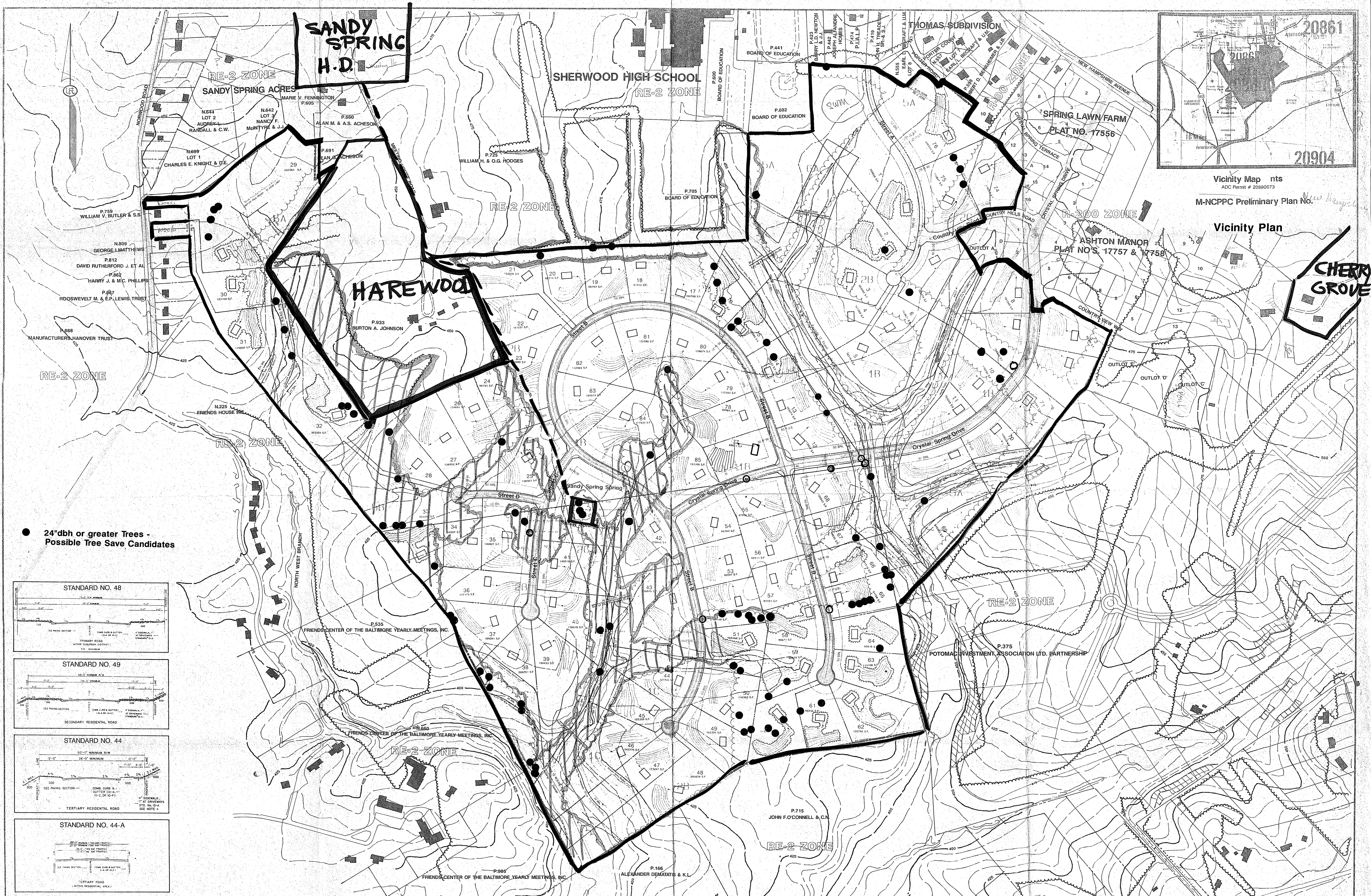

Vicinity Map nts  
 ADC Permit # 20890073  
 M-NCPPC Preliminary Plan No. *New Hager*

Vicinity Plan

● 24" dbh or greater Trees - Possible Tree Save Candidates

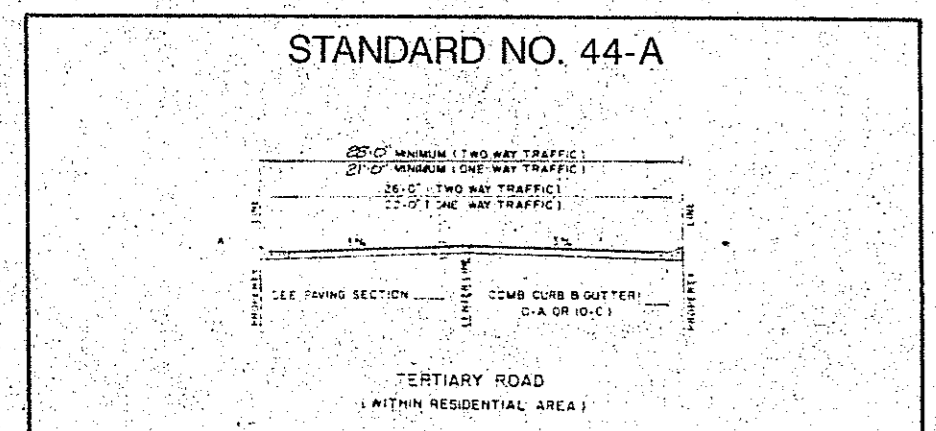
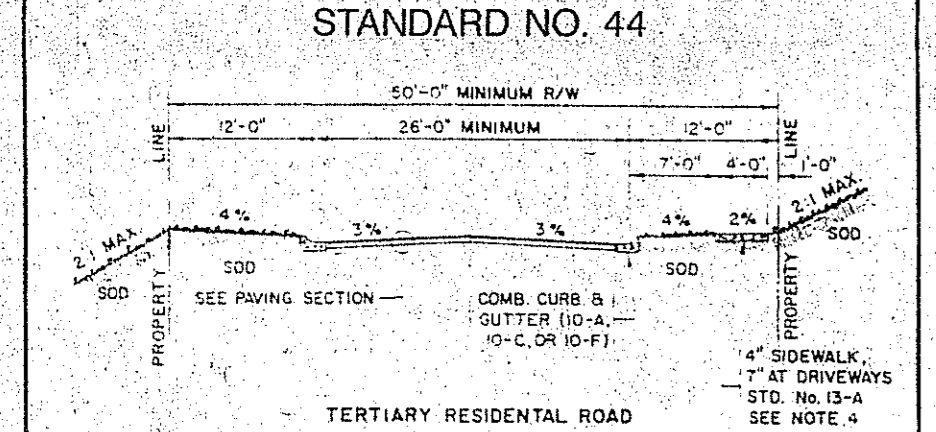
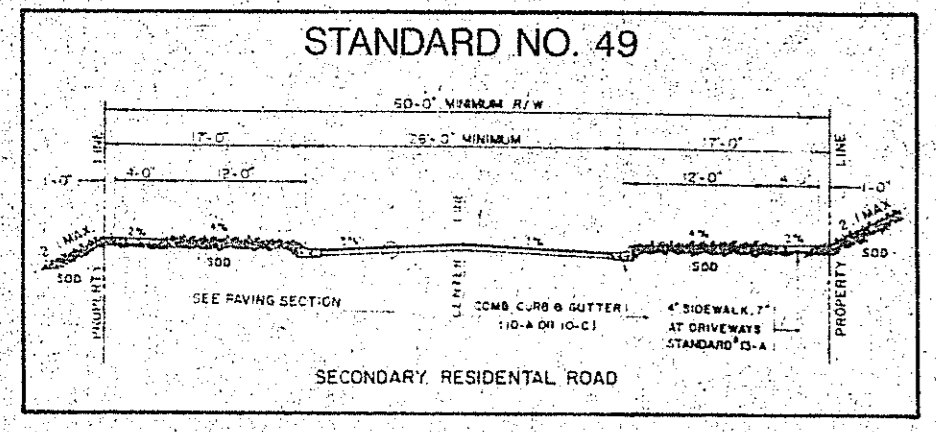
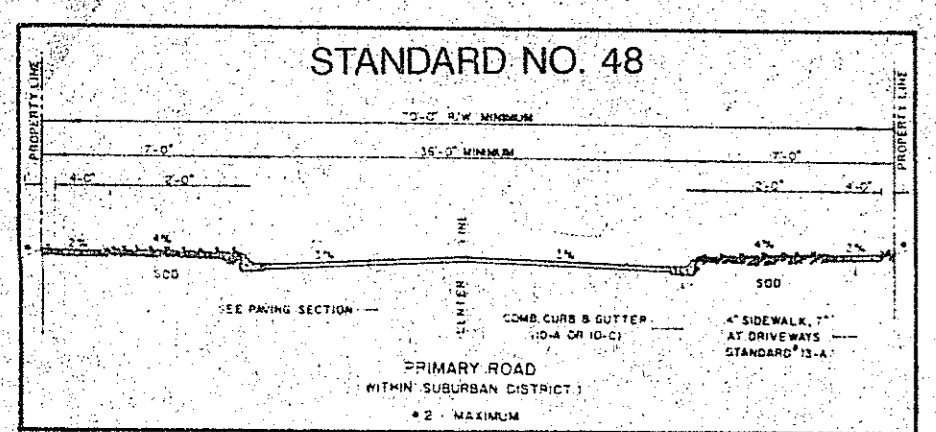

REVISION	DATE	REVISION	DATE	REVISION	DATE	REVISION	DATE

Applicant:  
 Joseph Alfandre & Co., Inc.  
 1355 Piccard Drive  
 Rockville, Maryland 20855

Vicinity Plan

Sandy Spring Property  
 Sandy Spring, Maryland

 <b>RODGERS &amp; ASSOCIATES, INC.</b> 15800 CRABBS BRANCH WAY ROCKVILLE, MD. 20855 (301) 948-4700 (301) 253-6600 (301) 948-6256 FAX	LAND USE EVALUATION • PLANNING CIVIL ENGINEERING • SURVEYING	BY: _____ DATE: _____	SCALE: 1"=200' JOB NO: 481K4 DATE: 12/91
	RELEASE FOR _____ DATE: _____	SHEET NO. 4 OF 4	BY: _____ DATE: _____
	PRELIMINARY NOT FOR CONSTRUCTION		
	SANDY SPRING PRELIMINARY PLAN - 342 (0, 30) FF: 481K1 900 02-D6C-91 04: 02 PH / 481K-20		

PRELIMINARY MAP FOR CONSTRUCTION

Rockville, Maryland 20822  
1322 Piccard Drive  
Joseph Altshuler & Co., Inc.  
Applicant:

VICINITY PLAN

Rockville, Maryland  
Sandy Spring Property

RODGERS & ASSOCIATES, INC.  
12800 SILVER BRANCH AVE  
ROCKVILLE, MD 20850  
TEL: 800-820-1111  
TEL: 301-527-8008  
FAX: 301-527-1100

DATE	1/15/84
SCALE	1"=500'
PROJECT NO.	1322 PICCARD DRIVE
CLIENT	JOSEPH ALTSHULER & CO., INC.
DESIGNED BY	RODGERS & ASSOCIATES, INC.
CHECKED BY	
DATE	

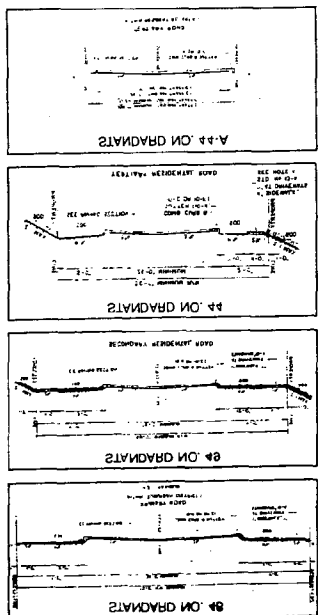

Possible tree sale candidates  
Set-off of Grades - trees

