

30/13 Commuter Loading Platform
No #

No record of
discussion,

No computer
record made

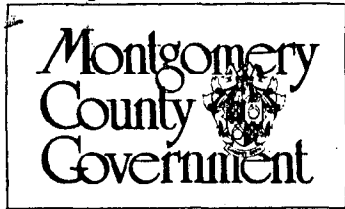

Historic Preservation Commission
100 Maryland Avenue, Rockville, Maryland 20850
279-1327

APPLICATION FOR HISTORIC AREA WORK PERMIT

TAX ACCOUNT # 3000456-3
NAME OF PROPERTY OWNER State Railroad Adm TELEPHONE NO. 682-6329
ADDRESS P.O. Box 3970 Dundalk CITY Maryland STATE Maryland ZIP
CONTRACTOR The Driggs Corp TELEPHONE NO. 499-1950
CONTRACTOR REGISTRATION NUMBER 54-1091757
PLANS PREPARED BY Montgomery County DOT TELEPHONE NO. 251-2133
Whitman Regu. Inst. Aspc. (Include Area Code)
REGISTRATION NUMBER

LOCATION OF BUILDING/PREMISE
House Number Street Commuter Loading Platform
Town/City GARRETT PARK Election District
Nearest Cross Street 5th Ave and Argyle Ave.
Lot Block Subdivision
Liber Folio Parcel

1A. TYPE OF PERMIT ACTION: (circle one)
Construct Extend/Add Alter/Renovate Repair Wreck/Raze Move Install Revocable Revision
Circle One: A/C Slab Room Addition
Porch Deck Fireplace Shed Solar Woodburning Stove
Fence/Wall (complete Section 4) Other
1B. CONSTRUCTION COSTS ESTIMATE \$
1C. IF THIS IS A REVISION OF A PREVIOUSLY APPROVED ACTIVE PERMIT SEE PERMIT #
1D. INDICATE NAME OF ELECTRIC UTILITY COMPANY
1E. IS THIS PROPERTY A HISTORICAL SITE? Yes

PART TWO: COMPLETE FOR NEW CONSTRUCTION AND EXTEND/ADDITIONS
2A. TYPE OF SEWAGE DISPOSAL 01 () WSSC 02 () Septic 03 () Other
2B. TYPE OF WATER SUPPLY 01 () WSSC 02 () Well 03 () Other

PART THREE: COMPLETE ONLY FOR FENCE/RETAINING WALL
4A. HEIGHT feet inches
4B. Indicate whether the fence or retaining wall is to be constructed on one of the following locations:
1. On party line/Property line
2. Entirely on land of owner
3. On public right of way/easement (Revocable Letter Required).

I hereby certify that I have the authority to make the foregoing application, that the application is correct, and that the construction will comply with plans approved by all agencies listed and I hereby acknowledge and accept this to be a condition for the issuance of this permit.

Clyde A. Raleigh Signature of owner or authorized agent (agent must have signature notarized on back)
1/9/87 Date

APPROVED For Chairperson, Historic Preservation Commission
DISAPPROVED Signature Date

APPLICATION/PERMIT NO: FILING FEE: \$
DATE FILED: PERMIT FEE: \$
DATE ISSUED: BALANCE \$
OWNERSHIP CODE: RECEIPT NO: FEE WAIVED:

SEE REVERSE SIDE FOR INSTRUCTIONS

THE FOLLOWING ITEMS MUST BE COMPLETED AND THE REQUIRED DOCUMENTS MUST ACCOMPANY THIS APPLICATION

DESCRIPTION OF PROPOSED WORK: (including composition, color and texture of materials to be used:)

Placing New Cross the Platforms for Passengers
Loading / Unloading.

(If more space is needed, attach additional sheets on plain or lined paper to this application)

ATTACH TO THIS APPLICATION (2) COPIES OF: SUCH SITE PLANS (lot dimensions, building location with dimensions, drives, walks, fences, patios, etc. proposed or existing) and/or ARCHITECTURAL DRAWINGS (floor plans, elevations, etc.), PHOTOGRAPHS OF THE AREA AFFECTED, as are necessary to fully describe the proposed work.

MAIL OR DELIVER THE APPLICATION AND ALL REQUIRED DOCUMENTS TO THE:
HISTORIC PRESERVATION COMMISSION
100 MARYLAND AVENUE
ROCKVILLE, MARYLAND 20850

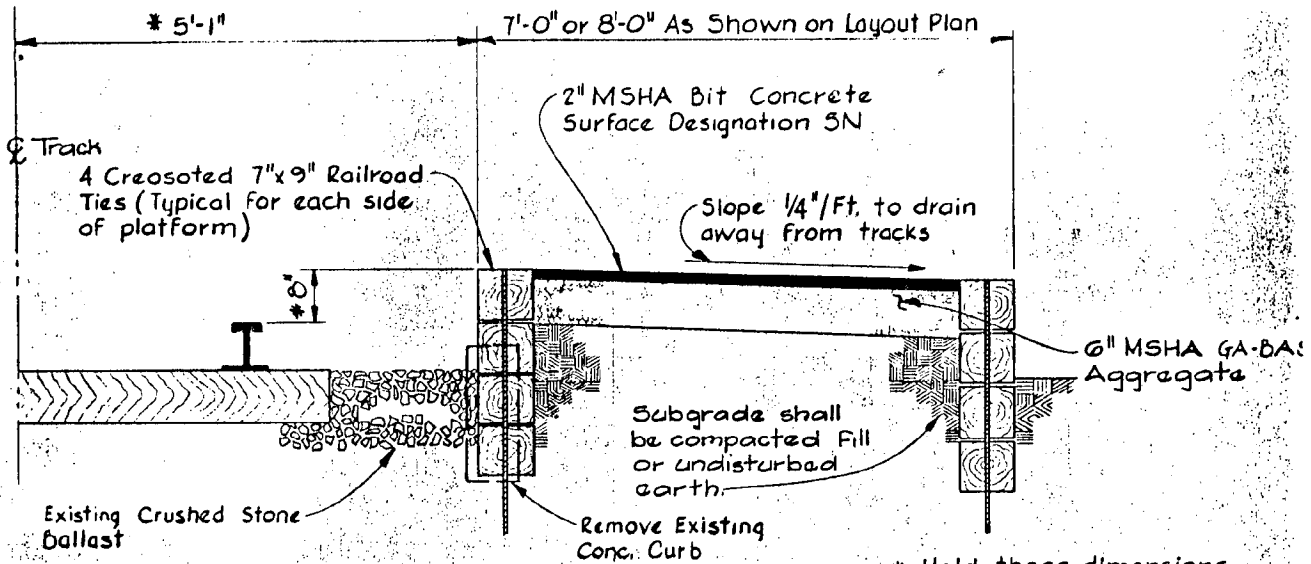

RAIL STATION WAITING PLATFORM
SECTION 3A/1 & 3A/2
 No Scale

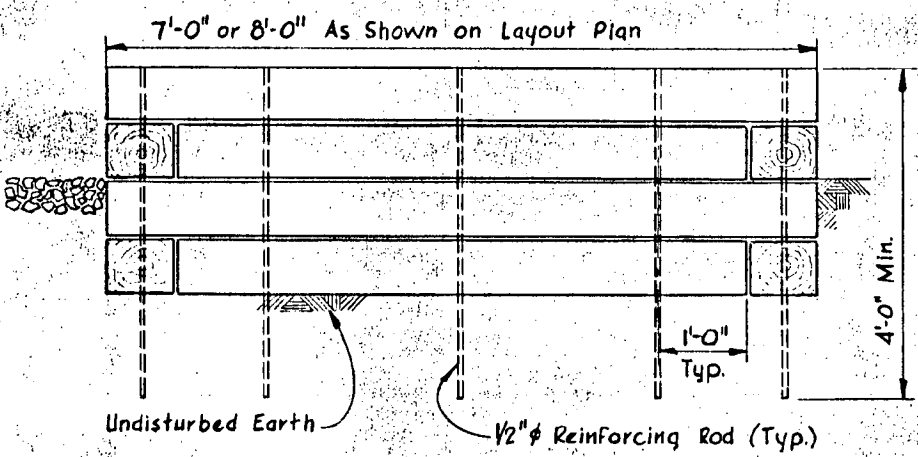

PROFILE - RAILROAD TIES @ END OF PLATFORM
 Scale: 3/4" = 1'-0"

NOTE:
 All reinforcing rods for
 dowels in railroad ties
 shall be galvanized.

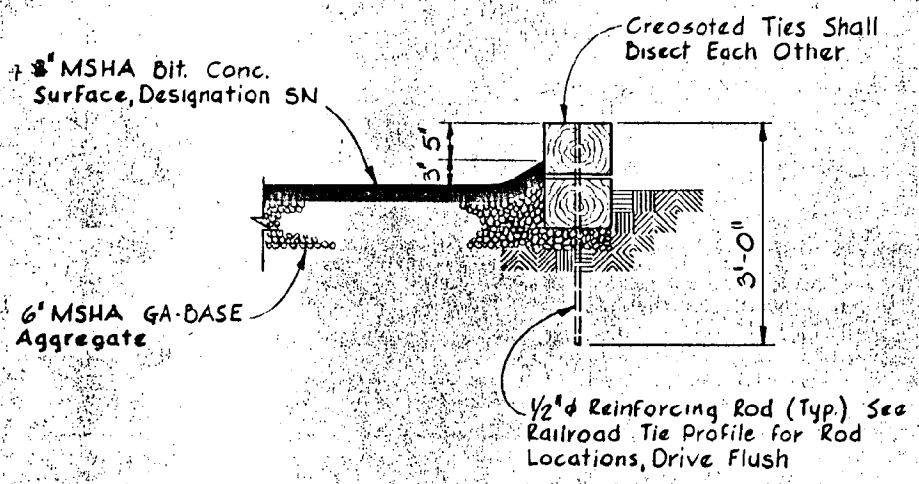

RAILROAD TIE WHEEL STOP
SECTION 3B/1
 Scale: 3/4" = 1'-0"

Flow

PASSENGER SHELTER FOUNDATION

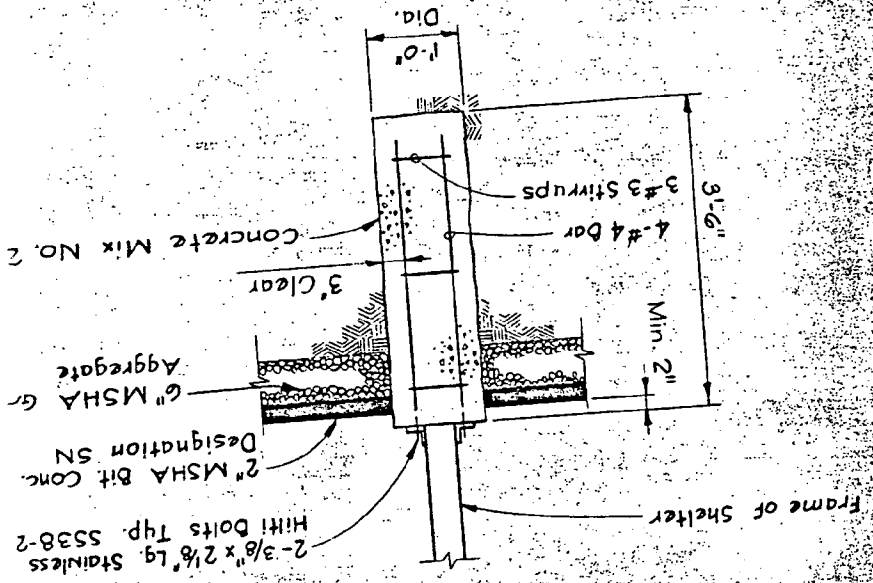

PASSENGER SHELTER FOUNDATION PLAN

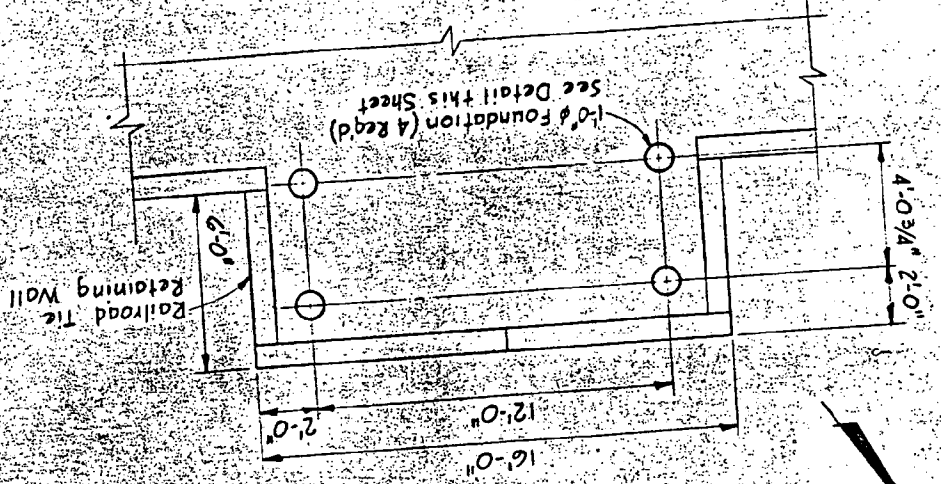

ties for

RAILROAD TIES PROFILE

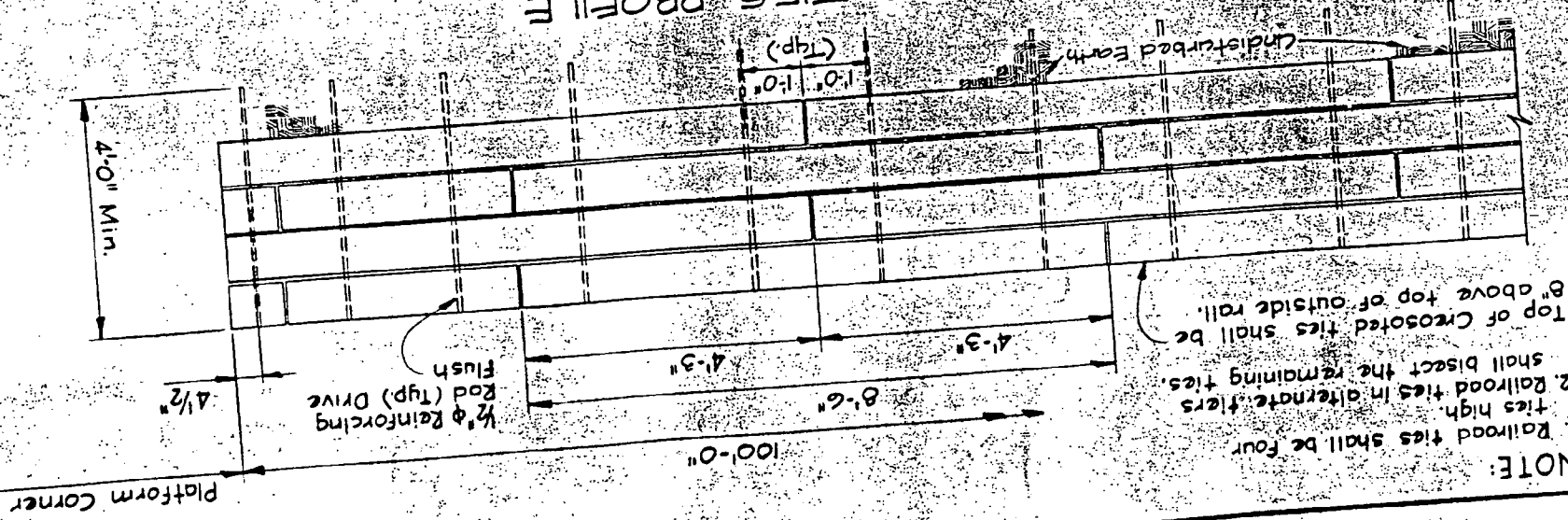

- NOTE:
1. Railroad ties shall be four ties high.
 2. Railroad ties in alternate tiers shall bisect the remaining ties.
 3. Top of creosoted ties shall be 8" above top of outside rail.

BE