

4

36/1-05B 2801 Linden Lane
MP Site # 36/1 National Park Seminary

LIGHTS / INTERPRETIVE
SIGNAGE

HISTORIC PRESERVATION COMMISSION STAFF REPORT

| | | | |
|---------------------|---|------------------------|----------------------|
| Address: | 2801 Linden Lane, Silver Spring | Meeting Date: | 07/13/05 |
| Applicant: | Forest Glen Ventures, LLC (David G. Vos, Agent) | Report Date: | 06/30/05 |
| Resource: | <i>Master Plan</i> Site #36/01 National Park Seminary Historic District | Public Notice: | 06/29/05 |
| Review: | HAWP | Tax Credit: | Partial |
| Case Number: | 36/01-05B | Staff: | Tania Tully |
| PROPOSAL: | Landscape Plan including lighting and signage. | RECOMMENDATION: | Conditional Approval |

STAFF RECOMMENDATION

Staff is recommending approval with the following conditions:

1. Approval is received from the Maryland Historical Trust prior to implementation.
2. The text and layout of the interpretive signage will be reviewed and approved by HPC staff.
3. Any minor changes to the plan will be approved at the staff level.

PROPERTY DESCRIPTION

SIGNIFICANCE: *Master Plan* Historic District
STYLE: Eclectic
DATE: 1887-1942

The subject parcel 880 and part of 394 (just under an acre) encompasses approximately 33 acres and is roughly bounded by I-495 on the north, a private road that runs parallel to the CSX line on the east, and Linden Lane on the south and west. The neighborhood west of the district consists of single-family residences constructed from the 1920s through the 1980s. The area to the east contains Army warehouses, commercial properties and single-family residences. South of the district is a vacant lot that will be built-out with new construction as part of this project and the Walter Reed Army Medical Center is south and east of that.

HISTORY:

The wooded architectural fantasyland known as National Park Seminary was a finishing school for young women established in 1894. The site began as a speculative real estate development intended to capitalize on proximity to the railroad. An ornate Stick Style hotel, the Forest Inn (1887), was the centerpiece of the resort, built with wraparound porches, towers, and applied stickwork detailing. When the hotel proved unsuccessful, John and Vesta Cassedy purchased the site, converting the inn into a boarding school. National Park Seminary became one of the most popular and exclusive finishing schools in the Washington area.

Young women from wealthy families were groomed to fulfill their roles as society matrons. A basic principle in the National Park Seminary program was the importance of understanding foreign and domestic culture. Underscoring this philosophy was the architecture and interior design on campus, inspired by the grand, international architecture of the World's Columbian Exposition of 1893. Between 1894 and 1907, the Cassedys constructed a score of fanciful buildings. Sorority meetings were held in the English Garden Castle, Swiss Chalet, American Bungalow, Colonial House, Spanish Mission, Dutch Windmill, and Japanese Pagoda. Students resided in the Italian Villa and the Shingle Style Senior House. They took physical education classes in the Classical Revival Gymnasium and studied in the Shingle Style Miller Library.

Beginning in 1916, NPS President Dr. James Ament instituted his own building campaign, expanding campus buildings, constructing an elaborate network of covered walkways and bridges, and installing classical garden sculptures. Ament designed the last building constructed on campus--the awe-inspiring Ballroom (1927), which, when constructed, was the tallest building in Montgomery County.

During World War II, the U.S. Army acquired the site for a convalescent center for soldiers who spent an average of 20 days in the bucolic setting. A Baltimore reporter described the transformation of the site: A "one-time finishing school for ritzy sweet young things becomes the healer of the sick and maimed, giving the boys in khaki a luxurious but none the less homelike atmosphere to smooth the comeback trail. There's no suggestion of the hospital about it--and for that the men are grateful."

After the Army, in the 1970s, relocated its medical facility to the main Walter Reed campus in Washington, D.C., the buildings that comprise this historic district were used for administration and then abandoned. Many have deteriorated and others have been lost to fire and vandalism. One of the best loved structures was the Odeon Theatre, destroyed by fire in 1993. Stabilizing efforts and compatible reuse options are a high priority for this outstanding and important resource.

PROJECT BACKGROUND:

Autumn 2004: Property transferred from the Army to the development team, via Montgomery County and Preservation Easement placed on the Property by Maryland Historical Trust (MHT)

October 13, 2004: HAWP approved for stabilization

Winter 2005: Property Rezoned (Currently under appeal)

March 25, 2005: HAWP approved for rehabilitation of the Main Building and Demolition of the Army buildings

April 7, 2005: Preliminary and Site Plans approved by the Planning Board

APPLICABLE GUIDELINES:

Montgomery County Code; Chapter 24A

- A HAWP permit should be issued if the Commission finds that:
 1. The proposal will not substantially alter the exterior features of a historic site or historic resource within a historic district.
 2. The proposal would enhance or aid in the protection, preservation and public or private utilization of the historic site or historic resource located within an historic district in a manner compatible with the historical, archeological, architectural or cultural value of the historic site or historic district in which an historic resource is located; or

Secretary of the Interior's Standards for Rehabilitation:

- 1# A property will be used as it was historically or be given a new use that requires minimal change to its distinctive materials, features, spaces, and spatial relationships.
- 2# The historic character of a property will be retained and preserved. The removal of distinctive materials or alteration of features, spaces, and spatial relationships that characterize a property will be avoided.
- 5# Distinctive materials, features, finishes, and construction techniques or examples of craftsmanship that characterize a property will be preserved.
- 6# Deteriorated historic features will be repaired rather than replaced. Where the severity of deterioration requires replacement of a distinctive feature, the new feature will match the old in design, color, texture, and, where possible, materials. Replacement of missing features will be substantiated by documentary and physical evidence.

PROPOSAL:

1. Site improvements including replacement of drive and walkway materials. Most of the existing locations will remain.
2. Site Lighting (Circle 6)
3. Landscaping (Details on Circles 20-25)
4. Interpretive signage (Circle 7)

STAFF DISCUSSION

Landscape plan currently presented is substantially the same as the site plan the Commission saw and supported at the March 23, 2005 HPC meeting. This HAWP application is a refinement that includes detailed information about the proposed lighting fixtures, site furniture, and interpretive signage. The proposed new and altered parking, sidewalks, retaining walls, and unit planting have not changed and are now a requirement of the Site Plan as approved by the Planning Board.

Staff is comfortable with the landscape plan as proposed. Specifically, the lighting fixtures proposed are benign, meaning that they are not replicative of a particular time period, nor are they so modern as to draw attention away from the historic resources. Staff is recommending approval with a few minor conditions including the redundant requirement that approval is received from MHT. Staff also recommends that the text and layout of the interpretive signage be reviewed and approved at the staff level. This is already a condition of the proper HAWP. Additionally, staff requests the authority to approve minor changes in the landscaping at the staff level.

STAFF RECOMMENDATION:

Staff recommends that the Commission **approve** the HAWP application as being consistent with Chapter 24A-8(b)(1) & (2);

and with the *Secretary of the Interior's Standards for Rehabilitation*;

and with the conditions stated on Circle 1;

and with the general condition applicable to all Historic Area Work Permits that **the applicant will present 3 permit sets of drawings to HPC staff for review and stamping prior to submission for permits (if applicable)**. After issuance of the Montgomery County Department of Permitting Services (DPS) permit, the applicant will arrange for a field inspection by calling the DPS Field Services Office at 240-777-6370 prior to commencement of work and not more than two weeks following completion of work.



RETURN TO: DEPARTMENT OF PERMITTING SERVICES
755 ROCKVILLE PIKE, 2nd FLOOR, ROCKVILLE, MD 20850
240/777-6370

DPS - #8

T

HISTORIC PRESERVATION COMMISSION
301/563-3400

APPLICATION FOR HISTORIC AREA WORK PERMIT

All applicable plans were forwarded to Tanya Tulle per her request.

Contact Person: DAVID VOS
Daytime Phone No.: 608.258.5580

Tax Account No.: 20-2680815
Name of Property Owner: FOREST GLEN VENTURE, LLC Daytime Phone No.: 703.525.5565
Address: 1000 WILSON BLVD, STE 2920 ARLINGTON, VA 22209
Street Number City Street Zip Code
Contractor: EYA CONSTRUCTION, INC. Phone No.: 703.525.5565
Contractor Registration No.: _____
Agent for Owner: DAVID VOS Daytime Phone No.: 608.258.5580

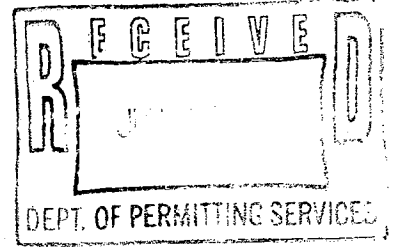

LOCATION OF BUILDING/PREMISE

House Number: 2801 ~~WILSON BLVD~~ Street: LINDEN LANE
Town/City: SILVER SPRING Nearest Cross Street: SMITH DRIVE
Lot: 1-53 Block: A Subdivision: _____
Liber: 28584 Folio: 168 Parcel: _____

PART ONE: TYPE OF PERMIT ACTION AND USE

1A. CHECK ALL APPLICABLE:

- Construct
- Extend
- Alter/Renovate
- Move
- Install
- Wreck/Raze
- Revision
- Repair
- Revocable

CHECK ALL APPLICABLE:

- A/C
- Slab
- Room Addition
- Porch
- Deck
- Shed
- Solar
- Fireplace
- Woodburning Stove
- Single Family (towyn/homes)
- Fence/Wall (complete Section 4)
- Other: PARKING GARAGE

landscape plan
new

1B. Construction cost estimate: \$ 20,000,000

1C. If this is a revision of a previously approved active permit, see Permit # _____

PART TWO: COMPLETE FOR NEW CONSTRUCTION AND EXTEND/ADDITIONS

2A. Type of sewage disposal: 01 WSSC 02 Septic 03 Other: _____
2B. Type of water supply: 01 WSSC 02 Well 03 Other: _____

PART THREE: COMPLETE ONLY FOR FENCE/RETAINING WALL

3A. Height _____ feet _____ inches
3B. Indicate whether the fence or retaining wall is to be constructed on one of the following locations:
 On party line/property line Entirely on land of owner On public right of way/easement

I hereby certify that I have the authority to make the foregoing application, that the application is correct, and that the construction will comply with plans approved by all agencies listed and I hereby acknowledge and accept this to be a condition for the issuance of this permit.

[Signature]
Signature of owner or authorized agent

6/14/05
Date

Approved: _____ For Chairperson, Historic Preservation Commission
Disapproved: _____ Signature: _____ Date: _____
Application/Permit No.: 388157 Date Filed: _____ Date Issued: _____

Landscape Plan Set for NATIONAL PARK SEMINARY

-Phase 1-
MNCP&PC #8-05024
13th Election District, Silver Spring
Montgomery County, Maryland

PARKER RODRIGUEZ, INC.
1300 WOODBURN ROAD
SILVER SPRING, MD 20910
TEL: 301-585-1100
FAX: 301-585-1101

REFERENCE PLAN

NATIONAL PARK SEMINARY
MONTGOMERY COUNTY MARYLAND

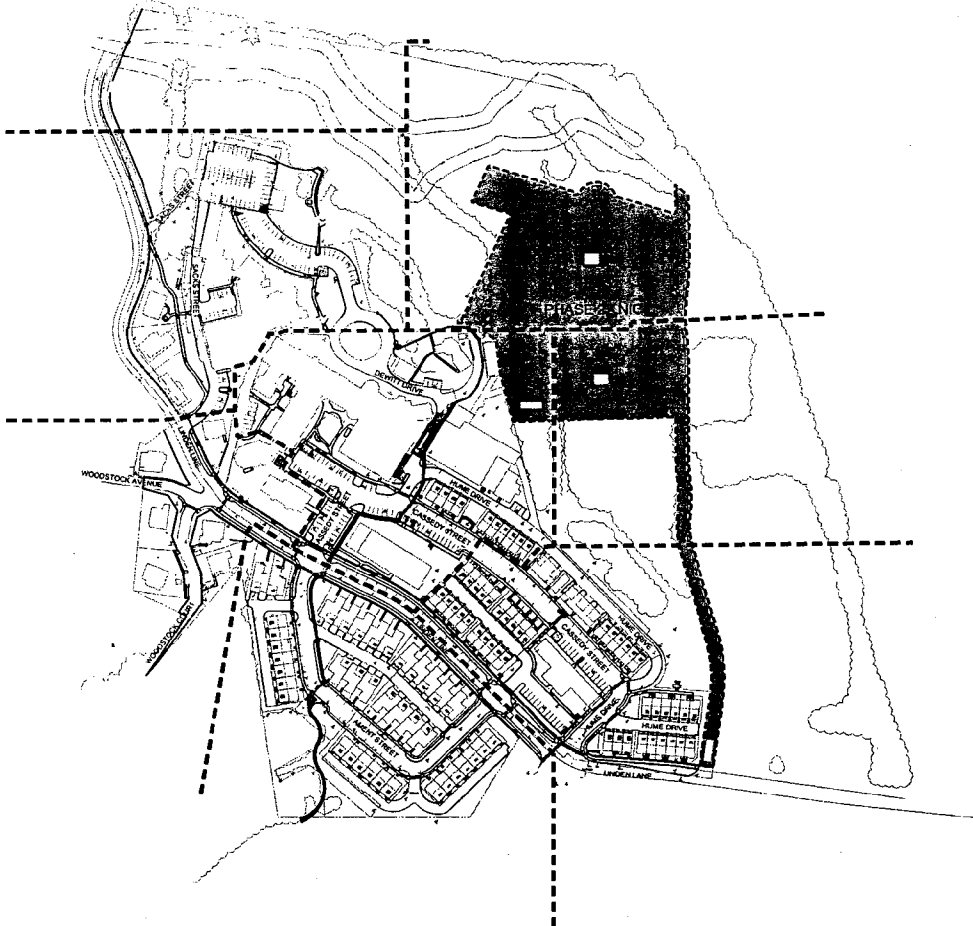

Landscape Plan Set

1. L0-0 REFERENCE PLAN
2. L1-0 RECREATION PLAN
3. L1-1 LANDSCAPE PLAN
4. L1-2 LANDSCAPE PLAN
5. L1-3 LANDSCAPE PLAN
6. L1-4 LANDSCAPE PLAN
7. L1-5 LANDSCAPE PLAN
8. L1-6 LANDSCAPE PLAN
9. L1-7 LANDSCAPE PLAN
10. L1-8 LANDSCAPE PLAN
11. L2-1 ENLARGEMENT PLAN
12. L2-2 SITE FEATURES
13. L3-1 SITE FURNITURE
14. L3-2 SITE DETAILS
15. L3-3 RETAINING WALLS
16. L3-4 INTERPRETIVE SIGNS
17. L4-1 TYPICAL UNIT PLANTING
18. L4-2 PLANTING DETAILS

PROJECT TEAM

RELANDSCAPING, INC.
ALEXANDER COMPANY
141 EAST BROADWAY ROAD
SUITE 200
MONTGOMERY, MARYLAND 20894
CONTACT: MICHAEL BLUM
301-251-0000

THE LITTLE GROUP
1900 FARMERS 30 DRIVE
SUITE 100
BALTIMORE, MD 21228
CONTACT: WESLEY GIBBS
410-528-3411

CONSTRUCTION
2021 CLAYBURY ROAD, SUITE 100
GERMANTOWN, MARYLAND 20874
CONTACT: CHUCK WOODS II
301-616-1100

SITE LIGHTING PLANS ARE PROVIDED UNDER SEPARATE COVER.

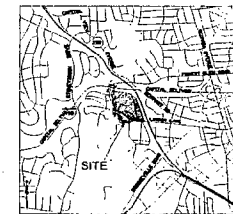

LOCAL VICINITY MAP
NATIONAL PARK SEMINARY

MNCP&PC SITE INSPECTION CHECKLIST

| | | | |
|-------|-------|-------|-------|
| _____ | _____ | _____ | _____ |
| _____ | _____ | _____ | _____ |
| _____ | _____ | _____ | _____ |
| _____ | _____ | _____ | _____ |

SITE PLAN APPROVAL STAMP

APPLICANT'S AGREEMENT

The undersigned agrees to adhere to the standards and requirements of the Site Plan and to accept and pay the Montgomery County approval fees and the Montgomery County Planning Board and the Montgomery County Planning Commission.

Project: **National Park Seminary, LLC**
 Date: _____
 Signature: _____
 Title: _____

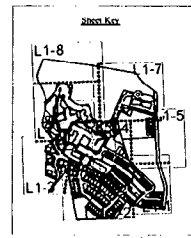

Revisions & Dates

| | |
|--|--|
| | |
| | |
| | |

Drawn by: **JL, CJ**
 Designed by: **W, A**
 Checked by: **A**
 Date: **07/23/08**
 Scale: **As Noted**
 Drawing Number: **L0-0**
 Sheet of 17

5

4

5

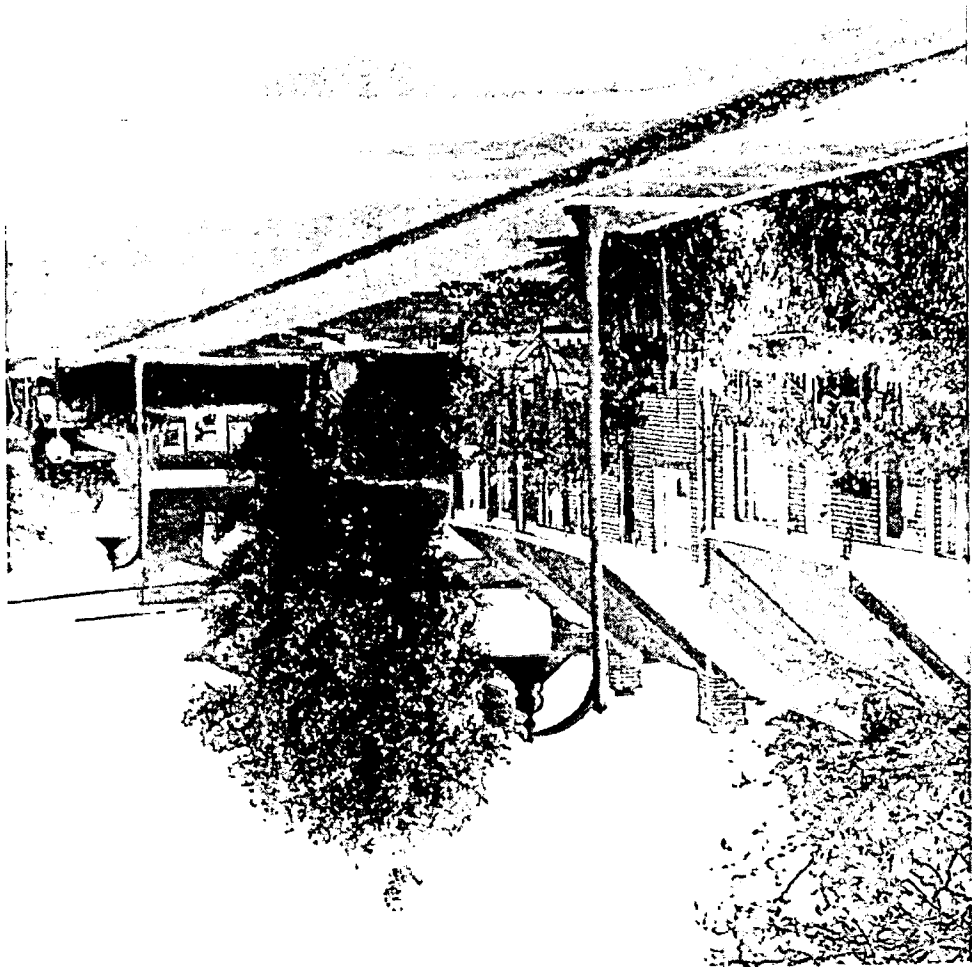

6

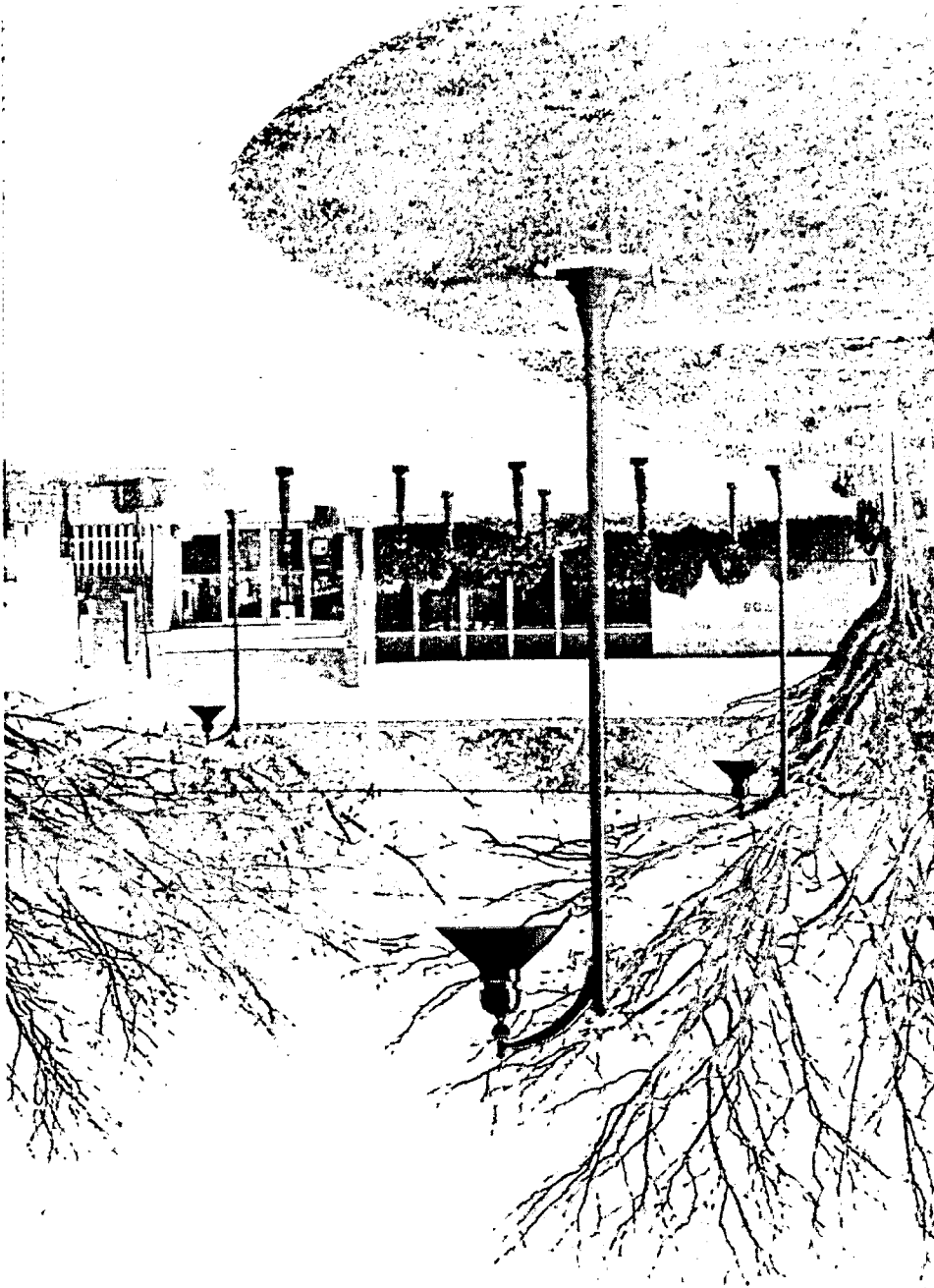

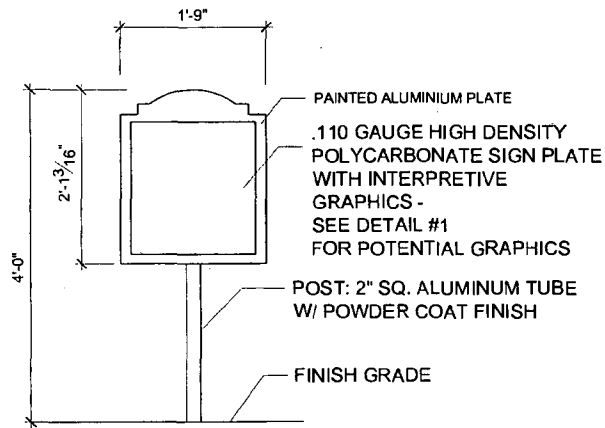



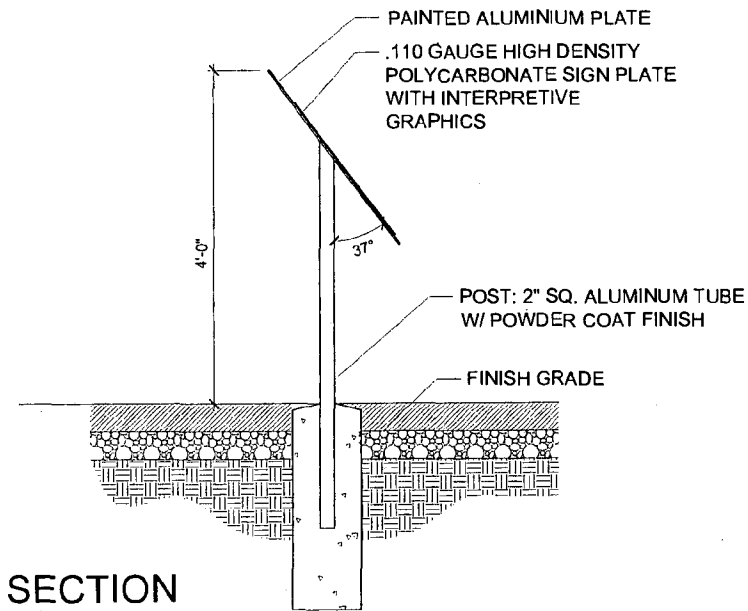
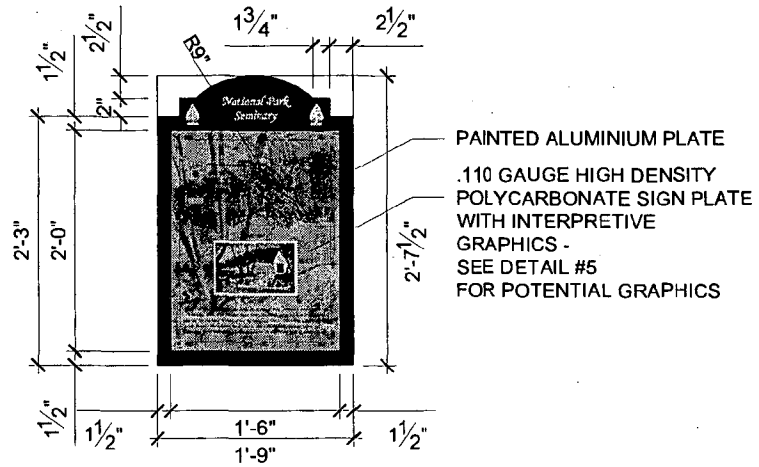

ELEVATION



SECTION

-  *Monument Location*
-  *You Are Here*
-  *Interpretive Sign*
-  *Historic Structures*
-  *New Construction*

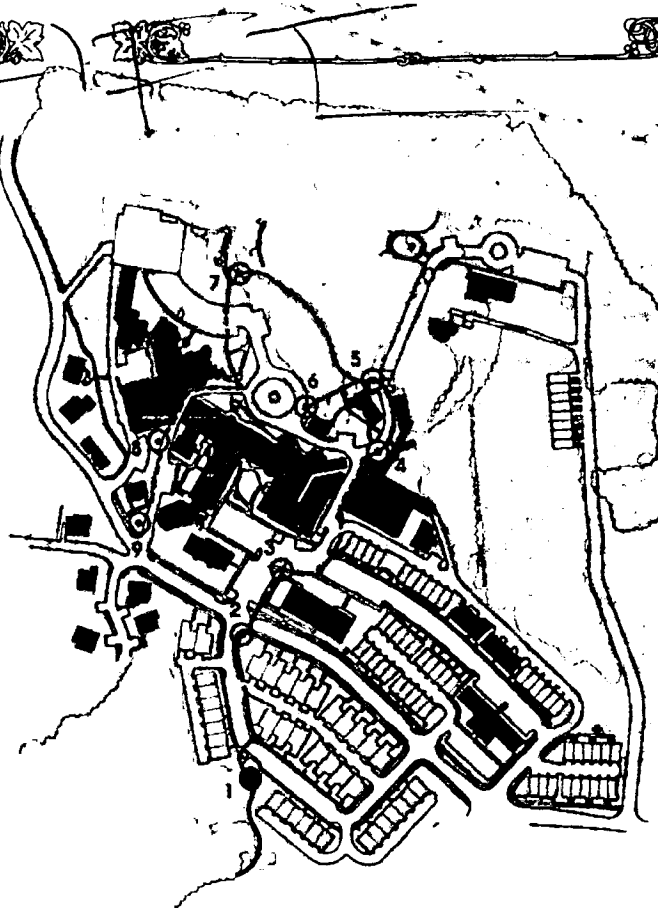

foto

Guests at The Forest Inn, students at National Park Seminary, and recovering wounded soldiers at Walter Reed Army Medical Center each, in their turn, enjoyed the tranquil beauty of the surrounding forest. The school's name evoked the famous Rock Creek Park that is only a short walk through the woods. Canoeing, horseback riding and hiking were an important part of seminary life.

6)

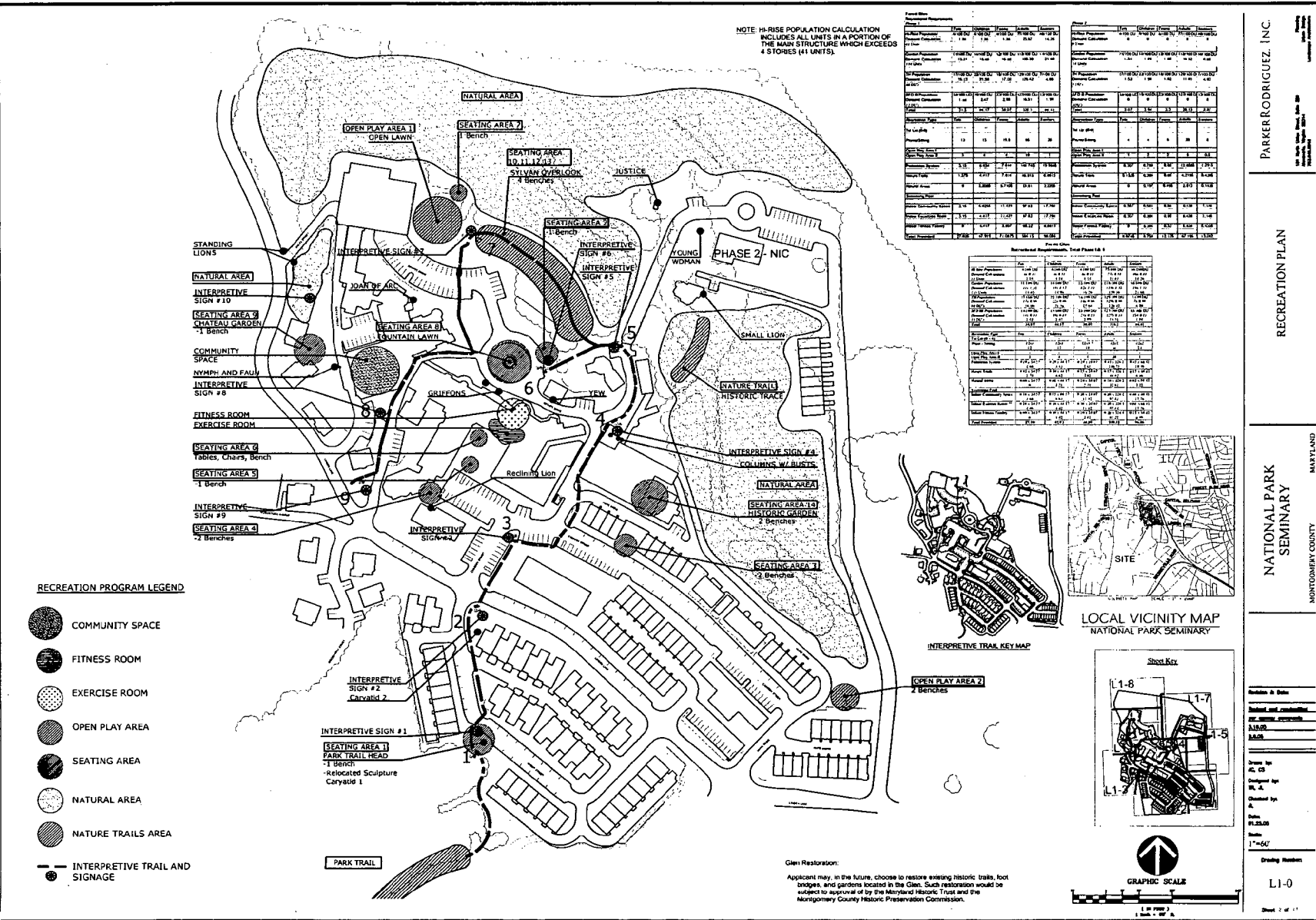

NOTE: HI-RISE POPULATION CALCULATION INCLUDES ALL UNITS IN A PORTION OF THE MAIN STRUCTURE WHICH EXCEEDS 4 STORES (41 UNITS).

| Category | Units | Population | Area | Notes |
|-----------|-------|------------|-----------|-------|
| Phase 1 | 100 | 400 | 100,000 | |
| Phase 2 | 150 | 600 | 150,000 | |
| Phase 3 | 200 | 800 | 200,000 | |
| Phase 4 | 250 | 1,000 | 250,000 | |
| Phase 5 | 300 | 1,200 | 300,000 | |
| Phase 6 | 350 | 1,400 | 350,000 | |
| Phase 7 | 400 | 1,600 | 400,000 | |
| Phase 8 | 450 | 1,800 | 450,000 | |
| Phase 9 | 500 | 2,000 | 500,000 | |
| Phase 10 | 550 | 2,200 | 550,000 | |
| Phase 11 | 600 | 2,400 | 600,000 | |
| Phase 12 | 650 | 2,600 | 650,000 | |
| Phase 13 | 700 | 2,800 | 700,000 | |
| Phase 14 | 750 | 3,000 | 750,000 | |
| Phase 15 | 800 | 3,200 | 800,000 | |
| Phase 16 | 850 | 3,400 | 850,000 | |
| Phase 17 | 900 | 3,600 | 900,000 | |
| Phase 18 | 950 | 3,800 | 950,000 | |
| Phase 19 | 1,000 | 4,000 | 1,000,000 | |
| Phase 20 | 1,050 | 4,200 | 1,050,000 | |
| Phase 21 | 1,100 | 4,400 | 1,100,000 | |
| Phase 22 | 1,150 | 4,600 | 1,150,000 | |
| Phase 23 | 1,200 | 4,800 | 1,200,000 | |
| Phase 24 | 1,250 | 5,000 | 1,250,000 | |
| Phase 25 | 1,300 | 5,200 | 1,300,000 | |
| Phase 26 | 1,350 | 5,400 | 1,350,000 | |
| Phase 27 | 1,400 | 5,600 | 1,400,000 | |
| Phase 28 | 1,450 | 5,800 | 1,450,000 | |
| Phase 29 | 1,500 | 6,000 | 1,500,000 | |
| Phase 30 | 1,550 | 6,200 | 1,550,000 | |
| Phase 31 | 1,600 | 6,400 | 1,600,000 | |
| Phase 32 | 1,650 | 6,600 | 1,650,000 | |
| Phase 33 | 1,700 | 6,800 | 1,700,000 | |
| Phase 34 | 1,750 | 7,000 | 1,750,000 | |
| Phase 35 | 1,800 | 7,200 | 1,800,000 | |
| Phase 36 | 1,850 | 7,400 | 1,850,000 | |
| Phase 37 | 1,900 | 7,600 | 1,900,000 | |
| Phase 38 | 1,950 | 7,800 | 1,950,000 | |
| Phase 39 | 2,000 | 8,000 | 2,000,000 | |
| Phase 40 | 2,050 | 8,200 | 2,050,000 | |
| Phase 41 | 2,100 | 8,400 | 2,100,000 | |
| Phase 42 | 2,150 | 8,600 | 2,150,000 | |
| Phase 43 | 2,200 | 8,800 | 2,200,000 | |
| Phase 44 | 2,250 | 9,000 | 2,250,000 | |
| Phase 45 | 2,300 | 9,200 | 2,300,000 | |
| Phase 46 | 2,350 | 9,400 | 2,350,000 | |
| Phase 47 | 2,400 | 9,600 | 2,400,000 | |
| Phase 48 | 2,450 | 9,800 | 2,450,000 | |
| Phase 49 | 2,500 | 10,000 | 2,500,000 | |
| Phase 50 | 2,550 | 10,200 | 2,550,000 | |
| Phase 51 | 2,600 | 10,400 | 2,600,000 | |
| Phase 52 | 2,650 | 10,600 | 2,650,000 | |
| Phase 53 | 2,700 | 10,800 | 2,700,000 | |
| Phase 54 | 2,750 | 11,000 | 2,750,000 | |
| Phase 55 | 2,800 | 11,200 | 2,800,000 | |
| Phase 56 | 2,850 | 11,400 | 2,850,000 | |
| Phase 57 | 2,900 | 11,600 | 2,900,000 | |
| Phase 58 | 2,950 | 11,800 | 2,950,000 | |
| Phase 59 | 3,000 | 12,000 | 3,000,000 | |
| Phase 60 | 3,050 | 12,200 | 3,050,000 | |
| Phase 61 | 3,100 | 12,400 | 3,100,000 | |
| Phase 62 | 3,150 | 12,600 | 3,150,000 | |
| Phase 63 | 3,200 | 12,800 | 3,200,000 | |
| Phase 64 | 3,250 | 13,000 | 3,250,000 | |
| Phase 65 | 3,300 | 13,200 | 3,300,000 | |
| Phase 66 | 3,350 | 13,400 | 3,350,000 | |
| Phase 67 | 3,400 | 13,600 | 3,400,000 | |
| Phase 68 | 3,450 | 13,800 | 3,450,000 | |
| Phase 69 | 3,500 | 14,000 | 3,500,000 | |
| Phase 70 | 3,550 | 14,200 | 3,550,000 | |
| Phase 71 | 3,600 | 14,400 | 3,600,000 | |
| Phase 72 | 3,650 | 14,600 | 3,650,000 | |
| Phase 73 | 3,700 | 14,800 | 3,700,000 | |
| Phase 74 | 3,750 | 15,000 | 3,750,000 | |
| Phase 75 | 3,800 | 15,200 | 3,800,000 | |
| Phase 76 | 3,850 | 15,400 | 3,850,000 | |
| Phase 77 | 3,900 | 15,600 | 3,900,000 | |
| Phase 78 | 3,950 | 15,800 | 3,950,000 | |
| Phase 79 | 4,000 | 16,000 | 4,000,000 | |
| Phase 80 | 4,050 | 16,200 | 4,050,000 | |
| Phase 81 | 4,100 | 16,400 | 4,100,000 | |
| Phase 82 | 4,150 | 16,600 | 4,150,000 | |
| Phase 83 | 4,200 | 16,800 | 4,200,000 | |
| Phase 84 | 4,250 | 17,000 | 4,250,000 | |
| Phase 85 | 4,300 | 17,200 | 4,300,000 | |
| Phase 86 | 4,350 | 17,400 | 4,350,000 | |
| Phase 87 | 4,400 | 17,600 | 4,400,000 | |
| Phase 88 | 4,450 | 17,800 | 4,450,000 | |
| Phase 89 | 4,500 | 18,000 | 4,500,000 | |
| Phase 90 | 4,550 | 18,200 | 4,550,000 | |
| Phase 91 | 4,600 | 18,400 | 4,600,000 | |
| Phase 92 | 4,650 | 18,600 | 4,650,000 | |
| Phase 93 | 4,700 | 18,800 | 4,700,000 | |
| Phase 94 | 4,750 | 19,000 | 4,750,000 | |
| Phase 95 | 4,800 | 19,200 | 4,800,000 | |
| Phase 96 | 4,850 | 19,400 | 4,850,000 | |
| Phase 97 | 4,900 | 19,600 | 4,900,000 | |
| Phase 98 | 4,950 | 19,800 | 4,950,000 | |
| Phase 99 | 5,000 | 20,000 | 5,000,000 | |
| Phase 100 | 5,050 | 20,200 | 5,050,000 | |

PARKER RODRIGUEZ, INC.

NATIONAL PARK SEMINARY

MONTGOMERY COUNTY MARYLAND

Client Restoration:
 Applicant may, in the future, choose to restore existing historic trails, foot bridges, and gardens located in the Glen. Such restoration would be subject to approval of by the Maryland Historic Trust and the Montgomery County Historic Preservation Commission.

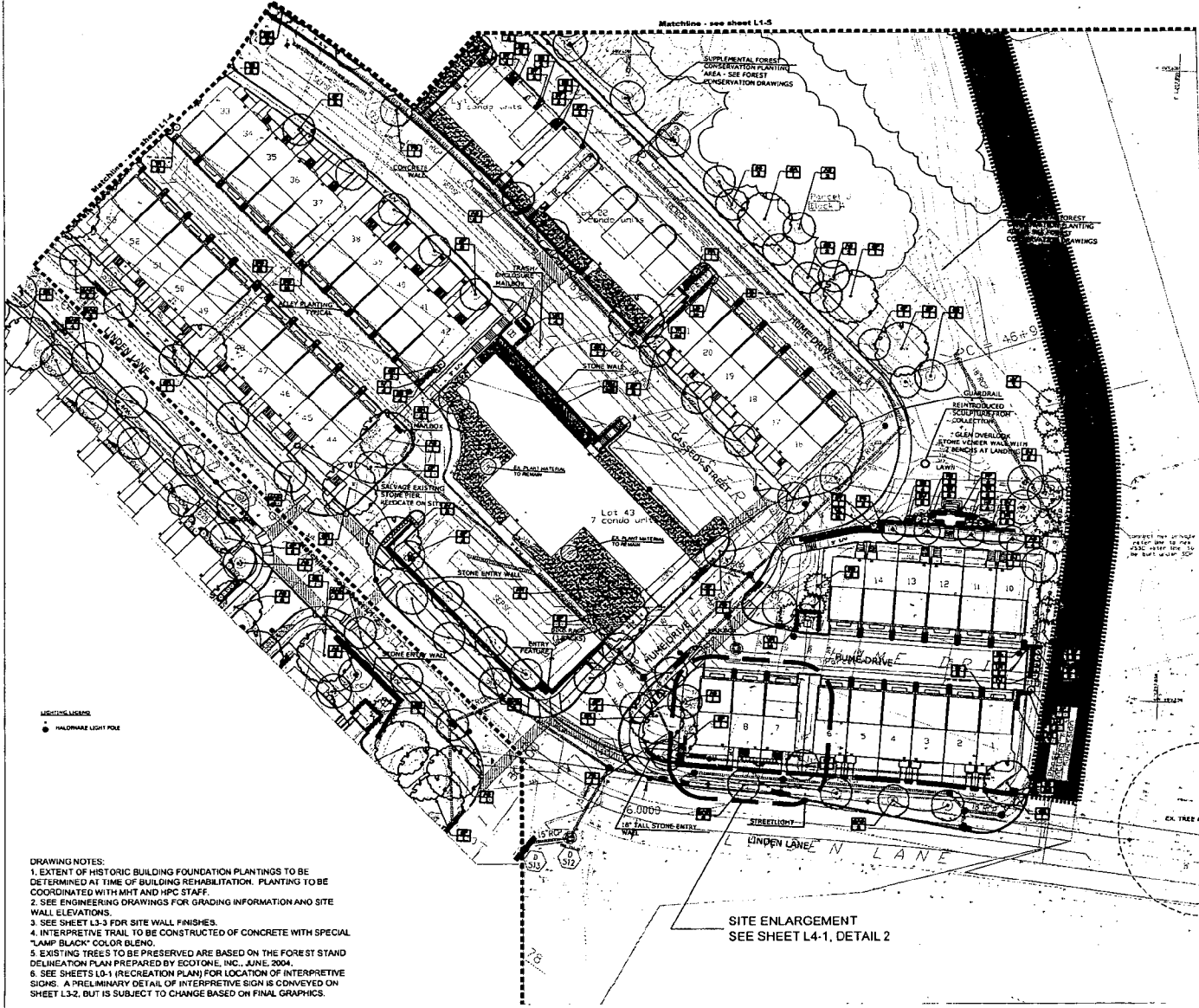

VERTICAL SIGN
 ○ HALLOWEEN LIGHT POLE

- DRAWING NOTES:**
1. EXTENT OF HISTORIC BUILDING FOUNDATION PLANTINGS TO BE DETERMINED AT TIME OF BUILDING REHABILITATION. PLANTING TO BE COORDINATED WITH MHT AND HPC STAFF.
 2. SEE ENGINEERING DRAWINGS FOR GRADING INFORMATION AND SITE WALL ELEVATIONS.
 3. SEE SHEET L3-3 FOR SITE WALL FINISHES.
 4. INTERPRETIVE TRAIL TO BE CONSTRUCTED OF CONCRETE WITH SPECIAL "LAMP BLACK" COLOR BLEND.
 5. EXISTING TREES TO BE PRESERVED ARE BASED ON THE FOREST STAND DELINEATION PLAN PREPARED BY ECOTONE, INC., JUNE 2004.
 6. SEE SHEETS L0-1 (RECREATION PLAN) FOR LOCATION OF INTERPRETIVE SIGNS. A PRELIMINARY DETAIL OF INTERPRETIVE SIGN IS CONVEYED ON SHEET L3-2, BUT IS SUBJECT TO CHANGE BASED ON FINAL GRAPHICS.

SITE ENLARGEMENT
 SEE SHEET L4-1, DETAIL 2

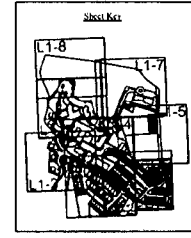

PARKER RODRIGUEZ, INC.
 1000 N. W. 10th Ave., Suite 100
 Ft. Lauderdale, FL 33304
 Phone: (954) 561-1111
 Fax: (954) 561-1112
 www.parkerrodriguez.com

LANDSCAPE PLAN

NATIONAL PARK SEMINARY
 MONTGOMERY COUNTY
 MARYLAND

| | |
|-----------------|-----------|
| Author & Date: | |
| Checked by: | |
| Date: | 01.25.05 |
| Scale: | 1"=30'-0" |
| Drawing Number: | L1-1 |
| Sheet: | 2 of 2 |

10

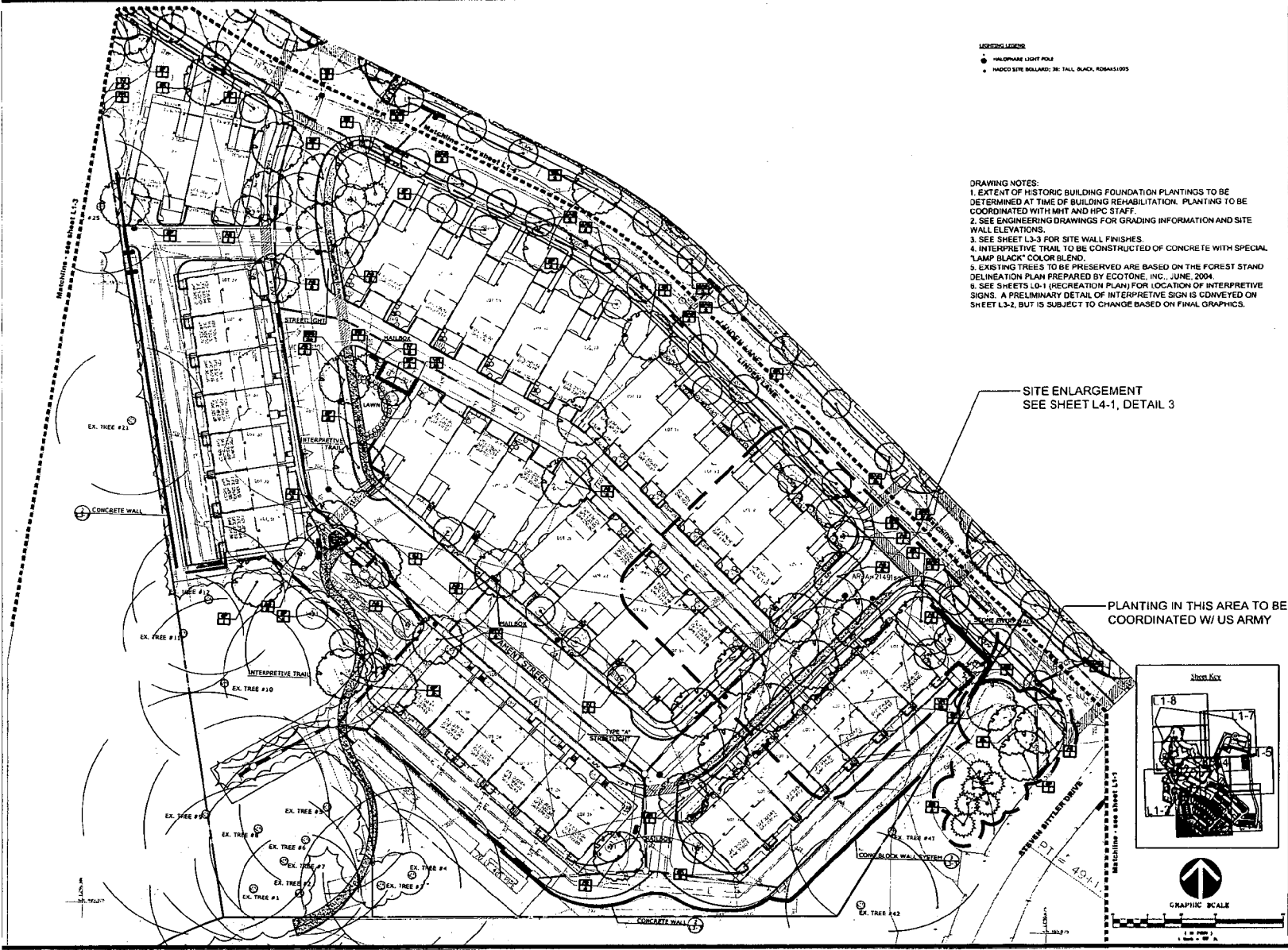

- LEGEND**
- WALLPAPER LIGHT POLE
 - HAZCO SITE WALL: 36" TALL, BLACK, R08A611095

- DRAWING NOTES:**
1. EXTENT OF HISTORIC BUILDING FOUNDATION PLANTINGS TO BE DETERMINED AT TIME OF BUILDING REHABILITATION. PLANTING TO BE COORDINATED WITH MHT AND HPC STAFF.
 2. SEE ENGINEERING DRAWINGS FOR GRADING INFORMATION AND SITE WALL ELEVATIONS.
 3. SEE SHEET L3-3 FOR SITE WALL FINISHES.
 4. INTERPRETIVE TRAIL TO BE CONSTRUCTED OF CONCRETE WITH SPECIAL "LAMP BLACK" COLOR BLEND.
 5. EXISTING TREES TO BE PRESERVED ARE BASED ON THE FOREST STAND DELINEATION PLAN PREPARED BY ECOTONE, INC., JUNE 2004.
 6. SEE SHEETS L0-1 (RECREATION PLAN) FOR LOCATION OF INTERPRETIVE SIGNS. A PRELIMINARY DETAIL OF INTERPRETIVE SIGN IS CONVEYED ON SHEET L3-2, BUT IS SUBJECT TO CHANGE BASED ON FINAL GRAPHICS.

SITE ENLARGEMENT
SEE SHEET L4-1, DETAIL 3

PLANTING IN THIS AREA TO BE
COORDINATED W/ US ARMY

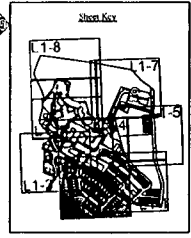

| | |
|--------------|----------|
| Author | DC |
| Checked by | DC |
| Drawn by | DC |
| Date | 11/20/05 |
| Scale | AS SHOWN |
| Sheet Number | L-1-2 |
| Sheet 2 of 2 | |

PARKER RODRIGUEZ, INC.
 LANDSCAPE PLAN
 NATIONAL PARK SEMINARY
 MONTGOMERY COUNTY, MARYLAND

11

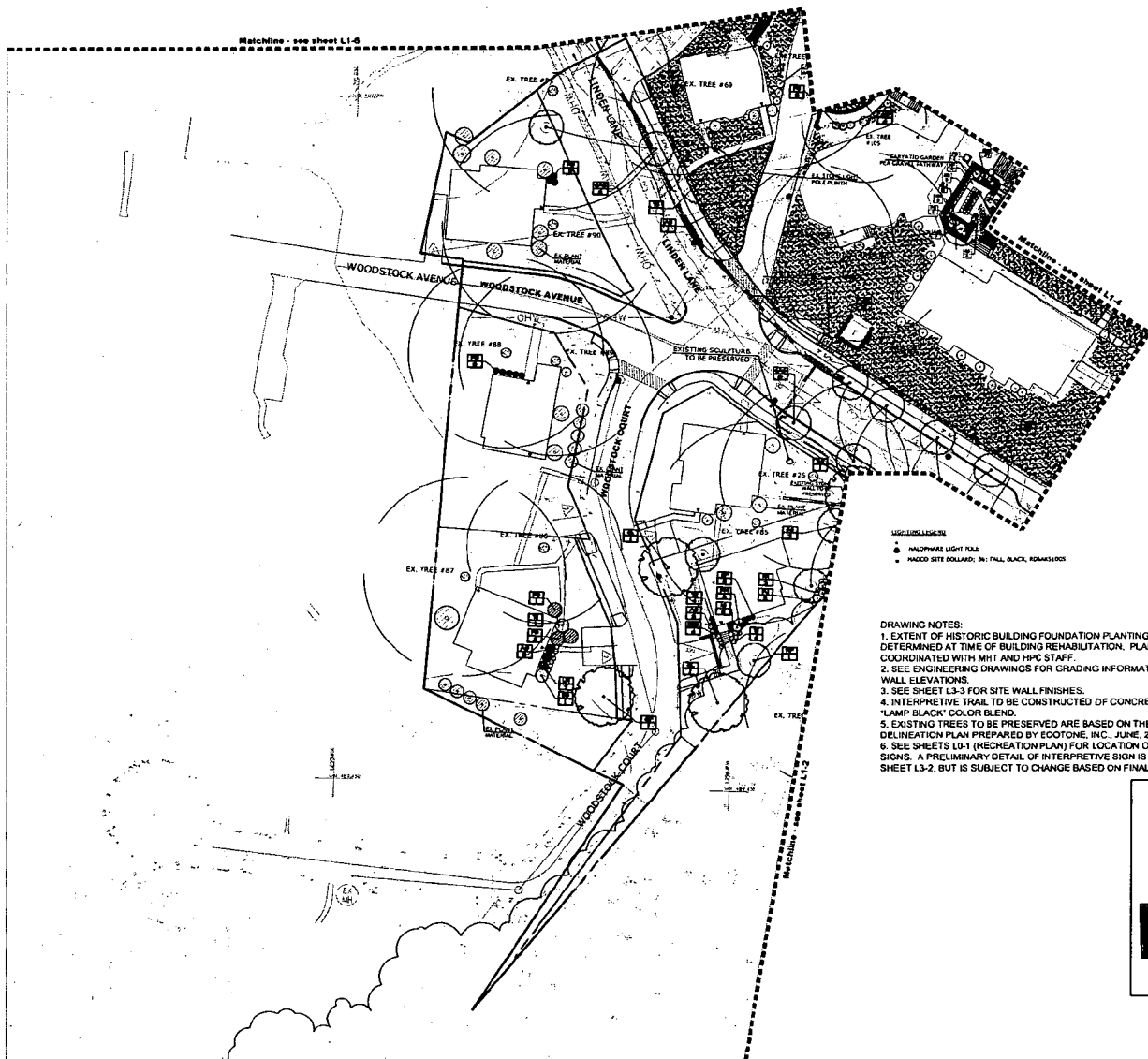

- DRAWING NOTES:**
1. EXTENT OF HISTORIC BUILDING FOUNDATION PLANTINGS TO BE DETERMINED AT TIME OF BUILDING REHABILITATION. PLANTING TO BE COORDINATED WITH MHT AND HPC STAFF.
 2. SEE ENGINEERING DRAWINGS FOR GRADING INFORMATION AND SITE WALL ELEVATIONS.
 3. SEE SHEET L3-3 FOR SITE WALL FINISHES.
 4. INTERPRETIVE TRAIL TO BE CONSTRUCTED OF CONCRETE WITH SPECIAL "LAMP BLACK" COLOR BLEND.
 5. EXISTING TREES TO BE PRESERVED ARE BASED ON THE FOREST STAND DELINEATION PLAN PREPARED BY ECOTONE, INC., JUNE, 2004.
 6. SEE SHEETS L0-1 (RECREATION PLAN) FOR LOCATION OF INTERPRETIVE SIGNS. A PRELIMINARY DETAIL OF INTERPRETIVE SIGN IS CONVEYED ON SHEET L3-2, BUT IS SUBJECT TO CHANGE BASED ON FINAL GRAPHICS.

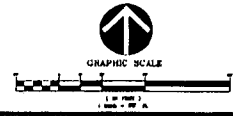
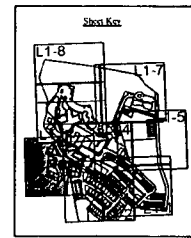

PARKER RODRIGUEZ, INC.
 10000 Rockville Pike, Suite 200
 Rockville, MD 20850
 Phone: 301-761-1000
 Fax: 301-761-1001
 www.parkerrodriguez.com

LANDSCAPE PLAN

NATIONAL PARK SEMINARY
 MONTGOMERY COUNTY, MARYLAND

| | |
|---|--|
| Revision & Date | |
| Prepared and Constructed by: PARKER RODRIGUEZ, INC. | |
| Scale: AS SHOWN | |
| Drawn by: A.C. CS | |
| Checked by: W.A. | |
| Designed by: A. | |
| Date: 01.25.05 | |
| Project: L1-3 | |

Drawing Number:
L1-3
 Sheet 4 of 4

PARKER RODRIGUEZ, INC.
 1000 N. 10th St., Suite 100
 Phoenix, AZ 85006
 Phone: (602) 955-1100
 Fax: (602) 955-1101

LANDSCAPE PLAN

NATIONAL PARK SEMINARY

MONTGOMERY COUNTY, MARYLAND

Scale: 1/8" = 1'-0"
 Date: 06/27/07
 Drawing Number: L1-4
 Sheet 0 of 0

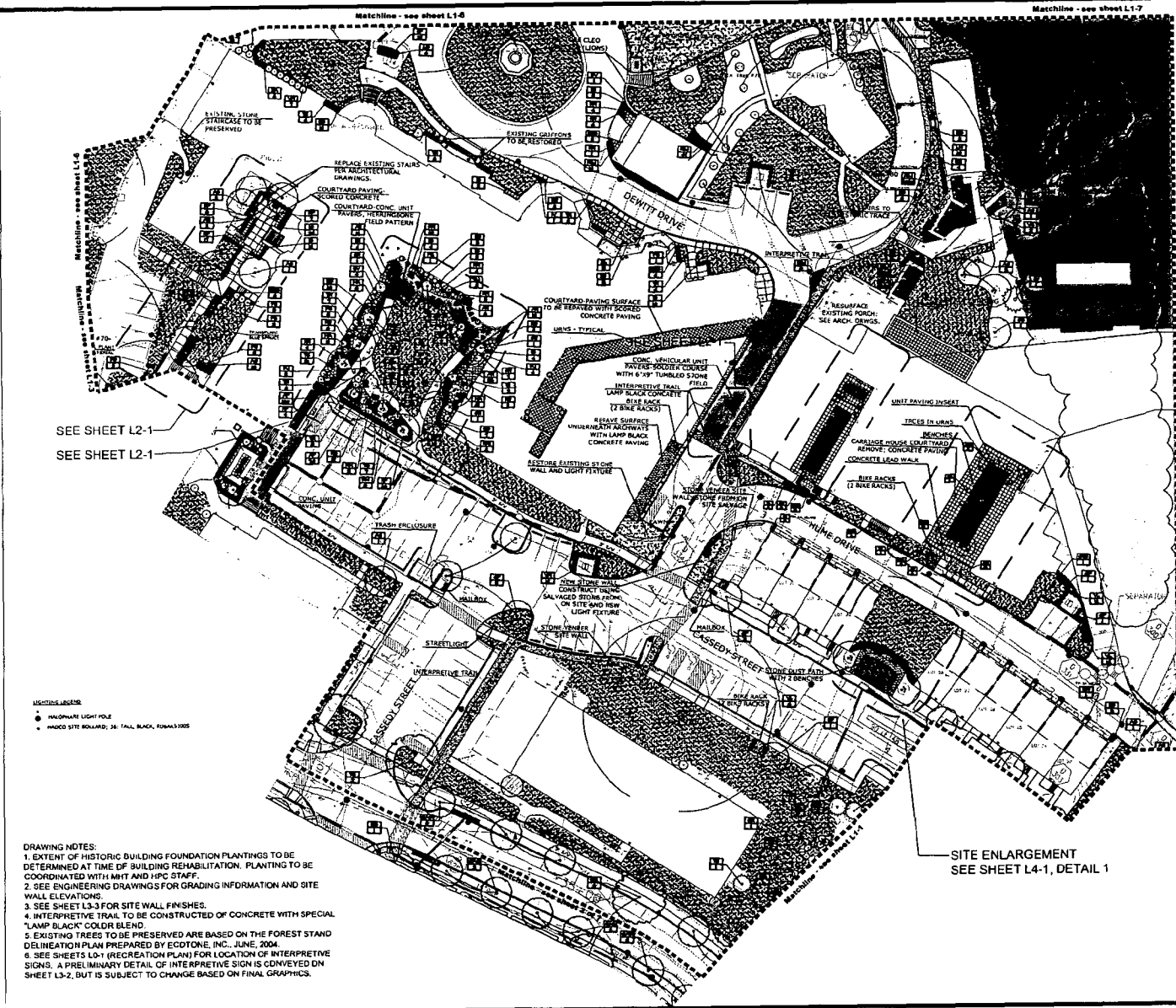
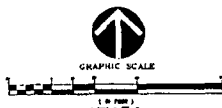
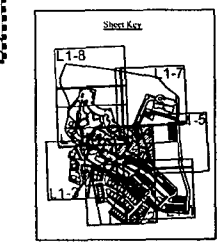

SEE SHEET L2-1

SEE SHEET L2-1

Matchline - see sheet L1-5

SEE SHEET L2-1
 SEE SHEET L2-1

SITE ENLARGEMENT
 SEE SHEET L4-1, DETAIL 1

- LEGEND:**
- HANDICAP LIGHT POLE
 - HAZARD SITE BOLLARD; 36" TALL, BLACK, EDWARDS 1005

- DRAWING NOTES:**
1. EXTENT OF HISTORIC BUILDING FOUNDATION PLANTINGS TO BE DETERMINED AT TIME OF BUILDING REHABILITATION. PLANTING TO BE COORDINATED WITH MHT AND HPC STAFF.
 2. SEE ENGINEERING DRAWINGS FOR GRADING INFORMATION AND SITE WALL ELEVATIONS.
 3. SEE SHEET L3-3 FOR SITE WALL FINISHES.
 4. INTERPRETIVE TRAIL TO BE CONSTRUCTED OF CONCRETE WITH SPECIAL "LAMP BLACK" COLOR BLEND.
 5. EXISTING TREES TO BE PRESERVED ARE BASED ON THE FOREST STAND DELINEATION PLAN PREPARED BY ECOTONE, INC., JUNE, 2004.
 6. SEE SHEETS L-1 (RECREATION PLAN) FOR LOCATION OF INTERPRETIVE SIGNS. A PRELIMINARY DETAIL OF INTERPRETIVE SIGN IS CONVEYED ON SHEET L3-2, BUT IS SUBJECT TO CHANGE BASED ON FINAL GRAPHICS.

13

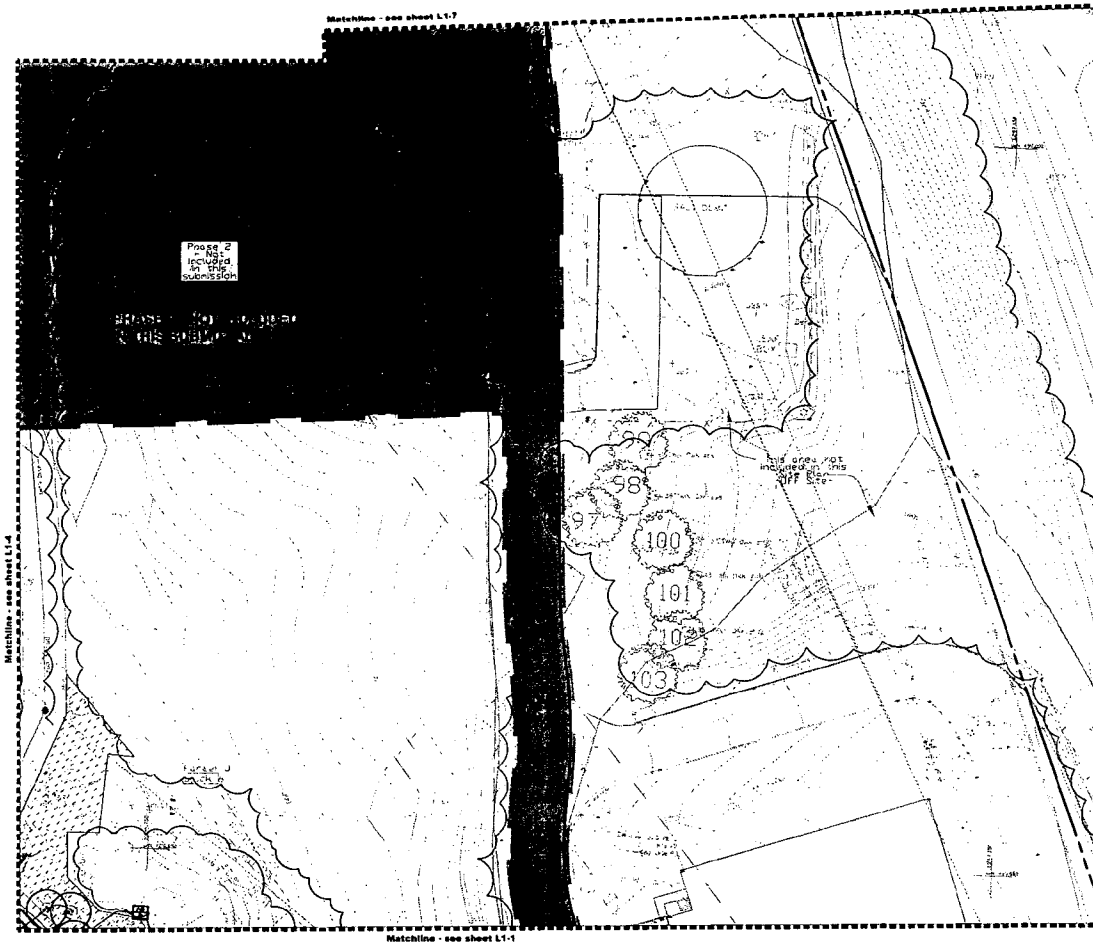

Page 2
- NOT
RECORDED
IN THE
SUBMISSION

PLANTING
SCHEDULE

NOTING LEGEND

- MASONRY LIGHT POLE
- MADED SITE BOLLARD, 38" TALL BLACK, R064431005

DRAWING NOTES:

1. EXTENT OF HISTORIC BUILDING FOUNDATION PLANTINGS TO BE DETERMINED AT TIME OF BUILDING REHABILITATION. PLANTING TO BE COORDINATED WITH MHT AND HPC STAFF.
2. SEE ENGINEERING DRAWINGS FOR GRADING INFORMATION AND SITE WALL ELEVATIONS.
3. SEE SHEET L3-3 FOR SITE WALL FINISHES.
4. INTERPRETIVE TRAIL TO BE CONSTRUCTED OF CONCRETE WITH SPECIAL 'LAMP BLACK' COLOR BLEND.
5. EXISTING TREES TO BE PRESERVED ARE BASED ON THE FOREST STAND DELINEATION PLAN PREPARED BY ECOTONE, INC., JUNE, 2004.
6. SEE SHEETS L0-1 (RECREATION PLAN) FOR LOCATION OF INTERPRETIVE SIGNS. A PRELIMINARY DETAIL OF INTERPRETIVE SIGN IS CONVEYED ON SHEET L3-2, BUT IS SUBJECT TO CHANGE BASED ON FINAL GRAPHICS.

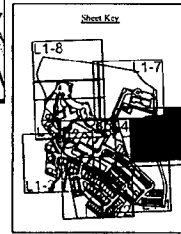

PARKER RODRIGUEZ, INC.
 1000 N. 10th St., Suite 200
 Phoenix, AZ 85006
 Phone: (602) 998-8888
 Fax: (602) 998-8889
 Website: www.parkerrodriguez.com

LANDSCAPE PLAN

NATIONAL PARK SEMINARY
 MONTGOMERY COUNTY
 MARYLAND

Revisions & Order

| Revised and resubmitted | For drawing comments | Date |
|-------------------------|----------------------|------|
| | | |
| | | |
| | | |

Drawn by: J.C. CS
Designed by: J.C. CS
Checked by: J.C. CS
Date: 01/20/08
Scale: 1/8" = 1'-0"

Drawing Number: L1-5
Sheet # of: 8

171

(K)

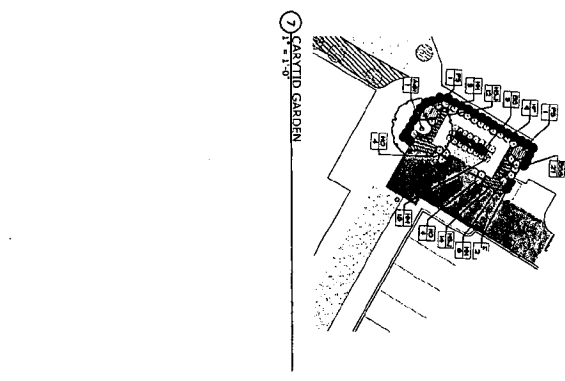
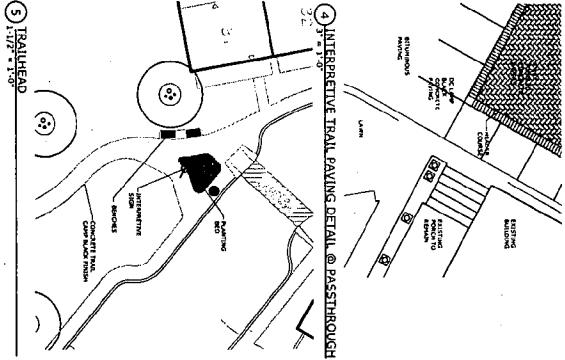
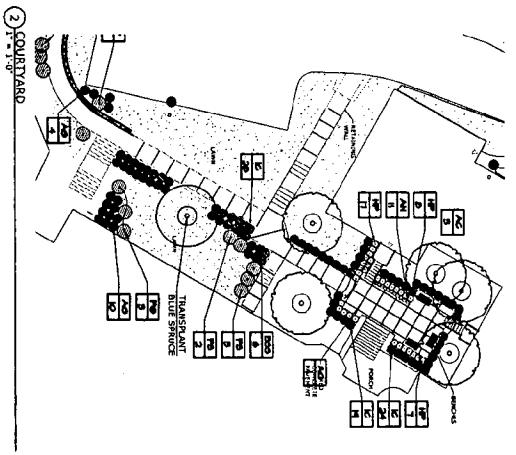
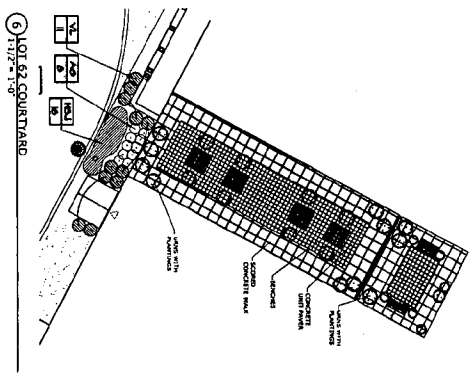
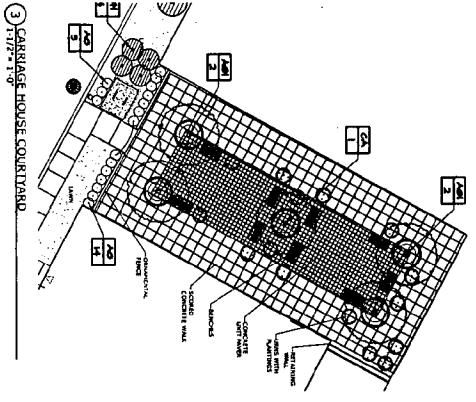
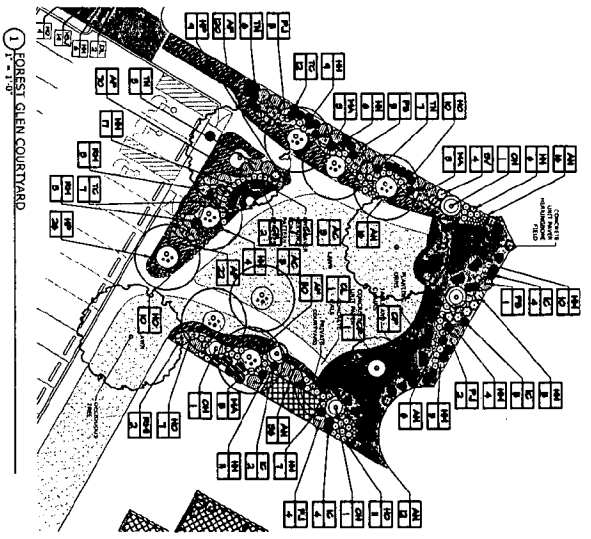

| | | | |
|---|--|--------------------|---|
| <p>Scale: 1/8" = 1'-0"</p> <p>North Arrow</p> <p>DATE: 12-1</p> <p>PROJECT: NATIONAL PARK SEMINARY</p> <p>LOCATION: MONTGOMERY COUNTY, MARYLAND</p> | <p>NATIONAL PARK SEMINARY</p> <p>MONTGOMERY COUNTY MARYLAND</p> | <p>ENLARGMENTS</p> | <p>PARKER RODRIGUEZ, INC.</p> <p>100 North Main Street, Suite 200 Rockville, Maryland 20850 301.761.2000</p> |
|---|--|--------------------|---|

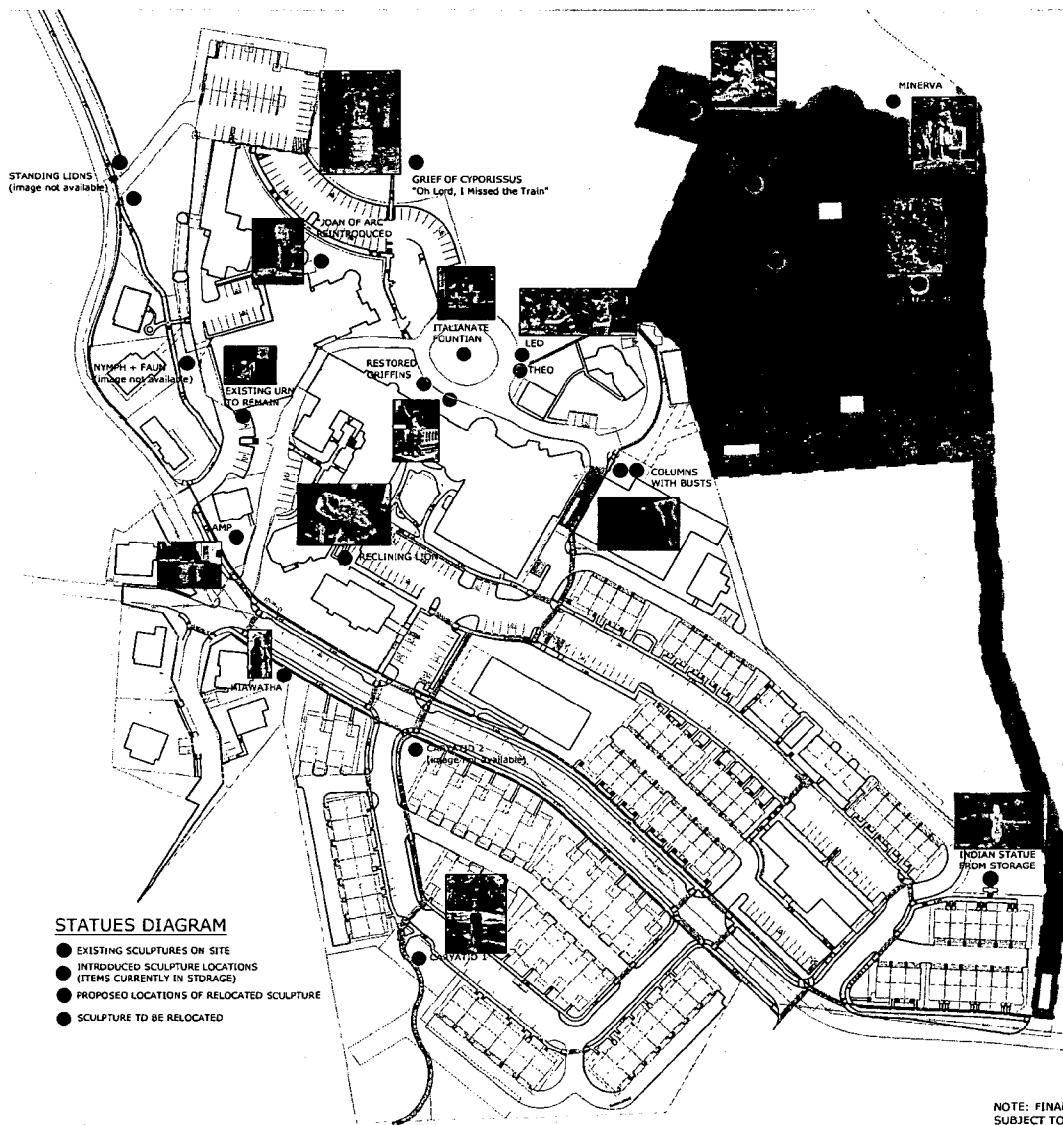

STATUES DIAGRAM

- EXISTING SCULPTURES ON SITE
- INTRODUCED SCULPTURE LOCATIONS (ITEMS CURRENTLY IN STORAGE)
- PROPOSED LOCATIONS OF RELOCATED SCULPTURE
- SCULPTURE TO BE RELOCATED

NOTE: FINAL LOCATION OF ALL SCULPTURE SUBJECT TO SITE CONSTRAINTS, HISTORICAL DATA AND FINAL ENGINEERING.

PARKER RODRIGUEZ, INC.
 101 North Main Street, Suite 200
 Frederick, MD 21701
 Phone: 301-746-1000
 Fax: 301-746-1001

SITE FEATURES

NATIONAL PARK SEMINARY
 MONTGOMERY COUNTY, MARYLAND

Revised & Date:
 Revised and Resubmitted:
 FOR PRELIMINARY APPROVAL:
 J. L. R. R.
 5.8.05

Drawn by:
 J.C. D.
 Designed by:
 R. A.
 Checked by:
 A.
 Date:
 01/28/05
 Scale:
 AS NOTED

Drawing Number:
L2-2
 Sheet of

(19)

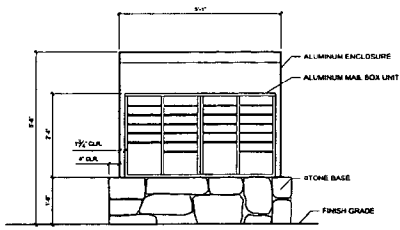

ELEVATION



PLAN

1 MAILBOX ENCLOSURE
SCALE: 1/4"=1'-0"

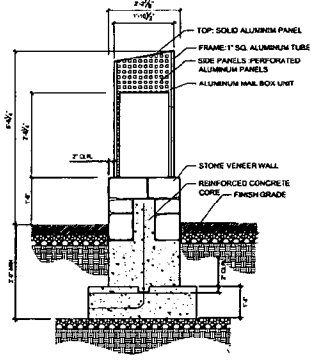

SECTION

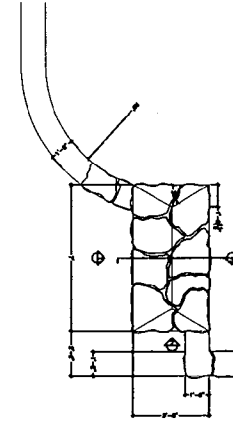

4 STONE ENTRY PLINTH AND PILLAR - PLAN VIEW
SCALE: 1/2"=1'-0"

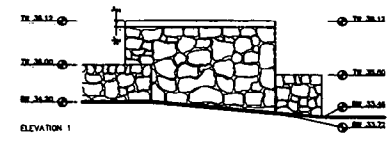

ELEVATION 1



ELEVATION 2

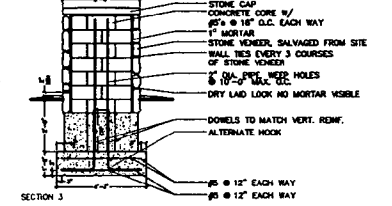

5 STONE ENTRY PLINTH AND PILLAR - ELEVATION, SECTION
SCALE: 1/2"=1'-0"

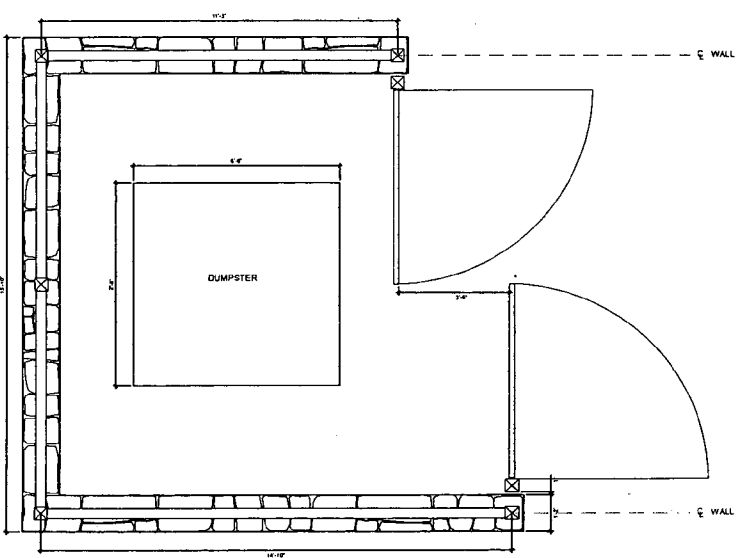

2 DUMPSTER ENCLOSURE - PLAN VIEW
SCALE: 3/4"=1'-0"

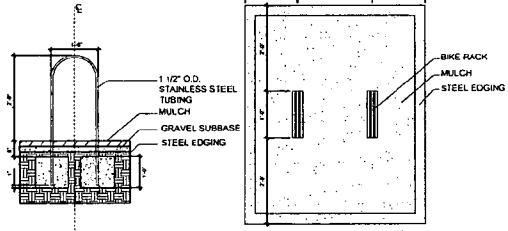

3 BIKE RACK
SCALE: 3/4"=1'-0"

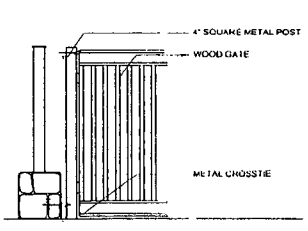

6 DUMPSTER ENCLOSURE - ELEVATION
SCALE: 3/4"=1'-0"

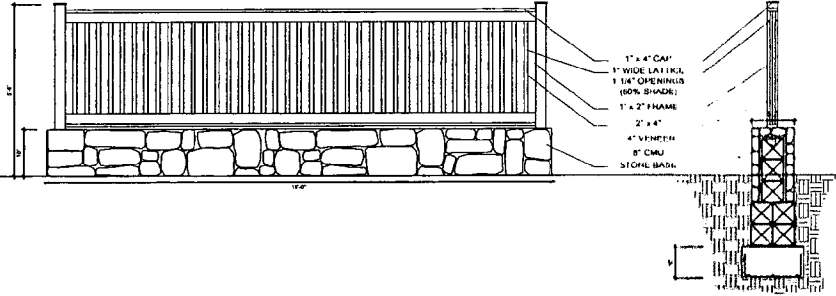

7 DUMPSTER ENCLOSURE - ELEVATION AND SECTION
SCALE: 3/4"=1'-0"

PARKER RODRIGUEZ, INC.
111 South Wood Street, Suite 200
Baltimore, Maryland 21202
Phone: (410) 524-1100
Fax: (410) 524-1101

SITE DETAILS

NATIONAL PARK SEMINARY
MONTGOMERY COUNTY, MARYLAND

Revision & Date:
 Prepared and Produced by:
 All Agency Comments:
 S. J. J. J.
 S. J. J. J.
 Drawn by:
 P. A.
 Designed by:
 P. A.
 Checked by:
 A.
 Date:
 10.25.00
 Scale:
 AS NOTED

Drawing Number:
 L3-2
 Sheet 4 of 4

12

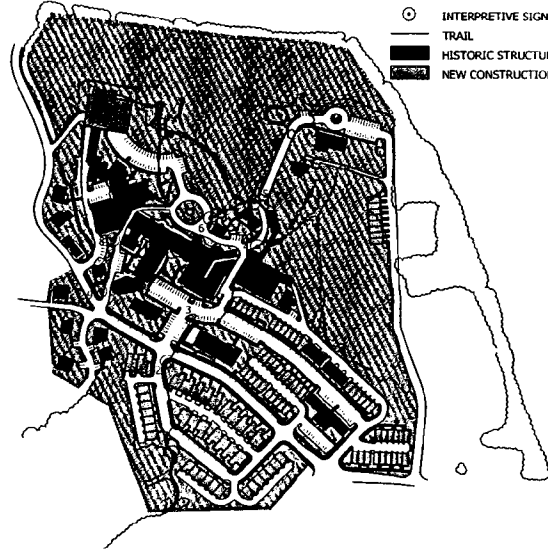
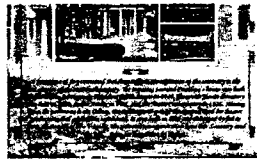
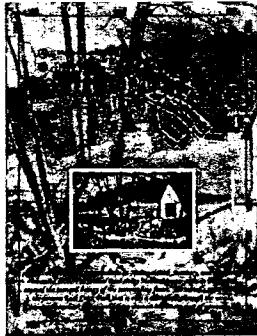

2 MAP
3/32" = 1'

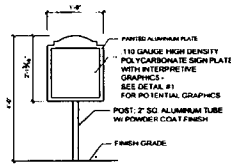

ELEVATION

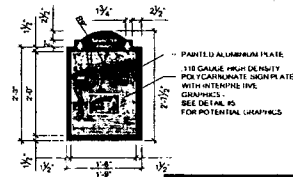

4 INTERPRETIVE SIGN
1" = 1'

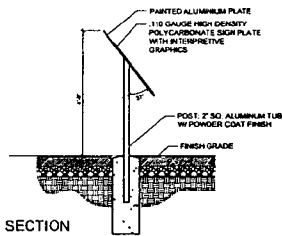

SECTION

3 INTERPRETIVE SIGN DETAIL
3/4" = 1'



1 INTERPRETIVE SIGNS
NOT TO SCALE

PARKER RODRIGUEZ, INC.
 401 West Main Street, Suite 200
 Frederick, Maryland 21701
 Phone: 410-326-1111
 Fax: 410-326-1112

INTERPRETIVE SIGNS

NATIONAL PARK SEMINARY

MONTGOMERY COUNTY MARYLAND

Revised & Date:
 Revised and comments:
 2.28.03
 4.4.05

Drawn by:
 J.P. CS
 Checked by:
 P.R. A.
 Date:
 01.25.05
 Scale:
 AS SHOWN

Drawing Number:

L3-4

Sheet 11 of

23

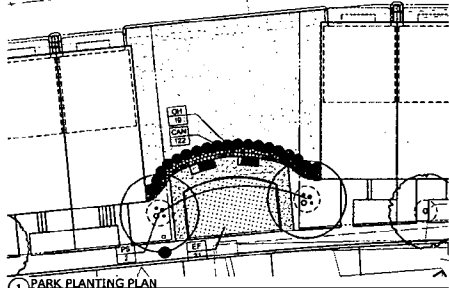

1 PARK PLANTING PLAN
SCALE: 1/4"

| PLANT LIST | Qty | Key | Unit Botanical Name | Common Name | Size | Condition | Comments |
|--------------------------|-----|-----|--|---------------------|--------|-----------|-----------------------------|
| ORNAMENTAL SHRUBS | | | | | | | |
| PS | 2 | | <i>Pinus serotina</i> 'Millers' | Keweenaw Pines | 6-10' | B&B | heavy, matched, symmetrical |
| EVERGREEN SHRUBS | | | | | | | |
| CS | 21 | | <i>Conium maculatum</i> 'Gaulth' | Common Cold Currant | 24-30" | cont. | all branching to ground |
| CH | 18 | | <i>Chamaecyparis heterophylla</i> 'Gaulth' | Common False Holly | 24-30" | cont. | all branching to ground |
| Perennials | | | | | | | |
| CAN | 122 | | <i>Coropatus verticillata</i> 'Nana' | Dwarf Cocksfoot | 1 gal. | cont. | 12' x 6' |

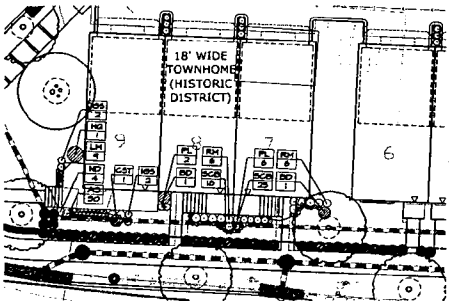

2 TYPICAL UNIT PLANTING PLAN - 18'-0" WIDE UNIT IN HISTORIC DISTRICT
SCALE: 1/4"

| TYPICAL UNIT PLANT LIST | Qty | Key | Unit Botanical Name | Common Name | Size | Condition | Comments |
|-------------------------|-----|-----|-----------------------------------|-----------------------|-----------|-----------|-----------------------------|
| SHRUBS | | | | | | | |
| CS | 1 | | <i>Conium maculatum</i> | Red Top Dogwood | 30" x 30" | cont. | heavy, matched, symmetrical |
| HS | 1 | | <i>Hydrangea quercifolia</i> | Oak Leaf Hydrangea | 30" x 30" | cont. | heavy, matched, symmetrical |
| EVERGREEN SHRUBS | | | | | | | |
| CS | 4 | | <i>Conium maculatum</i> | Common Cold Currant | 24-30" | B&B | all branching, upright |
| CH | 4 | | <i>Chamaecyparis heterophylla</i> | Common False Holly | 24-30" | B&B | all branching, upright |
| Perennials | | | | | | | |
| AS | 30 | | <i>Asplenium platyneuron</i> | White Asplenium | 1 gal. | cont. | |
| LS | 8 | | <i>Liriodendron tulipifera</i> | Big Blue Liriodendron | 1 gal. | cont. | |

| TYPICAL UNIT PLANT LIST | Qty | Key | Unit Botanical Name | Common Name | Size | Condition | Comments |
|-------------------------|-----|-----|----------------------------------|--------------------------------|--------|-----------|-----------------------------|
| SHRUBS | | | | | | | |
| BS | 1 | | <i>Buddleia davidii</i> | Black Knight Butterfly Bush | 24-30" | cont. | heavy, matched, symmetrical |
| MS | 1 | | <i>Myrica asplenifolia</i> | May Sedge Asplenium | 24-30" | cont. | all branching to ground |
| EVERGREEN SHRUBS | | | | | | | |
| PL | 2 | | <i>Pinus strobus</i> 'Otto Lutz' | Otto Lutz Pine | 24-30" | B&B | all branching, upright |
| Perennials | | | | | | | |
| SCR | 16 | | <i>Scilla maritima</i> | Buttery Blue Periwinkle Flower | 1 gal. | cont. | 12' x 6' |

| TYPICAL UNIT PLANT LIST | Qty | Key | Unit Botanical Name | Common Name | Size | Condition | Comments |
|-------------------------|-----|-----|----------------------------------|--------------------------------|--------|-----------|-----------------------------|
| SHRUBS | | | | | | | |
| BS | 1 | | <i>Buddleia davidii</i> | Black Knight Butterfly Bush | 24-30" | cont. | heavy, matched, symmetrical |
| MS | 1 | | <i>Myrica asplenifolia</i> | May Sedge Asplenium | 24-30" | cont. | all branching to ground |
| EVERGREEN SHRUBS | | | | | | | |
| PL | 2 | | <i>Pinus strobus</i> 'Otto Lutz' | Otto Lutz Pine | 24-30" | B&B | all branching, upright |
| Perennials | | | | | | | |
| SCR | 25 | | <i>Scilla maritima</i> | Buttery Blue Periwinkle Flower | 1 gal. | cont. | 12' x 6' |

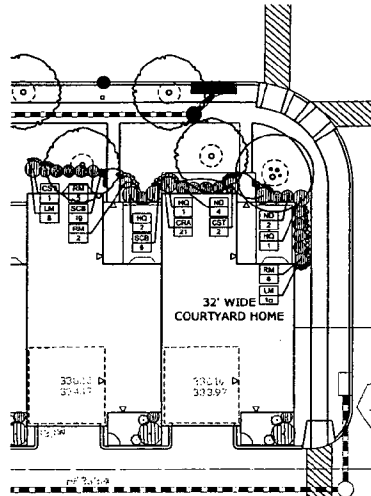

3 TYPICAL UNIT PLANTING PLAN - 32' WIDE COURTYARD HOME
SCALE: 1/4"

| TYPICAL UNIT PLANT LIST | Qty | Key | Unit Botanical Name | Common Name | Size | Condition | Comments |
|-------------------------|-----|-----|--------------------------------|--------------------------------|-----------|-----------|-----------------------------|
| SHRUBS | | | | | | | |
| CS | 1 | | <i>Conium maculatum</i> | Red Top Dogwood | 30" x 30" | cont. | heavy, matched, symmetrical |
| HS | 2 | | <i>Hydrangea quercifolia</i> | Oak Leaf Hydrangea | 30" x 30" | cont. | heavy, matched, symmetrical |
| MS | 1 | | <i>Myrica asplenifolia</i> | May Sedge Asplenium | 24-30" | cont. | all branching to ground |
| LS | 8 | | <i>Liriodendron tulipifera</i> | Big Blue Liriodendron | 1 gal. | cont. | |
| SCR | 22 | | <i>Scilla maritima</i> | Buttery Blue Periwinkle Flower | 1 gal. | cont. | 12' x 6' |

| TYPICAL UNIT PLANT LIST | Qty | Key | Unit Botanical Name | Common Name | Size | Condition | Comments |
|-------------------------|-----|-----|--------------------------------|--------------------------------|-----------|-----------|-----------------------------|
| SHRUBS | | | | | | | |
| CS | 1 | | <i>Conium maculatum</i> | Red Top Dogwood | 30" x 30" | cont. | heavy, matched, symmetrical |
| HS | 2 | | <i>Hydrangea quercifolia</i> | Oak Leaf Hydrangea | 30" x 30" | cont. | heavy, matched, symmetrical |
| MS | 1 | | <i>Myrica asplenifolia</i> | May Sedge Asplenium | 24-30" | cont. | all branching to ground |
| HS | 1 | | <i>Hydrangea quercifolia</i> | Oak Leaf Hydrangea | 30" x 30" | cont. | heavy, matched, symmetrical |
| MS | 1 | | <i>Myrica asplenifolia</i> | May Sedge Asplenium | 24-30" | cont. | all branching to ground |
| LS | 8 | | <i>Liriodendron tulipifera</i> | Big Blue Liriodendron | 1 gal. | cont. | |
| SCR | 21 | | <i>Scilla maritima</i> | Buttery Blue Periwinkle Flower | 1 gal. | cont. | 12' x 6' |

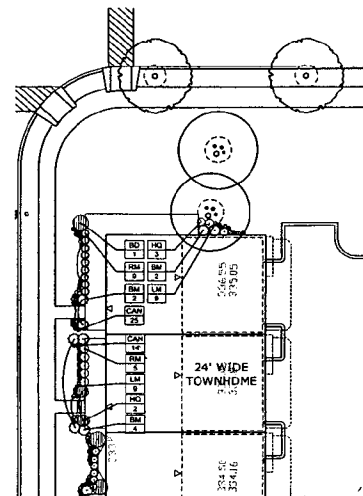

4 TYPICAL UNIT PLANTING PLAN - 24' WIDE TOWNHOME
SCALE: 1/4"

| TYPICAL UNIT PLANT LIST | Qty | Key | Unit Botanical Name | Common Name | Size | Condition | Comments |
|-------------------------|-----|-----|--------------------------------|-----------------------------|--------|-----------|-----------------------------|
| SHRUBS | | | | | | | |
| BS | 1 | | <i>Buddleia davidii</i> | Black Knight Butterfly Bush | 24-30" | cont. | heavy, matched, symmetrical |
| MS | 1 | | <i>Myrica asplenifolia</i> | May Sedge Asplenium | 24-30" | cont. | all branching to ground |
| EVERGREEN SHRUBS | | | | | | | |
| MS | 4 | | <i>Myrica asplenifolia</i> | May Sedge Asplenium | 24-30" | B&B | all branching, upright |
| LS | 8 | | <i>Liriodendron tulipifera</i> | Big Blue Liriodendron | 1 gal. | cont. | |
| Perennials | | | | | | | |
| CAN | 15 | | <i>Coropatus verticillata</i> | Dwarf Cocksfoot | 1 gal. | cont. | 12' x 6' |

| TYPICAL UNIT PLANT LIST | Qty | Key | Unit Botanical Name | Common Name | Size | Condition | Comments |
|-------------------------|-----|-----|--------------------------------|-----------------------|-----------|-----------|-----------------------------|
| SHRUBS | | | | | | | |
| CS | 1 | | <i>Conium maculatum</i> | Red Top Dogwood | 30" x 30" | cont. | heavy, matched, symmetrical |
| HS | 2 | | <i>Hydrangea quercifolia</i> | Oak Leaf Hydrangea | 30" x 30" | cont. | heavy, matched, symmetrical |
| MS | 1 | | <i>Myrica asplenifolia</i> | May Sedge Asplenium | 24-30" | cont. | all branching to ground |
| MS | 1 | | <i>Myrica asplenifolia</i> | May Sedge Asplenium | 24-30" | B&B | all branching, upright |
| LS | 8 | | <i>Liriodendron tulipifera</i> | Big Blue Liriodendron | 1 gal. | cont. | |
| Perennials | | | | | | | |
| CAN | 14 | | <i>Coropatus verticillata</i> | Dwarf Cocksfoot | 1 gal. | cont. | 12' x 6' |

PARKER RODRIGUEZ, INC.
 1000 N. W. 10th St., Suite 100
 Ft. Lauderdale, FL 33304
 (954) 562-1111
 FAX (954) 562-1112
 www.parkerrodriguez.com

NATIONAL PARK SEMINARY
 MONTGOMERY COUNTY, MARYLAND

Revision & Date
 Revised and published
 All other comments
 JLR/SP
 1/1/02

Drawn by
 P. C.
 Checked by
 P. A.
 Approved by
 A.
 Date
 1/1/02
 Scale
 1/4" = 1'-0"

Sheet Number
 L4-1
 Sheet 16 of 17

PR

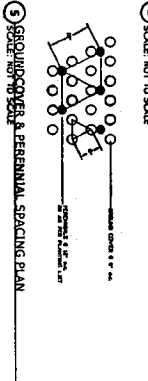
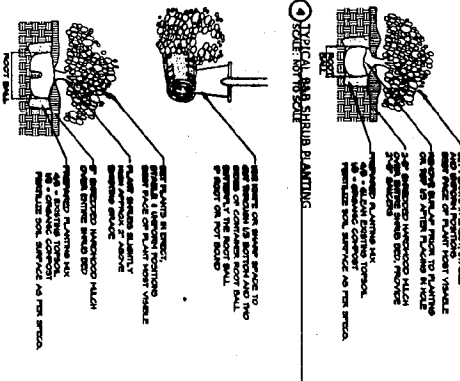
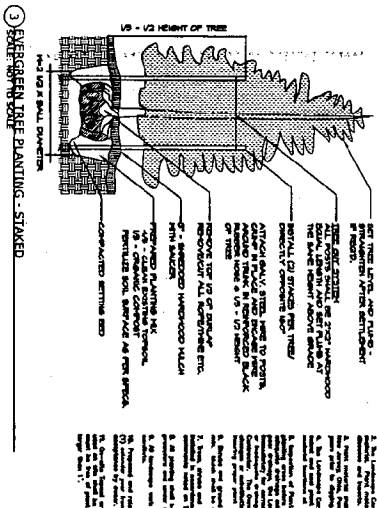
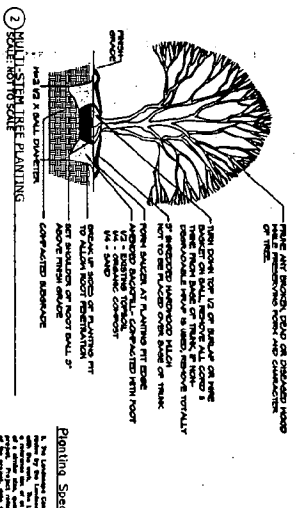
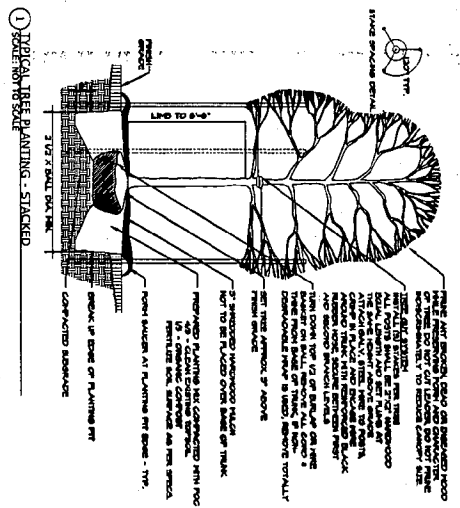

Planting Specifications:

1. All plants shall be planted in a hole 2 to 3 times the diameter of the root ball. The hole shall be dug to a depth of 12 to 18 inches below the root ball. The hole shall be filled with a mixture of soil and fertilizer. The plants shall be watered thoroughly after planting.

2. All plants shall be planted in a hole 2 to 3 times the diameter of the root ball. The hole shall be dug to a depth of 12 to 18 inches below the root ball. The hole shall be filled with a mixture of soil and fertilizer. The plants shall be watered thoroughly after planting.

3. All plants shall be planted in a hole 2 to 3 times the diameter of the root ball. The hole shall be dug to a depth of 12 to 18 inches below the root ball. The hole shall be filled with a mixture of soil and fertilizer. The plants shall be watered thoroughly after planting.

4. All plants shall be planted in a hole 2 to 3 times the diameter of the root ball. The hole shall be dug to a depth of 12 to 18 inches below the root ball. The hole shall be filled with a mixture of soil and fertilizer. The plants shall be watered thoroughly after planting.

5. All plants shall be planted in a hole 2 to 3 times the diameter of the root ball. The hole shall be dug to a depth of 12 to 18 inches below the root ball. The hole shall be filled with a mixture of soil and fertilizer. The plants shall be watered thoroughly after planting.

| KEY BOTANICAL NAME | COMMON NAME | QUANTITY | SIZE | ROOT | REMARKS |
|--------------------|-------------|----------|--------|------|---------|
| 1. <i>Platanus</i> | Platanus | 10 | 24\"/> | | |

NATIONAL PARK SEMINARY

MONTGOMERY COUNTY MARYLAND

PLANTING DETAILS AND PLANT MATERIAL SCHEDULE

PARKER RODRIGUEZ, INC.

Drawn by: _____

Checked by: _____

Date: _____

Scale: _____

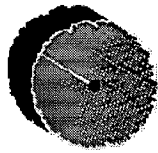

Willow Oak / Red Oak / Sugar Maple



Service Berry



American Hornbeam



Dogwood

Why do the street trees have to be set at such regular intervals? Especially on the historic side?

Explain the tree selections to me.

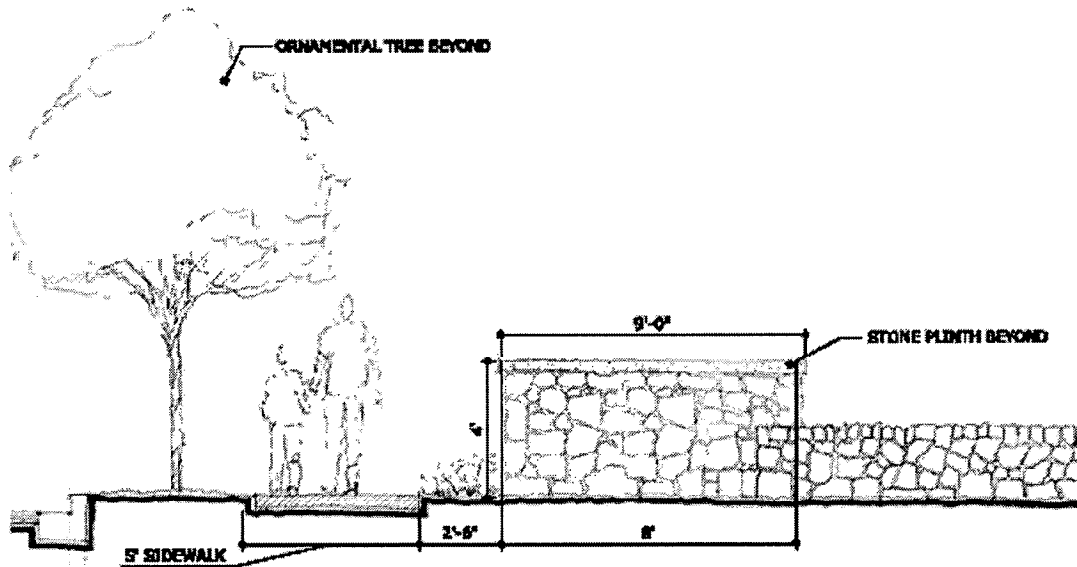

2 STONE ENTRY PLINTH AND PILLAR - WEST ELEVATION
3/8"=1'-0"

Why Type A along Ludlow Lane?

1/8" = 1'-0"

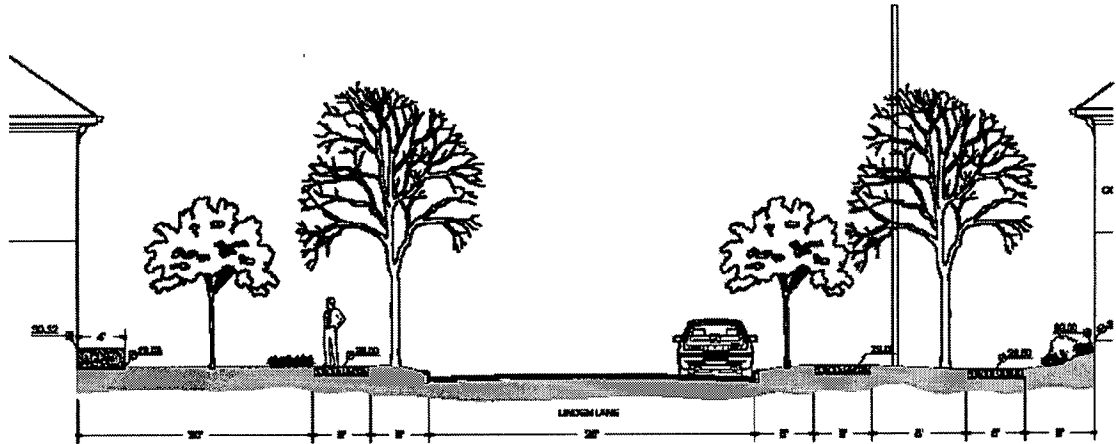

3 SECTION C
1/8" = 1'-0"

Ordering Guide

Large and Small Arealyte Ordering Guide

1 HOUSING



PA3 Large



PA2 Small

2 ARM



S Straight Arm



C Curved Arm



*HT
Horizontal Slipfitter
2 3/4" O.D.
Horizontal Mast Arm



*AT
Adjustable Arm
Vertical 2 3/4" O.D. x 4"
Pole Top Tenon Adapter

* Do not specify mounting.

3 MOUNTING

3 3" O.D. Round Pole

4 4" O.D. Round Pole

5 5" O.D. Round Pole

*6 6" O.D. Round Pole

S Square Pole

W Wall Mount

* Used only with straight arm.

4 FINISH



A Black



B White



H Bronze



X Silver

PA3

C

4

A

Ordering Example: PA3C4A3400HG V

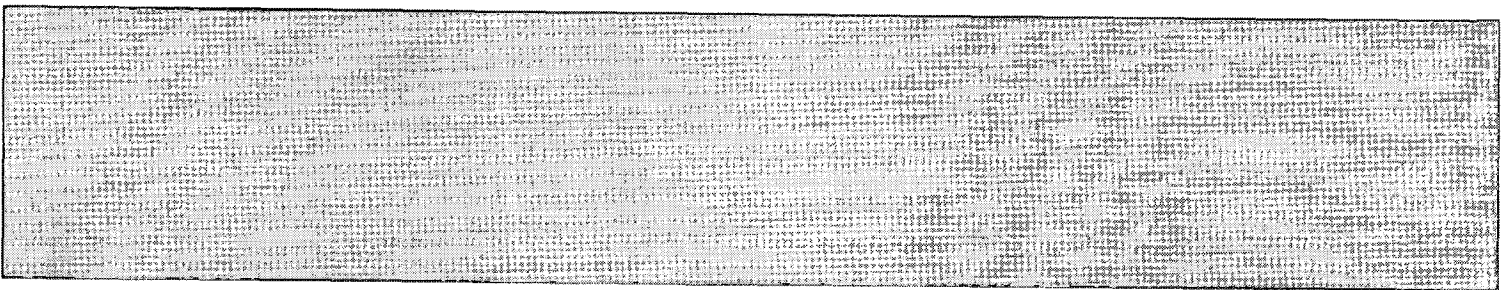

15 OPTICS

- * ① Type I
- ② Type II
- ③ Type III
- * ④ Type IV
- ⑤ Type V
- ⑥ Forward Throw

* Not available for PA2 fixture.

16 WATTAGE/LAMP

Mogul Base
PA3

- ①50S 150 W HPS E23.5
- ②50S 250 W HPS E18
- ④00S 400 W HPS E18
- ①75H 175 W MH E28
- ②50H 250 W MH E28
- ④00H 400 W MH E28

Medium Base
PA2

- ⑦0S 70 W HPS E17
- ①00S 100 W HPS E17 †
- ①50S 150 W HPS E17
- + ⑤0H 50 W MH E17
- + ⑦0H 70 W MH E17
- * ①00H 100 W MH E17
- * ①50H 150 W MH E17
- ①75H 175 W MH E17

† Not available in 480 Volt

17 VOLTAGE

- ① 120V
- ② 208V
- ③ 240V
- ④ 277V
- ⑤ 347V
- ⑥ 480V

18 OPTIONS

- ① None
- ② Air Filter
- * ③ Button Eye Photo Control
- ④ Fusing
- + ⑤ Polycarbonate Shield
- + ⑥ House-Side Shield
- ⑦ Quartz Restrike
- ⑧ PE Receptacle
- + ⑨ Terminal Block
- ⑩ Tamper-Resistant Latch

+ ① Not available in 480V

+ ② Not available with Type V or Forward Throw optics

* ③ PA3 fixture only

+ ④ Polycarbonate shield available up to 250W max.

①50

④00H

④00

④00

HABCO

TYPE V NARROW GLOBES

NARROW GLOBES ORDERING GUIDE

| 1 | 2 | 3 | 4 | 5 | 6 |
|--|-----|-----------------------------------|---|---|---|
| GLOBE | POD | ROOF | CAGE | FINIAL | FASTENER |
| <p>(R5) PolyAcryl™ Type V Narrow</p> | | <p>A Victorian</p> <p>B Acorn</p> | <p>A</p> <p>B</p> <p>E</p> <p>F</p> <p>G</p> <p>H</p> <p>(N) None</p> <p>^e Not available with pod A.</p> | <p>A</p> <p>B</p> <p>C</p> <p>D</p> <p>E</p> <p>F</p> <p>G</p> <p>H</p> <p>(N) None</p> <p>^f FINIAL Finial C, D, E cannot be used with roof B.</p> | <p>1 Hex head bolt for post fitter and globe holder.</p> <p>2 Allen head set screws for post fitter and globe holder.</p> |

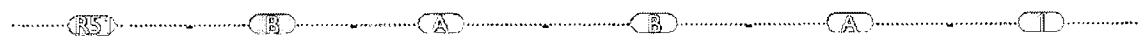

7 FINISH

- (A) Black
- (B) White
- (H) Bronze
- (I) Green

8 REFLECTOR

- (D) Sm Reflector
- (F) Sm Reflector w/House Side
- (G) Full Top w/ House Side
- (H) House Side
- (T) Full Top
- (N) None

9 PHOTO CONTROL

- (B) Button Photo Control
- (R) Twist-Lock Receptacle
- (N) None

10 SOCKET

- (D) Medium
- (G) Mogul
- (R) Inductive

SOCKET

- D and G - 70S to 100S and 175H
- D only for 70H
- G only for 200 and 250 S-H

11 WATTAGE/SOURCE

- (70 H) 70 W MH
- (100 H) 100 W MH
- (150 H) 150 W MH
- (175 H) 175 W MH
- (200 H) 200 W MH
- (250 H) 250 W MH
- (70 S) 70 W HPS
- (100 S) 100 W HPS
- (150 S) 150 W HPS
- (200 S) 200 W HPS
- (250 S) 250 W HPS
- (150 R) 150 W INDUCTIVE
- (100 R) 100 W INDUCTIVE
- (85 R) 85 W INDUCTIVE
- (55 R) 55 W INDUCTIVE
- (165 R) 165 W INDUCTIVE

WATTAGE/ SOURCE

Pods C, D, F have a 200 watt limit. Cannot use 250 watts.

12 VOLTAGE

- (E) 120 V
- (F) 208V
- (G) 240V
- (H) 277V
- (K) 347V

VOLTAGE

- 70, 100, 175, 250S to H (E, F, G, H, K)
- 200S (E, F, G, H)
- 200H (E, F, G, H)
- 150R and 100R (E, F, G)
- 165R, 85R, and 55R (E, G)

Fixtures shall be UL, cUL Listed.

Ordering Example: R51BABA1AFBG70HE



TYPE V

NARROW BODY SPECIFICATIONS

III GLOBE



- (R51) Type V Narrow globe shall be constructed of clear injection-molded acrylic (R52) or *polyacryl™ (R51), utilizing a slip-fit $\frac{1}{2}$ " overlap, two-piece design utilizing nutserts in the top globe section and stainless steel fasteners in the bottom globe which eliminates a "butt-glue" seam appearance. The bottom optical section of the globe shall have a neck opening of $7\frac{1}{4}$ " at the smallest diameter and an outside dimension of 8" at the bottom, be a minimum of $15\frac{1}{2}$ " in height and $14\frac{15}{16}$ " in width at the top with 117 horizontal prisms and 360 vertical prisms which shall be highly polished.

III ROOF



- (A) Victorian style roof shall be clear molded *polyacryl™, a minimum of $10\frac{1}{4}$ " in height with 79 horizontal prisms allowing the top to softly glow evenly. Width shall be $14\frac{15}{16}$ " to allow the top and bottom globe sections to be secured in a $\frac{1}{2}$ " slip-fit overlap design using four (4) #10-24 stainless steel pan head screws with four aluminum nutserts providing a mechanical lock and enabling easy future replacement of either the top or bottom globe sections if required.



- (B) Acorn style roof shall be clear molded *polyacryl™, a minimum of $7\frac{3}{4}$ " in height with 62 horizontal prisms allowing the top to softly glow evenly. Width shall be $14\frac{15}{16}$ " to allow the top and bottom globe sections to be secured in a $\frac{1}{2}$ " slip-fit overlap design using four (4) #10-24 stainless steel pan head screws with four aluminum nutserts providing a mechanical lock and enabling easy future replacement of either the top or bottom globe sections if required.



- (C) Roof shall be .090" thick spun aluminum, a height of 10" and width of $15\frac{3}{16}$ ". The top and bottom globe sections shall be secured in a $\frac{1}{2}$ " slip-fit overlap design using four (4) #10-24 stainless steel pan head screws with four aluminum nutserts providing a mechanical lock and enabling easy future replacement of either the top or bottom globe sections if required. Finish to be as specified, polyester thermoset powdercoat.



- (D) Roof shall be .090" thick spun aluminum, a height of $7\frac{1}{2}$ " and width of $15\frac{3}{16}$ ". The top and bottom globe sections shall be secured in a $\frac{1}{2}$ " slip-fit overlap design using four (4) #10-24 stainless steel pan head screws with four aluminum nutserts providing a mechanical lock and enabling easy future replacement of either the top or bottom globe sections if required. Finish to be as specified, polyester thermoset powdercoat.

POLYACRYL™ - A specially formulated polymer, which has the superior impact resistant features approaching that of polycarbonate in addition to the clarity, performance, and non-yellowing characteristics of acrylic.

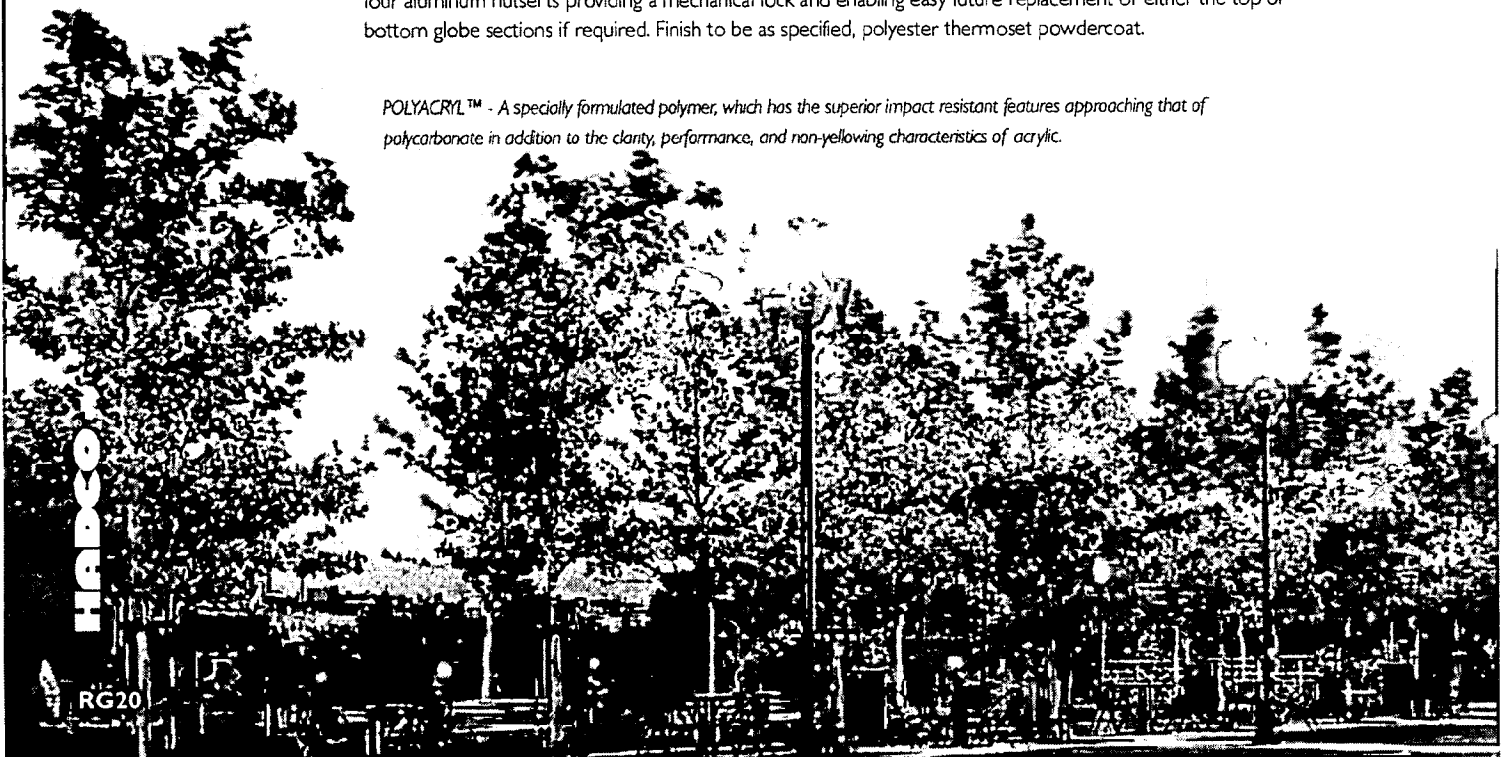

TYPE V NARROW GLOBES

HORIZONTAL FOOTCANDLES

Non Cut-Off Test # TR98123
 No Reflector
 150W HPS
 Total Lumens = 16,000
 Mounting Height = 12 ft.

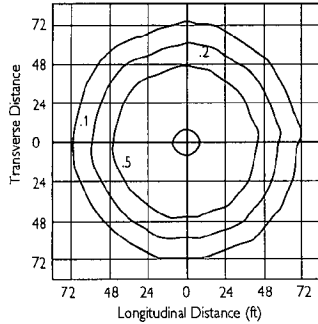

 Non Cut-Off Test # TR98124
~~Full Top Reflector~~
 150W HPS
 Total Lumens = 16,000
 Mounting Height = 12 ft.

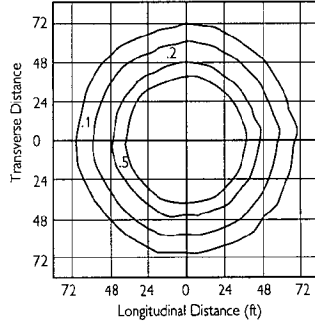

 Non Cut-Off Test # TR98127
~~Sm Reflector w/ House side shield~~
 150W HPS
 Total Lumens = 16,000
 Mounting Height = 12 ft.

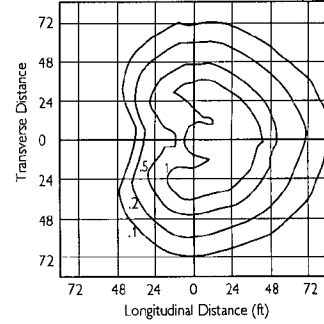

CONVERSION CHARTS FOR ISOLUX

| MOUNTING HEIGHT | | | | | | | |
|-----------------|------|------|-----|-----|-----|-----|-----|
| Mtg. Height | 10' | 11' | 12' | 13' | 14' | 15' | 16' |
| Multiplier | 1.44 | 1.19 | 1.0 | .86 | .73 | .64 | .56 |

| LAMP & WATTAGE | | | | |
|----------------|------|------|------|------|
| Lamp | 175W | 250W | 150W | 250W |
| | MH | MH | HPS | HPS |
| Mult. | .87 | 1.28 | 1.0 | 1.7 |

COEFFICIENTS OF UTILIZATION

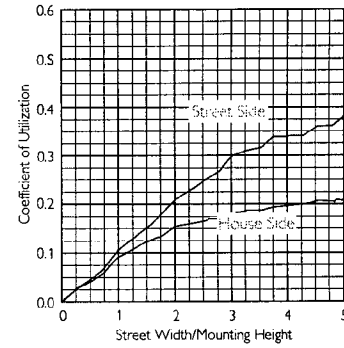
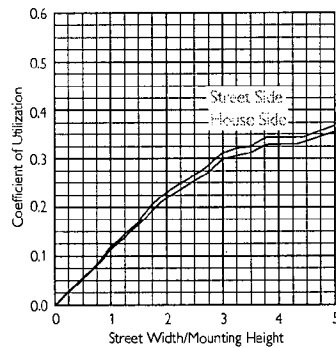
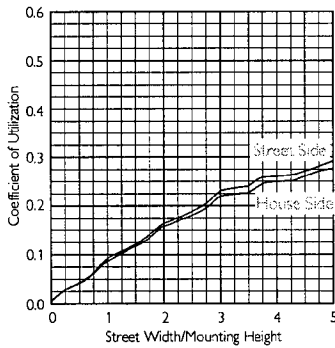

LUMENS OUTPUT & EFFICIENCY

| | LUMENS | PERCENT OF LAMP |
|----------------------|--------|-----------------|
| Downward Street Side | 5381 | 33.6 |
| Downward House Side | 5651 | 35.3 |
| Downward Total | 11032 | 68.9 |
| Upward Street Side | 2414 | 15.1 |
| Upward House Side | 2408 | 15.1 |
| Upward Total | 4822 | 30.1 |
| Total Flux | 15854 | 99.1 |

| | LUMENS | PERCENT OF LAMP |
|----------------------|--------|-----------------|
| Downward Street Side | 6499 | 40.6 |
| Downward House Side | 6757 | 42.2 |
| Downward Total | 13256 | 82.8 |
| Upward Street Side | 737 | 4.6 |
| Upward House Side | 760 | 4.8 |
| Upward Total | 1497 | 9.4 |
| Total Flux | 14753 | 92.2 |

| | LUMENS | PERCENT OF LAMP |
|----------------------|--------|-----------------|
| Downward Street Side | 7789 | 48.7 |
| Downward House Side | 3689 | 23.1 |
| Downward Total | 11478 | 71.7 |
| Upward Street Side | 1691 | 10.6 |
| Upward House Side | 987 | 6.2 |
| Upward Total | 2678 | 16.7 |
| Total Flux | 14156 | 88.5 |

HABCO